

COLLINS AND TURNER

BANK STREET PARK
(TJERRUING PARK)

Location Plan



Location	1A-19 Bank Street Pyrmont NSW 2009 Australia Lots 1 & 2 DP 1089643
Proposed Work	New waterfront public park, ancillary buildings and structures
Landscape & Urban Design	Oculus Roger Jasprizza Level 1, 5 Wilson Street, Newtown NSW 2042
Civil Engineering	Enspire Solutions Robert Hutchinson Level 4, 153 Walker St, North Sydney NSW 2060
BCA AND DDA	Philip Chun Philip Smillie Suite 22.02, Level 22, 264 George Street, Sydney NSW 2000
CPTED	Core42 Codee Ludbey Level 32, 152 St Georges Terrace, Perth WA 6000
Facade & Structural Engineering	Eckersley O'Callaghan Tom Donald Suite 6, Level 3, 11-17 Buckingham St, Surry Hills NSW 2010
Geotechnical Engineering	JKGeotechnics Owen Fraser 115 Wicks Road, Macquarie Park NSW 2113
Heritage Consultant	GML Heritage Patrick Atkinson Level 17, 323 Castlereagh St, Haymarket NSW 2000
Quantity Surveyor	Altus Group Yang Ong Level 12, 1 Market St, Sydney NSW 2000
Arboriculturalist	treeiQ Anna Hopwood & Michael Peacock PO Box 146, Summer Hill NSW 2130

Drawings

General

000	Cover Sheet
010	Title Sheet

Site Plans

111	Site Plan (Detail)	1:200
112	Site Analysis	1:200
113	Existing Plan	1:100
114	Existing Plan	1:100

Demo Plans

120	Demolition Plan	1:100
-----	-----------------	-------

GA Plans

140	Northwest Architectural Ground Floor Plan	1:100
141	Northwest Architectural Roof Plan	1:100
142	Pylon Surrounds Architectural Ground Floor Plan	1:100
143	Pylon Surrounds Architectural Roof Plan	1:100

Elevations

201	Elevations - 1-3 Bank Street	1:100
202	Elevations - 1-3 Bank Street	1:100
203	Elevations - 1-3 Bank Street	1:100
204	Elevations - 1-3 Bank Street	1:100
205	Elevations - Dragon Boat Storage	1:100
206	Elevations - Dragon Boat Storage	1:100

Sections

310	Sections - 1-3 Bank Street	1:100
311	Sections - 1-3 Bank Street	1:100
312	Sections - Dragon Boat Storage	1:100

GFA Diagrams

411	Area Diagram	1:200
412	Signage Strategy Plan	1:100, 1:1

Legend

ACC	Accessible WC
AMB	Ambulant WC
AO	Access opening
B	Basin, to architect's future detail and specification
BAL	External balustrade, to architect's future detail
BWK1	Recycled brickwork
BWK2	Existing brickwork; cleaned and made good where necessary
CAV	Accessible drainage cavity
EX	Existing
FAM	Family room
GL	Glass
GR	Green roof
GU	Gutter
MDR	Standing seam zinc (metal deck roof)
NGL	Natural ground level
OFC	Off-form concrete
PV	Photo-voltaic cells
SCR1	Screen - metal frame with varied material segments - to architect's future detail
SCR2	Screen - metal frame only - to architect's future detail
TDK	Timber decking
U	Urinal
WC	Toilet

Notes

Refer to surveyor, landscape, civil and heritage consultant's supporting DA documentation for further detail of these areas

BANK STREET PARK (TJERRUING PARK) 1A-19 BANK STREET PYRMONT

STATE SIGNIFICANT DEVELOPMENT APPLICATION SSD-53386706

COLLINS AND TURNER ARCHITECTURAL DRAWINGS

NOVEMBER, 2023

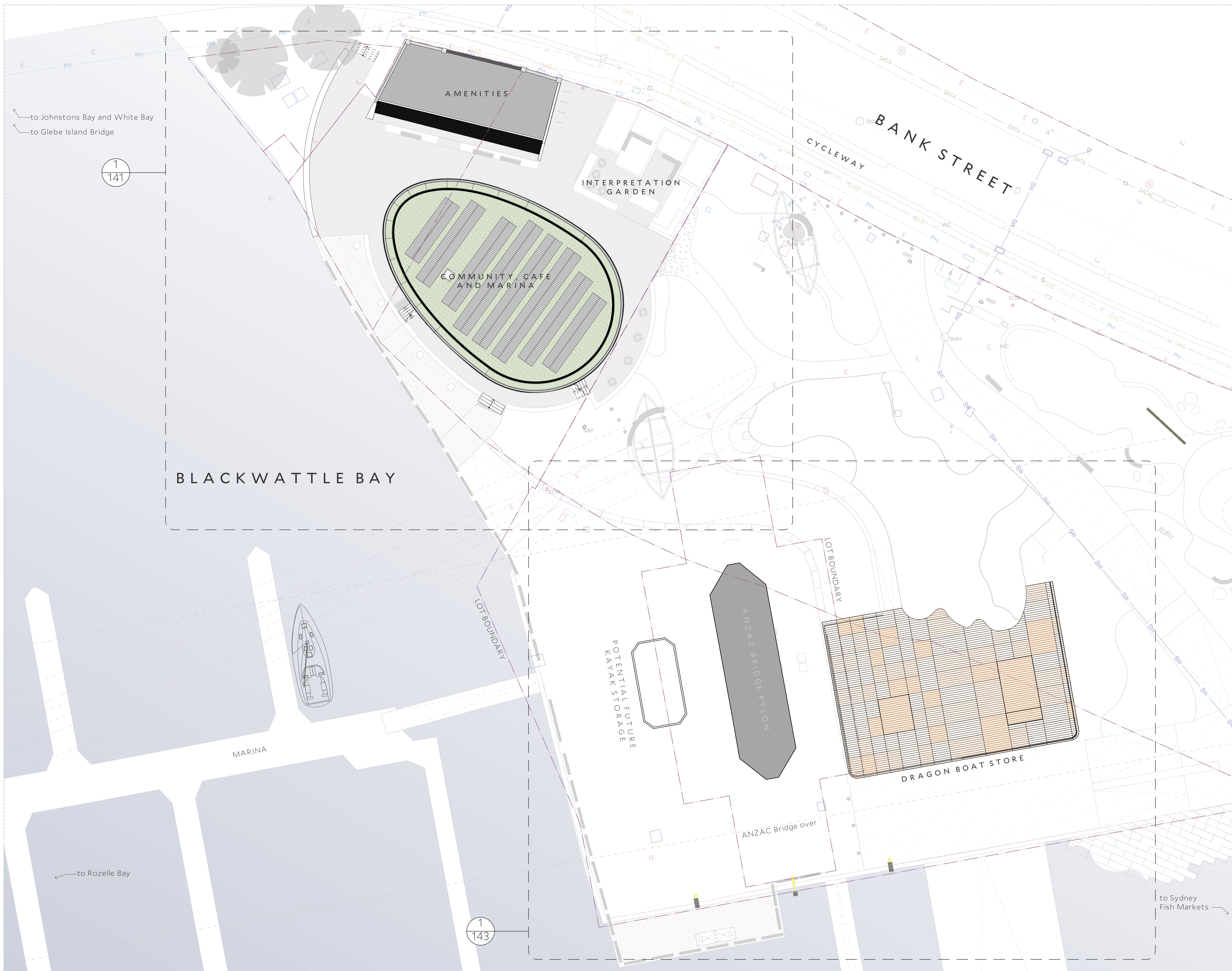

Architect Collins and Turner Pty Ltd
 Suite 6, Level 3, 11-17 Buckingham St
 Surry Hills NSW 2010 Australia
 telephone +612 9356 3217
 info@collinsandturner.com
 collinsandturner.com
 Registered Architect in NSW
 Penelope Collins ARB 7342

- Notes**
- 01 Do not scale; dimensions govern
 - 02 All dimensions are in millimeters
 - 03 All dimensions to be verified on site
 - 04 Collins and Turner is to be notified of any discrepancies



- Legend**
- - - Site boundary
 - - - Lot boundaries
 - - - Easements
 - - - Tree Protection Zone

No	Date	By	Note
01	1/9/2023	TD	For consultant information
02	21/9/2023	TD	Draft SSDA
03	13/10/2023	TD	For SSDA
06	27/11/2023	AL	For SSDA

Client
 Infrastructure NSW
 Level 27, 201 Kent St
 Sydney NSW 2000

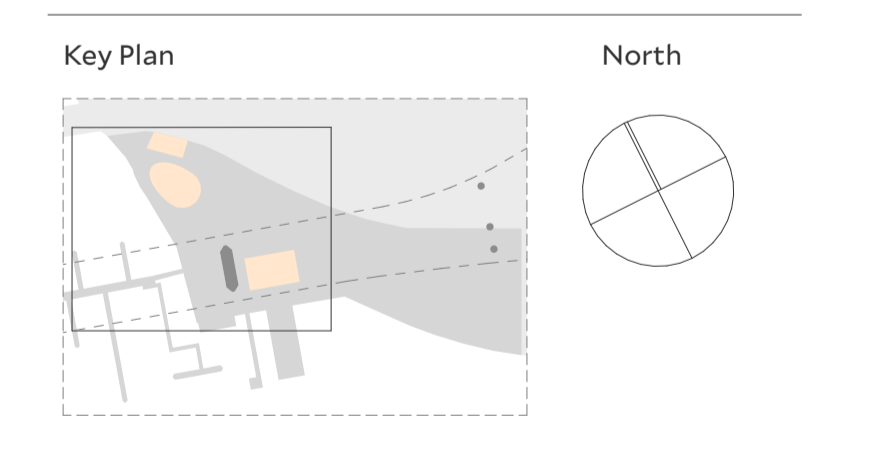

Project
 Bank Street Park
 (Tjerruing Park)
 1A-19 Bank Street
 Pyrmont, NSW

Copyright Collins and Turner 2023

Drawing Title
 Site Plan (Detail)

Scale 1:200 @ A1
 Date 1/9/23
 Drawn by TD

Drawing number+ 346_SSDA_111
 revision 06

to Johnstons Bay and White Bay
 to Glebe Island Bridge

1
141

BLACKWATTLE BAY

MARINA

to Rozelle Bay

1
143

to Sydney Fish Markets



Architect Collins and Turner Pty Ltd
 Suite 6, Level 3, 11-17 Buckingham St
 Surry Hills NSW 2010 Australia
 telephone +612 9356 3217
 info@collinsandturner.com
 collinsandturner.com
 Registered Architect in NSW
 Penelope Collins ARB 7342

- Notes
- 01 Do not scale; dimensions govern
 - 02 All dimensions are in millimeters
 - 03 All dimensions to be verified on site
 - 04 Collins and Turner is to be notified of any discrepancies



- Legend
- Site boundary
 - Lot boundaries
 - Easements

No	Date	By	Note
01	21/9/2023	TD	Draft SSSDA
02	13/10/2023	TD	For SSSDA
06	27/11/2023	AL	For SSSDA

Client
 Infrastructure NSW
 Level 27, 201 Kent St
 Sydney NSW 2000

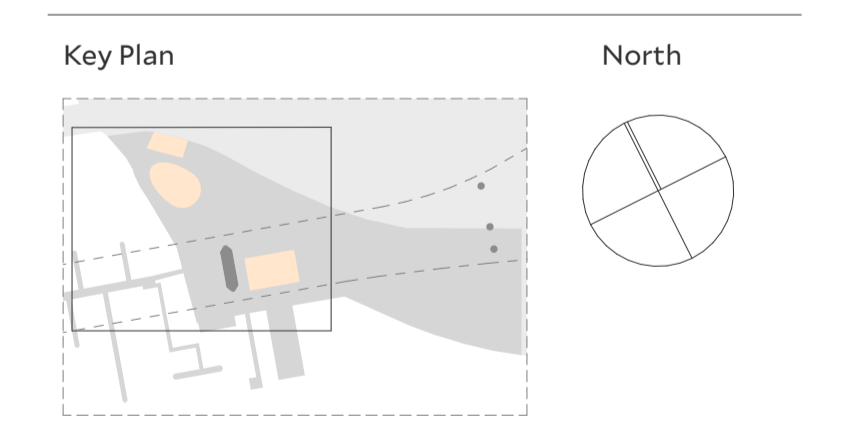

Project
 Bank Street Park
 (Tjerruing Park)
 1A-19 Bank Street
 Pyrmont, NSW

Copyright Collins and Turner 2023

Drawing Site Analysis
 Title

Scale 1:200 @ A1
 Date 21/9/23
 Drawn by TD

Drawing number+ 346_SSDA_112
 revision

to Johnstons Bay and White Bay
 to Glebe Island Bridge

1
141

BLACKWATTLE BAY

Winter Sunset

Summer Sunrise

MARINA

Hot Westerly Winds

to Rozelle Bay

Summer Sunset

1
143

ANZAC Bridge over

Cool Southerly Winds

to Sydney Fish Markets



Architect Collins and Turner Pty Ltd
 Suite 6, Level 3, 11-17 Buckingham St
 Surry Hills NSW 2010 Australia
 telephone +612 9356 3217
 info@collinsandturner.com
 collinsandturner.com
 Registered Architect in NSW
 Penelope Collins ARB 7342

Notes 01 Do not scale; dimensions govern
 02 All dimensions are in millimeters
 03 All dimensions to be verified on site
 04 Collins and Turner is to be notified of any discrepancies



Legend
 --- Site boundary
 --- Lot boundaries
 --- Easements

No	Date	By	Note
01	24/8/2023	TD	For consultant information
02	1/9/2023	TD	For consultant information
03	21/9/2023	TD	Draft SSDA
04	13/10/2023	TD	For SSDA
06	27/11/2023	AL	For SSDA

Client
 Infrastructure NSW
 Level 27, 201 Kent St
 Sydney NSW 2000

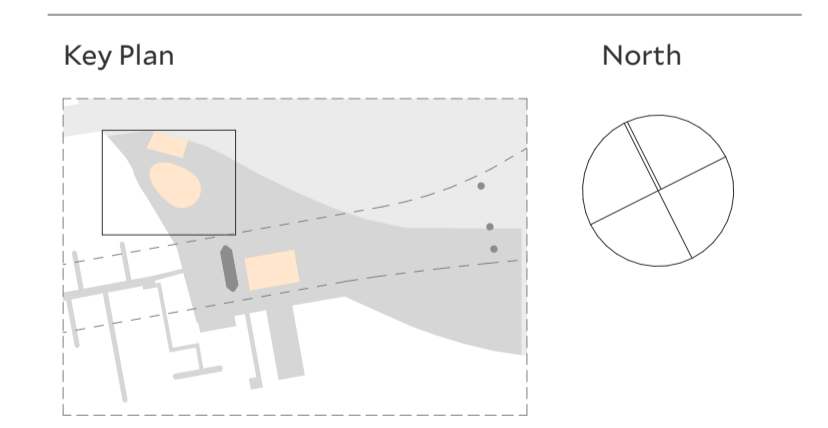

Project
 Bank Street Park
 (Tjerruing Park)
 1A-19 Bank Street
 Pymont, NSW

Copyright Collins and Turner 2023

Drawing Title
 Existing Plan

Scale 1:100 @ A1
 Date 24/8/23
 Drawn by TD

Drawing number+ revision
 346_SSDA_113

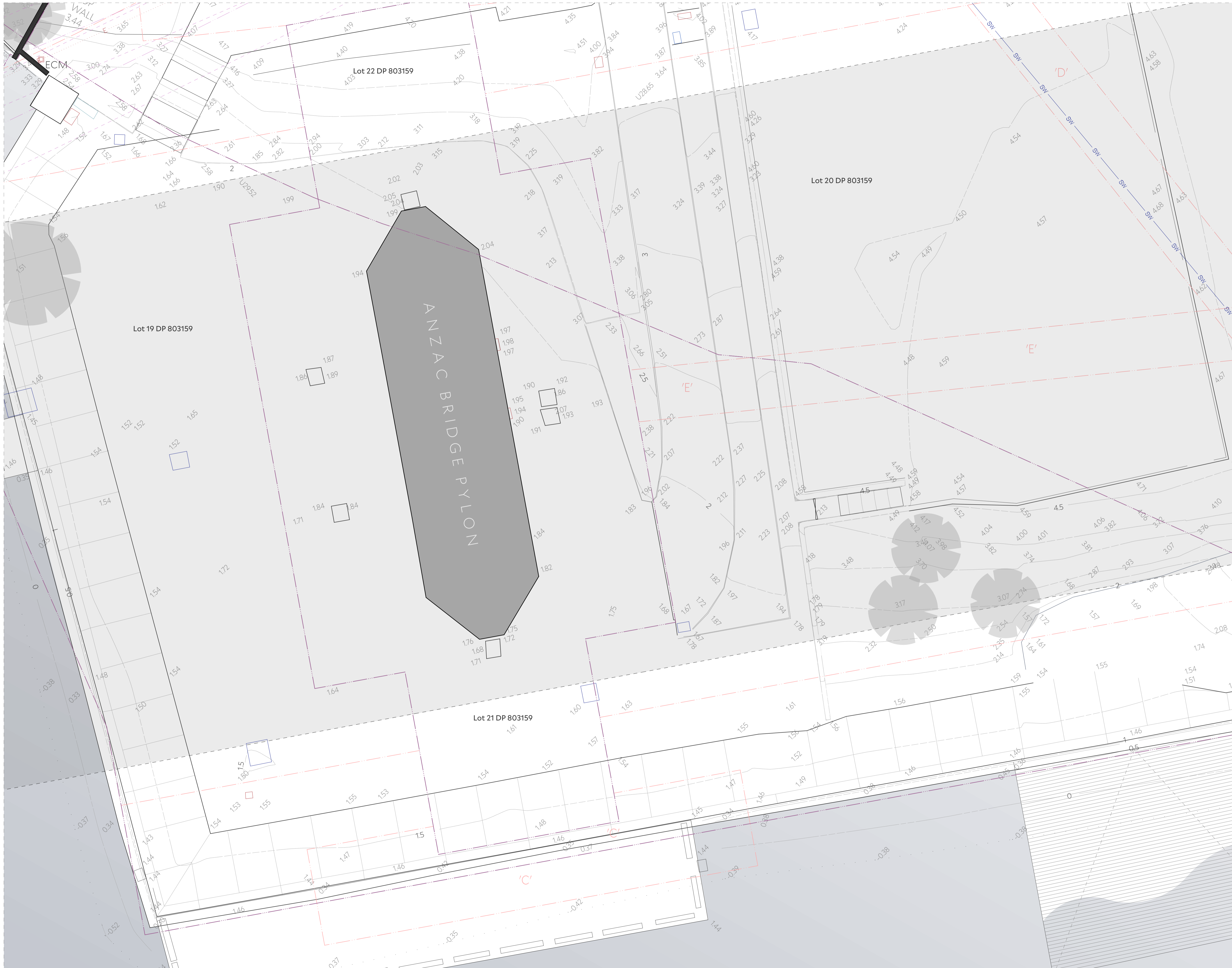

Architect Collins and Turner Pty Ltd
 Suite 6, Level 3, 11-17 Buckingham St
 Surry Hills NSW 2010 Australia
 telephone +612 9356 3217
 info@collinsandturner.com
 collinsandturner.com
 Registered Architect in NSW
 Penelope Collins ARB 7342

- Notes**
- 01 Do not scale; dimensions govern
 - 02 All dimensions are in millimeters
 - 03 All dimensions to be verified on site
 - 04 Collins and Turner is to be notified of any discrepancies



- Legend**
- Site boundary
 - Lot boundaries
 - Easements

No	Date	By	Note
01	1/9/2023	TD	For consultant information
02	21/9/2023	TD	Draft SSDA
03	13/10/2023	TD	For SSDA
06	27/11/2023	AL	For SSDA

Client
 Infrastructure NSW
 Level 27, 201 Kent St
 Sydney NSW 2000

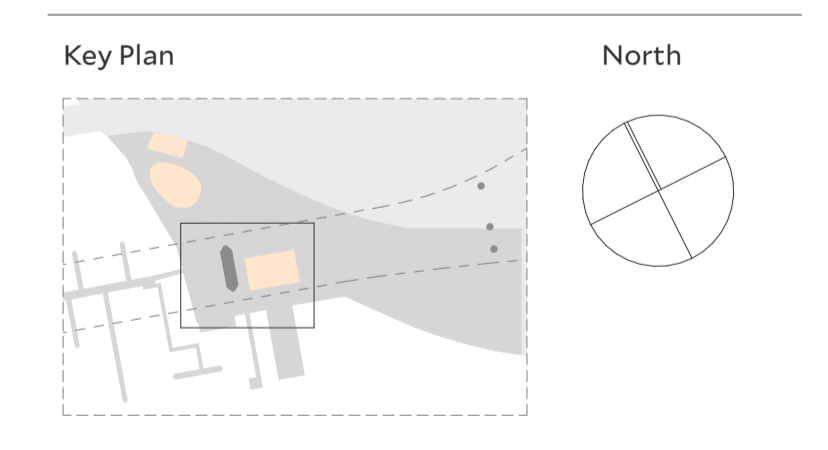

Project
 Bank Street Park
 (Tjerruing Park)
 1A-19 Bank Street
 Pymont, NSW

Copyright Collins and Turner 2023

Drawing Title
 Existing Plan

Scale 1:100 @ A1
 Date 1/9/23
 Drawn by TD

Drawing number+ 346_SSDA_114
 revision 06

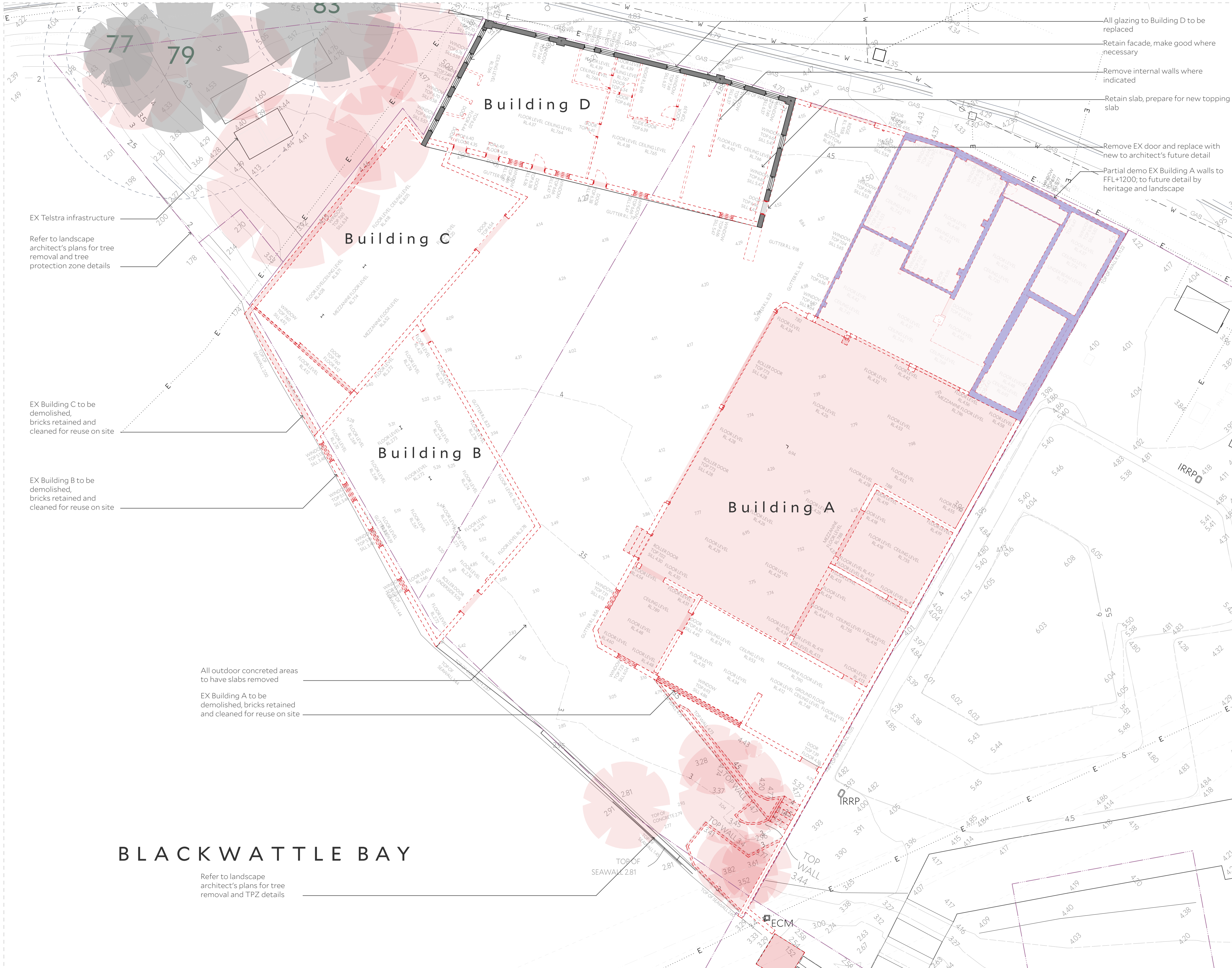

- All glazing to Building D to be replaced
- Retain facade, make good where necessary
- Remove internal walls where indicated
- Retain slab, prepare for new topping slab
- Remove EX door and replace with new to architect's future detail
- Partial demo EX Building A walls to FFL+1200; to future detail by heritage and landscape

EX Telstra infrastructure

Refer to landscape architect's plans for tree removal and tree protection zone details

EX Building C to be demolished, bricks retained and cleaned for reuse on site

EX Building B to be demolished, bricks retained and cleaned for reuse on site

All outdoor concreted areas to have slabs removed

EX Building A to be demolished, bricks retained and cleaned for reuse on site

Refer to landscape architect's plans for tree removal and TPZ details

Demolition Notes

This demolition plan is limited to the 1-3 Bank St site, refer to Oculus plans for full demolition details

Architect Collins and Turner Pty Ltd

Suite 6, Level 3, 11-17 Buckingham St
 Surry Hills NSW 2010 Australia
 telephone +612 9356 3217
 info@collinsandturner.com
 collinsandturner.com

Registered Architect in NSW
 Penelope Collins ARB 7342

Notes

01	Do not scale; dimensions govern
02	All dimensions are in millimeters
03	All dimensions to be verified on site
04	Collins and Turner is to be notified of any discrepancies



No	Date	By	Note
01	24/8/2023	TD	For consultant information
02	1/9/2023	TD	For consultant information
05	24/11/2023	AL	For SSDA information
06	27/11/2023	AL	For SSDA

Client

Infrastructure NSW
 Level 27, 201 Kent St
 Sydney NSW 2000

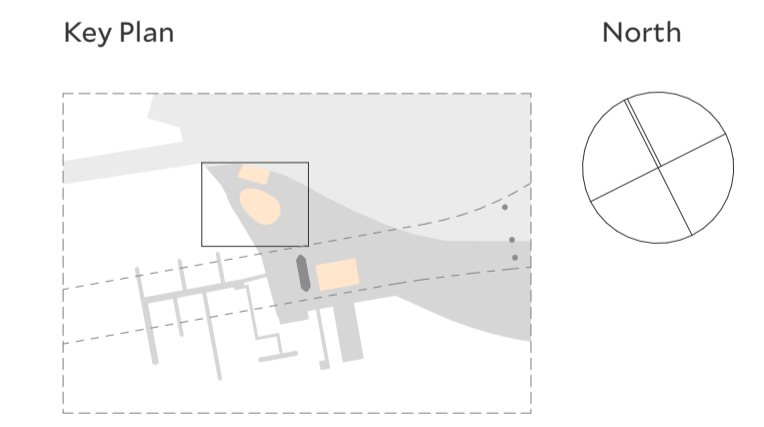

Project

Bank Street Park
 (Tjerruing Park)
 1A-19 Bank Street
 Pymont, NSW

Copyright Collins and Turner 2023

Drawing Title Demolition Plan

Scale 1:100 @ A1
 Date 24/8/23
 Drawn by TD

Drawing number+ revision 346_SSDA_120

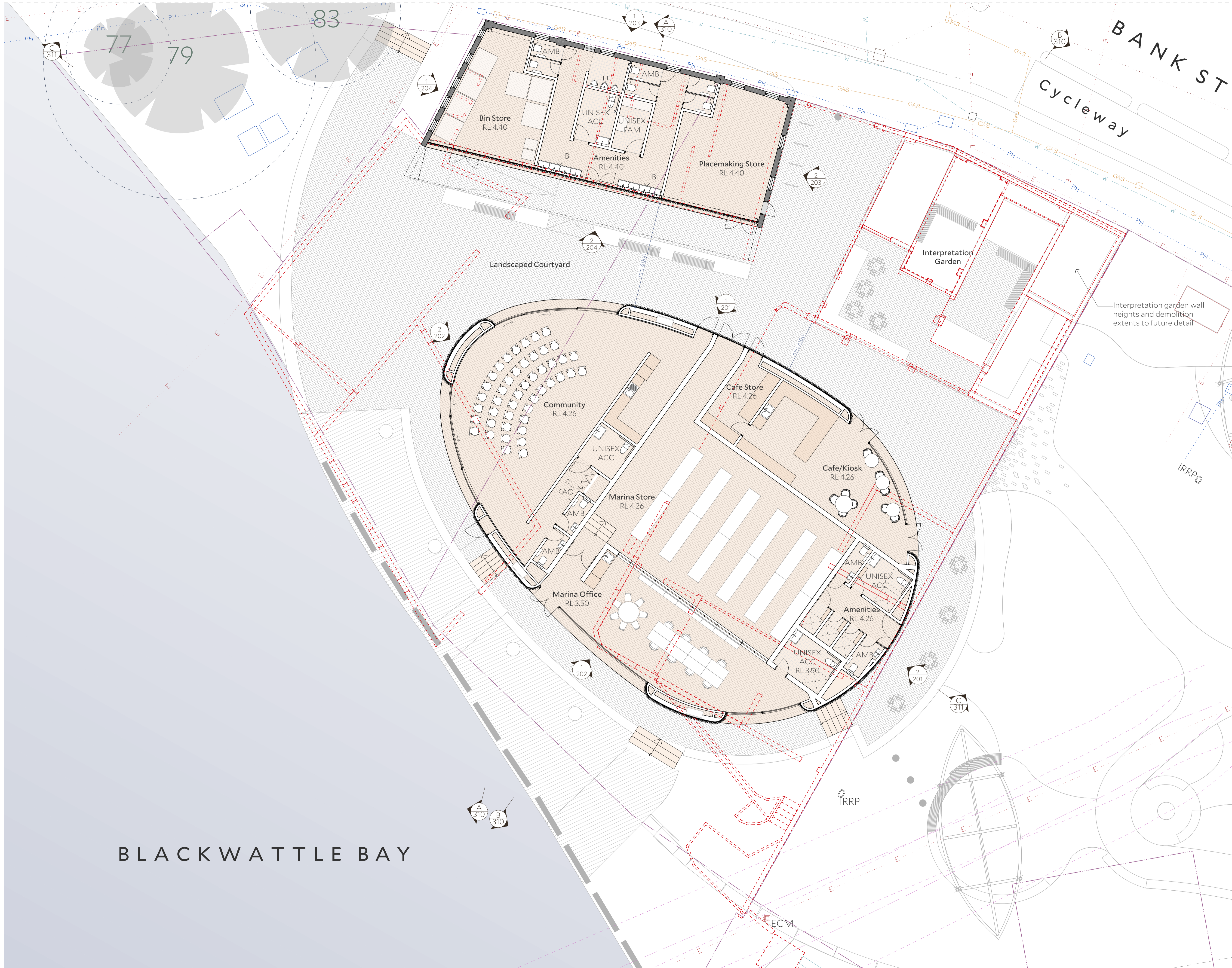

Architect Collins and Turner Pty Ltd
 Suite 6, Level 3, 11-17 Buckingham St
 Surry Hills NSW 2010 Australia
 telephone +612 9356 3217
 info@collinsandturner.com
 collinsandturner.com
 Registered Architect in NSW
 Penelope Collins ARB 7342

- Notes**
- 01 Do not scale; dimensions govern
 - 02 All dimensions are in millimeters
 - 03 All dimensions to be verified on site
 - 04 Collins and Turner is to be notified of any discrepancies



Legend

No	Date	By	Note
01	24/8/2023	TD	For consultant information
02	1/9/2023	TD	For consultant information
03	21/9/2023	TD	Draft SSDA
04	13/10/2023	TD	For SSDA
06	27/11/2023	AL	For SSDA

Client

Infrastructure NSW
 Level 27, 201 Kent St
 Sydney NSW 2000

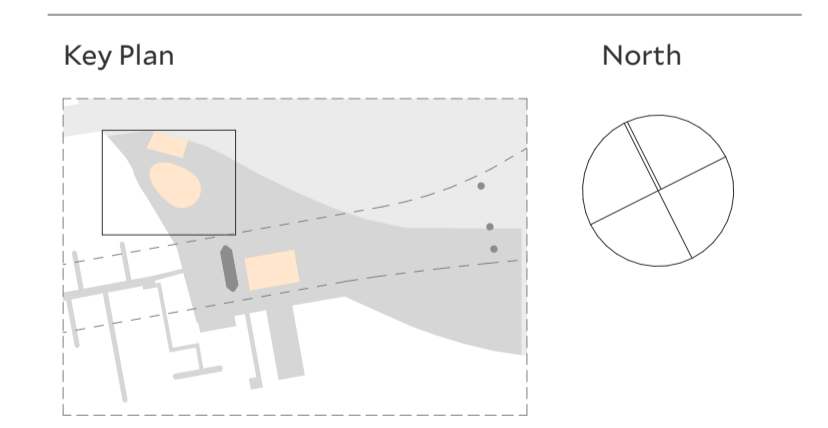

Project

Bank Street Park
 (Tjerruing Park)
 1A-19 Bank Street
 Pyrmont, NSW

Copyright Collins and Turner 2023

Drawing Title Northwest Architectural Ground Floor Plan

Scale 1:100 @ A1
 Date 24/8/23
 Drawn by TD

Drawing number+ 346_SSDA_140
 revision 06



Architect Collins and Turner Pty Ltd
 Suite 6, Level 3, 11-17 Buckingham St
 Surry Hills NSW 2010 Australia
 telephone +612 9356 3217
 info@collinsandturner.com
 collinsandturner.com
 Registered Architect in NSW
 Penelope Collins ARB 7342

Notes

01	Do not scale; dimensions govern
02	All dimensions are in millimeters
03	All dimensions to be verified on site
04	Collins and Turner is to be notified of any discrepancies



Legend

No	Date	By	Note
01	24/8/2023	TD	For consultant information
02	1/9/2023	TD	For consultant information
03	21/9/2023	TD	Draft SSDA
04	13/10/2023	TD	For SSDA
06	27/11/2023	AL	For SSDA

Client
 Infrastructure NSW
 Level 27, 201 Kent St
 Sydney NSW 2000

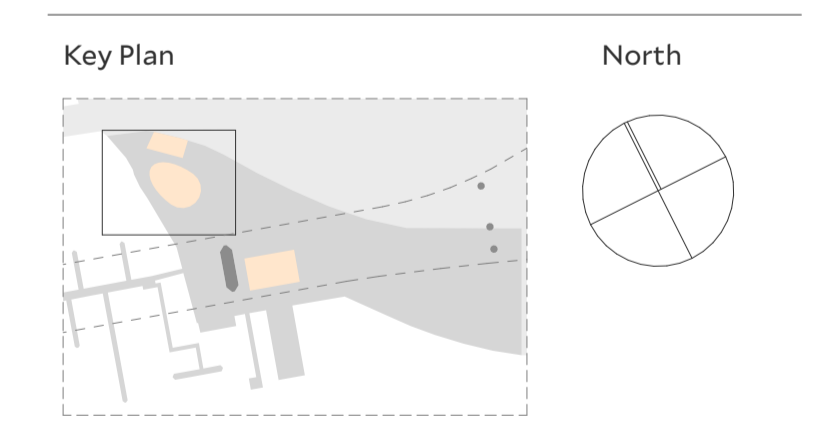

Project
 Bank Street Park
 (Tjerruing Park)
 1A-19 Bank Street
 Pyrmont, NSW

Copyright Collins and Turner 2023

Drawing Title Northwest Architectural Roof Plan

Scale 1:100 @ A1
 Date 24/8/23
 Drawn by TD

Drawing number+ revision 346_SSDA_141 06

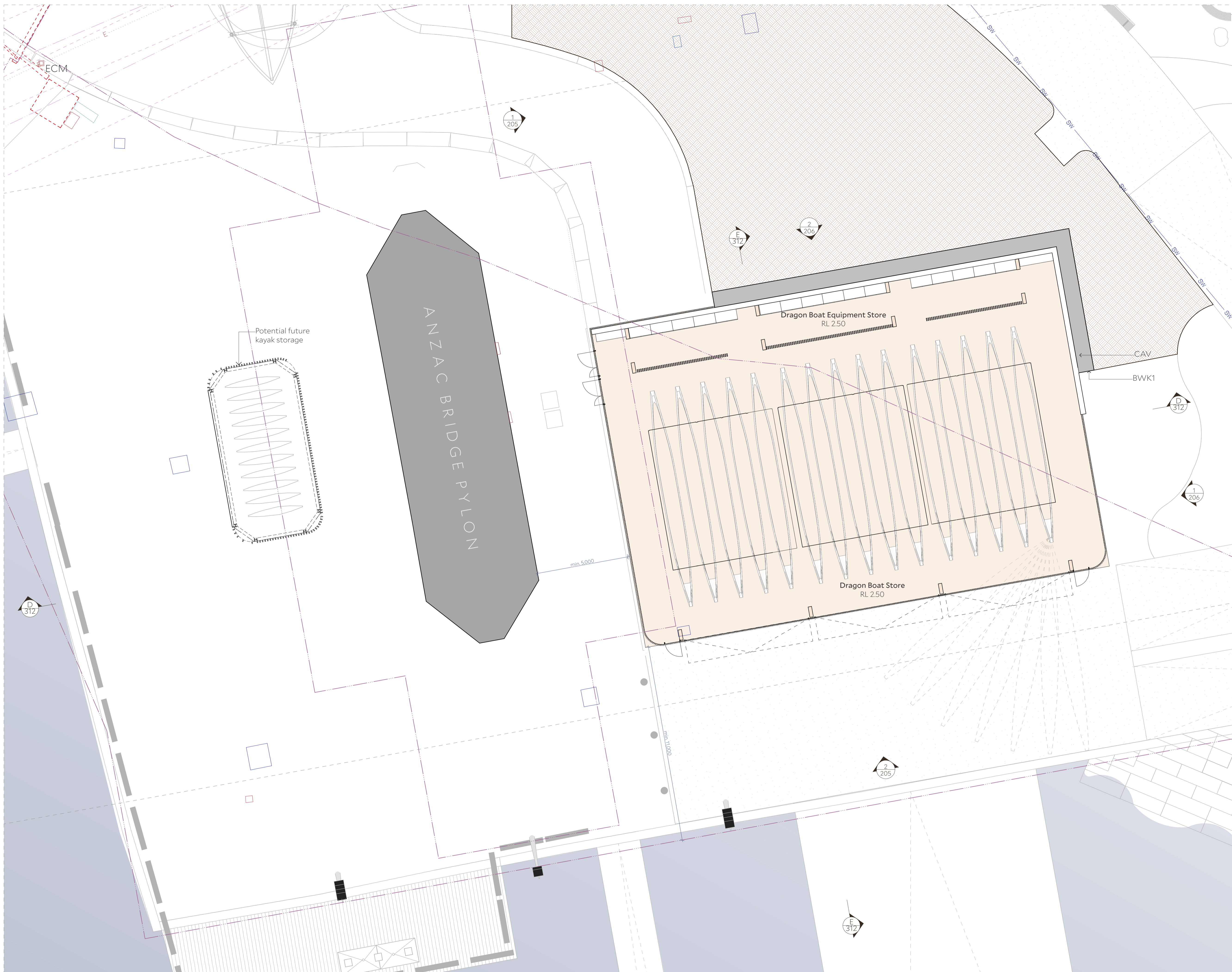

Architect Collins and Turner Pty Ltd
 Suite 6, Level 3, 11-17 Buckingham St
 Surry Hills NSW 2010 Australia
 telephone +612 9356 3217
 info@collinsandturner.com
 collinsandturner.com
 Registered Architect in NSW
 Penelope Collins ARB 7342

- Notes**
- 01 Do not scale; dimensions govern
 - 02 All dimensions are in millimeters
 - 03 All dimensions to be verified on site
 - 04 Collins and Turner is to be notified of any discrepancies



Legend

No	Date	By	Note
01	24/8/2023	TD	For consultant information
02	1/9/2023	TD	For consultant information
03	21/9/2023	TD	Draft SSDA
04	13/10/2023	TD	For SSDA
06	27/11/2023	AL	For SSDA

Client
 Infrastructure NSW
 Level 27, 201 Kent St
 Sydney NSW 2000

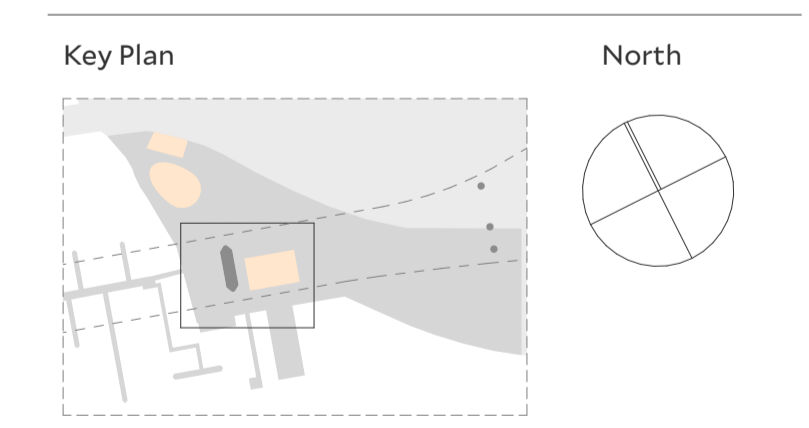

Project
 Bank Street Park
 (Tjerruing Park)
 1A-19 Bank Street
 Pyrmont, NSW

Copyright Collins and Turner 2023

Drawing Title Pylon Surrounds Architectural Ground Floor Plan

Scale 1:100 @ A1
 Date 24/8/23
 Drawn by TD

Drawing number+ revision 346_SSDA_142 06

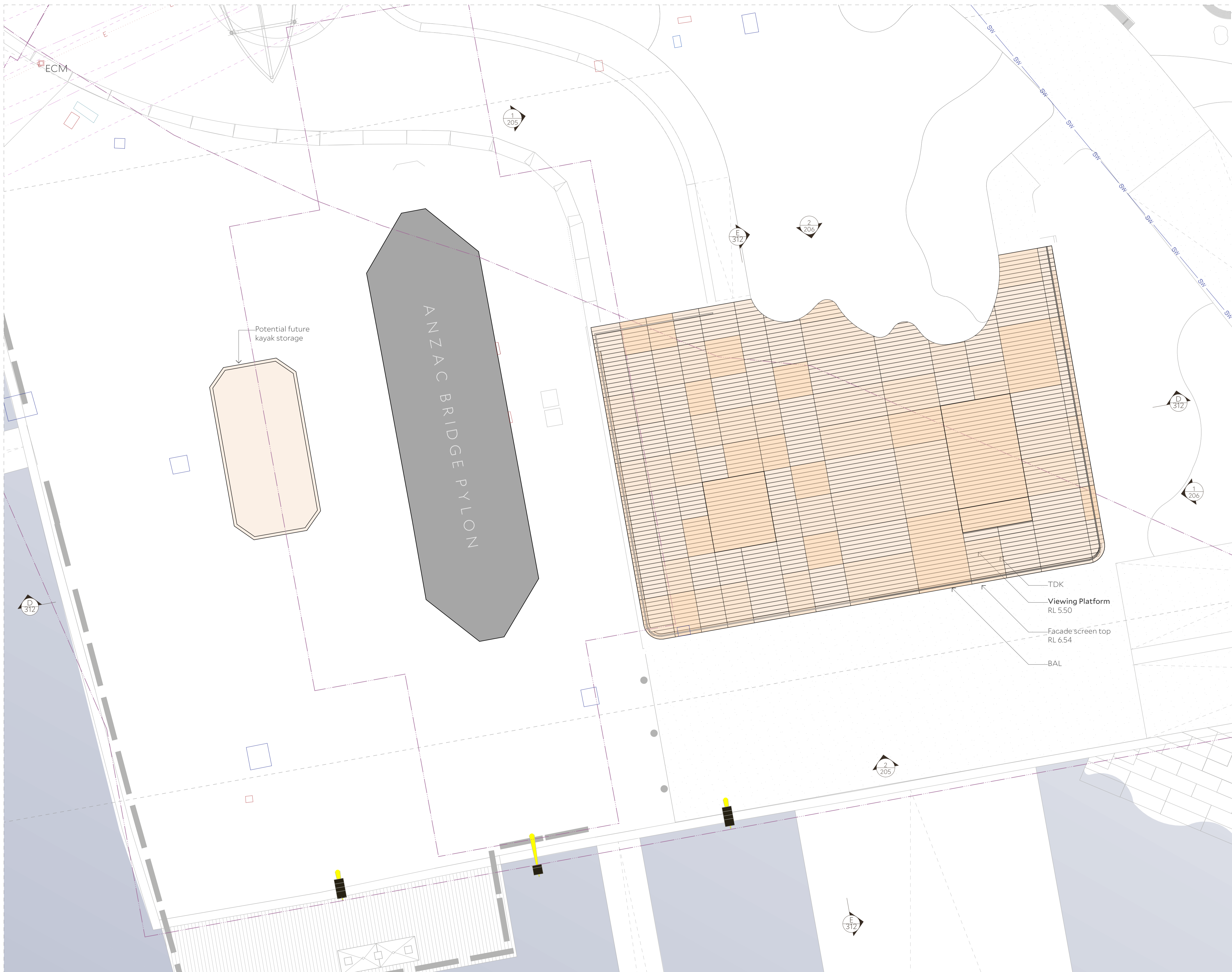

Architect Collins and Turner Pty Ltd
 Suite 6, Level 3, 11-17 Buckingham St
 Surry Hills NSW 2010 Australia
 telephone +612 9356 3217
 info@collinsandturner.com
 collinsandturner.com
 Registered Architect in NSW
 Penelope Collins ARB 7342

Notes

01	Do not scale; dimensions govern
02	All dimensions are in millimeters
03	All dimensions to be verified on site
04	Collins and Turner is to be notified of any discrepancies

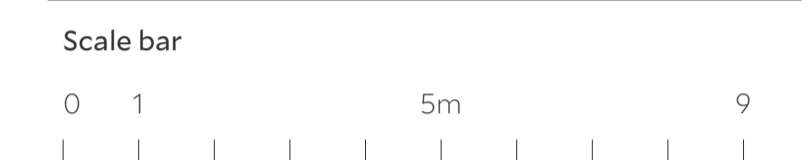

Legend

No	Date	By	Note
01	24/8/2023	TD	For consultant information
02	1/9/2023	TD	For consultant information
03	21/9/2023	TD	Draft SSSA
04	13/10/2023	TD	For SSSA
06	27/11/2023	AL	For SSSA

Client
 Infrastructure NSW
 Level 27, 201 Kent St
 Sydney NSW 2000

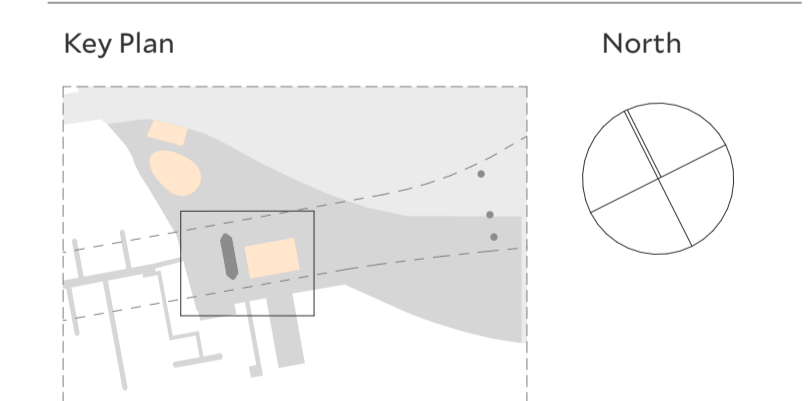

Project
 Bank Street Park
 (Tjerruing Park)
 1A-19 Bank Street
 Pyrmont, NSW

Copyright Collins and Turner 2023

Drawing Title Pylon Surrounds Architectural Roof Plan

Scale 1:100 @ A1
 Date 24/8/23
 Drawn by TD

Drawing number+ revision 346_SSSA_143

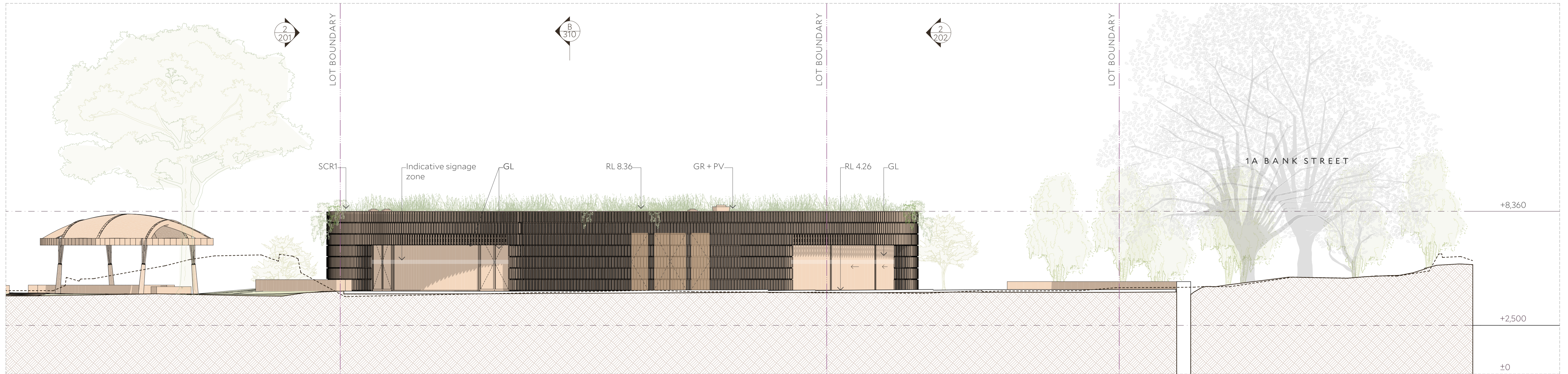
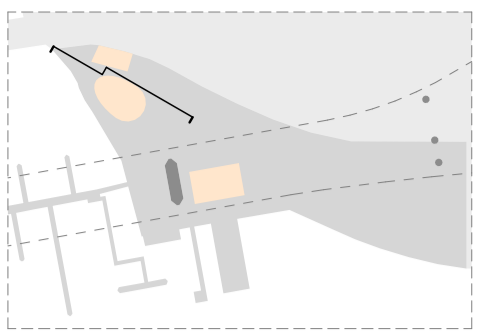

1 Courtyard (North) Facade
1:100

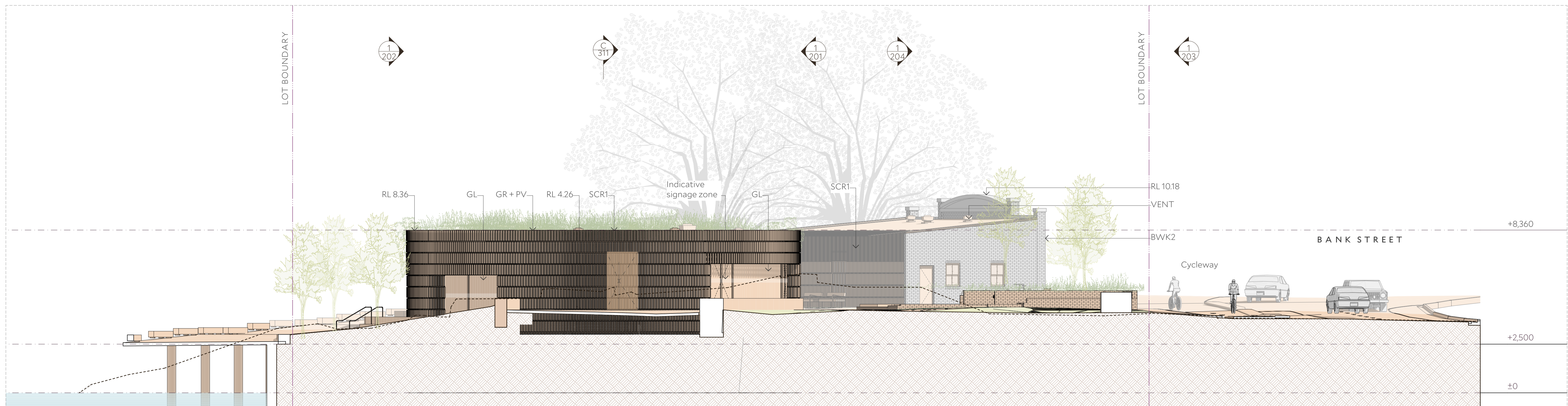
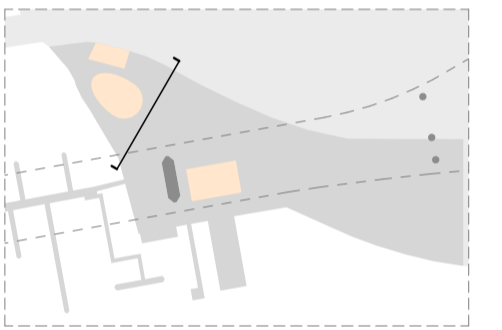

2 East Facade
1:100

Architect
COLLINS AND TURNER
Suite 6, Level 3, 11-17 Buckingham St
Surry Hills NSW 2010
+612 9356 3217
info@collinsandturner.com
collinsandturner.com
Registered Architect in NSW
Penelope Collins ARB 7342

Notes
01 Do not scale; dimensions govern
02 All dimensions are in millimeters
03 All dimensions to be verified on site
04 Collins and Turner is to be notified of any discrepancies

No	Date	By	Note
01	1/9/2023	TD	For consultant information
02	21/9/2023	TD	Draft SSDA
03	13/10/2023	TD	For SSDA
06	27/11/2023	AL	For SSDA

Client
Infrastructure NSW
Level 27, 201 Kent St
Sydney NSW 2000

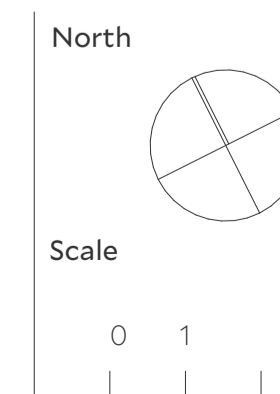

Project
Bank Street Park
(Tjerruing Park)
1A-19 Bank Street
Pyrmont, NSW 2009
Copyright Collins and Turner 2023

Drawing title	Elevations - 1-3 Bank Street	
Scale	1:100 @ A1	
Date	1/9/23	
Drawn by	TD	
Drawing Number+ Revision	346_SSDA_201	06