

DEMOLITION SHOWN IN RED

**PHASE 1 - SITE ESTAB, DEMOLITION & CIVIL (Month 1 - Month 11)**

- Demolition existing structure & trees in blue
- Establish initial site accommodation
- Sewer diversion works
- Install basement retention system
- Excavate site
- Pile
- Erect cranes
- Hydrostatic slab

Project Title  
**ELIZABETH STREET, REDFERN**  
 600-660 Elizabeth St, Redfern NSW 2016

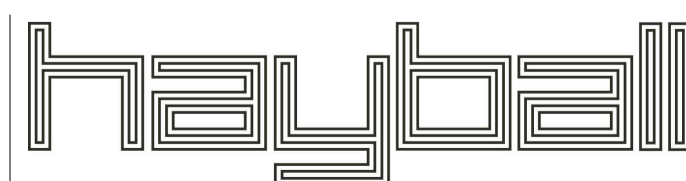

**Melbourne** Level 1  
 259 Finders Lane  
 Melbourne VIC 3000  
 T +61 3 9699 3644

**Sydney** Ground Floor  
 11-17 Buckingham Street  
 Surry Hills NSW 2010  
 T +61 2 9660 9329

**Brisbane** Level 5  
 253 Queen Street  
 Brisbane QLD 4000  
 T +61 7 3211 9621

**Canberra** Level 1  
 33 Alana Street  
 Canberra ACT 2601  
 T +61 2 9660 9329

ABN: 8400594261 NSW Nominated Architects: David Toroff 8028

Drawn By JC  
 Checked By DT  
 Date Printed 12/04/2024 9:51:27 AM  
 Scale 1 : 500@ A1

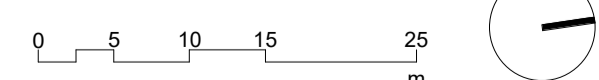

| Rev  | Date       | Description     |
|------|------------|-----------------|
| DRP3 | 08/03/2024 | Issued for DRP3 |
| DRP4 | 09/04/2024 | Issued for DRP4 |

Drawing Title  
**SITE PLAN - EXISTING & DEMOLITION**

Status  
 SKETCH DESIGN

Project No  
**2610**  
 Drawing No  
**A01.01**

Revision  
**DRP4**



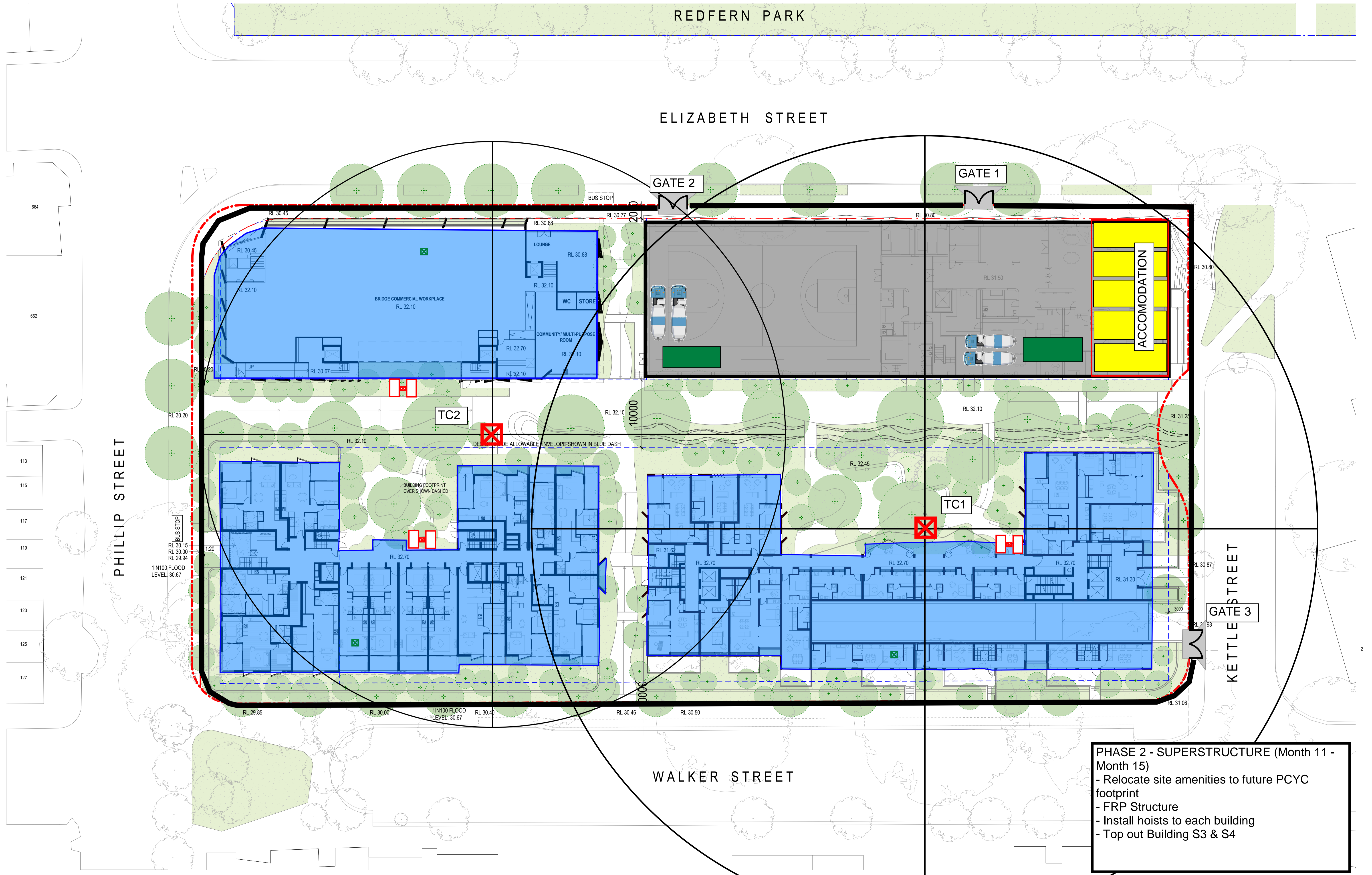

**PHASE 2 - SUPERSTRUCTURE (Month 11 - Month 15)**  
 - Relocate site amenities to future PCYC footprint  
 - FRP Structure  
 - Install hoists to each building  
 - Top out Building S3 & S4

Project Title  
**ELIZABETH STREET, REDFERN**  
 600-660 Elizabeth St, Redfern NSW 2016

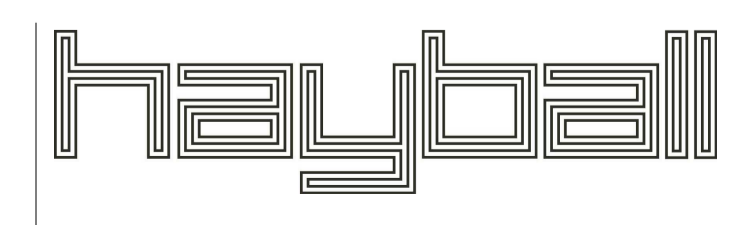

Melbourne Level 1  
 255 Finders Lane  
 Melbourne VIC 3000  
 T +61 3 9899 3644  
 ABN: 8400594261 NSW Nominated Architects: David Toroff 8028

Sydney Level 5  
 11-17 Buckingham Street  
 Surry Hills NSW 2010  
 T +61 2 9660 9329

Brisbane Level 5  
 253 Queen Street  
 Brisbane QLD 4000  
 T +61 7 3211 9621

Canberra Level 1  
 33 Alinga Street  
 Canberra ACT 2601  
 T +61 2 9660 9329

Drawn By JC  
 Checked By DT  
 Date Printed 12/04/2024 9:51:45 AM  
 Scale 1 : 250 @ A1

| Rev  | Date       | Description           |
|------|------------|-----------------------|
| 1    | 27/02/2024 | Issue for review      |
| 2    | 05/03/2024 | Issue for information |
| DRP1 | 14/11/2023 | Issued for DRP1       |
| DRP3 | 08/03/2024 | Issued for DRP3       |
| DRP4 | 09/04/2024 | Issued for DRP4       |

Drawing Title  
**MASTERPLAN NEW**

Status  
**SKETCH DESIGN**

Project No  
**2610**

Drawing No  
**A02.01**

Revision  
**DRP4**

Verify all figured dimensions on site before undertaking any works. Do not scale dimensions off drawings.



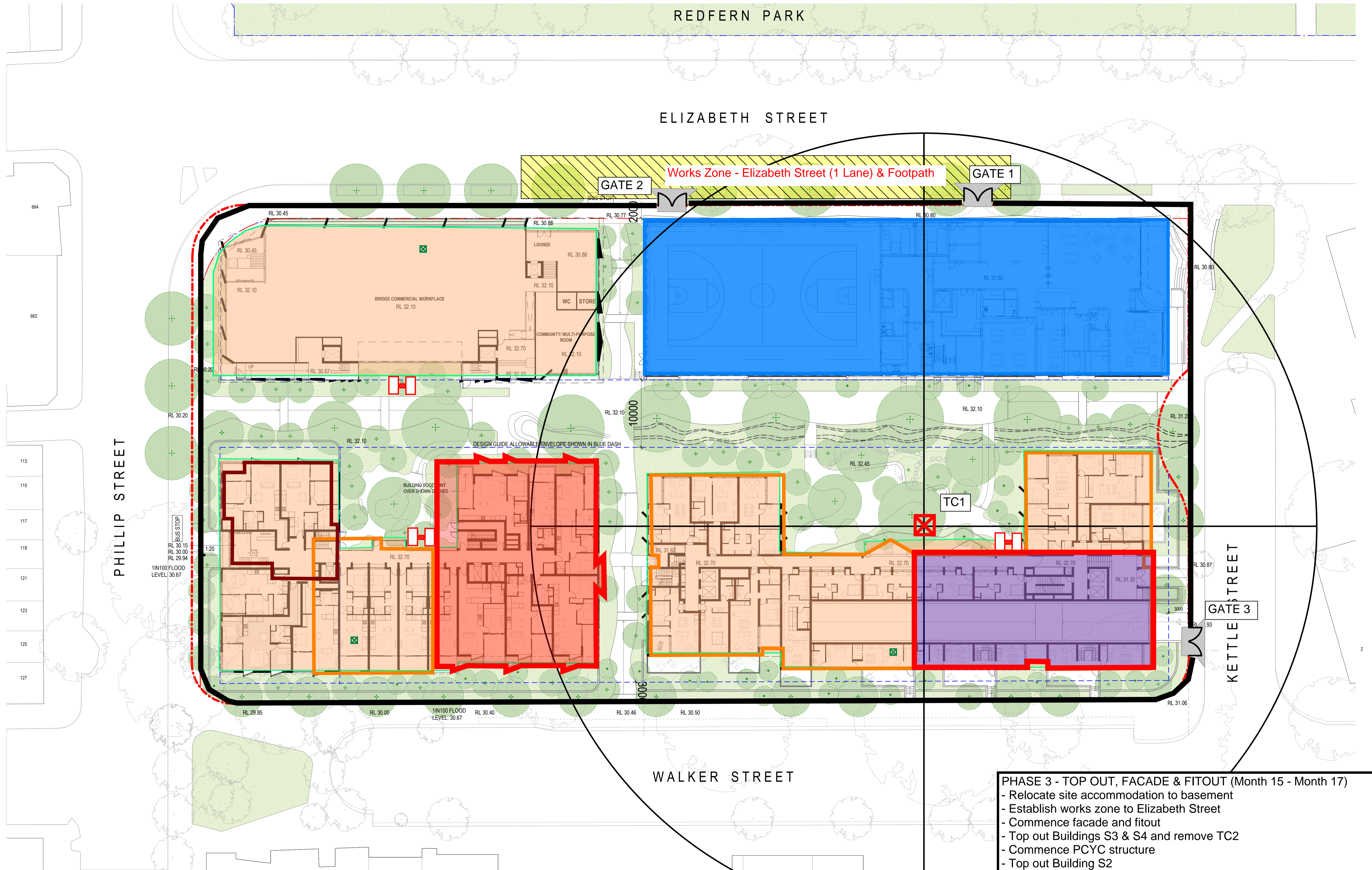

**PHASE 3 - TOP OUT, FACADE & FITOUT (Month 15 - Month 17)**

- Relocate site accommodation to basement
- Establish works zone to Elizabeth Street
- Commence facade and fitout
- Top out Buildings S3 & S4 and remove TC2
- Commence PCYC structure
- Top out Building S2

Project Title  
**ELIZABETH STREET, REDFERN**  
 600-660 Elizabeth St, Redfern NSW 2016

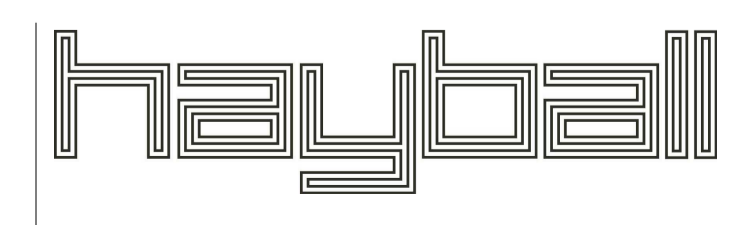

**Melbourne** Level 1  
 255 Finders Lane  
 Melbourne VIC 3000  
 T +61 3 9899 3644

**Sydney** Level 5  
 11-17 Buckingham Street  
 Surry Hills NSW 2010  
 T +61 2 9660 9329

**Brisbane** Level 5  
 253 Queen Street  
 Brisbane QLD 4000  
 T +61 7 3211 9821

**Canberra** Level 1  
 33 Alinga Street  
 Canberra ACT 2601  
 T +61 2 9660 9329

ABN: 64006394261 NSW Nominated Architects: David Toroff 8028

Drawn By: JC  
 Checked By: DT  
 Date Printed: 12/04/2024 9:51:45 AM  
 Scale: 1: 250 @ A1

| Rev  | Date       | Description             |
|------|------------|-------------------------|
| 1    | 27/02/2024 | Issue for review        |
| 2    | 05/03/2024 | Issued for consultation |
| DRP1 | 14/11/2023 | Issued for DRP1         |
| DRP3 | 08/03/2024 | Issued for DRP3         |
| DRP4 | 09/04/2024 | Issued for DRP4         |

Drawing Title  
**MASTERPLAN NEW**

SKETCH DESIGN

**2610**  
 Drawing No  
**A02.01**

**DRP4**

Verify all figured dimensions on site before undertaking any works. Do not scale dimensions off drawings.



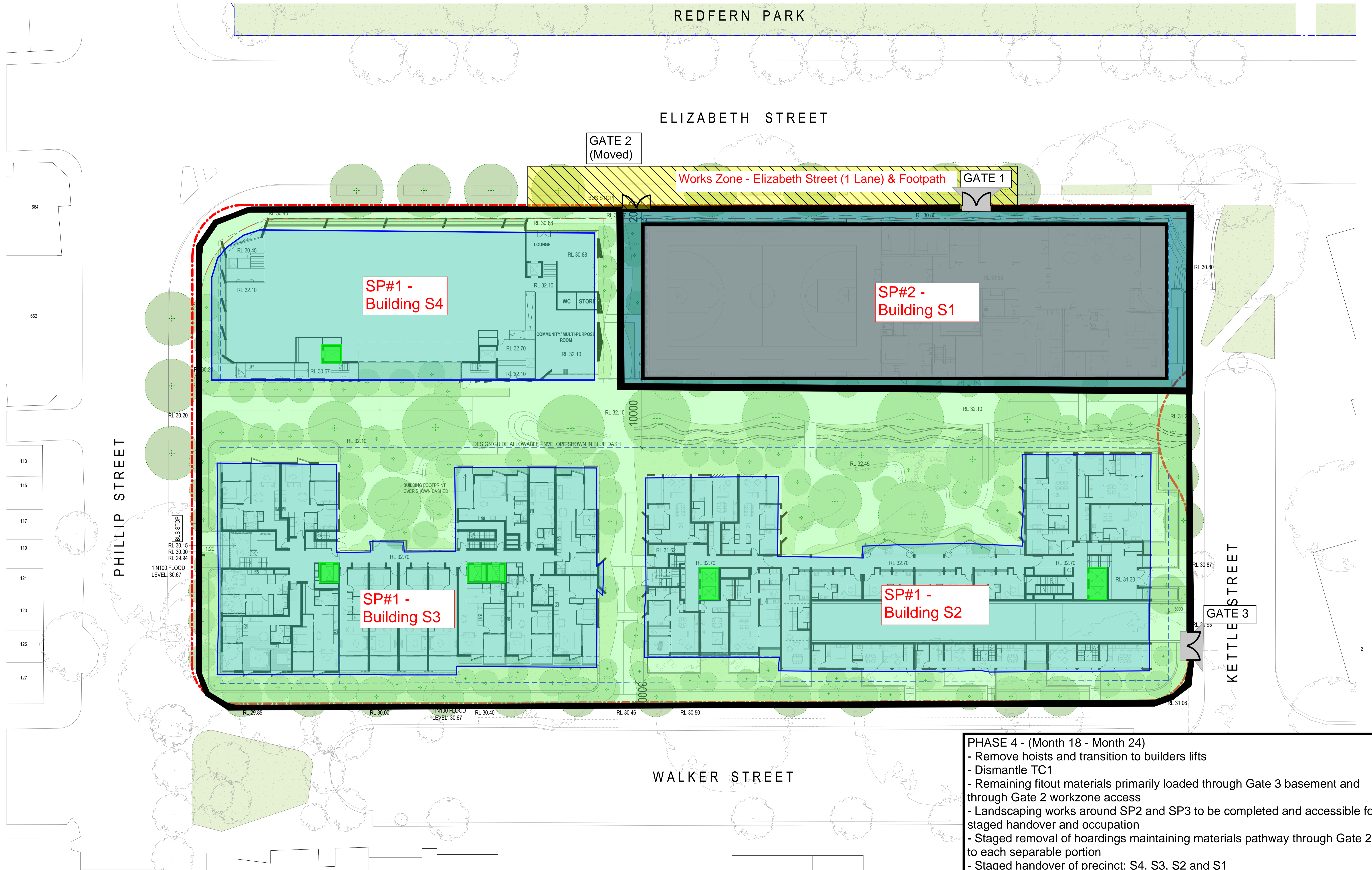

**PHASE 4 - (Month 18 - Month 24)**

- Remove hoists and transition to builders lifts
- Dismantle TC1
- Remaining fitout materials primarily loaded through Gate 3 basement and through Gate 2 workzone access
- Landscaping works around SP2 and SP3 to be completed and accessible for staged handover and occupation
- Staged removal of hoardings maintaining materials pathway through Gate 2 to each separable portion
- Staged handover of precinct: S4, S3, S2 and S1
- Public Domain upgrades

Project Title  
**ELIZABETH STREET, REDFERN**  
 600-660 Elizabeth St, Redfern NSW 2016

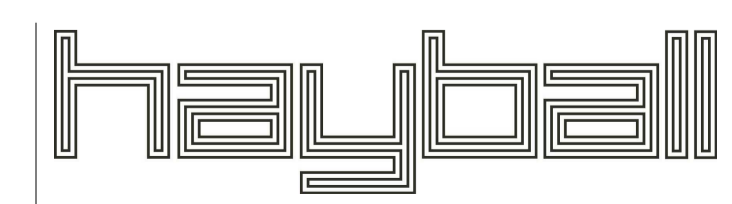

Melbourne Sydney Brisbane Canberra  
 Level 1, 255 Finders Lane, Melbourne VIC 3000  
 Level 5, 11-17 Buckingham Street, Sydney NSW 2010  
 Level 5, 253 Queen Street, Brisbane QLD 4000  
 Level 1, 33 Alinga Street, Canberra ACT 2601  
 T +61 3 9899 3644 T +61 2 9660 9329 T +61 7 3211 9821 T +61 2 9660 9329  
 ABN: 64006394261 NSW Nominated Architects: David Toroff 8028

Drawn By: JC  
 Checked By: DT  
 Date Printed: 12/04/2024 9:51:45 AM  
 Scale: 1: 250@ A1

| Rev  | Date       | Description            |
|------|------------|------------------------|
| 1    | 27/02/2024 | Issue for review       |
| 2    | 05/03/2024 | Issued for Information |
| DRP1 | 14/11/2023 | Issued for DRP1        |
| DRP3 | 08/03/2024 | Issued for DRP3        |
| DRP4 | 09/04/2024 | Issued for DRP4        |

Drawing Title  
**MASTERPLAN NEW**

**SKETCH DESIGN**

**2610**  
 Drawing No  
**A02.01**

**DRP4**

Verify all figured dimensions on site before undertaking any works. Do not scale dimensions off drawings.