

WALLGROVE BUSINESS HUB, Cecil Park, NSW 2178

Landscape Documentation for State Significant Development Application



IMAGE TAKEN FROM NEARMAP 2023

Drawing Register

Dwg No.	Drawing Name
SSD-00	Landscape Cover Sheet
SSD-01	Landscape Concept Master Plan (Ultimate)
SSD-02	Landscape & Canopy Cover Calculation
SSD-03	Stage 1 Landscape Detail Plan - Sheet 1
SSD-04	Stage 1 Landscape Detail Plan - Sheet 2
SSD-05	Stage 1 Landscape Detail Plan - Sheet 3
SSD-06	Landscape Sections
SSD-07	Specification, Details & Planting Matrices
SSD-08	Stage 1 Planting Schedule & Imagery

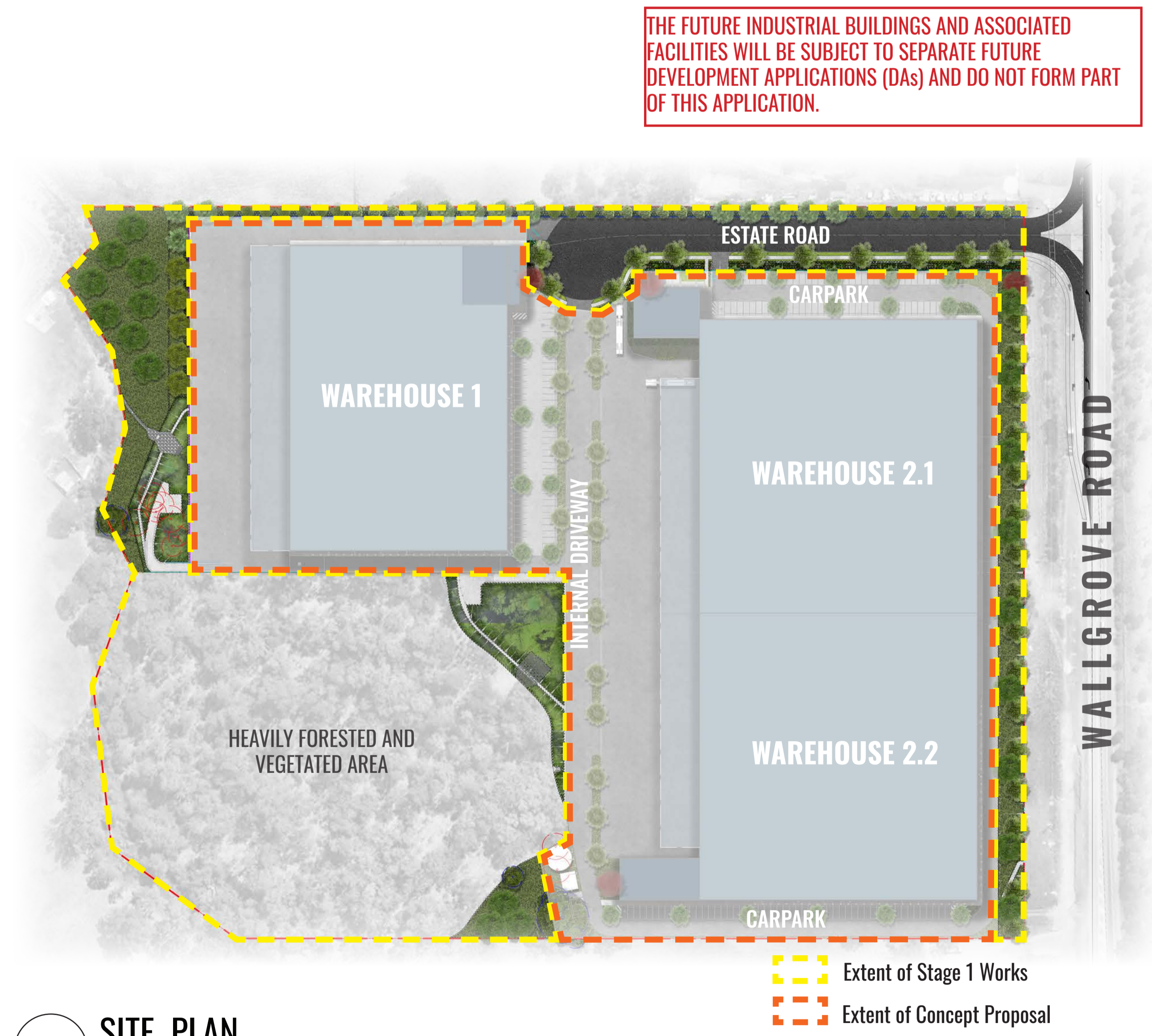

THE FUTURE INDUSTRIAL BUILDINGS AND ASSOCIATED FACILITIES WILL BE SUBJECT TO SEPARATE FUTURE DEVELOPMENT APPLICATIONS (DAs) AND DO NOT FORM PART OF THIS APPLICATION.

SITE PLAN

Extent of Stage 1 Works
 Extent of Concept Proposal

Drawing Title:
Landscape Cover Sheet
 DWG No:

SSD-00

GEOSCAPES
 LANDSCAPE ARCHITECTS
 Suite 303, 8 Help Street, Chatswood NSW 2067 Ph. (02) 9411 1485
 www.geoscapes.com.au
 ABN 84 620 205 781 ACN 620 205 781

Architect:
nettletontribe
 architecture

Client:

 Western Sydney Parklands

Scale: NTS Date: 14.06.24 Job Number: 230926 North:
 Project: Wallgrove Business Hub
 97-151 Wallgrove Rd, Cecil Park, NSW 2178

Revision				FOR SSD	
Rev	Date	Description	Drawn	Checked	
F	21.03.24	For SSD	PT	BG	
G	07.05.24	For SSD	PT	BG	
H	14.05.24	For SSD	PT	BG	
I	14.06.24	For SSD	PT	BG	

NOT FOR CONSTRUCTION



THE FUTURE INDUSTRIAL BUILDINGS AND ASSOCIATED FACILITIES WILL BE SUBJECT TO SEPARATE FUTURE DEVELOPMENT APPLICATIONS (DAs) AND DO NOT FORM PART OF THIS APPLICATION.

LEGEND

- Red dashed line: SITE BOUNDARY
- Blue dashed line: DEVELOPABLE AREA BOUNDARY
- Circle with dot: EXISTING TREES TO BE RETAINED
- Circle with dot and outer ring: PROPOSED TREE AND 3M CANOPY OFFSET
- Green shaded area: STAGE 1 CANOPY COVERAGE
- Yellow shaded area: CONCEPT PROPOSAL CANOPY COVERAGE
- Yellow dashed line: Extent of Stage 1 Works
- Red dashed line: Extent of Concept Proposal

WALLGROVE ROAD

PROPOSED CANOPY COVER

- Developable Area = 77,688m²
- Total number of proposed trees (Stage 1 + Concept Proposal) = 140
- Number of proposed trees in Stage 1 = 95
- Canopy coverage in Stage 1 = 4314m²
- Number of proposed trees in Concept Proposal = 45
- Canopy coverage in Concept Proposal = 2078m²
- CANOPY COVER IN DEVELOPABLE AREA (PROPOSED TREES + EXISTING TREES TO BE RETAINED) = 6,392m² = 8.23%

CANOPY COVER CALCULATION FOR BUSHFIRE (Ultimate Stage 1 + Concept Proposal)

- Developable Area = 77,688m²
- Building Area = 35,850m²
- IPA Area (Developable Area - Building Area) = 41,838m²
- CANOPY COVER IN IPA AREA (PROPOSED TREES + EXISTING TREES TO BE RETAINED) = 6,392m² = 15%

LANDSCAPE AREA CALCULATION (Ultimate Stage 1 + Concept Proposal)

- Required Landscape Area Within Developable Area = 10%
- TOTAL LANDSCAPE AREA WITHIN DEVELOPABLE AREA = 13,366m² = 17.2%

Drawing Title:
Landscape & Canopy Cover Calculation
DWG No:
SSD-02

GEOSCAPES
LANDSCAPE ARCHITECTS
Suite 303, 8 Help Street, Chatswood NSW 2067 Ph. (02) 9411 1485
www.geoscapes.com.au
ABN 84 620 205 781 ACN 620 205 781

Architect:
nettletontribe
architecture

Client:

Western Sydney Parklands

Scale: 1:650 @ A1
1:1300 @ A3
Date: 14.06.24
Job Number: 230926
Project: Wallgrove Business Hub
97-151 Wallgrove Rd, Cecil Park, NSW 2178

Revision				FOR SSD	
Rev	Date	Description	Drawn	Checked	
F	21.03.24	For SSD	PT	BG	BG
G	07.05.24	For SSD	PT	BG	BG
H	14.05.24	For SSD	PT	BG	BG
I	14.06.24	For SSD	PT	BG	BG

NOT FOR CONSTRUCTION

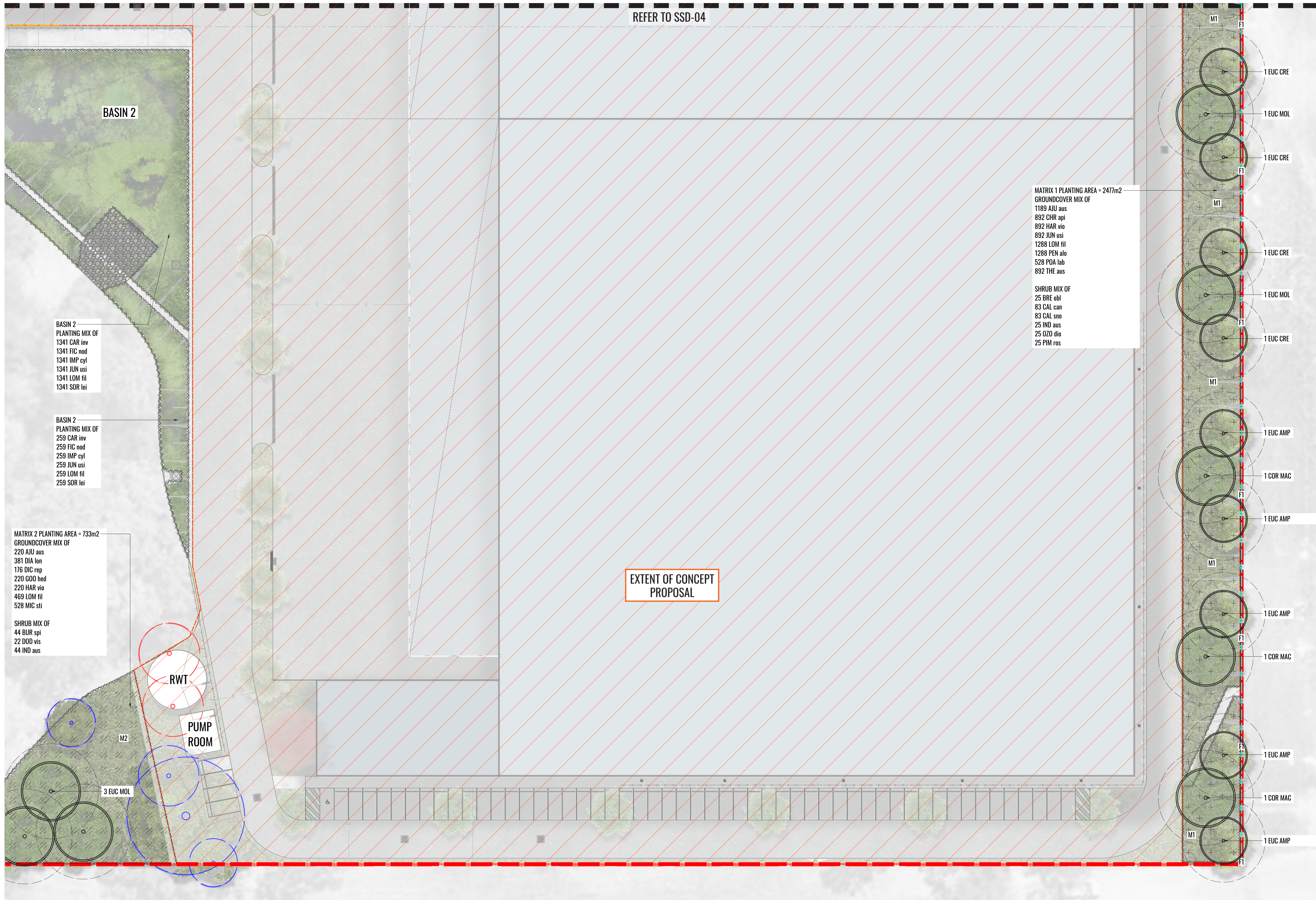

- LEGEND**
- SITE BOUNDARY
 - EXISTING TREES TO BE RETAINED
 - EXISTING TREES TO BE REMOVED
 - PROPOSED TREES
 - MASS HEDGE/SHRUB PLANTING
 - PROPOSED GROUNDCOVER PLANTING
 - ROAD
 - HARDSTAND
 - MATRIX PLANTING 1. REFER TO SSD-07 FOR DETAILS
 - MATRIX PLANTING 2. REFER TO SSD-07 FOR DETAILS
 - TURF
 - ACOUSTIC WALL 1 - 4.5m HIGH ACOUSTIC WALL TO ENGINEERS DETAILS
 - ACOUSTIC WALL 2 - 5m HIGH ACOUSTIC WALL TO ENGINEERS DETAILS
 - TABLE SETTINGS
 - 2.1m HIGH BLACK POWDERCOATED PALLISADE FENCE
 - 1.8m HIGH BLACK CHAINLINK FENCE WITH 3 ROWS OF BARBED WIRE (TOTAL HEIGHT 2.1m)
 - PROPOSED STORMWATER EASEMENT
 - EXTENT OF CONCEPT PROPOSAL

THE FUTURE INDUSTRIAL BUILDINGS AND ASSOCIATED FACILITIES WILL BE SUBJECT TO SEPARATE FUTURE DEVELOPMENT APPLICATIONS (DAs) AND DO NOT FORM PART OF THIS APPLICATION.

Drawing Title:
Stage 1 Landscape Detail Plan - Sheet 1
 DWG No:
SSD-03

GEOSCAPES
 LANDSCAPE ARCHITECTS
 Suite 303, 8 Help Street, Chatswood NSW 2067 Ph. (02) 9411 1485
 www.geoscapes.com.au
 ABN 84 620 205 781 ACN 620 205 781

Architect:
nettletontribe
 architecture

Client:

 Western Sydney Parklands

Scale: 1:300 @ A1
 1:600 @ A3

Date: 14.06.24

Job Number: 230926

North:

Project: **Wallgrove Business Hub**
 97-151 Wallgrove Rd, Cecil Park, NSW 2178

Revision				FOR SSD	
Rev	Date	Description	Drawn	Checked	
G	21.03.24	For SSD	PT	BG	
F	07.05.24	For SSD	PT	BG	
H	14.05.24	For SSD	PT	BG	
I	14.06.24	For SSD	PT	BG	

NOT FOR CONSTRUCTION

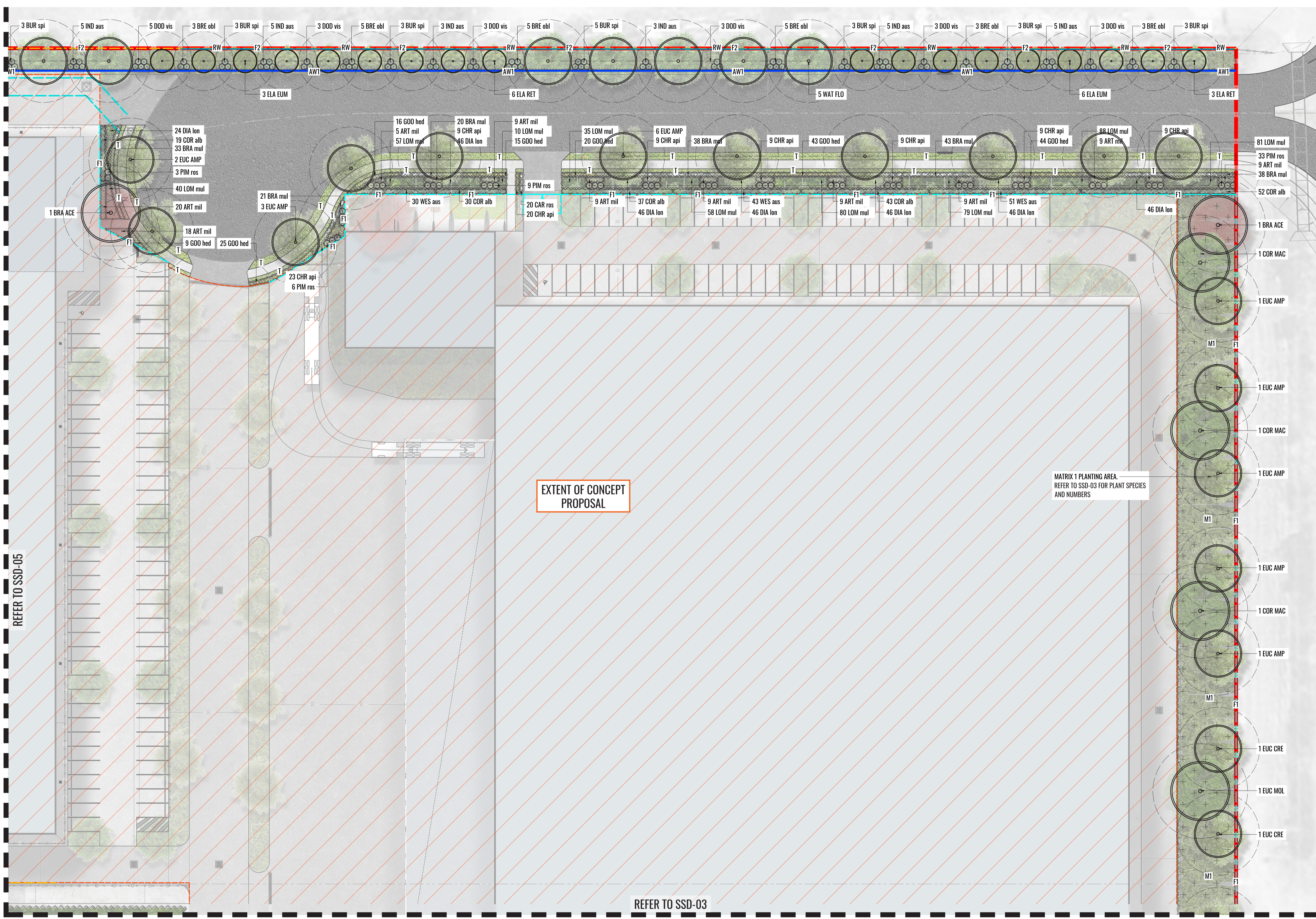

- LEGEND**
- SITE BOUNDARY
 - EXISTING TREES TO BE RETAINED
 - EXISTING TREES TO BE REMOVED
 - PROPOSED TREES
 - MASS HEDGE/SHRUB PLANTING
 - PROPOSED GROUNDCOVER PLANTING
 - ROAD
 - HARDSTAND
 - MATRIX PLANTING 1. REFER TO SSD-07 FOR DETAILS
 - MATRIX PLANTING 2. REFER TO SSD-07 FOR DETAILS
 - TURF
 - ACOUSTIC WALL 1 - 4.5m HIGH ACOUSTIC WALL TO ENGINEERS DETAILS
 - ACOUSTIC WALL 2 - 5m HIGH ACOUSTIC WALL TO ENGINEERS DETAILS
 - TABLE SETTINGS
 - 2.1m HIGH BLACK POWDERCOATED PALISADE FENCE
 - 1.8m HIGH BLACK CHAINLINK FENCE WITH 3 ROWS OF BARBED WIRE (TOTAL HEIGHT 2.1m)
 - PROPOSED STORMWATER EASEMENT
 - EXTENT OF CONCEPT PROPOSAL

EXTENT OF CONCEPT PROPOSAL

MATRIX 1 PLANTING AREA. REFER TO SSD-03 FOR PLANT SPECIES AND NUMBERS

REFER TO SSD-05

REFER TO SSD-03

THE FUTURE INDUSTRIAL BUILDINGS AND ASSOCIATED FACILITIES WILL BE SUBJECT TO SEPARATE FUTURE DEVELOPMENT APPLICATIONS (DAs) AND DO NOT FORM PART OF THIS APPLICATION.

Drawing Title:
Stage 1 Landscape Detail Plan - Sheet 2
DWG No:
SSD-04

GEOSCAPES
LANDSCAPE ARCHITECTS
Suite 303, 8 Help Street, Chatswood NSW 2067 Ph. (02) 9411 1485
www.geoscapes.com.au
ABN 84 620 205 781 ACN 620 205 781

Architect:
nettletontribe
architecture

Client:

Western Sydney Parklands

Scale: 1:300 @ A1, 1:600 @ A3
Date: 14.06.24
Job Number: 230926
North:
Project: **Wallgrove Business Hub**
97-151 Wallgrove Rd, Cecil Park, NSW 2178

Revision				FOR SSD	
Rev	Date	Description	Drawn	Checked	
F	21.03.24	For SSD	PT	BG	
G	07.05.24	For SSD	PT	BG	
H	14.05.24	For SSD	PT	BG	
I	14.06.24	For SSD	PT	BG	

NOT FOR CONSTRUCTION

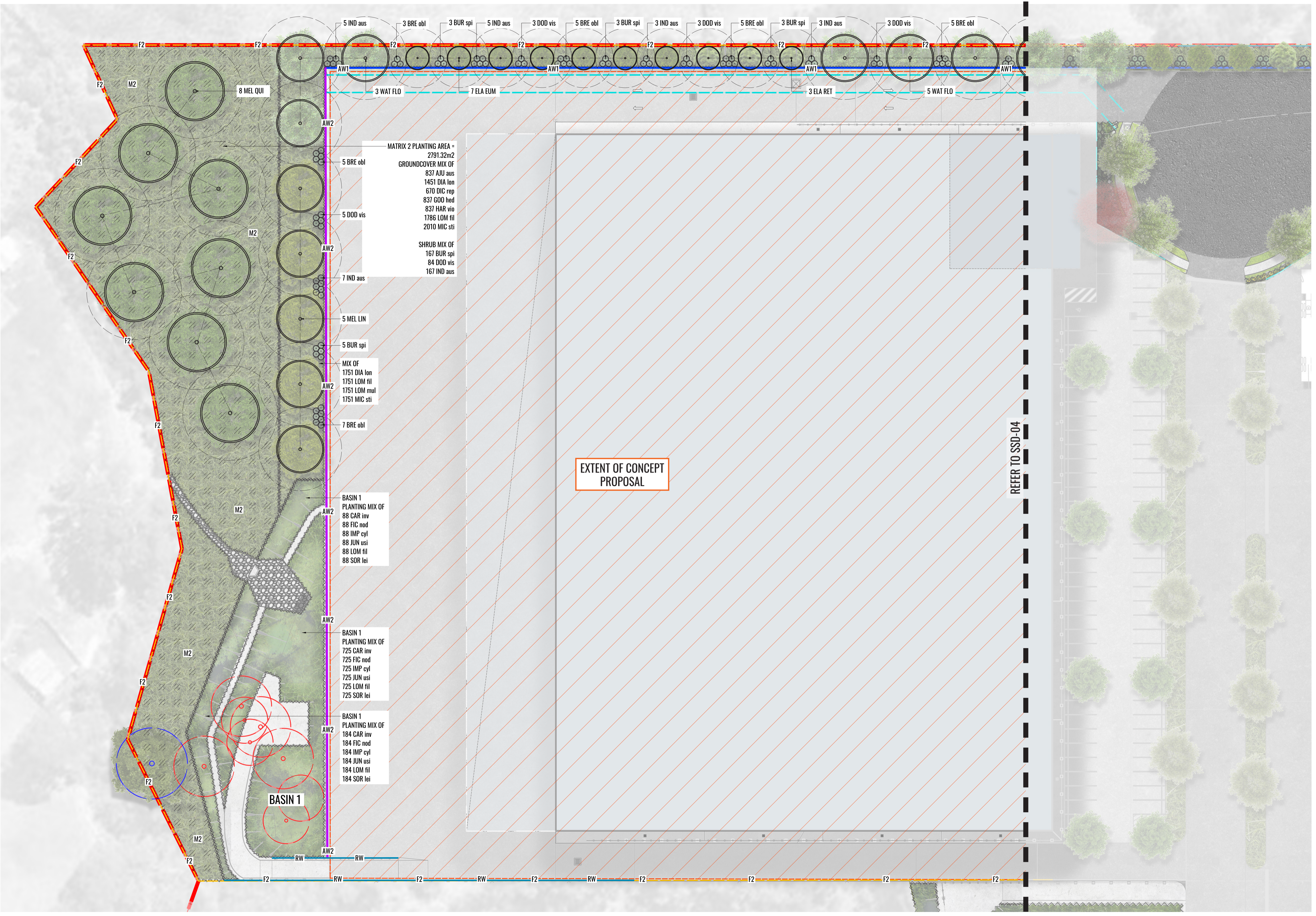

- LEGEND**
- SITE BOUNDARY
 - EXISTING TREES TO BE RETAINED
 - EXISTING TREES TO BE REMOVED
 - PROPOSED TREES
 - MASS HEDGE/SHRUB PLANTING
 - PROPOSED GROUNDCOVER PLANTING
 - ROAD
 - HARDSTAND
 - MATRIX PLANTING 1. REFER TO SSD-07 FOR DETAILS
 - MATRIX PLANTING 2. REFER TO SSD-07 FOR DETAILS
 - TURF
 - ACOUSTIC WALL 1 - 4.5m HIGH ACOUSTIC WALL TO ENGINEERS DETAILS
 - ACOUSTIC WALL 2 - 5m HIGH ACOUSTIC WALL TO ENGINEERS DETAILS
 - TABLE SETTINGS
 - 2.1m HIGH BLACK POWDERCOATED PALLISADE FENCE
 - 1.8m HIGH BLACK CHAINLINK FENCE WITH 3 ROWS OF BARBED WIRE (TOTAL HEIGHT 2.1m)
 - PROPOSED STORMWATER EASEMENT
 - EXTENT OF CONCEPT PROPOSAL

MATRIX 2 PLANTING AREA = 2791.32m²
 GROUNDCOVER MIX OF
 837 AJU aus
 1451 DIA Ion
 670 DIC rep
 837 GDO hed
 837 HAR vio
 1786 LOM fil
 2010 MIC sti
 SHRUB MIX OF
 167 BUR spi
 84 DOD vis
 167 IND aus

MIX OF
 1751 DIA Ion
 1751 LOM fil
 1751 LOM mul
 1751 MIC sti

BASIN 1 PLANTING MIX OF
 88 CAR inv
 88 FIC nod
 88 IMP cyl
 88 JUN usi
 88 LOM fil
 88 SOR lei

BASIN 1 PLANTING MIX OF
 725 CAR inv
 725 FIC nod
 725 IMP cyl
 725 JUN usi
 725 LOM fil
 725 SOR lei

BASIN 1 PLANTING MIX OF
 184 CAR inv
 184 FIC nod
 184 IMP cyl
 184 JUN usi
 184 LOM fil
 184 SOR lei

EXTENT OF CONCEPT PROPOSAL

REFER TO SSD-04

THE FUTURE INDUSTRIAL BUILDINGS AND ASSOCIATED FACILITIES WILL BE SUBJECT TO SEPARATE FUTURE DEVELOPMENT APPLICATIONS (DAs) AND DO NOT FORM PART OF THIS APPLICATION.

Drawing Title:
Stage 1 Landscape Detail Plan - Sheet 3
 DWG No:
SSD-05

GEOSCAPES
 LANDSCAPE ARCHITECTS
 Suite 303, 8 Help Street, Chatswood NSW 2067 Ph. (02) 9411 1485
 www.geoscapes.com.au
 ABN 84 620 205 781 ACN 620 205 781

Architect:
nettletontribe
 architecture

Client:

 Western Sydney Parklands

Scale: 1:300 @ A1, 1:600 @ A3
 Date: 14.06.24
 Job Number: 230926
 Project: **Wallgrove Business Hub**
 97-151 Wallgrove Rd, Cecil Park, NSW 2178

Revision			FOR SSD	
Rev	Date	Description	Drawn	Checked
F	21.03.24	For SSD	PT	BG
G	07.05.24	For SSD	PT	BG
H	14.05.24	For SSD	PT	BG
I	14.06.24	For SSD	PT	BG

NOT FOR CONSTRUCTION

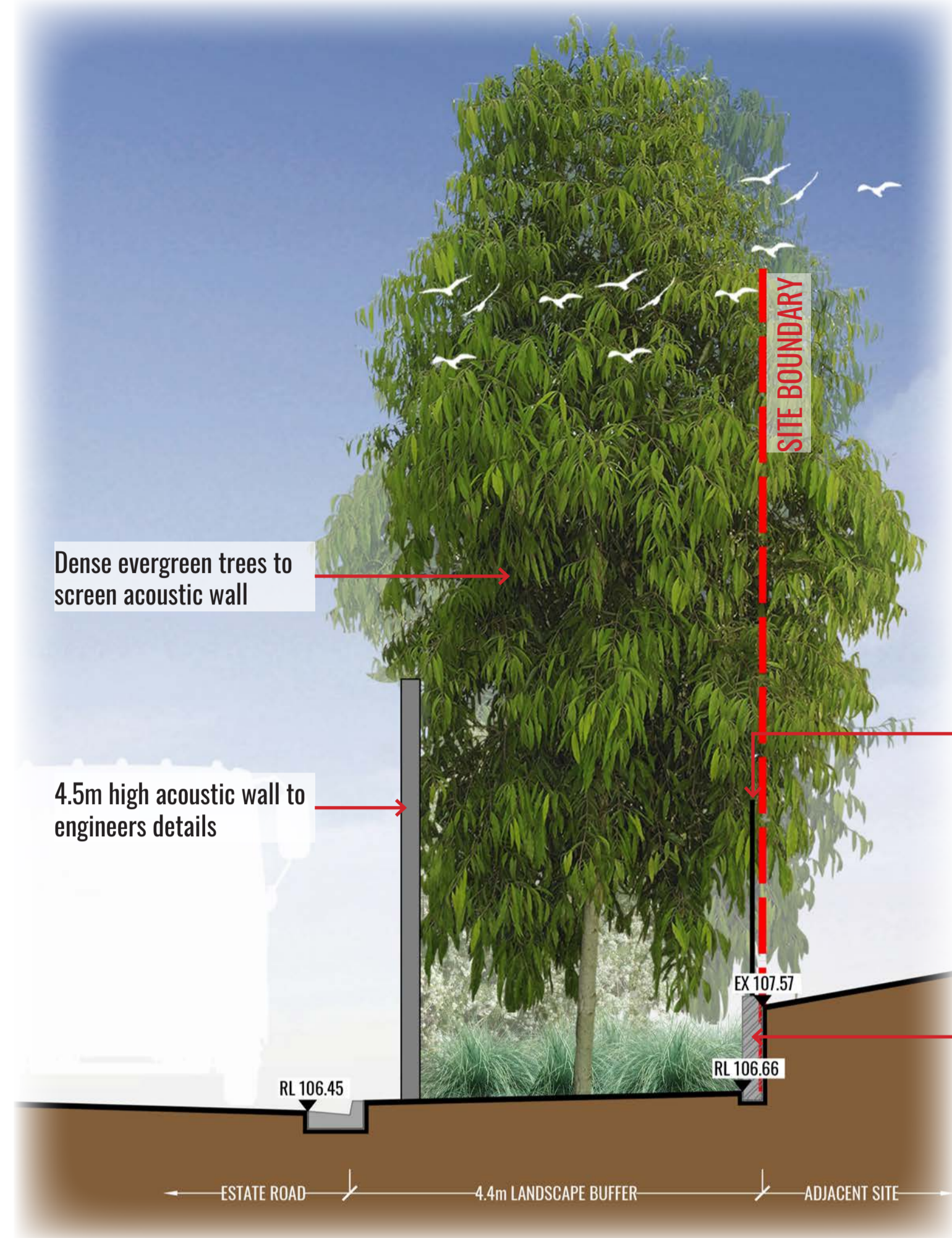

1 SECTION AA - STAGE 1 NORTHERN RETAINING WALL SCALE 1:50

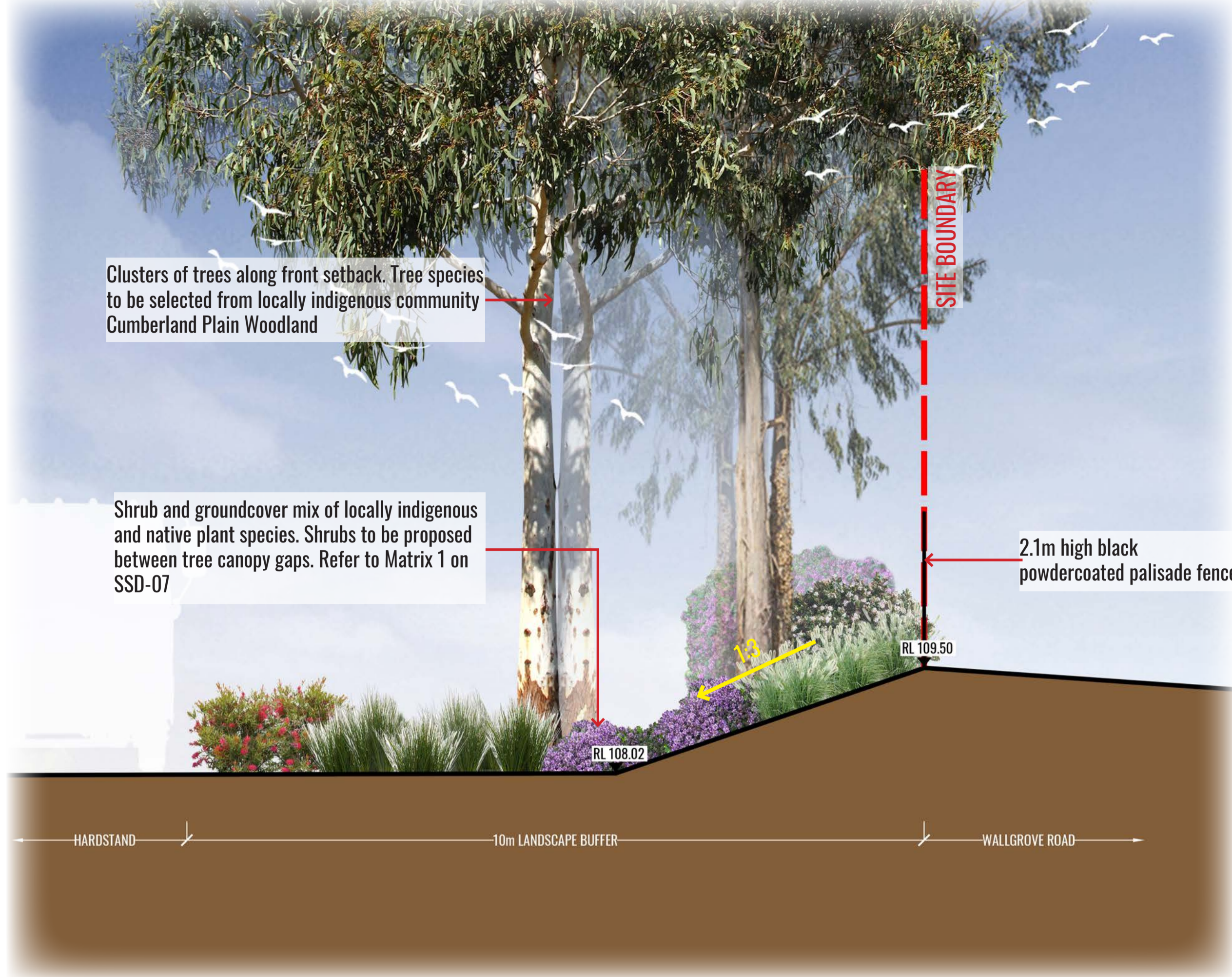

2 SECTION BB - STAGE 1 STREET FRONTAGE SCALE 1:50

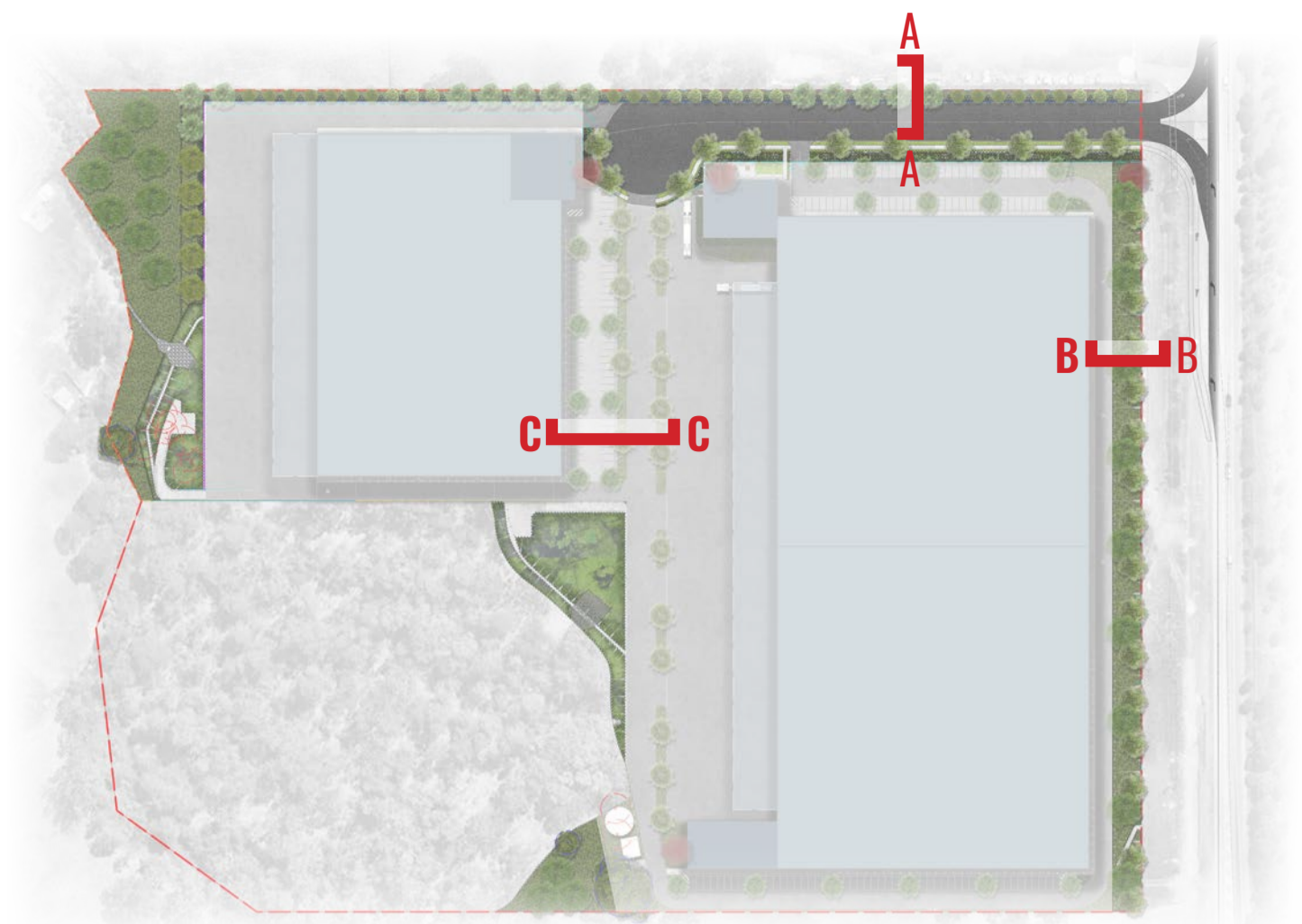

KEY PLAN

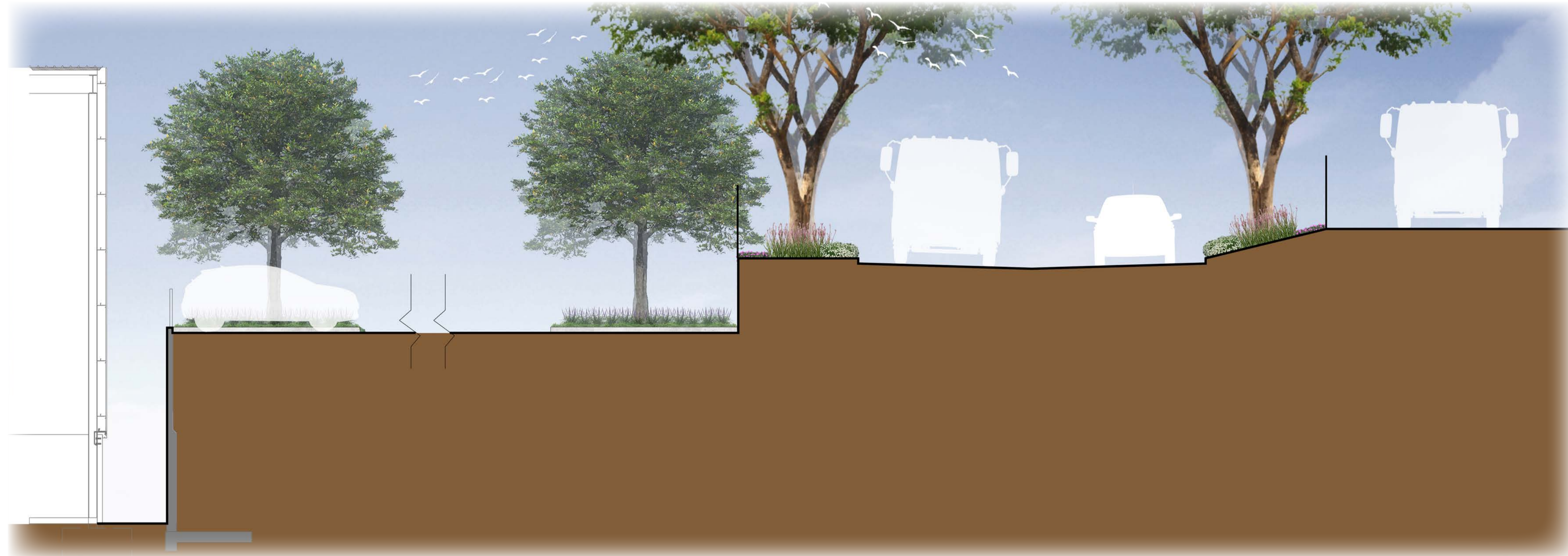

3 SECTION CC - CONCEPT PROPOSAL SCALE 1:75

THE FUTURE INDUSTRIAL BUILDINGS AND ASSOCIATED FACILITIES WILL BE SUBJECT TO SEPARATE FUTURE DEVELOPMENT APPLICATIONS (DAs) AND DO NOT FORM PART OF THIS APPLICATION.

Drawing Title:
Landscape Sections
DWG No:
SSD-06

GEOSCAPES
LANDSCAPE ARCHITECTS
Suite 303, 8 Help Street, Chatswood NSW 2067 Ph. (02) 9411 1485
www.geoscapes.com.au
ABN 84 620 205 781 ACN 620 205 781

Architect:
nettletontribe
architecture

Client:

Western Sydney Parklands

Scale: AS SHOWN @ A1 Date: 14.06.24 Job Number: 230926 North: Project: Wallgrove Business Hub 97-151 Wallgrove Rd, Cecil Park, NSW 2178

Revision			FOR SSD	
Rev	Date	Description	Drawn	Checked
F	21.03.24	For SSD	PT	BG
G	07.05.24	For SSD	PT	BG
H	14.05.24	For SSD	PT	BG
I	14.06.24	For SSD	PT	BG

NOT FOR CONSTRUCTION

MAINTENANCE PLAN

Maintenance shall mean the care and maintenance of the landscape works by accepted horticultural practice as rectifying any defects that become apparent in the landscape works under normal use. The landscape contractor shall attend the site on a **weekly basis** to maintain the landscape works commencing from practical completion.

Rubbish Removal

The Landscape Contractor shall undertake rubbish removal from the site on a **weekly basis** to ensure the site remains in tidy condition.

Weed Eradication

Weed growth that may occur in grassed, planted or mulched areas is to be removed using environmentally acceptable methods i.e. non-residual glyphosate herbicide (e.g. 'Roundup', applied in accordance with the manufacturer's direction.

Tree Replacement

Trees shall show signs of healthy vigorous growth and be free from disease and not exhibit signs of stress prior to handover to the client. Any trees or plant that die or fail to thrive, or are damaged or stolen will be replaced. Replacement material shall have the initial maintenance period extended in accordance with the landscape contract conditions. Trees and plant materials shall be equal to the minimum requirements of species specified and approved material delivered to site. Should the condition decline from the approved sample the Superintendent reserves the right to reject the tree / plants. Frequency: as required.

Stakes

Adjust and/or replace stakes and ties where required. Remove staking and guying when instructed by the Superintendent

Pruning

Selective pruning may be required during the establishment period to promote a balanced canopy structure. These activities shall be carried out to the best horticultural and industry practice. All pruned material is to be removed from site.

Mulched Surfaces

All planter beds and garden areas shall have a minimum depth of 75mm organic mulch. All mulch is to be free of deleterious matter such as soil, weeds, sticks and should conform to AS 4454.

Mulched surfaces are to be kept clean and tidy and free of any deleterious material and foreign matter. Reinstate depths to a uniform level of 75mm with mulch as specified, mulch to be free of any wood material impregnated with CCA or similar toxic treatment. Top up mulch levels prior to handover to client & estate management.

Watering

Implement an appropriate hand watering regime in areas not irrigated in association with current watering programme to maintain plant health and vigour. The program shall reflect seasonal conditions and plant species.

Frequency: Weekly or as required.

Soil In Natural Ground

Non-Australian native garden beds to have soil installed consisting of 50% existing site topsoil and 50% new topsoil equal or equivalent to 'Organic Garden Mix' as supplied by Australian Native Landscapes. Australian native garden beds to have soil installed consisting of 50% existing site topsoil and 50% new topsoil equal or equivalent to 'Native Low 'P' Mix' as supplied by Australian Native Landscapes. Soil to conform to AS4419 refer to typical detail.

Pest and Disease Control

The Landscape Contractor shall spray for pests and disease infestations when the pest and fungal attack has been positively identified and when their populations have increased to a point that will become detrimental to plant growth. Apply all pesticides to manufacturer's directions.

Frequency: weekly inspection

Fertilising

Generally check for signs of nutrient deficiencies (yellowing of leaves, failure to thrive), and adapt fertiliser regime to suit. Fertiliser should be applied at the beginning and the end of the (summer) growing season.

Irrigation

A temporary irrigation style is recommended to garden beds in Stage 1. A sub surface dripper style, electrically automated self timed irrigation system is recommended to be supplied to all garden bed areas in Concept Proposal. Regular checks are to be made to ensure continued successful operation. The Landscape Contractor shall be responsible for coordination and engagement of a specialist irrigation designer and installation contractor to design, supply and install an automatic subterranean drip irrigation system to all raised planter beds.

The irrigation system will need to provide designated landscaped areas with enough water for vigorous healthy plant growth. As a general rule landscaped areas will need 20-25mm, species dependant, of water per week. The landscape Contractor will need to monitor natural rainfall using a rain switch in order to set irrigation flow rates accordingly on a monthly basis.

Planter Box

The waterproofing membrane is to be sealed to the drainage outlet and exted vertically to a height of 100mm above the soil or fill level. A protection board should be installed to minimise root damage to the membrane. The internal fall in the planter box should be a minium of 1:100 and a suitable safety overflow should be provided. Externally exposed walls of the planter boxes should be waterproofed to prevent failure of the internal membrane.

Standards

All grown or purchased plant stock must conform to all the conditions and requirements given in NATSPEC Guide: Specifying Trees. Soils to be in accordance with AS4419, mulching composts and conditioners to be in accordance with AS4454. Soils should conform to best practice specifications as listed in the Landscape Soils Handbook (Simon Leake & Elke Haege 2017).

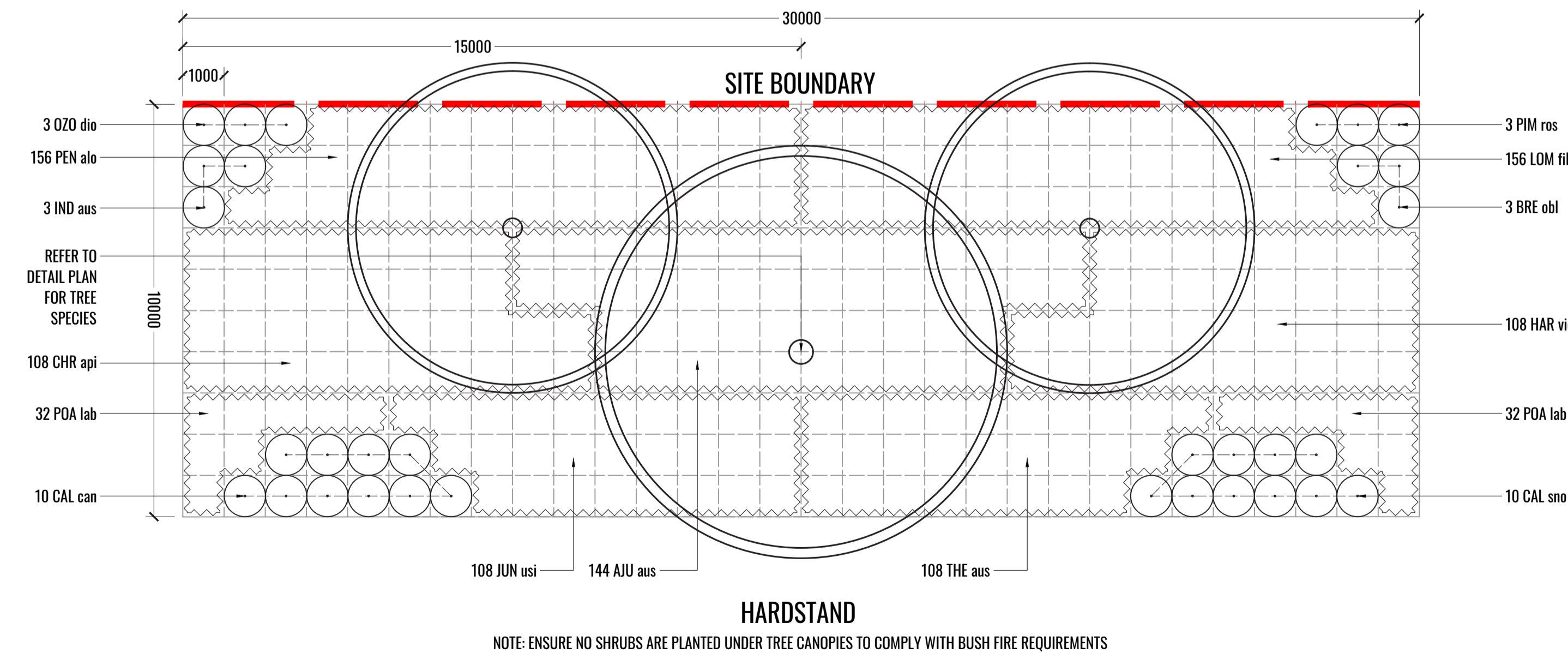

3 PLANTING MATRIX 1 - 10M LANDSCAPE FRONT SETBACK

TYPICAL SECTION SCALE 1:100

TYPICAL LANDSCAPE DETAILS

TREE/SHRUB SIZE AND QUALITY TO BE TO NATSPEC STANDARD. SPECIES IS TO BE AS PER PLAN AND PLANT SCHEDULE. ENSURE ONLY HEALTHY AND VIGOROUS, DISEASE FREE, WELL MAINTAINED PLANTS ARE USED. TAKE CARE TO ENSURE FOLIAGE, BRANCHES, TRUNKS AND ROOT CROWNS ARE NOT DAMAGED BEFORE, DURING AND AFTER PLANTING. ENSURE OPTIMUM MAINTENANCE AND ESTABLISHMENT OF TREES/SHRUBS OCCURS AS SOON AS THEY ARE AT SITE

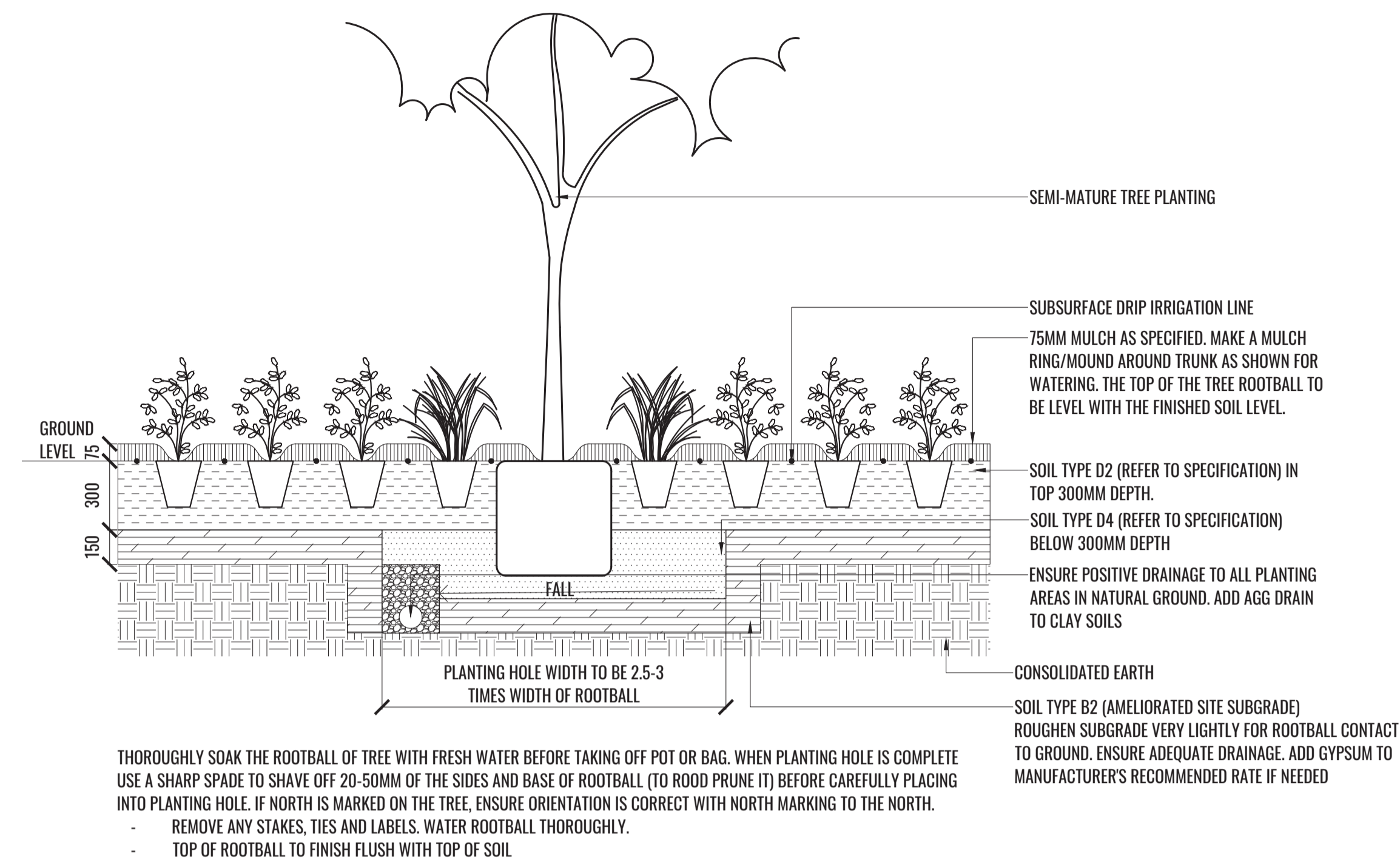

1 MASS PLANTING AND TREE DETAIL

TYPICAL SECTION SCALE 1:20

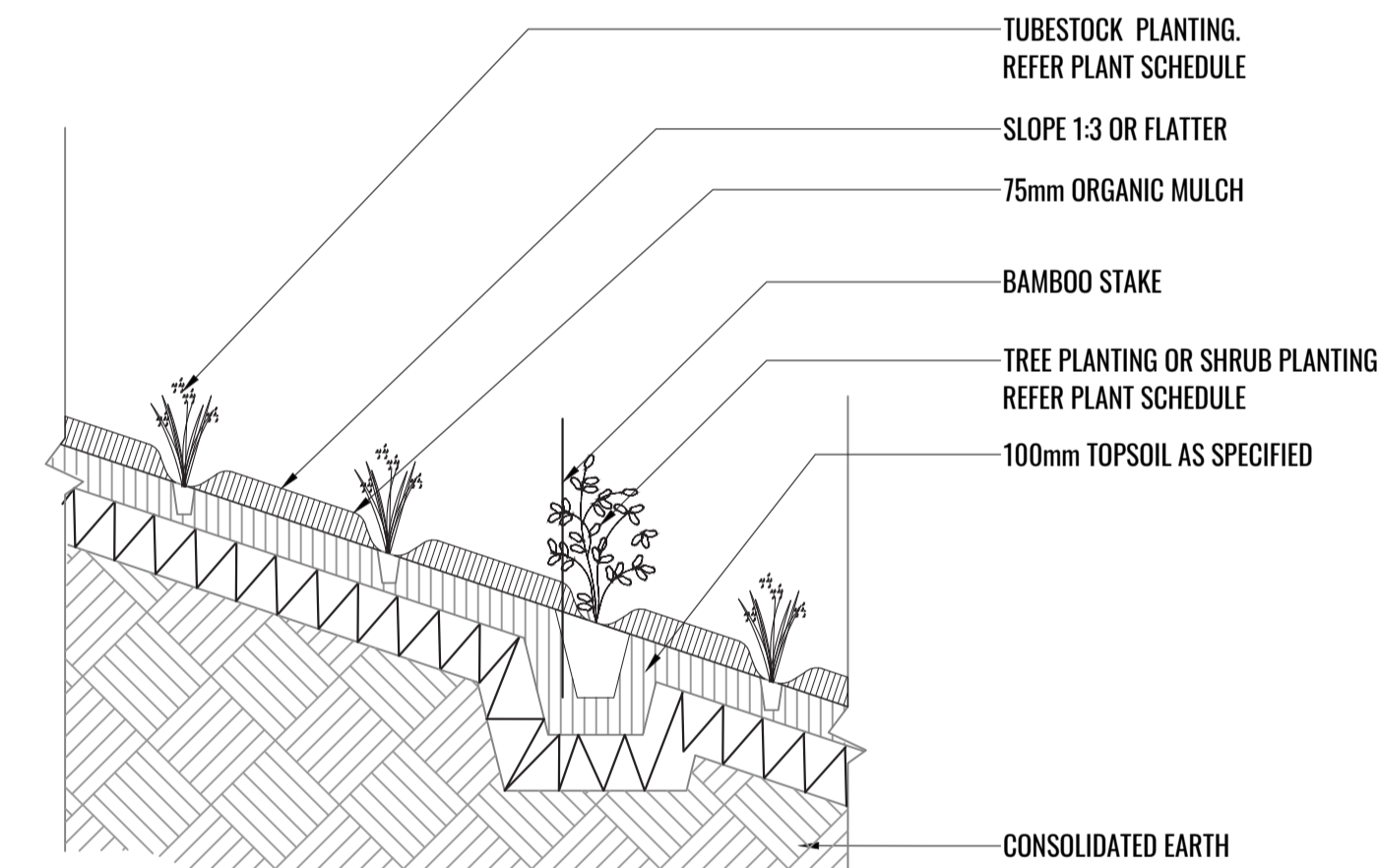

2 TUBESTOCK PLANTING DETAIL ON 1:3 GRADE OR FLATTER

TYPICAL SECTION SCALE 1:20

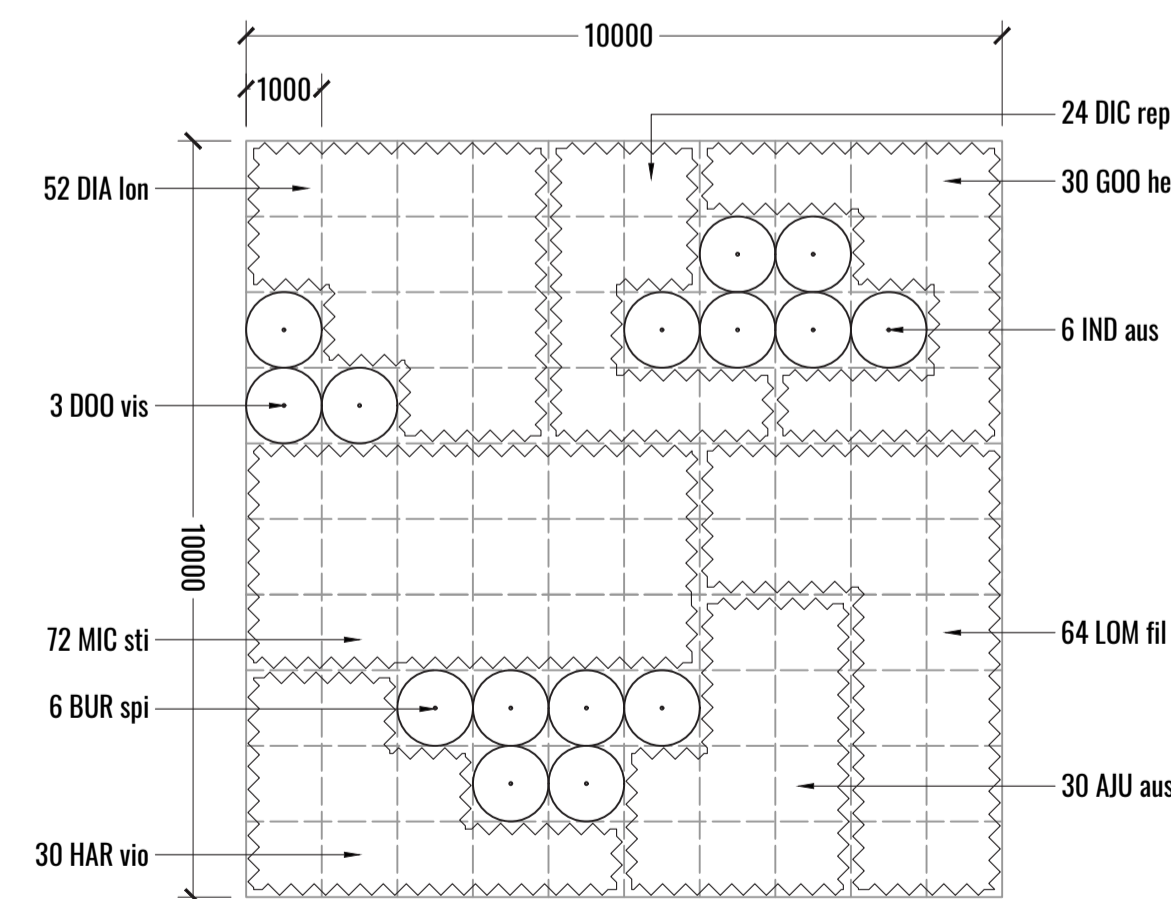

4 PLANTING MATRIX 2 - REAR LANDSCAPE

TYPICAL SECTION SCALE 1:100

Drawing Title:
Specification, Details & Planting Matrices
DWG No: **SSD-07**

GEOSCAPES
LANDSCAPE ARCHITECTS
Suite 303, 8 Help Street, Chatswood NSW 2067 Ph. (02) 9411 1485
www.geoscapes.com.au
ABN 84 620 205 781 ACN 620 205 781

Architect:
nettleontribe
architecture

Client:

Western Sydney Parklands

Scale:	Date:	Job Number:	North:	Revision		FOR SSD		
AS SHOWN @ A1 AS SHOWN @ A3	14.06.24	230926		Rev	Date	Description	Drawn	Checked
Project: Wallgrove Business Hub 97-151 Wallgrove Rd, Cecil Park, NSW 2178				F	21.03.24	For SSD	PT	BG
				G	07.05.24	For SSD	PT	BG
				H	14.05.24	For SSD	PT	BG
				I	14.06.24	For SSD	PT	BG

NOT FOR CONSTRUCTION

STAGE 1 PLANTING SCHEDULE

CODE	BOTANICAL NAME	COMMON NAME	MATURE HEIGHT	INSTALL SIZE	PLANTING DENSITY	CUMBERLAND		QTY**
						PLAIN WOODLAND	NATIVE	
Trees								
BRA ACE	<i>Brachychiton acerifolius</i>	Illawarra Flame Tree	15-20m	75LT	As Shown		✓	2
COR MAC	<i>Corymbia maculata</i>	Spotted Gum	30m	75LT	As Shown	✓	✓	6
ELA EUM	<i>Elaeocarpus eumundi</i>	Native Quandong	7m	75LT	As Shown		✓	16
ELA RET	<i>Elaeocarpus reticulatus</i>	Blueberry Ash	9m	75LT	As Shown		✓	12
EUC AMP	<i>Eucalyptus amplifolia</i>	Cabbage Gum	30m	75LT	As Shown	✓	✓	21
EUC CRE	<i>Eucalyptus crebra</i>	Grey Ironbark	35m	75LT	As Shown	✓	✓	6
EUC MOL	<i>Eucalyptus moluccana</i>	Grey Box	30m	75LT	As Shown	✓	✓	6
MEL LIN	<i>Melaleuca linariifolia</i>	Snow in Summer	10m	75LT	As Shown		✓	5
MEL QUI	<i>Melaleuca quinquenervia</i>	Broad-Leaved Paperbark	20m	75LT	As Shown		✓	8
WAT FLO	<i>Waterhousea floribunda</i>	Weeping Lilly Pilly	15m	75LT	As Shown		✓	13
Shrubs								
BRE obl	<i>Breynia oblongifolia</i>	Coffee Bush	2-3m	300mm	As Shown	✓	✓	79
BUR spi	<i>Bursaria spinosa</i>	Sweet Bursaria	3-4m	300mm	As Shown	✓	✓	248
COR alb	<i>Correa alba</i>	White Correa	0.8m*	300mm	As Shown OR 500mm Ctrs		✓	181
CAL can	<i>Callistemon 'Candy Burst'</i>	Pink Bottlebrush	1m	300mm	As Shown		✓	83
CAL sno	<i>Callistemon 'Snow Burst'</i>	White Bottlebrush	0.8m	300mm	As Shown		✓	83
DDD vis	<i>Dodonaea viscosa</i>	Hopbush	2.5m	300mm	As Shown	✓	✓	140
IND aus	<i>Indigofera australis</i>	Australian Indigo	2m	300mm	As Shown	✓	✓	285
OZO dio	<i>Ozothamnus diosmifolius</i>	Rice Flower	1.5m	300mm	As Shown	✓	✓	25
PIM ros	<i>Pimelea rosea</i>	Rice Flower	0.5-1m	300mm	As Shown		✓	76
WES aus	<i>Westringia fruticosa 'Aussie Box'</i>	Coastal Rosemary	0.8m	300mm	As Shown OR 500mm Ctrs		✓	124
Grasses & Groundcovers								
AJU aus	<i>Ajuga australis</i>	Australian Bugle	0.5m	140mm	3/m2	✓	✓	2246
ART mil	<i>Arthropodium milleflorum</i>	Pale Vanilla Lily	1m	140mm	4/m2	✓	✓	106
BRA mul	<i>Brachyscome multifida 'White Bliss'</i>	Native Daisy	0.2m	140mm	3/m2 OR 3/m2		✓	193
CAR ros	<i>Carpobrotus rossii 'White Hot'</i>	Pigface	0.2m	140mm	3/m2 OR 2/m2		✓	20
CHR api	<i>Chrysocephalum apiculatum</i>	Yellow Buttons	0.5m	140mm	3/m2	✓	✓	989
DIA lon	<i>Dianella longifolia</i>	Pale flax lily	0.6m	Tubestock	4/m2	✓	✓	3883
DIC rep	<i>Dichondra repens</i>	Kidney Weed	0.1m	140mm	3/m2	✓	✓	846
GOO hed	<i>Goodenia hederacea</i>	Goodenia	0.3m	140mm	3/m2 OR 2/Lm	✓	✓	1229
HAR vio	<i>Hardenbergia violacea</i>	Purple Coral Pea	1.5m	140mm	3/m2	✓	✓	1949
JUN usi	<i>Juncus usitatus</i>	Common Rush	1.2m	Tubestock	4/m2	✓	✓	892
LOM fil	<i>Lomandra filiformis</i>	Wattle Mat Rush	0.8m	Tubestock	4/m2 OR 4/Lm	✓	✓	5294
LOM mul	<i>Lomandra multiflora subsp. Multiflora</i>	Many Flowered Mat-Rush	0.75m	Tubestock	5/m2	✓	✓	2279
MIC sti	<i>Microlaena stipoides</i>	Weeping grass	0.75m	Tubestock	4/m2	✓	✓	4289
PEN alo	<i>Pennisetum alopecuroides 'Nafray'</i>	Foxtail Grass	0.7m	Tubestock	4/m2		✓	1288
POA lab	<i>Poa labillardieri var. labillardieri</i>	Tussock Grass	1.2m	Tubestock	4/m2	✓	✓	528
THE aus	<i>Themeda australis</i>	Kangaroo Grass	1.5m	Tubestock	4/m2	✓	✓	892
Total						26238	28342	28342
% of Total number of plants						93%	100%	

* To be trimmed to height indicated

** Total plant quantities to be confirmed at Construction Certificate stage

STAGE 1 BASIN PLANTING SCHEDULE

CODE	BOTANICAL NAME	COMMON NAME	MATURE HEIGHT	INSTALL SIZE	PLANTING DENSITY	CUMBERLAND		QTY**
						PLAIN WOODLAND	NATIVE	
Grasses								
CAR inv	<i>Carex inv</i>	Knob Sedge	0.5m	Tubestock	8/m2	✓	✓	2830
FIC nod	<i>Ficinia nodosa</i>	knotted club-rush	1m	Tubestock	8/m2		✓	2830
IMP cyl	<i>Imperata cylindrica</i>	Cogon Grass	1m	Tubestock	8/m2		✓	2830
JUN usi	<i>Juncus usitatus</i>	Common Rush	1.2m	Tubestock	8/m2	✓	✓	2830
LOM fil	<i>Lomandra filiformis</i>	Wattle Mat-Rush	0.3m	Tubestock	8/m2	✓	✓	2830
SOR lei	<i>Sorghum leiocladum</i>	Wild Sorghum	1m	Tubestock	8/m2	✓	✓	2830
Total						11320	16980	16980
% of Total number of plants						67%	100%	

** Total plant quantities to be confirmed at Construction Certificate stage

PLANT IMAGES



Corymbia maculata



Callistemon 'Candy Burst'



Dodenea viscosa



Indigofera australis



Bursaria spinosa



Eucalyptus amplifolia



Goodenia hederacea

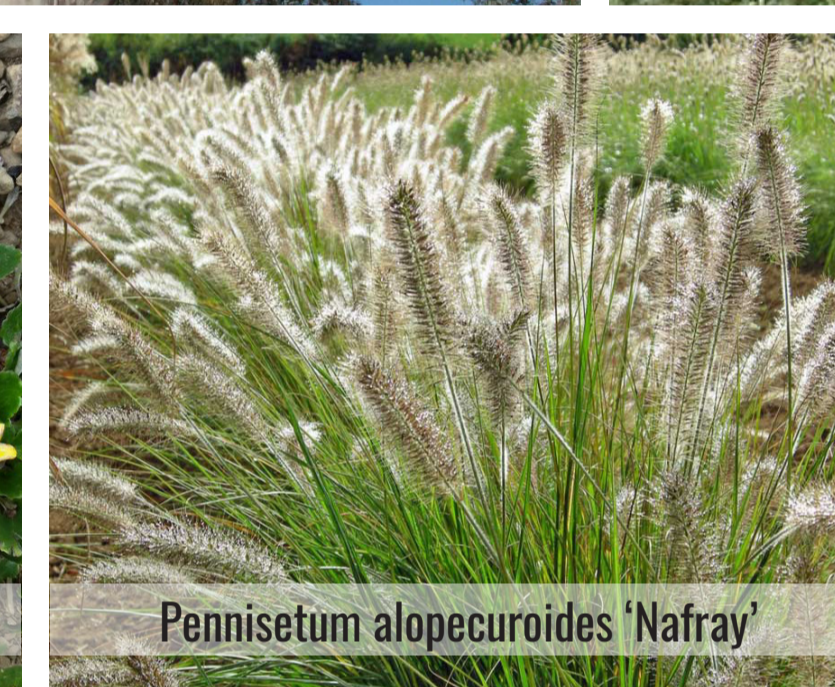

Pennisetum alopecuroides 'Nafray'

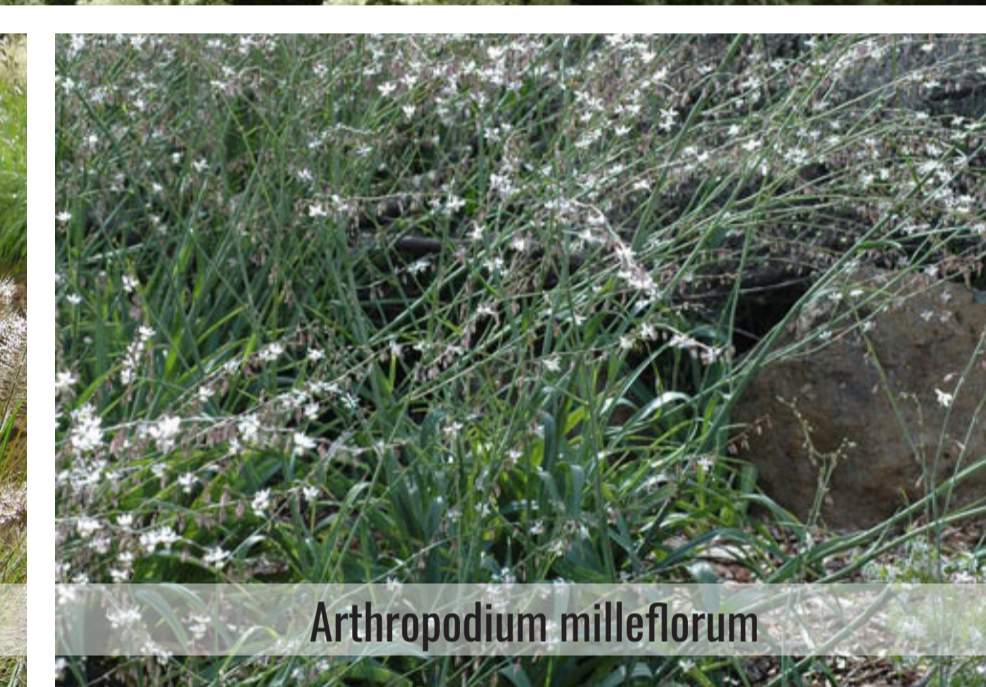

Arthropodium milleflorum

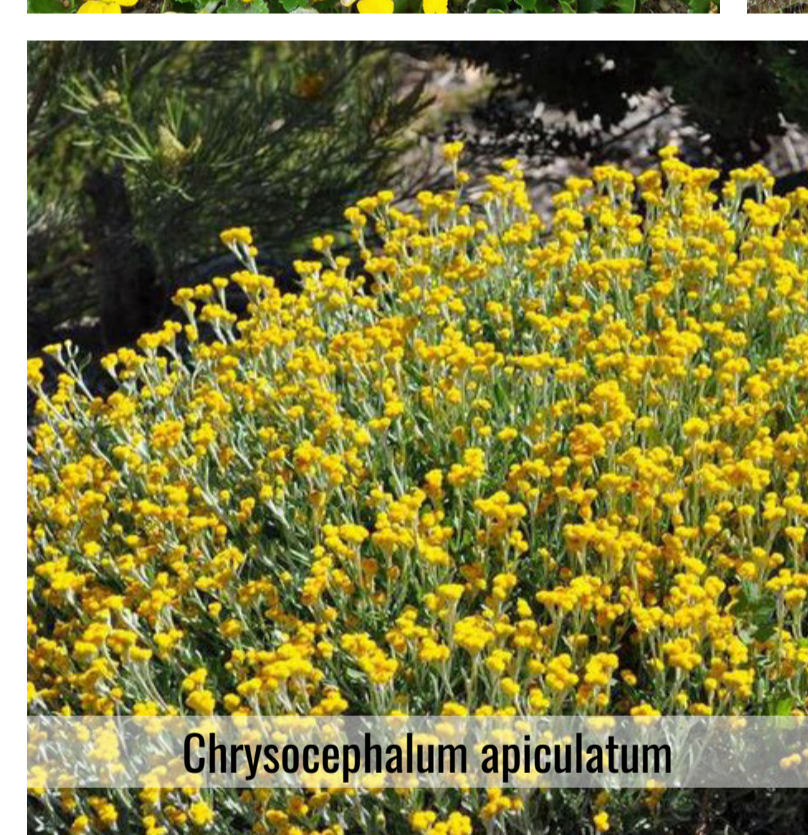

Chrysocephalum apiculatum



Elaeocarpus eumundi



Brachyscome multifida 'White Bliss'



Carpobrotus 'White Hot'



Ajuga australis



Brachychiton acerifolius

Drawing Title:

Stage 1 Planting Schedule & Imagery

DWG No:

SSD-08

GEOSCAPES
LANDSCAPE ARCHITECTS
Suite 303, 8 Help Street, Chatswood NSW 2067 Ph. (02) 9411 1485
www.geoscapes.com.au
ABN 84 620 205 781 ACN 620 205 781

Architect:

nettletontribe
architecture

Client:



Scale:

Date:

14.06.24

Job Number:

230926

North:

Revision

Rev	Date	Description	Drawn	Checked
F	21.03.24	For SSD	PT	BG
G	07.05.24	For SSD	PT	BG
H	14.05.24	For SSD	PT	BG
I	14.06.24	For SSD	PT	BG

FOR SSD

Project:

Wallgrove Business Hub

97-151 Wallgrove Rd, Cecil Park, NSW 2178

NOT FOR CONSTRUCTION