

1 AIN - Link West - Level 1 (RL 25.0)  
SCALE: 1:100

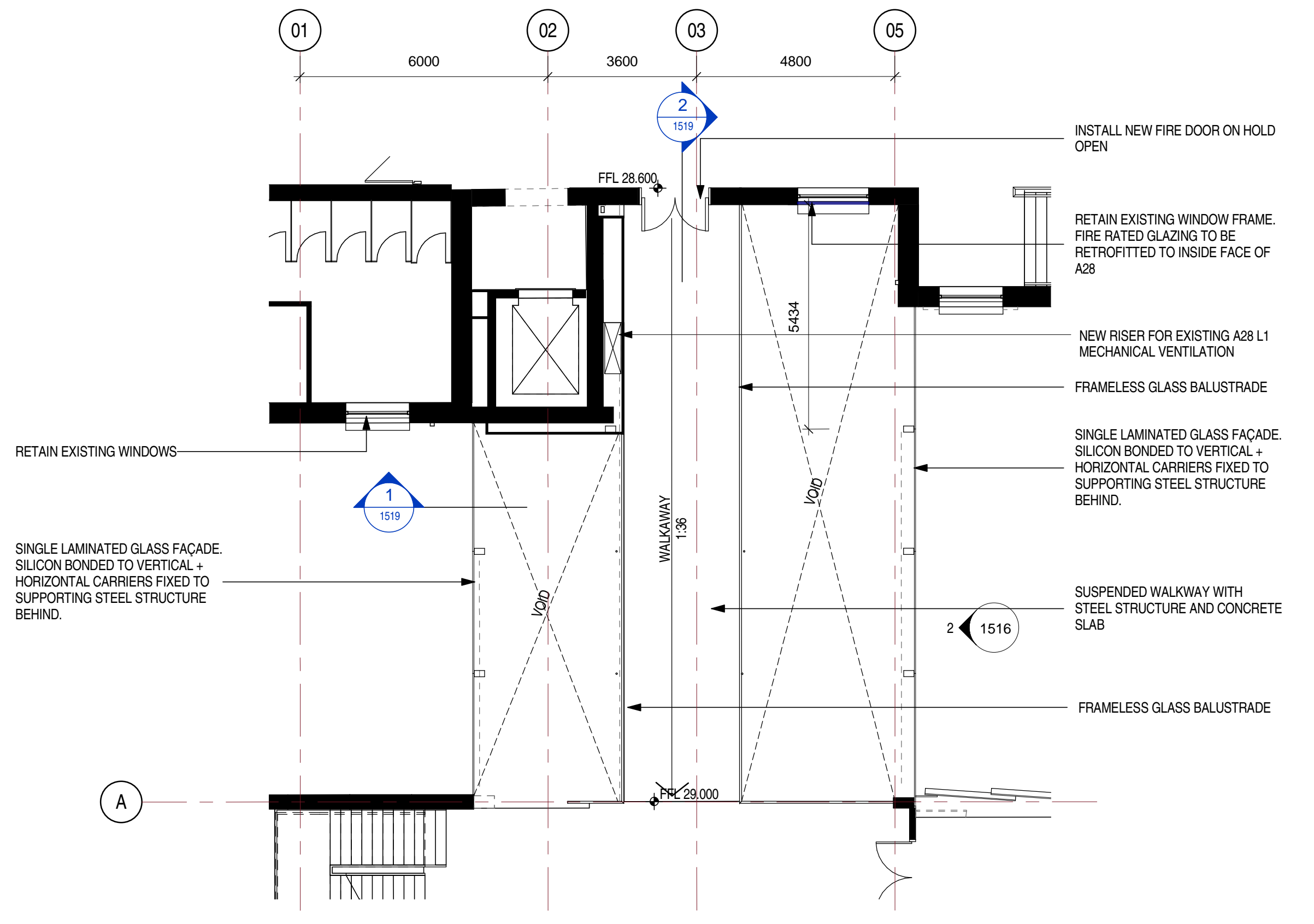

2 AIN - Link West - Level 2 (RL 29.0)  
SCALE: 1:100

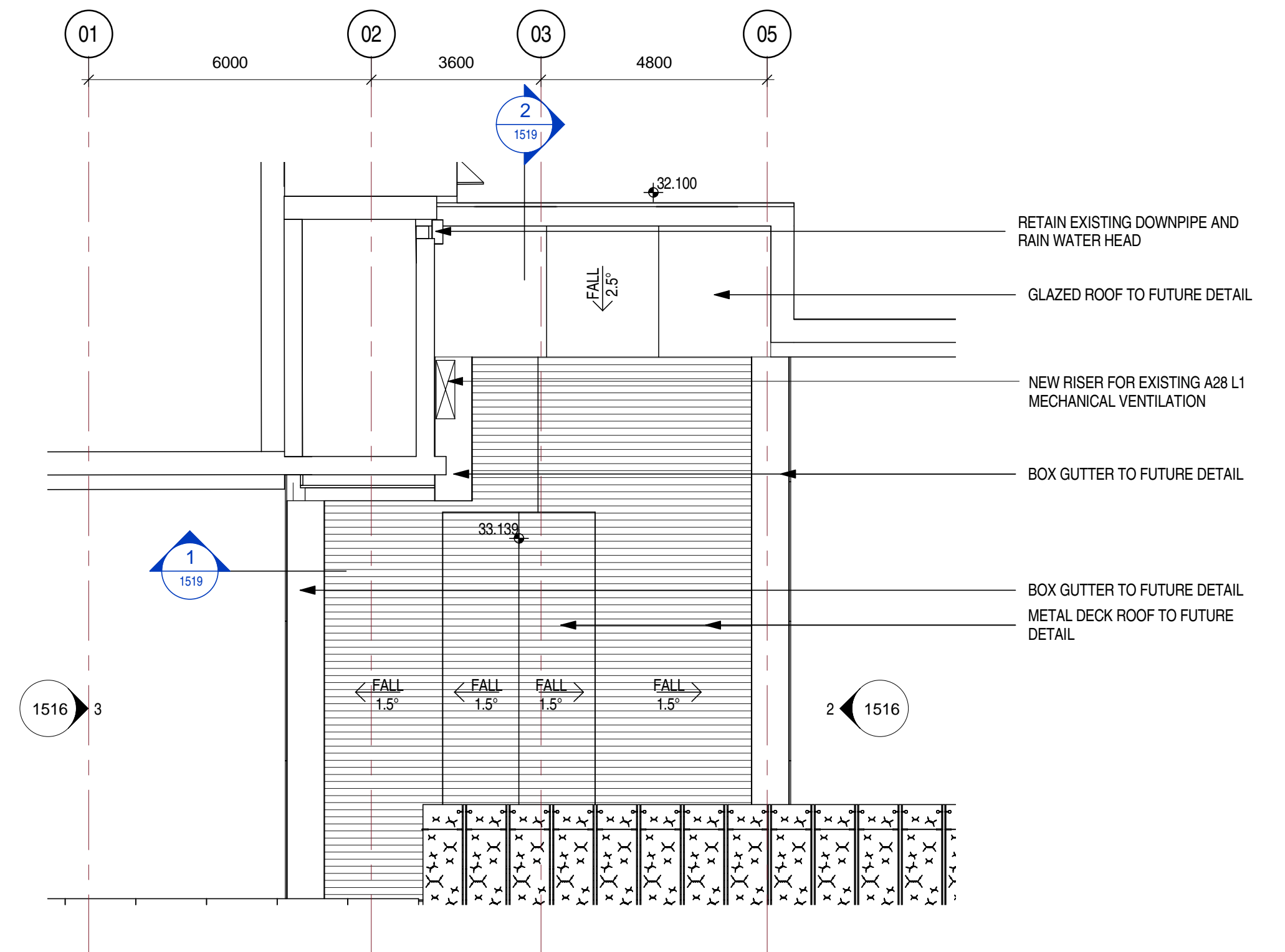

3 AIN - Link West - Roof  
SCALE: 1:100

architectus Sydney 2012

Architectus Sydney Pty Ltd is the owner of the copyright subsisting in these drawings, plans, designs and specifications. They must not be used, reproduced or copied, in whole or in part, nor may the information, ideas and concepts therein contained (which are confidential to Architectus Sydney Pty Ltd) be disclosed to any person without the prior written consent of that company.

Do not scale drawings.  
Verify all dimensions on site

issue	amendment	date
A	Work in Progress Issue	15.08.2012
B	Issue for PPR	06.09.2012
C	Issue for PPR	28.09.2012
D	Part 4 Submission	02.10.2012

issue	amendment	date

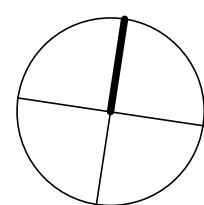

jestico + whites

1 Cobourg Street  
London  
NW1 2HP  
T (44) 207 380 0382  
F (44) 370 622 0732  
www.jesticowhites.com



Optima Building, Level 1 North  
58 Robertson Street  
Glasgow, United Kingdom G2 8DU  
T (44) 141 204 2333  
F (44) 141 204 2033  
www.ch2mhill.com

Sydney  
Melbourne  
Auckland  
Brisbane  
Shanghai

architectus™

Architectus Sydney  
Level 3 341 George Street  
Sydney NSW 2000  
T (61 2) 8252 8400  
F (61 2) 8252 8800  
sydney@architectus.com.au

ABN 11 098 489 448

checked	RO	scale
drawn	MM	project no 110010.00

project	Australian Institute of Nanoscience
drawing	Environmental Assessment
drawing no.	Proposed West Link Plans
issue	D
issue	A-1511

27/09/2012 1:02:20 PM