

DOCUMENTATION OF STRUCTURAL WORKS

PROPOSED CO-LIVING DEVELOPMENT

175-177 CLEVELAND STREET & 6-8 WOODBURN STREET, REDFERN

JAMES TAYLOR AND ASSOCIATES

SUITE 301, 115 MILITARY ROAD NEUTRAL BAY NSW 2089 A.C.N. 002 376 454

Tel: (02) 9969 1999 Email: mail@jamestaylorassociates.com.au

STRUCTURAL DRAWING LIST	
Sheet Number	Sheet Name
S01	COVER SHEET
S09	TUNNEL ALIGNMENT PLAN
S10	BULK EXCAVATION PLAN
S20	FOOTING PLAN
S21	BASEMENT PLAN
S25	SECTION 1
S26	SECTION 2

CONCRETE

- C1. ALL WORKMANSHIP AND MATERIALS SHALL BE IN ACCORDANCE WITH AS3600-2009 EXCEPT WHERE VARIED BY THE CONTRACT DOCUMENTS.
- C2. CONCRETE COMPOSITION AND CLEAR COVER TO REINFORCEMENT SHALL BE AS FOLLOWS:
- | | | |
|---------------------------------|-------------------------------|-----------|
| ELEMENT | AS 3600
f _c MPa | COVER mm. |
| FOOTINGS | 40 | 45 |
| ALL - UNO. INTERNAL
EXTERNAL | 40
40 | 25
45 |
- C3. ADMIXTURES, WHERE USED, SHALL COMPLY WITH THE REQUIREMENTS OF AS1478 AND AS1479. THESE COVER REQUIREMENTS MAY VARY DUE TO REQUIRED FIRE RESISTANCE RATING - REFER AS3600
- C3. ALL CONCRETE SUPPLY & TESTING SHALL CONFORM WITH AS1379 AND SHALL HAVE MAXIMUM SLUMP OF 80mm AND AGGREGATES IN ACCORDANCE WITH AS2758.1 TO A MAXIMUM SIZE OF 20mm
- C4. CONSTRUCTION JOINTS SHALL BE PROPERLY FORMED AND USED ONLY WHERE SHOWN ON DRAWINGS OR SPECIFICALLY APPROVED BY THE ENGINEER.
- C5. NO HOLES, CHASES OR EMBEDMENTS OF PIPES, OTHER THAN THOSE SHOWN ON THE STRUCTURAL DRAWINGS, SHALL BE MADE IN CONCRETE MEMBERS WITHOUT THE PRIOR APPROVAL OF THE ENGINEER.
- C6. ALL CONCRETE SHALL BE PLACED AND CURED IN ACCORDANCE WITH AS3600. WHERE A SURFACE CURING COMPOUND IS USED, IT MUST BE APPLIED ONTO SLABS WITHIN 2 HOURS OF FINISHING OPERATION AND ONTO WALLS AND COLUMNS IMMEDIATELY AFTER REMOVAL OF THE FORMWORK. HORIZONTAL FORMWORK SHALL BE STRIPPED WHEN APPROVED BY THE ENGINEER.
- C8. SLABS AND BEAMS SHALL BEAR ONLY ON THE BEAMS, WALLS ETC. SHOWN ON THE STRUCTURAL DRAWINGS. ALL OTHER BUILDING ELEMENTS SHALL BE KEPT 15mm CLEAR OF SOFFITS OF STRUCTURAL ELEMENTS.
- C9. COMPLETED STRUCTURAL ELEMENTS SHALL CONFORM WITH THE SHAPES, LINES, LEVELS, GRADES AND DIMENSIONS REQUIRED BY THE CONTRACT DRAWINGS.
- C10. ALL CONCRETE REINFORCEMENT SHALL CONFORM WITH AS/NZS 4671. DUCTILITY GRADE: CLASS N. NO REINFORCEMENT SHALL BE WELDED WITHOUT PRIOR APPROVAL.
- C11. R = STRUCTURAL GRADE ROUND BAR
N = "TEMPCORE" DEFORMED BAR
F = HARD DRAWN STEEL WIRE REINFORCING FABRIC
DESIGNATION CODE OF REINFORCEMENT BARS:-

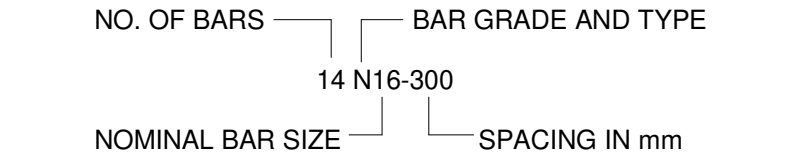

- UNO - UNLESS NOTED OTHERWISE.
NSOP - NOT SHOWN ON PLAN.
LV - LENGTH VARIES.
- C12. TRANSVERSE TIE BARS N12-300, WHERE NOT OTHERWISE SHOWN, SPLICE WHERE NECESSARY AND LAP WITH MAIN BARS 400mm.
- C13. SPLICES IN REINFORCEMENT SHALL BE MADE ONLY IN POSITIONS SHOWN ON THE STRUCTURAL DRAWINGS OR IN POSITIONS OTHERWISE APPROVED IN WRITING BY THE PRINCIPAL. LAPS SHALL BE IN ACCORDANCE WITH AS3600 AND NOT LESS THAN THE DEVELOPMENT FOR EACH BAR. SITE BENDING OF REINFORCING BARS SHALL BE DONE WITHOUT HEATING USING MECHANICAL BENDING TOOLS. WELDING OF REINFORCEMENT SHALL NOT BE PERMITTED UNLESS SHOWN ON THE STRUCTURAL DRAWINGS OR APPROVED BY THE STRUCTURAL ENGINEER. FABRICS SHALL BE LAPPED 2 TRANSVERSE WIRES PLUS 50mm. BUNDLED BARS SHALL BE TIED TOGETHER AT 30 BAR DIAMETER CENTRES WITH THREE WRAPS OF TIE WIRE.
- C14. REINFORCEMENT IS SHOWN DIAGRAMMATICALLY. IT IS NOT NECESSARILY SHOWN IN TRUE ROJECTION.
- C15. ALL REINFORCEMENT SHALL BE MAINTAINED IN POSITION DURING CONCRETING.

GENERAL

- G1. THESE DRAWINGS ARE TO BE READ IN CONJUNCTION WITH ALL OTHER RELEVANT DOCUMENTS INCLUDING ALL WORKING DRAWINGS AND SPECIFICATIONS, AND WRITTEN INSTRUCTIONS AS MAY BE ISSUED PRIOR TO OR DURING THE COURSE OF CONSTRUCTION. ALL DISCREPANCIES AND VARIATIONS SHALL BE REFERRED TO THE ENGINEER BEFORE PROCEEDING WITH THE WORK.
- G2. ALL STRUCTURAL WORK SHALL BE IN ACCORDANCE WITH THE REQUIREMENTS OF ALL RELEVANT AND CURRENT S.A.A. CODES.
- G3. STRUCTURAL DRAWINGS SHALL NOT BE SCALED IN ORDER TO OBTAIN DIMENSIONS. DIMENSIONS WHERE SHOWN ON STRUCTURAL DRAWINGS SHALL BE CO-ORDINATED WITH ALL OTHER RELEVANT DRAWINGS.
- G4. DURING CONSTRUCTION, THE STRUCTURE SHALL BE MAINTAINED IN A STABLE CONDITION AND NO PART SHALL BE OVERSTRESSED.

FOUNDATION

- F1. DESIGN BEARING PRESSURE = 1000kPa (APPROVED ROCK)
- F2. FOUNDATION MATERIAL SHALL BE APPROVED FOR THE ABOVE DESIGN BEARING PRESSURE PRIOR TO CONSTRUCTION OF FOOTINGS.

					ARCHITECT	CLIENT	PROJECT	James Taylor & Associates Civil & Structural Consulting Engineers SUITE 301, 115 MILITARY ROAD NEUTRAL BAY NSW 2089 A.B.N. 33 102 603 558 TEL: 02 99691999 EMAIL: mail@jamestaylorassociates.com.au <small>COPYRIGHT: THIS DESIGN AND PLANS ARE NOT TO BE USED OR REPRODUCED WHOLLY OR IN PART WITHOUT WRITTEN PERMISSION FROM JAMES TAYLOR AND ASSOCIATES</small>	DESIGN	RY	DRAWN	HL	PROJECT NO.	
					MARK SHAPIRO ARCHITECTS	EG FUNDS MANAGEMENT	PROPOSED CO-LIVING DEVELOPMENT		CHKD.				6394	
					markshapiro.com.au	ADDRESS	175-177 CLEVELAND ST & 6-8 WOODBURN ST, REDFERN		APPRD.			DRAWING NO.		REV
HL BY	R.Y. CHKD	FOR DA DESCRIPTION		14.09.2022 DATE	A REV	PHONE 0421 996 467	LEVEL 21, GOVERNOR PHILLIP TOWER, 1 FARRER PLACE, SYDNEY, 2000	COVER SHEET	SCALE As indicated			DATE	S01	A



ARCHITECT
MARK SHAPIRO ARCHITECTS
markshapiro.com.au
EMAIL mark@markshapiro.com.au
PHONE 0421 996 467

PROJECT
PROPOSED CO-LIVING DEVELOPMENT
175-177 CLEVELAND ST & 6-8 WOODBURN ST, REDFERN

TUNNEL ALIGNMENT PLAN

DESIGN	RY	DRAWN	HL
CHKD.			
APPRD.			
SCALE 1 : 150		DATE	

PROJECT NO.
6394

DRAWING NO. S09	REV A
---------------------------	-----------------

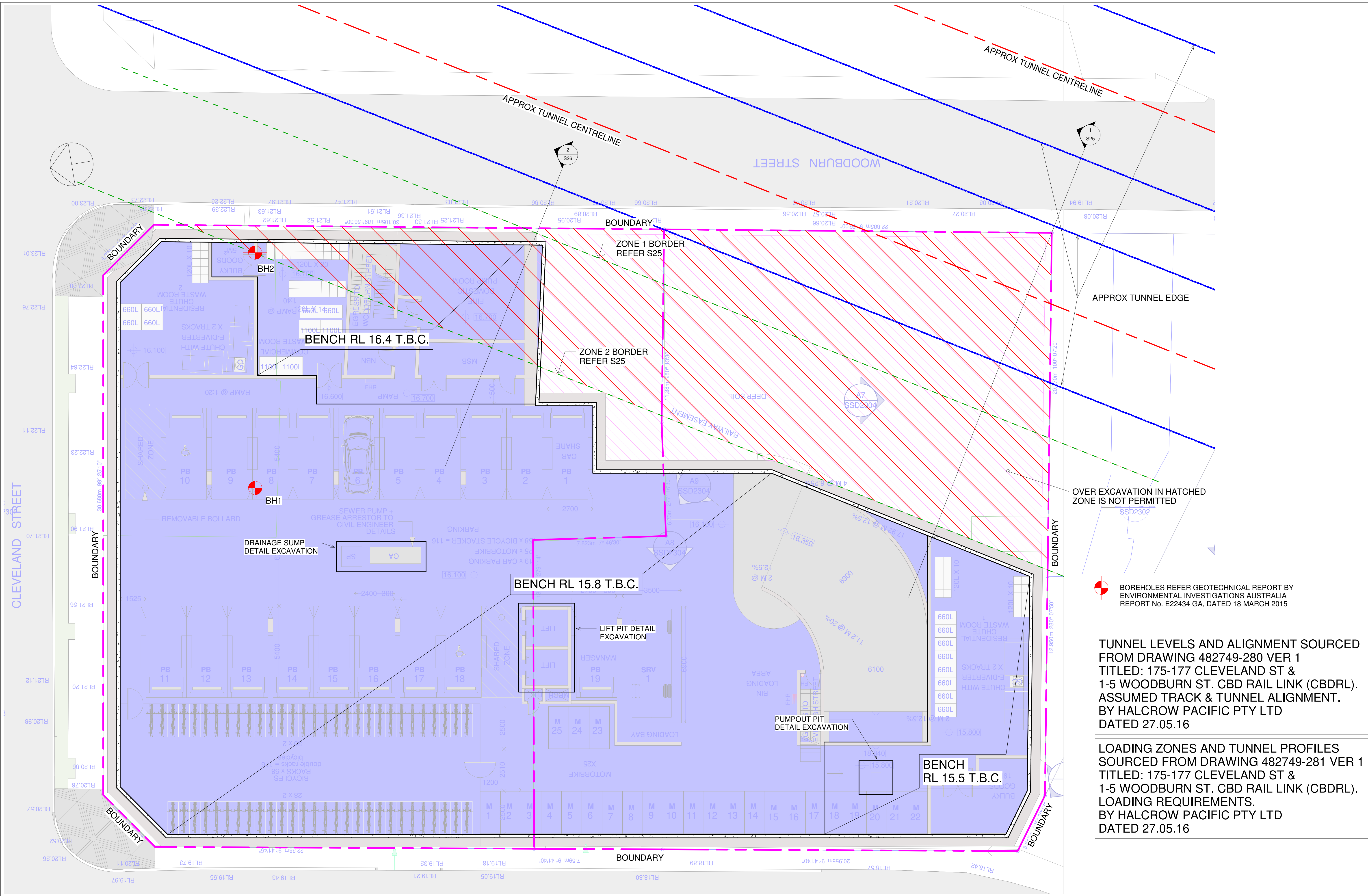

TUNNEL LEVELS AND ALIGNMENT SOURCED FROM DRAWING 482749-280 VER 1
TITLED: 175-177 CLEVELAND ST & 1-5 WOODBURN ST. CBD RAIL LINK (CBDRL).
ASSUMED TRACK & TUNNEL ALIGNMENT.
BY HALCROW PACIFIC PTY LTD
DATED 27.05.16

LOADING ZONES AND TUNNEL PROFILES SOURCED FROM DRAWING 482749-281 VER 1
TITLED: 175-177 CLEVELAND ST & 1-5 WOODBURN ST. CBD RAIL LINK (CBDRL).
LOADING REQUIREMENTS.
BY HALCROW PACIFIC PTY LTD
DATED 27.05.16

BULK EXCAVATION PLAN
SCALE 1 : 100 @A1

A1

HL	R.Y.	FOR DA	14.09.2022	A
BY	CHKD	DESCRIPTION	DATE	REV

ARCHITECT
MARK SHAPIRO ARCHITECTS
markshapiro.com.au
EMAIL mark@markshapiro.com.au
PHONE 0421 996 467

CLIENT
EG FUNDS MANAGEMENT
ADDRESS
LEVEL 21, GOVERNOR PHILLIP TOWER,
1 FARRER PLACE, SYDNEY, 2000

PROJECT
PROPOSED CO-LIVING DEVELOPMENT
175-177 CLEVELAND ST & 6-8 WOODBURN ST, REDFERN
BULK EXCAVATION PLAN

James Taylor & Associates
Civil & Structural Consulting Engineers
SUITE 301, 115 MILITARY ROAD NEUTRAL BAY NSW 2089
A.B.N. 33 102 603 558
TEL: 02 99691999 EMAIL: mail@jamestaylorassociates.com.au

DESIGN RY DRAWN HL
CHKD.
APPRD.
SCALE 1 : 100 DATE

PROJECT NO.
6394
DRAWING NO. REV
S10 A

COPYRIGHT: THIS DESIGN AND PLANS ARE NOT TO BE USED OR REPRODUCED WHOLLY OR IN PART WITHOUT WRITTEN PERMISSION FROM JAMES TAYLOR AND ASSOCIATES

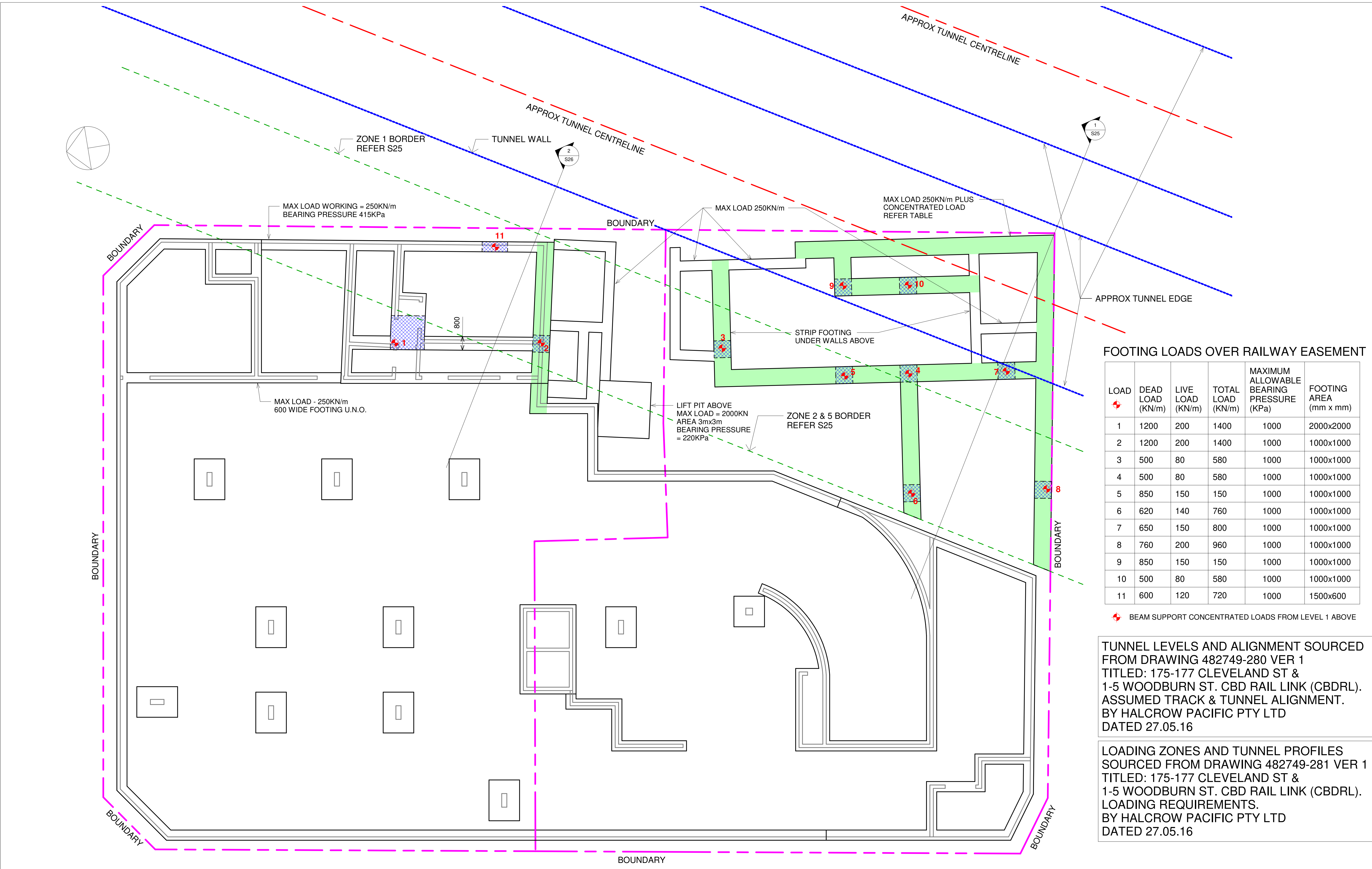

FOOTING LOADS OVER RAILWAY EASEMENT

LOAD	DEAD LOAD (KN/m)	LIVE LOAD (KN/m)	TOTAL LOAD (KN/m)	MAXIMUM ALLOWABLE BEARING PRESSURE (KPa)	FOOTING AREA (mm x mm)
1	1200	200	1400	1000	2000x2000
2	1200	200	1400	1000	1000x1000
3	500	80	580	1000	1000x1000
4	500	80	580	1000	1000x1000
5	850	150	150	1000	1000x1000
6	620	140	760	1000	1000x1000
7	650	150	800	1000	1000x1000
8	760	200	960	1000	1000x1000
9	850	150	150	1000	1000x1000
10	500	80	580	1000	1000x1000
11	600	120	720	1000	1500x600

BEAM SUPPORT CONCENTRATED LOADS FROM LEVEL 1 ABOVE

TUNNEL LEVELS AND ALIGNMENT SOURCED FROM DRAWING 482749-280 VER 1
TITLED: 175-177 CLEVELAND ST & 1-5 WOODBURN ST. CBD RAIL LINK (CBDRL).
ASSUMED TRACK & TUNNEL ALIGNMENT.
BY HALCROW PACIFIC PTY LTD
DATED 27.05.16

LOADING ZONES AND TUNNEL PROFILES SOURCED FROM DRAWING 482749-281 VER 1
TITLED: 175-177 CLEVELAND ST & 1-5 WOODBURN ST. CBD RAIL LINK (CBDRL).
LOADING REQUIREMENTS.
BY HALCROW PACIFIC PTY LTD
DATED 27.05.16

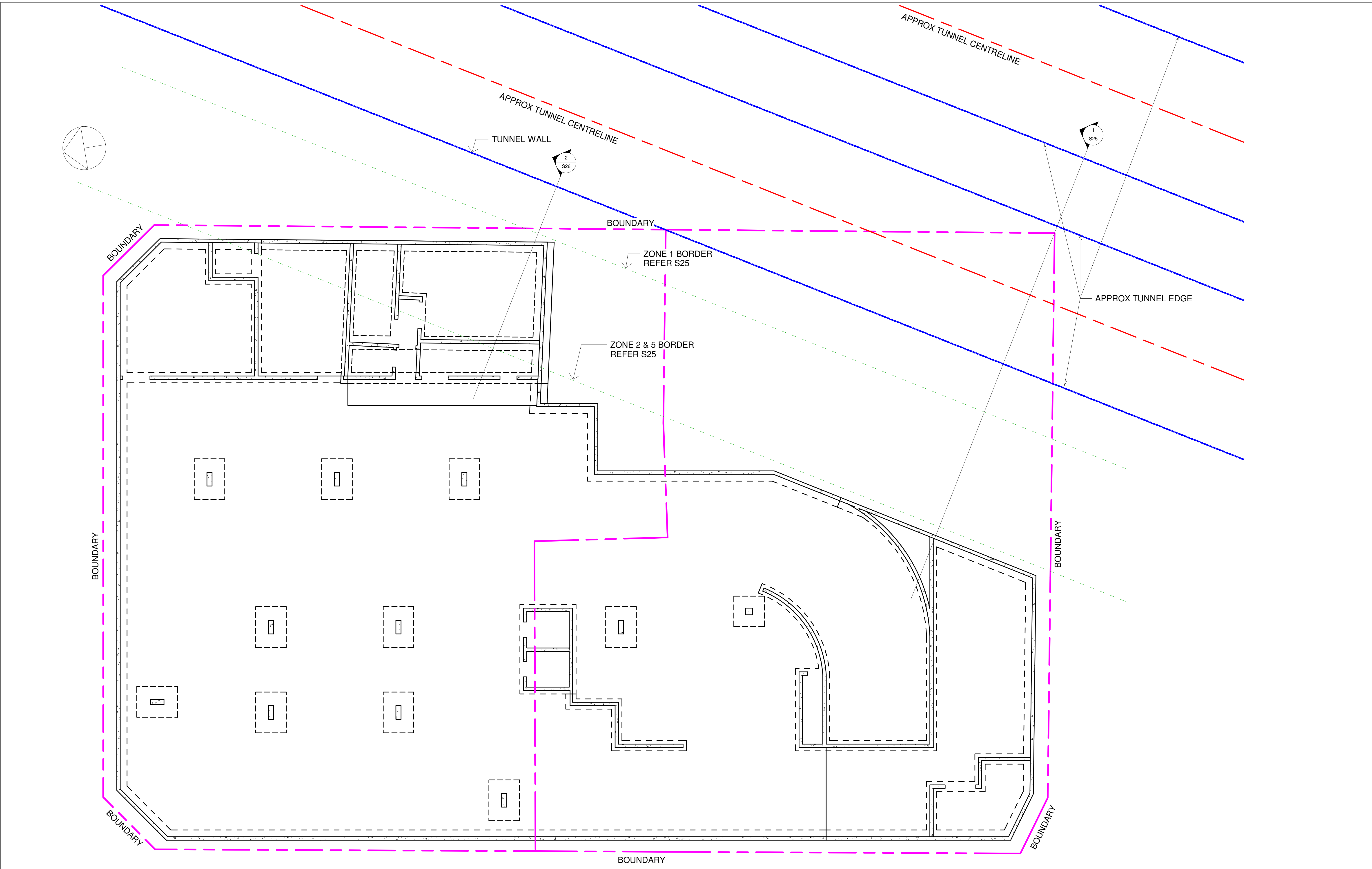

BASEMENT PLAN

SCALE 1 : 100 @A1

HL	R.Y.	FOR DA	14.09.2022	A	
BY	CHKD	DESCRIPTION	DATE	REV	

ARCHITECT
MARK SHAPIRO ARCHITECTS
markshapiro.com.au
EMAIL mark@markshapiro.com.au
PHONE 0421 996 467

CLIENT
EG FUNDS MANAGEMENT
ADDRESS
LEVEL 21, GOVERNOR PHILLIP TOWER,
1 FARRER PLACE, SYDNEY, 2000

PROJECT
PROPOSED CO-LIVING DEVELOPMENT
175-177 CLEVELAND ST & 6-8 WOODBURN ST, REDFERN
BASEMENT PLAN

James Taylor & Associates
Civil & Structural Consulting Engineers
SUITE 301, 115 MILITARY ROAD NEUTRAL BAY NSW 2089
A.B.N. 33 102 603 558
TEL: 02 99691999 EMAIL: mail@jamestaylorassociates.com.au

DESIGN	RY	DRAWN	HL
CHKD.			
APPRD.			
SCALE 1 : 100		DATE	

PROJECT NO.	
6394	
DRAWING NO.	REV
S21	A

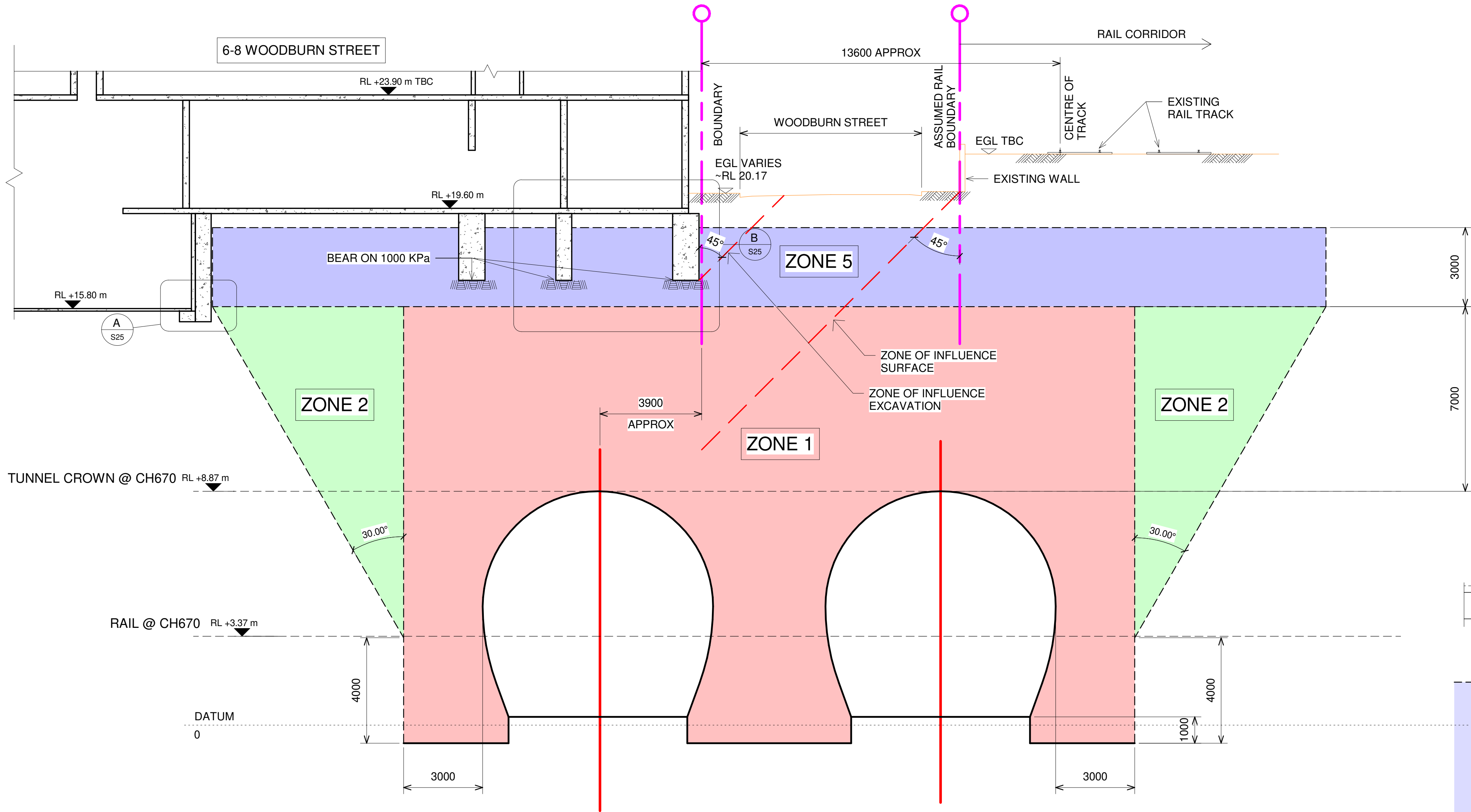

- ZONE 1 EXCAVATIONS, STRUCTURES NOT PERMITTED
- ZONE 2 VERTICAL LOADING NOT ALLOWED
- ZONE 5 3000kN/m² OVER 3x3m MAX (3000KPa) AND 1000kN/m² OVER 10x10m MAX (1000KPa)

TUNNEL CROWN @ CH670 RL +8.87 m

RAIL @ CH670 RL +3.37 m

DATUM
0

1 Section
S09 SCALE 1 : 100 @A1

TUNNEL LEVELS AND ALIGNMENT SOURCED FROM DRAWING 482749-280 VER 1
TITLED: 175-177 CLEVELAND ST & 1-5 WOODBURN ST. CBD RAIL LINK (CBDRL).
ASSUMED TRACK & TUNNEL ALIGNMENT.
BY HALCROW PACIFIC PTY LTD
DATED 27.05.16

LOADING ZONES AND TUNNEL PROFILES SOURCED FROM DRAWING 482749-281
VER 1
TITLED: 175-177 CLEVELAND ST & 1-5 WOODBURN ST. CBD RAIL LINK (CBDRL).
LOADING REQUIREMENTS.
BY HALCROW PACIFIC PTY LTD
DATED 27.05.16

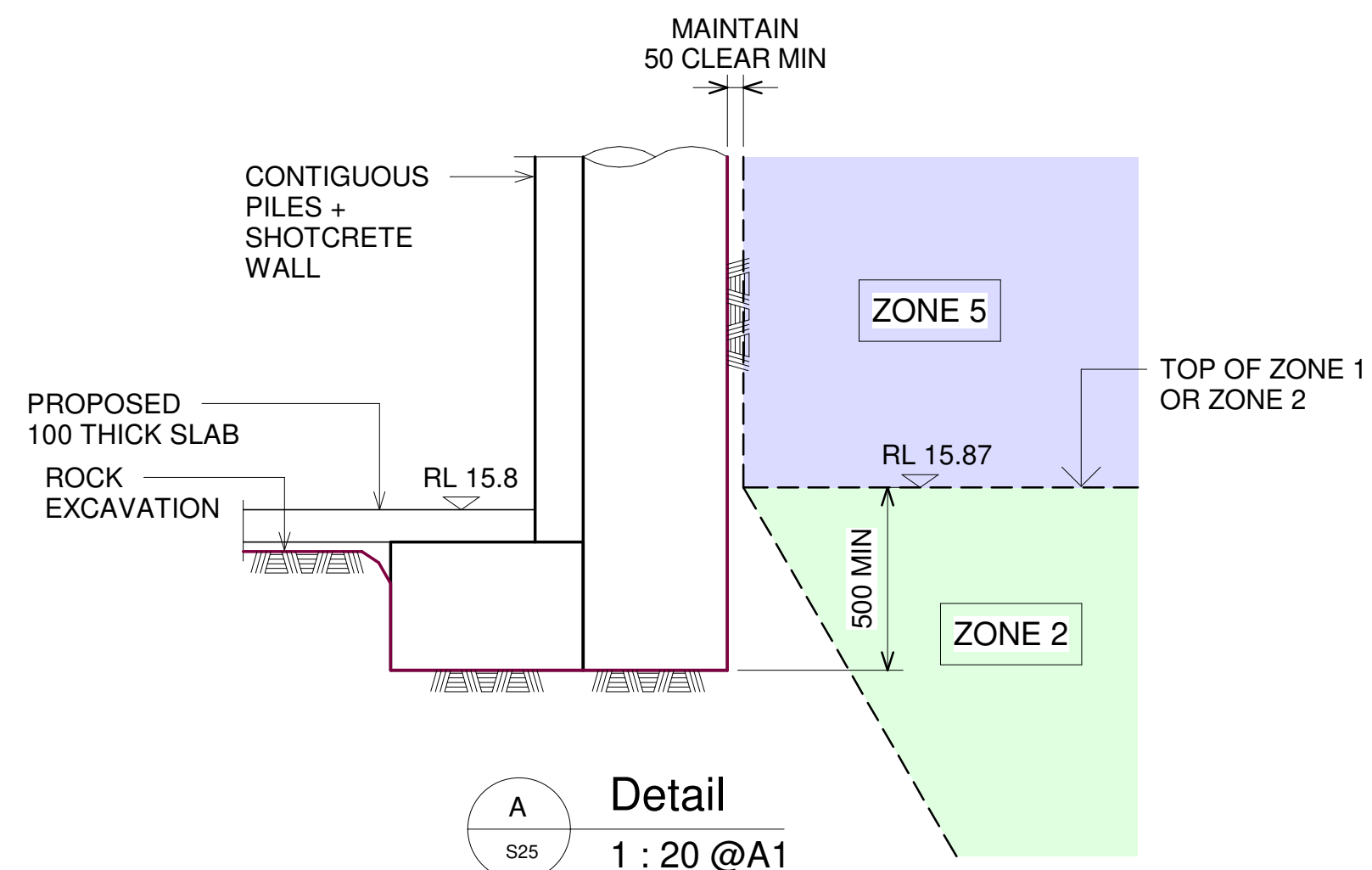

A Detail
S25 1 : 20 @A1

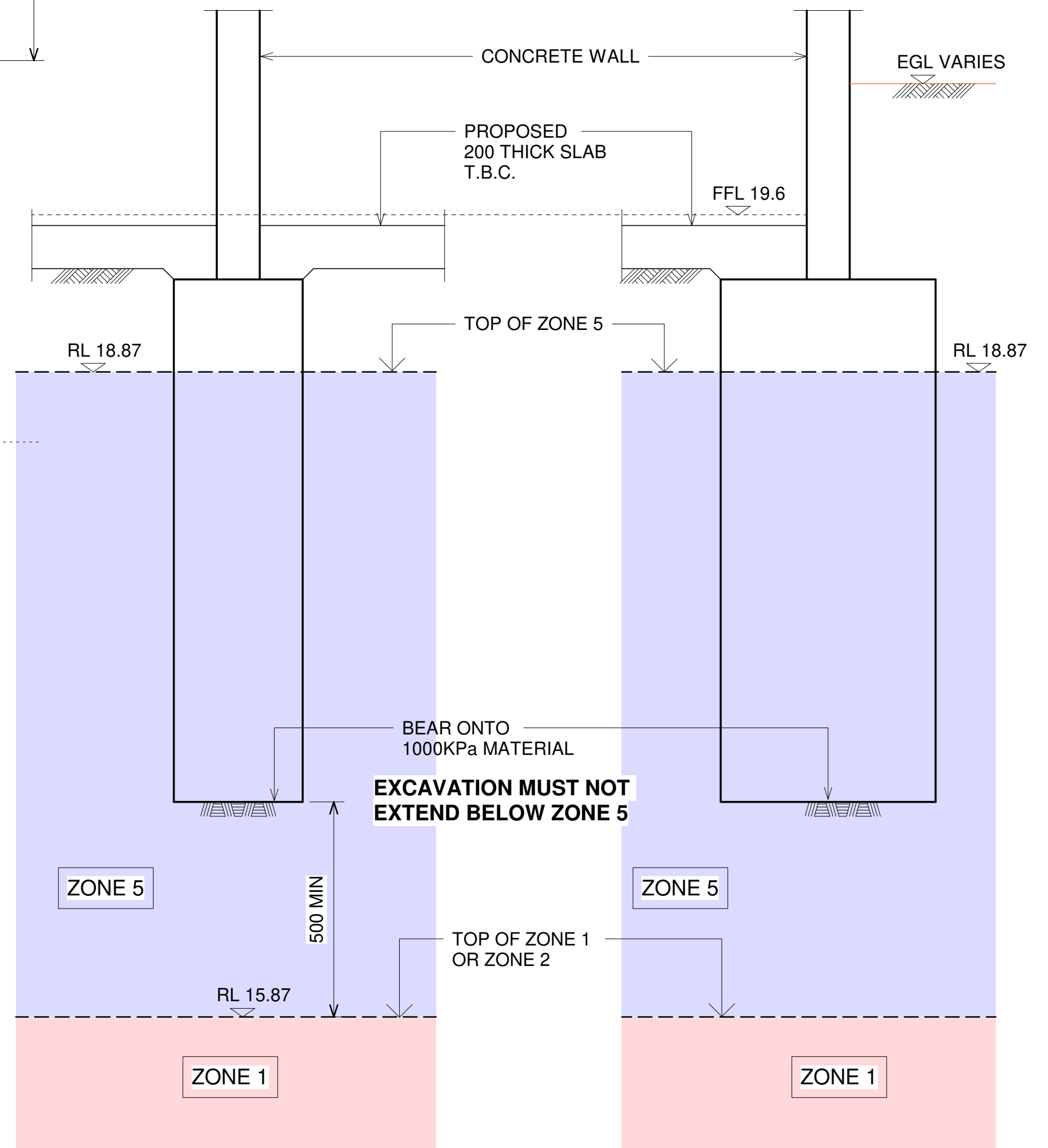

B Detail
S25 1 : 20 @A1

HL	R.Y.	FOR DA	14.09.2022	A	REV
BY	CHKD	DESCRIPTION	DATE		

ARCHITECT
MARK SHAPIRO ARCHITECTS
markshapiro.com.au
EMAIL mark@markshapiro.com.au
PHONE 0421 996 467

CLIENT
EG FUNDS MANAGEMENT
ADDRESS
LEVEL 21, GOVERNOR PHILLIP TOWER,
1 FARRER PLACE, SYDNEY, 2000

PROJECT
PROPOSED CO-LIVING DEVELOPMENT
175-177 CLEVELAND ST & 6-8 WOODBURN ST, REDFERN
SECTION 1

James Taylor & Associates
Civil & Structural Consulting Engineers
SUITE 301, 115 MILITARY ROAD NEUTRAL BAY NSW 2089
A.B.N. 33 102 603 558
TEL: 02 99691999 EMAIL: mail@jamestaylorassociates.com.au
COPYRIGHT: THIS DESIGN AND PLANS ARE NOT TO BE USED OR REPRODUCED WHOLLY OR IN PART WITHOUT WRITTEN PERMISSION FROM JAMES TAYLOR AND ASSOCIATES

DESIGN	RY	DRAWN	HL	PROJECT NO.
CHKD.				6394
APPRD.				DRAWING NO.
SCALE As indicated	DATE			S25
				REV
				A

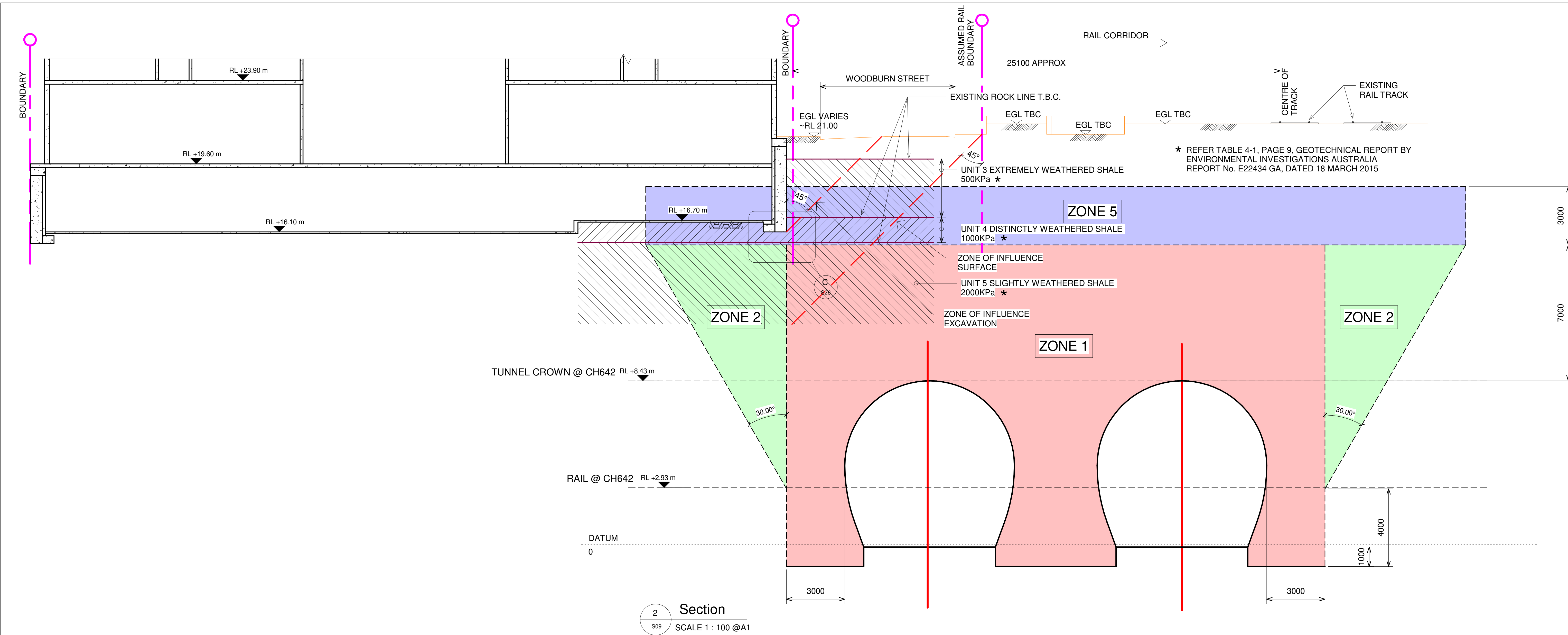

- ZONE 1 EXCAVATIONS, STRUCTURES NOT PERMITTED
- ZONE 2 VERTICAL LOADING NOT ALLOWED
- ZONE 5 3000kN/m² OVER 3x3m MAX (3000KPa) AND 1000kN/m² OVER 10x10m MAX (1000KPa)

TUNNEL LEVELS AND ALIGNMENT SOURCED FROM DRAWING 482749-280 VER 1
TITLED: 175-177 CLEVELAND ST & 1-5 WOODBURN ST. CBD RAIL LINK (CBDRL).
ASSUMED TRACK & TUNNEL ALIGNMENT.
BY HALCROW PACIFIC PTY LTD
DATED 27.05.16

LOADING ZONES AND TUNNEL PROFILES SOURCED FROM DRAWING 482749-281
VER 1
TITLED: 175-177 CLEVELAND ST & 1-5 WOODBURN ST. CBD RAIL LINK (CBDRL).
LOADING REQUIREMENTS.
BY HALCROW PACIFIC PTY LTD
DATED 27.05.16

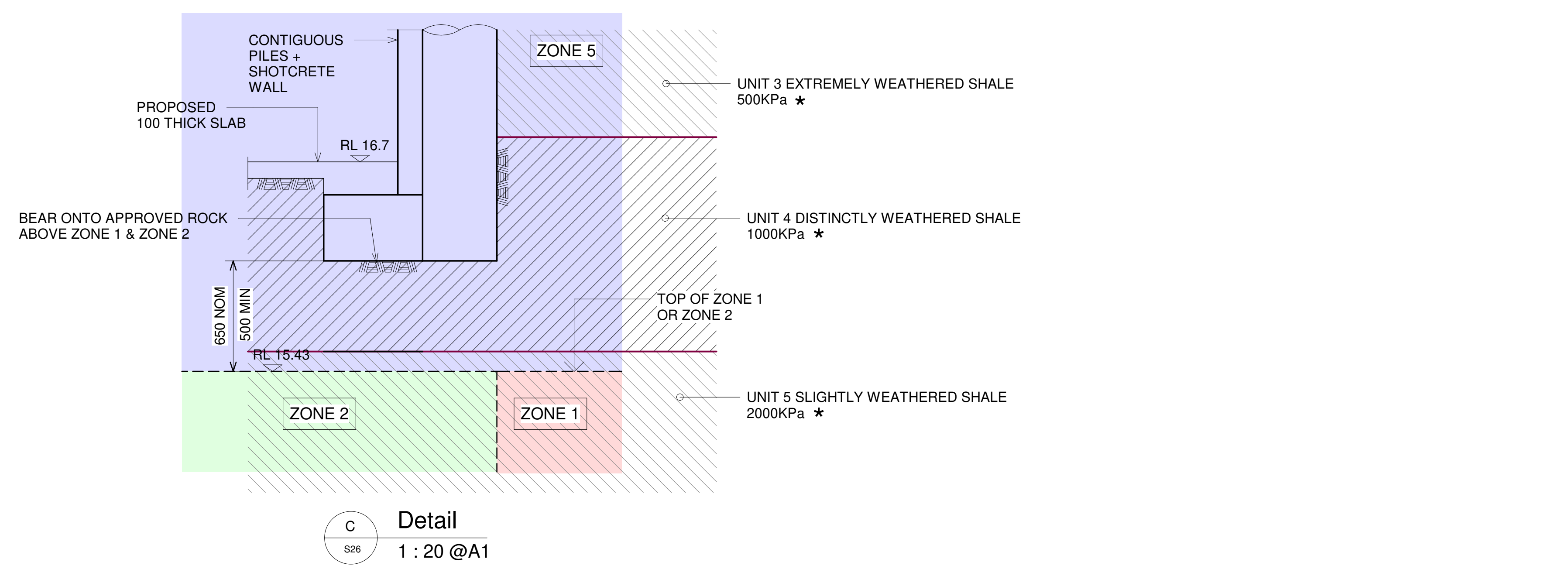

				ARCHITECT		CLIENT		PROJECT		James Taylor & Associates		DESIGN		RY		DRAWN		HL		PROJECT NO.	
				MARK SHAPIRO ARCHITECTS		EG FUNDS MANAGEMENT		PROPOSED CO-LIVING DEVELOPMENT		Civil & Structural Consulting Engineers										6394	
				markshapiro.com.au		ADDRESS		175-177 CLEVELAND ST & 6-8 WOODBURN ST, REDFERN		SUITE 301, 115 MILITARY ROAD NEUTRAL BAY NSW 2089										DRAWING NO.	
				mark@markshapiro.com.au						A.B.N. 33 102 603 558										RE	
				PHONE 0421 996 467		LEVEL 21, GOVERNOR PHILLIP TOWER,		SECTION 2		TEL: 02 99691999		EMAIL: mail@jamestaylorassociates.com.au								SCALE As indicated	
						1 FARRER PLACE, SYDNEY, 2000				COPYRIGHT: THIS DESIGN AND PLANS ARE NOT TO BE USED OR REPRODUCED WHOLLY OR IN PART WITHOUT WRITTEN PERMISSION FROM JAMES TAYLOR AND ASSOCIATES										DATE	
HL				R.Y.		FOR DA														S26	
BY				CHKD		DESCRIPTION		DATE		A		REV								A	