



# BARKER COLLEGE

## 91 Pacific Hwy Hornsby NSW

### LANDSCAPE DOCUMENTATION

#### STAGE 1 DA - NORTHERN PRECINCT

##### SSDA



##### DRAWING REGISTER

Dwg No.	Drawing Title	Scale	Size
LA-DA-00	Cover Page & Drawing Schedule	N/A	A1
LA-DA-01	Introduction & Design Statement		
LA-DA-02	Landscape Precincts - Stage 1		
LA-DA-03	Existing and Proposed Landscape Precincts		
LA-DA-04	Landscape Nodes Diagram		
LA-DA-05	Key Plan - Northern Precinct	1:100	A1
LA-DA-06	Northern Precinct - Circulation Plan - Stage 1	1:100	A1
LA-DA-07	Northern Precinct - Tree Removal Plan	NTS	A1
LA-DA-08	C Block Landscape Plan	1:100	A1
LA-DA-09	The Avenue - Circulation Routes	1:250	A1
LA-DA-10	The Avenue Landscape Plan	1:250	A1
LA-DA-11	Phipps Taylor & Rosewood Landscape Plan	1:500	A1
LA-DA-12	Planting Palette	NTS	A1
LA-DA-13	SRDP Response	NTS	A1
LA-DA-14	SRDP Response	NTS	A1

##### GENERAL NOTES

- \* FOR SSDA ONLY
- \* All tree dimensions and RLs in metres. All other dimensions in mm unless stated otherwise.
- \* Do not scale from drawings. Use figured dimensions only. Larger scale drawings and written dimensions take preference.
- \* All work shall be carried out in accordance with current versions of Australian Standards, BCA and Local Government Regulations.
- \* Structural Details are indicative only and are subject to Structural Engineer's Details and Specifications.
- \* Drainage details are subject to Hydraulic / Civil Engineer's Detail and Specification.
- \* Subbase details including compaction are to Civil and Structural Engineer's Specification.
- \* Lighting Plans are subject to detailed design by a qualified Lighting Consultant or Electrical Contractor.
- \* Water Feature Details are indicative only and are subject to detailed design by a specialist Water Feature designer.
- \* Service location on plans are indicative only. *360 Degrees Landscape Architects Pty Ltd* accepts no responsibility for the accuracy of service locations shown or for services not shown. It is the responsibility of the contractor to determine service locations prior to the commencement of work, including contacting *Dial Before You Dig* and performing on site service locations. Locate and protect all services on site and in adjacent public domain. Any damages to services and associated damages remains the responsibility of the contractor and shall be rectified at no cost to the client or any other party.
- \* All adjoining property elements including but not limited to buildings, walls, trees and paving to be protected. Damaged elements remain the responsibility of the contractor and shall be rectified at no cost to the client or any other party. Existing trees to be retained are to be protected to Council and Project Arborist's requirements. No vehicular traffic, stockpiling or storage of materials within Tree Protection Zones (TPZs).
- \* No responsibility will be taken by *360 Degrees Landscape Architects Pty Ltd* for any variations in design, construction method, materials specified and general specifications without permission from the Project Landscape Architect.
- \* This Drawing is copyright to *360 Degrees Landscape Architects Pty Ltd*.

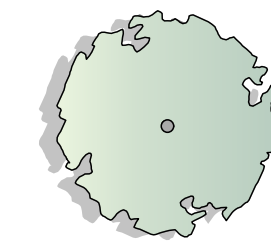
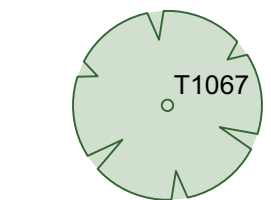
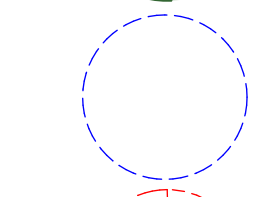
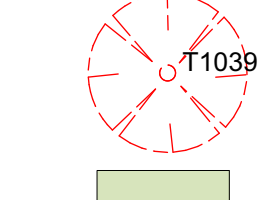
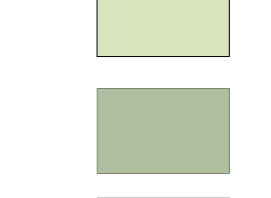
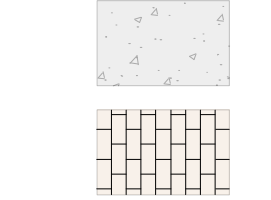
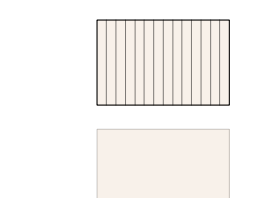
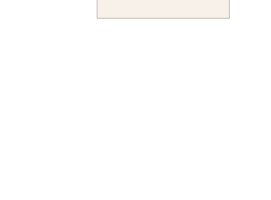
##### LEGEND

-  NEW TREES
-  EXISTING TREES TO BE RETAINED
-  TREE PROTECTION ZONE (TPZ)
-  EXISTING TREES TO BE REMOVED
-  TURF
-  GARDEN BEDS
-  CONCRETE PATH - EXPOSED AGGREGATE
-  PAVERS
-  TIMBER DECKING
-  ACRYLIC SPORTS SURFACE

NOT FOR TENDER OR CONSTRUCTION	Rev	Amendment	Date	By	<b>IMPORTANT NOTES:</b> Do not scale from drawings. All dimensions to be brought to the attention of the Project Landscape Architect. Larger scale drawings and written dimensions take preference. All dimensions in mm unless otherwise stated. All tree dimensions and RLs in metres. Site specific dimensions only. Service locations shall be subject to Engineer's Specifications. Contractors shall locate and protect all services prior to construction. All work shall be carried out in accordance with AS/NZS and Local Government Regulations. Drainage & Water Feature Details shall be subject to Hydraulic Engineer's Specifications. Lighting & Electrical Details shall be subject to Lighting Engineer's Specifications. No responsibility will be taken by 360 Degrees Landscape Architects Pty Ltd for any variations in design, construction method, materials specified and general specifications without permission from the Project Engineer or Landscape Architect. This Drawing is copyright to 360 Degrees Landscape Architects Pty Ltd.	CLIENT Barker College	CHECKED GD	DWG. TITLE <b>Cover Page &amp; Drawing List</b>	PROJECT <b>Barker College</b>	 Level 1, 1 Mary's Place Surry Hills, 2010 P 02 9332 3601 W 360.net.au ABN 90 146 901 322	LA-DA-00
	A	Draft SSDA	27/04/22	GD		ARCHITECT Neeson Murcutt + Neille	DRAWN KR				
	B	Draft SSDA	13/05/22	GD		SCALE N/A	SIZE A1				
	C	SSDA	02/08/22	GD		STAGE SSDA					
	D	SSDA Resubmission	09/09/22	GD							



INTRODUCTION

360 Degrees Landscape Architects have been enagaged by Barker College to prepare a Staged Landscape Masterplan to correspond with the Staged Architectural Masterplan by Neeson Murcutt + Neille. The SSDA project consists of Stage 1 and future masterplan stages across various precincts within the school.

**Stage 1** as outlined on L-DA-02 consists of :

- Block C Walkway
- RB Finlay Walk & The Avenue
- Pedestrian Upgrades to Phipps Taylor and Rosewood Fields

**Future Stages** as outlined on L-DA-12 to L-DA-15 consists of the Landscape Masterplan for:

- Aquatics and Tennis Courts
- Recital Hall

Block C Walkway

The landscape upgrade to Block C includes new marker trees to the east and west of Block C, with new concrete paving, and seating opportunities for social gathering and spectating the sports field.

RB Finlay Walk & The Avenue

The redevelopment of The Avenue is a significant landscape proposal and follows the purchase of the land by Barker College. The objective is to pedestrianise the former street into a shared zone predominantly for students and teachers whilst allowing for maintenance and emergency vehicular access to new and existing buildings. The character of the landscape will extend the language of the recently constructed landscape to the northern facade of Rosewood Sports Centre, tying together new and old buildings along RB Finlay Walk. The resurfaced shared path will extend along RB Finlay Walk to Chapel Drive where it will meet the Block C works, providing a strong east west connection from Block C to the new entrance at Unwins Road.

Pedestrian Upgrades to Phipps Taylor and Rosewood Fields

The pedestrian upgrades to Phipps Taylor and Rosewood Fields involve new paths, stairs, and seating opportunities to improve circulation on a north south axis and provide passive areas for socialisation and spectating sports on Rosewood Field. The path design in Stage 1 is proposed to be extended in the Future Stages to provide pedestrian connections to Aquatics and Tennis, and Recital Hall.

Existing and Proposed Precincts

The planting design will enhance the existing character of the school. As outlined on L-DA-03, the existing plantings create three distinct precincts which intersect:

- Heritage Landscape to the Upper Campus
- Parklands Landscape to the Western Campus
- Bluegum Forest Landscape to the Lower/Eastern Campus

These precincts intersect forming an axis and bicultural landscape through the centre of the school. The use of mixed exotic and native species will enhance this bicultural intersection and strengthen the central campus precincts and spines.

Connecting with Country

A series of nodes has been identified across the campus landscape to be developed for place-based, narrative-driven, visualised learning. These nodes provide settings for the integration of First Nation story-telling in support of Aboriginal ways of learning within a broader curriculum. Refer L-DA-04 and the Architectural Design Report by Neeson Murcutt + Neille.

MASTERPLAN PRINCIPLES

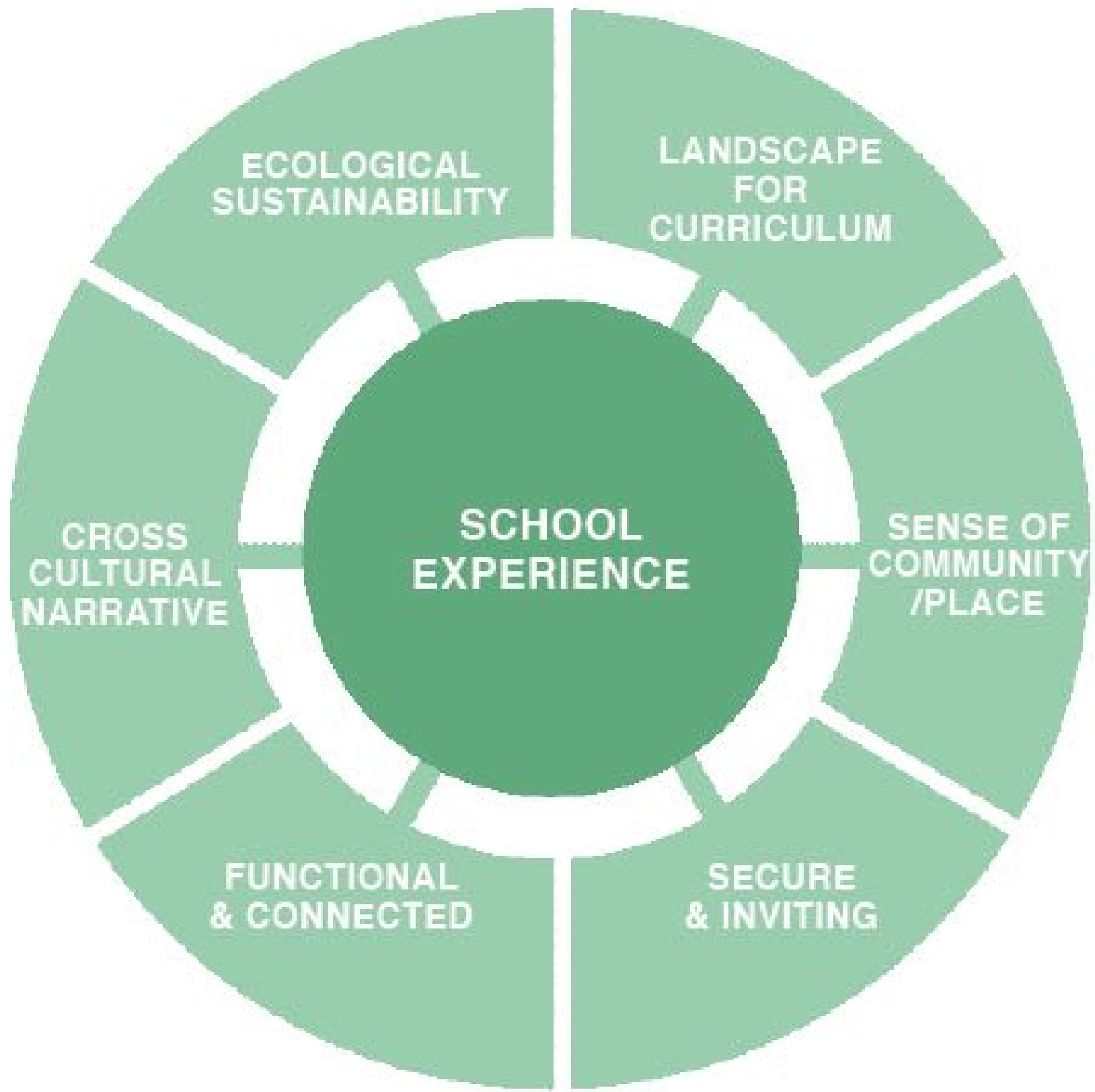

MASTERPLAN STRATEGIES

1

Enhance campus connections by prioritising pedestrian movement and improve wayfinding through activated landscape spines



2

Create adaptive landscape spaces to provide opportunities for learning, social & recreation activities to support building functions and enhance campus facilities



3

Unify existing campus planting characters through the establishment of landscape precincts that respond to campus heritage, endemic vegetation communities & site microclimates



4

Establish sustainable & resilient landscapes while providing learning opportunities within the landscape



5

Respect & enhance campus heritage & First Nations narratives throughout the campus' landscape spaces



<div>NOT FOR TENDER OR CONSTRUCTION</div>	Rev	Amendment	Date	By	<div>IMPORTANT NOTES: Do not scale from drawings. All dimensions to be brought to the attention of the Project Landscape Architect. Landscape drawings are subject to change without notice. All dimensions in mm unless otherwise stated. All new dimensions and R/L in meters. Site layout drawings are subject to the requirements of any applicable laws, regulations and R/L in meters. Contractors shall provide and protect all services prior to construction. All work shall be carried out in accordance with R/L, R/L and Local Government Regulations. Drainage &amp; Water Features shall be subject to Hydrographer's Specifications. All work shall be carried out in accordance with the Project Engineer's Specifications. No responsibility will be taken by 360 Degrees Landscape Architects Pty Ltd for any variance in design, construction, materials, methods and general specifications without permission from the Project Engineer or Landscape Architect. This Drawing is copyright to 360 Degrees Landscape Architects Pty Ltd.</div>	CLIENT Barker College	CHECKED GD	<div>DWG. TITLE Introduction &amp; Design Statement</div> <div>PROJECT Barker College</div>	<div>NEESON MURCUTT + NEILLE Level 1, 1 Mary's Place Surry Hills, 2010 P 02 9332 3601 W 360.net.au ABN 90 146 901 322</div>
	A	Draft SSDA	27/04/22	GD		ARCHITECT Neeson Murcutt + Neille	DRAWN KR		
	B	Draft SSDA	13/05/22	GD					
	C	SSDA	02/08/22	GD					
	D	SSDA Resubmission	09/09/22	GD					







## Existing Landscape Precincts

HERITAGE  
LANDSCAPE

- Upper Campus
- Primarily exotic species, planted in a heritage style consistent with surrounding building age
- Key species: Camellia's, Roses, Azaleas, Rhododendrons, Buxus



PARKLAND  
LANDSCAPE

- Western Campus/Barker Oval
- Trees in parkland style landscape. Avenue plantings
- Key species: Deciduous trees such as Maples, Liquid Ambers, Oaks



BLUEGUM  
FOREST  
LANDSCAPE

- Lower / Eastern Campus
- Primarily endemic native species of Blue Gum High Forest community
- Key species: Blue Gums (*Eucalyptus saligna*) , Forest Oak (*Allocasuarina torulosa*) Lillypilly (*Acmena smithii*) Wonga Wong Vine (*Pandorea pandorana*), Lomandra



## Proposed Landscape Precinct

## BICULTURAL LANDSCAPE

- Unification of existing landscape characters within the central campus precincts & spines
- Mixed exotic & native species with cultural / educational opportunities for learning landscapes
- Key species: Banksias, Waratahs, Native Grasses, Grass Trees, Roses, Gingko, Lavender

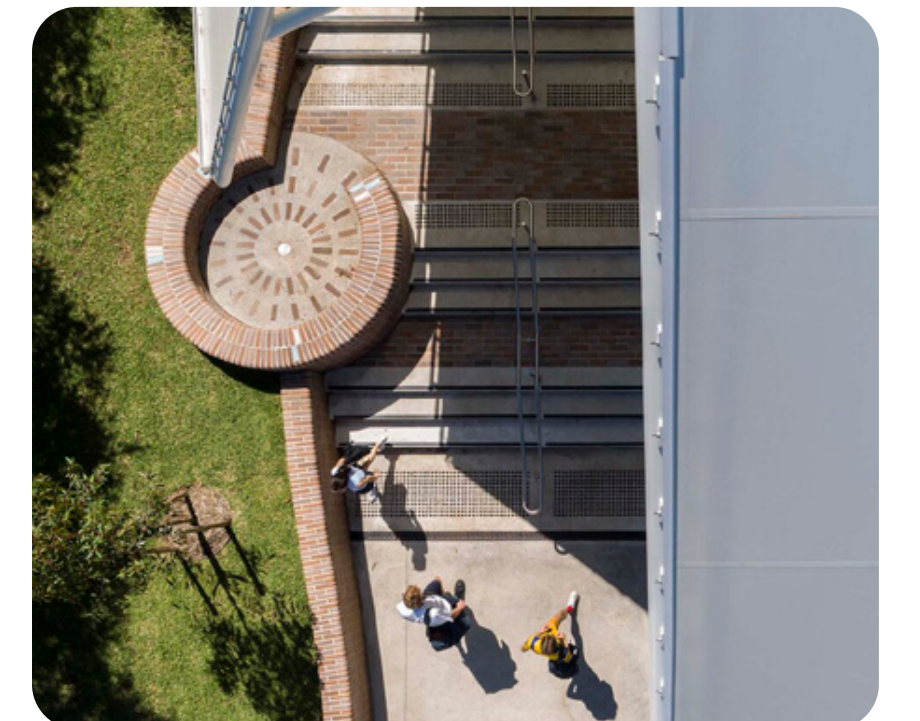

<div style="border: 1px solid black; padding: 5px; text-align: center;"> NOT FOR TENDER OR CONSTRUCTION </div>	Rev	Amendment	Date	By	<b>IMPORTANT NOTES:</b> Do not scale from drawings. All discrepancies to be brought to the attention of the Project Landscape Architect Larger scale drawings and sections otherwise take precedence. All dimensions in mm unless otherwise stated. All dimensions and levels are to be taken from the top of the finished ground level. Use fixed dimensions only. Varying of dimensions is to be taken from the commencement of any works. Contractors must scale and present all services up to construction. All work shall be carried out in accordance with AS/NZS 2204 and all Local Government Regulations. Drawings created and to be signed by the Project Landscape Architect. Drawings & Notes/Extra Details shall be subject to Hydraulic Engineer's Specifications. All work shall be carried out in accordance with Qualified Tradepeople according to Landscape Drainage and Engineer's Specifications. No responsibility will be taken by 360 Degree Landscape Architects Pty Ltd for any variations in design, construction methods, materials specified, and general specifications without permission from the Project Engineer or Landscape Architect. The Project Engineer and Landscape Architect are not responsible for any variations in design, construction methods, materials specified, and general specifications without permission from the Project Engineer or Landscape Architect.	<div> <div>CLIENT</div> <div>Barker College</div> </div> <div> <div>CHECKED</div> <div>GD</div> </div> <div> <div>DWG. TITLE</div> <div>Existing and Proposed Landscape Precincts</div> </div> <div> <div>DRAWN</div> <div>KR</div> </div> <div> <div>PROJECT</div> <div>Barker College</div> </div> <div> <div>SCALE</div> <div>N/A</div> </div> <div> <div>SIZE</div> <div>A1</div> </div> <div> <div>STAGE</div> <div>SSDA</div> </div>	<div> <div>NEESON MURCUTT &amp; NEILLE</div> <div>Level 1, 1 Mary's Place Surrey Hills, 2010</div> <div> <div>P 02 9332 3601</div> <div>W 3601.mel.au</div> <div>ABN 90 146 901 322</div> </div> </div> <div> <div>360°</div> <div>LA-DA-03</div> </div>
	A	Draft SSDA	27/04/22	GD			
	B	Draft SSDA	13/05/22	GD			
	C	SSDA	02/08/22	GD			
	D	SSDA Resubmission	09/09/22	GD			





Possible Nodes:

1. Mint Gates – primary Barker address on Pacific Highway: *ancient Aboriginal track*
2. Chapel forecourt: *spiritual centre of Barker College*
3. Eastern end of new C-Block walk: *new landscape space at intersection of primary north-south + east-west pathways*
4. Western end of new C-Block walk: *new landscape space*
5. The Soundstage: *a loved school community meeting place*
6. Front of Music: *new landscape space*
7. Front of Maths: *new landscape space*
8. The Avenue between main entries to Rosewood + Centenary Design Centre: *top of the ridge*
9. Rosewood Fields: *new landscape space*
10. Memorial Oval: *a loved school community place*
11. Chapel Drive south: *within landscape looking north*
12. Aquatics forecourt: *on lower part of core campus*
13. Recital forecourt: *South of Clarke Road arrival space*

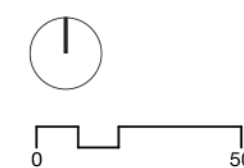

NEESON MURCUTT + NEILLE

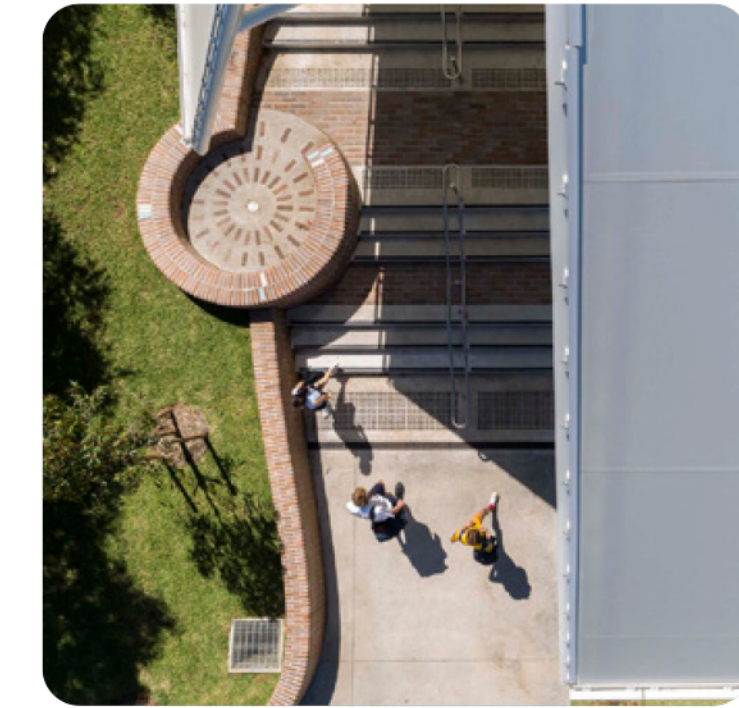

Yarning circles for social & learning gathering



Landscapes for learning



## Material & form expression



Places for ceremony or reflection

source: 360 DEGREES LANDSCAPE

NOT FOR TENDER OR CONSTRUCTION	Rev	Amendment	Date	By	<div>IMPORTANT NOTES:</div> <div>Do not scale from drawings.</div> <div>All dimensions to be brought to the attention of the Project Landscape Architect</div> <div>Larger scale drawings and sections otherwise take precedence. All dimensions in mm unless otherwise stated.</div> <div>All measurements are to face.</div> <div>Use rounded dimensions only.</div> <div>Varying dimensions do not indicate the commencement of any works.</div> <div>Contractors must locate and protect all services prior to construction.</div> <div>All work shall be carried out in accordance with AS/NZS 2209 and Local Council Government Regulations.</div> <div>Drawings created by the project Engineer or Landscaper.</div> <div>Drainage &amp; Water Feature Details shall be subject to Hydraulic Engineer's Specifications.</div> <div>All work shall be completed in accordance with Qualified Tradesperson according to landscape Design and Engineer's Specifications.</div> <div>No responsibility will be taken by 360 Degree Landscape Architects Pty Ltd for any variations in design, construction method, materials specified, and general specifications without permission from the Project Engineer or Landscape Architect.</div> <div>The client accepts responsibility for the accuracy of the information provided.</div>	CLIENT	CHECKED	DWG. TITLE	NEESON MURCUTT + NEILLE	<div>360°</div> <div>Level 1, 1 Mary's Place</div> <div>Surry Hills, 2010</div> <div>P 02 9332 3601</div> <div>W 360.net.au</div> <div>ABN 90 146 901 322</div>	LA-DA-04		
	A	SSDA	02/08/22	GD		Barker College	GD					Landscape Nodes Diagram	
	B	SSDA Resubmission	09/09/22	GD		ARCHITECT	DRAWN						
						Neeson Murcutt + Neille	KR						
						SCALE	SIZE						STAGE
						N/A	A1						SSDA







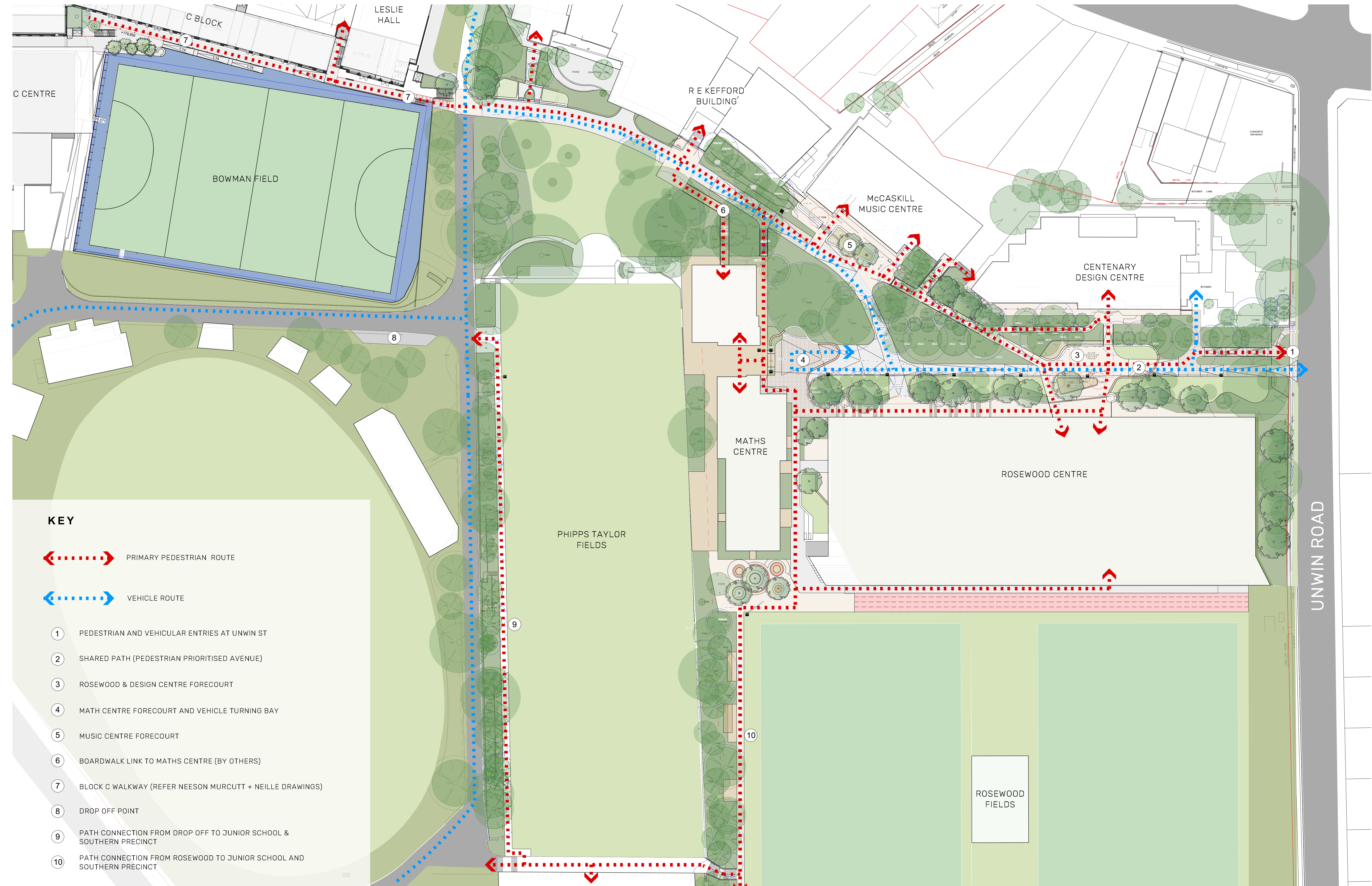

Rev	Amendment	Date	By
A	Draft SSDA	27/04/22	GD
B	Draft SSDA	13/05/22	GD
C	SSDA	02/08/22	GD
D	SSDA Resubmission	09/09/22	GD

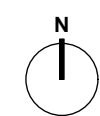

**IMPORTANT NOTES:**

- Do not scale from drawings
- All discrepancies to be brought to the attention of the Project Landscape Architect
- Large scale drawings and all other dimensions take preference. All dimensions in small letters otherwise stated
- Use standard dimensions and R/Ls as follows.
- Use specified dimensions only
- Verify all dimensions on site before the commencement of any work
- Contractors shall locate and protect all services prior to construction.
- All work shall be carried out in accordance with ASA, BCA and Local Government Regulations.
- Structural Details shall be subject to Engineer's Specifications
- Drainage & Water Feature Details shall be subject to Hydraulic Engineer's Specifications.
- All work shall be carried out in a professional manner by Qualified Tradesperson according to Landscape Drawings.
- No responsibility will be taken by 360 Degrees Landscape Architects Pty Ltd for any variations in design, cost, methods, materials specified, and general specifications without permission from the Engineer or Landscaper.

CLIENT <b>Barker College</b>	
ARCHITECT <b>Neeson Murcutt + Neille</b>	
SCALE <b>1:500</b>	SIZE <b>A1</b>

CHECKED	GD
DRAWN	KR
STAGE	SSDA

DWG. TITLE  
**Northern Precinct - Circulation Plan - Stage 1**

PROJECT  
**Barker College**











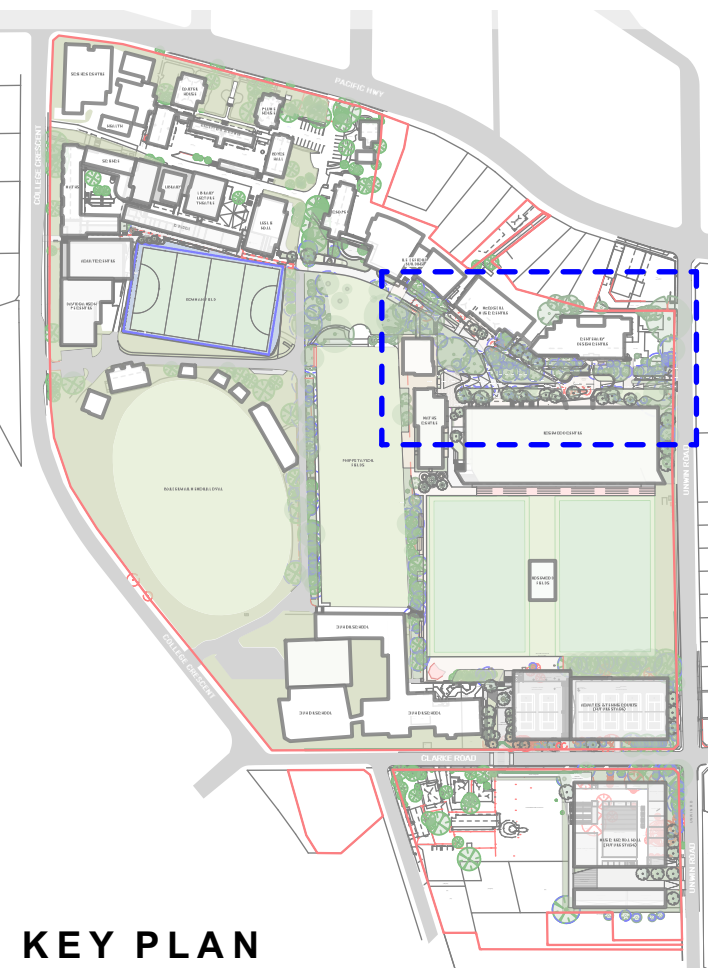
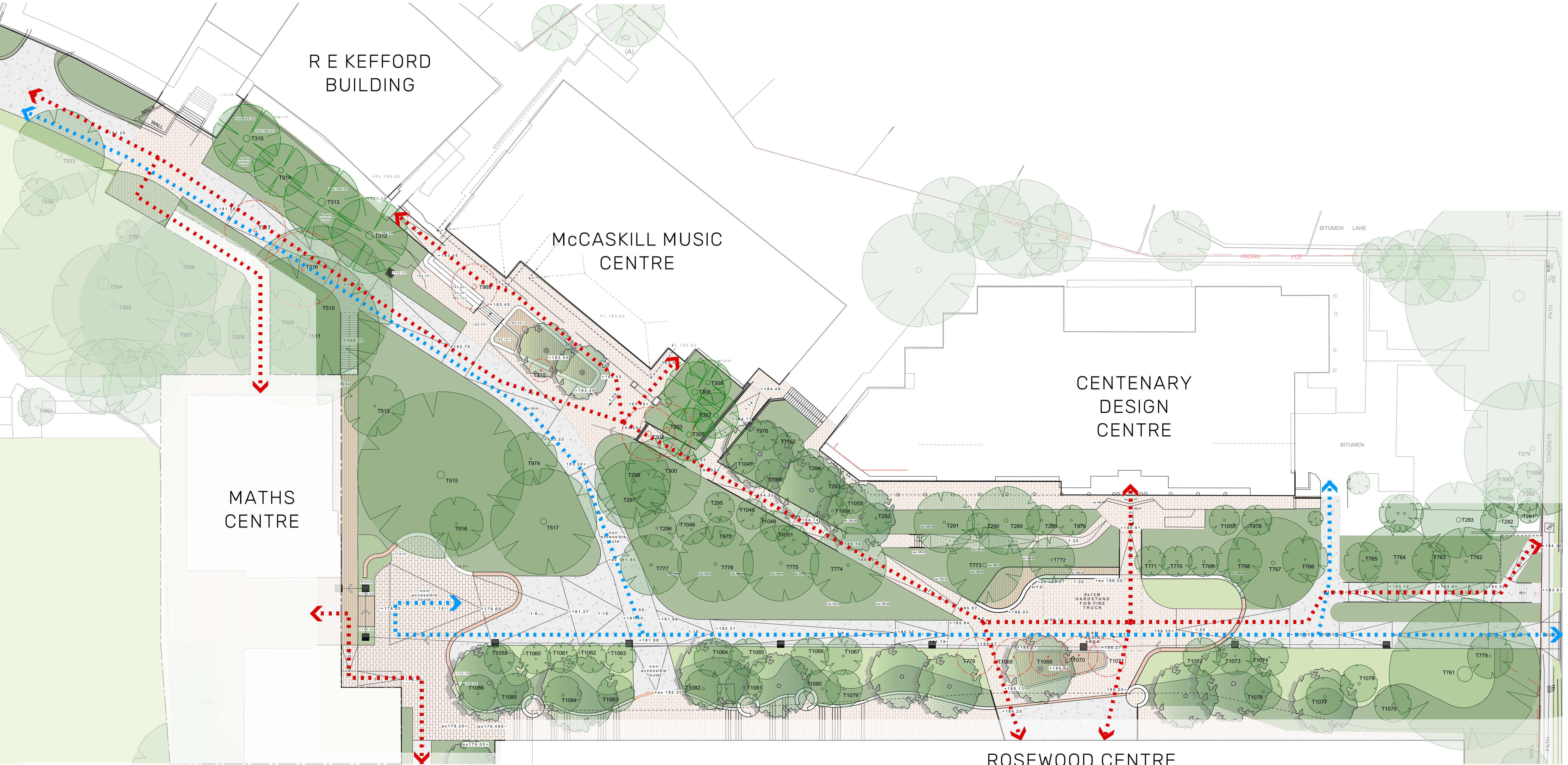

KEY PLAN

KEY

DDA COMPLIANT PEDESTRIAN ROUTE

MAINTENANCE AND EMERGENCY VEHICLE ROUTE

NOT FOR TENDER OR CONSTRUCTION	Rev	Amendment	Date	By		<p><b>IMPORTANT NOTES:</b></p> <p>Do not scale from drawings.</p> <p>All dimensions are to be shown to the attention of the Project Landscape Architect.</p> <p>Larger scale drawings and profiles show dimensions (see preference). All dimensions in mm unless otherwise stated.</p> <p>All new dimensions and 80% in metres.</p> <p>Use Imperial dimensions only.</p> <p>Profile dimensions are relative to the datum of any datum.</p> <p>Contractors must locate and protect all services prior to construction.</p> <p>All work shall be carried out in accordance with AS/NZS 3600 and Local Government Regulations.</p> <p>Structural Details shall be subject to Engineer's Specifications.</p> <p>For further information please refer to the relevant drawings.</p> <p>All work shall be carried out in a professional manner by Qualified Tradespeople according to Landscape Drawings and Engineer's Specifications.</p> <p>Responsibility will be taken by 360 Degree Landscape Architects Pty Ltd for any variations in design, construction method, materials specified, and general specifications without permission from the Project Engineer or Landscape Architect.</p> <p>This Drawing is copyright to 360 Degree Landscape Architects Pty Ltd</p>	CLIENT	Barker College	CHECKED	GD	DWG. TITLE	The Avenue - Circulation Routes	NEESON MURCUTT + NEILLE		Level 1, 1 Mary's Place Surry Hills, 2010	P 02 9332 3601 W 360.net.au ABN 90 146 901 322	LA-DA-09		
	A	Draft SSDA	27/04/22	GD			ARCHITECT	Neeson Murcutt + Neille	DRAWN	KR								PROJECT	Barker College
	B	Draft SSDA	13/05/22	GD			SCALE	1:250	SIZE	A1									
	C	SSDA	02/08/22	GD			SSDA												
	D	SSDA Resubmission	09/09/22	GD															



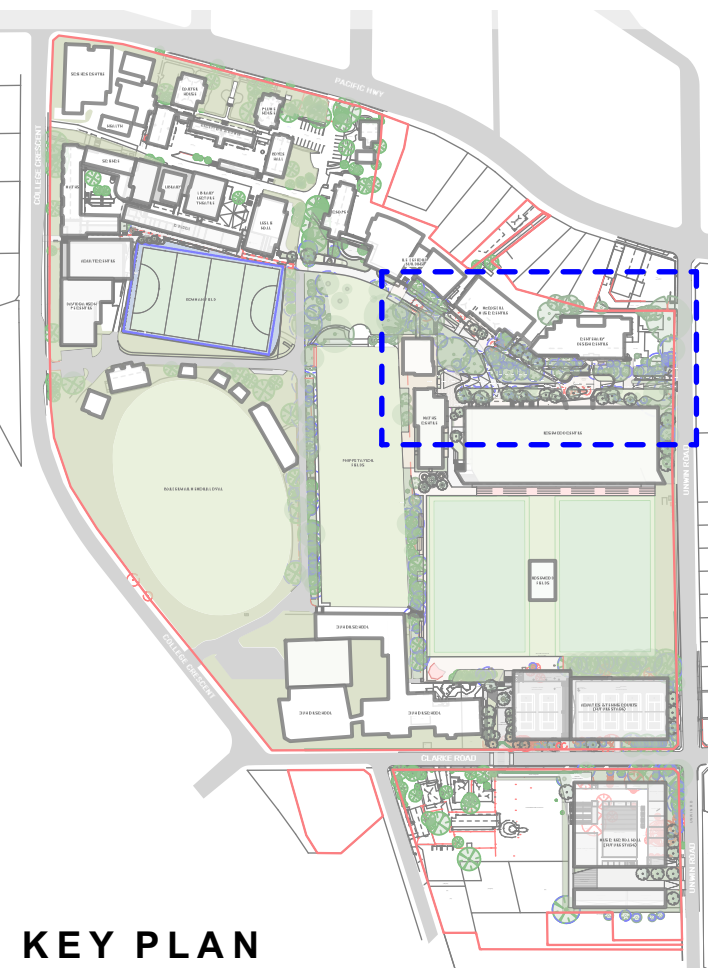

KEY PLAN



<div>NOT FOR TENDER OR CONSTRUCTION</div>	Rev	Amendment	Date	By	<div><div><div><div><div></div><div></div></div><div><div></div><div></div></div></div><div><div></div><div></div></div><div><div></div><div></div></div><div><div></div><div></div></div><div><div></div><div></div></div><div><div></div><div></div></div><div><div></div><div></div></div><div><div></div><div></div></div><div><div></div><div></div></div><div><div></div><div></div></div><div><div></div><div></div></div><div><div></div><div></div></div><div><div></div><div></div></div><div><div></div><div></div></div><div><div></div><div></div></div><div><div></div><div></div></div><div><div></div><div></div></div><div><div></div><div></div></div><div><div></div><div></div></div><div><div></div><div></div></div><div><div></div><div></div></div><div><div></div><div></div></div><div><div></div><div></div></div><div><div></div><div></div></div><div><div></div><div></div></div><div><div></div><div></div></div><div><div></div><div></div></div><div><div></div><div></div></div><div><div></div><div></div></div><div><div></div><div></div></div><div><div></div><div></div></div><div><div></div><div></div></div><div><div></div><div></div></div><div><div></div><div></div></div><div><div></div><div></div></div><div><div></div><div></div></div><div><div></div><div></div></div><div><div></div><div></div></div><div><div></div><div></div></div><div><div></div><div></div></div><div><div></div><div></div></div><div><div></div><div></div></div><div><div></div><div></div></div><div><div></div><div></div></div><div><div></div><div></div></div><div><div></div><div></div></div><div><div></div><div></div></div><div><div></div><div></div></div><div><div></div><div></div></div><div><div></div><div></div></div><div><div></div><div></div></div><div><div></div><div></div></div><div><div></div><div></div></div><div><div></div><div></div></div><div><div></div><div></div></div><div><div></div><div></div></div><div><div></div><div></div></div><div><div></div><div></div></div><div><div></div><div></div></div><div><div></div><div></div></div><div><div></div><div></div></div><div><div></div><div></div></div><div><div></div><div></div></div><div><div></div><div></div></div><div><div></div><div></div></div><div><div></div><div></div></div><div><div></div><div></div></div><div><div></div><div></div></div><div><div></div><div></div></div><div><div></div><div></div></div><div><div></div><div></div></div><div><div></div><div></div></div><div><div></div><div></div></div><div><div></div><div></div></div><div><div></div><div></div></div><div><div></div><div></div></div><div><div></div><div></div></div><div><div></div><div></div></div><div><div></div><div></div></div><div><div></div><div></div></div><div><div></div><div></div></div><div><div></div><div></div></div><div><div></div><div></div></div><div><div></div><div></div></div><div><div></div><div></div></div><div><div></div><div></div></div><div><div></div><div></div></div><div><div></div><div></div></div><div><div></div><div></div></div><div><div></div><div></div></div><div><div></div><div></div></div><div><div></div><div></div></div><div><div></div><div></div></div><div><div></div><div></div></div><div><div></div><div></div></div><div><div></div><div></div></div><div><div></div><div></div></div><div><div></div><div></div></div><div><div></div><div></div></div><div><div></div><div></div></div><div><div></div><div></div></div><div><div></div><div></div></div><div><div></div><div></div></div><div><div></div><div></div></div><div><div></div><div></div></div><div><div></div><div></div></div><div><div></div><div></div></div><div><div></div><div></div></div><div><div></div><div></div></div><div><div></div><div></div></div><div><div></div><div></div></div><div><div></div><div></div></div><div><div></div><div></div></div><div><div></div><div></div></div><div><div></div><div></div></div><div><div></div><div></div></div><div><div></div><div></div></div><div><div></div><div></div></div><div><div></div><div></div></div><div><div></div><div></div></div><div><div></div><div></div></div><div><div></div><div></div></div><div><div></div><div></div></div><div><div></div><div></div></div><div><div></div><div></div></div><div><div></div><div></div></div><div><div></div><div></div></div><div><div></div><div></div></div><div><div></div><div></div></div><div><div></div><div></div></div><div><div></div><div></div></div><div><div></div><div></div></div><div><div></div><div></div></div><div><div></div><div></div></div><div><div></div><div></div></div><div><div></div><div></div></div><div><div></div><div></div></div><div><div></div><div></div></div><div><div></div><div></div></div><div><div></div><div></div></div><div><div></div><div></div></div><div><div></div><div></div></div><div><div></div><div></div></div><div><div></div><div></div></div><div><div></div><div></div></div><div><div></div><div></div></div><div><div></div><div></div></div><div><div></div><div></div></div><div><div></div><div></div></div><div><div></div><div></div></div><div><div></div><div></div></div><div><div></div><div></div></div><div><div></div><div></div></div><div><div></div><div></div></div><div><div></div><div></div></div><div><div></div><div></div></div><div><div></div><div></div></div><div><div></div><div></div></div><div><div></div><div></div></div><div><div></div><div></div></div><div><div></div><div></div></div><div><div></div><div></div></div><div><div></div><div></div></div><div><div></div><div></div></div><div><div></div><div></div></div><div><div></div><div></div></div><div><div></div><div></div></div><div><div></div><div></div></div><div><div></div><div></div></div><div><div></div><div></div></div><div><div></div><div></div></div><div><div></div><div></div></div><div><div></div><div></div></div><div><div></div><div></div></div><div><div></div><div></div></div><div><div></div><div></div></div><div><div></div><div></div></div><div><div></div><div></div></div><div><div></div><div></div></div><div><div></div><div></div></div><div><div></div><div></div></div><div><div></div><div></div></div><div><div></div><div></div></div><div><div></div><div></div></div><div><div></div><div></div></div><div><div></div><div></div></div><div><div></div><div></div></div><div><div></div><div></div></div><div><div></div><div></div></div><div><div></div><div></div></div><div><div></div><div></div></div><div><div></div><div></div></div><div><div></div><div></div></div><div><div></div><div></div></div><div><div></div><div></div></div><div><div></div><div></div></div><div><div></div><div></div></div><div><div></div><div></div></div><div><div></div><div></div></div><div><div></div><div></div></div><div><div></div><div></div></div><div><div></div><div></div></div><div><div></div><div></div></div><div><div></div><div></div></div><div><div></div><div></div></div><div><div></div><div></div></div><div><div></div><div></div></div><div><div></div><div></div></div><div><div></div><div></div></div><div><div></div><div></div></div><div><div></div><div></div></div><div><div></div><div></div></div><div><div></div><div></div></div><div><div></div><div></div></div><div><div></div><div></div></div><div><div></div><div></div></div><div><div></div><div></div></div><div><div></div><div></div></div><div><div></div><div></div></div><div><div></div><div></div></div><div><div></div><div></div></div><div><div></div><div></div></div><div><div></div><div></div></div><div><div></div><div></div></div><div><div></div><div></div></div><div><div></div><div></div></div><div><div></div><div></div></div><div><div></div><div></div></div><div><div></div><div></div></div><div><div></div><div></div></div><div><div></div><div></div></div><div><div></div><div></div></div><div><div></div><div></div></div><div><div></div><div></div></div><div><div></div><div></div></div><div><div></div><div></div></div><div><div></div><div></div></div><div><div></div><div></div></div><div><div></div><div></div></div><div><div></div><div></div></div><div><div></div><div></div></div><div><div></div><div></div></div><div><div></div><div></div></div><div><div></div><div></div></div><div><div></div><div></div></div><div><div></div><div></div></div><div><div></div><div></div></div><div><div></div><div></div></div><div><div></div><div></div></div><div><div></div><div></div></div><div><div></div><div></div></div><div><div></div><div></div></div><div><div></div><div></div></div><div><div></div><div></div></div><div><div></div><div></div></div><div><div></div><div></div></div><div><div></div><div></div></div><div><div></div><div></div></div><div><div></div><div></div></div><div><div></div><div></div></div><div><div></div><div></div></div><div><div></div><div></div></div><div><div></div><div></div></div><div><div></div><div></div></div><div><div></div><div></div></div><div><div></div><div></div></div><div><div></div><div></div></div><div><div></div><div></div></div><div><div></div><div></div></div><div><div></div><div></div></div><div><div></div><div></div></div><div><div></div><div></div></div><div><div></div><div></div></div><div><div></div><div></div></div><div><div></div><div></div></div><div><div></div><div></div></div><div><div></div><div></div></div><div><div></div><div></div></div><div><div></div><div></div></div><div><div></div><div></div></div><div><div></div><div></div></div><div><div></div><div></div></div><div><div></div><div></div></div><div><div></div><div></div></div><div><div></div><div></div></div><div><div></div><div></div></div><div><div></div><div></div></div><div><div></div><div></div></div><div><div></div><div></div></div><div><div></div><div></div></div><div><div></div><div></div></div><div><div></div><div></div></div><div><div></div><div></div></div><div><div></div><div></div></div><div><div></div><div></div></div><div><div></div><div></div></div><div><div></div><div></div></div><div><div></div><div></div></div><div><div></div><div></div></div><div><div></div><div></div></div><div><div></div><div></div></div><div><div></div><div></div></div><div><div></div><div></div></div><div><div></div><div></div></div><div><div></div><div></div></div><div><div></div><div></div></div><div><div></div><div></div></div><div><div></div><div></div></div><div><div></div><div></div></div><div><div></div><div></div></div><div><div></div><div></div></div><div><div></div><div></div></div><div><div></div><div></div></div><div><div></div><div></div></div><div><div></div><div></div></div><div><div></div><div></div></div><div><div></div><div></div></div><div><div></div><div></div></div><div><div></div><div></div></div><div><div></div><div></div></div><div><div></div><div></div></div><div><div></div><div></div></div><div><div></div><div></div></div><div><div></div><div></div></div><div><div></div><div></div></div><div><div></div><div></div></div><div><div></div><div></div></div><div><div></div><div></div></div><div><div></div><div></div></div><div><div></div><div></div></div><div><div></div><div></div></div><div><div></div><div></div></div><div><div></div><div></div></div><div><div></div><div></div></div><div><div></div><div></div></div><div><div></div><div></div></div><div><div></div><div></div></div><div><div></div><div></div></div><div><div></div><div></div></div><div><div></div><div></div></div><div><div></div><div></div></div><div><div></div><div></div></div><div><div></div><div></div></div><div><div></div><div></div></div><div><div></div><div></div></div><div><div></div><div></div></div><div><div></div><div></div></div><div><div></div><div></div></div><div><div></div><div></div></div><div><div></div><div></div></div><div><div></div><div></div></div><div><div></div><div></div></div><div><div></div><div></div></div><div><div></div><div></div></div><div><div></div><div></div></div><div><div></div><div></div></div><div><div></div><div></div></div><div><div></div><div></div></div><div><div></div><div></div></div><div><div></div><div></div></div><div><div></div><div></div></div><div><div></div><div></div></div><div><div></div><div></div></div><div><div></div><div></div></div><div><div></div><div></div></div><div><div></div><div></div></div><div><div></div><div></div></div><div><div></div><div></div></div><div><div></div><div></div></div><div><div></div><div></div></div><div><div></div><div></div></div><div><div></div><div></div></div><div><div></div>&lt;</div></div></div>
-------------------------------------------	-----	-----------	------	----	----------------------------------------------------------------------------------------------------------------------------------------------------------------------------------------------------------------------------------------------------------------------------------------------------------------------------------------------------------------------------------------------------------------------------------------------------------------------------------------------------------------------------------------------------------------------------------------------------------------------------------------------------------------------------------------------------------------------------------------------------------------------------------------------------------------------------------------------------------------------------------------------------------------------------------------------------------------------------------------------------------------------------------------------------------------------------------------------------------------------------------------------------------------------------------------------------------------------------------------------------------------------------------------------------------------------------------------------------------------------------------------------------------------------------------------------------------------------------------------------------------------------------------------------------------------------------------------------------------------------------------------------------------------------------------------------------------------------------------------------------------------------------------------------------------------------------------------------------------------------------------------------------------------------------------------------------------------------------------------------------------------------------------------------------------------------------------------------------------------------------------------------------------------------------------------------------------------------------------------------------------------------------------------------------------------------------------------------------------------------------------------------------------------------------------------------------------------------------------------------------------------------------------------------------------------------------------------------------------------------------------------------------------------------------------------------------------------------------------------------------------------------------------------------------------------------------------------------------------------------------------------------------------------------------------------------------------------------------------------------------------------------------------------------------------------------------------------------------------------------------------------------------------------------------------------------------------------------------------------------------------------------------------------------------------------------------------------------------------------------------------------------------------------------------------------------------------------------------------------------------------------------------------------------------------------------------------------------------------------------------------------------------------------------------------------------------------------------------------------------------------------------------------------------------------------------------------------------------------------------------------------------------------------------------------------------------------------------------------------------------------------------------------------------------------------------------------------------------------------------------------------------------------------------------------------------------------------------------------------------------------------------------------------------------------------------------------------------------------------------------------------------------------------------------------------------------------------------------------------------------------------------------------------------------------------------------------------------------------------------------------------------------------------------------------------------------------------------------------------------------------------------------------------------------------------------------------------------------------------------------------------------------------------------------------------------------------------------------------------------------------------------------------------------------------------------------------------------------------------------------------------------------------------------------------------------------------------------------------------------------------------------------------------------------------------------------------------------------------------------------------------------------------------------------------------------------------------------------------------------------------------------------------------------------------------------------------------------------------------------------------------------------------------------------------------------------------------------------------------------------------------------------------------------------------------------------------------------------------------------------------------------------------------------------------------------------------------------------------------------------------------------------------------------------------------------------------------------------------------------------------------------------------------------------------------------------------------------------------------------------------------------------------------------------------------------------------------------------------------------------------------------------------------------------------------------------------------------------------------------------------------------------------------------------------------------------------------------------------------------------------------------------------------------------------------------------------------------------------------------------------------------------------------------------------------------------------------------------------------------------------------------------------------------------------------------------------------------------------------------------------------------------------------------------------------------------------------------------------------------------------------------------------------------------------------------------------------------------------------------------------------------------------------------------------------------------------------------------------------------------------------------------------------------------------------------------------------------------------------------------------------------------------------------------------------------------------------------------------------------------------------------------------------------------------------------------------------------------------------------------------------------------------------------------------------------------------------------------------------------------------------------------------------------------------------------------------------------------------------------------------------------------------------------------------------------------------------------------------------------------------------------------------------------------------------------------------------------------------------------------------------------------------------------------------------------------------------------------------------------------------------------------------------------------------------------------------------------------------------------------------------------------------------------------------------------------------------------------------------------------------------------------------------------------------------------------------------------------------------------------------------------------------------------------------------------------------------------------------------------------------------------------------------------------------------------------------------------------------------------------------------------------------------------------------------------------------------------------------------------------------------------------------------------------------------------------------------------------------------------------------------------------------------------------------------------------------------------------------------------------------------------------------------------------------------------------------------------------------------------------------------------------------------------------------------------------------------------------------------------------------------------------------------------------------------------------------------------------------------------------------------------------------------------------------------------------------------------------------------------------------------------------------------------------------------------------------------------------------------------------------------------------------------------------------------------------------------------------------------------------------------------------------------------------------------------------------------------------------------------------------------------------------------------------------------------------------------------------------------------------------------------------------------------------------------------------------------------------------------------------------------------------------------------------------------------------------------------------------------------------------------------------------------------------------------------------------------------------------------------------------------------------------------------------------------------------------------------------------------------------------------------------------------------------------------------------------------------------------------------------------------------------------------------------------------------------------------------------------------------------------------------------------------------------------------------------------------------------------------------------------------------------------------------------------------------------------------------------------------------------------------------------------------------------------------------------------------------------------------------------------------------------------------------------------------------------------------------------------------------------------------------------------------------------------------------------------------------------------------------------------------------------------------------------------------------------------------------------------------------------------------------------------------------------------------------------------------------------------------------------------------------------------------------------------------------------------------------------------------------------------------------------------------------------------------------------------------------------------------------------------------------------------------------------------------------------------------------------------------------------------------------------------------------------------------------------------------------------------------------------------------------------------------------------------------------------------------------------------------------------------------------------------------------------------------------------------------------------------------------------------------------------------------------------------------------------------------------------------------------------------







INDICATIVE PLANTING PALETTE





SDRP Comments:	Response
6. Further input from the Landscape Architect is required to illustrate the following: a. A whole of site landscape strategy with landscape principles in alignment with the core campus works and future stage architectural strategy b. Collaboration with the Traditional Custodians illustrating how the living history of the site can be incorporated into the landscape design c. Treatment of the ground plane associated with the elevated C-Block walk 7. Provide details on the treatment of fencing along the eastern and western edges of the site 8. Demonstrate how the interface with the neighbouring streets and private allotments can be improved 9. Indicate measures to increase natural surveillance and minimize the use of electronic surveillance	 Refer L-DA-02, L-DA-03, L-DA-04  Refer L-DA-04 and Architectural Design Report  Refer L-DA-08 Refer L-DA-17 Refer L-DA-18 Refer L-DA-17

## Fencing & Passive Surveillance

### Existing Site Conditions



Existing hedge in front of security fence to Clarke Rd creates a hard edge to the school boundary with limited passive surveillance



Existing boundary treatment on Clarke Road changes from hedges in front of the security fence to trees and underplanting behind the fence



Existing native trees, grasses and sparse small shrubs to Clarke Road near Unwins Road reduces the perceived density of the built form



Rosewood Centre (by NM+360). A 2.1m palisade school security fence on the Unwins Road boundary line with native Blue Gum Forest planting behind



Rosewood Centre, Barker College: Existing and new native trees with mass grasses and clumps of shrubs maintains sightlines and improves passive surveillance. This planting typology softens the bulk form and provides an improved school frontage and interface with the street.



Grasses allowing sightlines into the school

## Fencing & Passive Surveillance

### Landscape Strategies

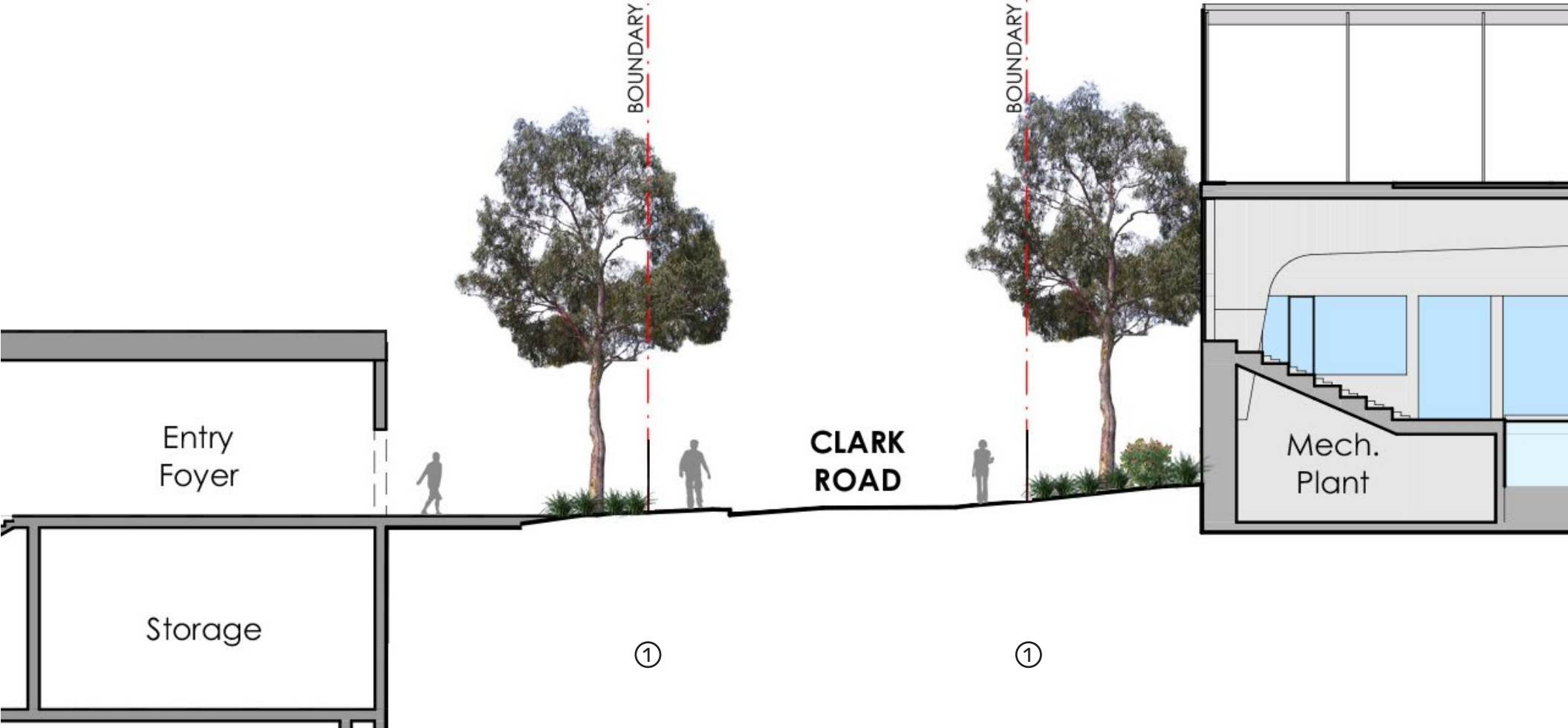
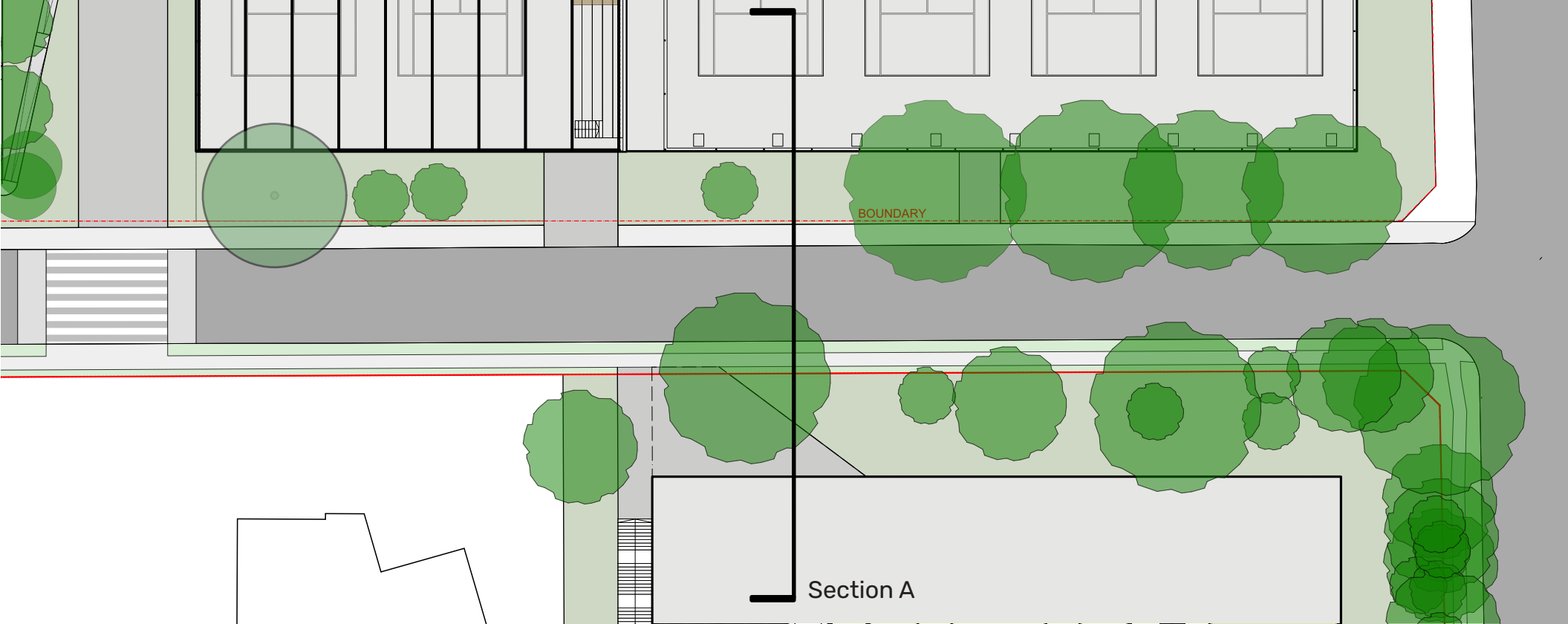

Section A

- ① Palisade school security fence to Clarke Road (typically 2.1m high)  
② Existing Trees underplanted with low grasses and shrubs planted where required for screening but allowing sightlines and natural surveillance

NOT FOR TENDER OR CONSTRUCTION	Rev	Amendment	Date	By	<b>IMPORTANT NOTES:</b> Do not scale from drawings. All dimensions to be checked to the attention of the Project Landscape Architect. Larger scale drawings and sections show dimensions in millimetres. All dimensions in mm unless otherwise stated. All face dimensions and B.S.A. in metres. Site layout dimensions only. Dimensions shown shall be subject to engineering confirmation of any works. Construction shall include and protect all services prior to construction. All work shall be carried out in accordance with B.S.A., B.S.A. and Local Government Regulations. Drainage & Water Features shall be subject to Hydrographer's Specifications. All work shall be carried out in accordance with the Project Engineer's Specifications. Engineering Specifications. No responsibility will be taken by 360 Degrees Landscape Architects Pty Ltd for any variance in design, construction, materials, installation and general maintenance without permission from the Project Engineer or Landscape Architect. The drawings copyright to 360 Degrees Landscape Architects Pty Ltd.	CLIENT Barker College	CHECKED GD	DWG. TITLE <b>SDRP Response</b>  PROJECT <b>Barker College</b>	NEESON MURCUTT + NIELLE  Level 1, 1 Mary's Place Surry Hills, 2010  P 02 9332 3601 W 360.net.au ABN 90 146 901 322	LA-DA-13	
	A	SSDA	02/08/22	GD		ARCHITECT Neeson Murcutt + Neille	DRAWN KR				
	B	SSDA Resubmission	09/09/22	GD		SCALE N/A	SIZE A1				STAGE SSDA



## Landscape Strategies

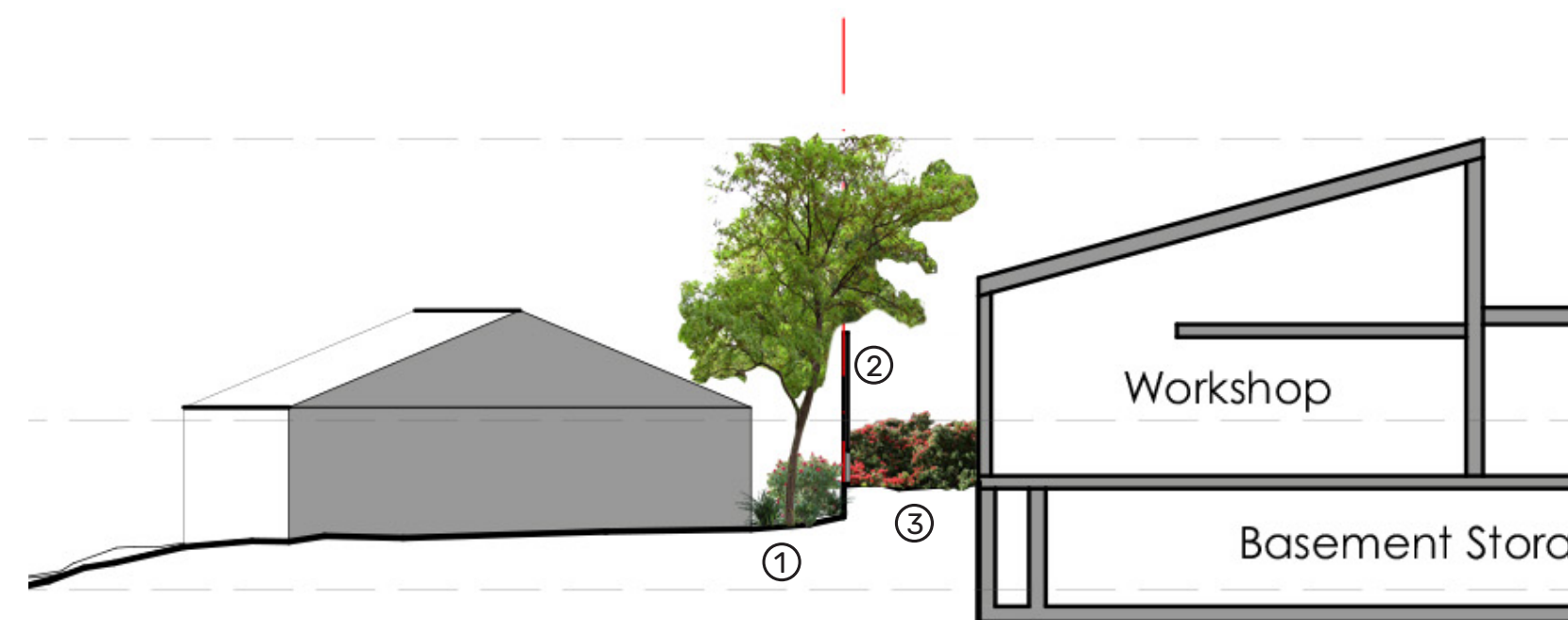
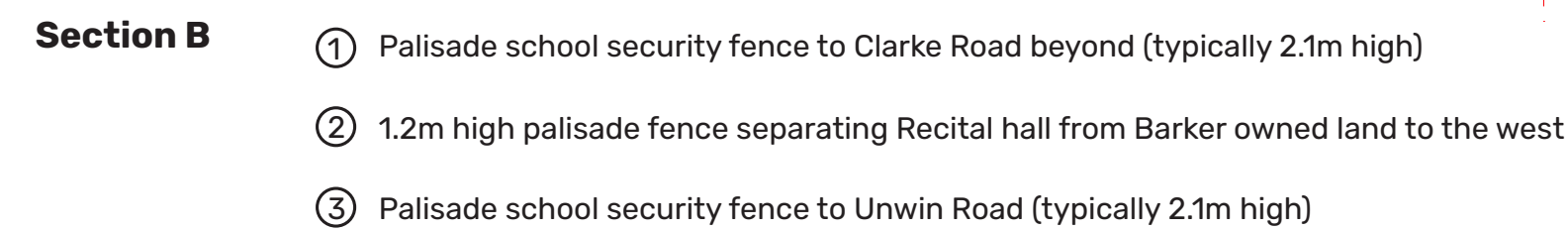

- Section C**
- ① Existing trees and underplanting in neighbours retained
  - ② Existing timber fence to be retained
  - ③ New shrub and grass planting  
No new trees to retain solar access to

Rev	Amendment	Date	By
A	SSDA	02/08/22	GD
B	SSDA Resubmission	09/09/22	GD

**IMPORTANT NOTES:**

- Do not scale from drawings.
- All discrepancies to be brought to the attention of the Project Landscape Architect.
- Large scale drawings and within dimensions take preference. All dimensions in inches otherwise stated.
- Do not scale from drawings.
- Use Spaced dimensions only.
- Verify all dimensions on site before the commencement of any works.
- Contractor shall locate and protect all services prior to construction.
- Contractor shall be carried out in accordance with the applicable State and Federal Government Regulations.
- All structural details shall be subject to Engineer's Specifications.
- Designs & Water Feature Details will be subject to Hydrologic Engineer's Specifications.
- Work shall be carried out in a professional manner by Qualified Tradesman according to Landscape Drawings and Engineer's Specifications.

No responsibility will be taken by 365 Degrees Landscape Architects Pty Ltd for any variations in design, construction materials, materials specified, and general specifications without permission from the Project Engineer or Landscape Architect.

CLIENT <b>Barker College</b>		CHECKED <b>GD</b>
ARCHITECT <b>Neeson Murcutt + Neille</b>		DRAWN <b>KR</b>
SCALE <b>N/A</b>	SIZE <b>A1</b>	STAGE <b>SSDA</b>

DWG. TITLE  
**SDRP Response**

PROJECT  
**Barker College**