

17-23 Talavera Road, Macquarie Park, NSW, 2113

Landscape Documentation for State Significant Development Application



IMAGE TAKEN FROM NEARMAP 2021

Drawing Register

Dwg No.	Drawing Name
SSD-00	Landscape Cover Sheet
SSD-01	Landscape Masterplan
SSD-02	Landscape Detail Plan
SSD-03	Tree Retention & Removal Plan
SSD-04	Landscape Sections
SSD-05	Specifications & Details
SSD-06	Planting Schedule & Imagery

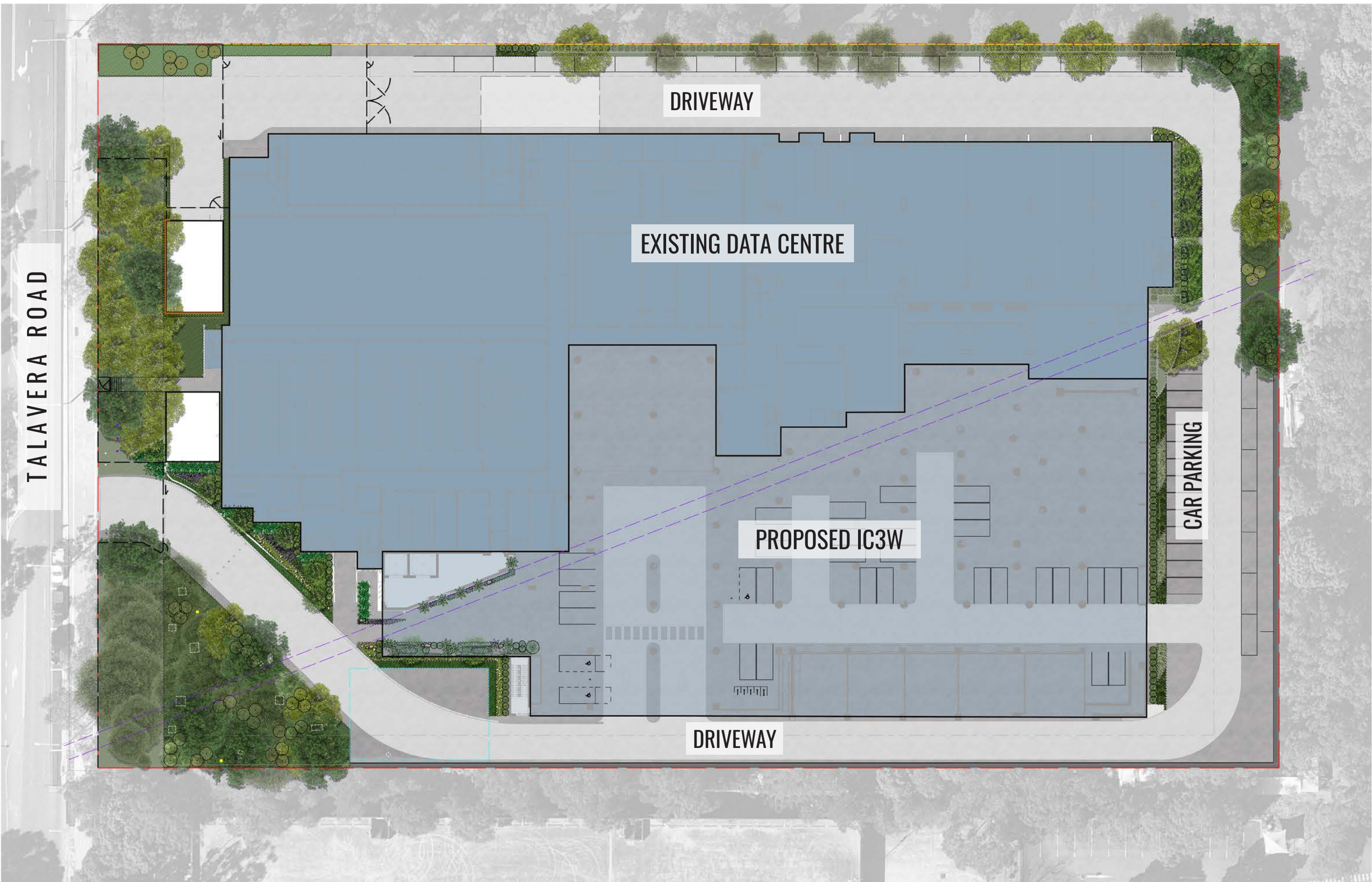

SITE PLAN

Drawing Title:
Landscape Cover Sheet
DWG No:

SSD-00

GEOSCAPES
LANDSCAPE ARCHITECTS
Suite 215, 284 Victoria Ave, Chatswood NSW 2067 Ph. (02) 9411 1485
www.geoscapes.com.au
ABN 84 620 205 781 ACN 620 205 781

Architect:
HR

Project Manager:
GIDDIS
PROJECT MANAGEMENT

Client:
macquarie
TELECOM GROUP

Scale:	Date:	Job Number:	North:	Revision					STATE SIGNIFICANT DEVELOPMENT	
N/A	03.11.21	210503	N/A	Rev	Date	Description	Drawn	Checked		
Project:				E	11.10.21	FOR SSD	KC	BG		
				F	20.10.21	FOR SSD	KC	BG		
				G	25.10.21	FOR SSD	KC	BG		
				H	03.11.21	FOR SSD	KC	BG		

MDC IC3West
17-23 Talavera Road, Macquarie Park, NSW 2113

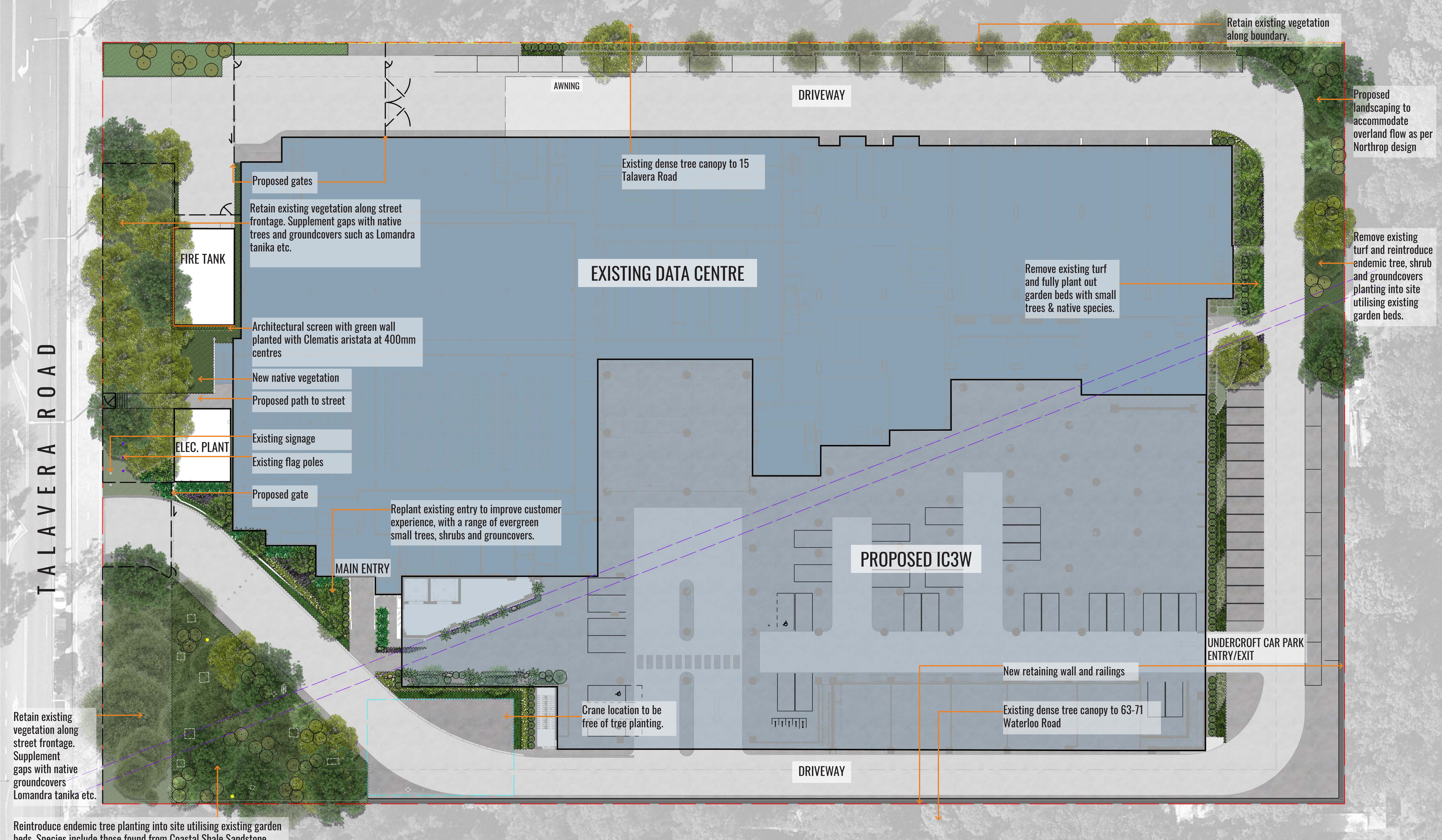

Retain existing vegetation along street frontage. Supplement gaps with native groundcovers Lomandra tanika etc.

Reintroduce endemic tree planting into site utilising existing garden beds. Species include those found from Coastal Shale Sandstone Forest such as Angophora costata, Corymbia gummifera, Eucalyptus resinifera and Pittosporum undulatum. Understorey of small shrubs and groundcovers.

Proposed Trees: 47 **Landscape Area: 2743m2 (14%)**

LEGEND

SITE BOUNDARY

RETAIN EXISTING TREES

REMOVE EXISTING TREES

STORMWATER EASEMENT

PROPOSED TREES

PROPOSED SHRUBS

ACCENT/FEATURE PLANTING

SANDSTONE ROCKS

PROPOSED GROUNDCOVER PLANTING

RETAIN EXISTING SHRUBS

RETAIN EXISTING GROUNDCOVER PLANTING

MASS HEDGE/SHRUB PLANTING

CRANE PAD LOCATIONS

EXISTING FENCE

EXISTING FLAG POLE LOCATIONS

GREEN WALL

EXISTING LIGHT POLES

PROPOSED CLIMBING PLANTS

EXISTING SERVICES

PROPOSED FENCE & GATE

Drawing Title:
Landscape Masterplan
DWG No:

GEOSCAPHES
LANDSCAPE ARCHITECTS
Suite 215, 284 Victoria Ave, Chatswood NSW 2067 Ph. (02) 9411 1485
www.geoscapes.com.au
ABN 84 620 205 781 ACN 620 205 781

SSD-01

Architect:
HDR

Project Manager:
GIDDIS
PROJECT MANAGEMENT

Client:
macquarie
TELECOM GROUP

Scale:
1:250 @ A1
1:500 @ A3

Date:
03.11.21

Job Number:
210503

North:

Project:
MDC IC3West
17-23 Talavera Road, Macquarie Park, NSW 2113

Revision			STATE SIGNIFICANT DEVELOPMENT	
Rev	Date	Description	Drawn	Checked
E	11.10.21	FOR SSD	KC	BG
F	20.10.21	FOR SSD	KC	BG
G	25.10.21	FOR SSD	KC	BG
H	03.11.21	FOR SSD	KC	BG



TALAVERA ROAD

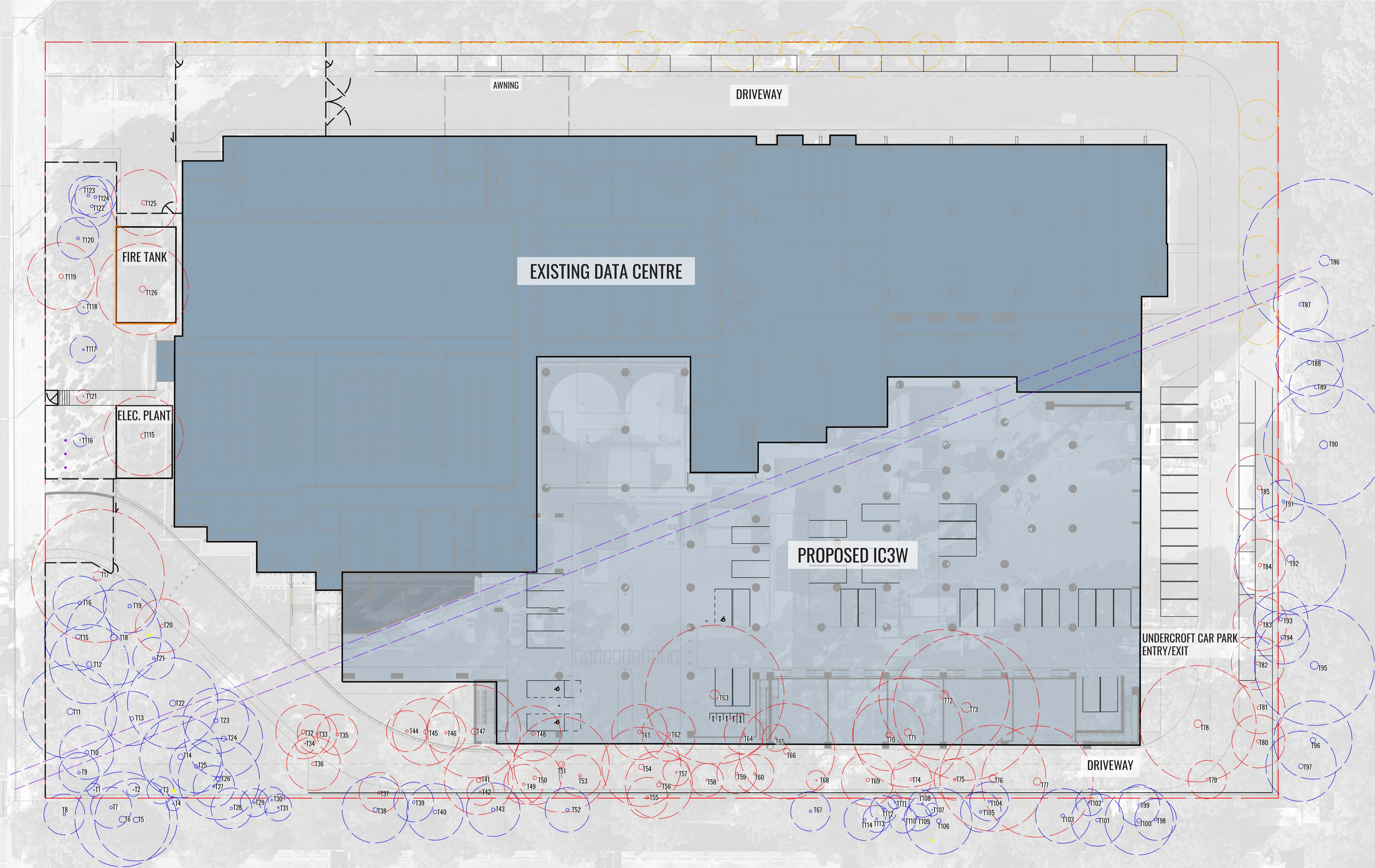

Trees to be retained inside site boundary: 29
Trees to be removed inside site boundary: 55

Juvenile trees to be retained from recent planting: 10

Drawing Title:
Tree Retention & Removal Plan
DWG No:

SSD-03

GEOSCAPHES
LANDSCAPE ARCHITECTS
Suite 215, 284 Victoria Ave, Chatswood NSW 2067 Ph. (02) 9411 1485
www.geoscapes.com.au
ABN 84 620 205 781 ACN 620 205 781

Architect:
HR

Project Manager:
GIDDIS
PROJECT MANAGEMENT

Client:
macquarie
TELECOM GROUP

Scale:
1:250 @ A1
1:500 @ A3

Date:
03.11.21

Job Number:
210503

North:
North

Project:

MDC IC3West
17-23 Talavera Road, Macquarie Park, NSW 2131

Revision			STATE SIGNIFICANT DEVELOPMENT	
Rev	Date	Description	Drawn	Checked
E	11.10.21	FOR SSD	KC	BG
F	20.10.21	FOR SSD	KC	BG
G	25.10.21	FOR SSD	KC	BG
H	03.11.21	FOR SSD	KC	BG

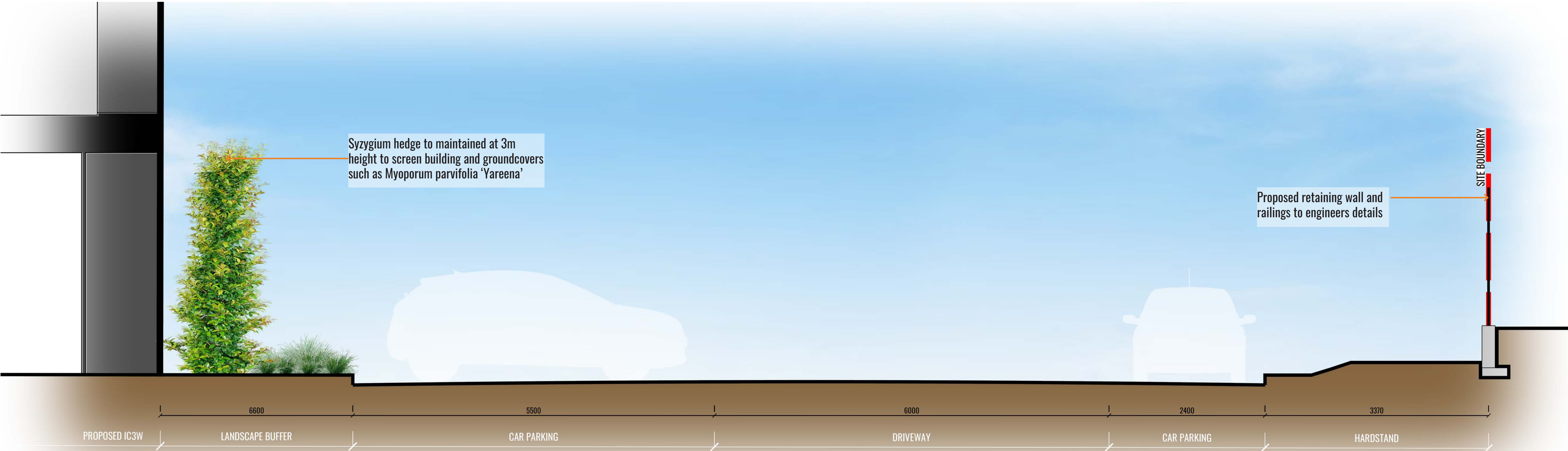

SECTION AA
SCALE 1:30

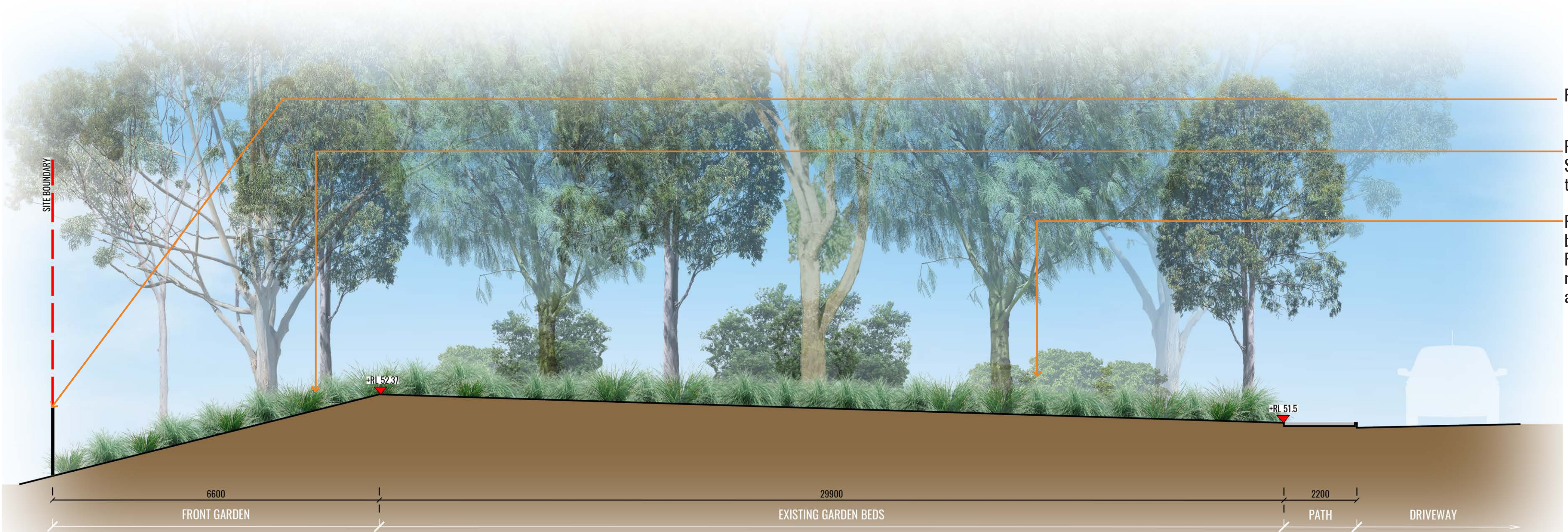

SECTION BB
SCALE 1:75

- Proposed fence
- Retain existing vegetation along street frontage. Supplement gaps with native groundcovers Lomandra tanika etc.
- Reintroduce endemic tree planting into site utilising existing garden beds. Species include those found from Coastal Shale Sandstone Forest such as Angophora costata, Corymbia gummifera, Eucalyptus resinifera and Pittosporum undulatum. Understorey of small shrubs and groundcovers.



KEY PLAN

MAINTENANCE PLAN

Maintenance shall mean the care and maintenance of the landscape works by accepted horticultural practice as rectifying any defects that become apparent in the landscape works under normal use. The landscape contractor shall attend the site on a **weekly basis** to maintain the landscape works commencing from practical completion.

Rubbish Removal

The Landscape Contractor shall undertake rubbish removal from the site on a **weekly basis** to ensure the site remains in tidy condition.

Weed Eradication

Weed growth that may occur in grassed, planted or mulched areas is to be removed using environmentally acceptable methods i.e. non-residual glyphosate herbicide (e.g. 'Roundup', applied in accordance with the manufacturer's direction.

Tree Replacement

Trees shall show signs of healthy vigorous growth and be free from disease and not exhibit signs of stress prior to handover to the client. Any trees or plant that die or fail to thrive, or are damaged or stolen will be replaced. Replacement material shall have the initial maintenance period extended in accordance with the landscape contract conditions. Trees and plant materials shall be equal to the minimum requirements of species specified and approved material delivered to site. Should the condition decline from the approved sample the Superintendent reserves the right to reject the tree / plants.

Frequency: as required.

Stakes

Adjust and/or replace stakes and ties where required. Remove staking and guying when instructed by the Superintendent

Pruning

Selective pruning may be required during the establishment period to promote a balanced canopy structure. These activities shall be carried out to the best horticultural and industry practice. All pruned material is to be removed from site.

Mulched Surfaces

All planter beds and garden areas shall have a minimum depth of 75mm organic mulch. All mulch is to be free of deleterious matter such as soil, weeds, sticks and should conform to AS 4454. Mulched surfaces are to be kept clean and tidy and free of any deleterious material and foreign matter. Reinststate depths to a uniform level of 75mm with mulch as specified, mulch to be free of any wood material impregnated with CCA or similar toxic treatment. Top up mulch levels prior to handover to client & estate management. Organic mulch is not to be used within 1m of a building. Use pebble mulch in these areas instead.

Watering

Implement an appropriate hand watering regime in areas not irrigated in association with current watering programme to maintain plant health and vigour. The program shall reflect seasonal conditions and plant species.

Frequency: Weekly or as required.

Soil In Natural Ground

Non-Australian native garden beds to have soil installed consisting of 50% existing site topsoil and 50% new topsoil equal or equivalent to 'Organic Garden Mix' as supplied by Australian Native Landscapes. Australian native garden beds to have soil installed consisting of 50% existing site topsoil and 50% new topsoil equal or equivalent to 'Native Low 'P' Mix' as supplied by Australian Native Landscapes. Soil to conform to AS4419 refer to typical detail.

Pest and Disease Control

The Landscape Contractor shall spray for pests and disease infestations when the pest and fungal attack has been positively identified and when their populations have increased to a point that will become detrimental to plant growth. Apply all pesticides to manufacturer's directions.

Frequency: weekly inspection

Fertilising

Generally check for signs of nutrient deficiencies (yellowing of leaves, failure to thrive), and adapt fertiliser regime to suit. Fertiliser should be applied at the beginning and the end of the (summer) growing season.

Irrigation

A sub surface dripper style, electrically automated self timed irrigation system is recommended to be supplied to all garden bed areas and planter container. Regular checks are to be made to ensure continued successful operation. The Landscape Contractor shall be responsible for coordination and engagement of a specialist irrigation designer and installation contractor to design, supply and install an automatic subterranean drip irrigation system to all raised planter beds.

The irrigation system will need to provide designated landscaped areas with enough water for vigorous healthy plant growth. As a general rule landscaped areas will need 20-25mm, species dependant, of water per week. The landscape Contractor will need to monitor natural rainfall using a rain switch in order to set irrigation flow rates accordingly on a monthly basis.

Standards

All grown or purchased plant stock must conform to all the conditions and requirements given in NATSPEC Guide: Specifying Trees. Soils to be in accordance with AS4419, mulching composts and conditioners to be in accordance with AS4454. Soils should conform to best practice specifications as listed in the Landscape Soils Handbook (Simon Leake & Elke Haege 2017).

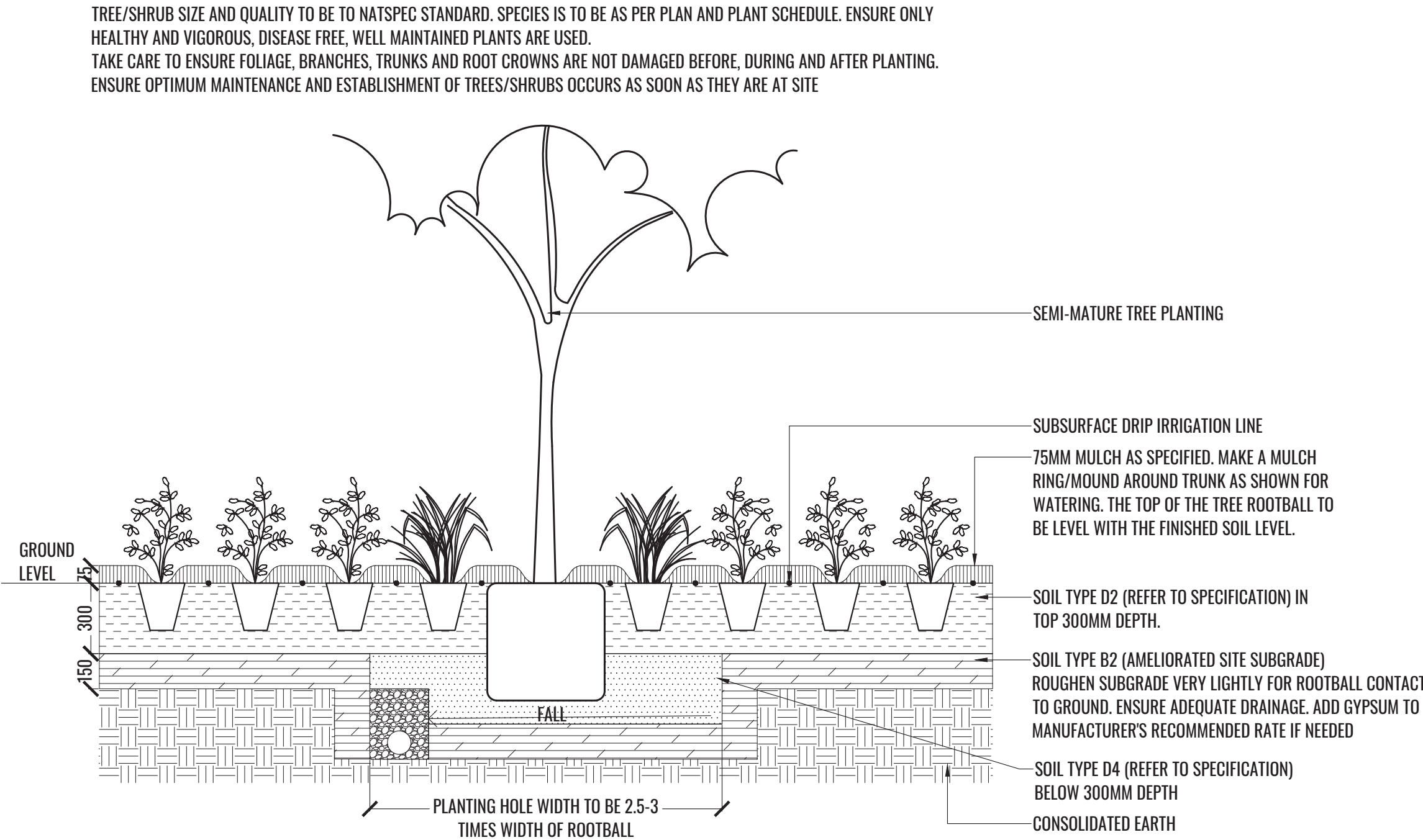

THOROUGHLY SOAK THE ROOTBALL OF TREE WITH FRESH WATER BEFORE TAKING OFF POT OR BAG. WHEN PLANTING HOLE IS COMPLETE USE A SHARP SPADE TO SHAVE OFF 20-50MM OF THE SIDES AND BASE OF ROOTBALL (TO ROOD PRUNE IT) BEFORE CAREFULLY PLACING INTO PLANTING HOLE. IF NORTH IS MARKED ON THE TREE, ENSURE ORIENTATION IS CORRECT WITH NORTH MARKING TO THE NORTH.

- REMOVE ANY STAKES, TIES AND LABELS. WATER ROOTBALL THOROUGHLY.
- TOP OF ROOTBALL TO FINISH FLUSH WITH TOP OF SOIL

1 MASS PLANTING AND TREE DETAIL
TYPICAL SECTION
SCALE 1:20

TYPICAL LANDSCAPE DETAILS

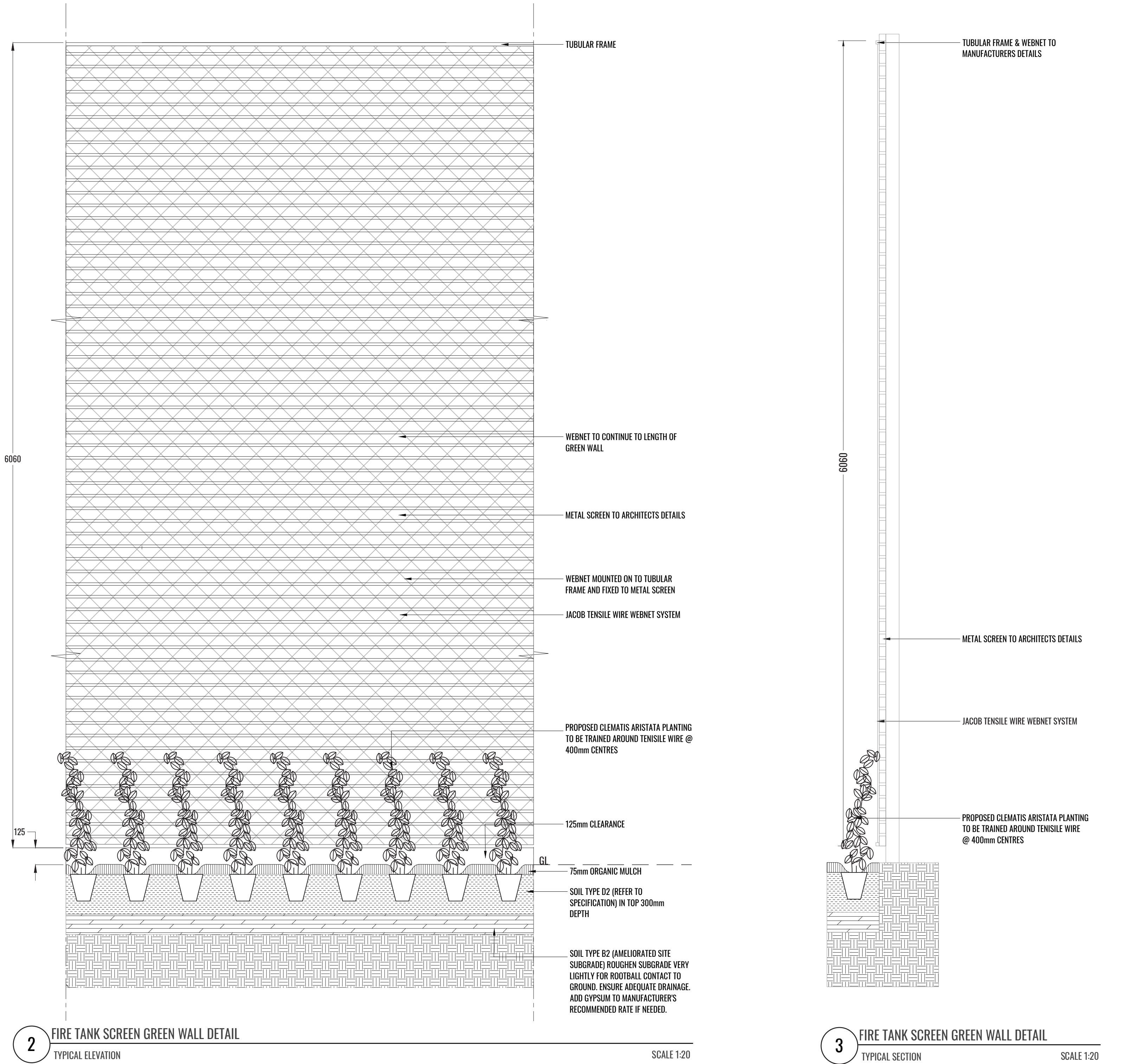

Drawing Title:
Specifications & Details
DWG No:

SSD-05

GEOSCAPES
LANDSCAPE ARCHITECTS

Suite 215, 284 Victoria Ave, Chatswood NSW 2067 Ph. (02) 9411 1485
www.geoscapes.com.au
ABN 84 620 205 781 ACN 620 205 781

Architect:

HR

Project Manager:

GIDDIS
PROJECT MANAGEMENT

Client:

macquarie
TELECOM GROUP

Scale:	Date:	Job Number:	North:	STATE SIGNIFICANT DEVELOPMENT				
				Rev	Date	Description	Drawn	Checked
AS SHOWN @ A1	03.11.21	210503	N/A	E	11.10.21	FOR SSD	KC	BG
				F	20.10.21	FOR SSD	KC	BG
				G	25.10.21	FOR SSD	KC	BG
				H	03.11.21	FOR SSD	KC	BG

Project:

MDC IC3West

17-23 Talavera Road, Macquarie Park, NSW 2113

PLANTING SCHEDULE

Code	Botanical Name	Common Name	Mature Height	Coastal Shale Sandstone Forest	Spacing	Pot Size	Qty*
Trees							
ANG COS	Angophora costata	Smooth-Bark Apple	15-25m	✓	As Shown	75L	6
ALL LIT	Allocasuarina littoralis	Black She-oak	8-12m	✓	As Shown	75L	5
COR GUM	Corymbia gummifera	Red Bloodwood	15m	✓	As Shown	75L	5
ELA EUM	Elaeocarpus eumundi	Eumundii Quandong	6-10m		As Shown	75L	6
EUC RES	Eucalyptus resinifera	Red Mahogany	45m	✓	As Shown	75L	2
MAG GRA	Magnolia grandiflora 'Teddy Bear'	Southern Magnolia	4m		As Shown	75L	2
PIT UND	Pittosporum undulatum	Sweet Pittosporum	12m	✓	As Shown	75L	11
SYN GLO	Syncarpia glomulifera	Turpentine	60m	✓	As Shown	75L	3
TRI LUC	Tristaniopsis laurina 'Luscious'	Water Gum	7-12m		As Shown	75L	7
Shrubs							
ACA lin	Acacia linifolia	Flax Wattle	2-5m	✓	As Shown	200mm	9
AGA att	Agave attenuata	Fox Tail Agave	3m		As Shown	200mm	14
ASP aus	Asplenium australasicum	Birds Nest Fern	1.5m		As Shown	200mm	8
BAN spi	Banksia spinulosa	Prickly-Leaved Banksia	1-3m	✓	As Shown	200mm	12
BLE sil	Blechnum 'Silver Lady'	Dwarf Tree Fern	1.2m		As Shown	200mm	3
CAL cit	Callistemon citrinus 'White Anzac'	Bottlebrush	0.5-1.5m		As Shown	200mm	13
DYP lut	Dypsis lutescens	Golden Cane Palm	2-2.5m		As Shown	200mm	1
DOD tri	Dodonaea triquetra	Common Hop Bush	3m	✓	As Shown	200mm	12
DOR exc	Doryanthes excelsa	Spear Lily	2-4m		As Shown	200mm	14
HAK ser	Hakea sericea	Needlebush	7m	✓	As Shown	200mm	10
LEP for	Leptospermum laevigatum 'Fore Shore'	Tea Tree	0.3-0.5m		As Shown	200mm	13
LOM sil	Lomatia silaifolia	Wild Parsley	1-2m	✓	As Shown	200mm	7
MEL cla	Melaleuca linariifolia 'Claret Tops'	Honey Myrtle	1m		As Shown	200mm	21
MIC mus	Microsorium musifolium	Crocodile Fern	1.2m		As Shown	200mm	6
RHA exc	Rhapis excelsa	Broadleaf Lady Palm	4m		As Shown	200mm	3
SYZ aus	Syzygium australe 'Northern Select'	Lilly Pilly	5m		1.5m Ctrs	200mm	51
Grasses + Groundcover							
ASP bul	Asplenium bulbiferum	Hen and Chickens Fern	1m		4/m2	140mm	41
ASP ela	Aspidistra elatior	Cast Iron Plant	0.9m		4/m2	140mm	19
BRA mul	Brachyscome multifida 'Break O Day'	Rock Daisy	0.2-3m		4/m2	140mm	156
CAR ros	Carpobrotus rossii 'White hot'	Native Pig Face	0.2-0.4m		3/m2	140mm	122
DIA cae	Dianella caerulea	Blue-Flax Lily	1m	✓	5/m2	Tube	1003
ERM gla	Eremophila glabra 'Blue Horizon [EREM1]	Emu Plant	0.25m		3/m2	140mm	78
IMP cyl	Imperata cylindrica var. major	Blady Grass	1.2m	✓	5/m2	Tube	1060
LIR mus	Liriope muscari	Lilyturf	0.6m		5/m2	140mm	110
LOM mul	Lomandra multiflora	Many-Flowered Mat-Rush	0.8m	✓	5/m2	Tube	932
LOM win	Lomandra confertifolia 'Wingarra' [SIR5]	Spiny Mat Rush	0.3m		5/m2	Tube	72
MIC sti	Microlaena stipoides var. stipoides	Weeping Grass	0.7m	✓	5/m2	Tube	932
MYO par	Myoporum parvifolia 'Yareena' [PARV01]	Creeping Boobialla	0.1m		3/m2	140mm	149
SCA whi	Scaevola albida 'White Carpet'	White Fan Flower	0.1-0.2m		3/m2	140mm	117
SCL bif	Scleranthus biflorus	Cushion Bush	0.1m		6/m2	140mm	42
THE aus	Themeda australis	Kanagroo Grass	0.2-0.5m	✓	5/m2	Tube	932
Climbers							
CLE ari	Clematis aristata	Goat's Beard	2m		0.4m Ctrs	Tubestock	60
*Plant numbers to be finalised at Detailed Design / CC-Tender stage							

PLANT IMAGES



A. Syncarpia glomulifera B. Banksia spinulosa C. Asplenium bulbiferum D. Rhapis excelsa E. Callistemon citrinus 'White Anzac' F. Syzygium australe 'Northern Select' G. Dianella tasmanica 'Splice' H. Carpobrotus rossii 'White hot' I. Clematis aristata J. Liriope muscari K. Scaevola albida 'White Carpet' L. Elaeocarpus eumundi M. Scleranthus biflorus N. Brachyscome multifida 'Break O Day' O. Myoporum parvifolia 'Yareena' P. Pittosporum undulatum

Drawing Title:
Planting Schedule & Imagery
DWG No:

SSD-06

GEOSCAPHES

LANDSCAPE ARCHITECTS

Suite 215, 284 Victoria Ave, Chatswood NSW 2067 Ph. (02) 9411 1485
www.geoscapes.com.au
ABN 84 620 205 781 ACN 620 205 781

Architect:

HDR

Project Manager:

GIDDIS

PROJECT MANAGEMENT

Client:

macquarie

TELECOM GROUP

Scale:	Date:	Job Number:	North:	RevisionSTATE SIGNIFICANT DEVELOPMENT				
N/A	03.11.21	210503	N/A	Rev	Date	Description	Drawn	Checked
				E	11.10.21	FOR SSD	KC	BG
				F	20.10.21	FOR SSD	KC	BG
				G	25.10.21	FOR SSD	KC	BG
Project:	MDC IC3West 17-23 Talavera Road, Macquarie Park, NSW 2113			H	03.11.21	FOR SSD	KC	BG

MDC IC3West
17-23 Talavera Road, Macquarie Park, NSW 2113