

# WILKINSON HOUSE

## SSDA

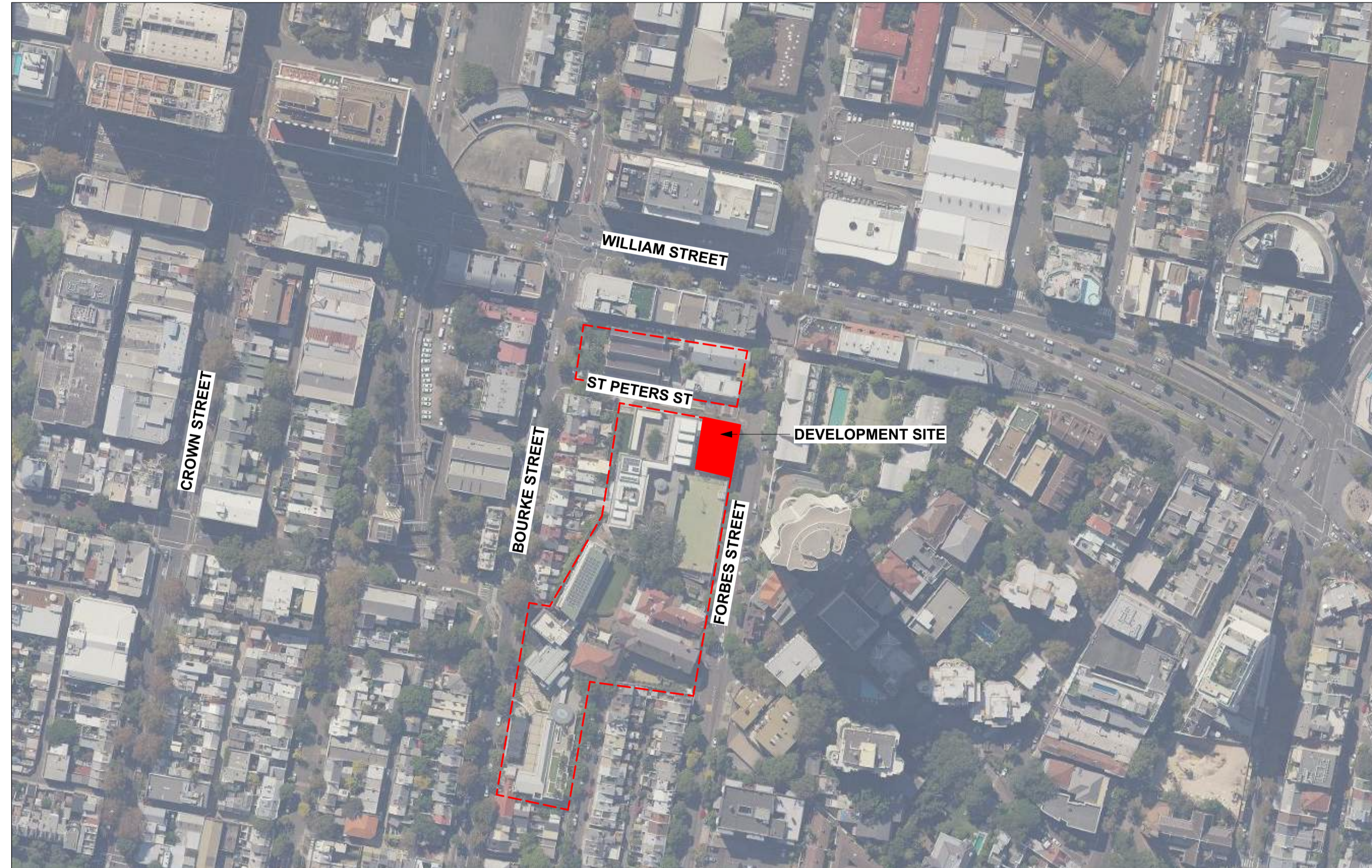

DRAWING NUMBER	DRAWING TITLE	REVISION
L_0001	COVER SHEET	A
L_0002	PLANTING SCHEDULES	A
L_1001	LANDSCAPE PLAN GROUND FLOOR	A
L_1002	LANDSCAPE PLAN LEVEL 3	A
L_7001	TYPICAL DETAILS	A

**NOTE:**  
VERIFY ALL DIMENSIONS ON SITE BEFORE COMMENCING WORK. REPORT ALL DISCREPANCIES TO LANDSCAPE ARCHITECT PRIOR TO CONSTRUCTION. FIGURED DIMENSIONS TO BE TAKEN IN PREFERENCE TO SCALED DRAWINGS. DRAWINGS MADE TO LARGER SCALES AND THOSE SHOWING PARTICULAR PARTS OF THE WORKS SHALL TAKE PRECEDENCE OVER DRAWINGS MADE TO SMALLER SCALE AND THOSE FOR GENERAL PURPOSES. ALL WORK IS TO CONFORM TO RELEVANT AUSTRALIAN STANDARDS AND OTHER CODES AS APPLICABLE TOGETHER WITH OTHER AUTHORITIES' REQUIREMENTS AND REGULATIONS. DESIGN DRAWINGS BY OTHER DISCIPLINES HAVE BEEN INCLUDED FOR COORDINATION ONLY. THIS DRAWING AND DESIGN IS SUBJECT TO COPYRIGHT AND MAY NOT BE REPRODUCED WITHOUT PRIOR WRITTEN CONSENT. IF IN DOUBT, ASK.

**NOT FOR CONSTRUCTION**

ISSUE	DESCRIPTION	BY	APPD	DATE
A	ISSUE FOR SSDA	TC	SW	22/09/2021

NORTH / SCALE  
Scale: NTS

PROJECT TEAM  
ARCHITECT  
**SMART DESIGN STUDIO**  
14 Stokes Ave, Alexandria NSW 2015  
Telephone: (02) 8332 4333

LANDSCAPE ARCHITECT  
**CONTEXT**  
LANDSCAPE ARCHITECTURE  
Context Landscape Design Pty Ltd  
Level 2, 52-58 William Street, East Sydney NSW 2011  
PO Box A868, Sydney South NSW 1235  
T. 61 2 8244 8900 W. www.context.net.au  
ABN: 14 093 350 719

CLIENT NAME  
**SCEGGS**  
PROJECT  
**WILKINSON HOUSE**  
SCEGGS DARLINGHURST

DRAWING TITLE  
**COVER SHEET**  
PROJECT STAGE  
SSDA  
PROJECT NUMBER  
**18549**

SHEET SIZE  
A1  
DRAWING NUMBER  
**L\_0001**  
ISSUE  
**A**

PLANTING SCHEDULE						
GROUND FLOOR PUBLIC DOMAIN						
GROUNDCOVERS						
SYMBOL	BOTANICAL NAME	COMMON NAME	PROVENANCE	HEIGHT	POT SIZE	QUANTITY
TRAjas	<i>Trachelospermum jasminoides</i>	Star Jasmine	exotic	0.3m	140mm	44

LEVEL 3 ROOFTOP PLANTER						
TREES						
SYMBOL	BOTANICAL NAME	COMMON NAME	PROVENANCE	HEIGHT	POT SIZE	QUANTITY
MELlin	<i>Melaleuca linariifolia</i> 'Snow in Summer'	Snow in Summer	native	pruned to 2m	300mm	1
GRASSES & GROUNDCOVERS						
SYMBOL	BOTANICAL NAME	COMMON NAME	PROVENANCE	HEIGHT	POT SIZE	QUANTITY
DIArev	<i>Dianella revoluta</i>	Blueberry Lily	native	0.4m	140mm	5/sqm
EREdeb	<i>Eremophila debilis</i>	Winter Apple	native	0.1m	140mm	2/sqm
MENsat	<i>Mentha saturoioides</i>	Native Penny Royal	native	0.2 - 0.4m	140mm	4/sqm
RHOant	<i>Rhodanthe anthemoides</i>	Chamomile Sunray	native	0.15 - 0.3m	140mm	4/sqm
TETtet	<i>Tetragonia tetragonioides</i>	Warrigal Greens	native	0.2m	140mm	2/sqm



*Melaleuca linariifolia*  
'Snow in Summer'



*Dianella revoluta*  
Blueberry Lily

*Eremophila debilis*  
Winter Apple

*Mentha saturoioides*  
Native Penny Royal

*Rhodanthe anthemoides*  
Chamomile Sunray

*Tetragonia tetragonioides*  
Warrigal Greens

*Trachelospermum jasminoides*  
Star Jasmine

**GENERAL NOTES**

**PREPARATION**

**Weed eradication**

Herbicide: Eradicate weeds using environmentally acceptable methods, such as a non-residual glyphosate herbicide in any of its registered formulae, at the recommended maximum rate.  
Removal: Regularly remove, by hand, rubbish and weed growth throughout grassed, planted and mulched areas. Remove weed growth from an area 750 mm diameter around the base of the trees in grassed areas. Continue eradication throughout the course of the works and during the planting establishment period.

**Vegetative spoil**

Disposal: Remove vegetative spoil from site. Do not burn.

**PLANTING**

**Locations**

General: If it appears necessary to vary plant locations and spacings to avoid service lines, or to cover the area uniformly, or for other reasons, give notice.

**Planting conditions**

Do not plant in unsuitable weather conditions such as extreme heat, cold, wind or rain. In other than sandy soils, suspend excavation when the soil is wet, or during frost periods.

**Watering**

Before planting begins, thoroughly water the trees and planting areas. Keep the areas moist during planting. Water the trees immediately after planting and thereafter as required to maintain growth rates free of stress.

**Handling**

All plants shall be handled at all times in such a manner as to prevent any damage in transit.

**Plants Set Out**

As soon as possible after delivery, the plants shall be set out in the positions for planting as indicated on the landscape layout plan, ready for inspection. The Construction manager will inspect the planting beds, set out with their full complement of plants, and will make sure minor changes of placement as necessary. Following this inspection, the landscape contractor is to immediately plant out the beds. Where all planting cannot be achieved in one day, this work will be staged.

**Planting Hole**

All species to be planted into an individual prepared hole. Each hole shall be dug with a shovel, backhoe or similar tool. Individual holes shall be excavated to suit the pot size while allowing the root system to sit flat on the excavated hole. Excavate hole to allow suitable clearance to each side of the root system. Cultivate the subsoil to 100mm below planting hole.

**Depth of Planting**

When the plant is in its final position in its hole or bed, the topsoil level of the plant root ball shall be level with the finished surface of the soil surrounding the hole or bed. Test the depth by inserting the plant, still in its container, into the hole.

**Placing**

When the hole or bed appears to be of correct size, and not before, remove the plant from the container with minimum disturbance to the root ball and place it in its final position. Root prune to ensure all circling roots have been either severed or aligned radially into the surrounding soil. Plant shall be set plumb, with the root ball set slightly below the final soil level. Compact lightly so as to minimise subsidence without compacting the backfill. Avoid mixing mulch with topsoil.

**Backfilling**

Soil shall be progressively firmed during backfilling to avoid air pockets. Backfilling shall be with Planting Soil Mix as specified to the specified depths.

**Watering**

Thoroughly water the plants before planting, immediately after planting, and as required to maintain growth rates free of stress.

**Placing mulch**

General: Place mulch to the required depth, clear of plant stems, and rake to an even surface flush with the surrounding finished levels. Spread and roll mulch so that after settling, or after rolling, it is smooth and evenly graded between design surface levels sloped towards the base of plant stems in plantation beds, and not closer to the stem than 50mm in the case of gravel mulches.

**NOTE:**  
VERIFY ALL DIMENSIONS ON SITE BEFORE COMMENCING WORK. REPORT ALL DISCREPANCIES TO LANDSCAPE ARCHITECT PRIOR TO CONSTRUCTION. FIGURED DIMENSIONS TO BE TAKEN IN PREFERENCE TO SCALED DRAWINGS. DRAWINGS MADE TO LARGER SCALES AND THOSE SHOWING PARTICULAR PARTS OF THE WORKS SHALL TAKE PRECEDENCE OVER DRAWINGS MADE TO SMALLER SCALE AND THOSE FOR GENERAL PURPOSES. ALL WORK IS TO CONFORM TO RELEVANT AUSTRALIAN STANDARDS AND OTHER CODES AS APPLICABLE TOGETHER WITH OTHER AUTHORITIES' REQUIREMENTS AND REGULATIONS. DESIGN DRAWINGS BY OTHER DISCIPLINES HAVE BEEN INCLUDED FOR COORDINATION ONLY. THIS DRAWING AND DESIGN IS SUBJECT TO COPYRIGHT AND MAY NOT BE REPRODUCED WITHOUT PRIOR WRITTEN CONSENT. IF IN DOUBT, ASK.

**NOT FOR CONSTRUCTION**

ISSUE	DESCRIPTION	BY	APPD	DATE
A	ISSUE FOR SSDA	TC	SW	22/09/2021

NORTH / SCALE  
Scale: NTS

PROJECT TEAM

ARCHITECT  
**SMART DESIGN STUDIO**  
14 Stokes Ave, Alexandria NSW 2015  
Telephone: (02) 8332 4333

LANDSCAPE ARCHITECT

**CONTEXT**  
LANDSCAPE ARCHITECTURE

Context Landscape Design Pty Ltd  
Level 2, 52-58 William Street, East Sydney NSW 2011  
PO Box A868, Sydney South NSW 1235  
T. 61 2 8244 8900 W. www.context.net.au  
ABN: 14 093 350 719

CLIENT NAME  
**SCEGGS**

PROJECT  
**WILKINSON HOUSE**  
SCEGGS DARLINGHURST

DRAWING TITLE PLANTING SCHEDULES		
PROJECT STAGE SSDA		SHEET SIZE A1
PROJECT NUMBER 18549	DRAWING NUMBER L_0002	ISSUE A

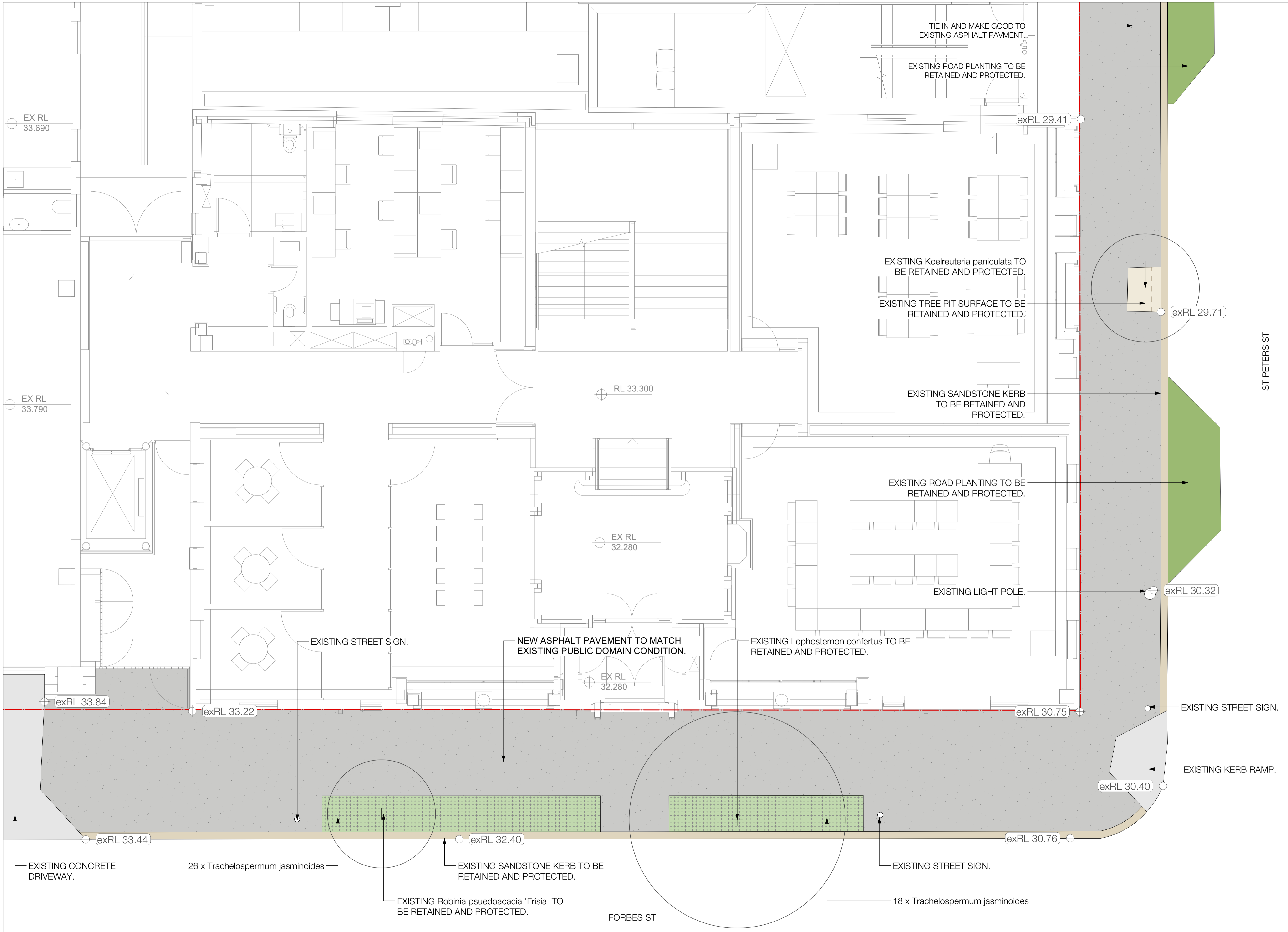

**LEGEND**

- BOUNDARY
- PROPOSED TREE LEVEL 3
- EXISTING TREES TO BE RETAINED & PROTECTED
- EXISTING PLANTING TO BE RETAINED & PROTECTED
- EXISTING CONCRETE SURFACE TO BE RETAINED & PROTECTED
- EXISTING SANDSTONE KERB TO BE RETAINED & PROTECTED
- MASS PLANTING
- ASPHALT

**KEY PLAN**

**NOTE:**  
VERIFY ALL DIMENSIONS ON SITE BEFORE COMMENCING WORK. REPORT ALL DISCREPANCIES TO LANDSCAPE ARCHITECT PRIOR TO CONSTRUCTION. FIGURED DIMENSIONS TO BE TAKEN IN PREFERENCE TO SCALED DRAWINGS. DRAWINGS MADE TO LARGER SCALES AND THOSE SHOWING PARTICULAR PARTS OF THE WORKS SHALL TAKE PRECEDENCE OVER DRAWINGS MADE TO SMALLER SCALE AND THOSE FOR GENERAL PURPOSES. ALL WORK IS TO CONFORM TO RELEVANT AUSTRALIAN STANDARDS AND OTHER CODES AS APPLICABLE TOGETHER WITH OTHER AUTHORITIES' REQUIREMENTS AND REGULATIONS. DESIGN DRAWINGS BY OTHER DISCIPLINES HAVE BEEN INCLUDED FOR COORDINATION ONLY. THIS DRAWING AND DESIGN IS SUBJECT TO COPYRIGHT AND MAY NOT BE REPRODUCED WITHOUT PRIOR WRITTEN CONSENT. IF IN DOUBT, ASK.

**NOT FOR CONSTRUCTION**

ISSUE	DESCRIPTION	BY	APPD	DATE
A	ISSUE FOR SSDA	TC	SW	22/09/2021

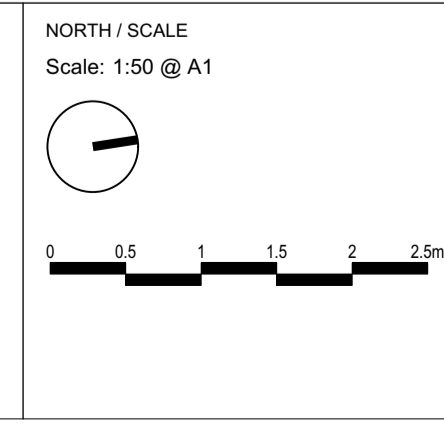

**PROJECT TEAM**

ARCHITECT  
**SMART DESIGN STUDIO**  
14 Stokes Ave, Alexandria NSW 2015  
Telephone: (02) 8332 4333

LANDSCAPE ARCHITECT

**CONTEXT**  
LANDSCAPE ARCHITECTURE

Context Landscape Design Pty Ltd  
Level 2, 52-58 William Street, East Sydney NSW 2011  
PO Box A868, Sydney South NSW 1235  
T. 61 2 8244 8900 W. www.context.net.au  
ABN: 14 093 350 719

CLIENT NAME  
**SCEGGS**







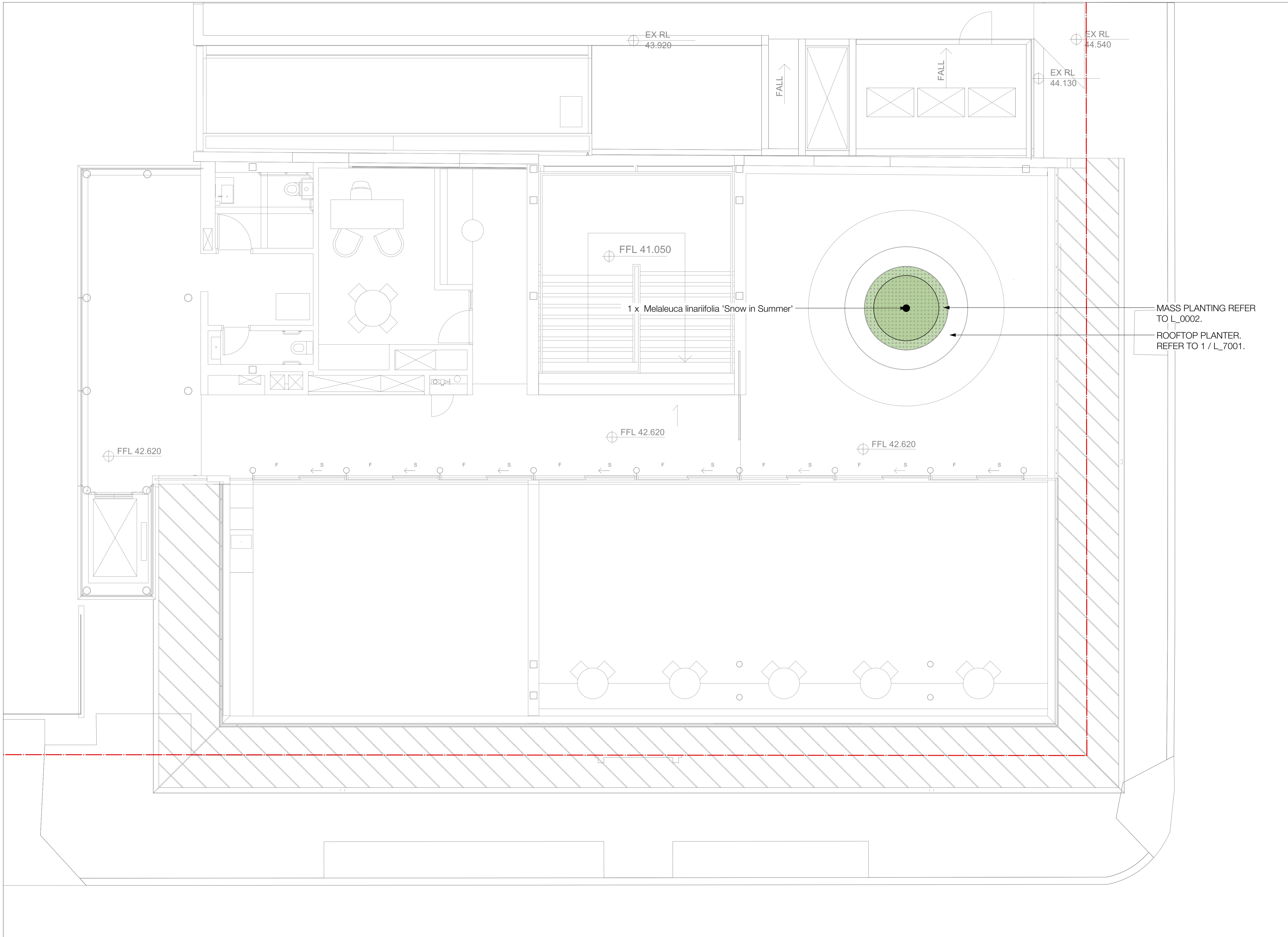

PROJECT  
**WILKINSON HOUSE**  
SCEGGS DARLINGHURST

DRAWING TITLE  
**LANDSCAPE PLAN GROUND FLOOR**

PROJECT STAGE SSDA	SHEET SIZE A1
PROJECT NUMBER 18549	DRAWING NUMBER L_1001
ISSUE A	

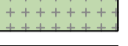

**LEGEND**

-  BOUNDARY
-  PROPOSED TREE LEVEL 3
-  EXISTING TREES TO BE RETAINED & PROTECTED
-  EXISTING PLANTING TO BE RETAINED & PROTECTED
-  EXISTING CONCRETE SURFACE TO BE RETAINED & PROTECTED
-  EXISTING SANDSTONE KERB TO BE RETAINED & PROTECTED
-  MASS PLANTING
-  ASPHALT

MASS PLANTING REFER TO L\_0002.  
ROOFTOP PLANTER. REFER TO 1 / L\_7001.

**KEY PLAN**

**NOTE:**  
VERIFY ALL DIMENSIONS ON SITE BEFORE COMMENCING WORK. REPORT ALL DISCREPANCIES TO LANDSCAPE ARCHITECT PRIOR TO CONSTRUCTION. FIGURED DIMENSIONS TO BE TAKEN IN PREFERENCE TO SCALED DRAWINGS. DRAWINGS MADE TO LARGER SCALES AND THOSE SHOWING PARTICULAR PARTS OF THE WORKS SHALL TAKE PRECEDENCE OVER DRAWINGS MADE TO SMALLER SCALE AND THOSE FOR GENERAL PURPOSES. ALL WORK IS TO CONFORM TO RELEVANT AUSTRALIAN STANDARDS AND OTHER CODES AS APPLICABLE TOGETHER WITH OTHER AUTHORITIES' REQUIREMENTS AND REGULATIONS. DESIGN DRAWINGS BY OTHER DISCIPLINES HAVE BEEN INCLUDED FOR COORDINATION ONLY. THIS DRAWING AND DESIGN IS SUBJECT TO COPYRIGHT AND MAY NOT BE REPRODUCED WITHOUT PRIOR WRITTEN CONSENT. IF IN DOUBT, ASK.

**NOT FOR CONSTRUCTION**

ISSUE	DESCRIPTION	BY	APPD	DATE
A	ISSUE FOR SSDA	TC	SW	22/09/2021

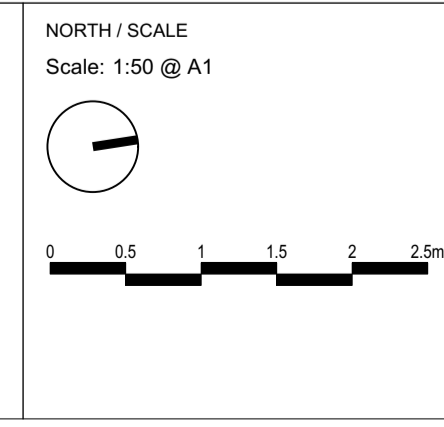

**PROJECT TEAM**

ARCHITECT  
**SMART DESIGN STUDIO**  
14 Stokes Ave, Alexandria NSW 2015  
Telephone: (02) 8332 4333

LANDSCAPE ARCHITECT

**CONTEXT**  
LANDSCAPE ARCHITECTURE

Context Landscape Design Pty Ltd  
Level 2, 52-58 William Street, East Sydney NSW 2011  
PO Box A868, Sydney South NSW 1235  
T. 61 2 8244 8900 W. www.context.net.au  
ABN: 14 093 350 719

CLIENT NAME  
**SCEGGS**

PROJECT  
**WILKINSON HOUSE**  
SCEGGS DARLINGHURST

DRAWING TITLE  
**LANDSCAPE PLAN LEVEL 3**

PROJECT STAGE SSDA	SHEET SIZE A1
PROJECT NUMBER 18549	DRAWING NUMBER L_1002
ISSUE A	

NOTE: ENSURE TREE ROOTBALLS ARE ADEQUATELY WATERED BEFORE PLANTING AND IMMEDIATELY AFTER PLANTING. ANY PLANTING TO BE OUTSIDE OF ROOTBALL EXCAVATED HOLE.

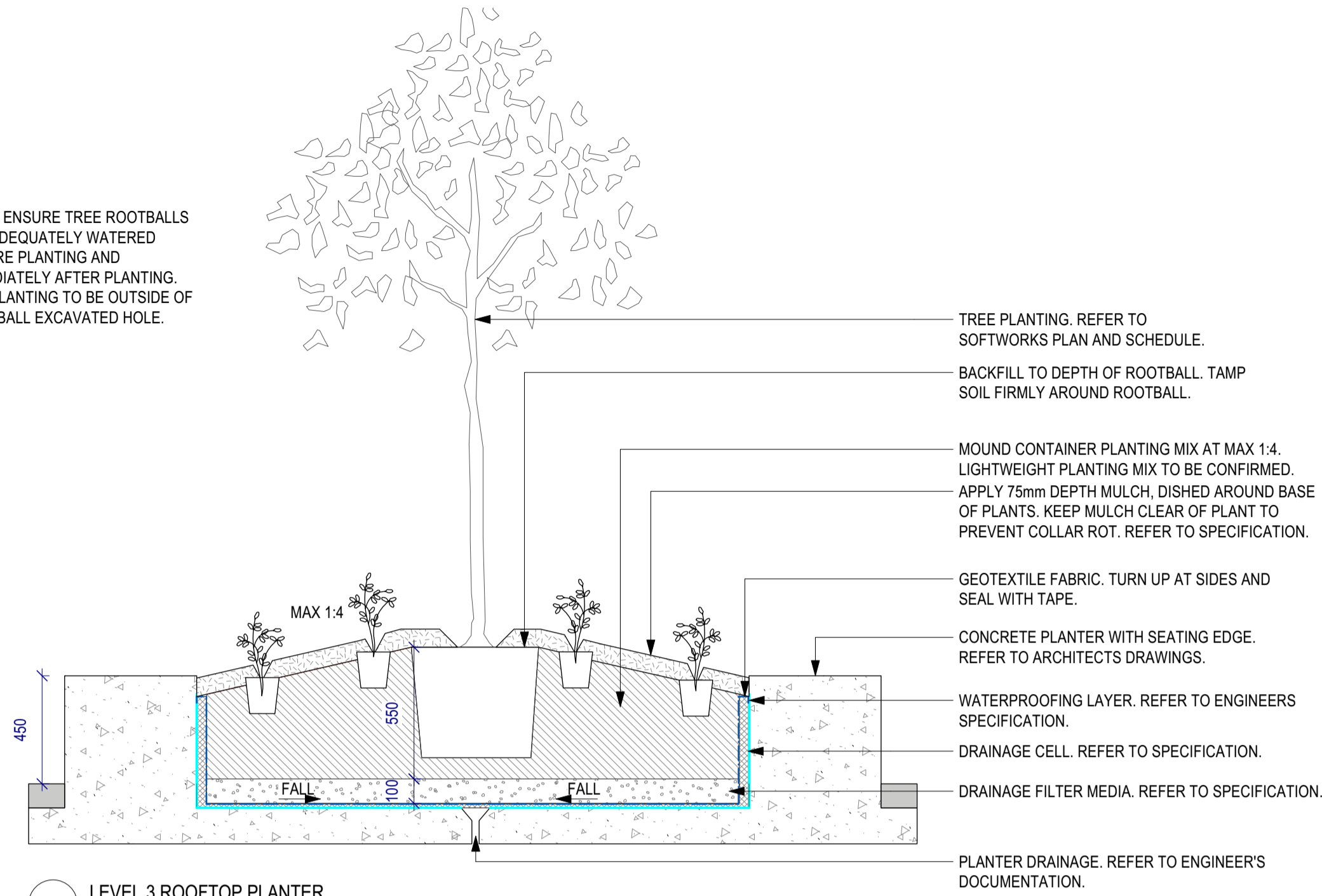

1 LEVEL 3 ROOFTOP PLANTER  
Scale: 1:20

NOTE:  
Make allowance for subsoil irrigation line to be run under the pedestal pavers and fed through a conduit formed in the concrete and sealed to the inside once the irrigation line is in place.

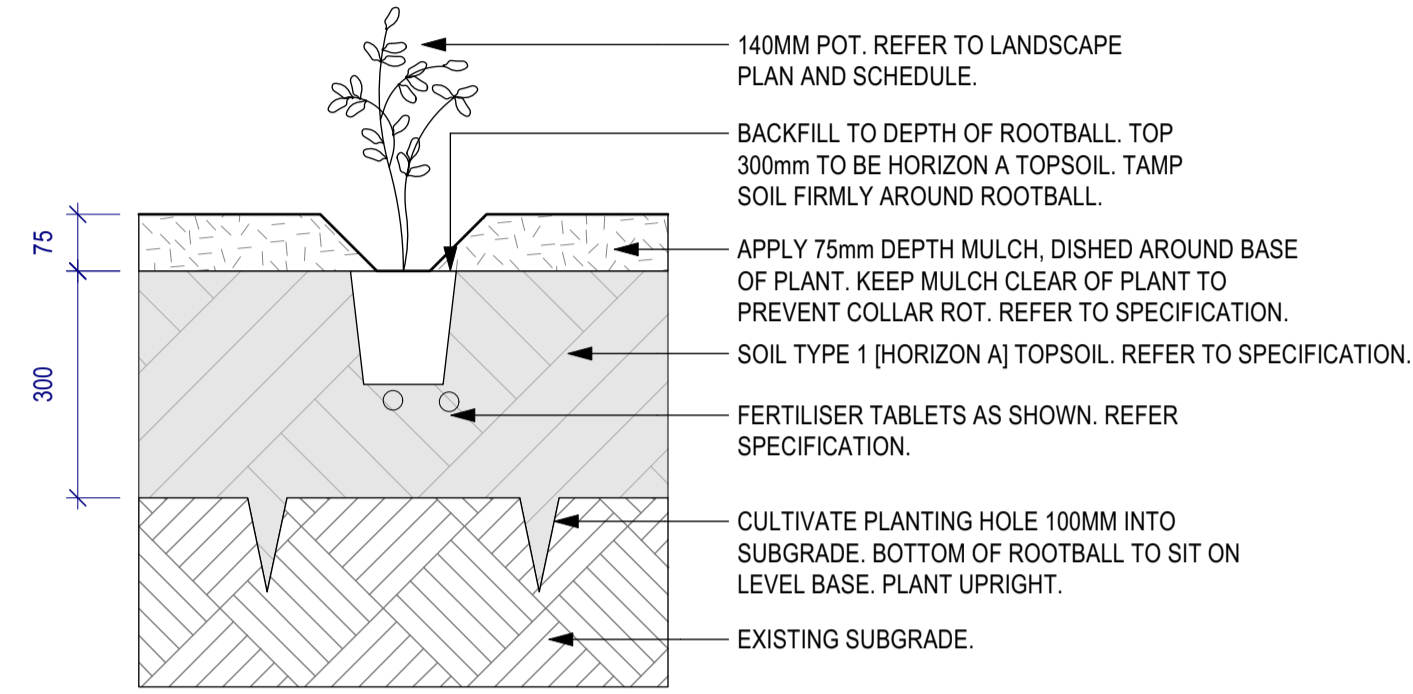

2 TYP. 140MM POT  
Scale: 1:10

**NOT FOR CONSTRUCTION**

ISSUE	DESCRIPTION	BY	APPD	DATE
A	ISSUE FOR SSDA	TC	SW	22/09/2021

NORTH / SCALE  
Scale: AS SHOWN

PROJECT TEAM  
ARCHITECT  
**SMART DESIGN STUDIO**  
14 Stokes Ave, Alexandria NSW 2015  
Telephone: (02) 8332 4333

LANDSCAPE ARCHITECT  
**CONTEXT**  
LANDSCAPE ARCHITECTURE  
Context Landscape Design Pty Ltd  
Level 2, 52-58 William Street, East Sydney NSW 2011  
PO Box A868, Sydney South NSW 1235  
T. 61 2 8244 8900 W. www.context.net.au  
ABN: 14 093 350 719

CLIENT NAME  
**SCEGGS**

PROJECT  
**WILKINSON HOUSE**  
SCEGGS DARLINGHURST

DRAWING TITLE		
<b>TYPICAL DETAILS</b>		
PROJECT STAGE SSDA	DRAWING NUMBER L_7001	SHEET SIZE A1
PROJECT NUMBER 18549	DRAWING NUMBER L_7001	ISSUE A