

Number	Revision Description	Date

**PRELIMINARY**

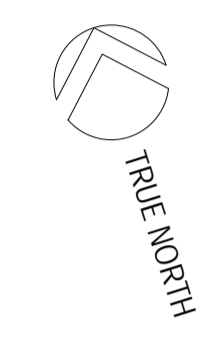
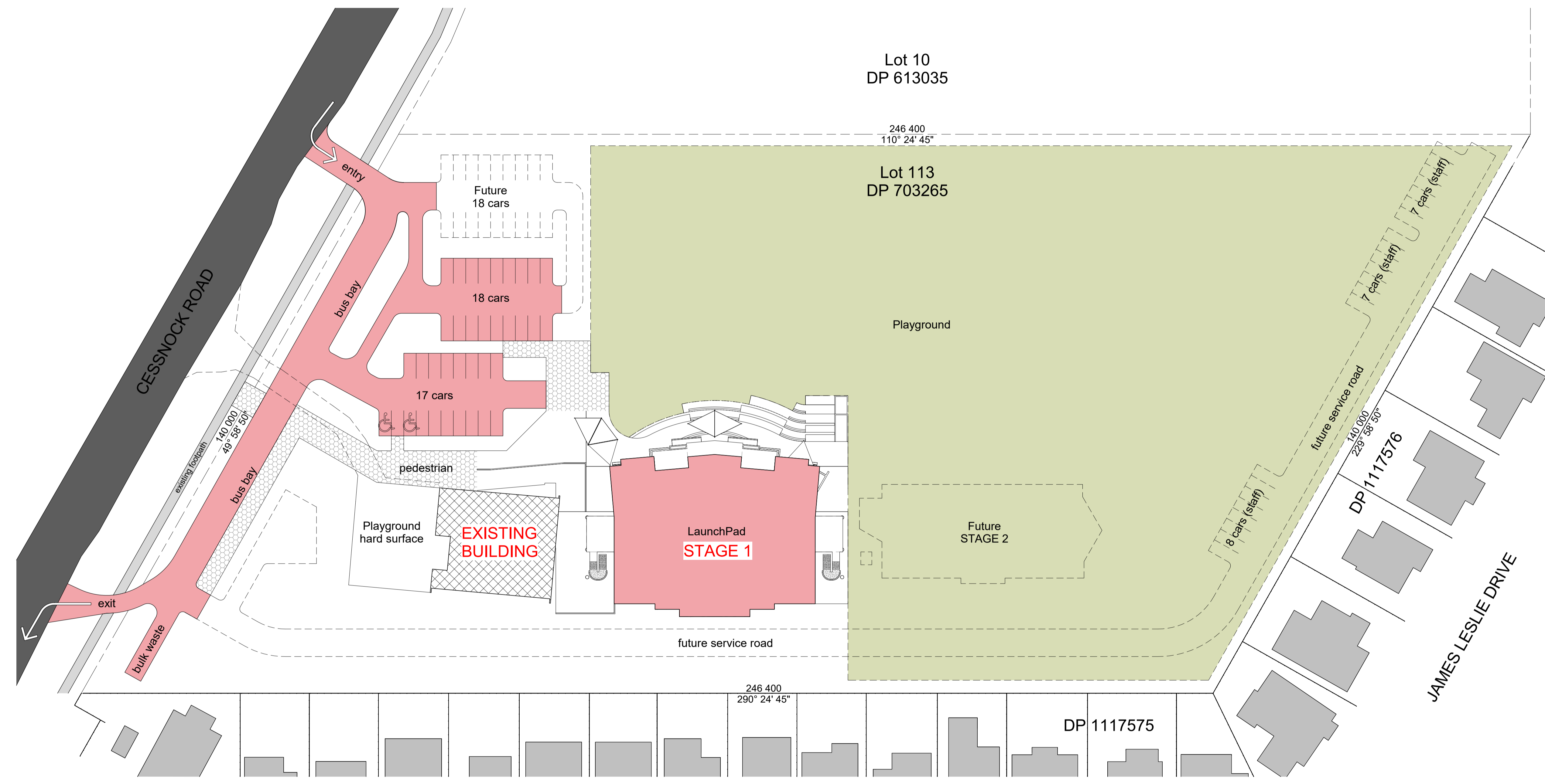

**SITE PLAN - STAGE 1**  
SCALE: 1:500

**LEGEND- STAGING**  
STAGE 1

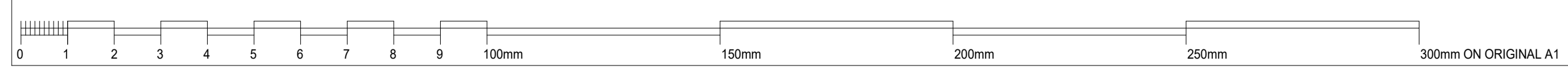

IF ANYTHING IS NOT CLEAR - DO NOT ASSUME  
PLEASE ASK THE ARCHITECT

**STEPHEN ROSE ARCHITECTS**  
A.B.N. 16 051 664 067  
T: (02) 4930 5688  
NOMINATED ARCHITECT  
NS.W. REGISTRATION: 4234  
6 SHIRAZ CLOSE HINTON NSW  
M: 0413 609 585

THESE DRAWINGS MUST BE READ IN CONJUNCTION WITH ALL OTHER DRAWINGS INCLUDING, BUT NOT LIMITED TO CIVIL, STRUCTURAL, ELECTRICAL, HYDRAULIC AND MECHANICAL DRAWINGS.

(C) Copyright  
The use of these drawings without the written permission of the Architects is an infringement of copyright.

**PROJECT**  
The Heights Learning Community - Master Plan

**CLIENT**  
SDA Schools

**SITE**  
209 Cessnock Road  
Gillieston Heights NSW

**SHEET REFERENCE**  
SITE PLAN - STAGE 1

WORK TO FIGURED DIMENSIONS ONLY  
CHECK ALL DIMENSIONS ON SITE

DRAWN	CURRENT REVISION	1
DATE	FEBRUARY 2021	SCALE As indicated
PROJECT NUMBER	ISSUE	DRAWING NUMBER
575	1	A30

PLOT DATE: 12/02/2021 12:33:39 PM

Number	Revision Description	Date
<b>PRELIMINARY</b>		

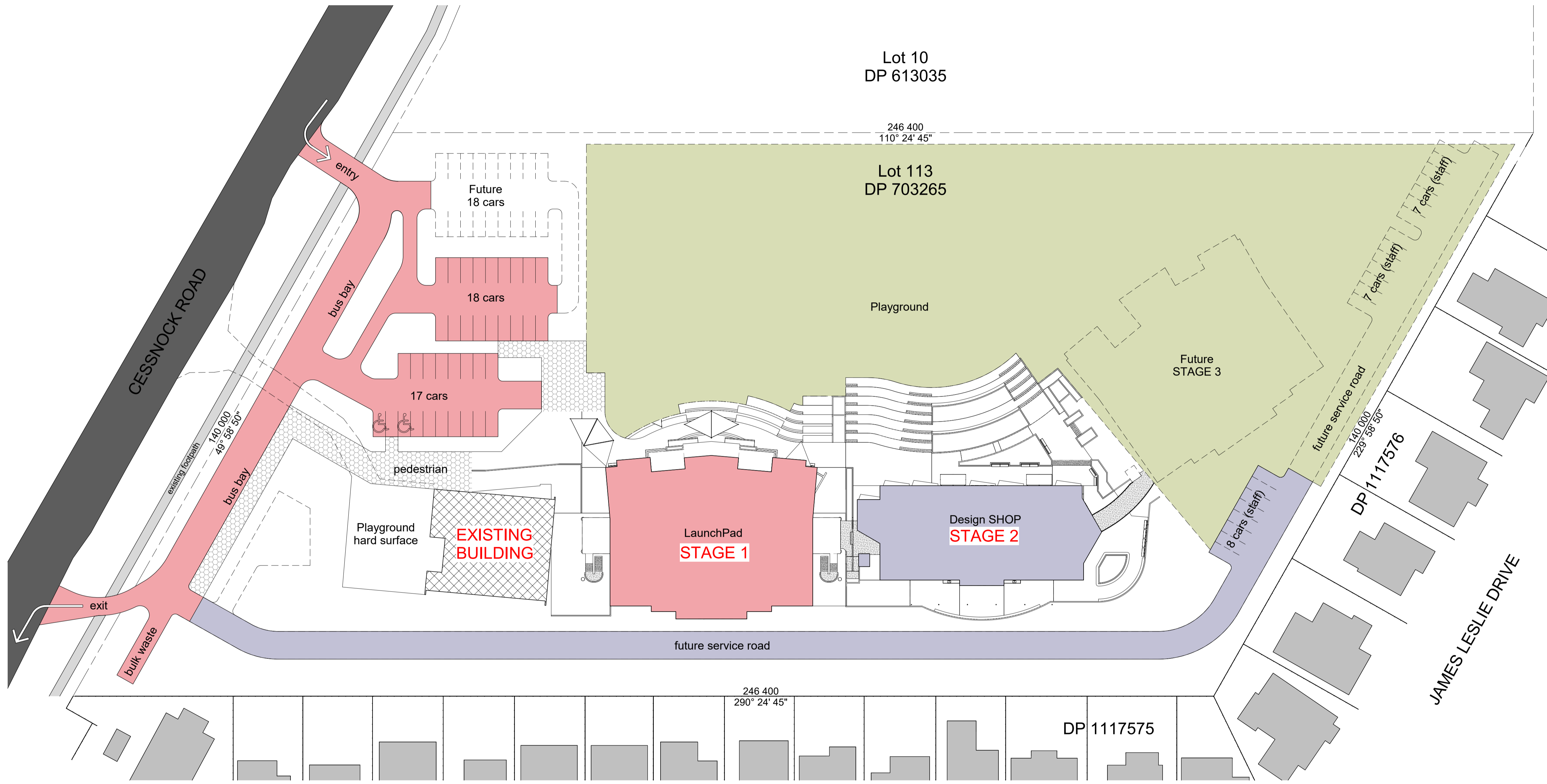

**SITE PLAN - STAGES 1 + 2**  
SCALE: 1 : 500

**LEGEND- STAGING**

STAGE 1

STAGE 2

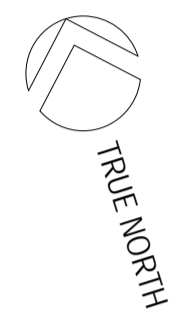
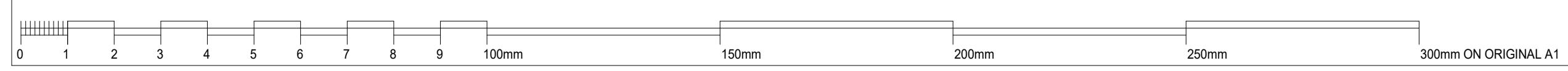

IF ANYTHING IS NOT CLEAR - DO NOT ASSUME  
PLEASE ASK THE ARCHITECT

**STEPHEN ROSE ARCHITECTS**  
A.B.N. 16 051 664 067  
T: (02) 4930 5688  
NOMINATED ARCHITECT  
NS.W. REGISTRATION: 4234  
6 SHIRAZ CLOSE HINTON NSW  
M: 0413 609 585

THESE DRAWINGS MUST BE READ IN CONJUNCTION WITH ALL OTHER DRAWINGS INCLUDING, BUT NOT LIMITED TO CIVIL, STRUCTURAL, ELECTRICAL, HYDRAULIC AND MECHANICAL DRAWINGS.

(C) Copyright  
The use of these drawings without the written permission of the Architects is an infringement of copyright.

**PROJECT**  
The Heights Learning Community - Master Plan

**CLIENT**  
SDA Schools

**SITE**  
209 Cessnock Road  
Gillieston Heights NSW

**SHEET REFERENCE**  
SITE PLAN - STAGES 1 + 2

WORK TO FIGURED DIMENSIONS ONLY  
CHECK ALL DIMENSIONS ON SITE

DRAWN	CURRENT REVISION	1
DATE	FEBRUARY 2021	SCALE As indicated
PROJECT NUMBER	ISSUE	DRAWING NUMBER
575	1	A31

PLOT DATE: 12/02/2021 12:34:49 PM

Number	Revision Description	Date

**PRELIMINARY**

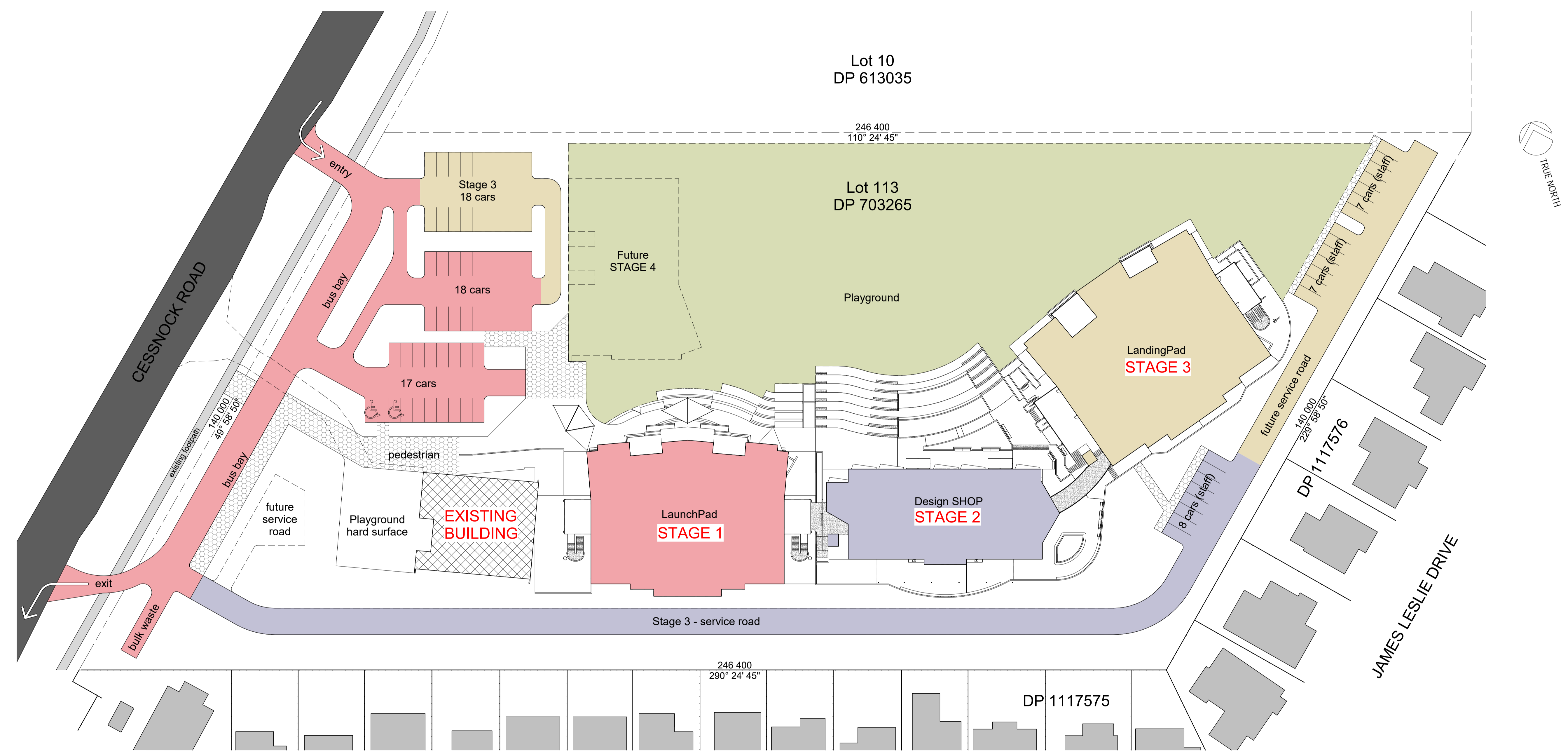

**SITE PLAN - STAGES 1 to 3**  
SCALE: 1 : 500

**LEGEND- STAGING**

- STAGE 1
- STAGE 2
- STAGE 3

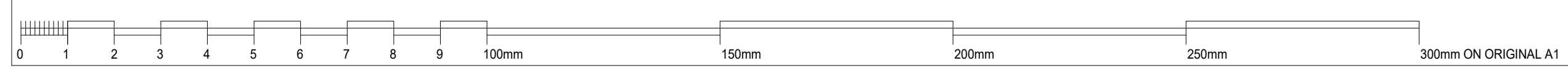

IF ANYTHING IS NOT CLEAR - DO NOT ASSUME  
PLEASE ASK THE ARCHITECT

**STEPHEN ROSE ARCHITECTS**  
A.B.N. 16 051 664 067  
T: (02) 4930 5688  
NOMINATED ARCHITECT  
NS.W. REGISTRATION: 4234  
6 SHIRAZ CLOSE HINTON NSW  
M: 0413 609 585

THESE DRAWINGS MUST BE READ IN CONJUNCTION WITH ALL OTHER DRAWINGS INCLUDING, BUT NOT LIMITED TO CIVIL, STRUCTURAL, ELECTRICAL, HYDRAULIC AND MECHANICAL DRAWINGS.

(C) Copyright  
The use of these drawings without the written permission of the Architects is an infringement of copyright.

**PROJECT**  
The Heights Learning Community - Master Plan

**CLIENT**  
SDA Schools

**SITE**  
209 Cessnock Road  
Gillieston Heights NSW

**SHEET REFERENCE**  
SITE PLAN - STAGES 1 to 3

WORK TO FIGURED DIMENSIONS ONLY  
CHECK ALL DIMENSIONS ON SITE

DRAWN	CURRENT REVISION	1
DATE	FEBRUARY 2021	SCALE As indicated
PROJECT NUMBER	ISSUE	DRAWING NUMBER
575	1	A32

PLOT DATE: 12/02/2021 12:41:14 PM

Number	Revision Description	Date
<b>PRELIMINARY</b>		



**SITE PLAN - STAGES 1 to 4**  
SCALE: 1:500

**LEGEND- STAGING**

- STAGE 1
- STAGE 2
- STAGE 3
- STAGE 4

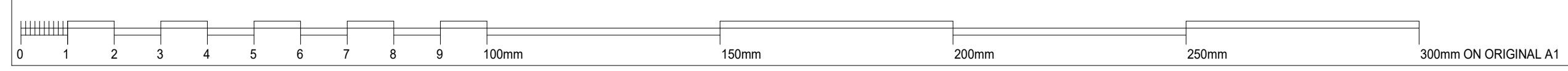

IF ANYTHING IS NOT CLEAR - DO NOT ASSUME  
PLEASE ASK THE ARCHITECT

**STEPHEN ROSE ARCHITECTS**  
A.B.N. 16 051 664 067  
T: (02) 4930 5688  
NOMINATED ARCHITECT  
NS.W. REGISTRATION: 4234  
6 SHIRAZ CLOSE HINTON NSW  
M: 0413 609 585

THESE DRAWINGS MUST BE READ IN CONJUNCTION WITH ALL OTHER DRAWINGS INCLUDING, BUT NOT LIMITED TO CIVIL, STRUCTURAL, ELECTRICAL, HYDRAULIC AND MECHANICAL DRAWINGS.

(C) Copyright  
The use of these drawings without the written permission of the Architects is an infringement of copyright.

**PROJECT**  
The Heights Learning Community - Master Plan

**CLIENT**  
SDA Schools

**SITE**  
209 Cessnock Road  
Gillieston Heights NSW

**SHEET REFERENCE**  
SITE PLAN - STAGE 1 to 4

WORK TO FIGURED DIMENSIONS ONLY  
CHECK ALL DIMENSIONS ON SITE

DRAWN	CURRENT REVISION	Checker
DATE	FEBRUARY 2021	SCALE As indicated
PROJECT NUMBER	ISSUE	DRAWING NUMBER
575	1	A33

PLOT DATE: 12/02/2021 12:42:04 PM

Number	Revision Description	Date

**PRELIMINARY**

**LEGEND- STAGING**

- STAGE 1
- STAGE 2
- STAGE 3
- STAGE 4
- STAGE 5

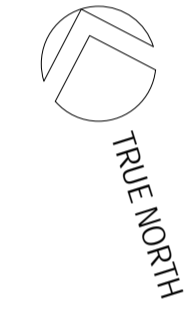
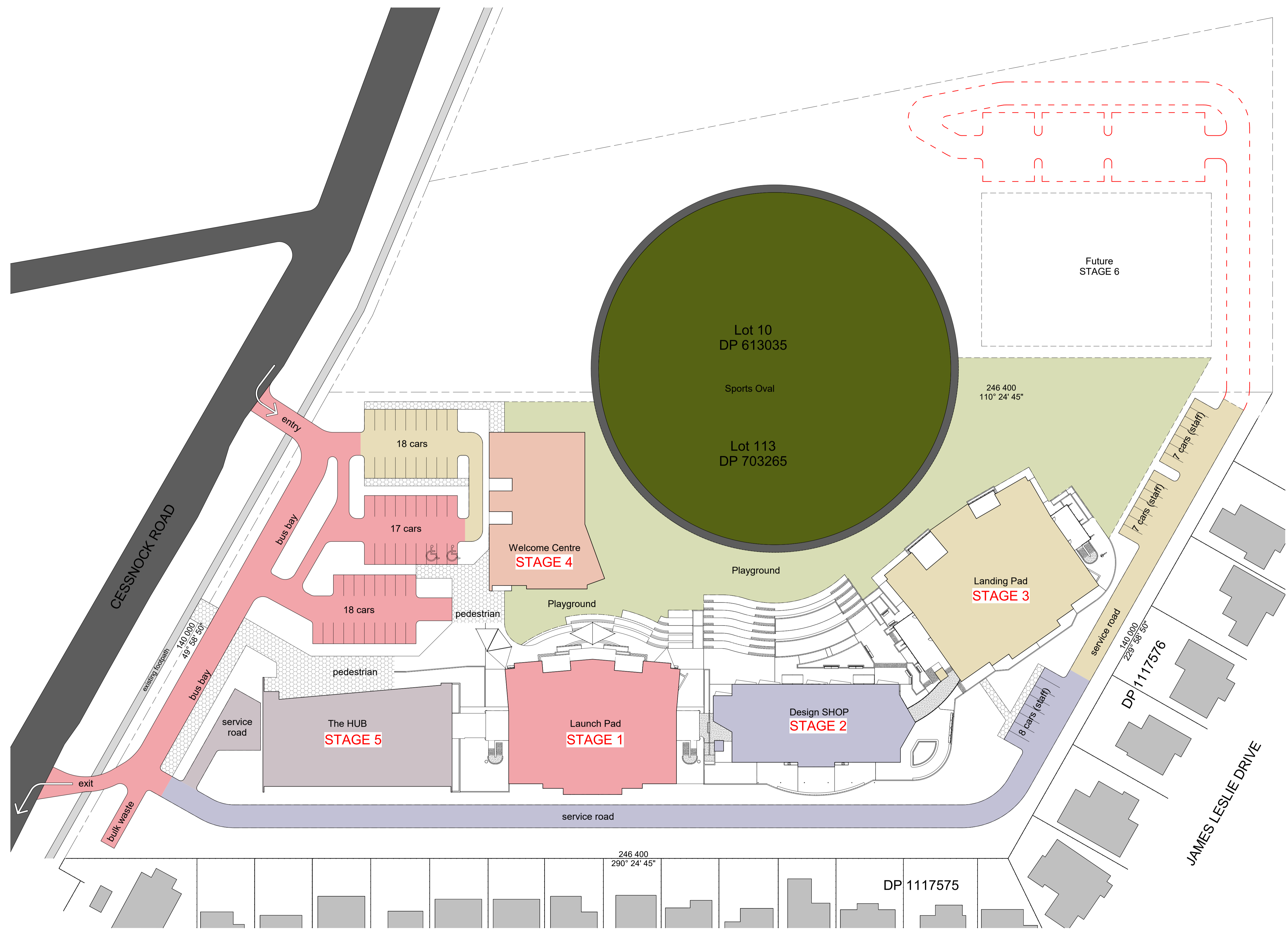

**SITE PLAN - STAGES 1 to 5**  
SCALE: 1:500

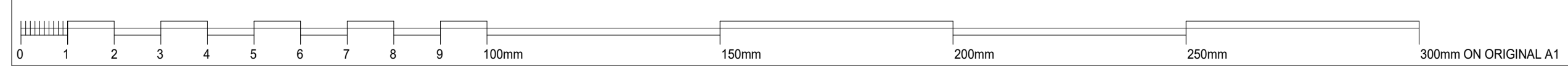

IF ANYTHING IS NOT CLEAR - DO NOT ASSUME  
PLEASE ASK THE ARCHITECT

**STEPHEN ROSE ARCHITECTS**  
A.B.N. 16 051 664 067  
T: (02) 4930 5688  
NOMINATED ARCHITECT  
NS.W. REGISTRATION: 4234  
6 SHIRAZ CLOSE HINTON NSW  
M: 0413 609 585

THESE DRAWINGS MUST BE READ IN CONJUNCTION  
WITH ALL OTHER DRAWINGS INCLUDING, BUT NOT  
LIMITED TO CIVIL, STRUCTURAL, ELECTRICAL,  
HYDRAULIC AND MECHANICAL DRAWINGS.

(C) Copyright  
The use of these drawings without the written permission  
of the Architects is an infringement of copyright.

**PROJECT**  
**The Heights Learning  
Community - Master Plan**

**CLIENT**  
**SDA Schools**

**SITE**  
**209 Cessnock Road  
Gillieston Heights NSW**

**SHEET REFERENCE**  
**SITE PLAN - STAGES 1  
to 5**

WORK TO FIGURED DIMENSIONS ONLY  
CHECK ALL DIMENSIONS ON SITE

DRAWN	CURRENT REVISION	1
DATE	FEBRUARY 2021	SCALE As indicated
PROJECT NUMBER	ISSUE	DRAWING NUMBER
<b>575</b>	<b>1</b>	<b>A34</b>

PLOT DATE: 12/02/2021 12:42:48 PM

Number	Revision Description	Date

preliminary

LEGEND- STAGING

- STAGE 1
- STAGE 2
- STAGE 3
- STAGE 4
- STAGE 5
- STAGE 6

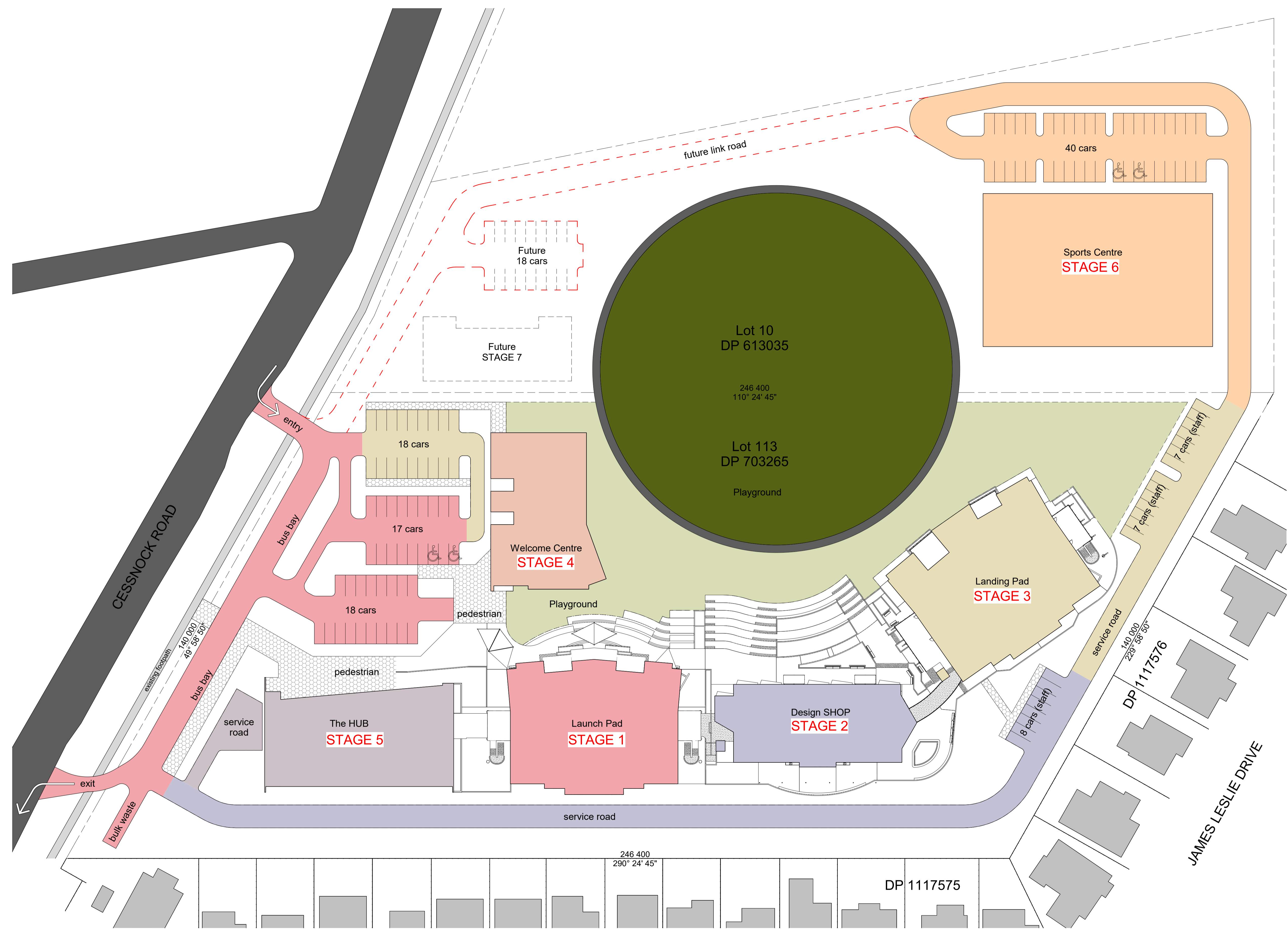
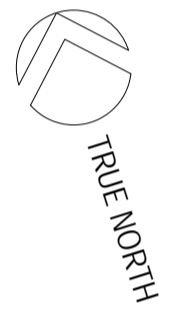

SITE PLAN - STAGES 1 to 5  
SCALE: 1:500

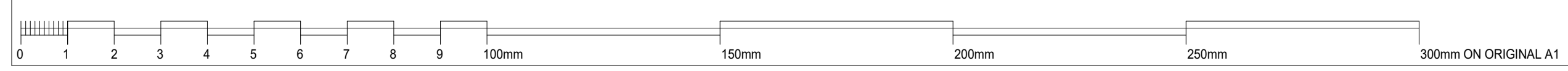

IF ANYTHING IS NOT CLEAR - DO NOT ASSUME  
PLEASE ASK THE ARCHITECT

**STEPHEN ROSE ARCHITECTS**  
A.B.N. 16 051 664 067  
T: (02) 4930 5688  
NOMINATED ARCHITECT  
NS.W. REGISTRATION 4234  
6 SHIRAZ CLOSE HINTON NSW  
M: 0413 609 585

THESE DRAWINGS MUST BE READ IN CONJUNCTION  
WITH ALL OTHER DRAWINGS INCLUDING, BUT NOT  
LIMITED TO CIVIL, STRUCTURAL, ELECTRICAL,  
HYDRAULIC AND MECHANICAL DRAWINGS.

(C) Copyright  
The use of these drawings without the written permission  
of the Architects is an infringement of copyright.

PROJECT  
**The Heights Learning  
Community - Master Plan**

CLIENT  
**SDA Schools**

SITE  
**209 Cessnock Road  
Gillieston Heights NSW**

SHEET REFERENCE  
**SITE PLAN - STAGES 1  
to 6**

WORK TO FIGURED DIMENSIONS ONLY  
CHECK ALL DIMENSIONS ON SITE

DRAWN	CURRENT REVISION	1
DATE	FEBRUARY 2021	SCALE As indicated
PROJECT NUMBER	ISSUE	DRAWING NUMBER
<b>575</b>	<b>1</b>	<b>A35</b>

PLOT DATE: 12/02/2021 12:43:39 PM

Number	Revision Description	Date

**PRELIMINARY**

**LEGEND- STAGING**

- STAGE 1
- STAGE 2
- STAGE 3
- STAGE 4
- STAGE 5
- STAGE 6
- STAGE 7

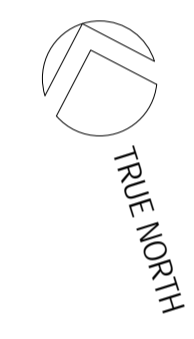
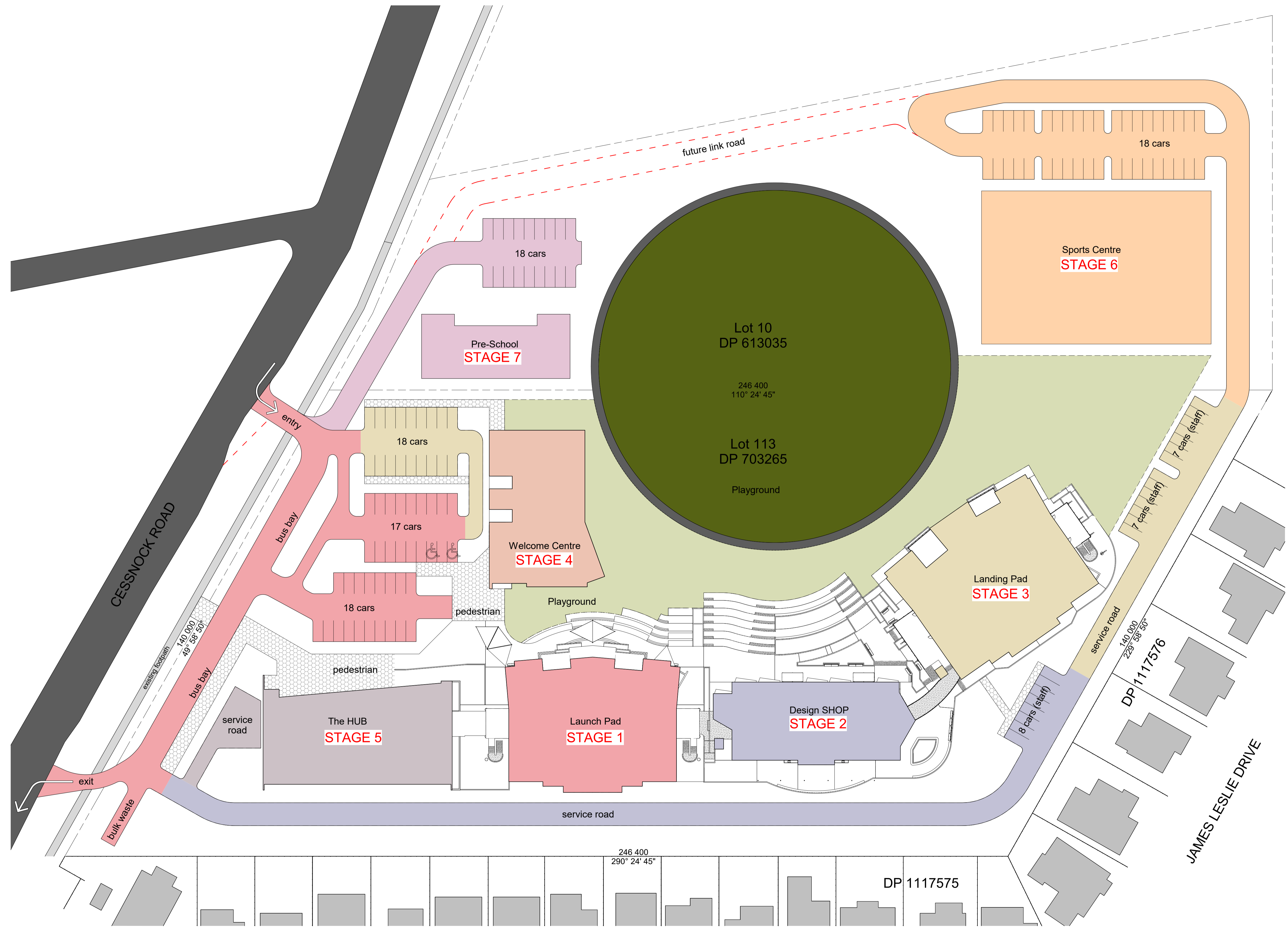

IF ANYTHING IS NOT CLEAR - DO NOT ASSUME  
PLEASE ASK THE ARCHITECT

**STEPHEN ROSE ARCHITECTS**  
 A.B.N. 16 051 664 067  
 T: (02) 4930 5688  
 NOMINATED ARCHITECT  
 NS.W. REGISTRATION: 4234  
 6 SHIRAZ CLOSE HINTON NSW  
 M: 0413 609 585

THESE DRAWINGS MUST BE READ IN CONJUNCTION WITH ALL OTHER DRAWINGS INCLUDING, BUT NOT LIMITED TO CIVIL, STRUCTURAL, ELECTRICAL, HYDRAULIC AND MECHANICAL DRAWINGS.

(C) Copyright  
The use of these drawings without the written permission of the Architects is an infringement of copyright.

**PROJECT**  
The Heights Learning Community - Master Plan

CLIENT  
**SDA Schools**

SITE  
**209 Cessnock Road  
Gillieston Heights NSW**

SHEET REFERENCE  
**SITE PLAN - STAGES 1 to 7**

WORK TO FIGURED DIMENSIONS ONLY  
CHECK ALL DIMENSIONS ON SITE

DRAWN	CURRENT REVISION	1
DATE	FEBRUARY 2021	SCALE As indicated
PROJECT NUMBER	ISSUE	DRAWING NUMBER
<b>575</b>	<b>1</b>	<b>A36</b>

PLOT DATE: 12/02/2021 12:44:26 PM

**SITE PLAN - STAGES 1 to 5**  
SCALE: 1:500

