



Education



Wentworth Point High School
(formerly known as Sydney Olympic Park new high school)

Construction & Operational Staging Plan (SSD-11802230 MOD 2)

November 2024

CONTENTS

1. **Summary**
2. **Construction & Operational Staging**
 - 2.1 Stage 1 – Gymnasium, sports court and fencing
 - 2.2 Stage 2 – Landscaping
 - 2.3 Stage 3 – Sports court and bicycle storage

1. Summary

The site is located within an area included in a Concept development application by Landcom, being DA-40/2015 which was approved on 17 February 2016 by the Sydney West Joint Regional Planning Panel and included Ridge Road within the school site. The Concept DA was modified under DA/875/2017/A in November 2024 but did not amend the location of Ridge Road within the school site. Since approval of SSD-11802230, Landcom lodged another modification and was granted approval by the Sydney Central City Planning Panel on 3 May 2024, which included relocation of Ridge Road outside of the school boundary (DA/875/2017/B) and has increased the site area available to the school.

This Staging Report supports the modification application of SSD-11802230 modification 2 (SSD-11802230-MOD-2). SSD-11802230-MOD-2 seeks modifications to enable the efficient use of space at Wentworth Point High School, made available as a result of the relocation of Ridge Road outside of the project boundaries under DA/875/2017/B, and includes a new gymnasium, sports court and landscaped area where Ridge Road was previously located.

The Wentworth Point High School received a Section 6.28 certificate from the Certifier in June 2024 and is on track to commence operation with Year 7 only (approx. 200 students) by day 1 term 1 2025. The works proposed as part of modification 2 are expected to be complete by 2026, meaning only 200 students need to be catered for during the construction of these works. That is, the school will not be at full capacity during the construction of modification 2 works and the available open place area per student will be maintained as approved in SSD-11802230 throughout the staged construction and operation.

The works proposed as part of SSD-11802230-MOD-2 can be managed appropriately in conjunction with the operation of the school through measures outlined in this Staging Report.

The modification also seeks to update conditions so that construction and operation can be staged, including that the Construction Environmental Management Plan (CEMP), including sub-plans such as the Noise and Vibration Management Sub-Plan and Construction Traffic and Pedestrian Management Sub-Plan, will be updated prior to the commencement of each construction stage. These plans will address critical aspects including hours of work, site management details, dust and odour management, lighting compliance, aviation operation measures, and community consultation protocols, in accordance with conditions B13 through B19 of SSD-11802230 to support the ongoing safe and efficient operation of the school.

Figure 1 outlines three sequential construction phases, each represented by different colours:

1. Red area – gymnasium construction, and purple area – Sports court and fencing
2. Orange area – Landscaping
3. Green areas – Sports court and bike storage

The 10-metre strip (Dark Green), running perpendicular to Burroway Road, will serve as a construction access route throughout the above construction stages, to minimise operational disruption.

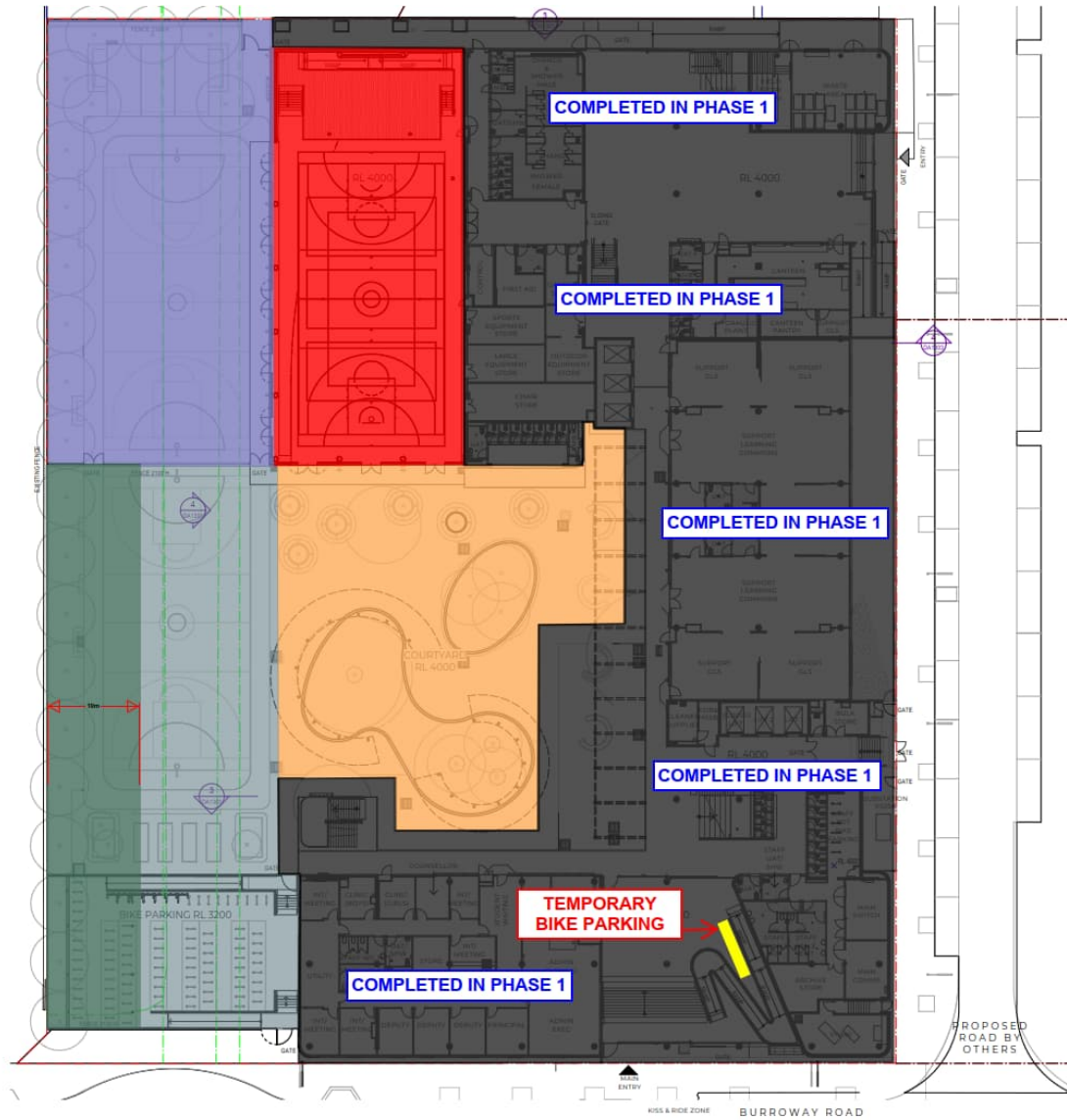

#	Revised	Description	Date
1	SSDA	SSDA	2/19/10
2	SSDA	SSDA	2/19/10
3	SSDA	SSDA	2/19/10
4	SSDA	SSDA	2/19/10
5	SSDA	SSDA	2/19/10
6	SSDA	SSDA	2/19/10
7	SSDA	SSDA	2/19/10
8	SSDA	SSDA	2/19/10
9	SSDA	SSDA	2/19/10
10	SSDA	SSDA	2/19/10

Notes:
 Copyright © Woods Bagot 2010
 All rights reserved.
 No part of this document may be reproduced without prior permission.
 Contractors must verify all dimensions on site before commencing work or proceeding with change.
 Do not scale drawings.

THIS DRAWING IS THE RESULT OF THE FINAL SITE CONSTRUCTION DOCUMENTS. UPDATES TO REFLECT ANY CHANGES DURING CONSTRUCTION OF THE BUILDING. CLIENTS TAKE WITH ACCURACY BUILDING TOLERANCES, INCREASING ETC. AND MAY NOT REFLECT ACTUAL BUILDING CONDITIONS.

Project:
 SYDNEY OLYMPIC PARK HIGH SCHOOL

W-B
 WOODS BAGOT

Project Number: 121566
 Drawing: MH CS A1
 Scale: 1:200

Client: SSDA
 Drawing Title: Proposed Ground Plan

Sheet Number: SOPHS-WB-AR-DA1200
 Sheet: SSDA

Figure 1 - Conceptual construction staging

2. Construction & Operational Staging

A strip running perpendicular to Burroway Road will serve as a construction access route throughout all construction stages, to minimise disruption to the live school. Appropriate hoardings will be maintained at all times along the construction site boundary, to segregate the work area from the operational school.

2.1. Stage 1 - Gymnasium, sports court and fencing

Figure 2 illustrates the first stage construction, highlighted in red and purple, that involves constructing the gymnasium, one sports court and associated fencing. Impacts to operation during this stage will be minimal via the implementation of the following:

- A-Class plywood hoarding to be utilised to segregate the construction site from the operational school.
- All structural works will be completed from within the construction site.
- Services connections to the existing building to be completed outside school hours where possible.
- Interim bike parking to be made available in the secure entry area in Figure 1.

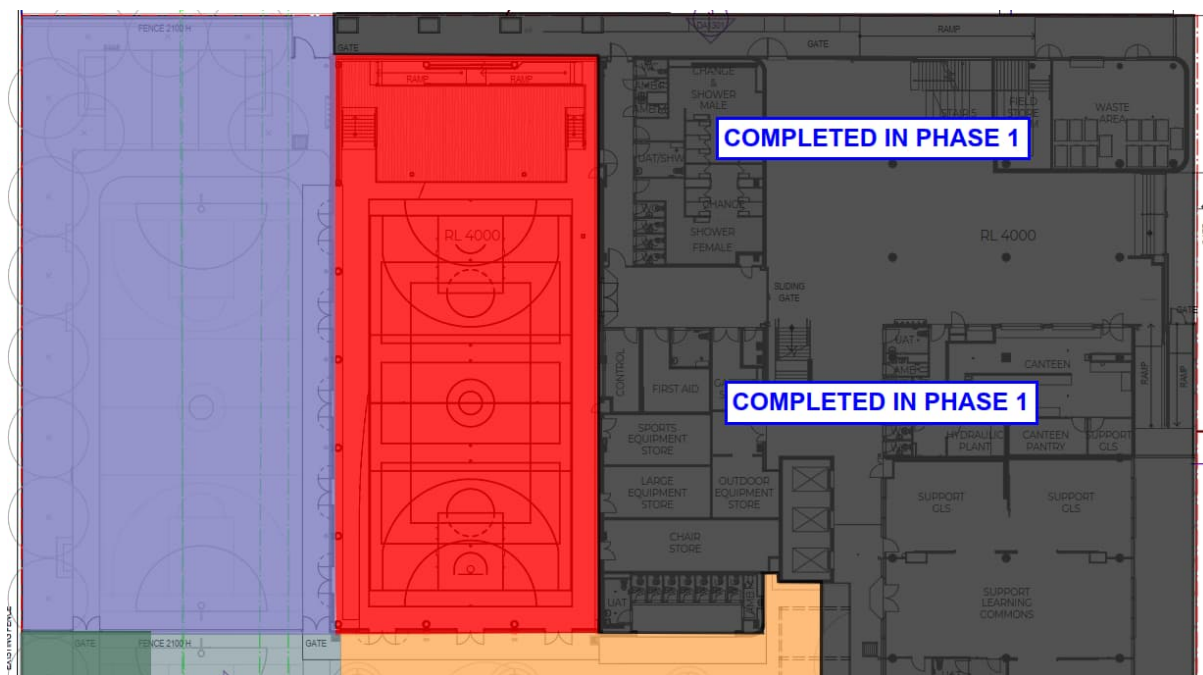

Figure 2 - Construction stage 1

Upon completion of this stage and receipt of Section 6.28 certificate from the Certifier, students will have access to an enclosed space (gymnasium) and sports court for adequate open space, as highlighted in blue in Figure 3.

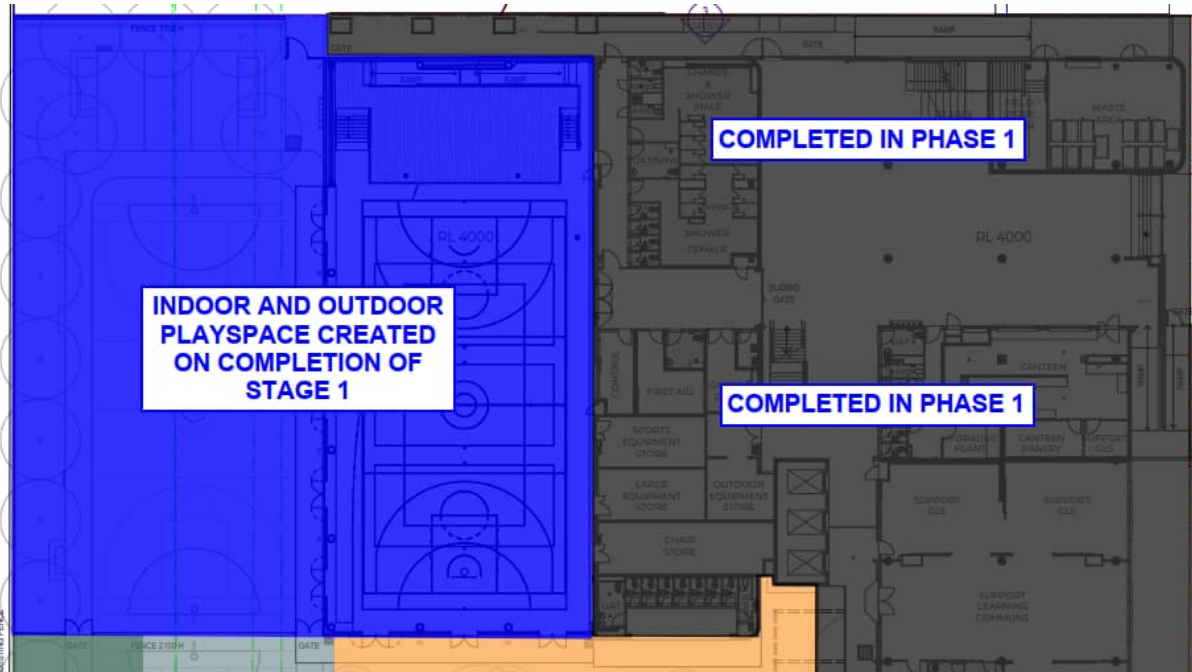

Figure 3 - Available play space on completion of stage 1

2.2. Stage 2 – Landscaping

The second stage focuses on landscaping within the central courtyard. The same controls proposed in Stage 1 construction will be used in Stage 2 to minimise impacts to the operational school during this stage.

Upon completion of this stage and receipt of Section 6.28 certificate from the Certifier, the central courtyard would be available for use by students as open space. Refer blue highlight in Figure 4 for the total open space available on completion of Stage 2.

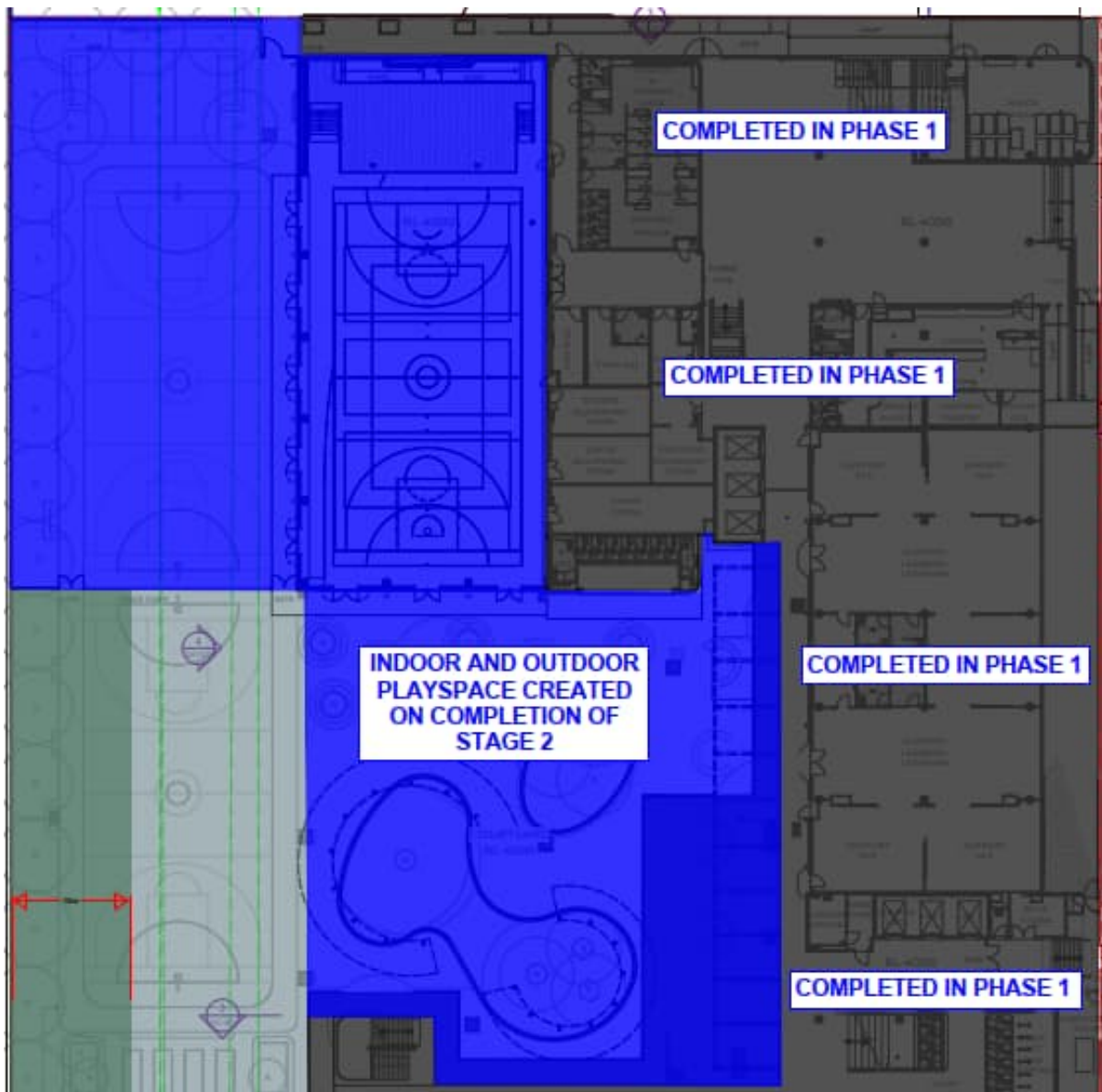

Figure 4 - Available play space on completion of stage 2

2.3. Stage 3 – Sports court and bicycle storage

The third stage focuses on a second sports court and bicycle storage area. The same controls proposed in Stage 1 and 2 construction will be used in Stage 3 to minimise impacts to the operational school during this stage (refer blue highlight in Figure 5). Upon completion of Stage 3 construction works, the entirety of the school will be operational.

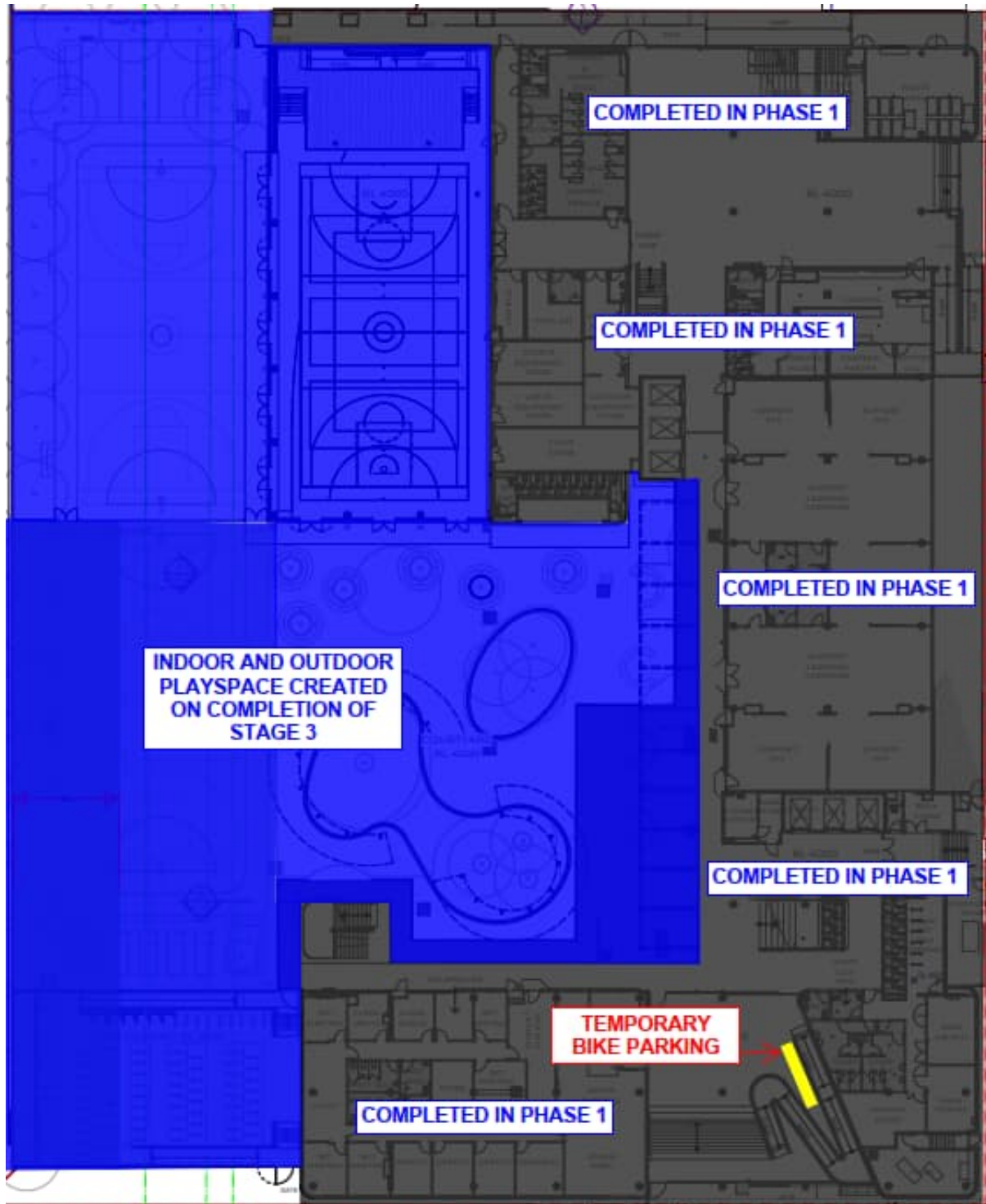

Figure 5 - Available play space on completion of stage 3