

**ANGEL PLACE
LEVEL 8, 123 PITT STREET
SYDNEY NSW 2000**

URBIS.COM.AU
Urbis Pty Ltd
ABN 50 105 256 228

02 June 2022

Assessment Officer
Department of Planning & Environment
4 Parramatta Square, 12 Darcy Street
Parramatta NSW 2150

RE: SSD-11802230 SYDNEY OLYMPIC PARK NEW HIGH SCHOOL SSDA AMENDMENT REPORT ON LANDSCAPE DESIGN

Urbis prepared the original Landscape Design Report for the Sydney Olympic Park new high school dated 24 March 2022.

Urbis has considered the SDRP's previous comments in the design of the amended proposal and confirm that the proposal continues to respond positively to the issues raised by SDRP, noting that not all of the SDRP's comments remain relevant given the reduced scope of the design. Please refer to the attached extract from our original design report (Appendix D).

The amended design continues to provide for a high-quality school development with a series of diverse, inclusive and interconnected learning and play spaces that foster a connection to nature, and appropriate interfaces to the surrounding built form.

The amended design attached to this statement includes the following changes:

- Reduction of external space including the deletion of one multipurpose court, reduced central courtyard area and removal of the large raised lawn area;
- Additional handball courts and
- Removal of the western boundary ecological planter.

The design previously considered by SDRP remains the future intended outcome for the site, while the amended design described in this addendum statement is the first and primary step in achieving that outcome.



APPENDICES

SDRP Comments on Reference Scheme by GroupGSA (note – the responses provided are by Urbis in relation to the current proposal. Although the comments were directed towards a different scheme, most are still valid).

SDRP Comments	Urbis' Response
Planting palettes -provide a palette that represents a living connection to Country, for example including species from the local salt marsh ecology. Incorporate this palette at active and passive outdoor learning spaces.	<p>The Urbis planting selection for the site has been chosen to be sensitive of local ecosystems, with a majority of species being chosen from within local communities including endangered communities of the Sydney Turpentine-Ironbark Forest and Swamp-oak Floodplain Forest that are endemic to the area around Wentworth Point and Sydney Olympic Park.</p> <p>Specialised planting has also been incorporated for the use on a green roof and the edible garden. Within these groupings there are native and endemic species that can contribute to education within the school and local community, such as the inclusion of native food sources within the edible garden.</p>
<p>Ecological healing and restoration – these ambitions are not evident in the concept design. Integrate ecological aspirations with a project-wide approach to connecting with Country. The following opportunities are recommended for their capacity to make manifest the attributes of Country:</p> <ul style="list-style-type: none"> - Plant species that support and restore local bio-diversity and ecology - The site's use and treatment of water. 	<p>See above response.</p> <p>The intention is the local plant communities including endangered plant communities are incorporated into the sitewide planting design.</p> <p>Water Treatment Strategies include:</p> <ul style="list-style-type: none"> - Water Sensitive Urban Design (WSUD) principals have been realised into the landscape design in a way that celebrates a sustainable water cycle. - Water Sensitive Urban Design (WSUD) principles have been realised into the landscape design in a way that celebrates a sustainable water cycle. - Where possible storm water runoff will be directed to the lawn and garden beds and - Rainwater tanks will be provided for irrigation. Irrigation will be provided to all soft landscape areas and will be specified within the tender package.

SDRP Comments on Current Proposal

SDRP Comments	Urbis' Response
Country	
2. Planting - Expand the use of endemic Indigenous plants beyond the single First Nations productive garden to be throughout the site. This is an opportunity for the landscape to be part of the pedagogy.	Endemic and indigenous species have been included into the planting palette, the intention is these species are incorporated into the overall sitewide planting design (not just the productive garden).
3. Green roof - Integrate endemic and Indigenous plants into the green roof and consider enabling monitored access to this area so that it can become part of the school.	Endemic and indigenous species have been included into the rooftop planting palette that can contribute to education within the school.
Landscape Strategy	
4. Communal courtyard – The practicality of using movable tree planters to create spatial flexibility is questioned and the creation of a sufficiently large outdoor gathering space is recommended.	<p>We have added a page that defines and describe the types of playground gathering spaces within the school grounds.</p> <p>We are providing a range of outdoor flexible gathering spaces for large, medium, and small gathering opportunities within the landscape design.</p> <p>The extra-large outdoor gathering spaces are provided to the multipurpose courts and between the internal gym and the adjacent external multipurpose sports court (refer to the playground gathering spaces diagram).</p> <p>The moveable tree planters have been replaced with permanent tree planters and seating benches/furniture to the northern edge of the central courtyard. These elements provide flexible spaces for small and medium size gatherings.</p>
5. Treecover - Provide detail on the proposed canopy cover percentage to provide comfort in relation to heat and other biophilic benefits.	<p>Within the site boundary the landscape design proposes a total of 38 new trees, offering a total green canopy cover of approximately 12%.</p> <p>The inclusion of architectural arbours and shade canopies increases this canopy cover to a total of 17%.</p> <p>Plus an additional 3% Ground Level COLA proposed by the architects.</p>

6. Planting palette – Provide more detail on plant selection at the next review.	<p>Refer to our Landscape Design Report for the Indicative Plant Schedule.</p> <p>Planting selection for the site has been chosen to be sensitive of local ecosystems, with a majority of species being chosen from within local communities including endangered communities of the Sydney Turpentine-Ironbark Forest and Swamp-oak Floodplain Forest that are endemic to the area around Wentworth Point and Sydney Olympic Park.</p> <p>Minimum soil depths are in accordance with both Council's and the 'Apartment Design Guide':</p> <ul style="list-style-type: none"> - Turf 200mm soil depth - Ground Cover 300-450mm soil depth - Shrubs 500-600mm soil depth - Small Trees (6-8m high) 800mm soil depth - Medium Trees (8-12m high) 1000mm soil depth - Large Trees (12-18m high) 1200-1500mm soil depth <p>All soil volumes are subject to review against tree species, location, desired effect and current industry best practice standards. An arborist or soil scientist will provide specific advice about the volume of soil that planting requires.</p>
Sustainability	
17. Green roofs – Consider the wider application of green roofs for the scheme, with particular focus on the increased efficacy of solar panels when combined with green roofs.	Refer to Architects report
Items to be provided	
1. A detailed landscape strategy including tree canopy cover and planting palette.	The landscape design strategy, confirmation of the tree canopy cover and planting palette have been provided in the landscape design report
3. Further development of considerations of Country particularly expansion of Indigenous planting and further integration of Aboriginal narratives in the building and built-form.	Endemic and indigenous species have been included into the planting palette, the intention is these species are incorporated into the overall sitewide planting design

LANDSCAPE CONCEPT DESIGN SITE PLAN

- LEGEND:
- 1 Main Arrival
 - 2 Amphitheatre Seating
 - 3 Central Courtyard
 - 4 North South Arbour
 - 5 Sports Court
 - 6 Raised Lawn Area
 - 7 Covered Bicycle + Scooter Stands / Parking
 - 8 Table Tennis
 - 9 Seated Tree Planter
 - 10 Community Arrival
 - 11 COLA Break Out Area
 - 12 Northern Access
 - 13 Seating Bench
 - 14 Free Play / Handball Courts
 - 15 Planting Buffer
 - 16 Moveable Furniture / Seating Elements
 - 17 Indicative Street Tree Planting



LANDSCAPE CONCEPT DESIGN SITE PLAN

LEGEND:

- ① Insitu Concrete Path
- ② Biodiversity Green Roof
- ③ Access Stairs



SYDNEY OLYMPIC PARK NEW HIGH SCHOOL

7-11 BURROWAY ROAD, WENTWORTH POINT NSW 2127

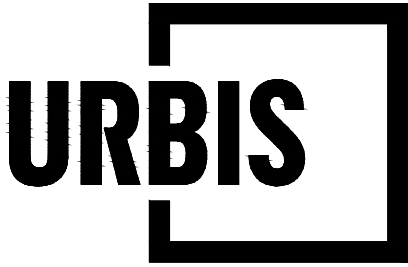

Level 14, The Quadrant, 1 William Street | Perth
WA 6000 Australia | +61 8 9346 0500
URBIS Pty Ltd | ABN 50 105 256 228

CLIENT
ROBERTS CO

KEY PLAN

DISCLAIMER
Copyright by Urbis Pty Ltd. This drawing or parts thereof may not be reproduced for any purpose or used for another project without the consent of Urbis other than reproduction for the purposes of actual ordering, supply, installation or construction. This drawing must be read in conjunction with all relevant contracts, schedules, specifications, drawings and any other issued written instructions. Do not scale from drawings. Written figured dimensions take preference to scaled dimension and must be verified on site before proceeding with any work. All discrepancies must be referred to the superintendent for a written decision prior to ordering, supply or installation. Urbis must be notified in writing of any discrepancies.

DRAWING REGISTER		
DRAWING NUMBER	DRAWING NAME	REVISION
L000	COVER SHEET	E
L001	PLANT SCHEDULE	E
L201	FINISHES PLAN	D
L221	FINISHES PLAN L2	C
L501	PLANTING PLAN GF	D
L521	PLANTING PLAN L2	C

LEGEND

GENERAL

	SITE BOUNDARY
	EXTENT OF PUBLIC DOMAIN WORKS
	EXISTING TREES TO BE REMOVED
	PROPOSED TREES
	SPOT LEVELS
	AR01: SCULPTURAL SHADE ARBOR STRUCTURE
	AR02: NORTH SOUTH ARBOR STRUCTURE
	STORMWATER PITS TO ENGINEERS DETAIL
	DR01: GRATED DRAIN TO ENGINEERS DETAIL
	EXTENT OF OSD TANK TO ENGINEERS DETAIL
	SWALE LOCATION

PAVEMENT TYPES

	PA01: TOPPING CONCRETE SLAB
	PA02: INSITU CONCRETE
	PA03: SPORTS COURTS SURFACE PAINT
	PA04: INSITU CONCRETE COLOUR OXIDE
	PA05: RUNNING TRACK SURFACE PAINT
	PA06: FEATURE GRAPHICS SURFACE PAINT
	PA07: PUBLIC DOMAIN FOOTPATH
	PA08: SYNTHETIC TURF SOCCERFIELD
	PA09: POROUS PAVEMENT
	PA10: TREE PIT POROUS PAVEMENT
	TA01: TACTILE INDICATORS

PLANTING TYPES

	TU1: NATURAL TURF FREE PLAY AREAS
	GA01: GARDEN BED PLANTING
	GA02: BIODIVERSITY ROOF
	GA03: FIRST NATIONS VEGGIE GARDEN
	GA04: GARDEN BED PLANTING

FENCE AND GATE TYPES

	FE01: 2.1m HIGH CENTRAL FENCE
	FE02: 2.4m HIGH SPORTS FIELD/ COURTS FENCE
	FE03: 1.2m HIGH SPORTS FIELD FENCE
	FE04: 2.1m HIGH DEMOUNTABLE FENCE
	FE05: 7m HIGH BARRIER FENCE

GATE TYPES

	GT01: 2.4m HIGH DOUBLE GATE
	GT02: 2.1m HIGH SINGLE GATE
	GT03: SWING/SLIDING GATE TO ARCHITECTS DETAIL
	GT04: 1.2m HIGH DOUBLE GATE

FURNITURE TYPES

	FU1A: FREESTANDING FURNITURE
	FU1B: FREESTANDING FURNITURE
	FU1C: FREESTANDING FURNITURE
	FU02: FREESTANDING FURNITURE
	FU03: TABLE TENNIS
	FU04: TREE PLANTER
	FU05: TIMBER SEATING
	FU6A: TIMBER SCULPTURAL SEATING BENCH TYPE A
	FU6B: TIMBER SCULPTURAL SEATING BENCH TYPE B BACKREST
	FU08: BICYCLE RACKS
	FU09: BASKETBALL + NETBALL HOOP
	FU10: SCOOTER RACKS
	FU11: SPORTS FIELD GOALS

WALLS AND EDGES

	WA01: WALL TYPE 1 CONCRETE SEATING WALL
	HA01: HANDRAIL TYPE 1

LIGHTING TYPES

	LI01: EXISTING STREET POLE LIGHTING
	LI02: PROPOSED STREET POLE LIGHTING

REV	DESCRIPTION	DWN	CHK	DATE
E	SSDA RTS RESUBMISSION	YV	MK	02/06/2022
D	SSDA RTS RESUBMISSION	YV	MK	01/06/2022
C	SSDA RTS RESUBMISSION	YV	MK	17/05/2022
B	SSDA RTS	YV	MK	25/02/2021
A	SSDA RTS	YV	MK	09/12/2021

PROJECT NAME & ADDRESS

**SYDNEY OLYMPIC PARK
NEW HIGH SCHOOL**

PROJECT DIRECTOR: MK

DRAWING TITLE
COVER SHEET

ISSUE
SSDA

PROJECT NO.
P0033179

SCALE

DRAWING NO.

L000

REVISION

E

PLOT STYLE: URBIS_A1.CTB
PAGE SETUP: ---
PLOTTED BY: YEN VU
PLOT DATE: 02.06.2022
PATH: J:\National Design\04 PROJECTS\P00303179 Sydney Olympic Park High School\10_Construction Docs\4.02_CAD\Layouts\SSDA\L001 - RIDGE ROAD.dwg

GROUND FLOOR PLANT SCHEDULE

Trees

Key	Botanic Name	Common Name	Size	Pot	Spacing	Qty.
COR mac	Corymbia maculata	Spotted Gum	25m x 10m	400L	AS SHOWN	2
ELA ret	Elaeocarpus reticulatus	Blueberry Ash	10m x 5m	400L	AS SHOWN	36
MEL eri	Melaleuca ericifolia	Swamp Paperbark	9m x 5m	400L	AS SHOWN	5
PIT und	Pittosporum undulatum	Native Daphne	12m x 7m	400L	AS SHOWN	2
TRI lus	Tristaniopsis 'Luscious'	Water Gum	15m x 7m	400L	AS SHOWN	1

Shrubs

Key	Botanic Name	Common Name	Size	Pot	Spacing	Qty.
BLE ind	Blechnum indicum	Silver Lady Fern	0.9m x 1.2m	300mm	500 mm	107
CRI ped	Crinum pedunculatum	Swamp Lily	1.5m x 1m	200mm	500 mm	96
CYC rev	Cycas revoluta	Sago Palm	2m x 2m	200mm	500 mm	21
KUN amb	Kunzea ambigua	White Kunzea	3m x 2m	200mm	580 mm	28
MEL cla	Melaleuca 'Claret Tops'	Honey Myrtle	1.2m x 1m	200mm	500 mm	38
PHI xan	Philodendron 'Xanadu'	Philodendron Xanadu	0.7m x 1m	200mm	500 mm	96
SYZ smi	Syzigium smithii	Lilli Pilli	5m x 2.5m	45L	580 mm	111
VIO ban	Viola banksii	Native Violet	0.1m x 0.3m	140mm	290 mm	217

Groundcovers

Key	Botanic Name	Common Name	Size	Pot	Spacing	Qty.
CHR api	Chrysocephalum apiculatum	Yellow Buttons	0.3m X 0.5m	200mm	410 mm	52
DIA cae	Dianella caerulea	Flax Lily	0.4m x 0.4m	200mm	410 mm	119
DIC rep	Dichondra repens	Kidney Weed	0.1m x 0.5m	140mm	350 mm	47
HAR vio	Hardenbergia violacea	Native sarsaparilla	1m x 1.5m	200mm	410 mm	36
LOM tan	Lomandra 'Tanika'	Lomandra Tanika	0.5m x 0.5m	200mm	410 mm	64
MYO par	Myoporum parvifolium	Creeping Myoporum	0.3m x 1.5m	140mm	350 mm	44
SAN tri	Sansevieria trifasciata	Mother in Laws Tongue	0.5m x 0.3m	200mm	350 mm	127

LEVEL 2 PLANT SCHEDULE

BIODIVERSITY GREEN ROOF

KEY	BOTANIC NAME	COMMON NAME	SIZE	POT	SPACING	QTY.
CAR gla	Carpobrutus glaucescens	Pigface	0.3m x 1.5m	140mm	350 mm	227
DIC rep	Dichondra repens	Kidney Weed	0.1m x 0.5m	140mm	350 mm	341
GOO hed	Goodenia hederacea	Forest Goodenia	0.2m x 0.8m	140mm	350 mm	341
KEN rub	Kennedia rubicunda	Dusky Coral Pea	0.2m x 1m	140mm	350 mm	341
MYO par	Myoporum parvifolium	Creeping Myoporum	0.3m x 1.5m	140mm	350 mm	227
OXA exi	Oxalis exilis	Yellow Sorrel	0.1m x 0.3m	140mm	350 mm	227
PRA pur	Pratia purpurascens	Purple Pratia	0.2m x 0.5m	140mm	350 mm	341
VIO ban	Viola banksii	Native Violet	0.1m x 0.3m	140mm	350 mm	227

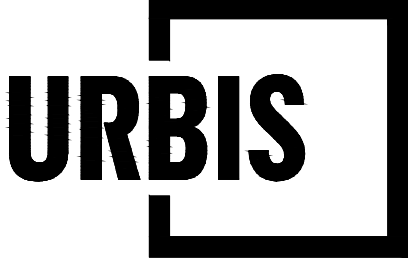

Level 14, The Quadrant, 1 William Street | Perth
WA 6000 Australia | +61 8 9346 0500
URBIS Pty Ltd | ABN 50 105 256 228

CLIENT
ROBERTS CO

-
-

KEY PLAN

DISCLAIMER

Copyright by Urbis Pty Ltd. This drawing or parts thereof may not be reproduced for any purpose or used for another project without the consent of Urbis other than reproduction for the purposes of actual ordering, supply, installation or construction. This drawing must be read in conjunction with all relevant contracts, schedules, specifications, drawings and any other issued written instructions. Do not scale from drawings. Written figured dimensions take preference to scaled dimension and must be verified on site before proceeding with any work. All discrepancies must be referred to the superintendent for a written decision prior to ordering, supply or installation. Urbis must be notified in writing of any discrepancies.

.....
.....
.....
.....
.....
D	SSDA RTS RESUBMISSION	YV	MK	01/06/2022
C	SSDA RTS RESUBMISSION	YV	MK	17/05/2022
B	SSDA RTS	YV	MK	25/02/2021
A	SSDA RTS	YV	MK	09/12/2021
REV	DESCRIPTION	DWN	CHK	DATE

PROJECT NAME & ADDRESS

SYDNEY OLYMPIC PARK
NEW HIGH SCHOOL

PROJECT DIRECTOR: MK

DRAWING TITLE
PLANT SCHEDULE

ISSUE
SSDA

PROJECT NO.
P0033179

SCALE

DRAWING NO.

L001

REVISION

D

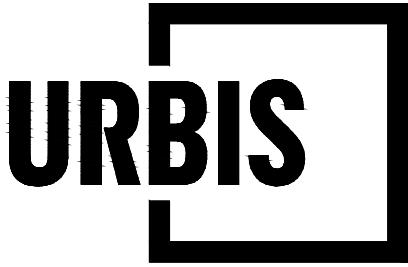
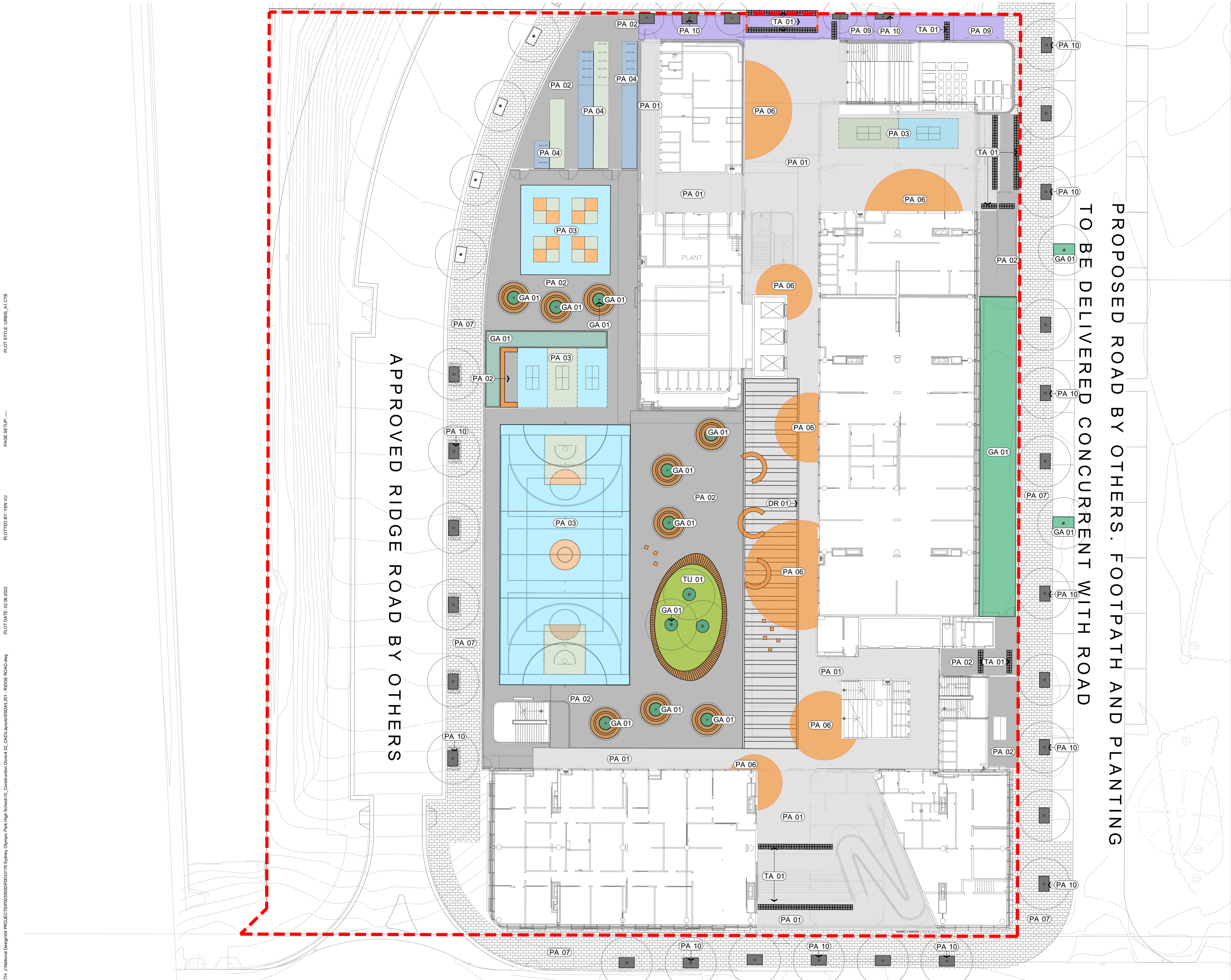

Level 14, The Quadrant, 1 William Street | Perth
WA 6000 Australia | +61 8 9346 0500
URBIS Pty Ltd | ABN 50 105 256 228

CLIENT
ROBERTS CO

#

KEY PLAN

DISCLAIMER
Copyright by Urbis Pty Ltd. This drawing or parts thereof may not be reproduced for any purpose or used for another project without the consent of Urbis other than reproduction for the purposes of actual ordering, supply, installation or construction. This drawing must be read in conjunction with all relevant contracts, schedules, specifications, drawings and any other issued written instructions. Do not scale from drawings. Written figured dimensions take preference to scaled dimension and must be verified on site before proceeding with any work. All discrepancies must be referred to the superintendent for a written decision prior to ordering, supply or installation. Urbis must be notified in writing of any discrepancies.

#	#	#	#	#
#	#	#	#	#
#	#	#	#	#
#	#	#	#	#
D	SSDA RTS RESUBMISSION	YV	MK	01/06/2022
C	SSDA RTS RESUBMISSION	YV	MK	17/05/2022
B	SSDA RTS	YV	MK	25/02/2021
A	SSDA RTS	YV	MK	09/12/2021
REV	DESCRIPTION	DWN	CHK	DATE

PROJECT NAME & ADDRESS
**SYDNEY OLYMPIC PARK
NEW HIGH SCHOOL**

PROJECT DIRECTOR: MK

DRAWING TITLE
**FINISHES PLAN
GRUND FLOOR**

ISSUE
SSDA

PROJECT NO.
P0033179

SCALE
1:200 @ A1
1:400 @ A3
2 4 6 8 10m

DRAWING NO.
L501

REVISION
D

Level 14, The Quadrant, 1 William Street | Perth
WA 6000 Australia | +61 8 9346 0500
URBIS Pty Ltd | ABN 50 105 256 228

CLIENT
ROBERTS CO

KEY PLAN

DISCLAIMER

Copyright by Urbis Pty Ltd. This drawing or parts thereof may not be reproduced for any purpose or used for another project without the consent of Urbis other than reproduction for the purposes of actual ordering, supply, installation or construction. This drawing must be read in conjunction with all relevant contracts, schedules, specifications, drawings and any other issued written instructions. Do not scale from drawings. Written figure dimensions take preference to scaled dimension and must be verified on site before proceeding with any work. All discrepancies must be referred to the superintendent for a written decision prior to ordering, supply or installation. Urbis must be notified in writing of any discrepancies.

REV	DESCRIPTION	DWN	CHK	DATE
C	SSDA RTS RESUBMISSION	YV	MK	02/06/2022
B	SSDA RTS	YV	MK	25/02/2021
A	SSDA RTS	YV	MK	09/12/2021

PROJECT NAME & ADDRESS

SYDNEY OLYMPIC PARK
NEW HIGH SCHOOL

PROJECT DIRECTOR: MK

DRAWING TITLE
FINISHES PLAN
LEVEL 2

ISSUE
SSDA

PROJECT NO.
P0033179

SCALE

1:200 @ A1 1:400 @ A3

	2	4	6	8	10	m
--	---	---	---	---	----	---

DRAWING NO.

L221



REVISION

C

REV	DESCRIPTION	DWN	CHK	DATE
D	SSDA RTS RESUBMISSION	YV	MK	01/06/2022
C	SSDA RTS RESUBMISSION	YV	MK	17/05/2022
B	SSDA RTS	YV	MK	25/02/2021
A	SSDA RTS	YV	MK	09/12/2021

PROJECT NAME & ADDRESS
**SYDNEY OLYMPIC PARK
NEW HIGH SCHOOL**

PROJECT DIRECTOR: MK

DRAWING TITLE
**PLANTING PLAN
GROUND FLOOR**

ISSUE
SSDA

PROJECT NO.
P0033179

SCALE

1:200 @ A1
1:400 @ A3
2 4 6 8 10m

DRAWING NO.

L501



REVISION

D

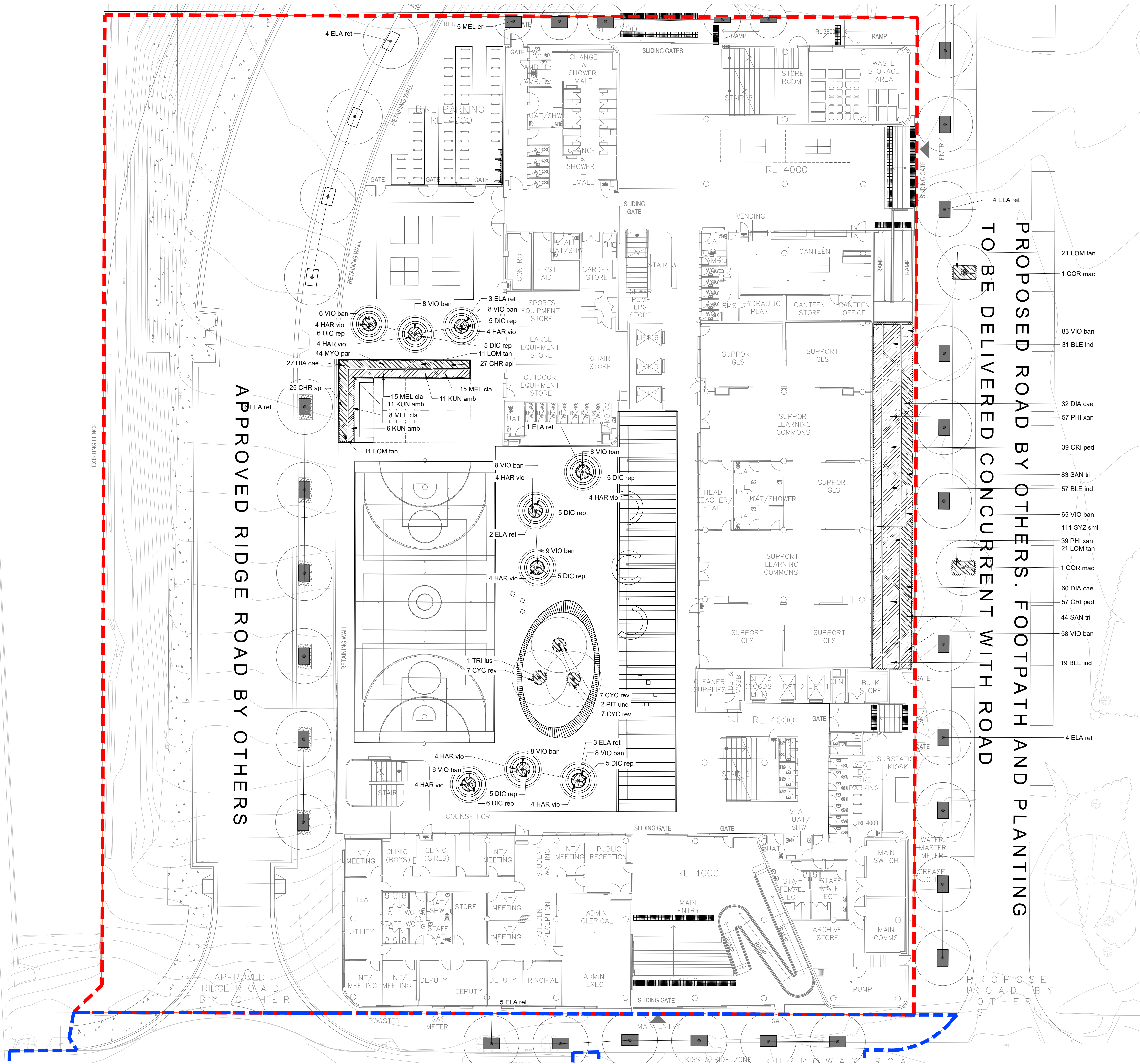

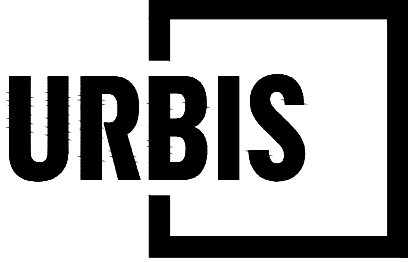
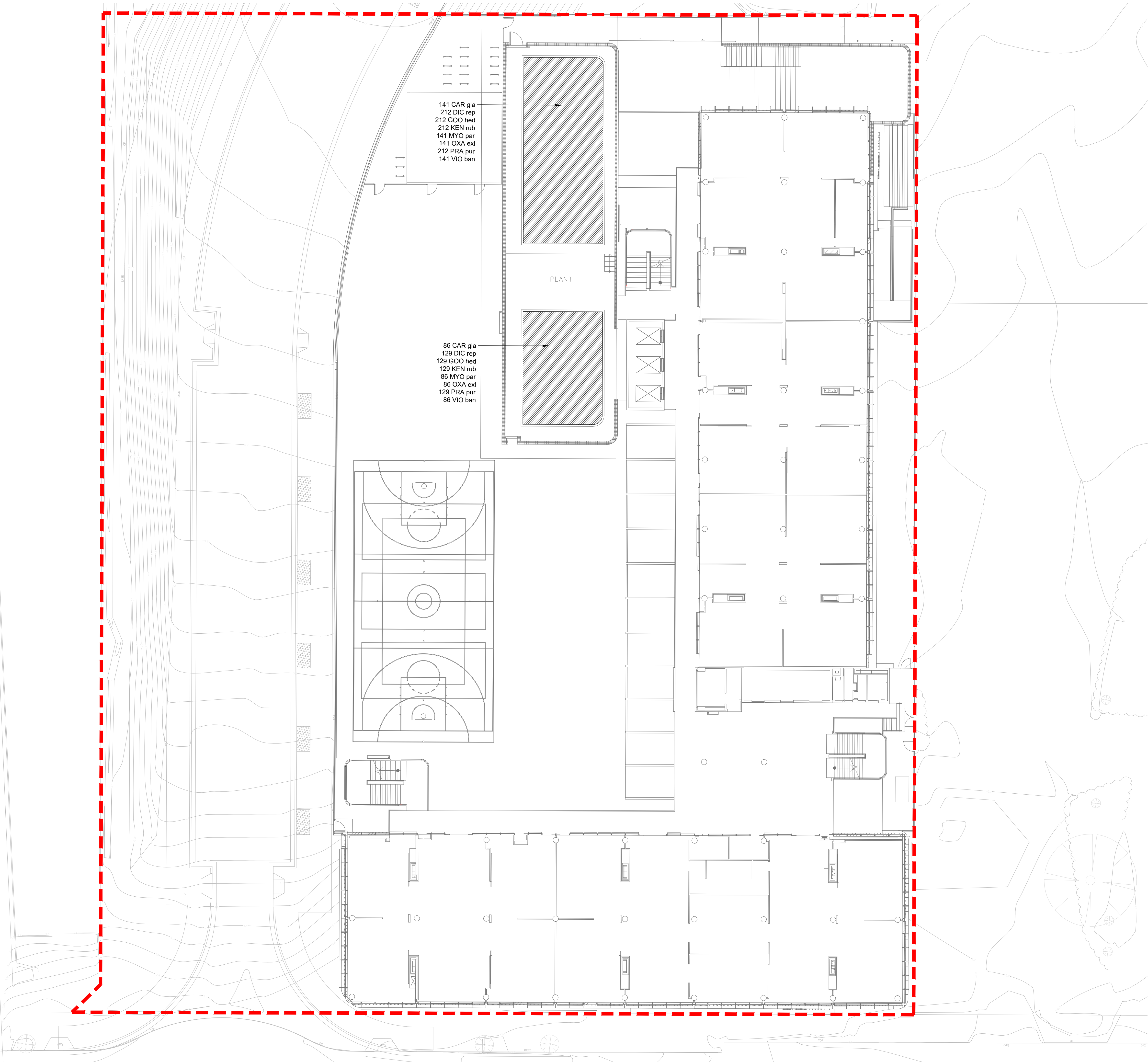

Level 14, The Quadrant, 1 William Street | Perth
WA 6000 Australia | +61 8 9346 0500
URBIS Pty Ltd | ABN 50 105 256 228

CLIENT
ROBERTS CO

-
-

KEY PLAN

DISCLAIMER

Copyright by Urbis Pty Ltd. This drawing or parts thereof may not be reproduced for any purpose or used for another project without the consent of Urbis other than reproduction for the purposes of actual ordering, supply, installation or construction. This drawing must be read in conjunction with all relevant contracts, schedules, specifications, drawings and any other issued written instructions. Do not scale from drawings. Written figured dimensions take preference to scaled dimension and must be verified on site before proceeding with any work. All discrepancies must be referred to the superintendent for a written decision prior to ordering, supply or installation. Urbis must be notified in writing of any discrepancies.

C	SSDA RTS RESUBMISSION	YV	MK	02/06/2022
B	SSDA RTS	YV	MK	25/02/2021
A	SSDA RTS	YV	MK	09/12/2021
REV	DESCRIPTION	DWN	CHK	DATE

PROJECT NAME & ADDRESS

**SYDNEY OLYMPIC PARK
NEW HIGH SCHOOL**

PROJECT DIRECTOR: MK

DRAWING TITLE
**PLANTING PLAN
LEVEL 2**

ISSUE

SSDA

SCALE

1:200 @ A1
2 4 6 8 10m
1:400 @ A3

DRAWING NO.

L521

PROJECT NO.

P0033179



REVISION

C