

By email
17 October 2022

Wayne Hutchinson
John Holland
Level 3, 65 Pirrama Rd
Pyrmont NSW 2009

Our ref 257913

Dear Wayne

Sydney Children's Hospital Stage 1 / Minderoo Children's Comprehensive Cancer Centre

Hospital Road B2 Ramp vertical clearances

Arup has assessed vertical clearances for vehicles accessing the ramp from Hospital Road (RL 51.050m) to the B2 loading dock (FFL 48.500m) within the SCH1/MCCCC development, based on design drawing SCH1-AR-DG-42-XX611 dated 12/10/21. Clearance assessments focussed on heavy rigid vehicle (HRV) access to the loading dock as the largest vehicle expected to utilise the ramp and dock. Assessment included using vertical clearance programs in CAD software to assess design drawing longitudinal sections. Cross sections of the ramp at significant points were assessed for clearances to the vehicle envelope to ensure structures and necessary services within the tunnel were positioned to allow safe vehicular travel along the length of the tunnel ramp.

This letter certifies that the ramp design has been assessed and found to provide safe vehicular operation for the standard HRV in accordance with Australian Standard 2890.2:2018. Vertical clearances for head and ground clearances were assessed for both ingress and egress of the HRV. The enclosed drawings show the vertical clearance assessment of the ramp long section with the red lines representing the required clearance envelope for an HRV as per the procedure outlined in Appendix 4 of AS2890.2.

Yours sincerely

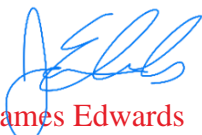

James Edwards
Senior Transport Planner

d +61 2 9320 9166
m 0414 487 636
e james-n.edwards@arup.com

Enc Head and ground clearance checks MH 17102022

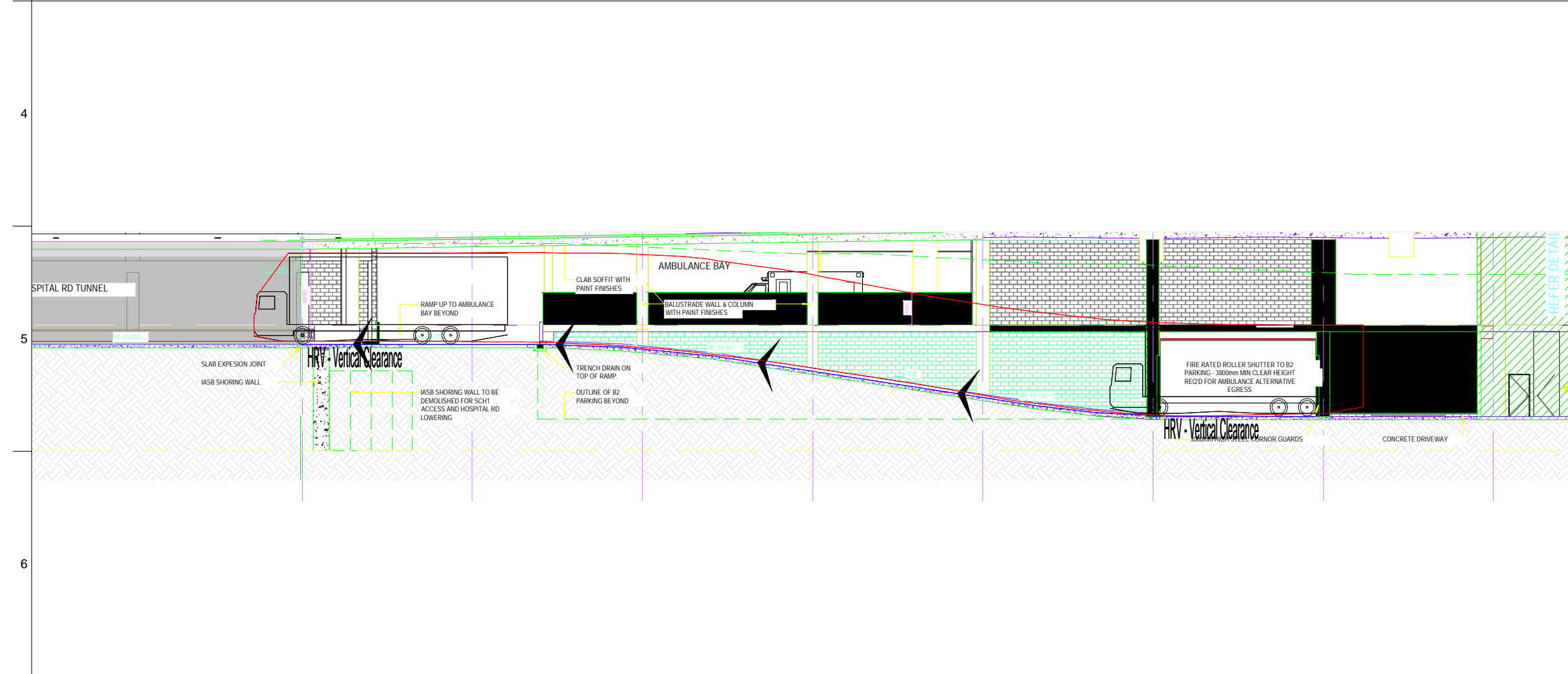
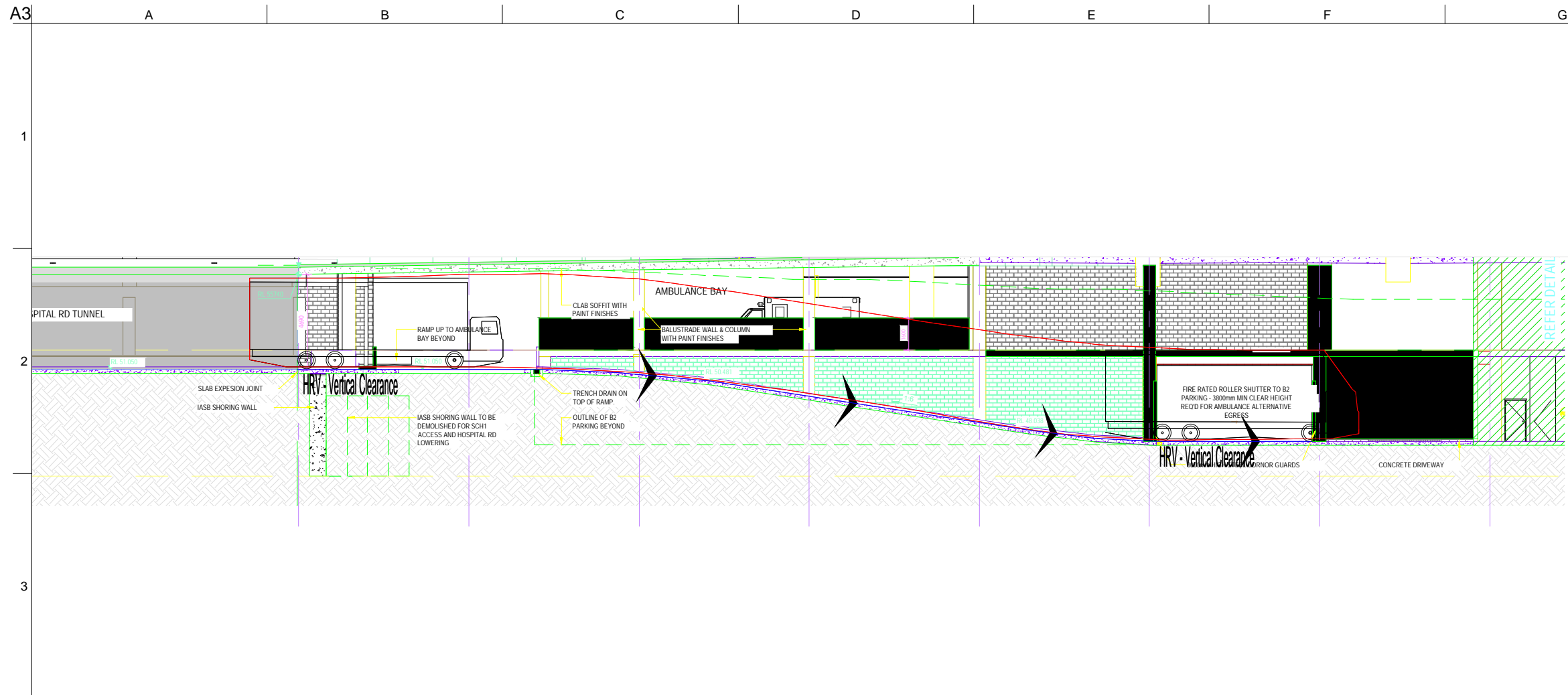

Legend

Body Envelope
Design Vehicle(s)

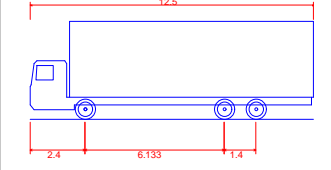

HRV - Heavy Rigid Vehicle
 Overall Length 12.500m
 Overall Width 2.500m
 Overall Body Height 4.300m
 Min Body Ground Clearance 0.417m
 Track Width 2.500m
 Lock to Lock Time 6.00 sec
 Curb to Curb Turning Radius 12.500m

Key Plan

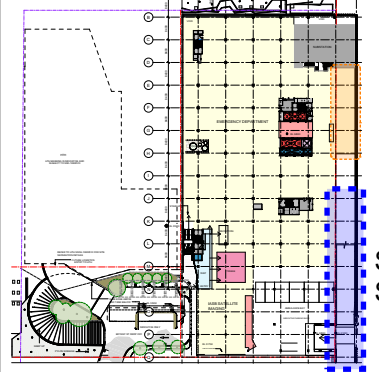

Southern Section

D	17/10/22	MH	JE	JE
C	24/06/22	MH	JE	JE
B	08/06/22	MH	JE	JE
A	24/08/21	AN	JRT	JRT

For information

Issue	Date	By	Chkd	Appd

ARUP

Arup, Level 5, 151 Clarence St
 Sydney NSW, 2000
 Tel +61 (02)9320 9320 Fax +61(02)9320 9321
 www.arup.com.au

Client
 HI

Job Title
 SCH1/MCCCC

Drawing Title
 Vertical Clearance Hospital Road
 Southern Section

Scale at A3
 1:300

Discipline
 Traffic and Transport

Drawing Status
Draft

Job No 274797-03	Drawing No SKT001	Issue D
----------------------------	-----------------------------	-------------------

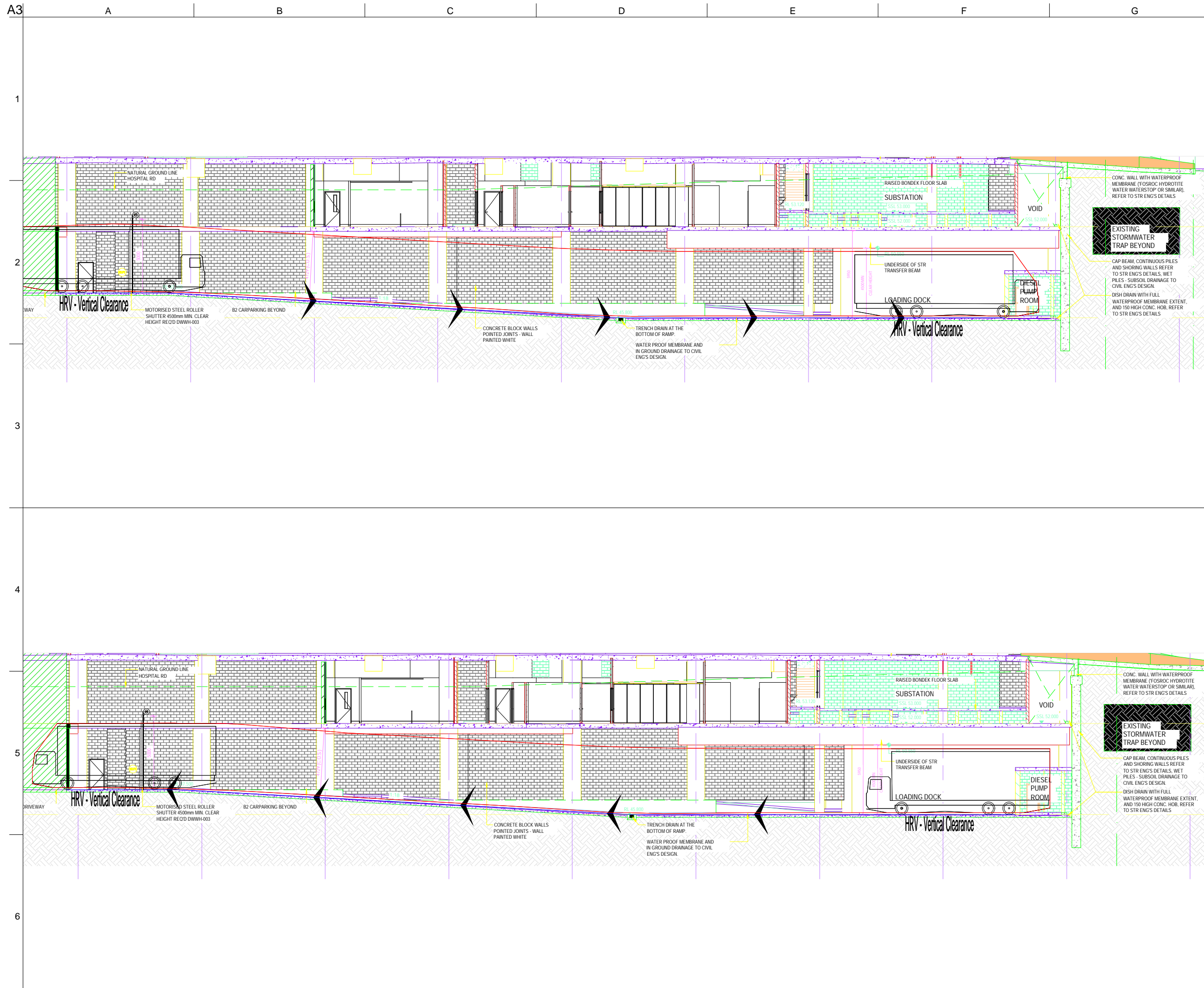

Legend

Body Envelope

Design Vehicle(s)

HRV - Heavy Rigid Vehicle
 Overall Length 12.500m
 Overall Width 2.500m
 Overall Body Height 4.300m
 Min Body Ground Clearance 0.417m
 Track Width 2.500m
 Lock to Lock Time 6.00 sec
 Curb to Curb Turning Radius 12.500m

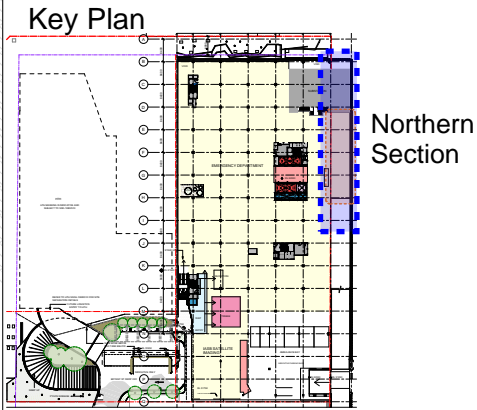

D	17/10/22	MH	JE	JE
C	24/06/22	MH	JE	JE
B	08/06/22	MH	JE	JE
A	24/08/21	AN	JRT	JRT

For information

Issue	Date	By	Chkd	Appd

ARUP

Arup, Level 5, 151 Clarence St
 Sydney, NSW, 2000
 Tel +61 (02)9320 9320 Fax +61(02)9320 9321
 www.arup.com.au

Client
 HI

Job Title
 SCH1/MCCCC

Drawing Title
 Vertical Clearance Hospital Road
 Northern Section

Scale at A3 1:250

Discipline Traffic and Transport

Drawing Status
Draft

Job No 274797-03	Drawing No SKT002	Issue D
----------------------------	-----------------------------	-------------------