

ALL FINISHED LEVELS SHOWN ARE ±1000mm

Issue	Description	Date
P2	ISSUED FOR RESPONSE TO SUBMISSION	17-02-21
P1	ISSUED FOR INFORMATION	18-11-19

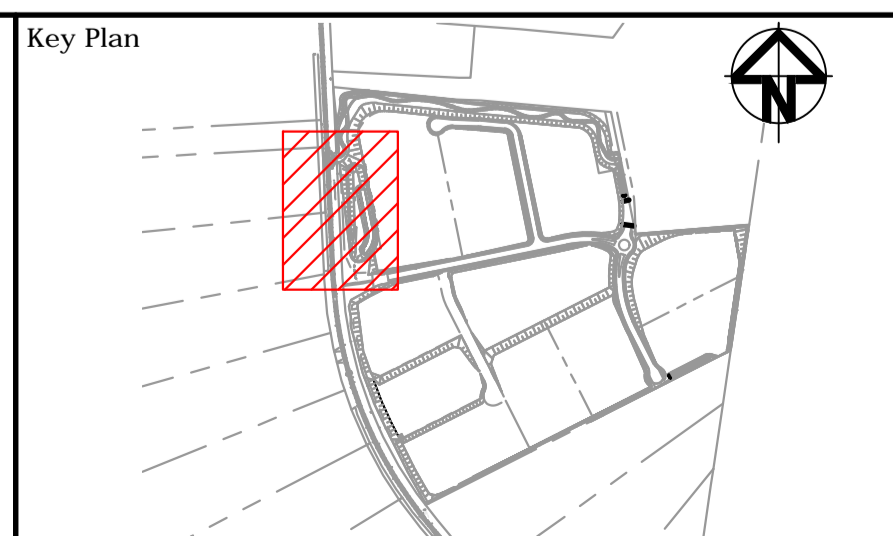
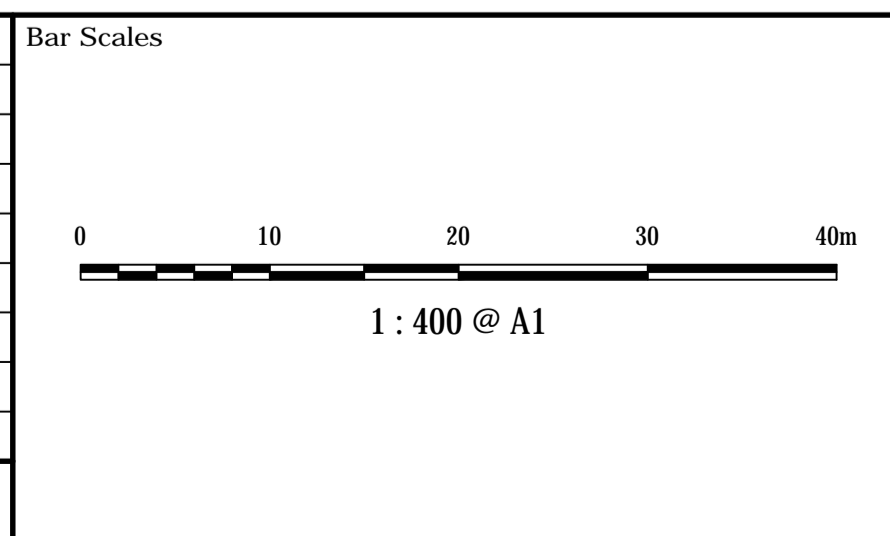

Scale	1:400	Drawn	PDK
		Designed	PDK
Grid	MGA	Checked	AT
Height Datum	AHD	Approved	

THIS DRAWING CANNOT BE COPIED OR REPRODUCED IN ANY FORM OR USED FOR ANY OTHER PURPOSE OTHER THAN THAT ORIGINALLY INTENDED WITHOUT THE WRITTEN PERMISSION OF AT&I

Project
**ASPECT INDUSTRIAL ESTATE
 MAMRE ROAD,
 KEMPS CREEK
 STAGE 1**

Title
**STORMWATER BASIN
 LAYOUT PLAN**

Civil Engineers and Project Managers

Level 7, 153 Walker Street
 North Sydney NSW 2060
 ABN 96 130 882 405
 Tel: 02 9439 1777
 Fax: 02 9923 1055
 www.at.net.au
 info@at.net.au

Status	FOR APPROVAL NOT TO BE USED FOR CONSTRUCTION	A1
Project - Drawing No.	18-596-C1057	Issue
		P2