

A1 0 1 2 3 4 5 6 7 8 9 10

SKC50 DETAILS SHEET

T:\Projects\SKC10.dwg - USER: duncann - Plot File Created: Oct 15, 2020 - 6:34pm

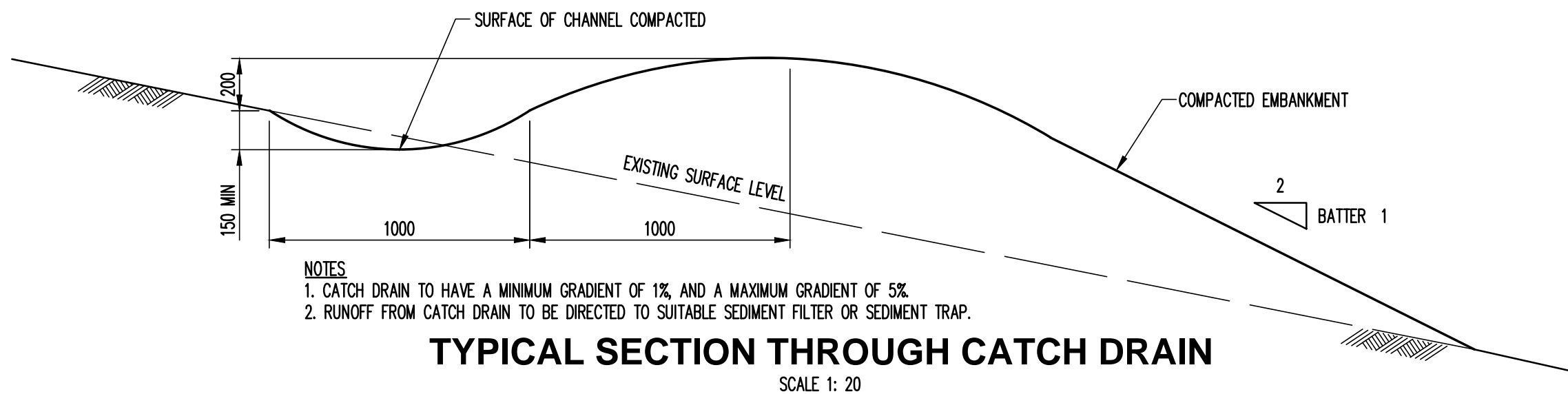
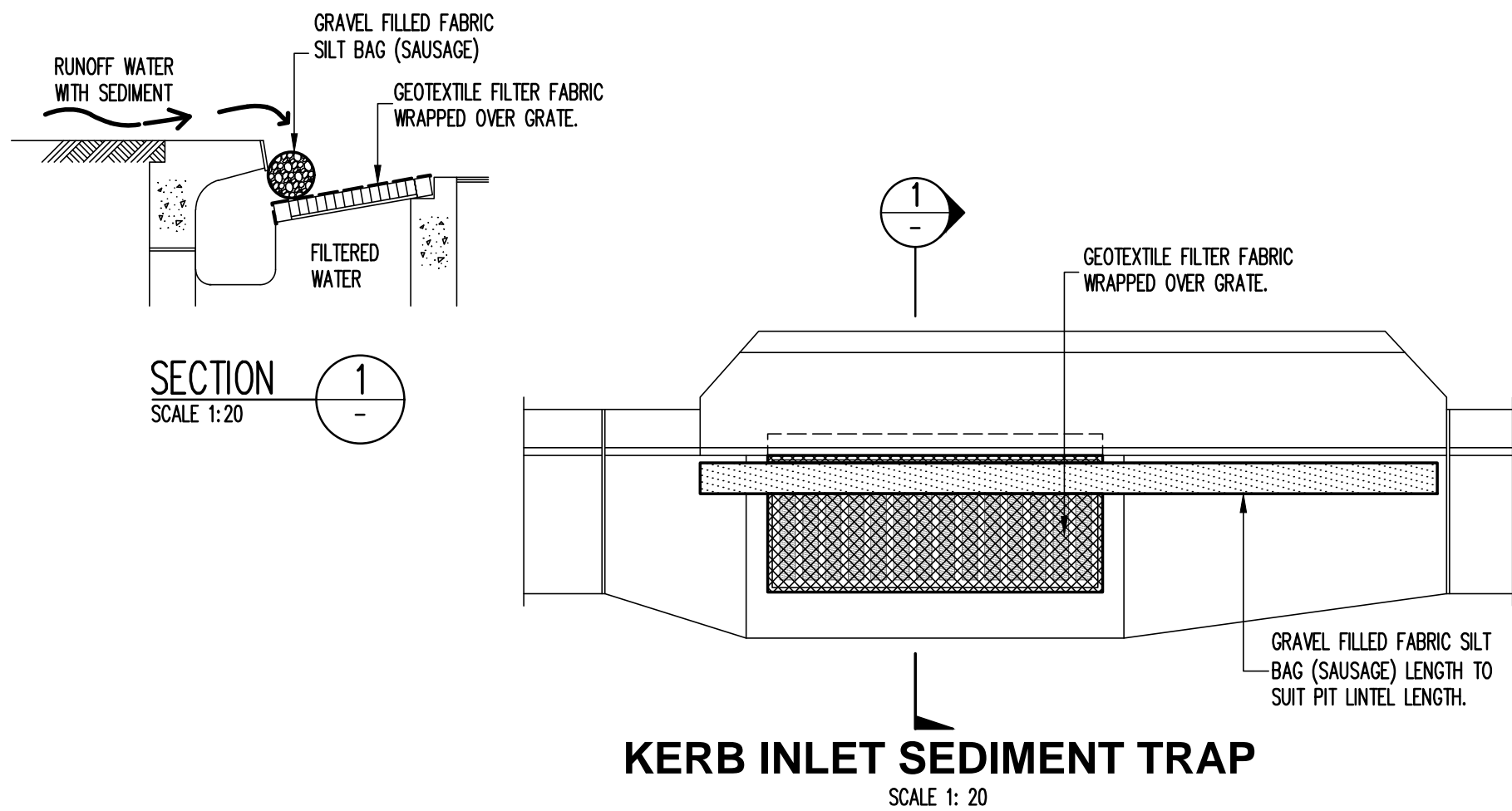
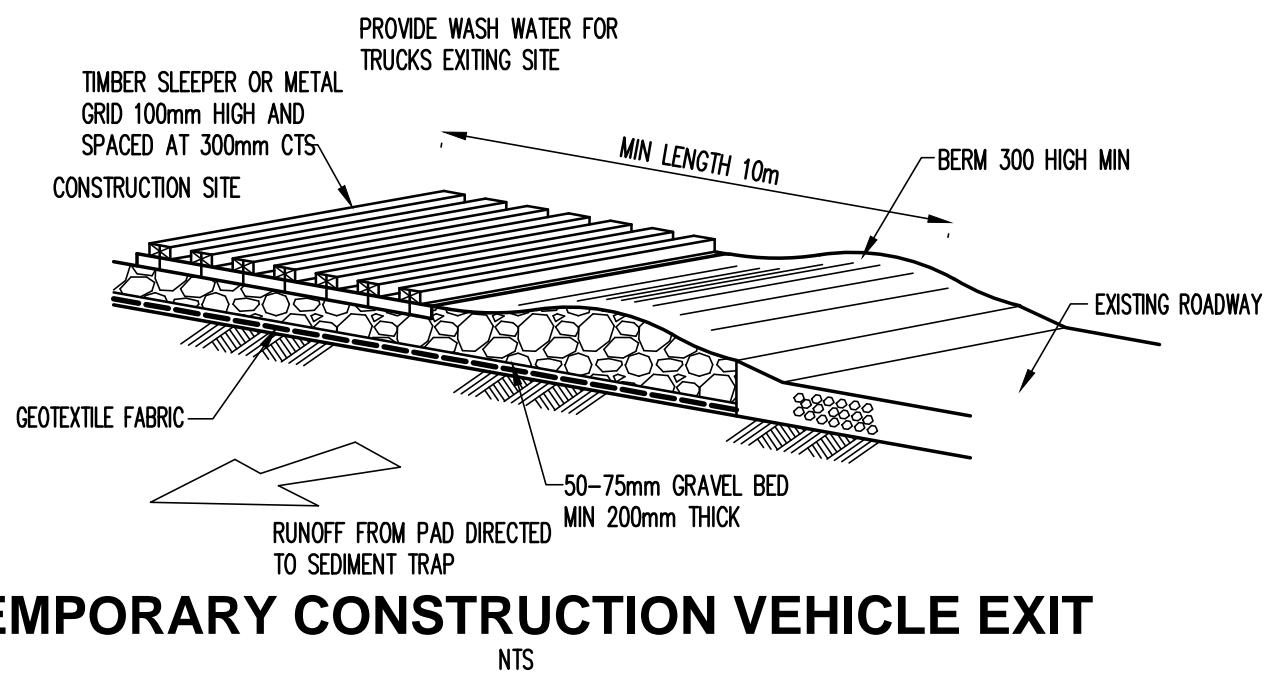
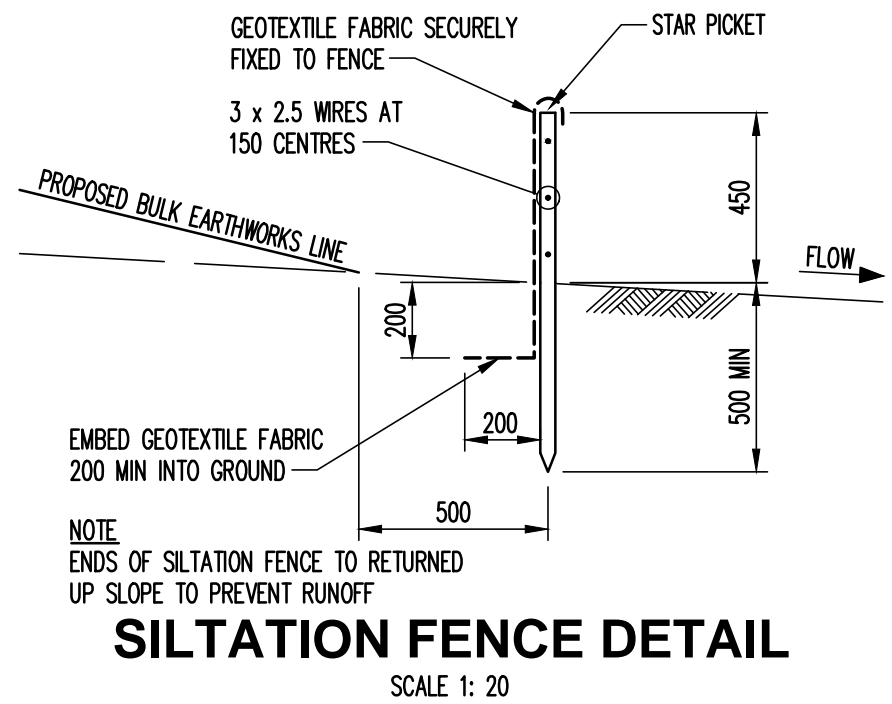
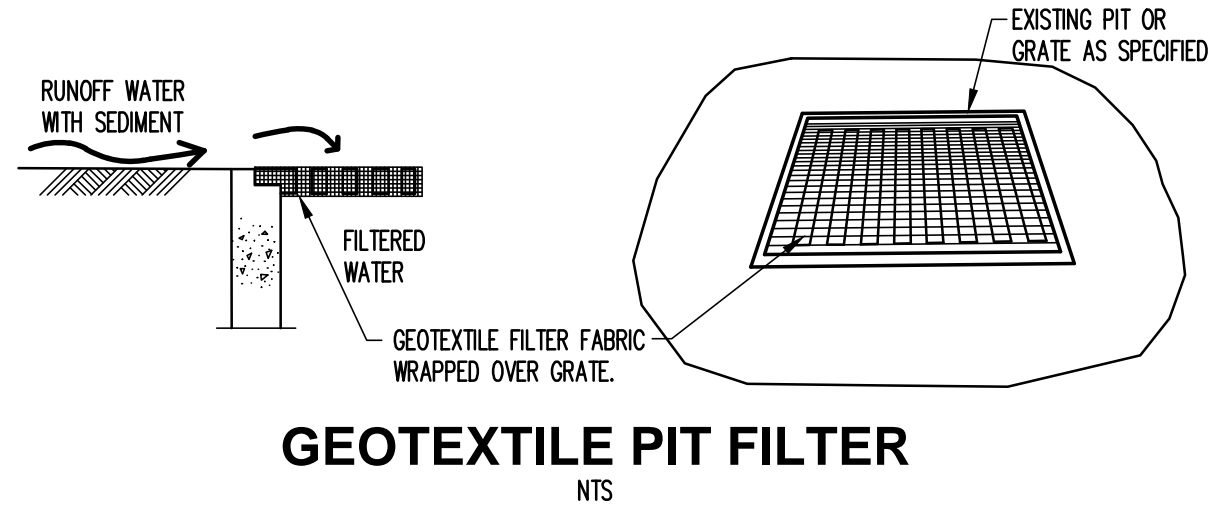
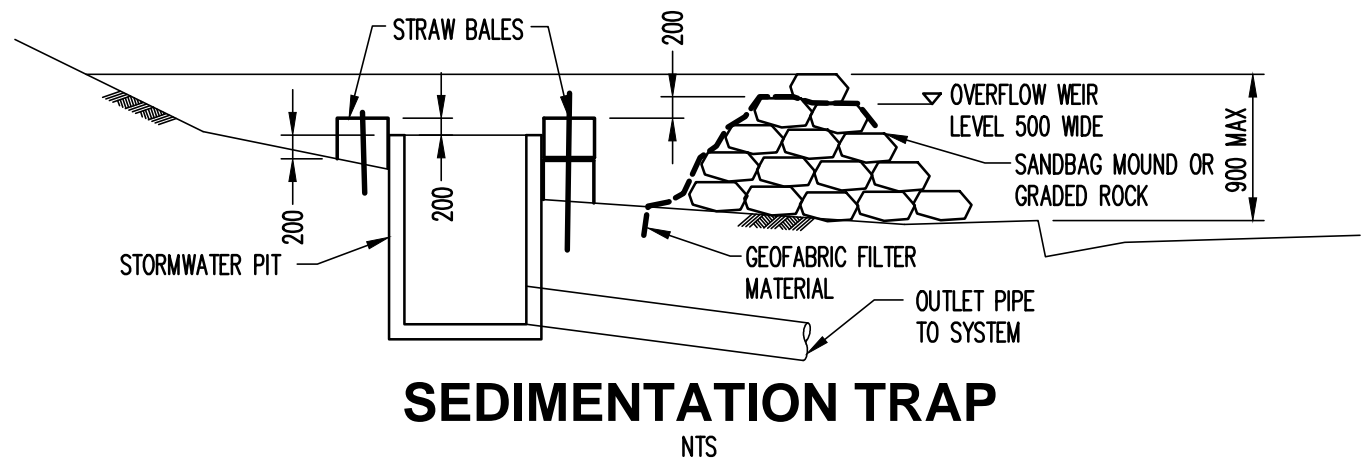
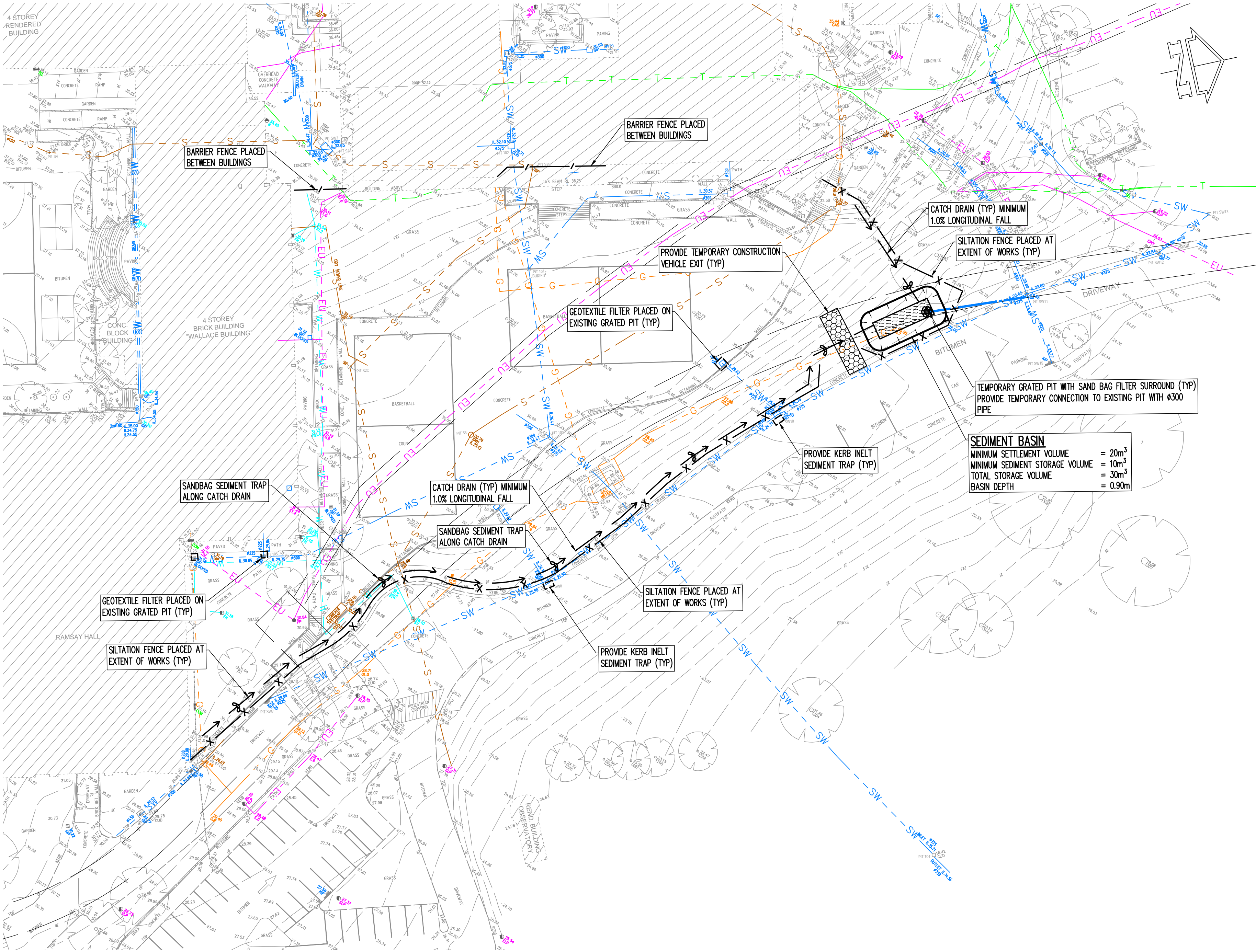

This drawing is copyright and is the property of TAYLOR THOMSON WHITTING (NSW) Pty Ltd and must not be used without authorisation. THIS DRAWING TO BE READ IN CONJUNCTION WITH ALL RELEVANT NOTES ON DRAWING C01

EROSION AND SEDIMENT CONTROL LEGEND

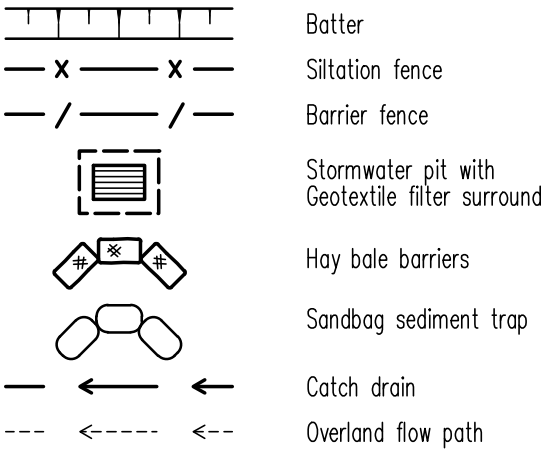

EROSION AND SEDIMENT CONTROL NOTES

- All work shall be generally carried out in accordance with:
(A) Local authority requirements,
(B) EPA - Pollution control manual for urban stormwater,
(C) LANDCOM NSW - Managing Urban Stormwater: Soils and Construction ("Blue Book").
- Erosion and sediment control drawings and notes are provided for the whole of the works. Should the Contractor stage these works then the design may be required to be modified. Variation to these details may require approval by the relevant authorities. The erosion and sediment control plan shall be implemented and adapted to meet the varying situations as work on site progresses.
- Maintain all erosion and sediment control devices to the satisfaction of the superintendent and the local authority.
- When stormwater pits are constructed prevent site runoff entering the pits unless silt fences are erected around pits.
- Minimise the area of site being disturbed at any one time.
- Protect all stockpiles of materials from scour and erosion. Do not stockpile loose material in roadways, near drainage pits or in watercourses.
- All soil and water control measures are to be put back in place at the end of each working day, and modified to best suit site conditions.
- Control water from upstream of the site such that it does not enter the disturbed site.
- All construction vehicles shall enter and exit the site via the temporary construction entry/exit.
- All vehicles leaving the site shall be cleaned and inspected before leaving.
- Maintain all stormwater pipes and pits clear of debris and sediment. Inspect stormwater system and clean out after each storm event.
- Clean out all erosion and sediment control devices after each storm event.

Sequence Of Works

- Prior to commencement of excavation the following soil management devices must be installed.
- Construct silt fences below the site and across all potential runoff sites.
- Construct temporary construction entry/exit and divert runoff to suitable control systems.
- Construct measures to divert upstream flows into existing stormwater system.
- Construct sedimentation traps/basin including outlet control and overflow.
- Construct turf lined swales.
- Provide sandbag sediment traps upstream of existing pits.
- Construct geotextile filter pit surround around all proposed pits as they are constructed.
- On completion of pavement provide sand bag kerb inlet sediment traps around pits.
- Provide and maintain a strip of turf on both sides of all roads after the construction of kerbs.

WATER QUALITY TESTING REQUIREMENTS

Prior to discharge of site stormwater, groundwater and seepage water into council's stormwater system, contractors must undertake water quality tests in conjunction with a suitably qualified environmental consultant outlining the following:

- Compliance with the criteria of the Australian and New Zealand Guidelines for Fresh and Marine Water Quality (2000)
- If required subject to the environmental consultants advice, provide remedial measures to improve the quality of water that is to be discharged into Councils storm water drainage system. This should include comments from a suitably qualified environmental consultant confirming the suitability of these remedial measures to manage the water discharged from the site into Councils storm water drainage system. Outlining the proposed, ongoing monitoring, contingency plans and validation program that will be in place to continually monitor the quality of water discharged from this site. This should outline the frequency of water quality testing that will be undertaken by a suitably qualified environmental consultant.

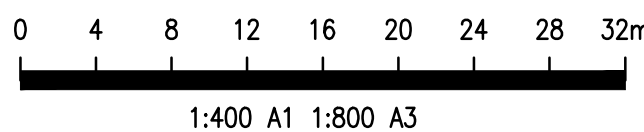

PRELIMINARY
NOT TO BE USED
FOR CONSTRUCTION

A1 0 1 2 3 4 5 6 7 8 9 10

Rev	Description	Eng	Draft	Date	Rev	Description	Eng	Draft	Date	Rev	Description	Eng	Draft	Date
P4	PRELIMINARY	DM	DM	15.10.20										
P3	DRAFT FOR APPROVAL	DM	DM	30.07.20										
P2	ISSUE FOR QS	DM	DM	08.07.20										
P1	PRELIMINARY	DM	DM	26.03.20										

Architect
PMDL
17 / 124 WALKER STREET,
NORTH SYDNEY, NSW 2060

Engineer
TTW Structural Civil Traffic Façade
612 9439 7288 | 48 Chandos Street St Leonards NSW 2065

Project
SAINT IGNATIUS' COLLEGE
RIVERVIEW - STAGE 2

Sheet Subject
CONCEPT SEDIMENT AND
EROSION CONTROL
SITE PLAN

Scale : A1
1:400
Drawn
DM
Authorised
-
Job No
191740
Drawing No
SKC10
Revision
P4
Plot File Created: Oct 15, 2020 - 6:34pm

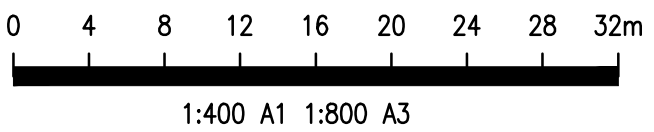
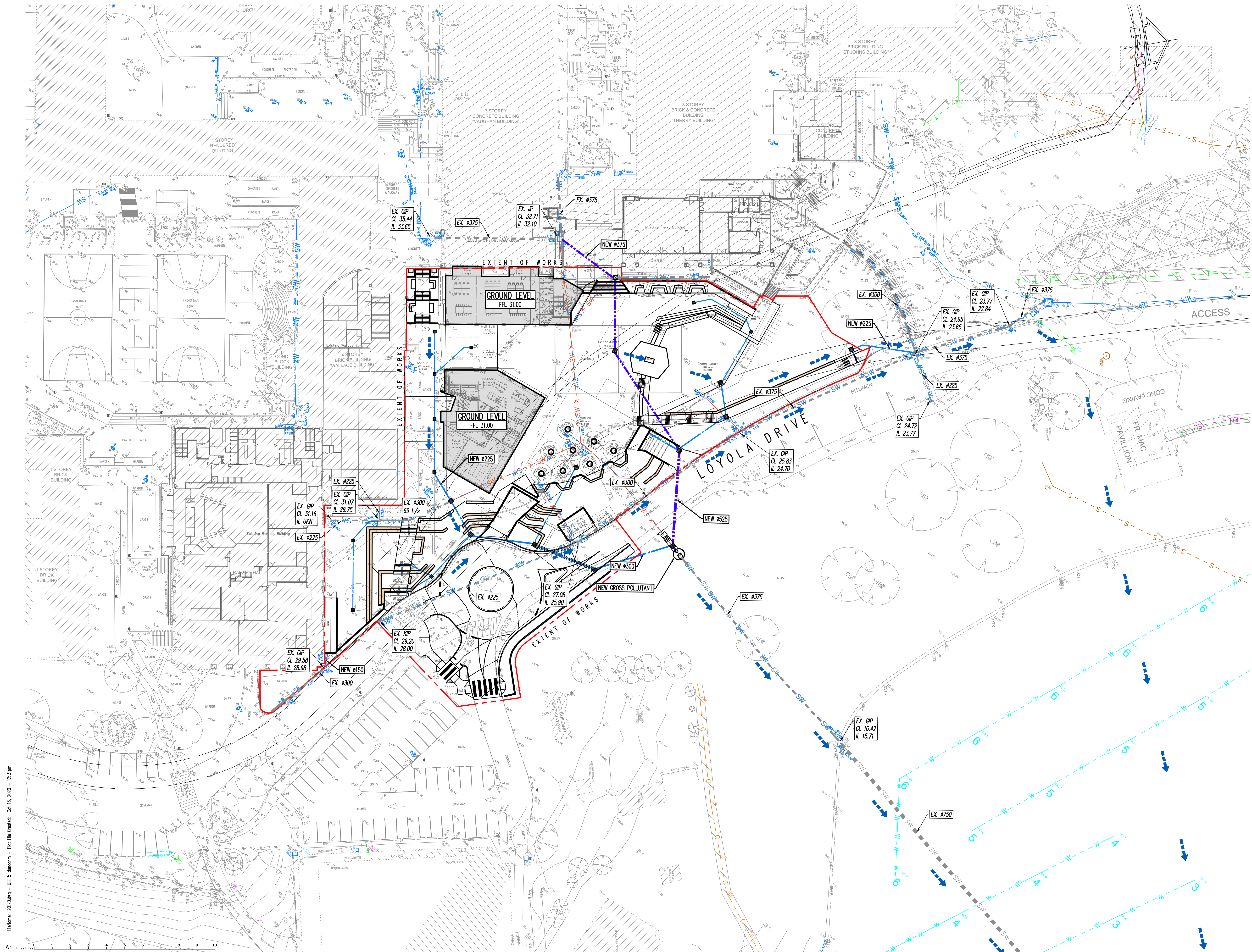

PRELIMINARY
NOT TO BE USED
FOR CONSTRUCTION

P5	PRELIMINARY	DM	DM	15.10.20					
P4	FOR COORDINATION	DM	DM	14.10.20					
P3	ISSUE FOR INFORMATION	DM	DM	06.10.20					
P2	DRAFT FOR APPROVAL	DM	DM	30.07.20					
P1	PRELIMINARY	DM	DM	26.03.20					
Rev	Description	Eng	Draft	Date	Rev	Description	Eng	Draft	Date

Architect
PMDL
17 / 124 WALKER STREET,
NORTH SYDNEY, NSW 2060

Engineer
TTW **Structural**
Civil
Traffic
Façade
612 9439 7288 | 48 Chandos Street St Leonards NSW 2065

Project
SAINT IGNATIUS' COLLEGE
RIVERVIEW - STAGE 2

Sheet Subject
CONCEPT LOCALITY PLAN

Scale : A1
1:400
Job No
191740
Plot File Created: Oct 16, 2020 - 12:31pm
Drawing No
SKC20
Revision
P5

D:\Users\SKC21\My - USBR - duncum - Plot File Created: Oct 15, 2020 - 6:35pm

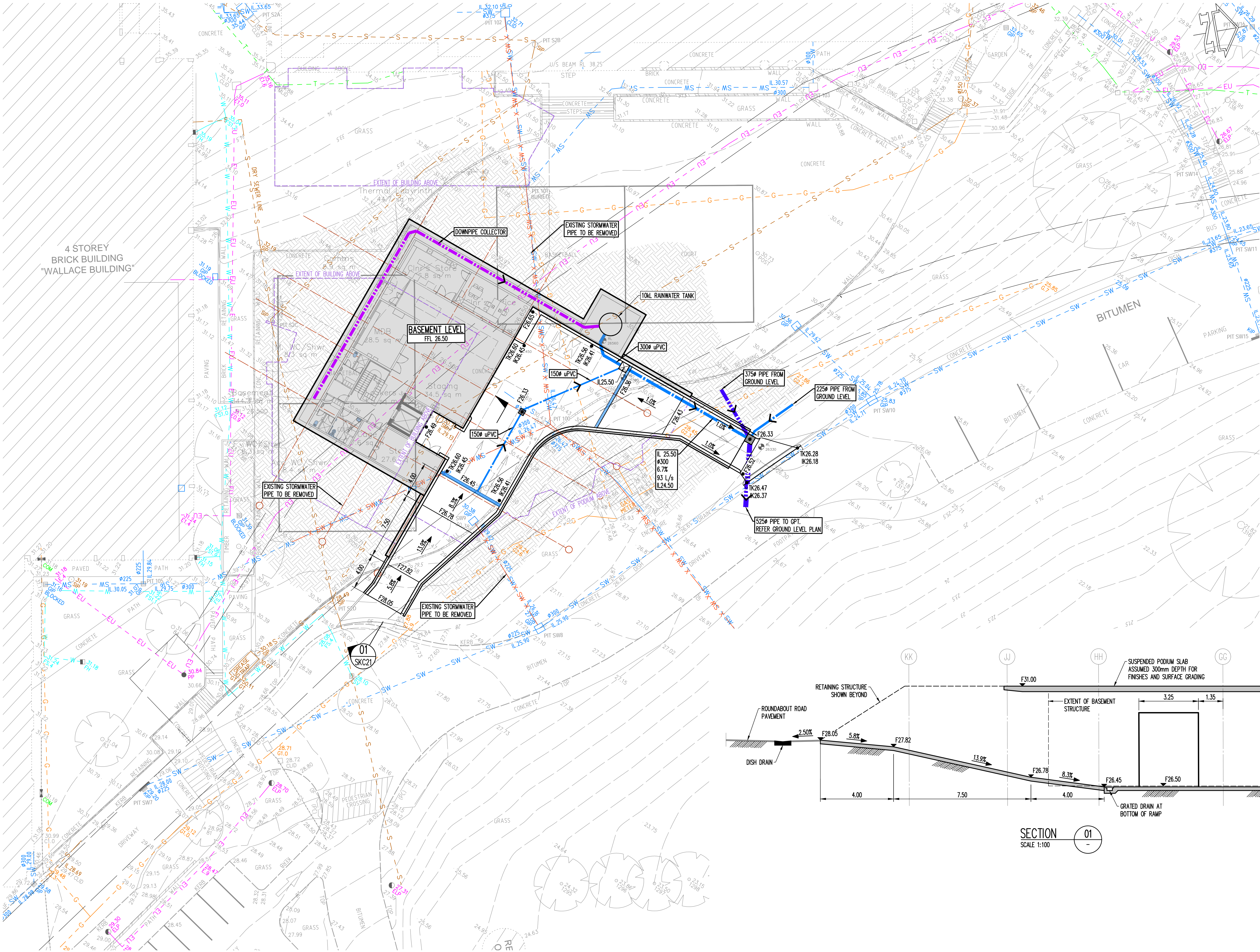

This drawing is copyright and is the property of TAYLOR THOMSON WHITTING (NSW) Pty Ltd and must not be used without authorisation.
THIS DRAWING TO BE READ IN CONJUNCTION WITH ALL RELEVANT NOTES ON DRAWING C01

STORMWATER LEGEND

- F22.20 Finished surface level
- F22.00 Finished contour
- Stormwater pit, flow direction and line
- Invert level upstream
Pipe size and class
Pipe grade
Flow rate (Litres per second)
Invert level downstream
- IR Intermediate riser with subsoil drainage line (100 dia)
- FP Flushing point with subsoil drainage line (100 dia)
- DP Downpipe
- RWO Rainwater outlet
- Surface water drainage
- Roof water drainage
- Stormwater diversion
- SW Existing stormwater to be retained
- SW Existing stormwater to be removed
- GD Grated drain
- RW Blockwork retaining wall
- Extent of structure above
- Extent of structure below

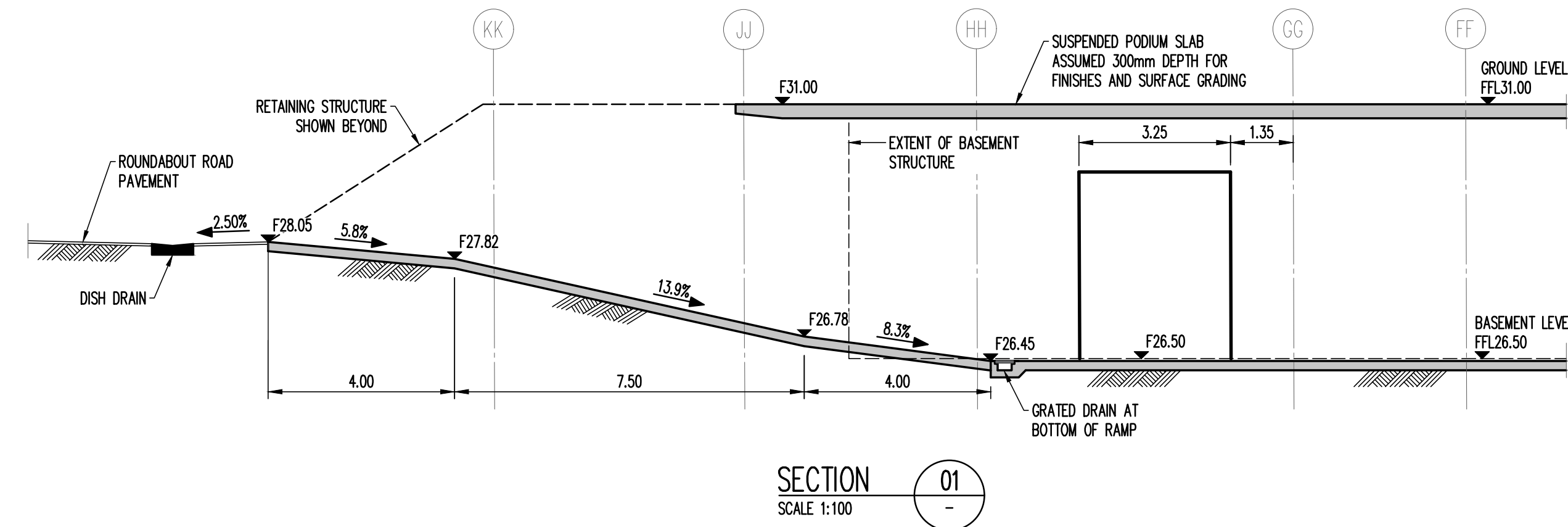

PRELIMINARY
NOT TO BE USED
FOR CONSTRUCTION

Rev	Description	Eng	Draft	Date	Rev	Description	Eng	Draft	Date
P6	DRAFT FOR APPROVAL	DM	DM	30.07.20	P10	PRELIMINARY	DM	DM	15.10.20
P5	ISSUE FOR QS	DM	DM	13.07.20	P9	FOR COORDINATION	DM	DM	14.10.20
P4	ISSUE FOR QS	DM	DM	08.07.20	P8	FOR INFORMATION ONLY	DM	DM	06.10.20
P3	PRELIMINARY	DM	DM	05.06.20	P7	FOR INFORMATION ONLY	DM	DM	29.09.20
P2	PRELIMINARY	DM	DM	26.03.20					
P1	PRELIMINARY	DM	DM	12.03.20					

Architect
PMDL
17 / 124 WALKER STREET,
NORTH SYDNEY, NSW 2060

Engineer
TTW Structural
Civil
Traffic
Façade
612 9439 7288 | 48 Chandos Street St Leonards NSW 2065

Project
SAINT IGNATIUS' COLLEGE
RIVERVIEW - STAGE 2

Sheet Subject
CONCEPT STORMWATER
MANAGEMENT PLAN
BASEMENT LEVEL

Scale : A1
1:200
Job No
191740
Plot File Created: Oct 15, 2020 - 6:35pm
Drawn
DM
Drawing No
SKC21
Revision
P10

STORMWATER LEGEND

- F22.20 Finished surface level
--- F22.00 Finished contour
[Symbol] Stormwater pit, flow direction and line
[Symbol] Invert level upstream
[Symbol] Pipe size and class
[Symbol] Pipe grade
[Symbol] Flow rate (Litres per second)
[Symbol] Invert level downstream
- IR Intermediate riser with subsoil drainage line (100 dia)
--- FP Flushing point with subsoil drainage line (100 dia)
--- DP Downpipe
--- RWO Rainwater outlet
--- Surface water drainage
--- Roof water drainage
--- Stormwater diversion
--- SW Existing stormwater to be retained
--- SW X Existing stormwater to be removed
--- GO Grated drain
--- RW Blockwork retaining wall
--- Extent of structure above
--- Extent of structure below

Filename: SKC22.dwg - User: darcum - Plot File Created: Oct 16, 2020 - 12:32pm

P6	DRAFT FOR APPROVAL	DM	DM	30.07.20					
P5	ISSUE FOR QS	DM	DM	13.07.20					
P4	ISSUE FOR QS	DM	DM	08.07.20	P10	PRELIMINARY	DM	DM	15.10.20
P3	PRELIMINARY	DM	DM	05.06.20	P9	FOR COORDINATION	DM	DM	14.10.20
P2	PRELIMINARY	DM	DM	26.03.20	P8	FOR INFORMATION ONLY	DM	DM	06.10.20
P1	PRELIMINARY	DM	DM	12.03.20	P7	FOR INFORMATION ONLY	DM	DM	29.09.20
Rev	Description	Eng	Draft	Date	Rev	Description	Eng	Draft	Date

Architect
PMDL
17 / 124 WALKER STREET,
NORTH SYDNEY, NSW 2060

Engineer
TTW **Structural Civil Traffic Façade**
612 9439 7288 | 48 Chandos Street St Leonards NSW 2065

Project
**SAINT IGNATIUS' COLLEGE
RIVERVIEW - STAGE 2**

Sheet Subject
**CONCEPT STORMWATER
MANAGEMENT PLAN
GROUND LEVEL**

0 2 4 6 8 10 12 14 16m
1:200 A1 1:400 A3

**PRELIMINARY
NOT TO BE USED
FOR CONSTRUCTION**

Scale: A1 1:200
Job No 191740
Plot File Created: Oct 16, 2020 - 12:32pm
Drawing No SKC22
Revision P10

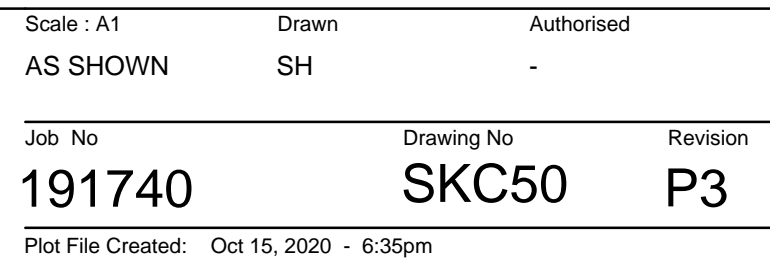

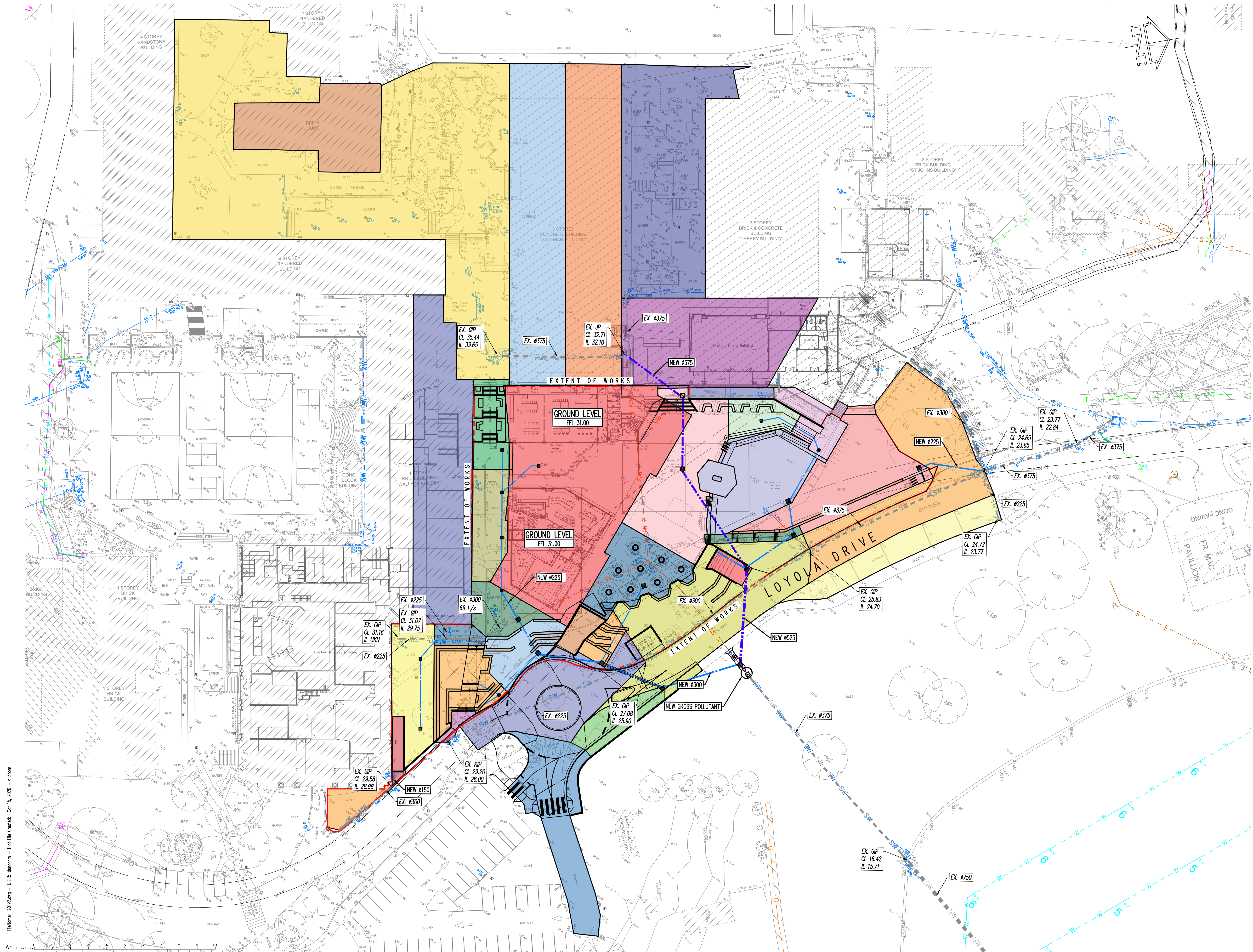

Filename: SKC92.dwg - User: darcum - Plot File Created: Oct 15, 2020 - 6:35pm

A1				0 1 2 3 4 5 6 7 8 9 10			
P1 FOR INFORMATION ONLY				DM	DM	15.10.20	
Rev	Description	Eng	Draft	Date	Rev	Description	Eng

Architect
PMDL
17 / 124 WALKER STREET,
NORTH SYDNEY, NSW 2060

Engineer
TTW Structural
Civil
Traffic
Façade
612 9439 7288 | 48 Chandos Street St Leonards NSW 2065

Project
SAINT IGNATIUS' COLLEGE
RIVERVIEW - STAGE 2

Sheet Subject
STORMWATER
CATCHMENT PLAN

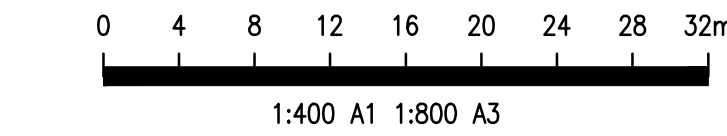

PRELIMINARY
NOT TO BE USED
FOR CONSTRUCTION

Scale : A1	Drawn	Authorised
1:400	DM	-
Job No	Drawing No	Revision
191740	SKC92	P2
Plot File Created: Oct 15, 2020 - 6:35pm		

Filename: SKC30.dwg - USER: danamm - Plot File Created: Nov 18, 2020 - 10:06pm

A1										1 2 3 4 5 6 7 8 9 10										11 12 13 14 15 16 17 18 19 20										21 22 23 24 25 26 27 28 29 30										31 32 33 34 35 36 37 38 39 40										41 42 43 44 45 46 47 48 49 50										51 52 53 54 55 56 57 58 59 60										61 62 63 64 65 66 67 68 69 70										71 72 73 74 75 76 77 78 79 80										81 82 83 84 85 86 87 88 89 90										91 92 93 94 95 96 97 98 99 100										101 102 103 104 105 106 107 108 109 110										111 112 113 114 115 116 117 118 119 120										121 122 123 124 125 126 127 128 129 130										131 132 133 134 135 136 137 138 139 140										141 142 143 144 145 146 147 148 149 150										151 152 153 154 155 156 157 158 159 160										161 162 163 164 165 166 167 168 169 170										171 172 173 174 175 176 177 178 179 180										181 182 183 184 185 186 187 188 189 190										191 192 193 194 195 196 197 198 199 200										201 202 203 204 205 206 207 208 209 210										211 212 213 214 215 216 217 218 219 220										221 222 223 224 225 226 227 228 229 230										231 232 233 234 235 236 237 238 239 240										241 242 243 244 245 246 247 248 249 250										251 252 253 254 255 256 257 258 259 260										261 262 263 264 265 266 267 268 269 270										271 272 273 274 275 276 277 278 279 280										281 282 283 284 285 286 287 288 289 290										291 292 293 294 295 296 297 298 299 300										301 302 303 304 305 306 307 308 309 310										311 312 313 314 315 316 317 318 319 320										321 322 323 324 325 326 327 328 329 330										331 332 333 334 335 336 337 338 339 340										341 342 343 344 345 346 347 348 349 350										351 352 353 354 355 356 357 358 359 360										361 362 363 364 365 366 367 368 369 370										371 372 373 374 375 376 377 378 379 380										381 382 383 384 385 386 387 388 389 390										391 392 393 394 395 396 397 398 399 400										401 402 403 404 405 406 407 408 409 410										411 412 413 414 415 416 417 418 419 420										421 422 423 424 425 426 427 428 429 430										431 432 433 434 435 436 437 438 439 440										441 442 443 444 445 446 447 448 449 450										451 452 453 454 455 456 457 458 459 460										461 462 463 464 465 466 467 468 469 470										471 472 473 474 475 476 477 478 479 480										481 482 483 484 485 486 487 488 489 490										491 492 493 494 495 496 497 498 499 500										501 502 503 504 505 506 507 508 509 510										511 512 513 514 515 516 517 518 519 520										521 522 523 524 525 526 527 528 529 530										531 532 533 534 535 536 537 538 539 540										541 542 543 544 545 546 547 548 549 550										551 552 553 554 555 556 557 558 559 560										561 562 563 564 565 566 567 568 569 570										571 572 573 574 575 576 577 578 579 580										581 582 583 584 585 586 587 588 589 590										591 592 593 594 595 596 597 598 599 600										601 602 603 604 605 606 607 608 609 610										611 612 613 614 615 616 617 618 619 620										621 622 623 624 625 626 627 628 629 630										631 632 633 634 635 636 637 638 639 640										641 642 643 644 645 646 647 648 649 650										651 652 653 654 655 656 657 658 659 660										661 662 663 664 665 666 667 668 669 670										671 672 673 674 675 676 677 678 679 680										681 682 683 684 685 686 687 688 689 690										691 692 693 694 695 696 697 698 699 700										701 702 703 704 705 706 707 708 709 710										711 712 713 714 715 716 717 718 719 720										721 722 723 724 725 726 727 728 729 730										731 732 733 734 735 736 737 738 739 740										741 742 743 744 745 746 747 748 749 750										751 752 753 754 755 756 757 758 759 760										761 762 763 764 765 766 767 768 769 770										771 772 773 774 775 776 777 778 779 780										781 782 783 784 785 786 787 788 789 790										791 792 793 794 795 796 797 798 799 800										801 802 803 804 805 806 807 808 809 810										811 812 813 814 815 816 817 818 819 820										821 822 823 824 825 826 827 828 829 830										831 832 833 834 835 836 837 838 839 840										841 842 843 844 845 846 847 848 849 850										851 852 853 854 855 856 857 858 859 860										861 862 863 864 865 866 867 868 869 870										871 872 873 874 875 876 877 878 879 880										881 882 883 884 885 886 887 888 889 890										891 892 893 894 895 896 897 898 899 900										901 902 903 904 905 906 907 908 909 910										911 912 913 914 915 916 917 918 919 920										921 922 923 924 925 926 927 928 929 930										931 932 933 934 935 936 937 938 939 940										941 942 943 944 945 946 947 948 949 950										951 952 953 954 955 956 957 958 959 960										961 962 963 964 965 966 967 968 969 970										971 972 973 974 975 976 977 978 979 980										981 982 983 984 985 986 987 988 989 990										991 992 993 994 995 996 997 998 999 1000										1001 1002 1003 1004 1005 1006 1007 1008 1009 1010										1011 1012 1013 1014 1015 1016 1017 1018 1019 1020										1021 1022 1023 1024 1025 1026 1027 1028 1029 1030										1031 1032 1033 1034 1035 1036 1037 1038 1039 1040										1041 1042 1043 1044 1045 1046 1047 1048 1049 1050										1051 1052 1053 1054 1055 1056 1057 1058 1059 1060										1061 1062 1063 1064 1065 1066 1067 1068 1069 1070										1071 1072 1073 1074 1075 1076 1077 1078 1079 1080										1081 1082 1083 1084 1085 1086 1087 1088 1089 1090										1091 1092 1093 1094 1095 1096 1097 1098 1099 1100										1101 1102 1103 1104 1105 1106 1107 1108 1109 1110										1111 1112 1113 1114 1115 1116 1117 1118 1119 1120										1121 1122 1123 1124 1125 1126 1127 1128 1129 1130										1131 1132 1133 1134 1135 1136 1137 1138 1139 1140										1141 1142 1143 1144 1145 1146 1147 1148 1149 1150										1151 1152 1153 1154 1155 1156 1157 1158 1159 1160										1161 1162 1163 1164 1165 1166 1167 1168 1169 1170										1171 1172 1173 1174 1175 1176 1177 1178 1179 1180										1181 1182 1183 1184 1185 1186 1187 1188 1189 1190										1191 1192 1193 1194 1195 1196 1197 1198 1199 1200										1201 1202 1203 1204 1205 1206 1207 1208 1209 1210										1211 1212 1213 1214 1215 1216 1217 1218 1219 1220										1221 1222 1223 1224 1225 1226 1227 1228 1229 1230										1231 1232 1233 1234 1235 1236 1237 1238 1239 1240										1241 1242 1243 1244 1245 1246 1247 1248 1249 1250										1251 1252 1253 1254 1255 1256 1257 1258 1259 1260										1261 1262 1263 1264 1265 1266 1267 1268 1269 1270										1271 1272 1273 1274 1275 1276 1277 1278 1279 1280										1281 1282 1283 1284 1285 1286 1287 1288 1289 1290										1291 1292 1293 1294 1295 1296 1297 1298 1299 1300										1301 1302 1303 1304 1305 1306 1307 1308 1309 1310										1311 1312 1313 1314 1315 1316 1317 1318 1319 1320										1321 1322 1323 1324 1325 1326 1327 1328 1329 1330										1331 1332 1333 1334 1335 1336 1337 1338 1339 1340										1341 1342 1343 1344 1345 1346 1347 1348 1349 1350										1351 1352 1353 1354 1355 1356 1357 1358 1359 1360										1361 1362 1363 1364 1365 1366 1367 1368 1369 1370										1371 1372 1373 1374 1375 1376 1377 1378 1379 1380										1381 1382 1383 1384 1385 1386 1387 1388 1389 1390										1391 1392 1393 1394 1395 1396 1397 1398 1399 1400										1401 1402 1403 1404 1405 1406 1407 1408 1409 1410										1411 1412 1413 1414 1415 1416 1417 1418 1419 1420										1421 1422 1423 1424 1425 1426 1427 1428 1429 1430										1431 1432 1433 1434 1435 1436 1437 1438 1439 1440										1441 1442 1443 1444 1445 1446 1447 1448 1449 1450										1451 1452 1453 1454 1455 1456 1457 1458 1459 1460										1461 1462 1463 1464 1465 1466 1467 1468 1469 1470										1471 1472 1473 1474 1475 1476 1477 1478 1479 1480										1481 1482 1483 1484 1485 1486 1487 1488 1489 1490										1491 1492 1493 1494 1495 1496 1497 1498 1499 1500										1501 1502 1503 1504 1505 1506 1507 1508 1509 1510										1511 1512 1513 1514 1515 1516 1517 1518 1519 1520										1521 1522 1523 1524 1525 1526 1527 1528 1529 1530										1531 1532 1533 1534 1535 1536 1537 1538 1539 1540										1541 1542 1543 1544 1545 1546 1547 1548 1549 1550										1551 1552 1553 1554 1555 1556 1557 1558 1559 1560										1561 1562 1563 1564 1565 1566 1567 1568 1569 1570										1571 1572 1573 1574 1575 1576 1577 1578 1579 1580										1581 1582 1583 1584 1585 1586 1587 1588 1589 1590										1591 1592 1593 1594 1595 1596 1597 1598 1599 1600										1601 1602 1603 1604 1605 1606 1607 1608 1609 1610										1611 1612 1613 1614 1615 1616 1617 1618 1619 1620										1621 1622 1623 1624 1625 1626 1627 1628 1629 1630										1631 1632 1633 1634 1635 1636 1637 1638 1639 1640										1641 1642 1643 1644 1645 1646 1647 1648 1649 1650										1651 1652 1653 1654 1655 1656 1657 1658 1659 1660										1661 1662 1663 1664 1665 1666 1667 1668 1669 1670										1671 1672 1673 1674 1675 1676 1677 1678 1679 1680										1681 1682 1683 1684 1685 1686 1687 1688 1689 1690										1691 1692 1693 1694 1695 1696 1697 1698 1699 1700										1701 1702 1703 1704 1705 1706 1707 1708 1709 1710										1711 1712 1713 1714 1715 1716 1717 1718 1719 1720										1721 1722 1723 1724 1725 1726 1727 1728 1729 1730										1731 1732 1733 1734 1735 1736 1737 1738 1739 1740										1741 1742 1743 1744 1745 1746 1747 1748 1749 1750										1751 1752 1753 1754 1755 1756 1757 1758 1759 1760										1761 1762 1763 1764 1765 1766 1767 1768 1769 1770										1771 1772 1773 1774 1775 1776 1777 1778 1779 1780										1781 1782 1783 1784 1785 1786 1787 1788 1789 1790										1791 1792 1793 1794 1795 1796 1797 1798 1799 1800										1801 1802 1803 1804 1805 1806 1807 1808 1809 1810										1811 1812 1813 1814 1815 1816 1817 1818 1819 1820										1821 1822 1823 1824 1825 1826 1827 1828 1829 1830										1831 1832 1833 1834 1835 1836 1837 1838 1839 1840										1841 1842 1843 1844 1845 1846 1847 1848 1849 1850										1851 1852 1853 1854 1855 1856 1857 1858 1859 1860										1861 1862 1863 1864 1865 1866 1867 1868 1869 1870										1871 1872 1873 1874 1875 1876 1877 1878 1879 1880										1881 1882 1883 1884 1885 1886 1887 1888 1889 1890										1891 1892 1893 1894 1895 1896 1897 1898 1899 1900										1901 1902 1903 1904 1905 1906 1907 1908 1909 1910										1911 1912 1913 1914 1915 1916 1917 1918 1919 1920										1921 1922 1923 1924 1925 1926 1927 1928 1929 1930										1931 1932 1933 1934 1935 1936 1937 1938 1939 1940										1941 1942 1943 1944 1945 1946 1947 1948 1949 1950										1951 1952 1953 1954 1955 1956 1957 1958 1959 1960										1961 1962 1963 1964 1965 1966 1967 1968 1969 1970										1971 1972 1973 1974 1975 1976 1977 1978 1979 1980										1981 1982 1983 1984 1985 1986 1987 1988 1989 1990										1991 1992 1993 1994 1995 1996 1997 1998 1999 2000										2001 2002 2003 2004 2005 2006 2007 2008 2009 2010										2011 2012 2013 2014 2015 2016 2017 2018 2019 2020										2021 2022 2023 2024 2025 2026 2027 2028 2029 2030										2031 2032 2033 2034 2035 2036 2037 2038 2039 2040										2041 2042 2043 2044 2045 2046 2047 2048 2049 2050										2051 2052 2053 2054 2055 2056 2057 2058 2059 2060										2061 2062 2063 2064 2065 2066 2067 2068 2069 2070										2071 2072 2073 2074 2075 2076 2077 2078 2079 2080										2081 2082 2083 2084 2085 2086 2087 2088 2089 2090										2091 2092 2093 2094 2095 2096 2097 2098 2099 2100										2101 2102 2103 2104 2105 2106 2107 2108 2109 2110										2111 2112 2113 2114 2115 2116 2117 2118 2119 2120										2121 2122 2123 2124 2125 2126 2127 2128 2129 2130										2131 2132 2133 2134 2135 2136 2137 2138 2139 2140										2141 2142 2143 2144 2145 2146 2147 2148 2149 2150										2151 2152 2153 2154 2155 2156 2157 2158 2159 2160										2161 2162 2163 2164 2165 2166 2167 2168 2169 2170										2171 2172 2173 2174 2175 2176 2177 2178 2179 2180										2181 2182 2183 2184 2185 2186 2187 2188 2189 2190										2191 2192 2193 2194 2195 2196 2197 2198 2199 2200										2201 2202 2203 2204 2205 2206 2207 2208 2209 2210										2211 2212 2213 2214 2215 2216 2217 2218 2219 2220										2221 2222 2223 2224 2225 2226 2227 2228 2229 2230										2231 2232 2233 2234 2235 2236 2237 2238 2239 2240										2241 2242 2243 2244 2245 2246 2247 2248 2249 2250										2251 2252 2253 2254 2255 2256 2257 2258 2259 2260										2261 2262 2263 2264 2265 2266 2267 2268 2269 2270										2271 2272 2273 2274 2275 2276 2277 2278 2279 2280										2281 2282 2283 2284 2285 2286 2287 2288 2289 2290										2291 2292 2293 2294 2295 2296 2297 2298 2299 2300										2301 2302 2303 2304 2305 2306 2307 2308 2309 2310										2311 2312 2313 2314 2315 2316 2317 2318 2319 2320										2321 2322 2323									
----	--	--	--	--	--	--	--	--	--	----------------------	--	--	--	--	--	--	--	--	--	-------------------------------	--	--	--	--	--	--	--	--	--	-------------------------------	--	--	--	--	--	--	--	--	--	-------------------------------	--	--	--	--	--	--	--	--	--	-------------------------------	--	--	--	--	--	--	--	--	--	-------------------------------	--	--	--	--	--	--	--	--	--	-------------------------------	--	--	--	--	--	--	--	--	--	-------------------------------	--	--	--	--	--	--	--	--	--	-------------------------------	--	--	--	--	--	--	--	--	--	--------------------------------	--	--	--	--	--	--	--	--	--	---	--	--	--	--	--	--	--	--	--	---	--	--	--	--	--	--	--	--	--	---	--	--	--	--	--	--	--	--	--	---	--	--	--	--	--	--	--	--	--	---	--	--	--	--	--	--	--	--	--	---	--	--	--	--	--	--	--	--	--	---	--	--	--	--	--	--	--	--	--	---	--	--	--	--	--	--	--	--	--	---	--	--	--	--	--	--	--	--	--	---	--	--	--	--	--	--	--	--	--	---	--	--	--	--	--	--	--	--	--	---	--	--	--	--	--	--	--	--	--	---	--	--	--	--	--	--	--	--	--	---	--	--	--	--	--	--	--	--	--	---	--	--	--	--	--	--	--	--	--	---	--	--	--	--	--	--	--	--	--	---	--	--	--	--	--	--	--	--	--	---	--	--	--	--	--	--	--	--	--	---	--	--	--	--	--	--	--	--	--	---	--	--	--	--	--	--	--	--	--	---	--	--	--	--	--	--	--	--	--	---	--	--	--	--	--	--	--	--	--	---	--	--	--	--	--	--	--	--	--	---	--	--	--	--	--	--	--	--	--	---	--	--	--	--	--	--	--	--	--	---	--	--	--	--	--	--	--	--	--	---	--	--	--	--	--	--	--	--	--	---	--	--	--	--	--	--	--	--	--	---	--	--	--	--	--	--	--	--	--	---	--	--	--	--	--	--	--	--	--	---	--	--	--	--	--	--	--	--	--	---	--	--	--	--	--	--	--	--	--	---	--	--	--	--	--	--	--	--	--	---	--	--	--	--	--	--	--	--	--	---	--	--	--	--	--	--	--	--	--	---	--	--	--	--	--	--	--	--	--	---	--	--	--	--	--	--	--	--	--	---	--	--	--	--	--	--	--	--	--	---	--	--	--	--	--	--	--	--	--	---	--	--	--	--	--	--	--	--	--	---	--	--	--	--	--	--	--	--	--	---	--	--	--	--	--	--	--	--	--	---	--	--	--	--	--	--	--	--	--	---	--	--	--	--	--	--	--	--	--	---	--	--	--	--	--	--	--	--	--	---	--	--	--	--	--	--	--	--	--	---	--	--	--	--	--	--	--	--	--	---	--	--	--	--	--	--	--	--	--	---	--	--	--	--	--	--	--	--	--	---	--	--	--	--	--	--	--	--	--	---	--	--	--	--	--	--	--	--	--	---	--	--	--	--	--	--	--	--	--	---	--	--	--	--	--	--	--	--	--	---	--	--	--	--	--	--	--	--	--	---	--	--	--	--	--	--	--	--	--	---	--	--	--	--	--	--	--	--	--	---	--	--	--	--	--	--	--	--	--	---	--	--	--	--	--	--	--	--	--	---	--	--	--	--	--	--	--	--	--	---	--	--	--	--	--	--	--	--	--	---	--	--	--	--	--	--	--	--	--	---	--	--	--	--	--	--	--	--	--	---	--	--	--	--	--	--	--	--	--	---	--	--	--	--	--	--	--	--	--	---	--	--	--	--	--	--	--	--	--	---	--	--	--	--	--	--	--	--	--	---	--	--	--	--	--	--	--	--	--	---	--	--	--	--	--	--	--	--	--	---	--	--	--	--	--	--	--	--	--	---	--	--	--	--	--	--	--	--	--	---	--	--	--	--	--	--	--	--	--	---	--	--	--	--	--	--	--	--	--	---	--	--	--	--	--	--	--	--	--	---	--	--	--	--	--	--	--	--	--	---	--	--	--	--	--	--	--	--	--	---	--	--	--	--	--	--	--	--	--	---	--	--	--	--	--	--	--	--	--	---	--	--	--	--	--	--	--	--	--	---	--	--	--	--	--	--	--	--	--	---	--	--	--	--	--	--	--	--	--	---	--	--	--	--	--	--	--	--	--	---	--	--	--	--	--	--	--	--	--	---	--	--	--	--	--	--	--	--	--	---	--	--	--	--	--	--	--	--	--	---	--	--	--	--	--	--	--	--	--	---	--	--	--	--	--	--	--	--	--	---	--	--	--	--	--	--	--	--	--	---	--	--	--	--	--	--	--	--	--	---	--	--	--	--	--	--	--	--	--	--	--	--	--	--	--	--	--	--	--	---	--	--	--	--	--	--	--	--	--	---	--	--	--	--	--	--	--	--	--	---	--	--	--	--	--	--	--	--	--	---	--	--	--	--	--	--	--	--	--	---	--	--	--	--	--	--	--	--	--	---	--	--	--	--	--	--	--	--	--	---	--	--	--	--	--	--	--	--	--	---	--	--	--	--	--	--	--	--	--	---	--	--	--	--	--	--	--	--	--	---	--	--	--	--	--	--	--	--	--	---	--	--	--	--	--	--	--	--	--	---	--	--	--	--	--	--	--	--	--	---	--	--	--	--	--	--	--	--	--	---	--	--	--	--	--	--	--	--	--	---	--	--	--	--	--	--	--	--	--	---	--	--	--	--	--	--	--	--	--	---	--	--	--	--	--	--	--	--	--	---	--	--	--	--	--	--	--	--	--	---	--	--	--	--	--	--	--	--	--	---	--	--	--	--	--	--	--	--	--	---	--	--	--	--	--	--	--	--	--	---	--	--	--	--	--	--	--	--	--	---	--	--	--	--	--	--	--	--	--	---	--	--	--	--	--	--	--	--	--	---	--	--	--	--	--	--	--	--	--	---	--	--	--	--	--	--	--	--	--	---	--	--	--	--	--	--	--	--	--	---	--	--	--	--	--	--	--	--	--	---	--	--	--	--	--	--	--	--	--	---	--	--	--	--	--	--	--	--	--	---	--	--	--	--	--	--	--	--	--	---	--	--	--	--	--	--	--	--	--	---	--	--	--	--	--	--	--	--	--	---	--	--	--	--	--	--	--	--	--	---	--	--	--	--	--	--	--	--	--	---	--	--	--	--	--	--	--	--	--	---	--	--	--	--	--	--	--	--	--	---	--	--	--	--	--	--	--	--	--	---	--	--	--	--	--	--	--	--	--	---	--	--	--	--	--	--	--	--	--	---	--	--	--	--	--	--	--	--	--	---	--	--	--	--	--	--	--	--	--	---	--	--	--	--	--	--	--	--	--	---	--	--	--	--	--	--	--	--	--	---	--	--	--	--	--	--	--	--	--	---	--	--	--	--	--	--	--	--	--	---	--	--	--	--	--	--	--	--	--	---	--	--	--	--	--	--	--	--	--	---	--	--	--	--	--	--	--	--	--	---	--	--	--	--	--	--	--	--	--	---	--	--	--	--	--	--	--	--	--	---	--	--	--	--	--	--	--	--	--	---	--	--	--	--	--	--	--	--	--	---	--	--	--	--	--	--	--	--	--	---	--	--	--	--	--	--	--	--	--	---	--	--	--	--	--	--	--	--	--	---	--	--	--	--	--	--	--	--	--	---	--	--	--	--	--	--	--	--	--	---	--	--	--	--	--	--	--	--	--	---	--	--	--	--	--	--	--	--	--	---	--	--	--	--	--	--	--	--	--	---	--	--	--	--	--	--	--	--	--	---	--	--	--	--	--	--	--	--	--	---	--	--	--	--	--	--	--	--	--	---	--	--	--	--	--	--	--	--	--	---	--	--	--	--	--	--	--	--	--	---	--	--	--	--	--	--	--	--	--	---	--	--	--	--	--	--	--	--	--	---	--	--	--	--	--	--	--	--	--	---	--	--	--	--	--	--	--	--	--	---	--	--	--	--	--	--	--	--	--	---	--	--	--	--	--	--	--	--	--	---	--	--	--	--	--	--	--	--	--	---	--	--	--	--	--	--	--	--	--	---	--	--	--	--	--	--	--	--	--	---	--	--	--	--	--	--	--	--	--	---	--	--	--	--	--	--	--	--	--	---	--	--	--	--	--	--	--	--	--	---	--	--	--	--	--	--	--	--	--	---	--	--	--	--	--	--	--	--	--	---	--	--	--	--	--	--	--	--	--	---	--	--	--	--	--	--	--	--	--	---	--	--	--	--	--	--	--	--	--	---	--	--	--	--	--	--	--	--	--	---	--	--	--	--	--	--	--	--	--	---	--	--	--	--	--	--	--	--	--	---	--	--	--	--	--	--	--	--	--	---	--	--	--	--	--	--	--	--	--	---	--	--	--	--	--	--	--	--	--	---	--	--	--	--	--	--	--	--	--	---	--	--	--	--	--	--	--	--	--	---	--	--	--	--	--	--	--	--	--	---	--	--	--	--	--	--	--	--	--	---	--	--	--	--	--	--	--	--	--	---	--	--	--	--	--	--	--	--	--	---	--	--	--	--	--	--	--	--	--	---	--	--	--	--	--	--	--	--	--	---	--	--	--	--	--	--	--	--	--	---	--	--	--	--	--	--	--	--	--	---	--	--	--	--	--	--	--	--	--	---	--	--	--	--	--	--	--	--	--	---	--	--	--	--	--	--	--	--	--	---	--	--	--	--	--	--	--	--	--	---	--	--	--	--	--	--	--	--	--	---	--	--	--	--	--	--	--	--	--	---	--	--	--	--	--	--	--	--	--	---	--	--	--	--	--	--	--	--	--	---	--	--	--	--	--	--	--	--	--	---	--	--	--	--	--	--	--	--	--	---	--	--	--	--	--	--	--	--	--	---	--	--	--	--	--	--	--	--	--	---	--	--	--	--	--	--	--	--	--	---	--	--	--	--	--	--	--	--	--	---	--	--	--	--	--	--	--	--	--	---	--	--	--	--	--	--	--	--	--	---	--	--	--	--	--	--	--	--	--	---	--	--	--	--	--	--	--	--	--	---	--	--	--	--	--	--	--	--	--	---	--	--	--	--	--	--	--	--	--	---	--	--	--	--	--	--	--	--	--	---	--	--	--	--	--	--	--	--	--	---	--	--	--	--	--	--	--	--	--	---	--	--	--	--	--	--	--	--	--	---	--	--	--	--	--	--	--	--	--	---	--	--	--	--	--	--	--	--	--	---	--	--	--	--	--	--	--	--	--	---	--	--	--	--	--	--	--	--	--	---	--	--	--	--	--	--	--	--	--	---	--	--	--	--	--	--	--	--	--	---	--	--	--	--	--	--	--	--	--	---	--	--	--	--	--	--	--	--	--	---	--	--	--	--	--	--	--	--	--	----------------	--	--	--	--	--	--	--	--	--

Architect
PMDL
17 / 124 WALKER STREET,
NORTH SYDNEY, NSW 2060

Engineer
TTW **Structural
Civil
Traffic
Façade**
612 9439 7288 | 48 Chandos Street St Leonards NSW 2065

Project
**SAINT IGNATIUS' COLLEGE
RIVERVIEW - STAGE 2**

Sheet Subject
**CONCEPT
BULK EARTHWORKS
CUT AND FILL PLAN**

Scale : A1
1:200

Drawn
DM

Authorised

Job No
191740

Drawing No
SKC30

Revision
P1

Plot File Created: Nov 18, 2020 - 10:06pm

This drawing is copyright and is the property of TAYLOR THOMSON WHITTING (NSW) Pty Ltd and must not be used without authorisation.
THIS DRAWING TO BE READ IN CONJUNCTION WITH ALL RELEVANT NOTES ON DRAWING C01

BULK EARTHWORKS LEGEND

	Batter
	Shoring wall
	Refer to structural engineer's drawings
	Bulk Earthworks Step (Step from low side to high side)
	Bulk earthworks spot level
	Bulk earthworks contour level
	Bulk earthworks platform level

CUT & FILL LEGEND

	Fill greater than 2.0m
	Fill 1.5-2m
	Fill 1.0-1.5m
	Fill 0.5-1.0m
	Fill 0.0-0.5m
	No cut or fill
	Cut 0.0-0.5m
	Cut 0.5-1.0m
	Cut 1.0-1.5m
	Cut 1.5-2.0m
	Cut 2.0-2.5m
	Cut 2.5-3.0m
	Cut 3.0-4.0m
	Cut 4.0-5.0m
	Cut 5.0 or greater

Estimated topsoil stripping
volume (400mm nominal) = 2,300 m³

Estimated cut volume = 4,550 m³
Estimated fill volume = 1,150 m³

Estimated balance volume = 3,400 m³ excess fill

NOTE

- * Bulk Earthworks level = Finish surface - Pavement/slab thickness
- Volumes calculated from stripped surface which assumes nominal 400mm depth of topsoil stripped from existing surface.
- Refer architects drawings for building setback
- Bulk Earthwork drawings are for bulk excavation only. They are not to be used for detailed excavation such as: lift shafts, footings, pits etc.
- Bulk Earthwork setback refers to bulk excavation only. They are not to be used for building, kerb or any other setback.

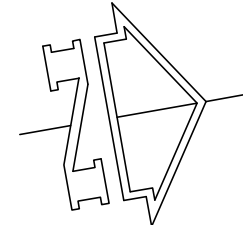

0 2 4 6 8 10 12 14 16m
1:200 A1 1:400 A3

PRELIMINARY
NOT TO BE USED
FOR CONSTRUCTION

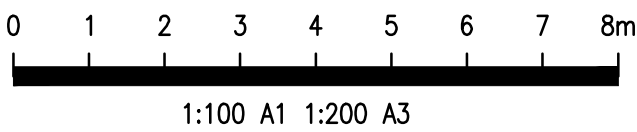
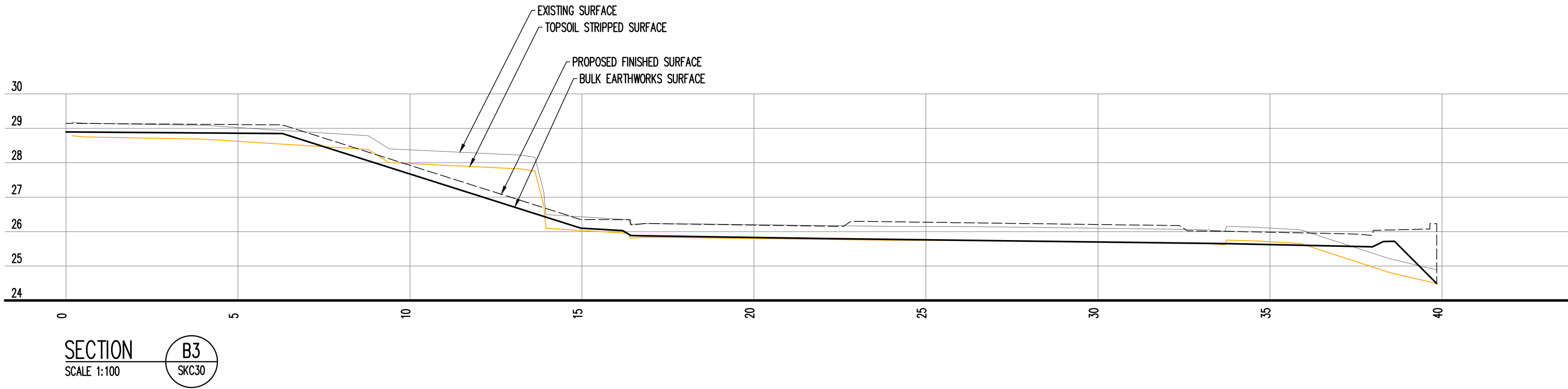
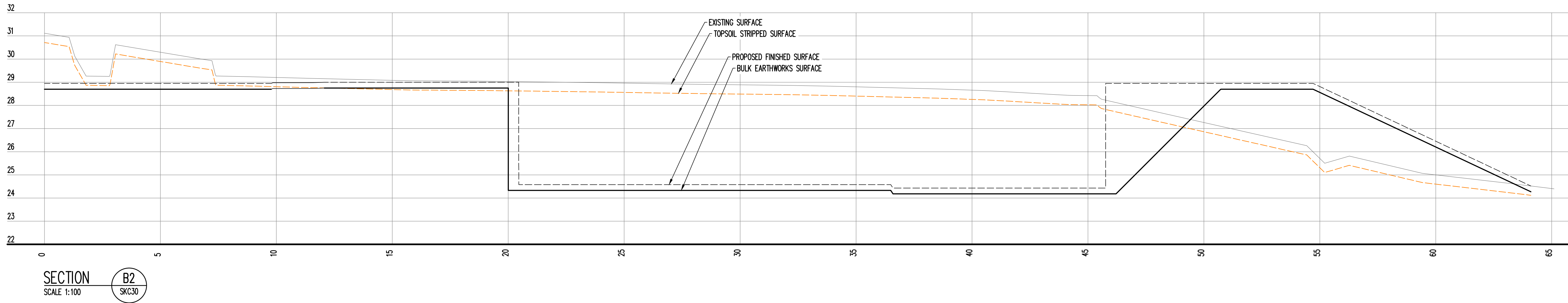
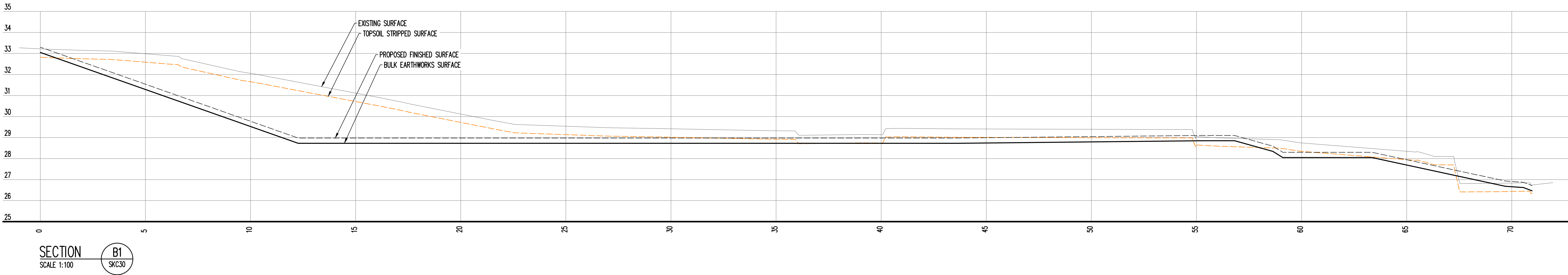

PRELIMINARY
NOT TO BE USED
FOR CONSTRUCTION

T:\Projects\SKC31.dwg - USER: duncorm - Plot File Created: Nov 18, 2020 - 10:06pm

A1 0 1 2 3 4 5 6 7 8 9 10

P1 PRELIMINARY				DM	DM	18.11.20					
Rev	Description	Eng	Draft	Date	Rev	Description	Eng	Draft	Date	Rev	Description

Architect
PMDL
17 / 124 WALKER STREET,
NORTH SYDNEY, NSW 2060

Engineer
TTW **Structural**
Civil
Traffic
Façade
612 9439 7288 | 48 Chandos Street St Leonards NSW 2065

Project
SAINT IGNATIUS' COLLEGE
RIVERVIEW - STAGE 2

Sheet Subject
CONCEPT
BULK SECTIONS SHEET

Scale : A1
1:200

Drawn
DM

Authorised
-

Job No
191740

Drawing No
SKC31

Revision
P1

Plot File Created: Nov 18, 2020 - 10:06pm