

Date	CM	The Contractor is to check all dimensions from the actual work; notify designer of discrepancies in the drawings and seek instructions.
Date	15/08/2019	
Checked	Authority is required for any reproduction.	
Printed Date	This drawing is based on architect's drawings by Koturic & Co. Pty Ltd and is subject to copyright.	
File Name	541	

Project

## New Learning Centre

6A Watsford Road,  
Campbelltown

For

Warakirri College

Sheet Name

## Landscape plan

Scales	1:100	Sheet	A1
Drawing Number	541-L1	Revision Number	H

### PLATFORM SEAT DETAIL

1000 x 1000 CONCRETE SLAB

1000

800

20

100

PAVING LEVEL

CORE FILLED BLOCKWORK BASE, CEMENT RENDERED AND PAINTED



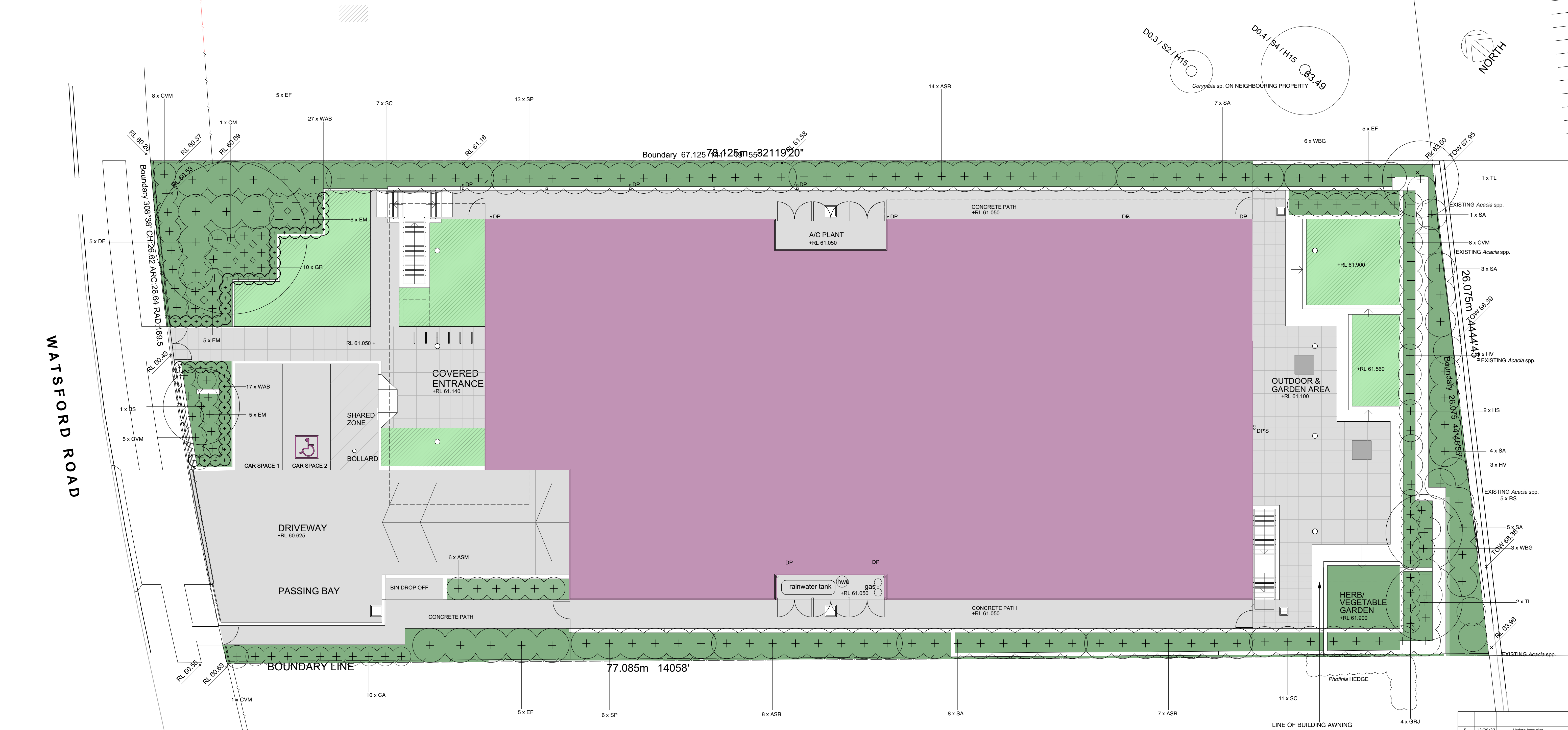

Acmena smithii 'BWNRED' 'Red Head'



Acmena smithii var. minor 'Baby Lily'



Banksia serrata



Callistemon viminalis 'LC01' 'Macarthur'



Correa alba



Corymbia maculata



Doryanthes excelsa



Eriostemon (syn. Philotheca) myoporoides



Eucalyptus ficifolia 'Baby Scarlet'



Grevillea rosmarinifolia 'H16' 'Crimson Villea'



Grevillea rhyolitica x juniperina 'TWD01' 'Cherry Cluster'



Hardenbergia violacea 'HB1' 'Meema'



Hibbertia scandens



Rhagodia spinescens 'SAB01' 'Aussie Flat Bush'



Syzygium australe 'Resilience'



Syzygium 'Cascade'



Syzygium paniculatum 'Backyard Bliss'



Tristaniopsis laurina



Westringia fruticosa 'Aussie Box'



Westringia hybrid 'WES03' 'Blue Gem'

### PLANT SCHEDULE

CODE	PLANT NAME	AV. MATURE HT.	No.	POT SIZE in mm
ASR	Acmena smithii 'BWNRED' 'Red Head'	6m	21	400
ASM	Acmena smithii var. minor 'Baby Lily'	1.0m	6	200
BS	Banksia serrata	6m	1	400
CVM	Callistemon viminalis 'LC01' 'Macarthur'	1.8m	22	200
CA	Correa alba	1.2m	10	200
CM	Corymbia maculata	15m	1	75L
DE	Doryanthes excelsa	2m	5	300
EM	Eriostemon (syn. Philotheca) myoporoides	0.9m	16	200
EF	Eucalyptus ficifolia 'Baby Scarlet'	3m	15	400
GR	Grevillea rosmarinifolia 'H16' 'Crimson Villea'	0.8m	10	200
GRJ	Grevillea rhyolitica x juniperina 'TWD01' 'Cherry Cluster'	0.4m	4	200
HV	Hardenbergia violacea 'HB1' 'Meema'	0.4m	6	200
HS	Hibbertia scandens	0.4m	2	200
RS	Rhagodia spinescens 'SAB01' 'Aussie Flat Bush'	0.5m	5	200
SA	Syzygium australe 'Resilience'	6m	28	400
SC	Syzygium 'Cascade'	2.0m	18	400
SP	Syzygium paniculatum 'Backyard Bliss'	6m	19	400
TL	Tristaniopsis laurina	8m	3	400
WAB	Westringia fruticosa 'WES08' 'Aussie Box'	0.8m	44	200
WBG	Westringia hybrid 'WES03' 'Blue Gem'	1.0m	9	200

E	12/09/22	Update base plan
D	10/11/20	For tender
C	10/11/20	
B	11/10/19	For DA submission
A	1/10/19	Design development
Revision	Date	Amendment

impact planners pty ltd

m: 0418 265 953  
e: impactplanners@fastmail.fm

Drawn	CM	The Contractor is to check all dimensions from the actual work, notify designer of discrepancies in the drawings and seek instructions.
Date	15/08/2019	
Checked		Authority is required for any reproduction.
Printed Date		This drawing is based on architectural drawings by Korus & Co. Pty Ltd and is subject to copyright.
File Name	541	

Project  
New Learning Centre

6A Watsford Road,  
Campbelltown

For

Warakirri College

Sheet  
Name  
Planting plan

Scales	1:100	Sheet	A1
Drawing Number	541-L2	Revision Number	E