

CONSULTATION REPORT

Green Square Integrated Community Facility and School - SSDA 10381 -
3 Joyton Avenue, Zetland



PR148806

3

13 October 2021

CONSULTATION REPORT

Document status

| Version | Purpose of document | Authored by | Reviewed by | Approved by | Review date |
|---------|-------------------------------------|-----------------|-------------|-------------|-------------|
| 0 | Preliminary draft for client review | Christine Bower | Rob Dwyer | Rob Dwyer | 19-07-21 |
| 1 | Draft for client review | Christine Bower | Rob Dwyer | Rob Dwyer | 13-08-21 |
| 2 | Draft for client review | Christine Bower | Rob Dwyer | Rob Dwyer | 03-09-21 |
| 3 | Final for submission | Christine Bower | Rob Dwyer | Rob Dwyer | 13-10-21 |

Approval for issue

Rob Dwyer



13 October 2021

This report was prepared by RPS within the terms of RPS' engagement with its client and in direct response to a scope of services. This report is supplied for the sole and specific purpose for use by RPS' client. The report does not account for any changes relating to the subject matter of the report, or any legislative or regulatory changes that have occurred since the report was produced and that may affect the report. RPS does not accept any responsibility or liability for loss whatsoever to any third party caused by, related to or arising out of any use or reliance on the report.

Prepared by:

RPS

Rob Dwyer
Planning Manager - Newcastle

Unit 2A, 45 Fitzroy Street
Carrington NSW 2294

T +61 2 4940 4200
E rob.dwyer@rpsgroup.com.au

Prepared for:

School Infrastructure NSW (SI NSW)

Michael Ing
Project Director

Level 8, 259 George Street
Sydney NSW 2000

Contents

| | |
|---|-----------|
| EXECUTIVE SUMMARY | 1 |
| 1 INTRODUCTION | 3 |
| 1.1 Purpose | 3 |
| 1.2 Consultation objectives | 3 |
| 1.3 Key Stakeholders | 3 |
| 1.4 SEARs Requirements | 4 |
| 2 BACKGROUND | 5 |
| 2.1 School description | 5 |
| 2.2 Project description | 5 |
| 2.3 Detailed scope of work | 5 |
| 2.4 Early consultation | 6 |
| 3 STRUCTURE OF THE COMMUNITY ENGAGEMENT | 7 |
| 3.1 Community engagement objectives | 7 |
| 3.2 Description of consultation and communication channels and activities | 7 |
| 3.3 Community consultation activities | 8 |
| 4 DESIGN COMPETITION | 9 |
| 5 TRANSPORT | 12 |
| 6 STAKEHOLDER AND COMMUNITY FEEDBACK | 13 |
| 6.1 Stakeholder meetings and correspondence | 13 |
| 7 ENVIRONMENTAL IMPACT STATEMENT CONSULTATION – GSICFS | 16 |
| 7.1 Public exhibition and consultation | 16 |
| 7.2 Submissions | 16 |
| 8 COMMUNITY CONSULTATION | 17 |
| 8.1 Community engagement channels and activities | 17 |
| 8.2 Community engagement timeline | 17 |
| 8.3 City of Sydney consultation response | 18 |
| 8.4 Community feedback and response | 19 |
| 9 CONCLUSION | 22 |

Tables

| | | |
|----------|---|----|
| Table 1 | SEARS Stakeholder Engagement | 4 |
| Table 2 | Consultation and communication activities | 7 |
| Table 3 | Communications actions | 8 |
| Table 4 | Jury Summary and Technical Review of BVN Submission | 9 |
| Table 5 | Jury Summary and Technical Review of BVN Submission | 10 |
| Table 6 | Transport Consultation Register | 12 |
| Table 7 | Stakeholder feedback | 13 |
| Table 8 | Community engagement pathways | 17 |
| Table 9 | Summary of engagement | 17 |
| Table 10 | City of Sydney engagement results | 19 |
| Table 11 | Virtual information room enquiries | 20 |

Figures

| | | |
|----------|--|----|
| Figure 1 | Letterbox Drop distribution area | 18 |
|----------|--|----|

Appendices

- Appendix A Media Release
- Appendix B Community Newsletter Announcement
- Appendix C Project Update (English and Chinese)
- Appendix D Information Boards
- Appendix E Information Pack
- Appendix F Virtual Room Information Report

EXECUTIVE SUMMARY

The purpose of community and stakeholder consultation throughout the preparation of the Environmental Impact Statement (EIS) is to ensure that all relevant stakeholders are aware of the Project and have the opportunity to raise key issues of relevance. This report draws on information provided in the Green Square EIS and the Green Square Social Impact Assessment (SIA), to address the requirements outlined in the Planning Secretary's Environmental Assessment Requirements (SEARs) with respect to consultation.

The proposed development is located at 3 Joynton Avenue Zetland. The development is known as the Green Square Integrated Community Facility and School (GSICFS). This is a joint project between Department of Education and the City of Sydney.

The development will comprise a four-storey building made up of various indoor and outdoor functional spaces including:

- Primary education facilities for up to 600 kindergarten to year 6 students.
 - Indoor and outdoor learning spaces.
 - Administration and staff rooms.
 - Library and School community hall.
- Shared multi-function spaces within for school and community use.
 - 2 x multipurpose community facilities rooms to be operated solely by City of Sydney.
 - 2 x multipurpose rooms to be shared by the City of Sydney and the primary school.
- At ground level there is:
 - play spaces which will be a shared use between school and community.
 - multipurpose games court.

A range of consultation mechanisms have been proposed for implementation during the assessment and approvals process for the Green Square Integrated Community Facility and School (GSICFS) project including the following:

- Virtual community information sessions.
- Local government (City of Sydney Council) briefings.
- Department of Planning, Industry and Environment (DPIE) briefings.
- School Infrastructure NSW (SINSW) briefings.
- Transport for NSW briefing.
- Media release.
- Newsletters.
- Project website updates.
- Publication of application and assessment materials on the State Significant Development Project website.

Consultation was conducted with the local community, affected landowners and other relevant stakeholders, including interested and affected persons and advisory agencies. Consultation will continue through subsequent stages including assessment and approval, post approval, during construction and throughout the ongoing operation of the school. The GSICFS project team has developed a community engagement plan for the project, prepared by SINSW. The community engagement strategy will continue to be implemented:

- During assessment and approval of the EIS; and
- Post EIS lodgement, exhibition prior to determination; and
- During construction and ongoing operation of the school.

CONSULTATION REPORT

The undertaking of stakeholder consultation throughout the duration of the project has provided guidance on the project development and has been implemented into the project design. The community consultation process has assisted in determining the intrinsic concerns of community members through responses provided by community members and stakeholders. This has been taken into consideration in the design of the development.

1 INTRODUCTION

1.1 Purpose

This report summarises the consultation and communication activities that have been undertaken in relation to the proposed new primary school to be known as Green Square Integrated Community Facility and School (GSICFS). It forms part of the EIS required for the State Significant Development (SSD-10381) application as specified in the Secretary's Environmental Assessment Requirements (SEARs).

The SEARs for SSD-10381 were received in November 2019. The SEARs require the EIS to describe the consultation as follows:

During the preparation of the EIS, you must consult with the relevant local, State or Commonwealth Government authorities, service providers, community groups, special interest groups including local Aboriginal land councils and registered Aboriginal stakeholders and affected landowners. In particular, you must consult with:

- City of Sydney Council
- Government Architect NSW
- Transport for NSW and
- Transport for NSW (Roads and Maritime Services).

Consultation should commence as soon as practicable to agree the scope of investigation. The EIS must describe the consultation process and the issues raised and identify where the design of the development has been amended in response to these issues. Where amendments have not been made to address an issue, a short explanation should be provided.

Consultation undertaken to support the submission of the EIS has been detailed in this report.

1.2 Consultation objectives

Stakeholder and community feedback has played a significant role in the development of GSICFS. The GSICFS communication objectives include:

- Communicate the rationale for the project and the broader community benefits it will deliver.
- Communicate Schools Infrastructure NSW (SINSW) concept and timing.
- Build key stakeholder and community relationships.
- Provide information regarding the planning approvals process and encourage community participation.
- Provide timely feedback to community issues, enquiries and complaints.

1.3 Key Stakeholders

The GSICFS project represents a unique partnership between the City of Sydney and the Department of Education. Ongoing consultation with City of Sydney has formed an integral part of informing and scoping investigations for the GSICFS development.

Key stakeholders for the project include:

- State government agencies (DPIE, SINSW, TfNSW, Government Architect NSW).
- Local Council (City of Sydney).
- Local community.

1.4 SEARs Requirements

This report summarises the engagement undertaken for the construction of GSICFS by outlining:

- The SEARs for stakeholder and community consultation.
- The consultation process undertaken, including key meetings with stakeholders.
- A summary of feedback received, and issues raised, by specific stakeholders.
- How feedback has been considered in the development of the SSD application.

A response to each relevant requirement of the SEARs is provided below, including references to sections of this report where applicable.

Table 1 SEARS Stakeholder Engagement

| SEARs requirements | Reference |
|--|--|
| During the preparation of the EIS, you must consult with the relevant local, State or Commonwealth Government authorities, service providers, community groups, special interest groups including local Aboriginal land councils and registered Aboriginal stakeholders and affected landowners. In particular, you must consult with: | |
| <ul style="list-style-type: none"> • City of Sydney Council | Refer to Section 4, Section 5 & Section 6. |
| <ul style="list-style-type: none"> • Government Architect NSW | A design competition was undertaken in accordance with Sydney LEP 2012 and the Draft Government Architects Design Excellence Guidelines. The requirement for further consultation with the Government Architect was delegated to the City of Sydney Design advisory panel. |
| <ul style="list-style-type: none"> • Transport for NSW | Refer to Section 5. |
| <ul style="list-style-type: none"> • Transport for NSW (Roads and Maritime Services) | Refer to Section 5. |

2 BACKGROUND

The NSW Government is investing \$7.9 billion over the next four years, continuing its program to deliver 215 new and upgraded schools to support communities across NSW. In addition, a record \$1.3 billion is being spent on school maintenance over five years. This is the largest investment in public education infrastructure in the history of NSW.

In September 2016, the City of Sydney approached the Department of Education with the idea to jointly fund and provide Council-owned land for a new, multi-storey integrated school and community facility at Green Square to cater for 600 primary school students in 24 home bases. The land identified for the project is on a part of the former Royal South Sydney Hospital site.

Located 3.5km south of the Sydney CBD, Green Square is a \$13bn urban development project encompassing 278 hectares of land in Zetland, Waterloo, Rosebery, Beaconsfield and Alexandria. One of Australia's fastest growing communities, more than 60,000 people are expected to live in Green Square by 2030.

Tzannes Architects were engaged to draft initial design concepts for a business case. A brief was then prepared for the Design Excellence Competition which has now been completed. BVN Architecture produced the winning design and have carried the scheme since the design competition.

Once the site has been established site remediation works, including demolition of the existing hydrotherapy pool will be carried out immediately prior to the main construction commencing.

2.1 School description

The proposed development is located at 3 Joynton Avenue Zetland. The development is known as the Green Square Integrated Community Facility and School (GSICFS) and will cater to primary school students. This is a joint project between the Department of Education and the City of Sydney. The development will comprise a four-storey building made up of various indoor and outdoor functional spaces.

2.2 Project description

The construction of GSICFS will:

- Deliver an educational facility for primary aged students and to provide community spaces.
- Offer new classrooms that support and enable smart, future focused learning and teaching.
- Provide the necessary accommodation for the growth in the number of school aged children in the local community.

2.3 Detailed scope of work

The development will comprise a four-storey building made up of various indoor and outdoor functional spaces including:

- Primary education facilities for up to 600 kindergarten to year 6 students
 - Indoor and outdoor learning spaces.
 - Administration and staff rooms.
 - Library and Communal hall.
- Shared multi-function spaces within for school and community use.
 - 2 x multipurpose community facilities rooms to be operated solely by City of Sydney.
 - 2 x multipurpose rooms to be shared by the City of Sydney and the school.
- At ground level there is:
 - play spaces which will be a shared use between school and community.
 - multipurpose games court.

2.4 Early consultation

Early community and stakeholder consultation focused on the development of a master plan and draft concept design, with the objective to provide a new primary education facility. Following early consultation, the concept plans were developed into a draft concept design, which was submitted with the request for SEARs in November 2019. Following receipt of the SEARs, stakeholder and community consultation continued in relation to the proposal, focusing on the draft concept design.

3 STRUCTURE OF THE COMMUNITY ENGAGEMENT

3.1 Community engagement objectives

As set out in the Community Engagement Plan, the following community engagement objectives have been identified for this proposal:

- Promote the benefits of the project.
- Build key schools community stakeholder relationships and maintain goodwill with impacted communities.
- Manage community expectations and build trust by delivering on commitments.
- Provide timely information to impacted stakeholders, schools and broader communities.
- Address and correct misinformation in the public domain.
- Leave a positive legacy in each community.

3.2 Description of consultation and communication channels and activities

Table 2 Consultation and communication activities

| Description of consultation and communication activities | | |
|--|---|---|
| Activity | Strategic intent | Date |
| Media release announcing the project | First formal public announcement that the project concept has been endorsed by the NSW Government and will move forward to the next stage. Announcement that funding has been approved as well as the winner of the design competition. Trigger point for community engagement to commence. | 15 July 2021, see Appendix A and Appendix B . |
| FAQs | To provide approved messaging and responses which address all known, expected and emerging issues and risks. These FAQs will be used to guide content development and will be rolled out across all engagement and communications activities and materials as appropriate and required. | Ongoing through the SINSW website. |
| Project update | Provides context regarding where the project is in the project planning process, reassuring stakeholders and the community that we are still in the consultation phase. | Ongoing, through SINSW website, refer to content in Appendix C . |
| Project webpage | Enable sharing of images, videos and other content to support effective community engagement while face-to-face options are limited due to social distancing. | Ongoing. |
| Information Packs | Provides context regarding where we are in the project planning process and provides some detailed information on design and project update. Will accompany the virtual information sessions as part of the consultation phase. | Detailed on SINSW website, found under Appendix E . |
| Information boards | Provides a visual around the look and design of the new public school. Will be utilised as part of the virtual information sessions as part of the consultation phase. | Ongoing, through SINSW website and Appendix D . |

Description of consultation and communication activities

| | | |
|-----------------------------|---|---|
| Virtual information session | Information session held in a virtual format to showcase materials in an interactive digital environment (information packs, information boards). | A virtual session has been selected as the most appropriate form due to the current Covid-19 situation. Virtual information room details are found under Appendix F . |
|-----------------------------|---|---|

3.3 Community consultation activities

Table 3 below outlines the communication actions undertaken to keep stakeholders and communities informed about this proposal.

Table 3 Communications actions

| Date | Targeted stakeholders | Communication channel and action |
|--|---|---|
| July 2021 | General public | Media release to confirm funding of the project and announce the winner of the design competition. |
| September 2021 | School community, nearby residents | Project update – Virtual information session. |
| 23 September 2021 to 27 September 2021 | All visitors to the Virtual Information Room consultation | Materials from the Virtual information room consultation are available on the project website in the ‘Library’ tab and are found in Appendix E of this report. Results of the Virtual information Room can be found under Appendix F . |

4 DESIGN COMPETITION

The GSICFS project was awarded to BVN Architects as the result of a design competition initiated by School Infrastructure NSW (SI NSW) and the City of Sydney. The design competition was undertaken in accordance with the *Sydney Local Environmental Plan 2012* (Sydney LEP 2012), the City of Sydney *Competitive Design Policy 2013* and the Draft Government Architects Design Excellence Guidelines. The competition was undertaken in consultation and disclosure with City of Sydney, GANSW officers, SINSW and the Probity Advisor. The jury report provides the following recommendations in **Table 4** and features to be retained and rectified as a result of the competition.

Table 4 Jury Summary and Technical Review of BVN Submission

| Design elements that are supported in the scheme (Design Competition Panel) | Design response: |
|---|---|
| The games court was deemed as an integral component of the design and must be maintained in the location proposed | Has been retained in the same location. |
| The public artwork that is integrated with the games court must be maintained, including on the eastern wall and soffit. | Public Art to Games Court will be maintained. |
| The relationship between the Assembly Hall and Games Court is to be retained, especially the benefit of a large, whole of school congregational space. | To remain as presented. |
| The scheme is to maintain the high level of activation to all street frontages. | GSICFS will have a high level of activation to all street frontages. |
| The transparency and openness of the ground floor: the clear line of sight provided with respect to the east-west through site connection is to be maintained as it contributes to a very permeable ground floor. | Clear sightlines through the ground floor plan are provided, notably from east to west. |
| Maintain the visual connections throughout the building – particularly outward views. | Strong visual connections have been maintained throughout the building – outward views from the courtyard (north-south and east-west and upper levels provide 360-degree precinct views. |
| The generosity and clarity of the open space is to be retained alongside the coherent landscape strategy. | Open space has been retained alongside the landscape strategy. |
| The Jury provide strong support for the fresh and distinctive character of the cladding and request this is conceptually retained subject to material selection and sourcing. | The cladding design has been retained. |
| The high degree of flexibility, pattern of light and shade, privacy and thermal benefits of the screen should be maintained. | Light, shade, privacy and thermal benefits of the screen have been retained. |
| Retention of a north, south, east and west connection. | The north, south and east, west connection has been retained in the design. |
| The Jury strongly support the benefits of the timber structure, particularly the aesthetic, sustainability, health and education benefits. | The design has retained the majority of the ESD commitments from the original design. The timber structure has not been able to be retained due to cost, fire rating and durability factors. |
| The flexibility of learning areas is supported and is to be retained. | The flexibility of learning areas has been retained. |

| Design elements that are supported in the scheme (Design Competition Panel) | Design response: |
|--|---|
| The location of multipurpose Space 2 on the corner of the shared driveway facing the public space is to be retained. | The location of multipurpose space 2 has been retained. |
| Principles of sustainability to be maintained in achieving the aspirations of the proponent. | ESD commitments have been retained in the design. |

Table 5 Jury Summary and Technical Review of BVN Submission

| Design elements that require resolution (Design Competition Panel) | Design Response: |
|---|--|
| Levels and security lines, universal access to ground level to be resolved. | Universal access to ground level has been well resolved. |
| Resolution of OSHC and north-south access between 4:30pm and 6:00pm. | Access has been resolved by allowing OSHC to operate until 6:00pm and thereafter allowing north and south access to the public from 6:30pm. |
| Review and resolve the address and entry of multipurpose space 1A and multipurpose space 1B- levels and ancillary spaces. | Has been well resolved with lowered internal floor level plus Zetland Avenue universal access. |
| Provision of direct access to amenities for multipurpose space 1A and multipurpose space 1B. | Direct access to amenities for multipurpose space 1A and multipurpose space 1B has been provided. |
| Further refinement with respect of the Zetland Avenue access to provide visually more direct north-south connections. | Zetland Avenue access has been well resolved. |
| Careful selection of materials. | Materials have been selected on the basis of quality of finish, compliance with school standards and cost effectiveness. |
| The ground floor administration area is to be replanned to ensure all required functions are co-located. | The ground floor administration has been split into two areas with vertical adjacency. |
| Canteen location to be revisited. | Canteen location has been moved to a more central location. |
| Further development and detail with regard to maintenance access between the facade screen and internal glass line wall to be reviewed and resolved to ensure adequate space is provided. | The maintenance access between the facade screen and internal glass line wall has been well resolved. |
| Exploration of options with regard to the location of the library to the satisfaction of education requirements. | The library location has been retained in the original location on Level 3. This strongly supports the link to outdoor learning and keeping Learning Hubs on the lower levels. |
| Resolve issues with respect to columns with multipurpose spaces and games court to ensure unobstructed spaces are provided. | The multipurpose spaces and games court have been resolved to ensure unobstructed spaces are provided. |
| Resolution of the location of substation to be accessed on Portman Street. | No substation required, demonstrated by the energy provider. |
| Look for opportunities to increase the generosity of vertical circulation. | Lift issues have been resolved. The vertical staircase width has increased. |

| Design elements that require resolution (Design Competition Panel) | Design Response: |
|--|---|
| Refinements to maximise outdoor play space – it is accepted that with the planning constraints on this site that being slightly under the requirement may be acceptable. | Outdoor play space has been maximised which includes utilisation of ground floor and rooftop play areas. |
| Toilet numbers and locations are to be reviewed. | Toilet numbers have been confirmed to provide appropriate amenity. |
| Equitable light distribution to all classrooms access throughout the school which may involve the relocation of some amenities. | Resolved. |
| Resolution of carparking and loading to ensure all functions operate effectively and do not block north – south public access. | Carparking and loading has been resolved to ensure north- south public access is not blocked. |
| Effective management of acoustic impacts of the Games Court for internal school functions. | The acoustic report prepared by Acoustic Logic demonstrates that the design of the Games court is attenuated. |

The competition provided an initial opportunity for consultation with relevant stakeholders and informed the design of GSICFS. The recommended design amendments have been carefully considered and where practicable, have been integrated into the final design of GSICFS.

5 TRANSPORT

The following consultation has been undertaken with the City of Sydney transport team, SINSW and TfNSW throughout the duration of the project. **Table 6** details the consultation and the subject of the consultation in relation to transport.

Table 6 Transport Consultation Register

| Contact | Date | Subject | Overview |
|----------------------------------|------------|-------------------------------------|--|
| NSW Ambulance Service | 07/08/2020 | Ambulance Access | Confirming NSW ambulance access requirements. |
| Mukesh Malhotra - City of Sydney | 04/03/2021 | AECOM SIDRA Models | Requesting SIDRA modelling from City of Sydney. |
| Fiona Campbell - City of Sydney | 04/03/2021 | Mode Share Information | City of Sydney provided Traffix with some bicycle data from other schools. |
| Bruce Gillespie - City of Sydney | 05/03/2021 | AECOM SIDRA Models | Requesting SIDRA modelling from City of Sydney. |
| Bourke Street Public School | 08/03/2021 | Bicycle and Scooter Parking Demands | Requesting school to provide some information relating to their existing parking arrangements/demands. |
| Peter Calantzis - City of Sydney | 10/03/2021 | AECOM SIDRA Models | Requesting SIDRA modelling from City of Sydney. |
| Asif Ahmed - City of Sydney | 11/03/2021 | Bicycle Parking Standards | Provided advice to City of Sydney regarding latest bicycle parking standards. |
| Rod Stanton - SINSW | 11/03/2021 | School Questionnaire Surveys | Issuing draft questionnaire surveys for SINSW review. |
| Rod Stanton - SINSW | 15/03/2021 | School Questionnaire Surveys | Updated questionnaire surveys for SINSW review. |
| Rod Stanton - SINSW | 17/03/2021 | School Questionnaire Surveys | Final surveys sent to SINSW for release. |
| Rod Stanton - SINSW | 26/03/2021 | School Questionnaire Surveys | Updating SINSW on survey response rate. |
| Divna Cvetojevic - TfNSW | 29/03/2021 | AECOM SIDRA Models | Requesting SIDRA modelling from TfNSW. |
| Deirdre Coffey - City of Sydney | 08/04/2021 | Waste Truck Size | Confirming largest waste truck accessing the site. |
| Divna Cvetojevic - TfNSW | 12/04/2021 | AECOM SIDRA Models | Advising TfNSW that info provided was insufficient. |
| Rod Stanton - SINSW | 30/04/2021 | AECOM SIDRA Models | Providing SINSW with City of Sydney contact regarding SIDRA models. |
| Deirdre Coffey - City of Sydney | 10/05/2021 | AECOM SIDRA Models | Request to City of Sydney to confirm assumptions relating to the SIDRA models. |
| Divna Cvetojevic - TfNSW | 11/05/2021 | AECOM SIDRA Models | Request to TfNSW to confirm assumptions relating to the SIDRA models |

The project team has undergone extensive consultation in regard to access and traffic modelling required for the development. As a result of the consultation, SIDRA modelling has been utilised from a local project for the projected transport scenarios as limited parking is provided onsite. It is anticipated that future travel modes for staff and students would involve increased uptake of active modes of transport and potentially public transport.

In accordance with the SEARs for the project, a Draft School Transport Plan has been prepared to increase sustainable transport uptake and active transport options.

6 STAKEHOLDER AND COMMUNITY FEEDBACK

Stakeholder feedback has been integral to the development of this proposal. Feedback was sought from stakeholders through the consultation activities and communication channels listed in Section 3.

The project team has held a virtual information session between 23 September 2021 to 27 September 2021 to provide more information and capture feedback on the project.

Consultation identified concerns and issues of community interest for consideration during the preparation of the Environmental Impact Statement.

Themes that have emerged from the feedback are identified and described below:

6.1 Stakeholder meetings and correspondence

Table 7 outlines a summary of the key consultation undertaken with stakeholders, in addition to those defined and required by the SEARs.

Table 7 Stakeholder feedback

| Stakeholder | Dates | Feedback topics | Outcomes |
|---|------------|--|--|
| Council of the City of Sydney Pre- development application meeting | 21/06/2021 | <ul style="list-style-type: none"> Forum was a pre-lodgement meeting; Parapet heights have been rationalised to accommodate the PV array and provide consistency. Acceptable, reference to hipped roof ridge line of outpatient building to the south. | <ul style="list-style-type: none"> The Panel suggests that a sample prototype panel should be tested to ensure an optimum learning environment. Sunlight access and sun-shading have been designed with careful consideration. More detail has been provided in regard to the roof structure and support for the photovoltaic cells. |
| | | <ul style="list-style-type: none"> The timber structure proposed in the competition has been changed to concrete. Reasons for the change include cost, provision of a fire-resistant structure, maintenance, and supply. | <ul style="list-style-type: none"> Timber framing was proposed as an alternative to concrete in the competition process. The competition jury recommended that design development proceed with the timber option but recognised the challenges and concerns regarding durability and fire safety. |
| | | <ul style="list-style-type: none"> Building generally complies with building envelope controls. Minor variation to 12 metre setback from Waranara. | <ul style="list-style-type: none"> This has been previously discussed and deemed acceptable by Council and the design jury. |
| | | <ul style="list-style-type: none"> Materials sample board should be submitted with an application including glazing sample. Concrete elements to be a single colour, preferably darker than presented. | <ul style="list-style-type: none"> A Material sample board will be submitted. |
| | | <ul style="list-style-type: none"> Further landscaping package to be provided for review by City's Landscape officer. | <ul style="list-style-type: none"> Landscaping has been provided to increase amenity and has been incorporated into the SSDA. |
| | | <ul style="list-style-type: none"> Development is aiming to meet the minimum environmental performance targets set out at competition. | <ul style="list-style-type: none"> ESD commitments will specify how the proposal meets the minimum environmental targets and the green star score. |
| | | <ul style="list-style-type: none"> Public art strategy to be provide with application. | <ul style="list-style-type: none"> Guideline for Public Art in Private development has been considered. |

CONSULTATION REPORT

| Stakeholder | Dates | Feedback topics | Outcomes |
|---|------------|--|--|
| | | <ul style="list-style-type: none"> – Signage strategy to accompany application | A signage strategy accompanies the application. |
| | | <ul style="list-style-type: none"> – Car parking to be provided. | The project has determined that only a loading zone will be provided to the rear lane with no car parking. |
| | | <ul style="list-style-type: none"> – Sufficient waste storage is to be provided to minimise collections to 1x/ week for each waste stream. Please use appendices within City's Guidelines for Waste Minimisation in New Developments. | The number of bins in the site have been calculated based on City of Sydney's information. The equipment is drawn into the waste rooms to ensure that there is adequate space to accommodate the bins while allowing for acceptable access. |
| | | <ul style="list-style-type: none"> – Cycling to be provided throughout development rather in their central location. | GSICFS has been designed to encourage active and public transport, bicycle parking for staff and students. Bike racks have been distributed across the ground floor area. Change facilities are provided to the development, a site-specific travel plan has been prepared for the project. |
| City of Sydney Traffic Consultation Meeting | 14/04/2021 | Operational Waste Management Meeting | Consulted with City of Sydney on required allowances for truck size and swept paths, workshoped compliant solutions and positioning of loading bays for waste collection |
| City of Sydney Traffic Workshop | 12/05/2021 | Traffic Discussion | Discussed traffic modelling requirements with City of Sydney Work-shopped safe access to the school by students |
| City of Sydney Traffic Consultation Meeting | 13/05/2021 | Southern Interface Workshop | Discussed proposed Swept Paths for vehicular access along "Ruby" Lane (Portman – Joynton through link) – confirmed they aligned with Australian Standards Discussed City of Sydney waste collection and resolved City's concerns with previous plan Discussed bollard control and came to a resolution to manage traffic through "Ruby" lane |
| Government Architect | 2019/2020 | Jury member on the Design Excellence competition jury. | Requirement for further consultation was delegated to the City of Sydney Design advisory panel. |
| Transport for NSW (TfNSW) | 23/02/2021 | Meeting to discuss the following: <ul style="list-style-type: none"> – Kiss and drop location management. – Travel Access guide to accompany the EIS. | Change existing sign posting for kiss and drop spaces. Confirmation of bike storage to accommodate both school and community. |
| Transport for NSW (TfNSW) | 30/04/2021 | <ul style="list-style-type: none"> – Meeting to discuss the SIDRA modelling requirements. | Modal share for the GSICFS site: 10% Cars, 70% walking, 20% riding, 0% bus, 0% train. K-Y6 students typically generate additional car movements. |
| Transport for NSW (TfNSW) | 12/05/2021 | <ul style="list-style-type: none"> – School route crossings may be too dangerous for children to walk. | Enrolment data to be utilised for flow diagram to detail pedestrian analysis. |

CONSULTATION REPORT

| Stakeholder | Dates | Feedback topics | Outcomes |
|--|------------------------------------|--|---|
| | | | School transport plan to be updated to include school enrolment staging. |
| Local Aboriginal Land Councils and Registered Aboriginal stakeholders Email, mailed letters | Ongoing from May 2020 to July 2021 | An Aboriginal Cultural Heritage Assessment is required to be undertaken. DPIE has provided a list of stakeholders to be contacted or comment on the project. | The Aboriginal Cultural Heritage Assessment Report has been drafted in consultation with the relevant stakeholders. After considering the archaeological context, environmental information, consultation with the local Aboriginal community, the findings of the archaeological survey and the predicted impact of the proposed development on archaeological resources. An AHIP investigation is being conducted to confirm the low likelihood of uncovering any items of Aboriginal heritage. |
| Service providers Email | Various dates to August 2021 | Detail on existing site infrastructure from various service providers including Sydney Water, Jemena Gas, Ausgrid, Roads and Maritime Services, Telstra | Refer to GSICFS Infrastructure Management Plan, for correspondence to date with the relevant service providers and incorporation of this correspondence into the current design. |

7 ENVIRONMENTAL IMPACT STATEMENT CONSULTATION – GSICFS

7.1 Public exhibition and consultation

The SSD Application for GSICFS including the EIS will be required to be publicly exhibited in accordance with the statutory requirements. Advertisements will be displayed on various media platforms to advise of public exhibition and where the EIS can be viewed. This process will be undertaken by the Department of Planning, Industry and Environment (DPIE), as part of its statutory obligations under the *Environmental Planning & Assessment Act 1979*.

Consultation and engagement activities will be undertaken by the project group during the statutory public exhibition of the EIS including:

- Direct email to distribution list. .
- Project Update letterbox dropped to nearby neighbours.
- Awareness and marketing campaigns.
- The project website.
- Environmental Impact Statement summary document.
- Government stakeholder engagement.
- Government Architect engagement.
- Project briefings and presentations.
- Social media updates.
- Stakeholder meetings.

7.2 Submissions

During the exhibition period, all stakeholders will be invited to make submissions. Once the exhibition period closes, a response to submissions report will be prepared to address the issues raised by the submissions received. The report will then be submitted to City of Sydney and made publicly available.

8 COMMUNITY CONSULTATION

This section of the report summarises the community consultation activities that have been undertaken by SINSW and the City of Sydney in relation to the proposed new Green Square Public School – including information about community spaces.

8.1 Community engagement channels and activities

SINSW use a range of standard community engagement channels, tools and activities on an as-needs basis across all projects as shown in **Table 8**.

Table 8 Community engagement pathways

| Activity | Strategic Intent |
|---|--|
| School community engagement (project review group, meetings, workshops, school tours, and design user group sessions) | Discuss aspects of the design, consultation and construction approach and seek feedback and input from members. Design user groups seek input from end users including staff and students about the proposed design and its applicability. |
| Community information sessions | Provide an opportunity for face-to-face engagement between residents, school community, staff and members of the project team. Allow for Q&A and concerns to be raised. Information sessions are widely advertised through the communication channels listed in this table. May be virtual, with the same materials available and feedback/question forms (depending on public health advice). |
| Communications (project webpage, information pack, project updates and works notifications) | Distribution of project information to stakeholders delivered via letterbox drop and school newsletter. |
| Contact channels (emails and 1300 project information number) | Distribution of project information to stakeholders delivered via letterbox drop and school newsletter. |
| School community communication (newsletter input, Parents and Citizens' Association meetings) | Distribution of project information to stakeholders delivered via letterbox drop and school newsletter. |

8.2 Community engagement timeline

Community engagement and public communication activities implemented to date for the Green Square Public School – including information about community spaces are outlined in **Table 9**.

Table 9 Summary of engagement

| Date(s) | Targeted Stakeholders | Activity |
|------------------------------------|--------------------------------------|---|
| February 2018 to 30 September 2021 | All interested stakeholders | SINSW Project webpage for new Green Square Public School went live. Historically the webpage had 6,293 visits, 7,237 page views and 4,881 unique visitors. |
| 2018 to present. | All interested stakeholders | City of Sydney website, newsletter and social media platforms published information on the new Green Square Public School – including information about community spaces with links to the Project website. |
| July 2021 | General public | Media release announcing the design competition winner and resulting coverage, Appendix A . |
| September 2021 | Green Square and surrounding suburbs | Project Update issued with scope of the project and invitation to upcoming online community information session. |

| Date(s) | Targeted Stakeholders | Activity |
|----------------------------------|-----------------------------|--|
| 23 September – 27 September 2021 | All interested stakeholders | <p>Published online and letterboxed to approximately 10,000 addresses in and around Green Square.</p> <p>Virtual information Room held online. Information Pack, Fly Through video and Information Boards also published on the Project website.</p> <p>The Virtual Information Room drove the largest increase in project webpage activity with more than 600 visits.</p> |

The project team engaged with people within Green Square suburb and surrounding suburbs as shown in **Figure 1**. Project update notifications were distributed to the Green Square locality and surrounding suburbs. A total of 10,000 addresses received updates on Friday 17 September 2021.



Figure 1 Letterbox Drop distribution area

8.3 City of Sydney consultation response

The City of Sydney undertook activities to support and promote the engagement, including an announcement on the City of Sydney News site, an update to the website, an invitation to subscribers of the City’s Green Square eNewsletter, and social media posts across Twitter, Facebook and LinkedIn. An email was also sent to approximately 100 participants in its Green Square Community Liaison Group and other key stakeholders. Key statistics for each activity can be found below in **Table 10**.

Table 10 City of Sydney engagement results

| Engagement outlets | Outcome |
|---|---|
| Invite to subscribers of Green Square eNewsletter | |
| Link to invite: http://createsend.com/t/j-7B8445C3CAD4ECA22540EF23F30FEDED | Sent Sep 23, 2021 at 9:40AM Sent to 2,613 unique subscribers <ul style="list-style-type: none"> • 1,194 Unique opens • 3,148 total opens to date • 536 click throughs to www.schoolinfrastructure.nsw.gov.au |
| Social media posts | |
| Facebook post: https://www.facebook.com/cityofsydney/posts/224907479678218 | Post impressions and reach: 20,422 <ul style="list-style-type: none"> • Post engagement: 323 • Reactions: 44 • Comments: 2 • Link clicks: 222 • Shares: 1 |
| LinkedIn post: https://www.linkedin.com/feed/update/urn:li:activity:6846620630855634944 | <ul style="list-style-type: none"> • Impressions: 1,753 • Reactions: 14 • Link clicks: 31 |
| Twitter post: https://twitter.com/cityofsydney/status/1440855529316773892?s=20 | <ul style="list-style-type: none"> • Impressions: 2,636 • Total engagements: 43 • Link clicks: 17 • Likes: 9 • Retweets: 1 |
| City of Sydney News Announcement | |
| Page: https://news.cityofsydney.nsw.gov.au/articles/take-a-virtual-tour-green-square-primary-school-and-community-spaces | Date range 21 Sept to 30 Sept <ul style="list-style-type: none"> • 570 Page views • 478 Unique pageviews • 209 click throughs to www.schoolinfrastructure.nsw.gov.au |
| Corporate website | |
| Page: https://www.cityofsydney.nsw.gov.au/green-square | Date range: 23 Sept to 27 Sept <ul style="list-style-type: none"> • 205 page views • 152 Unique page views • 5 clicks to http://edu.nsw.link/xeqYJ7 |

8.4 Community feedback and response

Feedback was sought from stakeholders and communities on the project design through the consultation activities and communication channels listed in community engagement channels and activities above.

The primary consultation activity undertaken for the project was the Virtual Information Room, an activity required due to Covid-19 restrictions. A total of 12 enquiries resulted from the Virtual information room and are detailed below in **Table 11**.

The community feedback received will be considered in the preparation and submission of the Environmental Impact Statement. **Table 11** provides a detailed summary of the key issues that emerged and the corresponding project responses. The majority of feedback requested information on construction, completion date, intake area and the like.

Table 11 Virtual information room enquiries

| Issue raised | Project response |
|--|---|
| Hi there, do you know when is the estimate this school will be ready for? | Following community consultation, the project team will continue to work through the overall layout and consideration of environmental, access, transport and other planning requirements. When this work has been completed, we will submit a State Significant Development (SSD) application to the City of Sydney for assessment, as delegated by Department of Planning, Industry and Environment (DPIE). |
| Could you tell me when the school is due for completion and enrolments? | Should consent be provided, we will have more information about construction commencement and completion dates. In the meantime, we anticipate we will commence site establishment and early works later this year. The early works have been approved via an existing development application. |
| When can I start to enrol my son to attend the school? We live in Beaconsfield. Are we part of the catchment? | The school intake area will be confirmed closer to the school opening and will be based on the most up to date demographic data on the number of school aged children living in the local area at the time the school opens. We will publish the intake area and enrolment information for this project when construction nears completion. In the meantime, 'School Finder' is an online tool for parents to use to locate NSW public schools in your intake area. This can be accessed at https://education.nsw.gov.au/school-finder . To keep up to date with the progress of this project, please visit the project webpage. |
| Sustainability: Could the design integrate additional leading sustainability features like green roofs, trees planted in deep soil within the building, water capture and reuse, etc.? | The school is incorporating sustainable design features to achieve a 5 Star Green Star rating. It will be one of the first schools in the metropolitan Sydney region to achieve this rating. The rooftop will have shade elements provided by the extensive array of solar panels. The design integrates a stormwater system that provides water capture in rainwater tanks for reuse. The next phase of community consultation is the public exhibition of the SSD application. The community will have the opportunity to make submissions directly to the City during the 28 day public exhibition period. General enquiries to clarify the information contained within the SSD application can be made to SINSW: schoolinfrastructure@det.nsw.edu.au . When consent is granted, we will have more information about construction commencement and completion dates. In the meantime, we anticipate early works to commence later this year. To keep up to date with the progress of this project, please visit the project webpage. |
| Increased traffic on Elizabeth Street and parking facilities at the school. | The school and community spaces are centrally located within the Green Square town centre, which has been designed as a network of people-friendly, low-speed streets that encourage walking and cycling in the area. There will be a "kiss and drop" located to the new Zetland Avenue frontage however there will be no carparking provision within the development. Separated cycleways are located on two streets that run alongside the site, connecting to the extensive bike network in the area. It is adjacent to main bus routes and will include drop off and pick up zones in the newly built Zetland Avenue. The site is well positioned 350m from Green Square train station. Following community consultation, the project team will continue to work through the overall layout and consideration of environmental, access, transport and other planning requirements. When this work has been completed, we will submit a State Significant Development (SSD) application to the City of Sydney for assessment, as delegated by Department of Planning, Industry and Environment (DPIE). Traffic and transport matters have been considered as part of the SSD application and can be found in the Transport and Accessibility Impact Assessment (TAIA), which is a technical study in the Environmental Impact Statement. |

| Issue raised | Project response |
|---|--|
| <p>Safety of students/community access and interface with Waranara Early Education Centre</p> | <p>The safety of students has been carefully considered within the design and has the highest priority to be maintained during school operations. The community will only have access to the courtyard, Games Court, Communal Hall and multipurpose spaces after school hours (after 6:30pm on week nights and weekends).</p> <p>The dedicated Community space (multipurpose space 1) will be used during the day by the community. This area will have a separate entrance off Zetland Avenue and will have no access to the rest of the ground floor area which is reserved for students. The school will be fully secured during school hours.</p> <p>We understand the concerns regarding the interface with the Waranara Early Education Centre.</p> <p>The Waranara Early Education Centre management have been closely involved with the planning of the demolition of the existing Waves building and establishment of an increased play area for the children.</p> <p>Please contact the Waranara Early Education Centre management who will be providing further information to parents.</p> |
| <p>General layout of school – location of library, provision of lifts, toilets, play areas and rooftop amenity.</p> | <p>The layout of the school has been determined to meet the needs of both the school and community when considering the spatial allocations and compliance with the existing Green Square development guidelines. The educational team has supported the location of learning spaces on levels 1 and 2 and library on the rooftop. The library location provides good access to outdoor learning opportunities and quieter spaces during school hours. The majority of students will take either one or two flights of stairs to the library and rooftop play area from their classrooms.</p> <p>There is one lift included within the design to provide equitable access to all areas of the building. There are three stairways which provide access to the roof level. Three levels is standard for primary schools which have limited site area.</p> <p>The rooftop will have shade elements provided by the extensive array of solar panels. An internal stairway may be utilised to access the library in inclement weather.</p> <p>Indoor play areas are provided on the ground floor with the Games Court, Communal Hall and multipurpose spaces available during school hours.</p> <p>Toilets are located on Ground, Level 1 and Level 2 at the southern end of the building.</p> <p>The school is incorporating sustainable design features to achieve a 5 Star Green Star rating. It will be one of the first schools in the metropolitan Sydney region to achieve this rating.</p> |

9 CONCLUSION

In preparing the SSD application for the GSICFS, the project team has met the consultation requirements prescribed by the SEARs.

SINSW have demonstrated in this report how it has engaged with stakeholders and the feedback has led to design revision and incorporated such changes into the supporting documentation of the assessment SSD application.

Continued engagement will take place with stakeholders and communities during the statutory exhibition of the SSD application, as well as during future stages of the planning and development process.

The project has met the SEARs requirement for consultation by providing the following:

- Ongoing consultation with the City of Sydney.
- Government Architect consultation undertaken in the design competition stage with further consultation to be undertaken as previously arranged post-lodgement.
- Ongoing consultation with Transport for NSW.

As demonstrated in this report, consultation with relevant stakeholders, service providers, community groups, special interest groups including local Aboriginal land councils and registered Aboriginal stakeholders and affected landowners has been undertaken by the project team and specialist consultants.

The final design of GSICFS has been guided by the initial feedback from the design competition and through ongoing communication with City of Sydney, TfNSW, Department of Education and SINSW.

Appendix A

Media Release



Sarah Mitchell
Minister for Education and Early Childhood Learning

MEDIA RELEASE

Thursday, 15 July 2021

WINNING DESIGN REVEALED FOR NEW GREEN SQUARE PRIMARY SCHOOL

The Green Square community will get a first look at its planned new primary school and community facility today, with the designs unveiled by the NSW Government and the City of Sydney.

The new primary school will provide fit-for-purpose learning spaces and core facilities to meet enrolment demands in one of Australia's fastest growing neighbourhoods. The project will include additional facilities designed for both school and community use.

Architect BVN's competition-winning design integrates school and community spaces for both day and night use and will be built on the former South Sydney Hospital site on Joynton Avenue.

Minister for Education Sarah Mitchell said the design marked an important milestone in the planning process and that she was excited to share the first artist impressions with the community.

"We are committed to providing students with the educational infrastructure needed to learn, grow and prepare for a successful life after school," Ms Mitchell said.

"Schools are the hearts of our communities and the winning design from BVN captured this and created a fantastic place for children to learn."

The NSW Government will fund and staff the project with a contribution from the City of Sydney.

The competition was run by the NSW Department of Education and the City of Sydney and was judged by a panel of experts drawn from education, architecture and urban design fields.

The winning design was commended for its response to the surrounding local area, its clever multi-purpose sports court, smart educational approach and its consideration of the environment.

City of Sydney Lord Mayor Clover Moore congratulated the winning team of architects and said she was pleased the project could progress to its next stage.

“This new school will sit at the heart of the growing Green Square community and set a new benchmark for urban development.

“The City will contribute \$25 million to this revolutionary school to provide much-needed community facilities that will be activated day and night for the whole community to use.

“Close to the aquatic center and library, this school will be an important addition to the area’s educational, social and cultural life,” the Lord Mayor said.

The NSW Government is growing its historic schools building program with the new Green Square primary school one of 44 new and upgraded school projects to receive funding as part of the 2021-22 NSW Budget.

The community will be invited to view and provide feedback on the winning design before plans are submitted for planning approval and go on exhibition for further public consultation.

The NSW Government is investing \$7.9 billion over the next four years, continuing its program to deliver 215 new and upgraded schools to support communities across NSW. This is the largest investment in public education infrastructure in the history of NSW.

Images of the winning design are available at the following link: <https://bit.ly/3ehoge9>

MEDIA: Taylor Denny | 0439 760 111

Appendix B Community Newsletter Announcement

AND SUPPORTING CREATIVITY



Artist's impressions of the new creative centre in Bathurst Street

WITH SOME BIG IDEAS FOR OUR FUTURE



CITY OF SYDNEY

JULY 2021
SYDNEY CITY NEWS

Seventy five affordable housing units were negotiated by the City as part of the Harold Park redevelopment

CITY OF SYDNEY CREATIVE STUDIOS OPENING SOON ...

The City is committed to reinvigorating our night-time economy post-Covid, and to supporting our cultural and creative communities through grants and engagement opportunities. We also use our planning controls to negotiate new facilities. Our 2000 sqm state-of-the-art creative hub in the Greenland Centre in Bathurst Street has five floors of affordable rehearsal and work space for dance, theatre, music rehearsal and visual arts. It is the result of a voluntary planning agreement between Greenland Australia and the City. We've secured the space on a 99 year lease at a peppercorn rent.



Intersections lights up Surry Hills



Our town halls reimagined

Artist's Impression

AND PROVIDING INCENTIVES AND CUTTING RED TAPE

The City is cutting red tape to help reignite our 24-hour economy and create and maintain space for artists and performers.

These changes soften restrictions for businesses and make it easier for unlicensed premises to open later and for a wide variety of small scale cultural events to occur in shops, offices, warehouses and community facilities.

They also make it easier for organisations to establish maker-spaces and to open up city venues, such as Erskineville Town Hall, for live music and performances.

And planning controls are being proposed for the revitalisation of Oxford Street, with extra floor space granted for the provision of creative space. It's estimated that these concessions could add more than 11,000 sqm of new creative space from Whitlam Square to Paddington.

SUPPORTING ARTISTS AND ENHANCING OUR STREETS

Intersections by artist Ian Strange is a temporary work and part of the City's Art and About public art series, which makes art accessible to all.

LED rods seem to pierce and intersect a dilapidated terrace in Surry Hills, creating dramatic lighting effects.

The work is the first in the City's Art & About program since the pandemic began last year.

It will be followed by *As One Door Closes, Another Opens* by Sydney artist Will Cooke. It will be presented as a large-scale mural on the northern side of the Top of the Town building in Victoria Street Darlinghurst.

CONNECTING THE CITY BACK TO OUR WONDERFUL HARBOUR... AND THEN DOWN A PEDESTRIANISED GEORGE STREET TO TOWN HALL CIVIC SQUARE, AND ON TO CENTRAL STATION PLAZA



Artist's Impression of Town Hall Civic Square



Artist's impression of Central Station surrounds

The City has already purchased Customs House at Circular Quay, the whole length of George Street from Circular Quay to Central is being pedestrianised and traversed by light rail. The City has acquired buildings valued at \$300m towards the creation of Town Hall Civic Square and the concept work around people-oriented surrounds to Central Station is beginning.

AND TRANSFORMING MAJOR STREETS INTO GREEN AVENUES...



Artist's impression of Park Street



Artist's impression of Loftus Street

Ideas have been proposed to green and pedestrianise main streets such as Park and Loftus streets (pictured), Pitt Street in the CBD, and also Broadway and Botany Road. The desired outcome would be reduced traffic, increased pedestrianisation and cycling, with more trees and greenery. Greater investment in public transport, re-evaluations of current usages and some clever planning could see these traffic arteries reimagined and redesigned as more beautiful, safe places for people.

CREATING A FAIRER CITY FOR ALL

The City of Sydney is committed to community wellbeing, social justice and diversity as important measures of urban liveability.

The demand for social and affordable housing in the city has never been greater, and given the projected health, social and economic impacts of Covid-19, we know that is likely to increase.

We don't want our key workers, our nurses, police officers, childcare workers to be pushed further away from their places of work in our city. While local government isn't responsible for housing, we've taken every opportunity to promote the building of mostly affordable housing, but also social and supported accommodation. The City has collected developer contributions, discounted land sales, and used its Affordable and Diverse Housing Fund to help deliver 1070 new affordable homes, with another 629 in the pipeline.

As well, the City has facilitated the delivery of 801 social housing dwellings, with 116 in the pipeline and a further 75 planned. And City seed funding

has enabled HammondCare to build accommodation in Darlinghurst and the renewal of Edward Eagar Lodge in Surry Hills.

We were the first council in NSW with a dedicated homelessness unit. Over the past four years we've contributed \$4.7 million to the Department of Communities and Justice to deliver specialist homelessness services, with another \$3.6 million to be invested over the coming three years.

We donated more than \$2 million to OzHarvest and other charities during the Covid-19 pandemic and delivered more than 20,000 face masks to Sydney's most vulnerable communities.

Helping create a fairer city that is inclusive and accessible to all underpins our work, whether providing essential community infrastructure and

services accessible to all, housing and homelessness services or free rates for pensioners.

We also celebrate our diverse culture and community loudly and publicly. As a long-time supporter of Mardi Gras, we have just recently granted another \$500,000 to World Pride to help it create an event that invites the world to Sydney. Our Lunar New Year Festival is now the largest such celebration outside Asia. Later this month we will unveil *bara*, a glorious monument to the Eora overlooking Sydney Harbour.

Clover Moore

Lord Mayor of Sydney
@CloverMoore
@clovermooresydney

GREEN SQUARE SCHOOL FUNDED

After years of advocacy, funding has been secured from the current State Budget for a new primary school at Green Square! This is a great result for our fastest growing community, which will be home to 61,000 residents by 2030.

We set aside City-owned land on the former South Sydney Hospital site next to Waranara Early Education Centre for a new building housing a school and community centre, and a competition was held to get the best design.

So we're very excited to be working with Government to provide the community with a school, and both dedicated and after-hours community facilities.

The City has invested more than \$540 million in infrastructure and community facilities since Green Square was earmarked by the State Government as an urban renewal precinct. This includes a new library, aquatic centre, parks, playgrounds, roads and cycleways.

The new school and community facility for Green Square



How to contact the City Visit: City of Sydney, Town Hall House, 456 Kent Street, Sydney Post: GPO Box 1591, Sydney NSW 2001 T: 02 9265 9333 Email: council@cityofsydney.nsw.gov.au Online: cityofsydney.nsw.gov.au
Your councillors are Clover Moore (CMIT) / Jess Miller (CMIT) / Robert Kok (CMIT) / Jess Scully (CMIT) / Philip Thalys (CMIT) / Christine Forster (LIB) / Craig Chung (LIB) / Linda Scott (LAB) / Kerry Phelps (IND) / Angela Vitoulkas (SBP)

If you require this information in an alternative format please contact:
City of Sydney: 02 9265 9333 council@cityofsydney.nsw.gov.au
Translating & Interpreting Service (TIS): 13 14 50

ENABLING HOUSING AND A PLACE FOR EVERYONE ...

Access to affordable and social housing is essential for a diverse, cohesive, and economically successful global city. And although housing is a state government responsibility, the City is playing a leading role in enabling housing supply and affordability through levies, amended planning controls, discounted property sales, and our Affordable and Diverse Housing Fund.

Our work for a fairer city is manifest in many ways ...

CITY DESIGN FOR WATERLOO PUBLIC HOUSING REDEVELOPMENT SUPPORTED ...



The City's alternative plan for Waterloo's Cooper Street, featuring wider streets and more sunlight

The City's changes to the Land and Housing Corporation redevelopment proposal for Waterloo housing estate has been generally accepted to proceed to public exhibition towards the end of the year.

We wanted to ensure quality streets and public spaces, with maximum access to sunlight, and more sustainable and accessible buildings. And thankfully that's been supported. But we've had limited success so far increasing the proportion of affordable and social housing to private-for-sale housing. We will continue to work to get a fairer housing mix.

The Department of Planning is responsible for consultation and finalising the new planning controls.



Left to right: St George Community Housing Chair Annette Gallard, NSW Housing Minister Melinda Pavey, Lord Mayor Clover Moore, and Minister for Families, Communities and Disability Services Alister Henskens at the opening of 11 Gibbons Street.

SUPPORTING SOCIAL HOUSING

The City has supported 162 new social and affordable housing apartments at 11 Gibbons Street Redfern and negotiated at least 25% of the units as Indigenous housing.

The former council depot site was sold at a discounted rate by the City to St George Community Housing, enabling the development to go ahead.

And we're supporting our social housing tenants through advocacy and face to face meetings. Staff contact up to 2,500 tenants each year to provide assistance, and we host regular meetings bringing tenants and service providers together to solve issues of concern.

More than 51,000 people are on the public housing waiting list, and 5,000 are a priority. So the City helps support the development of social housing, which is not normally the responsibility of local government, where it can.



HammondCare, Darlinghurst

Ironbark Apartments, Harold Park



11 Gibbons Street Redfern

The 76-bed Edward Eagar Lodge



AND CARING FOR THE HOMELESS

We were the first council in Australia with a dedicated homelessness unit connecting rough sleepers with essential services and we invest more than \$2 million every year to reduce homelessness and its impacts. Through the pandemic we've been working with key agencies to ensure safe accommodation for those sleeping rough.

We've also provided grants and seed funding for vital projects, including \$1 million towards the recent refurbishment of Edward Eagar Lodge in Surry Hills, which offers crisis accommodation and support for people at risk of being homeless.

And, a grant of \$1.5 million towards the construction of HammondCare in Darlinghurst, opened last year to provide residential care for older people, especially older women, who could otherwise be homeless.



GROWING AFFORDABLE HOUSING ACROSS OUR CITY

We've made \$17.81 million worth of discounted City land available to community housing providers for affordable housing. This has enabled the delivery of 75 units at Ironbark Apartments in Harold Park and 104 units at the Exordium Apartments at Green Square, amongst others.

Through our Affordable and Diverse Housing Fund, we've committed more than \$10 million to support initiatives such as HammondCare in Darlinghurst, for older people with complex needs, and Foyer Central in Chippendale, providing supported affordable accommodation for young people exiting out-of-home care and affordable housing for low income workers.

And our affordable housing levies in Pyrmont/Ultimo and Green Square have allowed housing providers to deliver 38 social and 859 affordable housing dwellings.

At our request, the State Government has recently extended the levy scheme city-wide, a move that's expected to help create an additional 1,100 affordable homes.

CARING FOR OUR COMMUNITIES



YOGA AT GUNYAMA AQUATIC CENTRE, the City's newest award winning facility.

Since 2004, we've completed more than 250 community projects, creating beautiful parks, libraries, pools and community facilities for all. And now we're delivering a further 430 new projects as part of our 10 year plan. These facilities offer innovative, efficient and enriching services to every resident, from our library services, to exercise programs, companion pet support, community events, recreational classes and learn to swim sessions.



PET DAY AT WATERLOO

Introduced our biannual pet days held in Waterloo and Northcott every year, providing discounted and free services for people on low incomes. Our last one attracted 200 social housing residents and 181 companion animals including 132 dogs, 48 cats, and one rabbit.



SKATING AT SYDNEY PARK
Invested more than \$270 million across the City's open space, sport and recreation facility network since 2005. This includes 132 parks and 61 playgrounds, and three skate parks.



FACILITIES FOR FUN AND FITNESS

Upgraded or completed 37 sports facilities and fields, including Gunyama Park and Aquatic Centre, and provided programs from swim classes to aqua aerobics.



SPACES FOR LETTING GO

Developed a network of fitness equipment and accessible outdoor spaces across the LGA, and programs encouraging health and wellbeing, including multicultural performance opportunities reflecting our diverse population.



LEISURE CENTRES FOR ALL ...

Established 15 popular local community and arts centres, catering for a range of creative, cultural, social, business and educational needs.



AND LOOKING AFTER CITY KIDS

Increased childcare services and facilities for our young families. We've upgraded parks and playgrounds, built or renewed 24 childcare centres since 2013, and we operate six out-of-school care services.

Appendix C Project Update (English and Chinese)

Image courtesy of BVN Real



Artist impression of the new primary school and community spaces

Green Square Public School

Including information about community spaces

Project update | September 2021



Investing in our schools

The NSW Government is investing \$7.9 billion over the next four years, continuing its program to deliver 215 new and upgraded schools to support communities across NSW. This is the largest investment in public education infrastructure in the history of NSW.

The NSW Department of Education is committed to delivering new and upgraded schools for communities across NSW. The delivery of these important projects is essential to the future learning needs of our students and supports growth in the local economy.

Project overview

The new primary school at Green Square will provide fit-for-purpose learning spaces and core facilities to meet enrolment demands in the area. It will also include dedicated multipurpose spaces for community use and shared spaces designed for both school and community use.

The new primary school and community spaces will be located on the former Royal South Sydney Hospital site on Joynton Avenue and will include:

- flexible teaching spaces
- a library
- a covered outdoor learning area (COLA)
- a canteen
- a communal hall (shared space)
- multipurpose spaces (community and shared spaces)
- out of school hours care (OSHC)
- staff rooms
- administrative offices and amenities
- a games court and adjacent courtyard (shared spaces).

For more information contact:

School Infrastructure NSW

Email: schoolinfrastructure@det.nsw.edu.au

Phone: 1300 482 651

www.schoolinfrastructure.nsw.gov.au

JOINTLY FUNDED BY



Progress summary

A design excellence competition was held and architects were invited to submit designs. Architect BVN's competition-winning concept design integrates the school and community spaces for day and night use. The design will continue to be refined throughout the planning process.

Next steps

- Virtual information room will be open for the community from 9 am Thursday 23 to 5 pm Monday 27 September 2021.
- Submit a State Significant Development (SSD) application to the City of Sydney for assessment, as delegated by Department of Planning, Industry and Environment (DPIE).
- The application will be placed on public exhibition and submissions must be made directly to DPIE.
- Determination of the SSD application.
- Start site establishment and early works on the Joynton Ave site, anticipated in late 2021. This work has been approved by a separate development application.

You're invited

You're invited to attend a virtual information room to find out more about the project scope and benefits, timeline and design approach. In the room you will also be able to submit feedback and questions about the project.

The virtual information room will be available online from 9 am Thursday 23 to 5 pm Monday 27 September 2021. Access the virtual information session by visiting edu.nsw.link/xeqYJ7 or scanning the QR code.



Frequently asked questions

Why was there a design excellence competition?

A Design Excellence Competition was held due to the significance of the project and key location in the Green Square Town Centre. Design competitions have also been held for the nearby Green Square Library and Plaza and Gunyama Park Aquatic and Recreation Centre. The competition was held in late 2019 and won by Sydney architects BVN. The design will continue to be refined throughout the planning process.

Who will operate the community spaces?

The community spaces will be managed by the City of Sydney and will be hired out for community use.

How can I find out more about the project?

School Infrastructure NSW (SINSW) will share information with the local community as the project progresses.

The SINSW website will continue to have up-to-date information about the school project in your area:

www.schoolinfrastructure.nsw.gov.au/projects/n/New-primary-school-in-Green-Square.html

You can also continue to contact us via our community information line 1300 482 651 and by email

schoolinfrastructure@det.nsw.edu.au.

For more information contact:

School Infrastructure NSW

Email: schoolinfrastructure@det.nsw.edu.au

Phone: 1300 482 651

www.schoolinfrastructure.nsw.gov.au

JOINTLY FUNDED BY



插图由 BVN Real 提供



新建小学和社区场地艺术效果图

Green Square公立学校

包含关于社区场地的信息

项目进展 | 2021年9月



投资于我们的学校

新州政府拟在未来四年内投资79亿澳元，继续推进新建或升级215所学校的计划，为新州各地社区提供支持。这是新州历史上对公共教育基础设施最大的一笔投资。

新州教育部致力于为新州各地社区新建并升级学校。建设这些重要项目对于满足学生今后的学习需求、支持当地经济的增长都是必不可少的。

项目概况

Green Square新建的小学将提供专用学习场地和核心设施，以满足当地的入学需求。小学还专门设有供社区使用的多功能场地以及学校和社区共同使用的场地。

新建小学和社区场地将位于Joynton Avenue的南悉尼皇家医院旧址，将包含以下设施：

- 灵活的教学场地
- 一个图书馆
- 一个有遮盖的户外学习区域（COLA）
- 一个食堂
- 一个公共大厅（共用场地）
- 多功能场地（社区和共用场地）
- 课外托管服务（OSHC）场地
- 教职员休息室
- 行政办公室和便利设施
- 一个运动场和邻近空地（共用场地）。

如果需要了解更多信息，请联系：

新州学校基建处（School Infrastructure NSW）

电邮：schoolinfrastructure@det.nsw.edu.au

电话：1300 482 651

www.schoolinfrastructure.nsw.gov.au

JOINTLY FUNDED BY

CITY OF SYDNEY 

进展摘要

我们举办了卓越设计竞赛，邀请建筑师提交设计方案。BVN建筑公司提交的概念设计综合了校园和社区场地在白天和晚上的用途，在竞赛中胜出。该设计将在规划过程中不断完善。

后续步骤

- 2021年9月23日星期四上午9点至27日星期一下午5点，虚拟信息间将对社区开放。
- 提交新州重要项目开发（SSD）申请，由悉尼市政府根据规划、行业与环境局（DPIE）的授权加以评估。
- 申请书将公开展示，反馈意见必须直接提交给DPIE。
- SSD的申请得出结果。
- 预期在2021年底开始在Joynton Ave地块布置工地并进行早期施工。这项工作已经通过单独的建设申请获得批准。

欢迎您参与

欢迎您加入虚拟信息间，进一步了解项目的范围和好处、时间线和设计方案。在这个信息间里，您还可以对项目提出意见和问题。

虚拟信息间将从2021年9月23日星期四上午9点到9月27日星期一下午5点在线开放。请访问 edu.nsw.link/xeqYJ7 或扫描二维码进入虚拟信息间。



常见问题

举办卓越设计竞赛的目的是什么？

举办卓越设计竞赛是因为项目极其重要，地处Green Square市镇中心的关键位置。为了建设附近的Green Square图书馆和广场以及Gunyama公园水上娱乐中心，于2019年底举办也举办过设计竞赛，悉尼BVN建筑公司获奖。在规划过程中，设计将持续进行完善。

社区场地将由谁负责？

社区场地将由悉尼市政府管理，并将出租给社区使用。

我该如何进一步了解这个项目的相关信息？

项目的推进过程中，新州学校基建处（SINSW）将跟当地社区分享信息。

SINSW网站将持续发布当地学校项目的最新相关信息：

www.schoolinfrastructure.nsw.gov.au/projects/n/New-primary-school-in-Green-Square.html

您也可以继续通过社区信息热线 1300 482 651 或电邮 schoolinfrastructure@det.nsw.edu.au 跟我们取得联系。

如果需要了解更多信息，请联系：

新州学校基建处（School Infrastructure NSW）

电邮：schoolinfrastructure@det.nsw.edu.au

电话：1300 482 651

www.schoolinfrastructure.nsw.gov.au

JOINTLY FUNDED BY

CITY OF SYDNEY 

Appendix D Information Boards

Project overview

The new primary school and community spaces in Green Square will be delivered by the Department of Education in collaboration with the City of Sydney. It will provide fit-for-purpose flexible learning spaces and core facilities to meet enrolment demands in the area.

The school will be located in Green Square on the former Royal South Sydney Hospital site on Joynton Avenue. The project will include dedicated multipurpose spaces for community use and shared spaces designed for both school and community use, including a communal hall, a multipurpose space, a games court and adjacent courtyard. Out of school hours care (OSHC) will also be provided on site.



Artist impression of the new primary school and community spaces



Green Square Public School





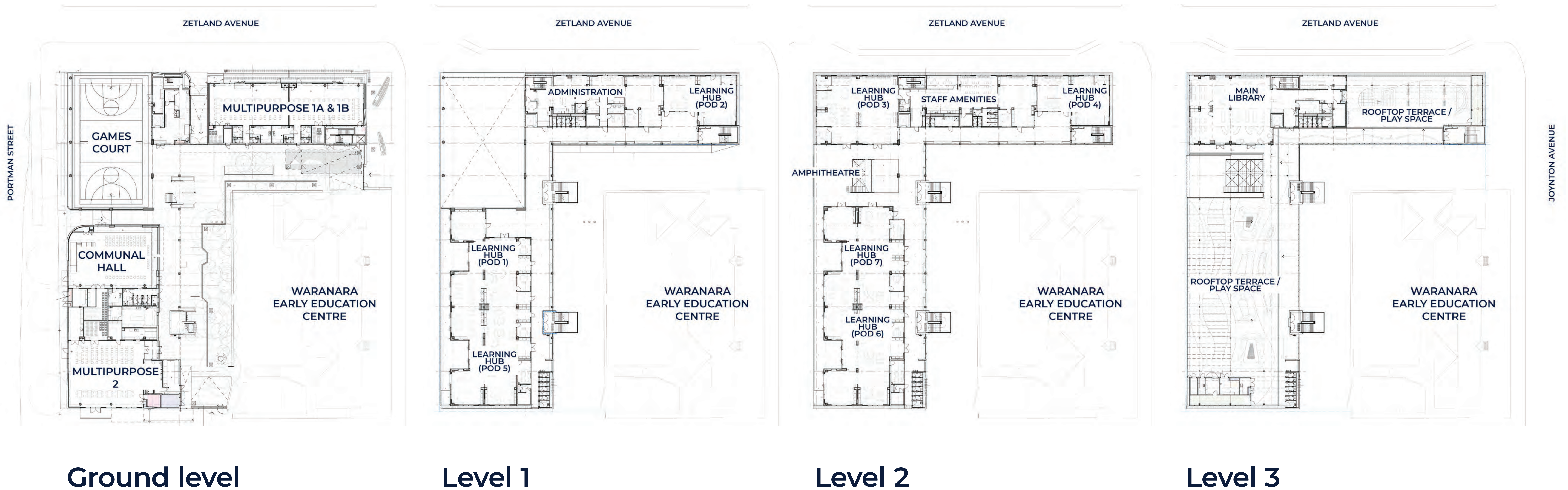

Including information about community spaces

Proposed layout



Ground floor layout

LEGEND

-  Community spaces
-  Shared spaces
-  Main entry
-  Kiss and drop zone
-  Bus stop
-  Public bike path
-  Bike parking
-  Throughsite link
-  Site boundary

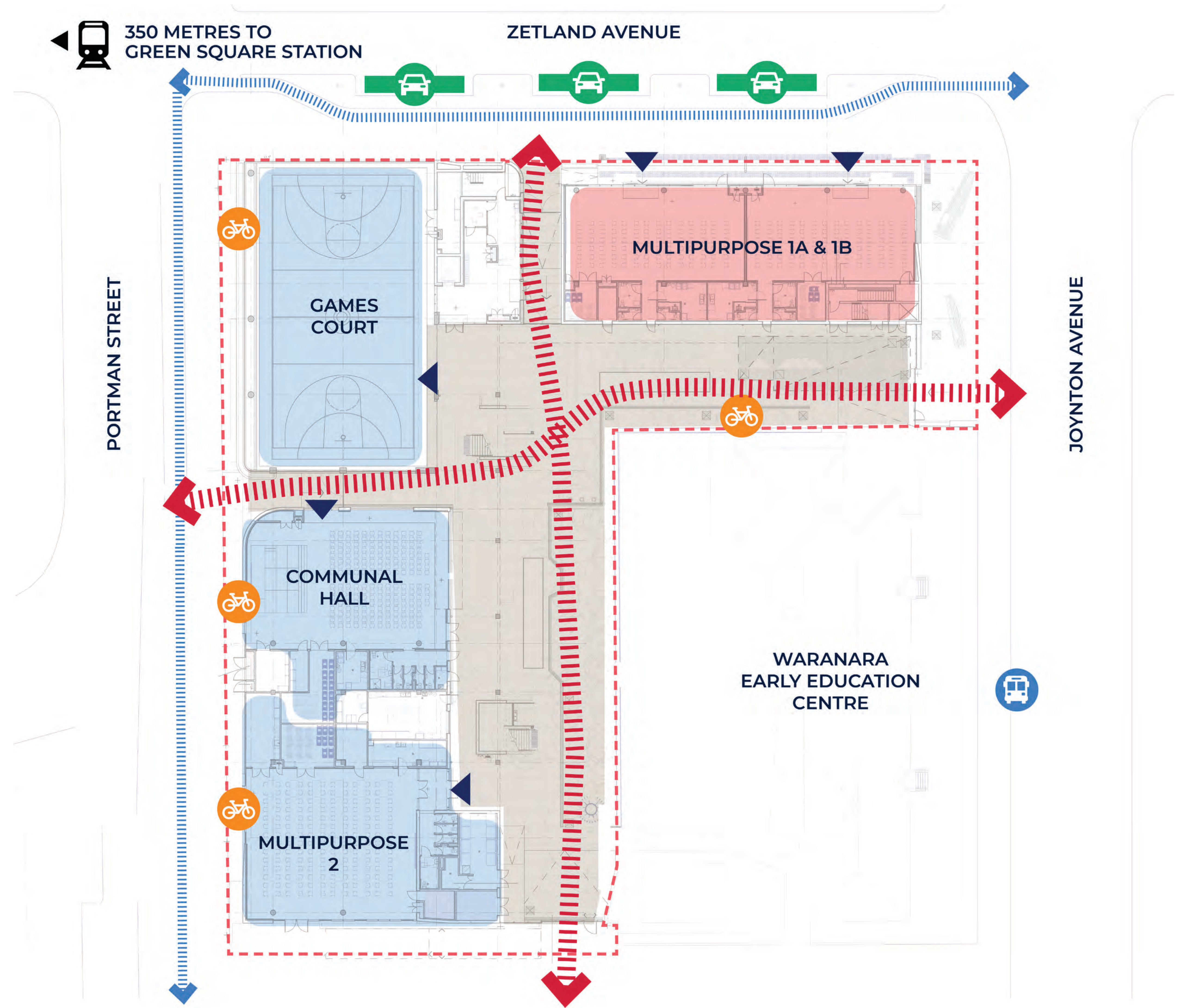

Green Square Public School

Including information about community spaces

Artist impressions

Image courtesy of BVN Real



View from north west

Image courtesy of BVN Real



View from north east



Timeline



What's next?

- Submit a State Significant Development (SSD) application to the City of Sydney for assessment, as delegated by Department of Planning, Industry and Environment (DPIE).
- The application will be placed on public exhibition and submissions must be made directly to the City of Sydney.
- Determination of the SSD application.
- Start site establishment and early works on the Joynton Ave site, anticipated in late 2021. This work has been approved by a separate development application.

We look forward to sharing more information with you as the project progresses. In the meantime you can stay informed by regularly visiting the project web page and you can contact us via email or phone if you have any questions or feedback.



Flexible learning spaces

Contemporary learning and teaching prepares students for a diverse and interconnected world. We are evolving the ways we teach our students new skills that are valued by a changing workforce. We understand there are different ways students learn as well as new ways to interact with information through technology.

Flexible learning environments are spaces designed and equipped to support contemporary learning and teaching.

What makes a flexible learning space?



Learning space

- Different zones (areas of a building or floors) are designed to support a range of activities sometimes grouped by subject area
- Varied furniture allows for student choice, comfort and flexibility
- Spaces are flexibly connected allowing students to work in varied group sizes
- Connection between indoor and outdoor learning spaces



Organisation

- Movement is encouraged for students and teachers to collaborate and interact
- More than one teacher may be available to students within the learning environment
- Students learn in classes, small groups or individually



Teaching and learning

- Learning is personalised
- Learning is connected across different subject areas
- There is a focus on creativity and innovation with students prototyping, testing and using technology in creative ways



Technology

- Technology is integrated into spaces to extend learning opportunities
- WiFi is available everywhere including outdoors
- Specialist equipment is available for students to innovate, communicate and create

Community and shared spaces

The ground floor has been designed to foster connection with the broader community, surrounding parks, and community facilities. It includes dedicated multipurpose community spaces and areas that can be shared with the broader community at night and on weekends.

Both the community and shared spaces will be hireable through the City of Sydney.



Sewing group at Green Square Community Hall



East Sydney Community and Arts Centre



All abilities music jam at Customs House



Auslan interpreted yoga class at Redfern Community Centre

Images courtesy City of Sydney

What spaces can the community use?

Community spaces

- Two dedicated multipurpose community spaces with separate access via Zetland Avenue
- The spaces have timber floors and are designed to be flexible
- Multipurpose 1A is 193m² and multipurpose 1B is 180m²
- Each space can accommodate up to 80 people seated at tables
- Chairs and tables will be provided for hirers
- Access to free City of Sydney wifi
- A dedicated kitchenette and toilets will service each space

Shared spaces

- A 308m² communal hall with sprung timber floors, removable stage and seating available for 200 people
- A 309m² multipurpose space with sprung timber floors, chairs and tables
- Multipurpose 2 can accommodate up to 150 people seated at tables
- Dedicated kitchenettes, toilets, and free City of Sydney wifi will service the communal hall and multipurpose 2
- A ground floor courtyard providing through site links will be open for the community in the evenings and on weekends
- Public toilets are available at Matron Ruby Grant Park and the Drying Green Park for hirers of the games court
- A high school standard games court with hoops and line markings for basketball and netball

Appendix E Information Pack

Green Square Public School

Including information about community spaces

September 2021



Image courtesy of BVN Real



Artist impression of the new primary school and community spaces

The NSW Government is investing \$7.9 billion over the next four years, continuing its program to deliver 215 new and upgraded schools to support communities across NSW. This is the largest investment in public education infrastructure in the history of NSW.

The NSW Department of Education is committed to delivering new and upgraded schools for communities across NSW. The delivery of these important projects is essential to the future learning needs of our students and supports growth in the local economy.



Flexible learning spaces /
homebase classrooms



Multipurpose spaces



Out of school hours
care (OSHC)



A canteen



A library



Games court



Covered outdoor
learning areas (COLA)



Open space

Project overview

The new primary school and community spaces in Green Square will be delivered by the Department of Education in collaboration with the City of Sydney. It will provide fit-for-purpose flexible learning spaces and core facilities to meet enrolment demands in the area.

The school will be located in Green Square on the former Royal South Sydney Hospital site on Joynton Avenue. The project will include dedicated multipurpose spaces for community use and shared spaces designed for both school and community use, including a communal hall, a multipurpose space, a games court and adjacent courtyard. Out of school hours care (OSHC) will also be provided on site.

Progress Summary

We are pleased to announce a new primary school and community spaces to be built in Green Square. This project is jointly funded by the NSW Government and City of Sydney.

A design excellence competition was held in late 2019, where architects were invited to submit designs for a new integrated school and community facility at Green Square. Sydney architects BVN have designed the winning scheme.

Next Steps

- Virtual information room will be open for the community from 9 am Thursday 23 to 5 pm Monday 27 September 2021.
- Submit a State Significant Development (SSD) application to the City of Sydney for assessment, as delegated by Department of Planning, Industry and Environment (DPIE).
- The application will be placed on public exhibition and submissions must be made directly to the City of Sydney.
- Determination of the SSD application.
- Start site establishment and early works on the Joynton Ave site, anticipated in late 2021. This work has been approved by a separate development application.

Timeline



Site plan



| LEGEND | | | |
|--------|------------------|--|--------------------|
| | Community spaces | | Shared spaces |
| | Main entry | | Kiss and drop zone |
| | Bus stop | | Public bike path |
| | Bike parking | | Throughsite link |

Schematic design

Ground level



Level 1

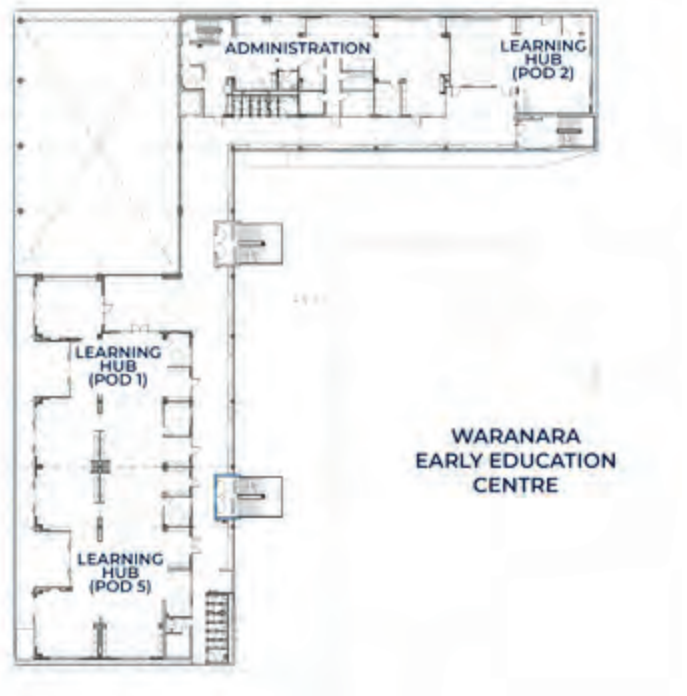

Level 2

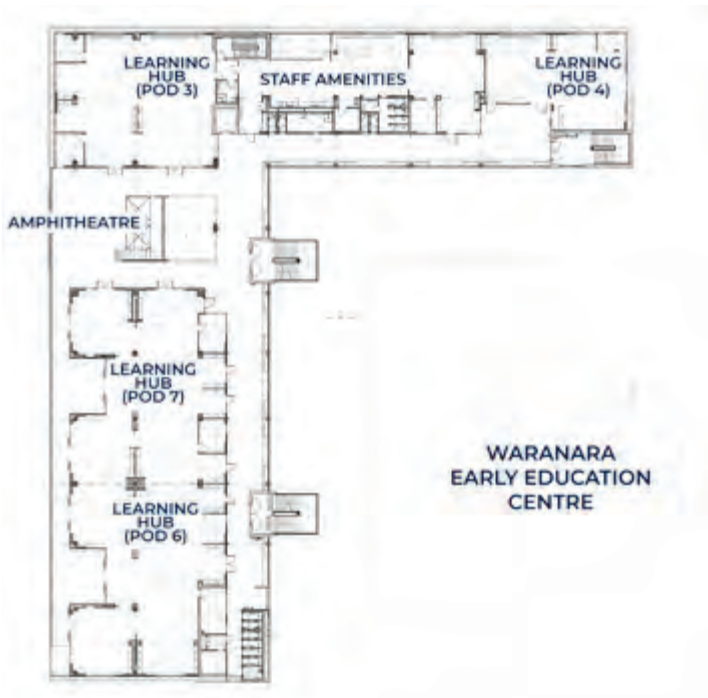

Level 3



Design principles

School Infrastructure NSW and the City of Sydney invited architects to participate in an Architectural Design Excellence Competition at the former Royal South Sydney Hospital site at Green Square, Zetland to provide a new high-quality, multi-level public primary school, new community facilities as well as shared facilities.

The City has a history of providing high quality community facilities, including a number of community facilities in the immediate vicinity of the Competition Site, such as a world class library, an aquatic and recreation centre, an Early Education Centre, Community Shed and the Joynton Avenue Creative Centre. Across New South Wales (NSW), the Department of Education is funding new public schools, upgrades to existing public schools and improved facilities as public school enrolments continue to grow.

The purpose of the competition was to deliver the highest quality architectural, urban and landscape design. The competition sought high quality, functional design that responded to the site's context in Green Square Town Centre with a welcoming street presence that reinforces the site's civic nature in Green Square Community and Cultural Precinct, respects the surrounding heritage context, considers the significant inter-relationship between the school and the community facilities and fits within the given budget.

All components of the project are considered equally important in achieving the overall design intent to create a high-quality, integrated school and community spaces that enhances the activation and liveability of Green Square.

The overall design objective is to provide a cohesive design response, integrating all components of the school and community spaces, which is essential to achieving design excellence. The overarching design objectives are as follows:

- To create the highest quality architectural, urban design and landscape design solution that is capable of achieving design excellence.
- Contribute to the civic qualities of the new Green Square Town Centre in terms of its design and the continuing civic role of Green Square Community and Cultural Precinct.
- Respect the site's physical surroundings, distinctive heritage character and the park so that the new development complements the local area in terms of appearance and amenity.
- Ensure building form is not monotonous, over-powering, impersonal, or institutional.
- Ensure the landscape spaces are designed to be thoroughly integrated with the building design, and to support the educational and recreational needs of students and staff.
- Ensure the design creates a culture of welcome, inclusion and belonging that reflects and respect diversity within the community, with a clear sense of arrival for all users and wayfinding on site.
- Optimise comfort and enjoyment within buildings and spaces through acoustic and thermal comfort, appropriate lighting, appropriately apportioned spaces and connection to surroundings.
- Create a sustainable building and landscape, both in design and operation.
- Create spaces that are inclusive and universally accessible.
- Promote the safety and security of all students, staff, visitors and members of the community.
- Embed potential for reconfigurability, multi-purpose use over time.
- Actively promote safe and easy access by all modes of transport.
- Maximise site permeability.



Artist impression of multipurpose court



View from north west



View from north east

Frequently asked questions

What is being delivered as part of this project?

The project will deliver a range of school facilities, including flexible teaching homebase classrooms, canteen, covered outdoor learning area (COLA) and library, dedicated multipurpose community spaces and additional facilities designed for both school and community use, including a communal hall, multipurpose space, out of school hours care (OSHC), a games court and adjacent courtyard.

Where will the school be located?

The new primary school and community spaces will be located in Green Square on the former Royal South Sydney Hospital site at Joynton Avenue, Zetland.

Why was there a design excellence competition?

A design excellence competition was held due to the significance of the project and key location in the Green Square town centre. Design Competitions have also been held for the nearby Green Square Library and Plaza and Gunyama Park Aquatic and Recreation Centre. The competition was held in late 2019. Design competitions are a well-tested and highly successful procurement model; they help prioritise good design and can bring the highest quality of thinking and originality to a project. More information about Design Excellence competitions can be found through the NSW Government Architect.

Who is the design excellence competition winner?

Sydney architects BVN have designed the winning scheme for the new integrated school and community spaces at Green Square. The winning BVN design will be refined before plans are submitted for planning approval and go on public exhibition.

What open space and recreation areas will be provided?

The design will provide a dedicated school rooftop play area, games court space, courtyard and multipurpose space within the site.

What are the shared use arrangements?

The building will incorporate joint use and dedicated community spaces on the ground floor. Aside from the dedicated community spaces fronting Zetland Avenue, the remainder of the ground floor will be used by the school during school hours and open to the public after hours and during weekends. Levels 1 to 3 will be dedicated school facilities only.

Who will operate the community spaces?

The community spaces will be managed by the City of Sydney and will be hired out to community groups and users.

What stage of design is the project in?

The schematic design shown in this Info Pack is in development. During master planning, we worked with key stakeholders to develop the education principles behind the project, and identify constraints and opportunities of the site which informed the building footprints. The project is currently in the schematic design phase and our consultant team are working through the overall layout and consideration of environmental, access, transport and other planning requirements.

What happens next?

Submit a State Significant Development (SSD) application to the City of Sydney for assessment, as delegated by Department of Planning, Industry and Environment (DPIE).

Frequently asked questions (cont.)

What is the catchment area for the new primary school?

The school catchment will be confirmed closer to the school opening and will be based on the most up to date demographic data on the number of school aged children living in the local area at the time the school opens.

How will students get to the new school?

The site is centrally located within the Green Square town centre, which has been designed as a network of people-friendly, low-speed streets that encourage walking and cycling in the area.

Separated cycleways are located on two streets that run alongside the site, connecting to the extensive bike network in the area. It is adjacent to main bus routes and will include a drop off and pick up zone. The site is well positioned 350m from Green Square train station.

Traffic and transport movements will be considered as part of the SSD application and can be found in the Transport and Accessibility Impact Assessment (TAIA), which will be a technical study in the Environmental Impact Statement.

How can I find out more about the project?

School Infrastructure NSW (SINSW) will share information with the local community as the project progresses.

The SINSW website will continue to have up-to-date information about the high school project in your area edu.nsw.link/xeqYJ7.

You can also continue to contact us via our community information line 1300 482 651 and by email schoolinfrastructure@det.nsw.edu.au.

Contact us



Website

Stay up to date by visiting the School Infrastructure NSW website schoolinfrastructure.nsw.gov.au



Email

Contact the Community Engagement team by emailing schoolinfrastructure@det.nsw.edu.au



Phone

Contact us between 9:00am and 5:00pm, Monday to Friday on **1300 482 651**



Appendix F

Virtual Room Information Report

Green Square: Invitation – virtual tour of new Green Square school and community spaces

Sent Sep 23, 2021 at 9:40AM

Sent to 2,613 unique subscribers in Green Square

● Opens and ● Link Clicks for first day

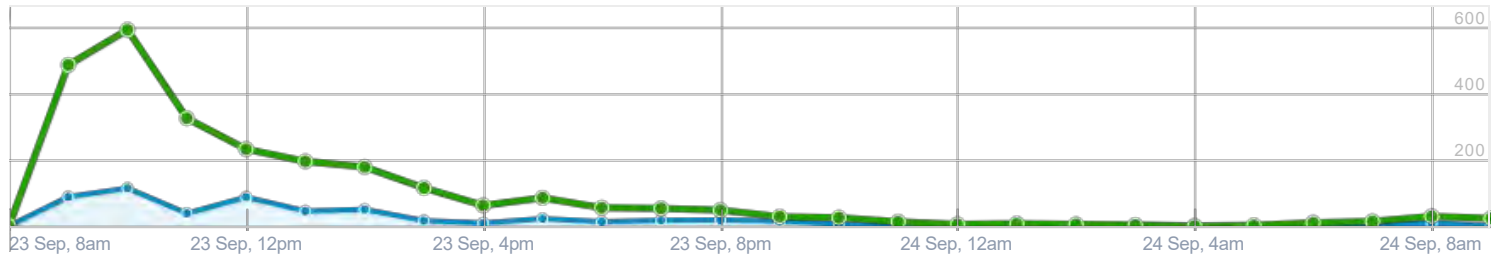

Campaign Overview

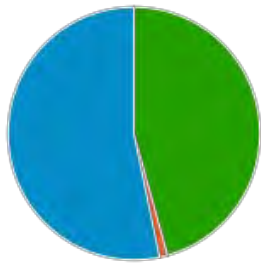

- **1,194** Unique opens
3,148 total opens to date
- **27** Bounced
1.03% couldn't be delivered
- **1,392** Unopened
Open rates are only estimates

46.17% of all recipients opened so far

25.63% clicked a link (306 people)

0.31% unsubscribed (8 people)

0 people marked it as spam (0%)

0 shares across Facebook & email

Links Clicked

306

people clicked
Giving you a **25.63%** click rate.

669

total clicks
Made by 306 people

2.19

clicks per person
Average of all those who clicked.

888

didn't click
That's 74.37% of all those who opened.

| Link (URL) | Unique | Total |
|---|--------|-------|
| https://www.schoolinfrastructure.nsw.gov.au/green-square/primary-school-in-Green-Square.html | 271 | 536 |
| https://news.cityofsydney.nsw.gov.au/a...-square-school-will-mean-space-for-all | 57 | 74 |
| Link to web-based version of this email | 13 | 23 |
| https://www.cityofsydney.nsw.gov.au/green-square | 10 | 15 |
| www.cityofsydney.nsw.gov.au | 10 | 12 |
| https://www.cityofsydney.nsw.gov.au/about-us/privacy | 7 | 9 |