

ABN 16 002 247 565

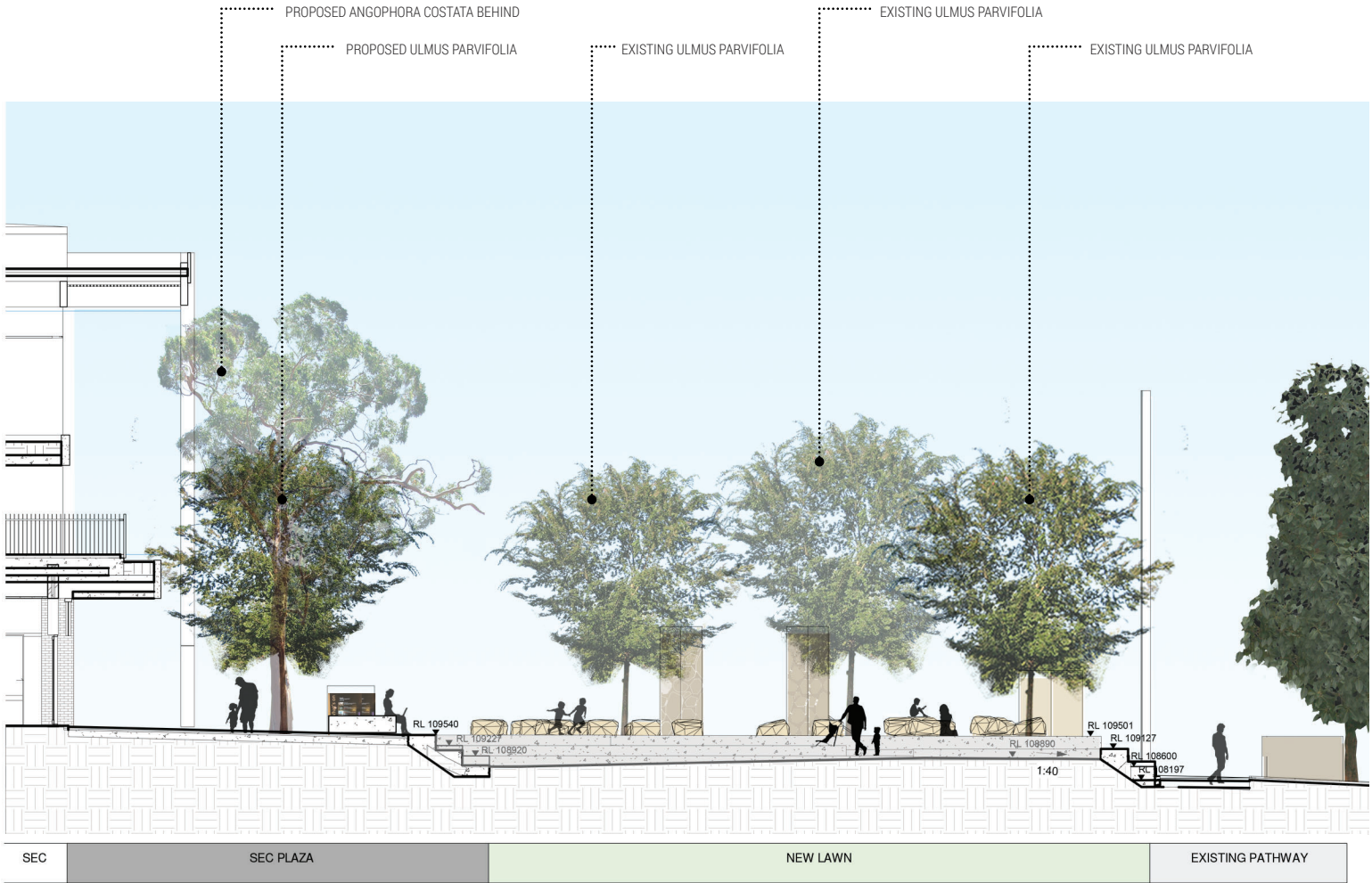

SECTION B
SCALE: 1:100 @ A1 | 1:200 @ A3

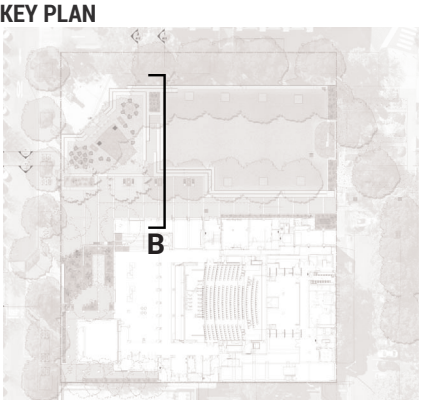

Issue				
No.	Date	Description		Chkd
1	17/01/2020	DRAFT DA		BS
2	14/02/2020	DRAFT DA		BS
3	09/03/2020	ISSUE FOR DA		BS

Disclaimer
These plans are for Client use and/or Council Approval only. Not intended for construction purpose unless specifically noted. The contractor intending to use these documents shall check and verify all works on site and report any discrepancy to the Landscape Architect prior to commencement. Failure to do so shall not be the responsibility of the Client or Landscape Architect.
Any form of replication of this drawing in full or in part without the written permission of NBRS & PARTNERS Pty Ltd constitutes an infringement of the copyright
ABN 16 002 247 565 © 2019

Drawing Title
LANDSCAPE SECTIONS

Project
Sutherland Shire Entertainment Centre (SEC)
at
30 Eaton Street, Sutherland NSW
for
Sutherland Shire Council (SSC REF. 17700)

Landscape Architect
NBRSARCHITECTURE.
LANDSCAPE
Sydney
61 2 9922 2344
Any form of replication of this drawing in full or in part without the written permission of NBRS+PARTNERS Pty Ltd constitutes an infringement of the copyright.
Nominated Architects:
Andrew Duffin NSW 5602
NBRS & Partners Pty Ltd VIC 51197
© 2019
ABN 16 002 247 565

SCC Ref. No 17700

Date 17/01/2020
Scale 1:200 @ A3 or 1:100 @ A1

Drawing Reference
18465-NBRS-LDA-108

Revision
03

0 10 20 30 40 50 60 70 80 90 100



VIEW 1: LOOKING TOWARDS MAIN LOBBY ENTRY ACROSS TERRACE LAWN



VIEW 2: SUTHERLAND ENTERTAINMENT CENTRE ETON STREET ENTRY

KEY PLAN

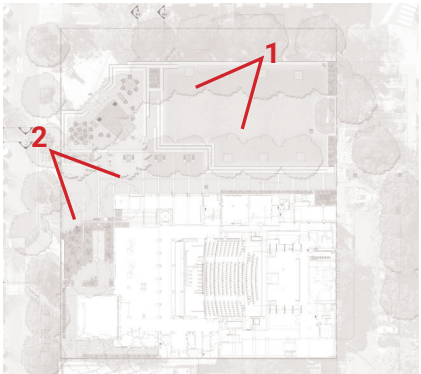

Issue				Chkd	Disclaimer
No.	Date	Description			
1	17/01/2020	DRAFT DA		BS	These plans are for Client use and/or Council Approval only. Not intended for construction purpose unless specifically noted. The contractor intending to use these documents shall check and verify all works on site and report any discrepancy to the Landscape Architect prior to commencement. Failure to do so shall not be the responsibility of the Client or Landscape Architect. Any form of replication of this drawing in full or in part without the written permission of NBR & PARTNERS Pty Ltd constitutes an infringement of the copyright ABN 16 002 247 565
2	14/02/2020	DRAFT DA		BS	
3	09/03/2020	ISSUE FOR DA		BS	
					© 2019

Drawing Title

LANDSCAPE VIEWS

Project

Sutherland Shire Entertainment Centre (SEC)

at

30 Eaton Street, Sutherland NSW

for

Sutherland Shire Council (SSC REF. 17700)

Landscape Architect

NBR
SARCHITECTURE
LANDSCAPE

Sydney
61 2 9922 2344
Any form of replication of this drawing in full or in part without the written permission of NBR & PARTNERS Pty Ltd constitutes an infringement of the copyright.
Nominated Architects:
Andrew Duffin NSW 5602
NBR & Partners Pty Ltd VIC 51197

© 2019
ABN 16 002 247 565

SCC Ref. No 17700

Date 17/01/2020

Scale

Drawing Reference

18465-NBR-LDA-109

Revision

03

0 10 20 30 40 50 60 70 80 90 100



VIEW 3: ETON STREET WAR MEMORIAL NORTHERN CORNER



VIEW 4: SUTHERLAND ENTERTAINMENT CENTRE PLAZA LOOKING TOWARDS ETON STREET

KEY PLAN

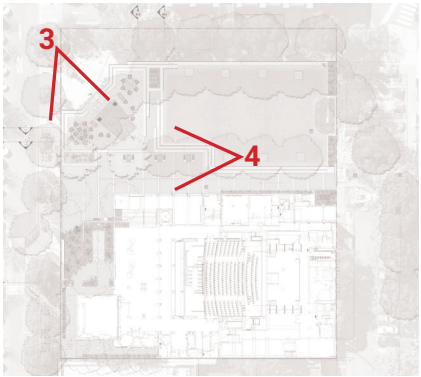

Issue				Chkd	Disclaimer
No.	Date	Description			
1	17/01/2020	DRAFT DA		BS	These plans are for Client use and/or Council Approval only. Not intended for construction purpose unless specifically noted. The contractor intending to use these documents shall check and verify all works on site and report any discrepancy to the Landscape Architect prior to commencement. Failure to do so shall not be the responsibility of the Client or Landscape Architect. Any form of replication of this drawing in full or in part without the written permission of NBRSS & PARTNERS Pty Ltd constitutes an infringement of the copyright ABN 16 002 247 565
2	14/02/2020	DRAFT DA		BS	
3	09/03/2020	ISSUE FOR DA		BS	
					© 2019

Drawing Title
LANDSCAPE VIEWS

Project
Sutherland Shire Entertainment Centre
(SEC)
at
30 Eaton Street, Sutherland NSW
for
Sutherland Shire Council (SSC REF. 17700)

Landscape Architect
NBRSSARCHITECTURE.
LANDSCAPE
Sydney
61 2 9922 2344
Any form of replication of this drawing in full or in part without the written permission of NBRSS+PARTNERS Pty Ltd constitutes an infringement of the copyright.
Nominated Architects:
Andrew Duffin NSW 5602
NBRSS & Partners Pty Ltd VIC 51197

SCC Ref. No 17700

Date 17/01/2020
Scale

Drawing Reference
18465-NBRSS-LDA-1010

Revision
03

0 10 20 30 40 50 60 70 80 90 100