



# TRINITY GRAMMAR SCHOOL - SUMMER HILL CAMPUS

The Renewal Project - Landscape SSDA

January 2020

ARCADIA

# Table of Contents

---

## Section 1 The Renewal Project

Trinity Grammar School  
Landscape Precincts  
Landscape Masterplan  
The Agora  
TNL  
Jubilee Entry  
The Terrace  
Trinity Theatre  
Chapel Drive Entry  
Junior School Play

---

## Section 2 Landscape Strategies

Landscape Character  
Hardstand Palette  
Planting Palette  
The Town Gown

---

Arcadia respectfully acknowldges the traditional custodians of the land upon which Trinity Grammar School stands today, the Wangal people of the Dharug (Eora) Nation. We honour elders past, present and emerging whose knowledge and wisdom will ensure the continuation of cultures and traditonal practices.



# Trinity Grammar School

## Renewal Project

### Aims and Objectives

The following objectives have been identified as forming the basis of the proposed development of the existing educational establishment:

- Create an education precinct to create a high-quality teaching and learning environment for staff and students;
- Establish additional floor space to increase availability and efficiency of teaching functions for Trinity Grammar School Summer Hill Campus;
- Improve site access, car parking and surrounding traffic functions in the precinct;
- Strengthen pedestrian linkages throughout the campus;
- Enhance the overall campus aesthetic, upgrade the public domain to create visually interesting transitions through the campus, and promote the heritage elements of the campus;
- Ensure minimal environmental impact;
- Maintain the significant green fields assets and provide opportunities for new outdoor environments;
- Ensure development is compatible with surrounding development and the local context; and
- Create a safe environment to support and nurture the boys growth.

The site and proposed design are considered to meet the objectives of the project as it allows for development on land that has been previously used for educational purposes.

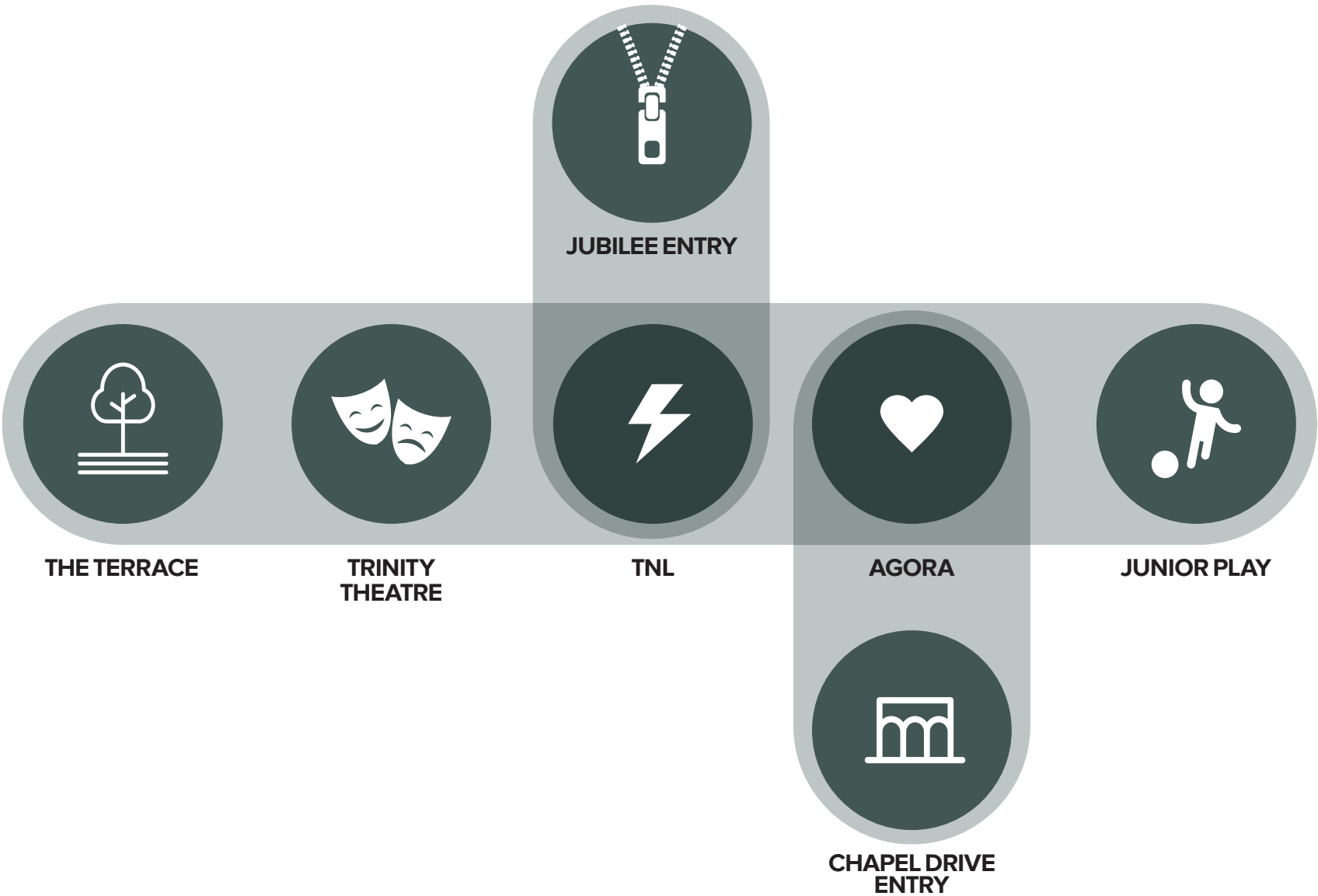



# Landscape Precincts

## Renewal Project

### Description of the Proposal

The proposed development seeks detailed built form approval of new teaching and educational facilities, as detailed below:

- New five (5) storey building at the heart of the Campus to accommodate modern, flexible teaching and learning spaces;
- Improve movement and flow for students, with better east-west and north-south links across the school grounds and between levels, including more accessible connections between the Junior School, ovals and car park, and providing strong visual and physical connections;
- Renewal and Refurbishment of existing teaching and learning facilities;
- Reconfiguration and connection of underground car park improve traffic flow for the school drop-off and pick-up zone and improve the safety of boys and visitors who enter the school grounds as pedestrians from Victoria Street;
- New multipurpose pavilion between Ovals 1 and 3 containing a multipurpose space and basketball court;
- Demolition of school-owned residences at 46, 48, 50 and 52 Seaview Street, improving the existing service, maintenance and delivery facilities;
- Improvement and extension to Junior School outdoor teaching area and outdoor assembly area.

Overall, the proposed built form approval seeks to provide a framework for the future physical development of the Campus to ensure the best teaching and learning outcomes, and ongoing evolution of the School.

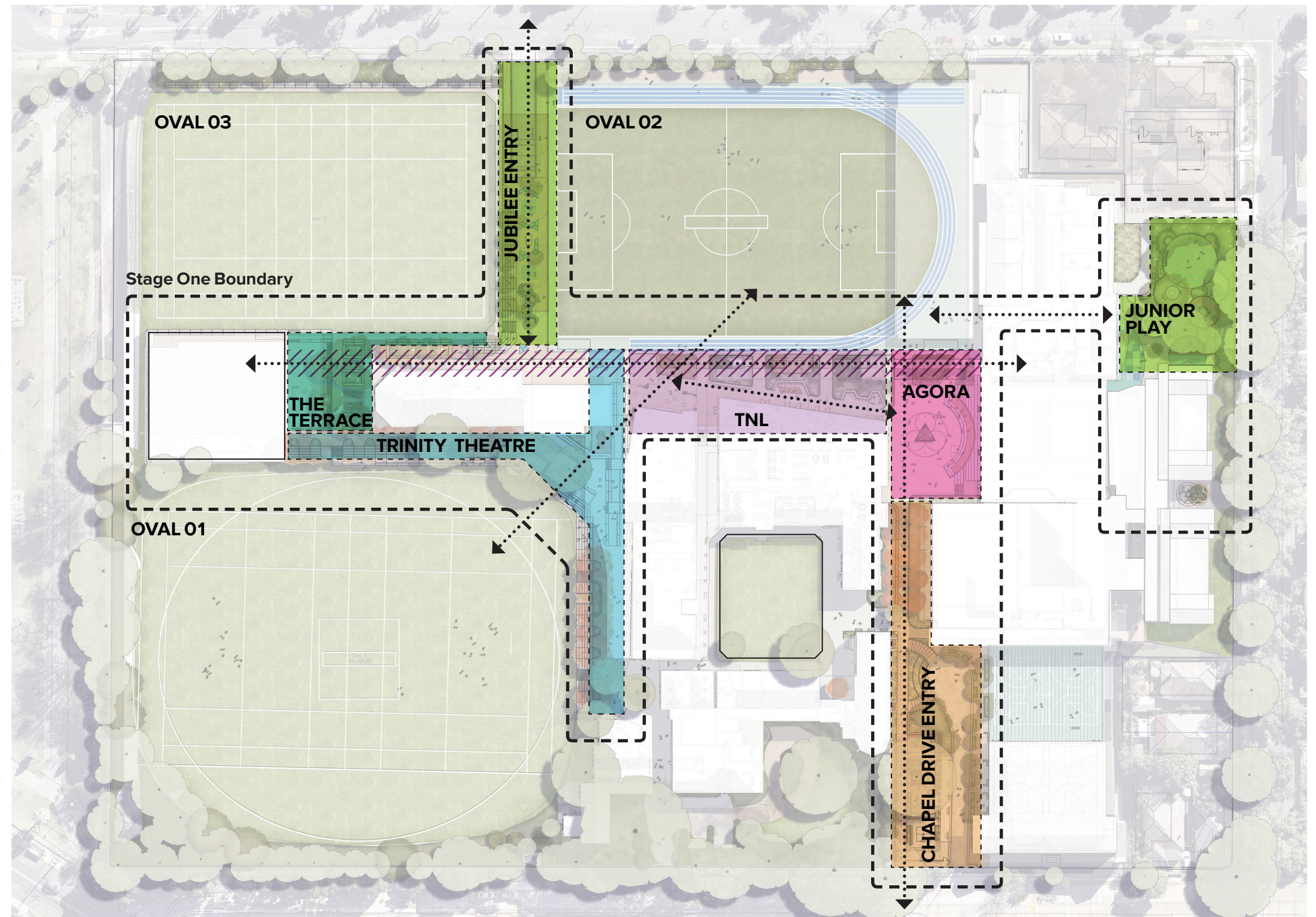



Master Plan

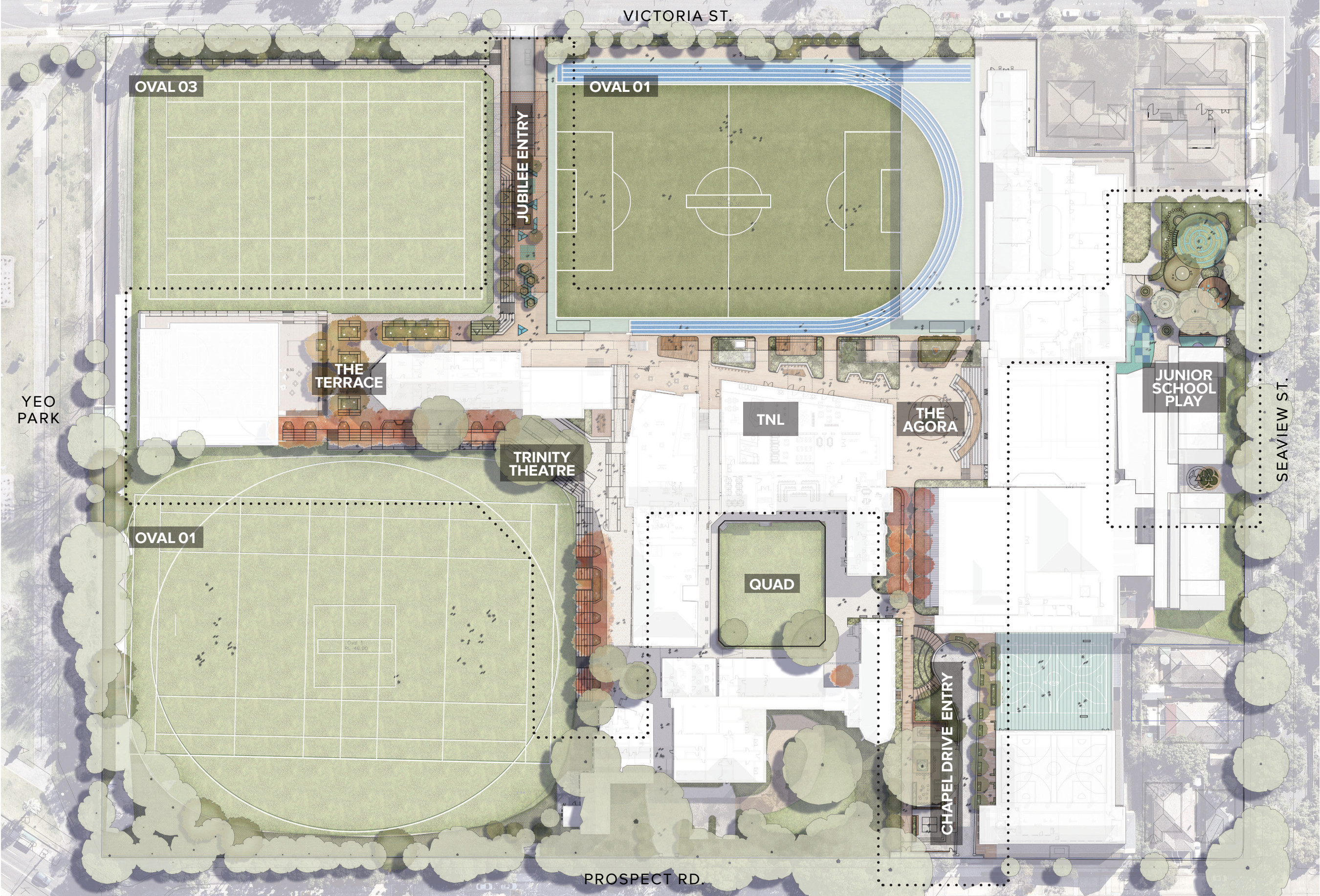



# The Agora

## Precinct Vision



### The Experience



#### Program & Users

- A flexible platform for the whole campus, providing grand assembly, performance, and exhibition
- Grand entry and arrival to and from vehicular drop off and pick up
- Space used for entire school, visitor arrival & meeting point as a the primary node unifying various areas of the campus.

### Character & Spatial Qualities



#### Spatial Qualities

- Axis views to chapel + Ceremonial Axis, views to TNL and sports grounds
- The crossroads for the Trinity campus. Generous multi-levelled pedestrian zones facilitate movement to and from each area of the campus.
- An indoor-outdoor space, shelter is provided year-round, while microclimatic zones are focused on providing amenable spaces for gathering and learning.
- A multi functional space that can transform into a stage, a gallery or function area.

### Elements & Materiality

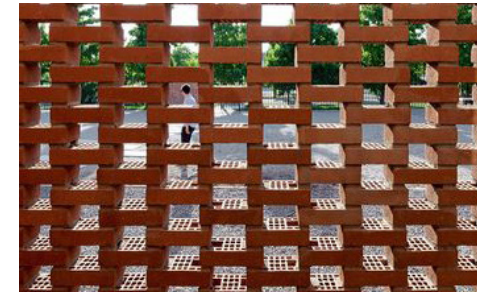

#### Materiality

- Transitioning from traditional heritage to contemporary materials
- Permeable structures allow ample light to flow through the space
- Opportunities for artistic display adds interest, texture and emphasises place
- Technology built in to agora for functions, exhibitions and performances



# The Agora

## Precinct Detail Plan

### Legend

- 1 Feature paving with school emblem
- 2 Feature assembly lounge
- 3 Spectator seating to sports court
- 4 Entry feature grove with art and lounge
- 5 Multi Functional Forecourt
- 6 Communal Seating Nook with Study Table
- 7 Access portal to carpark
- 8 Cascading plants to basement
- 9 Sunken tropical garden

### Key Plan

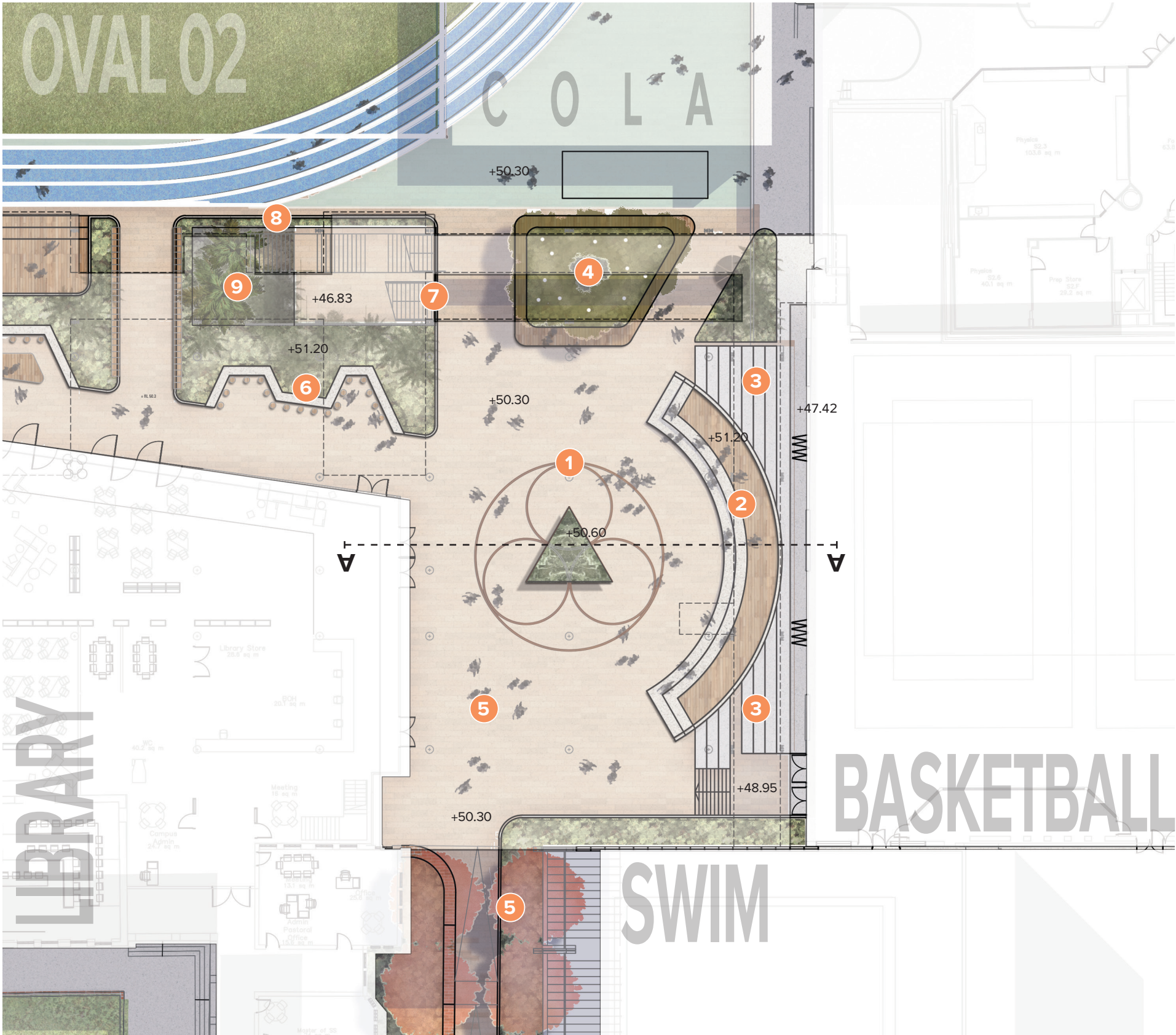
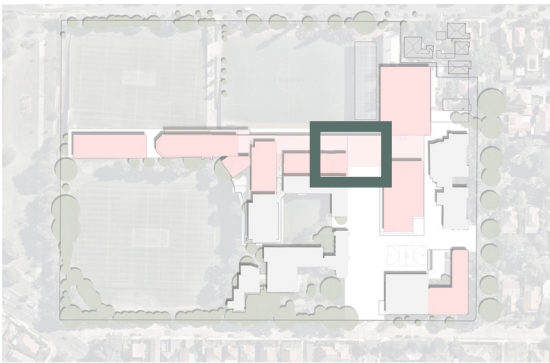

The Agora  
Section A - A

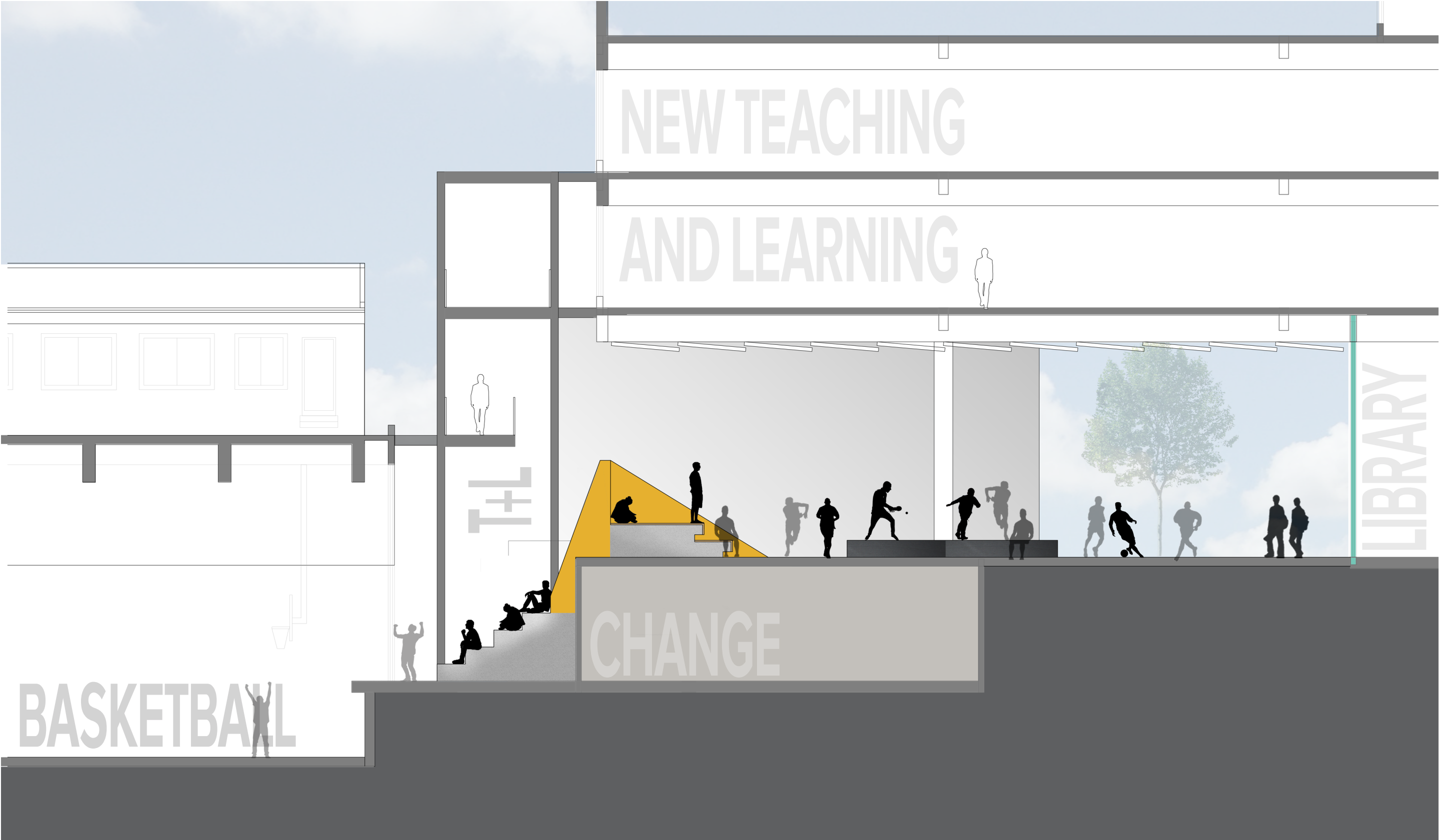



The Agora  
Isometric Diagram



Key Plan





The Agora  
Isometric Diagram



Key Plan

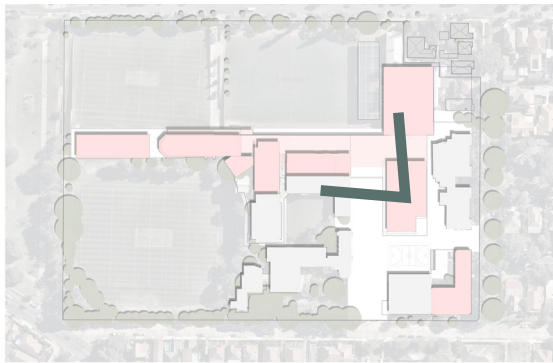





## The Experience



### Precinct Concept

- A continuous legible north south corridor through school to Yeo park
- A multi-levelled link between Sports, Music, Agora, and Junior School. The corridor provides spill over spaces that respond to the specific needs of each faculty, allowing for formal and informal gathering, performances, and maker spaces.
- Flexible indoor-outdoor spaces for both learning, gathering, and viewing sports
- Strengthen solar protection to existing and proposed buildings
- Enhanced drop-off experience and connectivity

## Character & Spatial Qualities

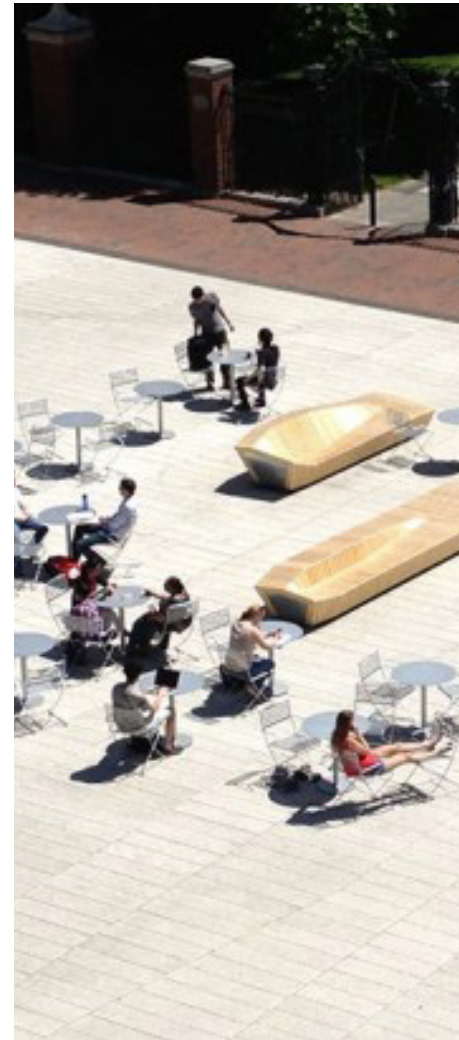

### Spatial Qualities

- Views west over sports and neighbourhood
- Linear circulation with flexible gathering and study nodes activating interstitial zones
- Shelter is provided for students moving through the space in inclement conditions while microclimatic zones are focused on providing amenable spaces for gathering and learning.

## Elements & Materiality

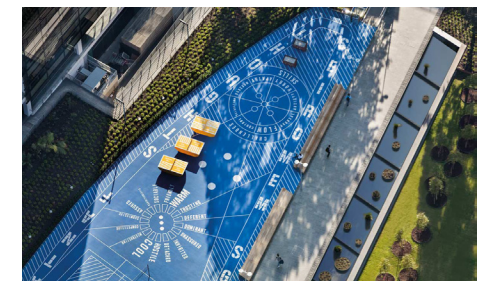

### Materiality

- Contemporary materials to complement new architecture and contrast with heritage structures
- Permeable screening + planting to allow light
- Shade structures including vertical planting provide internal amenity and external identity



# TNL SPILL OUT

Precinct Detail Plan

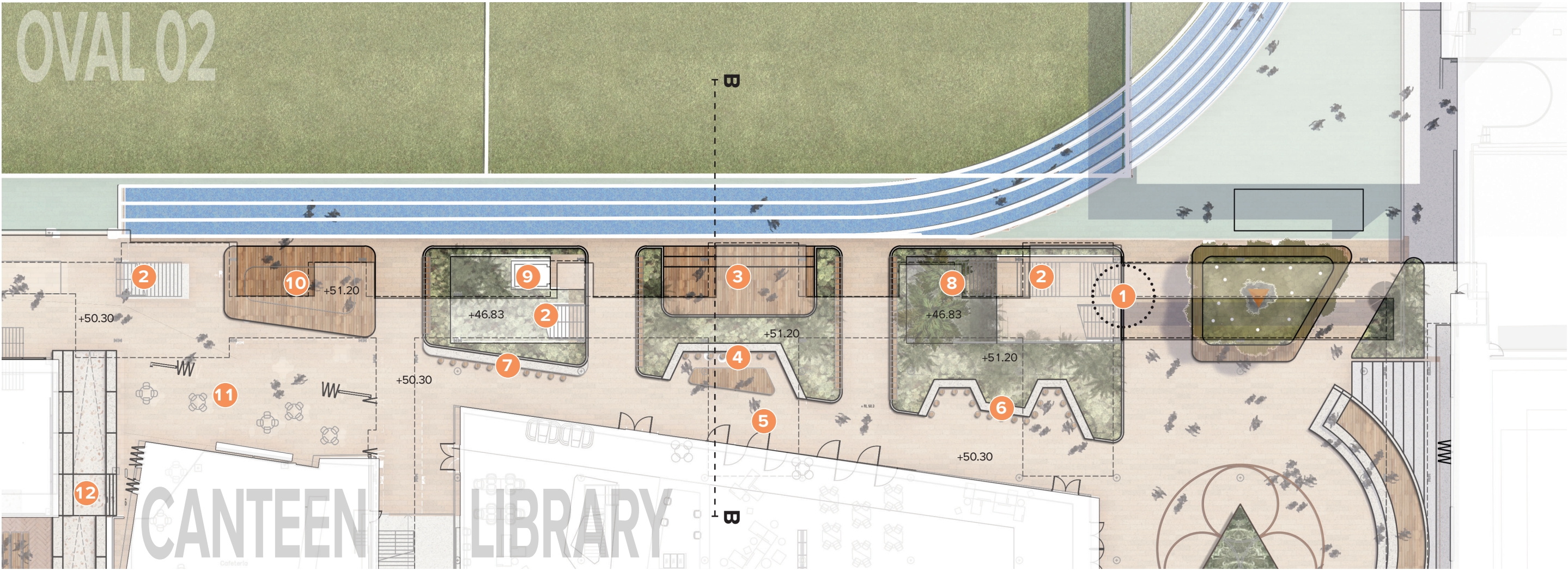

## Legend

- |   |   |    |                      |
|---|---|----|----------------------|
| 1 | Access portal to carpark                      | 9  | Lift access          |
| 2 | Vertical circulation                          | 10 | Timber island lounge |
| 3 | Terraced deck lounge                          | 11 | Canteen forecourt    |
| 4 | Outdoor classroom nook                        | 12 | Oval one access      |
| 5 | Circulation path around library and reception |    |                      |
| 6 | Communal Seating Nook with Study Table        |    |                      |
| 7 | Bar table                                     |    |                      |
| 8 | Sunken tropical garden                        |    |                      |

## Key Plan

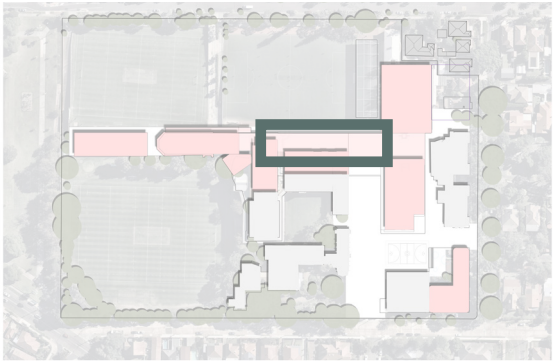



# The Power Pack

Section B - B

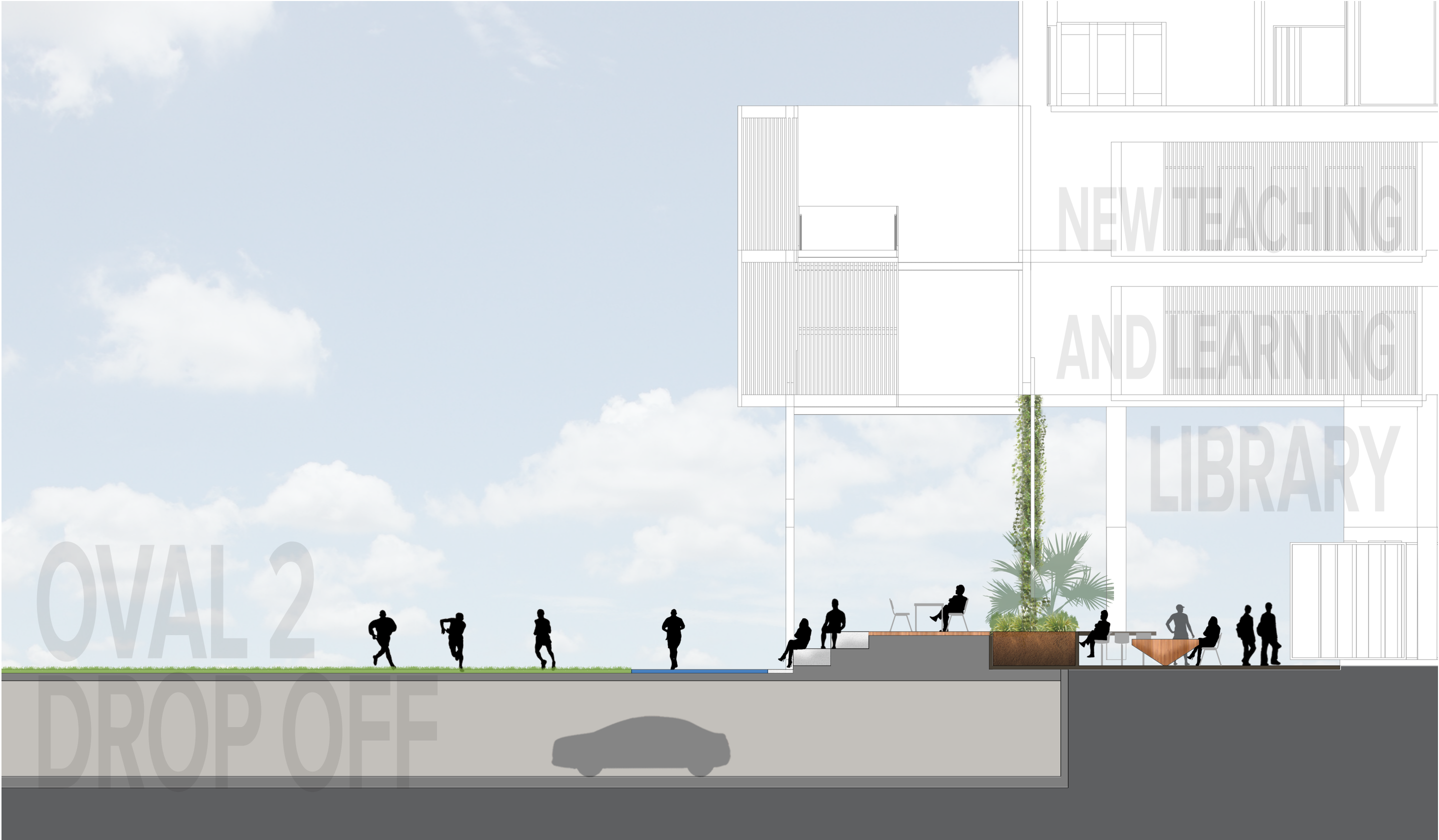



# Jubilee Entry

Precinct Vision

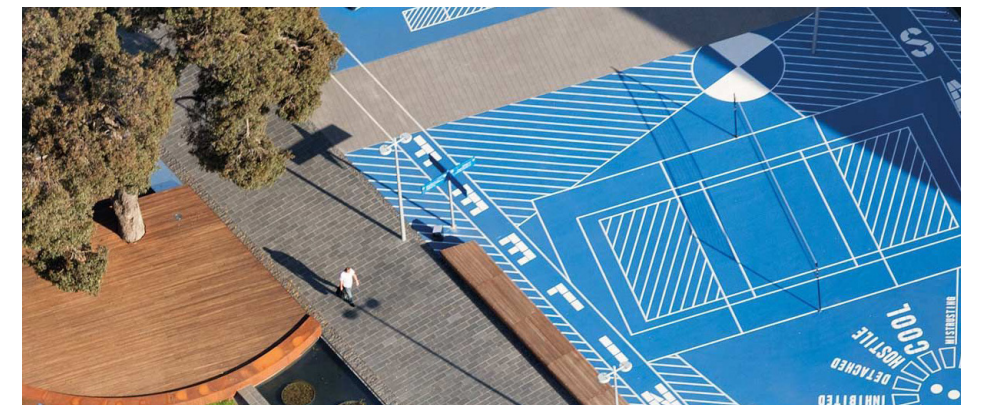
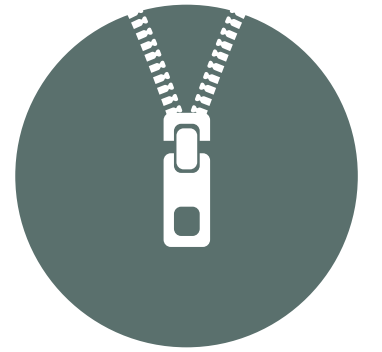

## Program & Users

- Bus drop off, kiss + drop, parent gathering
- Passers by, visitors
- Chapel (weddings, funerals, and the like)

## Spatial Qualities

- Retain & enhance prominent street presence. Frame agora & ceremonial spine with formal avenues
- Public perimeter movement

## Materiality

- Formal planting and materials
- Signage/Wayfinding
- Landmarks



# Jubilee Entry

Precinct Detail Plan

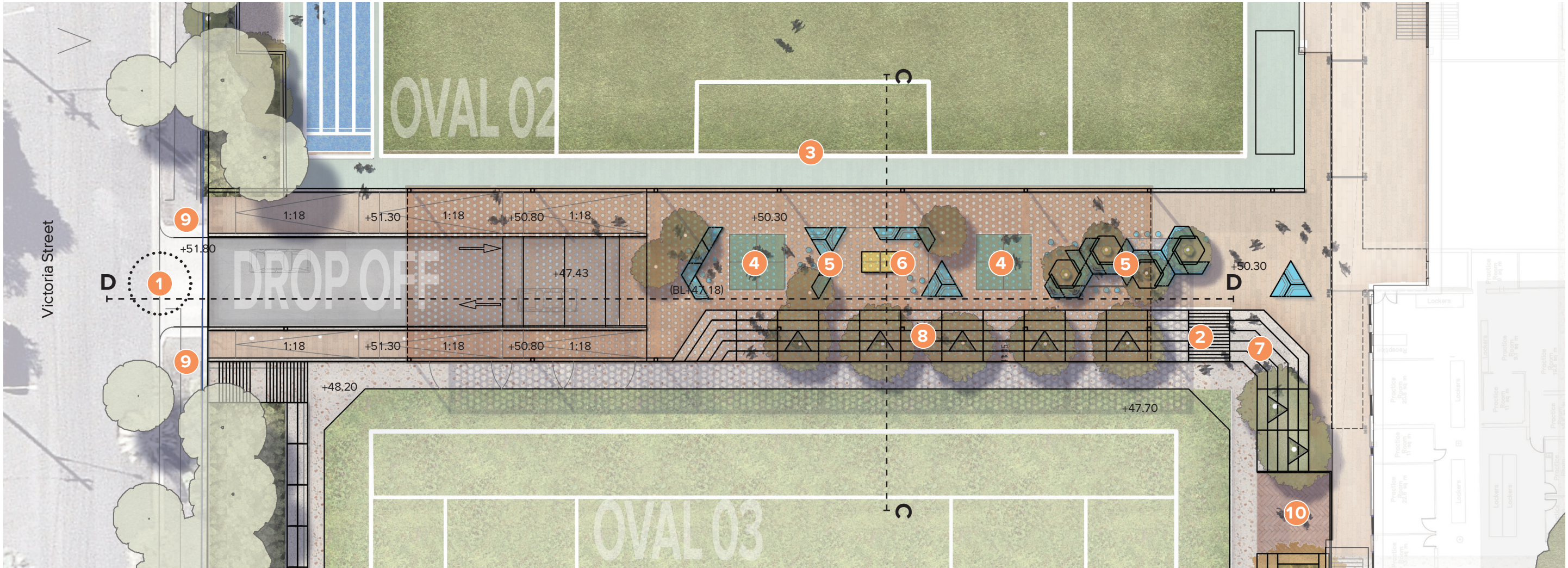

## Legend

- |   |  |    |  |
|---|--|----|--|
| 1 | Entrance Driveway to underground carpark | 7  | Amphitheatre Seating                                     |
| 2 | Stairs access to Jubilee Entry           | 8  | Precast concrete terrace with integrated avenue planting |
| 3 | Soccer net                               | 9  | Pedestrian access to Victoria Street                     |
| 4 | Painted handball court                   | 10 | Pedestrian access to carpark/B1                          |
| 5 | Modular communal lounge with backrest    |    |  |
| 6 | Ping pong table                          |    |  |

## Key Plan

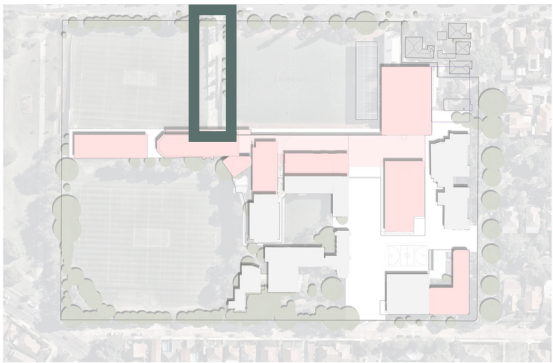



# Jubilee Entry

Isometric Diagram

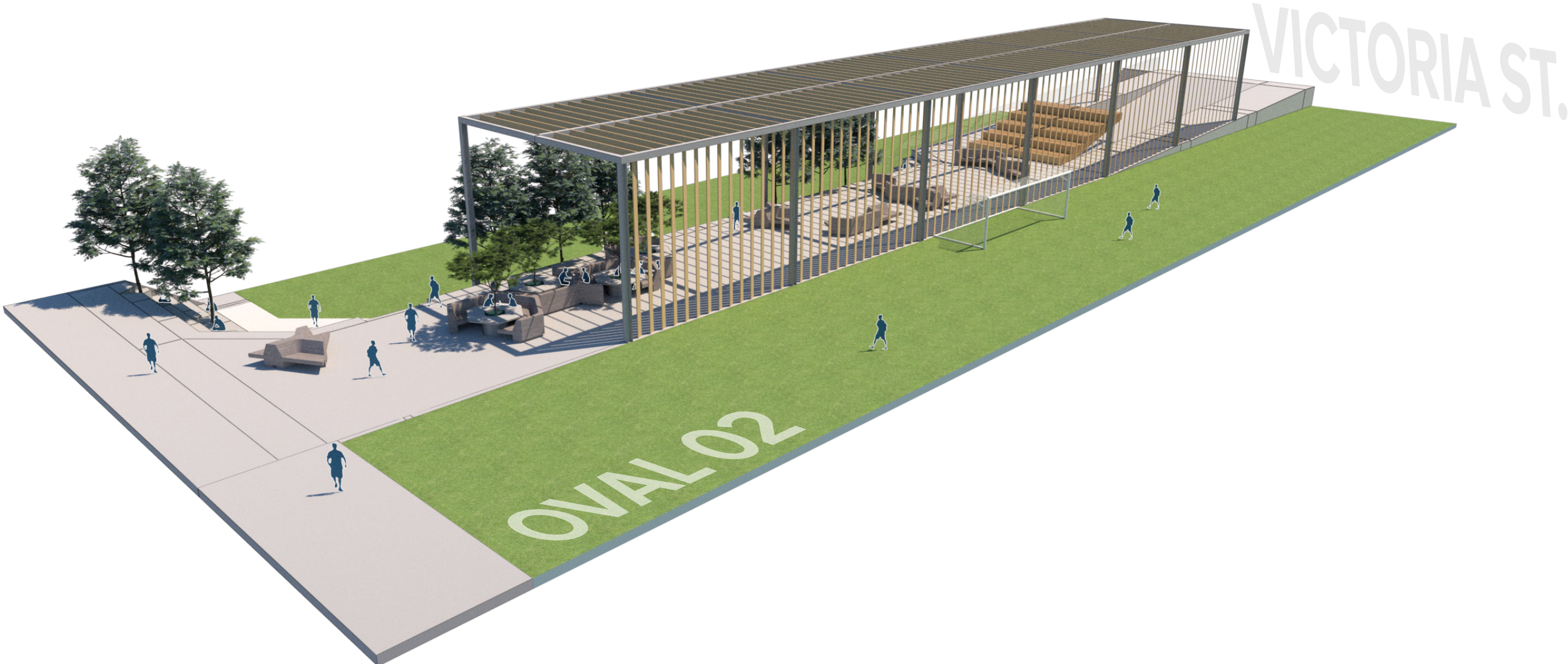

## Key Plan

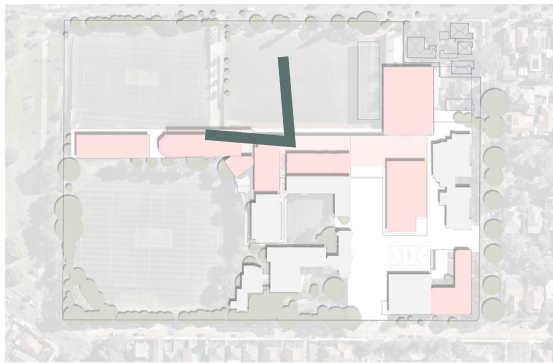



# The Terrace

Precinct Vision

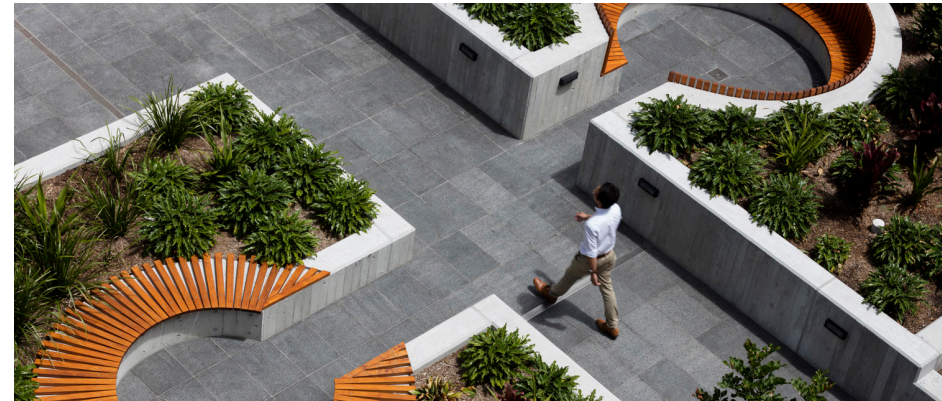

## Program & Users

- Key axis between Oval 1 and 2
- Students in groups of 8-25 outdoor communal space
- Sporting event breakout space
- Increased green canopy
- Sports spectating

## Spatial Qualities

- Combination of communal and intimate outdoor rooms
- Flexible outdoor furniture for recess or class
- Prime spectating and passive surveillance

## Materiality

- Precast concrete modules define bleachers for spectating and retaining for soft landscaping and trees
- Finegrain material palette define communal hangout areas



# The Terrace

## Precinct Detail Plan

### Legend

- 1 Integrated seating terrace/planter
- 2 Raised grove planting
- 3 Communal table
- 4 Alfresco terrace
- 5 Kiosk
- 6 Shade canopy (above)

### Key Plan

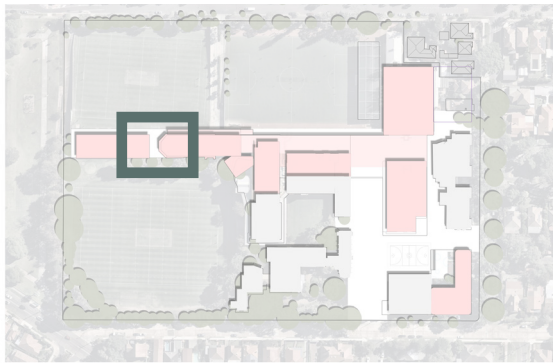



# The Terrace

Section E - E





# Trinity Theatre

## Precinct Vision

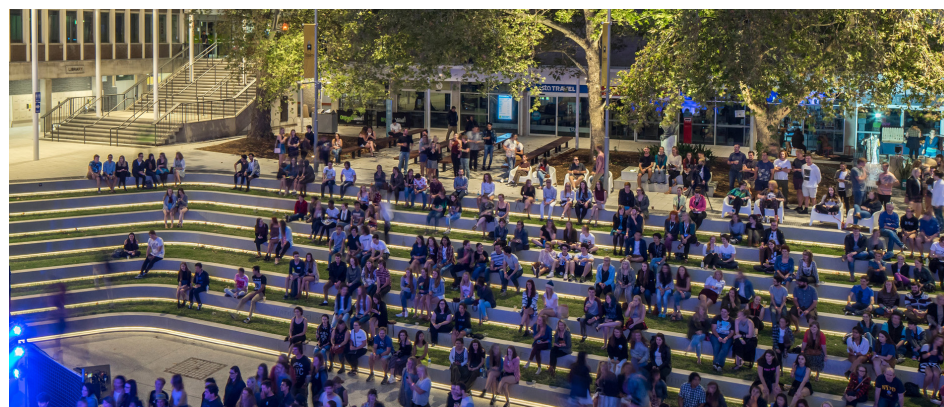

### Program & Users

- Key external assembly area (approx. 1200 pax)
- Formalised oval one spectating
- Integrated legacy tree planting
- accessible ramp access to oval 02 and carpark
- Outdoor performing arts amphitheatre
- Canteen breakout space
- Accessible

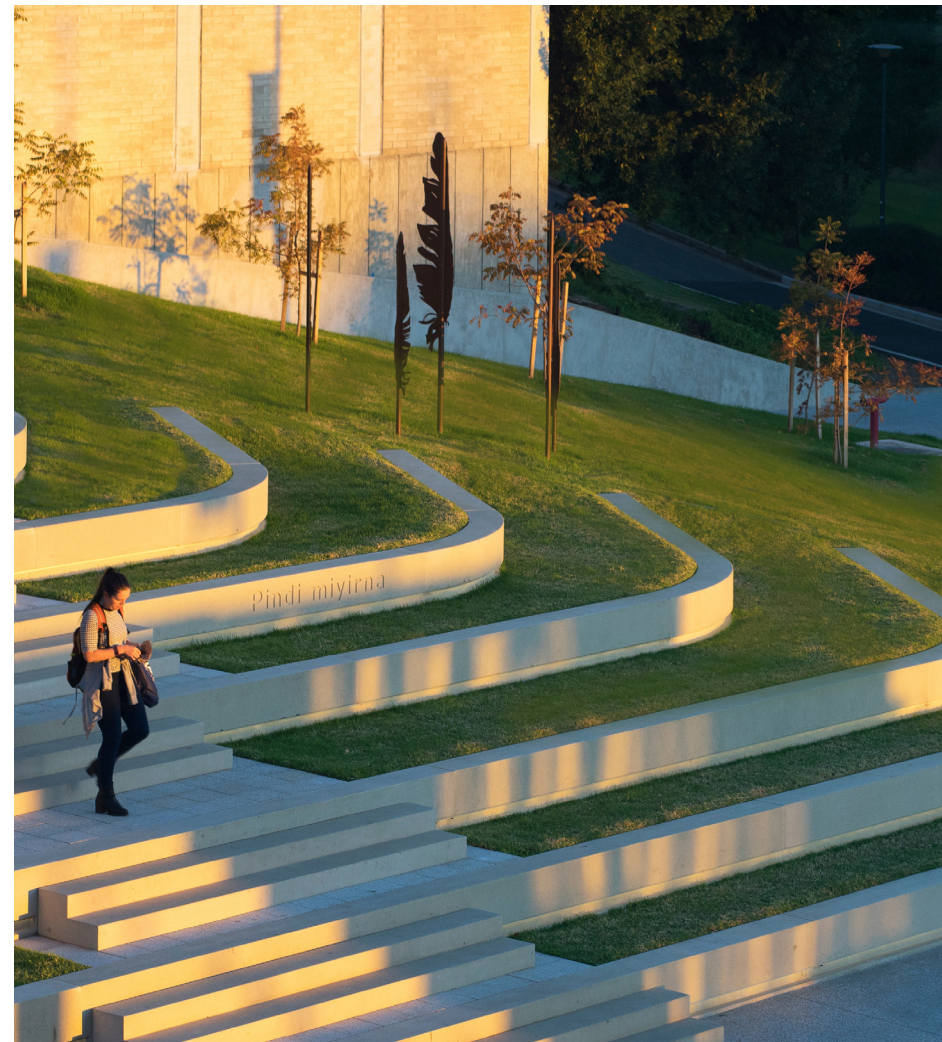

### Spatial Qualities

- A grand assembly destination
- Carnival events
- Competition sports spectating
- Seasonal comfort

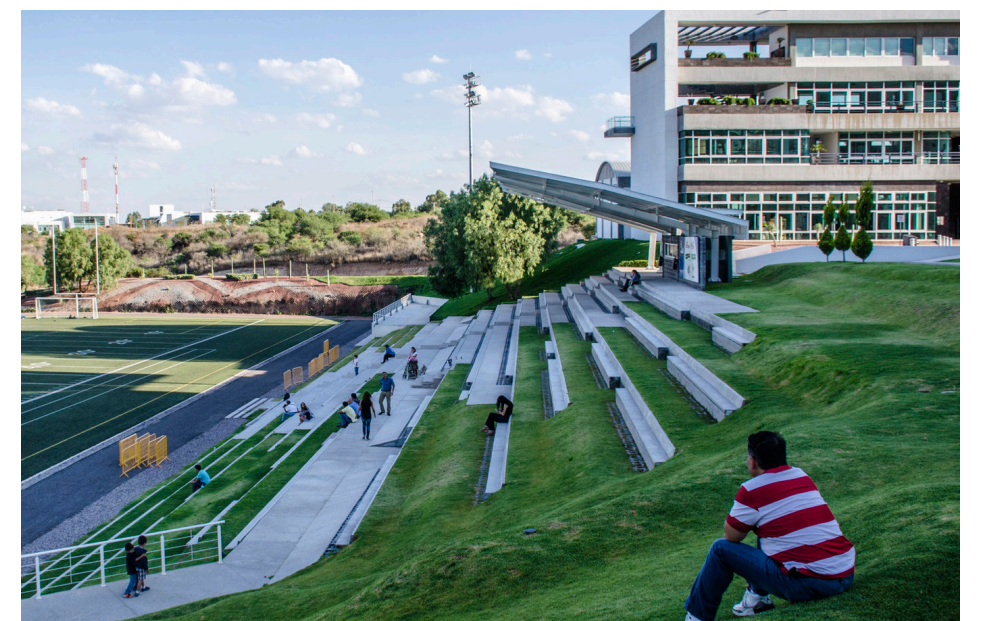

### Materiality

- Precast concrete modules define bleachers for spectating and retaining for soft landscaping and trees



# Trinity Theatre

Precinct Detail Plan





# Trinity Theatre

Section F - F





# Trinity Theatre

Isometric Diagram



## Key Plan

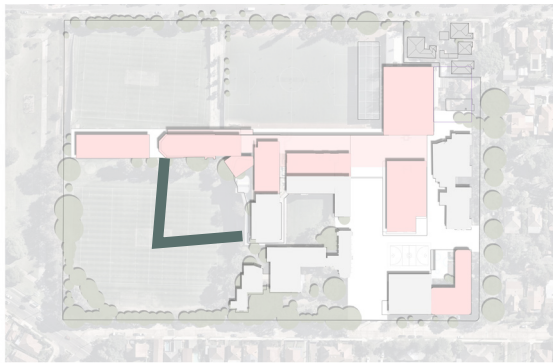



# CHAPEL DRIVE ENTRY

Precinct Vision



## The Experience

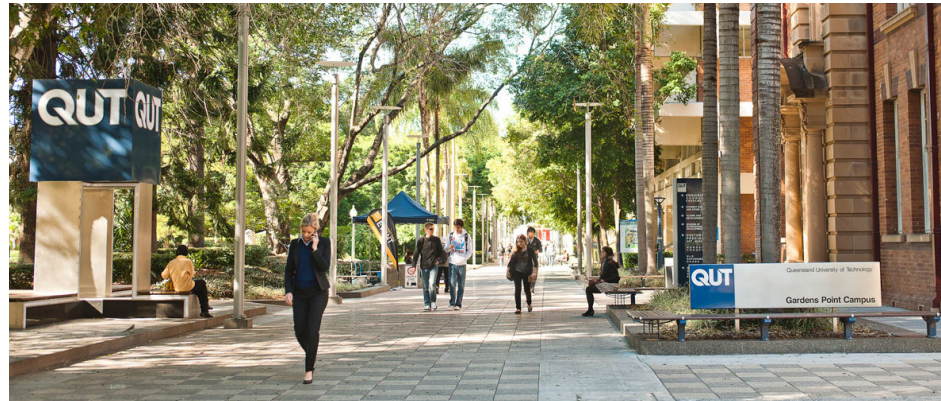

## Character & Spatial Qualities

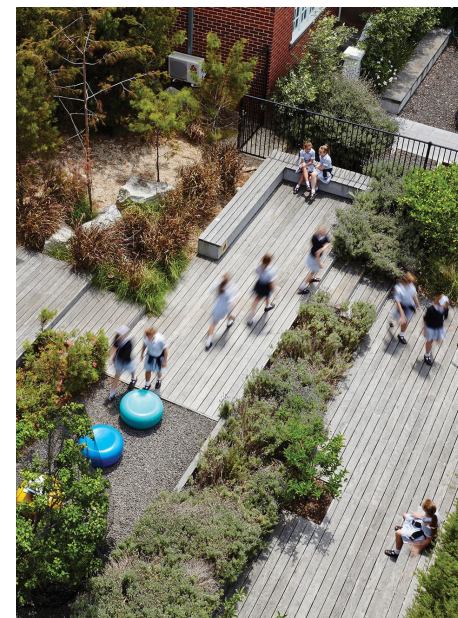
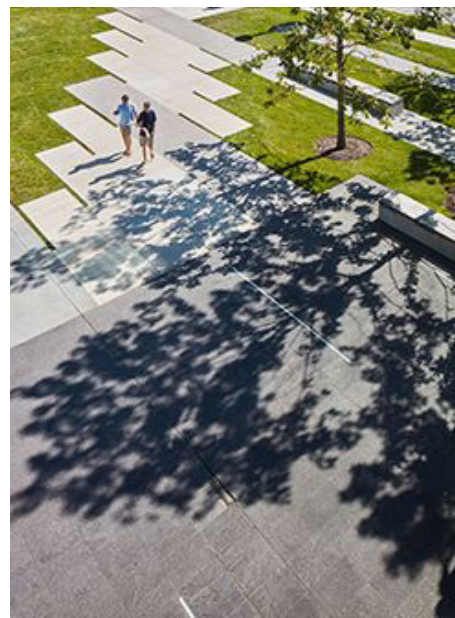

## Elements & Materiality

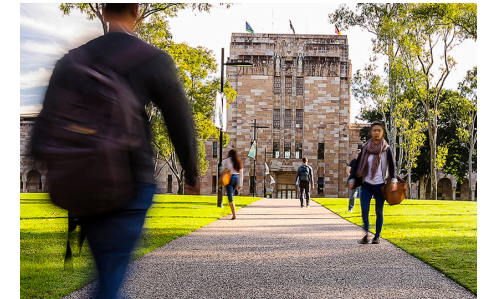
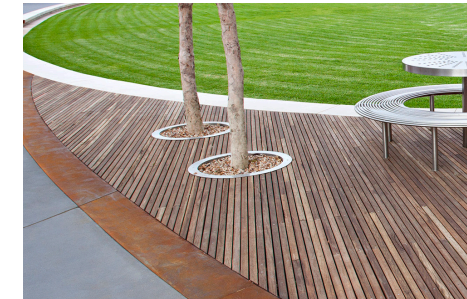

## Programme & Users

- Bus drop off and pick up
- Walkway to academic core and junior school
- New Science TAS/Art outdoor learning
- Handball and games
- Informal group gathering
- Chapel arrival and service (weddings, funerals, and the like)

## Spatial Qualities

- Heritage views to chapel, garden and quad, and linear Axis views to Agora
- Generous pedestrian zones aiding both movement and gathering, as well as provision for service and processional vehicular access
- Shelter is provided for students moving through the space in inclement conditions while microclimatic zones are focused on providing amenable spaces for gathering and learning.

## Materiality

- Formal paving and hardscape elements complement the Heritage Chapel and Core
- Formal planting and avenues to soften and complement existing heritage character and direct sightlines along the linear axis.
- Hard surfaces provide a desirable pedestrian environment while serving vehicular needs



# CHAPEL DRIVE ENTRY

Precinct Detail Plan



## Legend

- |  |                                |
|--|--------------------------------|
| 1 Vehicle turning circle with pavement upgrade | 7 Chapel forecourt             |
| 2 3m Ceremonial access path                    | 8 Communal table / deck lounge |
| 3 Feature wayfinding wall                      | 9 Integrated handball court    |
| 4 Ceremoial grove                              | 10 Terrace access              |
| 5 Widened Chapel access stair                  | 11 Covered bus bay             |
| 6 Existing rose bush planting                  | 12 Forecourt entry             |

## Key Plan

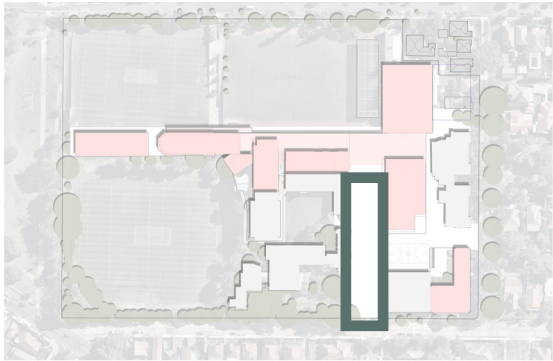



# CHAPEL DRIVE ENTRY

Section G - G





# CHAPEL DRIVE ENTRY

Isometric diagram

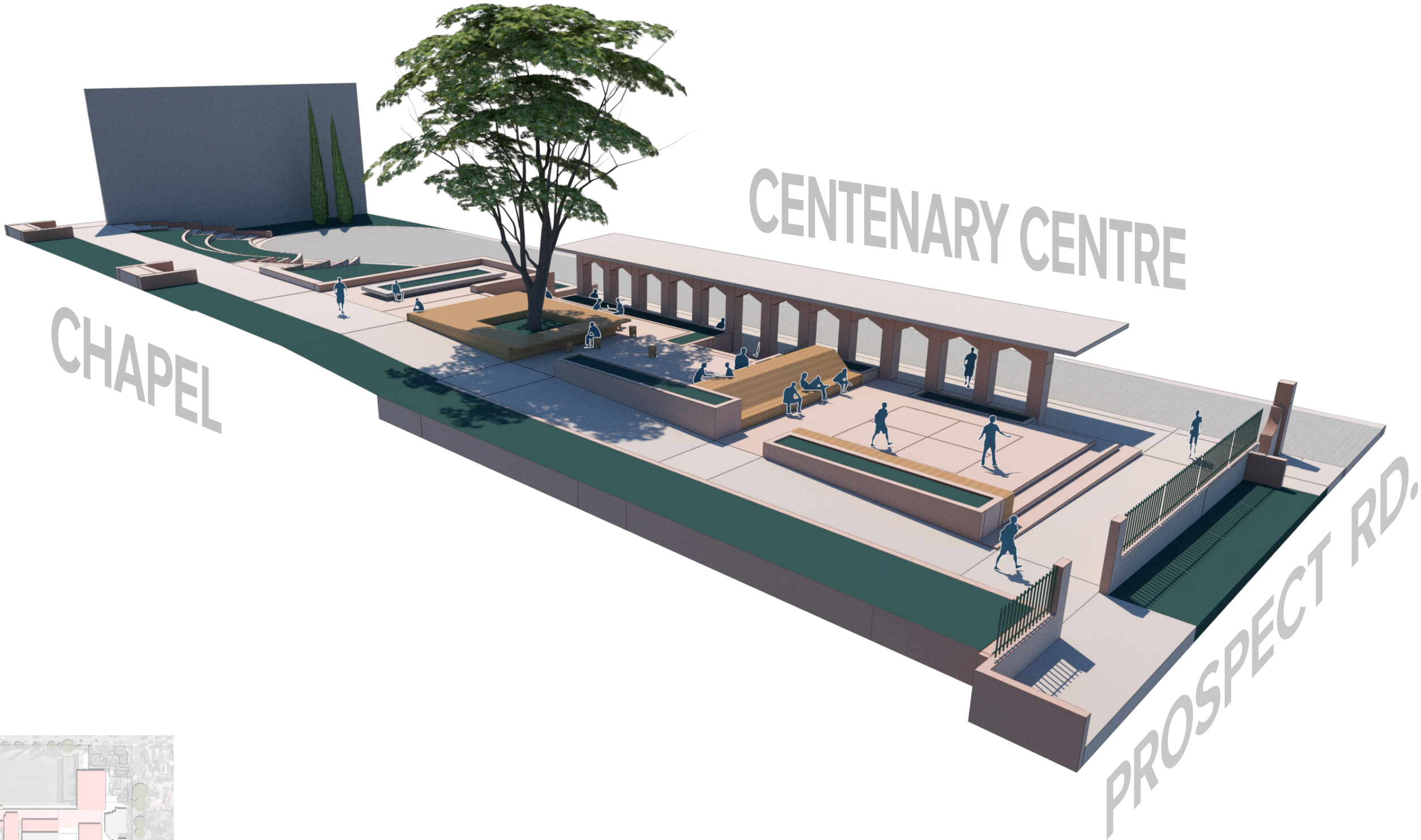

## Key Plan

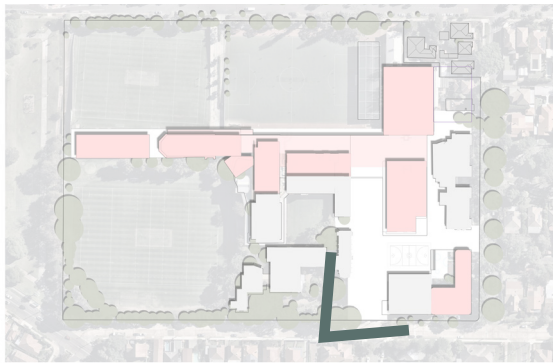



# CHAPEL DRIVE ENTRY

Isometric Diagram

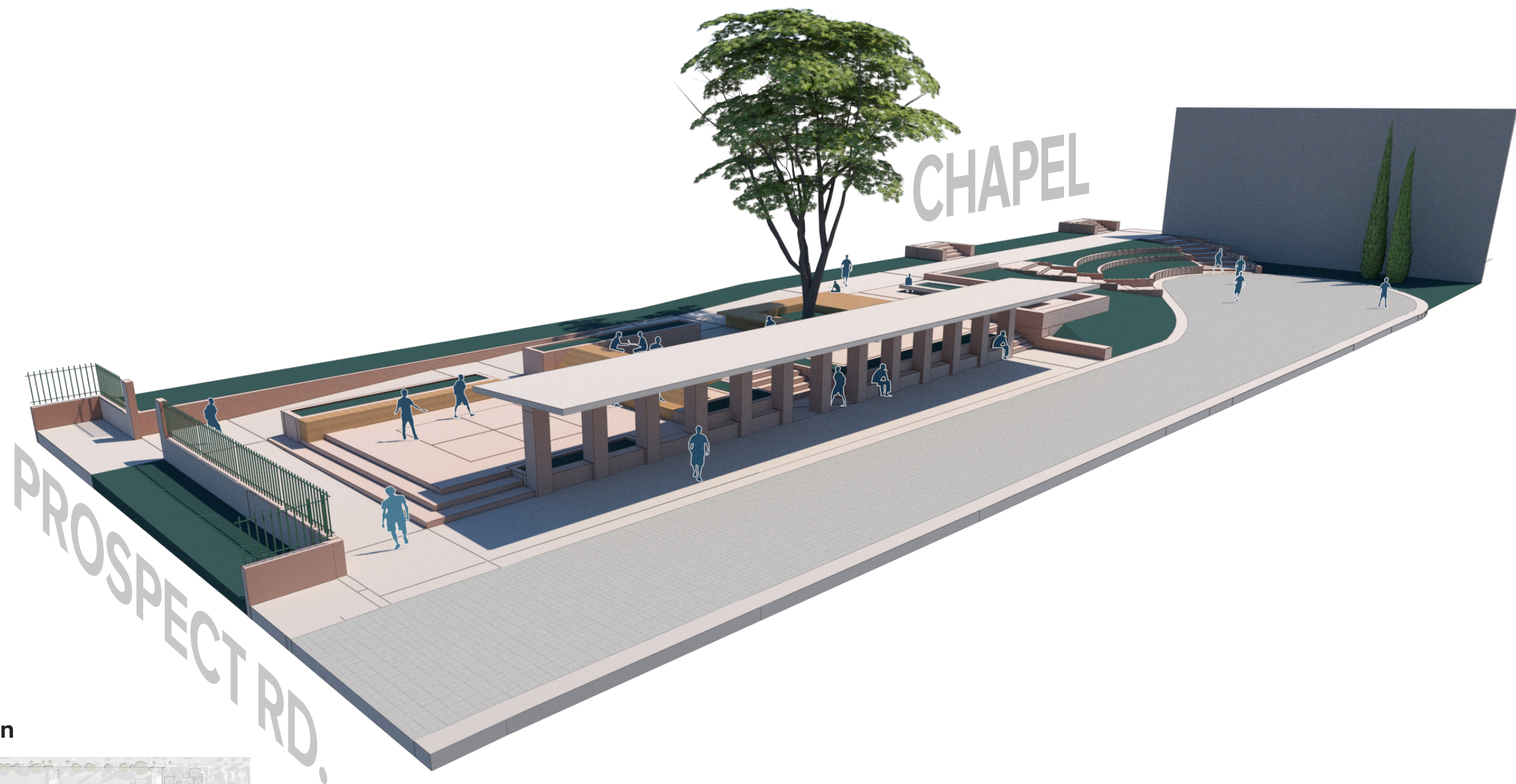

Key Plan

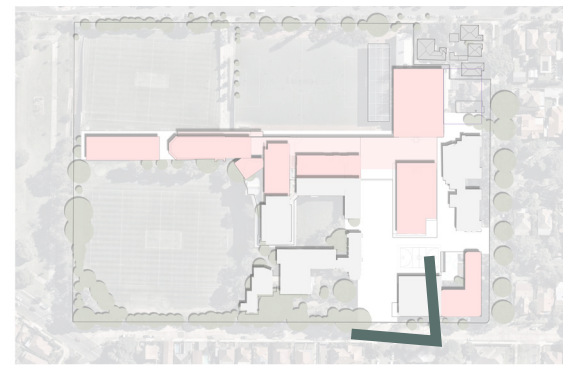



# Junior School Play

## Precinct Vision

### The Experience



### Program & Users

- Nestled at lower levels to the north of the Trinity school campus
- A playful overlay to navigate level changes.
- Outdoor learning spaces to create a healthy and green learning environment
- Dedicated age specific play spaces
- Scale elements specific to the smaller users of the school

### Character & Spatial Qualities



### Spatial Qualities

- Natural valley gully experience
- Filtered views to Seaview Street, visual connections to the Agora and Ceremonial Axis
- Multi-leveled linear pedestrian zones between the Ceremonial Axis and the Agora aiding both movement and gathering, as well as provision for service and processional vehicular access
- Shelter is provided for students moving through the space in inclement conditions while microclimatic zones are focused on providing amenable spaces for gathering and learning.

### Elements & Materiality



### Materiality

- Natural materials and permeable paving to soften forms
- Native informal planting
- Mounded lawns for relaxation and imaginative play
- Educational gardens for agricultural learning
- Colourful play surfaces within gym playground



# Junior School Play

## Precinct Detail Plan

### Legend

- 1 Connection to senior school & carpark
- 2 Buffer planting to edges of play area
- 3 Open lawn space
- 4 Passive learning/seating area
- 5 Nature trail journey with interactive balance beams, stepped logs, etc
- 6 Vegetable patch
- 7 Art space with flexible seating, tables and an interactive art wall
- 8 Play embankment with slides and various climbing features
- 9 Raised decking platforms
- 10 Existing trees
- 11 Fountain to surround existing tree
- 12 Assembly area with amphitheatre seating (300 students)
- 13 Monkey bar arrangement
- 14 At grade handball courts
- 15 Play/Veggie garden storage shed
- 16 Access to Main Switchboard
- 17 Multiuse sports/fitness screen

### Key Plan

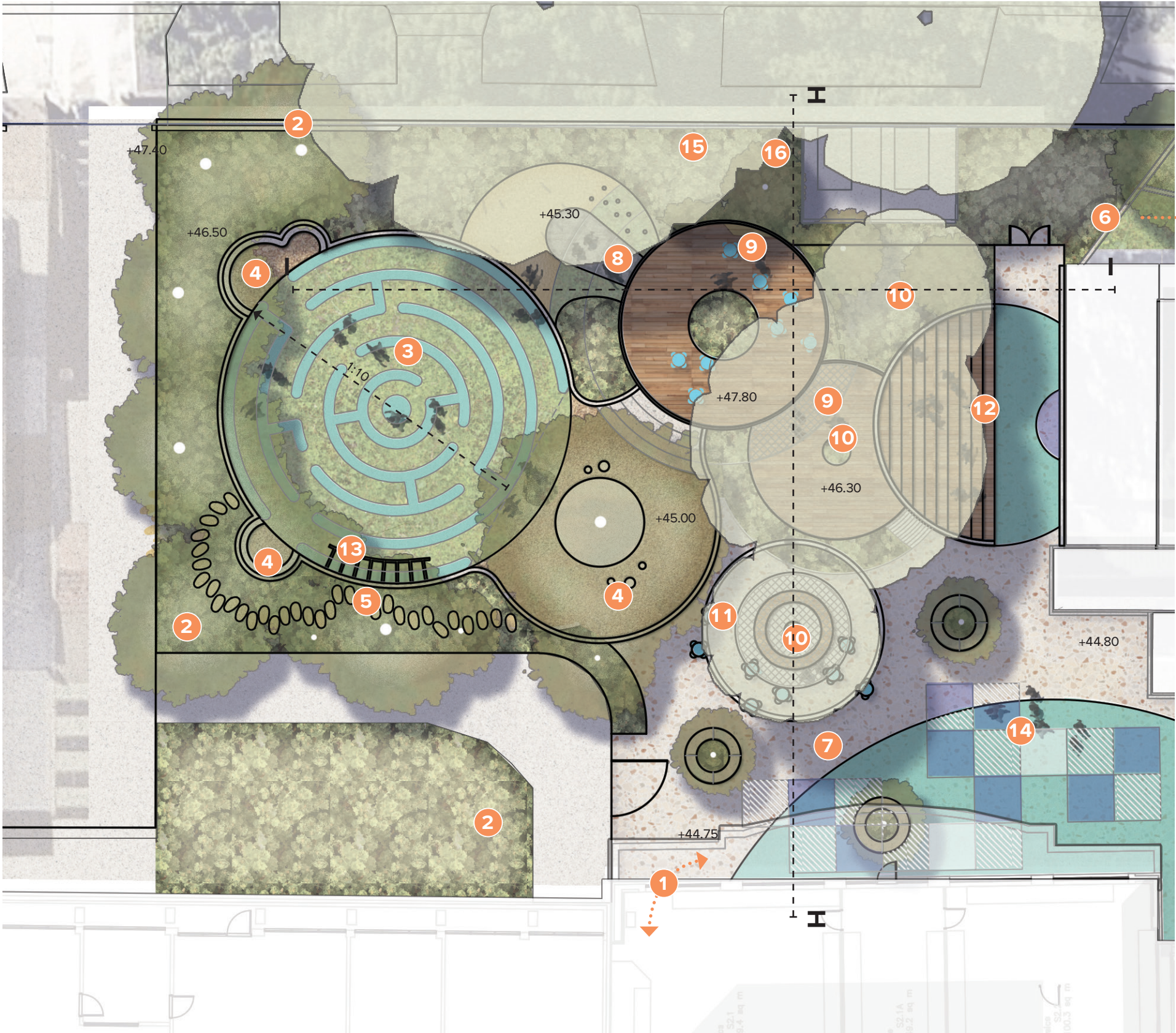
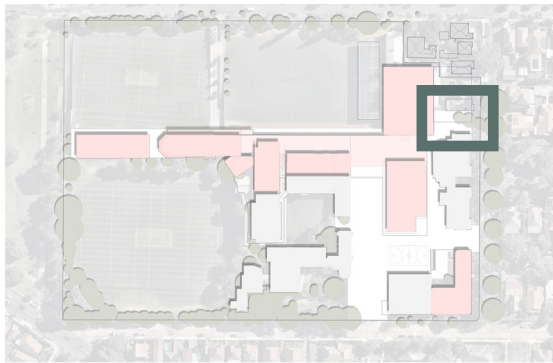



# Junior School Play

Section H - H



1:100 @ A3



# Junior School Play

Section I-I



1:100 @ A3



## 2.0 LANDSCAPE STRATEGIES



# Hardscape Palette



## KEY

- 1 Precast concrete furniture with timber fixtures
- 2 In situ concrete elements
- 3 Feature clay paving
- 4 Coloured concrete with exposed aggregate

- 5 Feature granite paving
- 6 Play surfaces with artificial turf features
- 7 Decomposed granite



# Planting Strategies

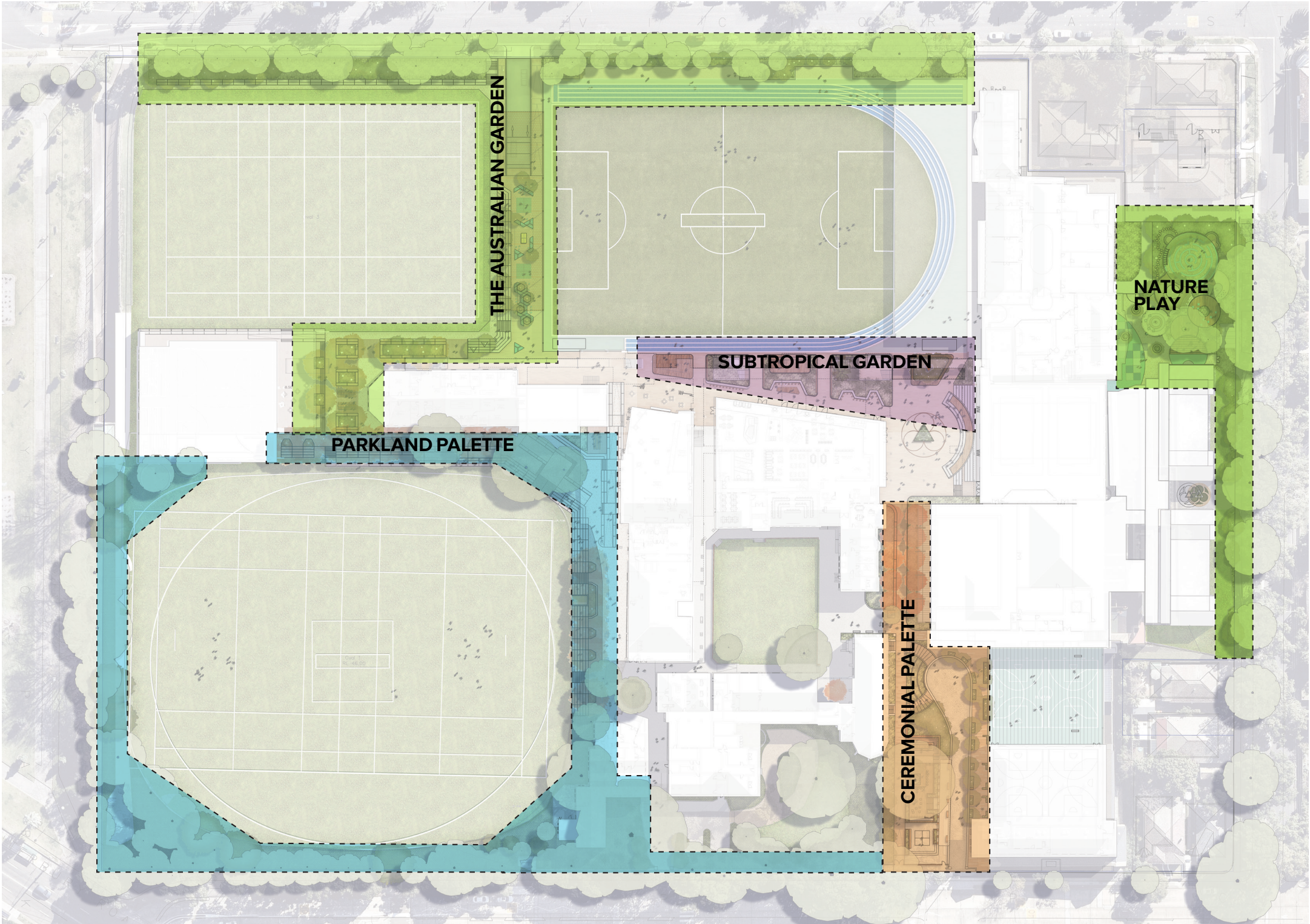



# Planting palette

## Formal Planting

### TREES



*Betula pendula*



*Cupressus sempervirens 'glauca'*



*Lagerstromia indica*



*Magnolia grandiflora*

### SHRUBS + CLIMBERS



*Backea imbricata*

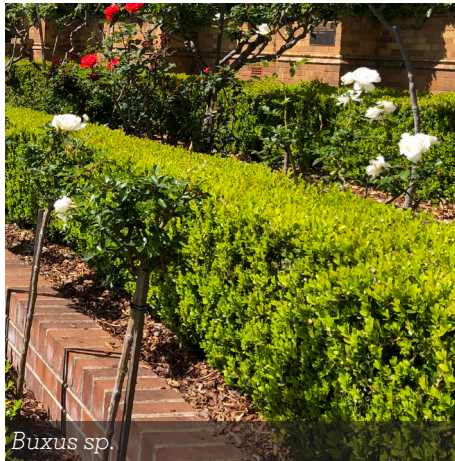

*Buxus sp.*



*Camellia japonica*



*Eremopholia nivea*



*Tuecium fruticans*



*Hedera helix*

### GROUNDCOVERS



*Dichondra repens 'Silver Falls'*



*Lavandula ssp.*



*Salvia rosmarinus*



*Santolina chamaecyparissus*



*Liriope muscari*



*Stachys lanata*



# Planting palette

Subtropical Planting

## UNDERCROFT TREES



*Dicksonia antarctica*



*Cyathea australis*



*Davidsonia pruriens*



*Licuala ramsayi*

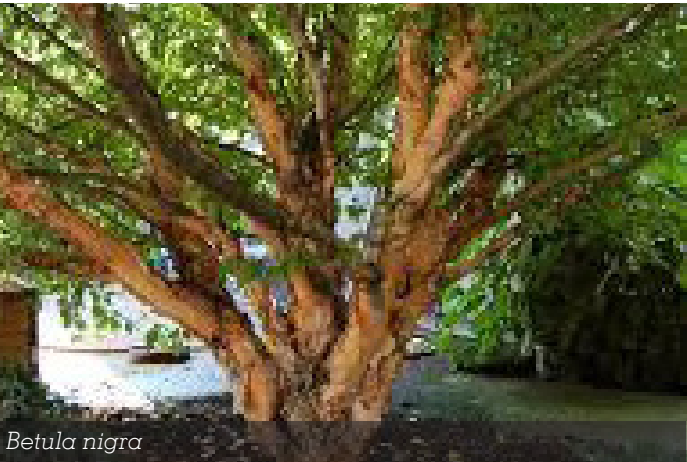

*Betula nigra*

## UNDERCROFT SHRUBS + GROUNDCOVERS



*Asplenium australasicum*



*Casuarina glauca*



*Dianella caerulea*



*Liriope muscari*



*Zoysia spp.*

## VERTICAL PLANTING

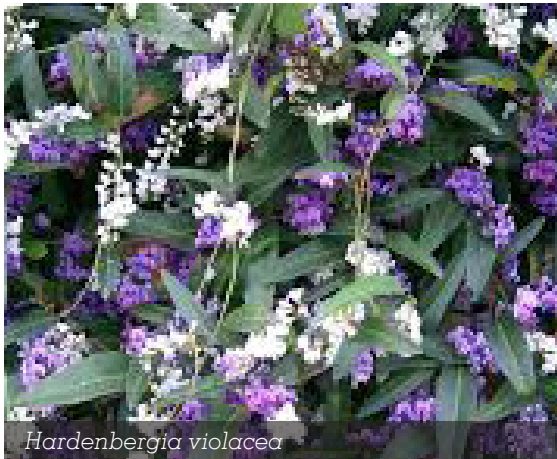

*Hardenbergia violacea*



*Cissus antarctica*



*Thunbergia grandiflora*



*Hedera helix*



# Planting palette

Parkland

## TREES



*Agathis robusta*



*Corymbia ficifolia*



*Fagus sylvatica*



*Fraxinus oxycarpa raywoodii*



*Quercus rubra*

## SHRUBS, GRASSES + GROUND COVERS



*Correa alba*



*Eremopholia nivea*



*Raphiolepis indica*



*Liriope muscari*



*Lomandra 'Tanika'*



*Pennisetum alopecuroides*

## RAIN GARDENS



*Hibbertia scandens*



*Santolina chamaecyparissus*



*Hedera helix*



*Carex appressa*



*Dianella caerulea*



*Isoplepis nodosa*



# Planting palette

Nature Play

## TREES

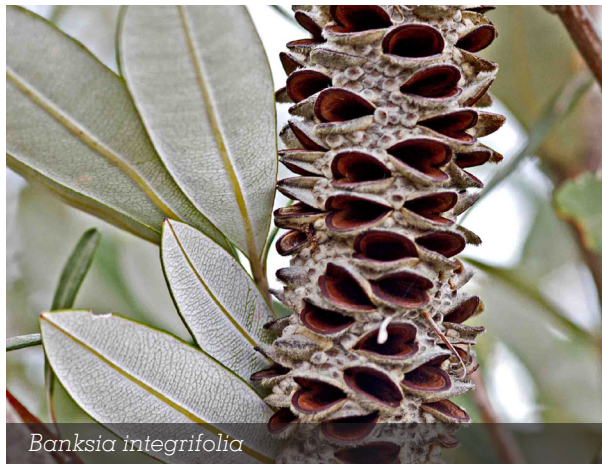

## SHRUBS + GRASSES

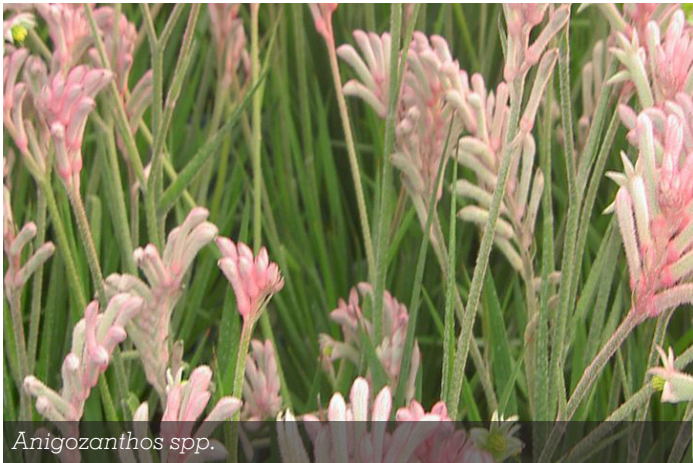

## GROUNDCOVERS





# Planting palette

Australian Garden

## TREES



## SHRUBS



## GROUNDCOVERS

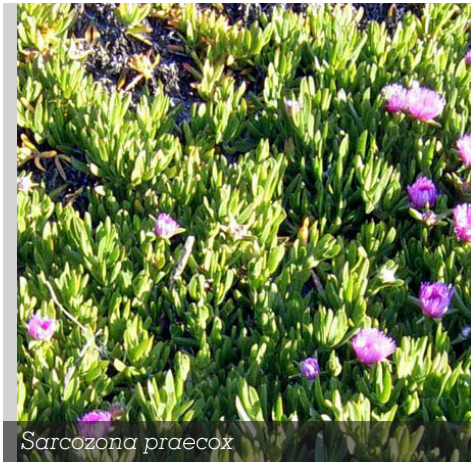



# The Town Gown - The Street Address

Street Perspective Diagrams

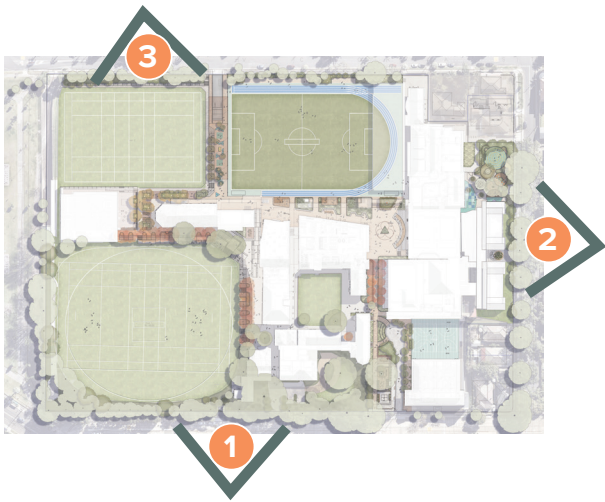

Prospect Road



Seaview Street



Victoria Street



ARCADIA