

1 HOSPITAL ROAD - LONG SECTION_LOOKING EAST
108-B100001 1 : 200



1 HOSPITAL ROAD - LONG SECTION_LOOKING WEST
SK-UNSW-11B-010001: 200

CLIENT



CONSTRUCTION MANAGER



PROJECT

RANDWICK CAMPUS

REDEVELOPMENT

BARKER ST

RANDWICK NSW 2031

AUSTRALIA

BVN PROJECT NUMBER

s1606008

KEY PLAN

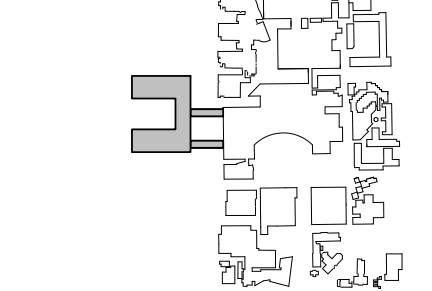

TRUE NORTH

PROJECT NORTH



SCALE

1:2000#B1

DO NOT SCALE

STATUS

DESIGN DEVELOPMENT

DRAWING

HOSPITAL ROAD WORKS -
SECTIONS - SHEET 3

ROR-BVN-ARC-00-DRAW-

12D-NL00002

ISSUE

B

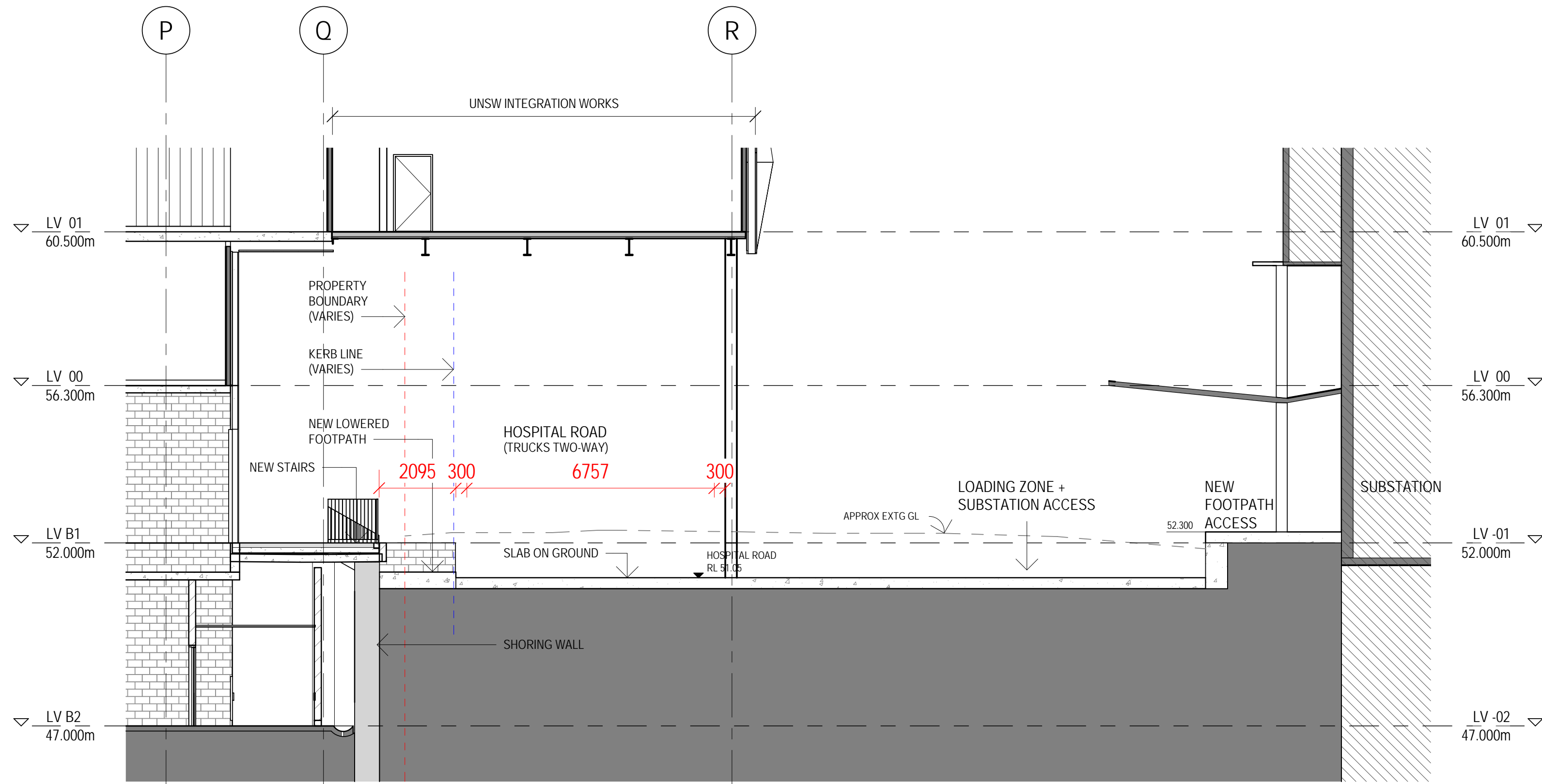

1 HOSPITAL ROAD - SECTION WOMEN'S HOSPITAL LOADING DOCK
1 : 100

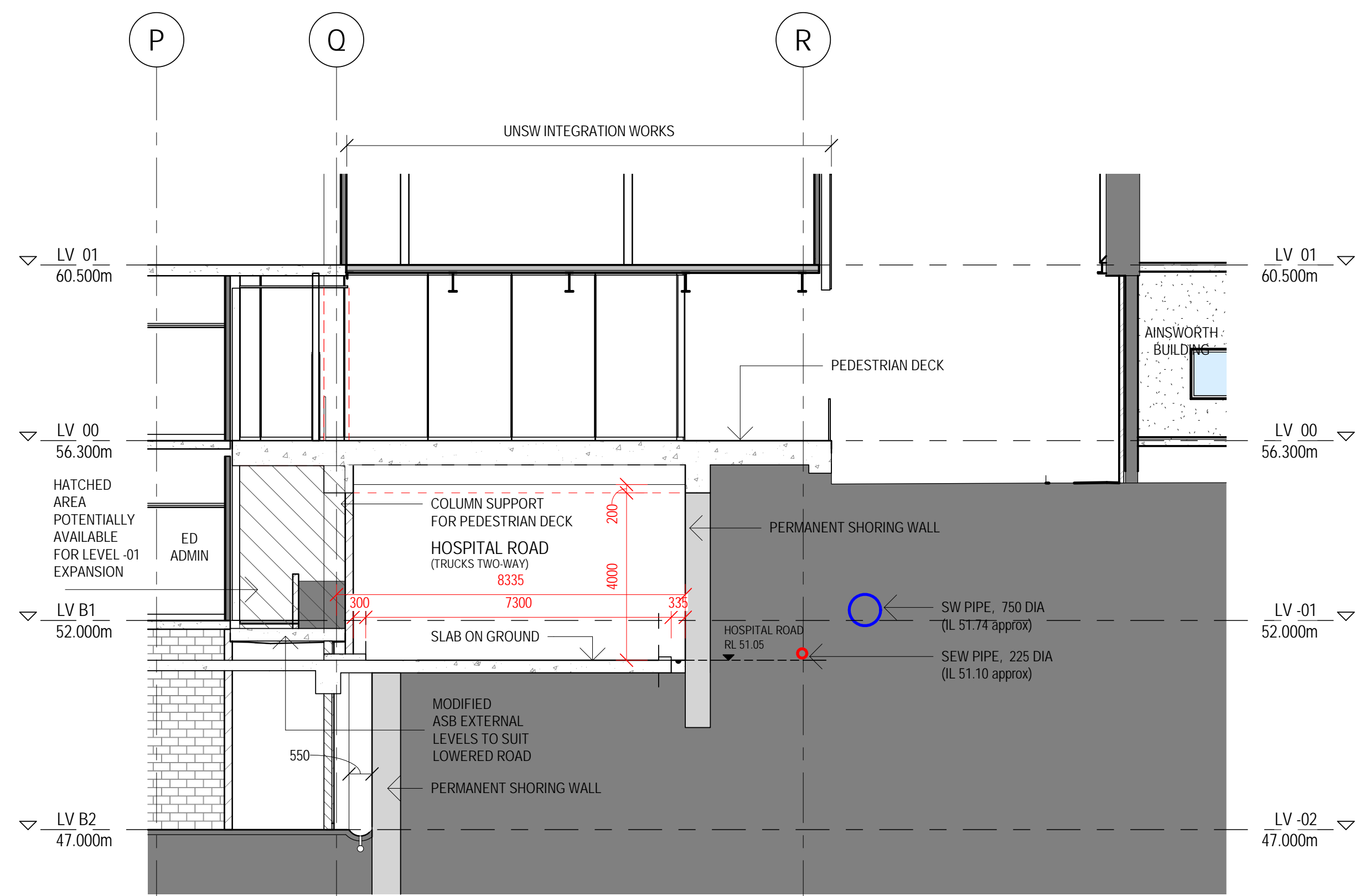

2 HOSPITAL ROAD - SECTION AINSWORTH
1 : 100

CLIENT



CONSTRUCTION MANAGER



PROJECT
RANDWICK CAMPUS
REDEVELOPMENT
BARKER ST
RANDWICK NSW 2031
AUSTRALIA
BVM PROJECT NUMBER

s1606008

KEYPLAN

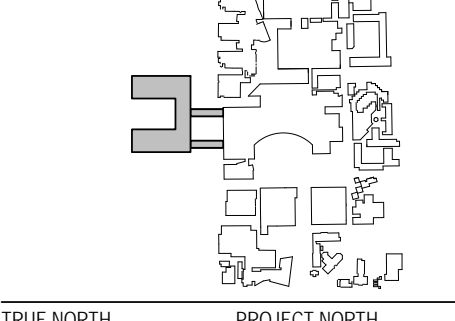

TRUE NORTH PROJECT NORTH

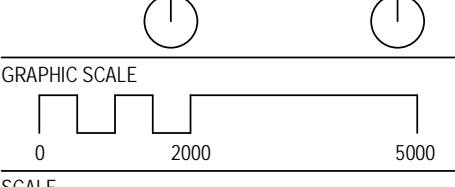

1 : 1000#B1 DO NOT SCALE
STATUS

DESIGN DEVELOPMENT
DRAWING

HOSPITAL ROAD WORKS -
SECTIONS - SHEET 4

RCR-BVN-ARC-00-DRW-
12D-NL000003

ISSUE
B

Legend:

Exclusions

The following areas are excluded from the Stage 1 Hospital Road lowering works:

- Landscaping to public deck
- Interface zone between new public deck and existing Ainsworth Building
- Future lowering works north of Stair 10

Associated documents

Read in conjunction with:

- UNSW East Integration drawings
- Services and structural engineer's drawings

Key

Fire separation wall. 2hr Fire rating assumed

INTELLECTUAL PROPERTY

COPYRIGHT BVN ARCHITECTURE PTY LIMITED. UNLESS OTHERWISE AGREED IN WRITING, ALL RIGHTS TO THIS DOCUMENT ARE SUBJECT TO PAYMENT IN FULL OF ALL BVN CHARGES. THIS DOCUMENT MAY ONLY BE USED FOR THE EXPRESS PURPOSES AND PROJECT FOR WHICH IT HAS BEEN CREATED AND DELIVERED AS NOTIFIED IN WRITING BY BVN. ANY UNAUTHORIZED USE OF THIS DOCUMENT IS AT THE USER'S SOLE RISK AND WITHOUT LIMITING REMEDIES, THE USER RELEASES AND INDEMNIFIES BVN FROM AND AGAINST ALL LOSS OR ARISING.

NOTE

CONTRACTOR TO CHECK AND VERIFY ALL DIMENSIONS ON SITE PRIOR TO COMMENCEMENT OF WORKS OR PREPARATION OF SHOP DRAWINGS. DO NOT SCALE THIS DRAWING.

ISSUE DATE FOR
A 2012/18 FOR INFORMATION

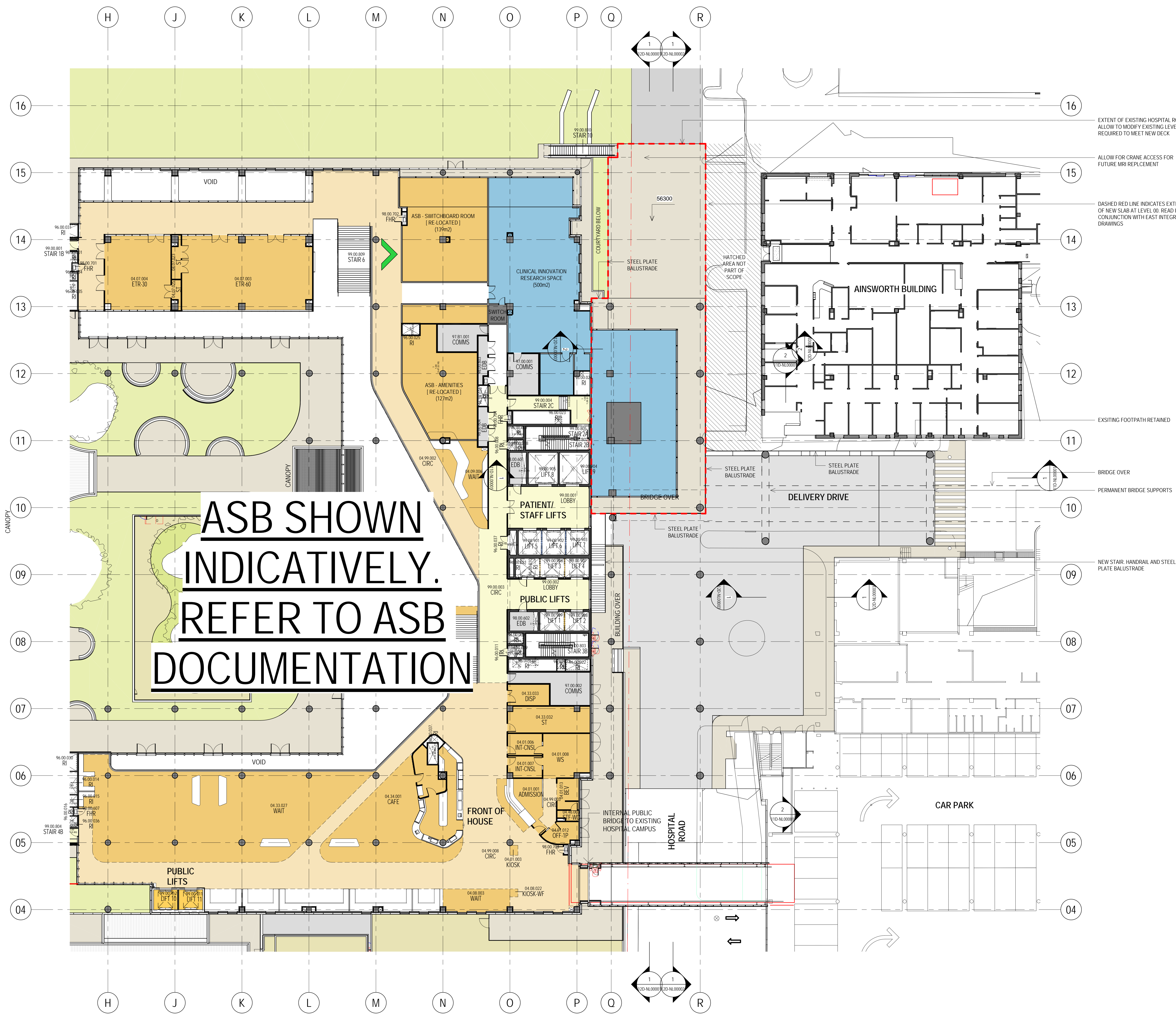

EXTENT OF EXISTING HOSPITAL ROAD. ALLOW TO MODIFY EXISTING LEVELS AS REQUIRED TO MEET NEW DECK

ALLOW FOR CRANE ACCESS FOR FUTURE MRI REPLACEMENT

DASHED RED LINE INDICATES EXTENT OF NEW SLAB AT LEVEL 00. READ IN CONJUNCTION WITH EAST INTEGRATION DRAWINGS

EXISTING FOOTPATH RETAINED

BRIDGE OVER

PERMANENT BRIDGE SUPPORTS

NEW STAIR, HANDRAIL AND STEEL PLATE BALUSTRADE

CLIENT



CONSTRUCTION MANAGER



PROJECT

ASB/UNSW EAST INTEGRATION
e.g. 255 PITT STREET,
SYDNEY NSW
AUSTRALIA

BVN PROJECT NUMBER

s1606008

KEYPLAN

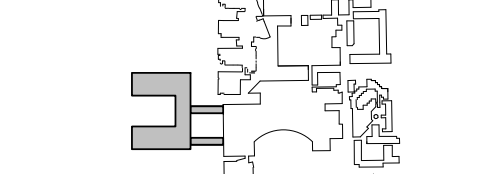

TRUE NORTH

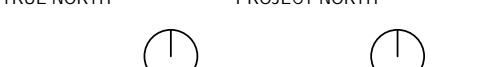

GRAPHIC SCALE



SCALE

1:2000/81

STATUS

DESIGN DEVELOPMENT

DRAWING

HOSPITAL ROAD WORKS - LEVEL 00

RCR-BVN-ARC-00-DRW.

11B-0000001

ISSUE A

Legend:

Exclusions

- The following areas are excluded from the Stage 1 Hospital Road lowering works:
- Landscaping to public deck
 - Interface zone between new public deck and existing Ainsworth Building
 - Future lowering works north of Stair 10

Associated documents

- Read in conjunction with:
- UNSW East Integration drawings
 - Services and structural engineer's drawings

Key

- Fire separation wall. 2hr Fire rating assumed

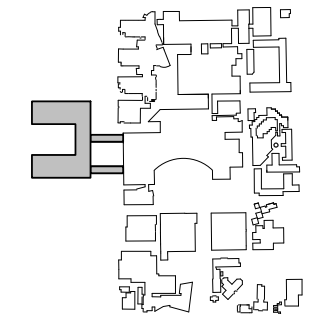
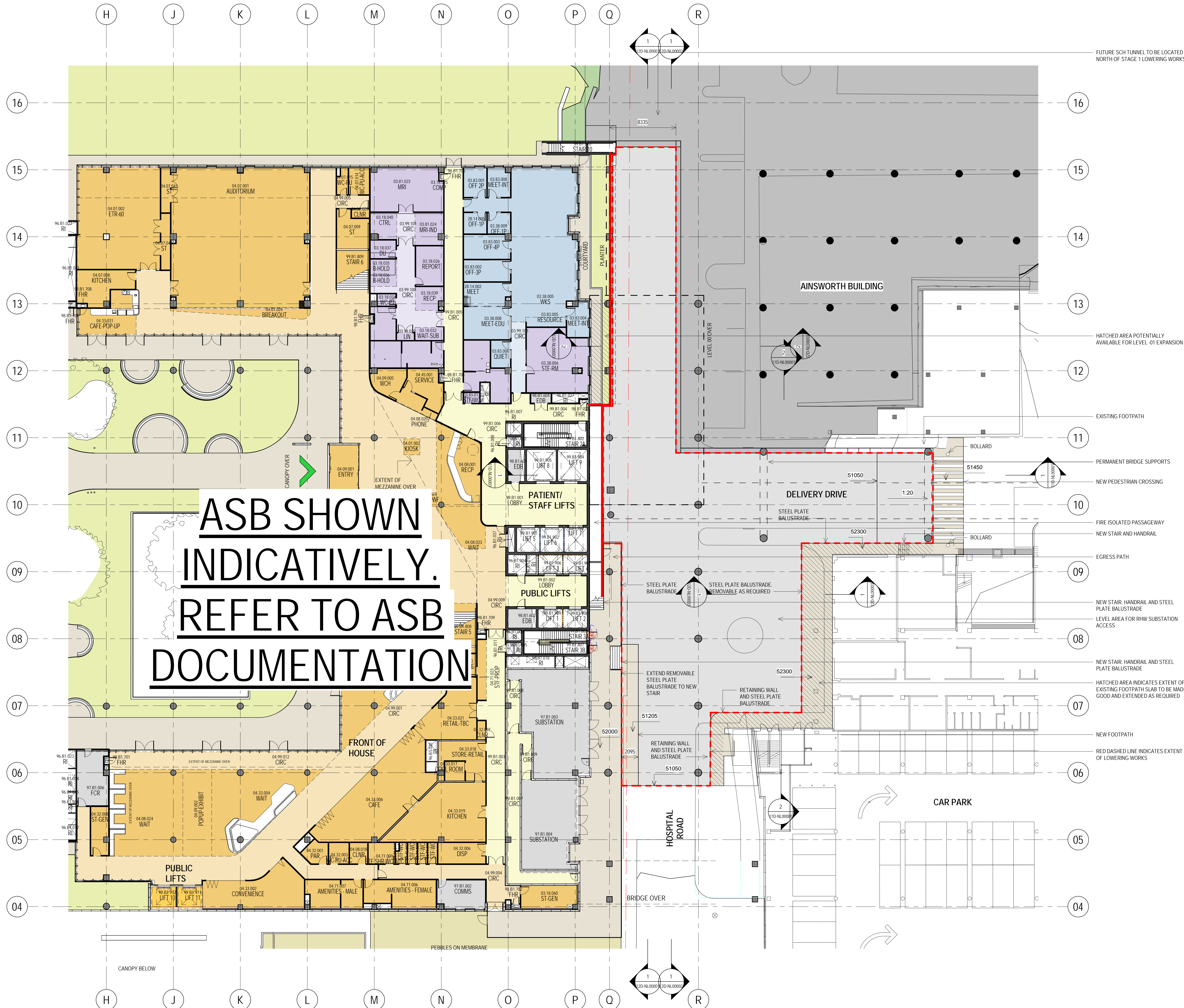

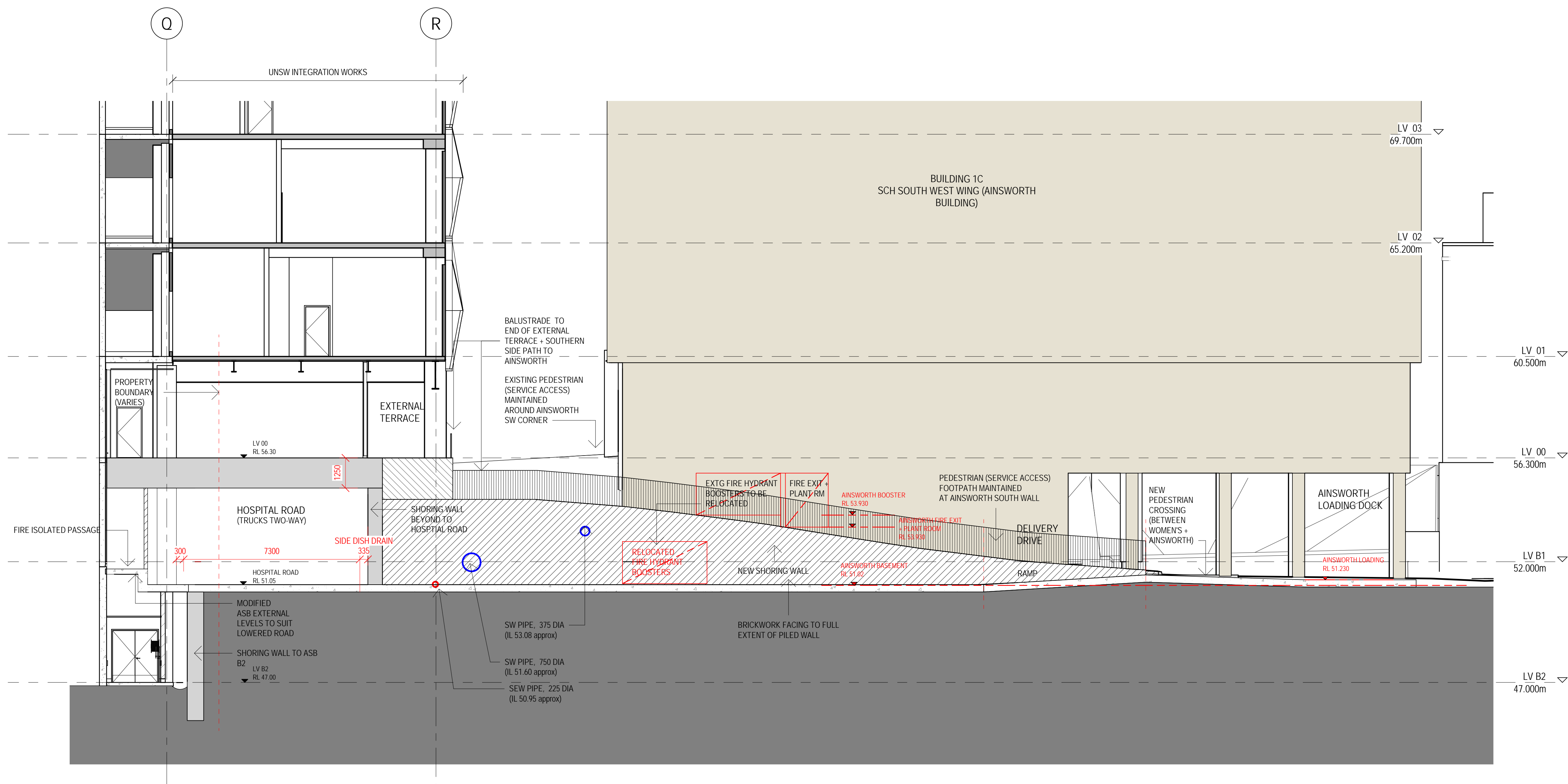

1 HOSPITAL ROAD - SECTION_AINSWORTH SOUTH ELEVATION
1 : 100

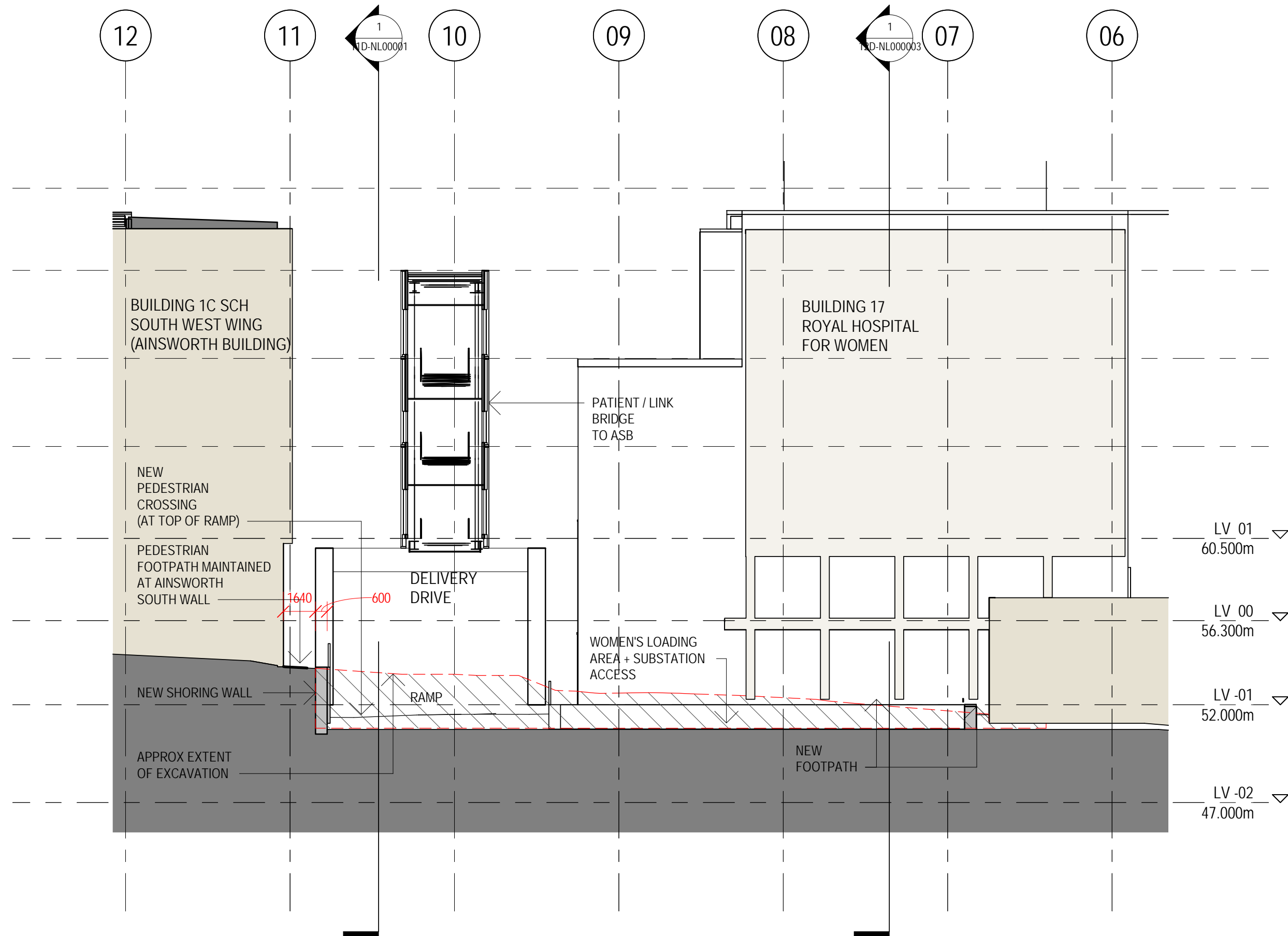

2 DELIVERY DRIVE - SECTION_AINSWORTH + WOMEN'S
1 : 200

CLIENT



CONSTRUCTION MANAGER



PROJECT

RANDWICK CAMPUS
REDEVELOPMENT
BARKER ST
RANDWICK NSW 2031
AUSTRALIA

BVN PROJECT NUMBER

s1606008

KEYPLAN

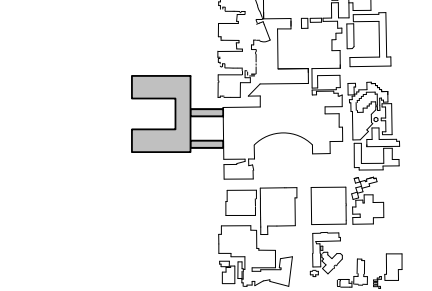

TRUE NORTH PROJECT NORTH

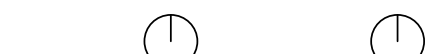

SCALE

As indicated @B1 DO NOT SCALE

STATUS

DESIGN DEVELOPMENT

DRAWING

HOSPITAL ROAD WORKS -
SECTIONS - SHEET 1

RCR-BVN-ARC-00-DRAW- ISSUE

11D-NL00001 B