



stanton dahl
architects

PO Box 833 Epping
NSW 1710, Australia
Tel +61 2 8876 5300
Fax +61 2 9868 2624
design@stantondahl.com.au
www.stantondahl.com.au

Waste Management Plan

State Significant Development Application

Project International Chinese School
211 Pacific Highway, St. Leonards NSW
Job No 2417.19
Date May 2019

Introduction

This Waste Management Plan has been prepared for the proposed International Chinese School in support of the project's State Significant Development Application submitted to the Department of Planning & Infrastructure.

This plan outlines a general approach to waste management for the site and processes to be implemented for construction of the new school campus, and ongoing management of waste for the School. All statements and proposals documented in this plan are preliminary. The Waste Management Plan will be reviewed at the time of the awarding of the contract for the works to ensure alignment with the proposed methodologies, staging and sequencing of the preferred Contractor, and also by the School in the preparation of their waste management policy for the campus.

The Proposal

The Project comprises the fitout of an existing commercial premises to create a new K-6 school and outdoor playing area. The School is proposed within one stand-alone two storey building located at 211 Pacific Highway, St. Leonards. Actual construction works proposed comprise a new kiss & drop zone with a capital investment value of \$180,000.00.

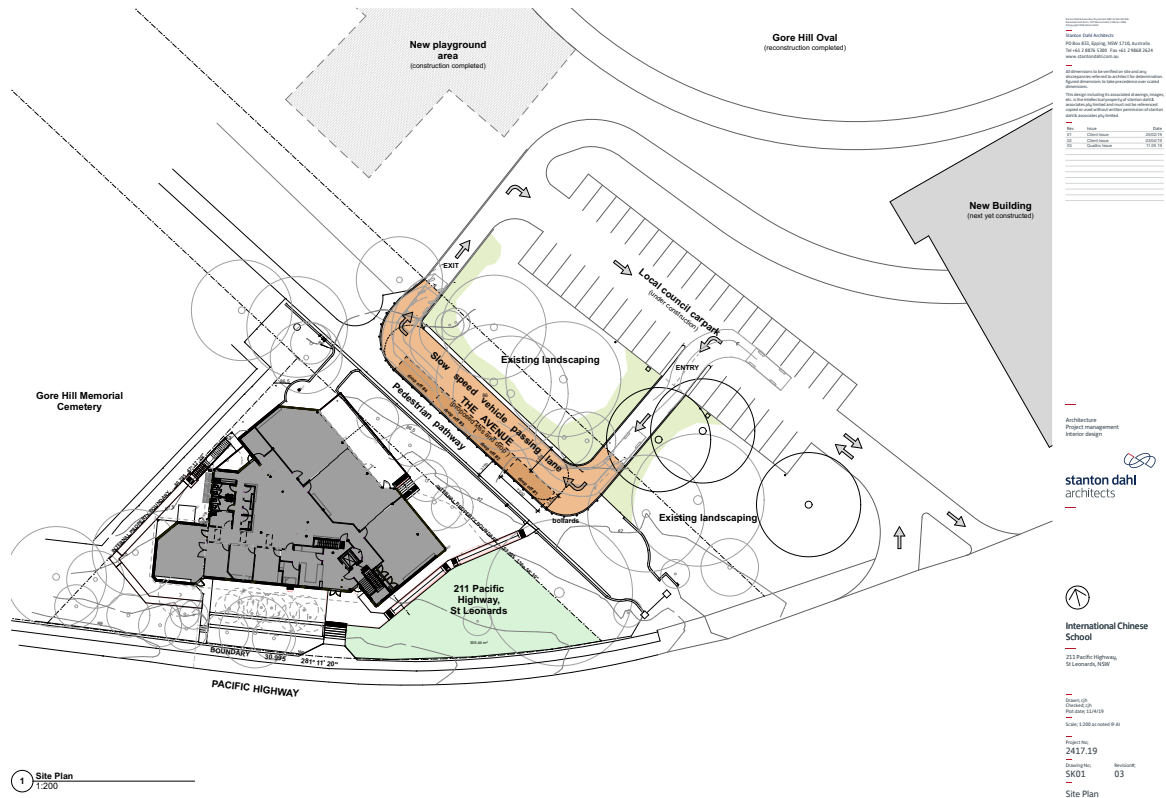



Demolition Stage

(Kiss & Drop Works)

Materials on Site		Destination		
		Reuse and Recycling		Disposal
Type of Material	Estimated Quantity	On-Site	Off-Site	
Excavation Material	15m ³	N/A	<u>Bitumen Paving, Kerbs & subgrade material:</u> Remove from site to be recycled.	Skip Bin Bingo Industries* T. 1 300 424 646
Green Material	295m ²	N/A	<u>Garden Mulch & Planting:</u> Remove from site to be recycled.	Skip Bin Bingo Industries* T. 1 300 424 646
Bricks	90 m ²	<u>Heritage brick paving & dish drains:</u> Building Contractor to store on-site for re-use & reinstatement as per Heritage Report.	N/A	N/A
Concrete	Vide 'Excavation Material'	N/A	N/A	N/A
Timber	N/A	N/A	N/A	N/A
Plasterboard	N/A	N/A	N/A	N/A
Metals	N/A	N/A	N/A	N/A
Other	N/A	N/A	N/A	N/A

Note: *skip bin contractor may change at time of construction due to price and / or availability

Construction Stage

(Kiss & Drop Works)

Materials on Site		Destination		
		Reuse and Recycling		Disposal
Type of Material	Estimated Quantity	On-Site	Off-Site	
Excavation Material	See 'Demolition Stage'	N/A	N/A	N/A
Green Material	See 'Demolition Stage'	N/A	N/A	N/A
Bricks	To be confirmed	Offcuts and waste to be re-used for fill where appropriate.	Surplus material to be removed from site for recycling. Building Contractor	Skip Bin Bingo Industries* T. 1 300 424 646



			to specify recycling subcontractor.	
Concrete	To be confirmed	Waste to be re-used for fill where appropriate.	Surplus material to be removed from site for recycling. Building Contractor to specify recycling subcontractor.	Skip Bin Bingo Industries* T. 1300 424 646
Timber	To be confirmed		Offcuts and waste material to be removed from site for recycling. Building Contractor to specify recycling subcontractor.	Skip Bin Bingo Industries* T. 1300 424 646
Plasterboard	N/A	N/A	N/A	N/A
Metals	N/A	N/A	N/A	N/A
Plastics	N/A	N/A	N/A	N/A
Other	N/A	N/A	N/A	N/A
Note: *skip bin contractor may change at time of construction due to price and / or availability				

Use of Premises

(School Premises)

Type of Waste to be Generated	Expected Volume per Week With MAX 210 students	Proposed On-Site Storage and Treatment Facilities	Destination
<u>Recyclables:</u>			
Cardboard Paper	1000 litres	240 litre bins located in appropriate internal and outdoor areas.	Collection by Council Waste Contractor or private contractor appointed by the School.
Mixed Recycling Glass Bottles Plastic Bottles	200 litres	240 litre bins located in appropriate locations for re-use.	Collection by Council Waste Contractor or private contractor appointed by the School.
Mixed Recycling Glass Bottles Plastic Bottles	200 litres	Store in suitable receptacles in appropriate locations for re-use.	Collection by Council Waste Contractor or private contractor appointed by the School.
<u>Non-Recyclables:</u>			
Food Waste Non-recyclable Waste	To be confirmed	Waste receptacles located in strategic areas throughout the school & 240 litre bins located in appropriate internal and outdoor areas.	Collection by Council Waste Contractor or private contractor appointed by the School.



Ongoing Waste Management

(School Premises)

The management of waste will consist of the education of staff at induction to outline the schools site procedures in waste management. Permanent bin storage area will be allocated, and scheduled waste pick up will be adopted by using Councils standard pick up service.

Waste will be managed on site with a dedicated bin storage area. To minimize the amount of landfill the school generated waste will be sorted into mixed recycling, paper / cardboards, green waste and general waste receptacles. Any hazardous waste or chemicals will be required to be disposed of in accordance with Local Government and EPA regulations.

Management of waste is the responsibility of the school's operation staff via;

- Developing waste disposal working procedures.
- Monitoring the waste procedure at the school.
- Ensuring that all waste related accidents on site are contained, cleaned up and dealt with appropriately.
- Minimising the amount of waste generated at the school.
- Ensuring that all waste is sorted correctly.
- Ensuring that the waste is disposed of with detrimental effects on the neighboring area.
- Ensuring that waste is removed at the appropriate times and that waste disposal activities are conducted without impacting the surrounding neighbourhood.