



- | | | |
|------------------------------------|--|---------------------------------------|
| 1 Kiosk | 10 Green Avenue | 19 High School Tiered Seating / COLA |
| 2 Traffic Gate | 11 Car parking area | 20 Access Path |
| 3 Overall Catholic Precinct Sign | 12 Primary School Oval | 21 School Basketball Court & New COLA |
| 4 Pedestrian Crossing | 13 Intermediate Space for Flexible Use | 22 Pedestrian Access |
| 5 Pedestrian Access | 14 After-hours Hall Entry | 23 Detention Basin |
| 6 Primary School Main Entry | 15 Primary School Basketball Court | 24 Car Access with Removable Bollards |
| 7 McAuley Rose Garden | 16 Existing tree with seating around | 25 Gas Tank |
| 8 Early Learning Centre Main Entry | 17 Primary School Natural Garden | 26 Loading zone |
| 9 Staff Breakout Area | 18 High School Breakout Courtyard | 27 Bicycle Parking |

- | | |
|---------------------------------|---------------------------------|
| 28 Fire Trail | SEPP 14 wetlands |
| 29 High school main entry | Creek Flood Lin |
| 30 Library seating space | Creek top of bank |
| 31 Primary school sports field | Power lines |
| 32 High school sports field | 1:100 Year flood line |
| 33 Car park overflow area | 50m Asset Protection Zone |
| 34 Synthetic turf assembly area | Existing Vegetation Trunk Line |
| 35 Central landscape space | Existing Vegetation Canopy Line |
| 36 Shade structure & sail | |

- | |
|------------------------|
| Light pole |
| Water/irrigation tanks |

- | | |
|---------------------------------|--------------------------------|
| Boundary Line | Existing trees removed |
| Barrier Fence/ Gate | Existing trees to be retained |
| Fencing Around Basin For Safety | Proposed large trees |
| Feature paving | Proposed medium trees |
| Concrete paving | Proposed small to medium trees |
| Rubber softfall/play mulch | tree no 36 to be removed |
| Open lawn | Proposed replacement trees |
| Synthetic turf | |
| Seeded turf | |
| Basin | |
| Mass planting | |



Construction Asset Protection Zones for vegetation
Excepting the re vegetated riparian corridor has
been determined in accordance with AS 3959-2009
Method 1 (refer to Bushfire Assessment Report).
Riparian corridor planting refer to Vegetation
Management Plan (by Biosis on 29 Mar 19)

- New tree no. 1

Angophora costata
At Time of Planting (100L Pot Size): Height: 2.5 to 3.5 metres
At Maturity: Height: 15 to 25 metres Canopy Spread: 8-15metres
- New tree no. 2

Glochidion ferdinandi
At Time of Planting (100L Pot Size): Height: 2.0 to 2.5 metres
At Maturity: Height: 8 to 12 metres Canopy Spread: 10 metres

Two replacement trees for Tree No. 36 have been selected:
New tree no. 1: *Angophora costata* as a direct replacement, and
New tree no. 2: *Glochidion ferdinandi* (Cheese Tree), in accordance with Port Stephens Council's Biodiversity Technical Specification. The Cheese Tree is a native, medium-sized species that is low-maintenance, offers dense foliage for shade, and attracts fruit-eating birds. Both species proposed near the yarning circle to provide natural shade and ecological value. *Eucalyptus pilularis* (Blackbutt) and *Corymbia gummifera* (Red Bloodwood) were not selected due to their known risk of limb drop in public spaces.

Boundary Line

SEPP 14 wetlands

Asset Protection Zone

Existing Vegetation Trunk Line

Existing Vegetation Canopy Line

Existing trees removed

Existing trees to be retained

Proposed large trees

Proposed medium trees

Proposed small to medium trees

Existing trees to be removed

Proposed replacement trees

PROJECT:

Catherine McAuley Catholic School
Medowie, NSW.

DRAWN:

MA

DATE:

16/07/2025

SCALE:

AS SHOWN

JOB NUMBER:

13790.5

PHASE:

SD

D No:

L02

REV:

E

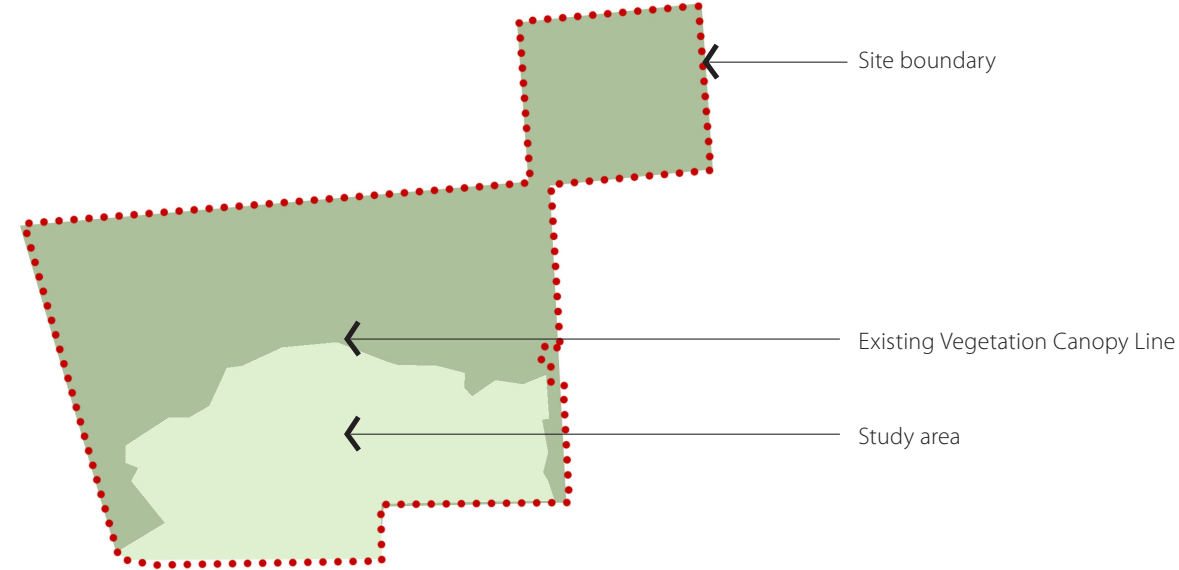

Site area	268300 m2
Study area	91400 m2
Existing tree retained	3780 m2
Existing tree remove	6520 m2
Proposed trees	23680 m2
Riparian corridor tree planting(MZ1)	1115 m2
Proposed trees + existing Trees retained+	1115 m2

PLANT SCHEDULE - CANOPY TREES

All trees supplied are to comply with NATSPEC's "Specifying Trees a guide to accessment of tree quality"

BOTANICAL NAME	COMMON NAME	MATURE HIGHT	MATURE SPREAD	POT SIZE	QUANTITY
TREES					
<i>Corymbia maculata</i>	Spotted Gum	30 m	10 m	100L	8
<i>Glochidion ferdinandi</i>	Cheese Tree	8-12 m	10 m	100L	7
<i>Quercus robur</i>	English Oak	11m	11m	200L	3
<i>Liquidamber styraciflua</i>	Sweetgum	13 m	9 m	100L	14
<i>Jacaranda mimosifolia</i>	Jacaranda	10 M	8 M	100L	8
<i>Lophostemon confertus</i>	Brush Box	12 m	6-8 m	200L	16
<i>Melaleuca quinquenervia</i>	Flax Leaved Paperbark	8-15m	5-10m	100L	5
<i>Fraxinus oxycarpa 'Raywoodii'</i>	Claret Ash	12 m	7 m	100 L	10
<i>Backhousia citriodora</i>	Lemon Myrtle	8 M	6 M	100 L	13
<i>Banksia integrifolia</i>	Coast Banksia	8-12m	4-6m	200L	11
<i>Hibiscus tiliaceus rubra</i>	Coast Cottonwood	8 m	5 m	100L	17
<i>Hymenosporum flavum</i>	Native Frangipani	6- 8 m	5-6 m	100L	8
<i>Pistacia chinensis</i>	Chinese Pistachio	8 m	6 m	100L	26
<i>Platanus orientalis 'Autumn Glory'</i>	Autumn Glory' Plane	12-15 m	6-8 m	100L	7
<i>Cupaniopsis anacardioides</i>	Tuckeroo	8 m	6 m	100L	36
<i>Elaeocarpus eumundi</i>	Blueberry Ash	8-12 m	6 m	200L	20
<i>Pyrus calleryana 'Chanticleer'</i>	Flowering Ornamental Pear	8-12 m	6 m	200L	15
<i>Brachychiton acerifolius</i>	Illawarra Flame Tree	12 M	6 M	100L	5
<i>Trisataniopsis laurina'Luscious'</i>	Water Gum	10m	5-7 m	100L	55
<i>Bauhinia variegata</i>	Orchid Tree	6-8m	6m	125 L	8
<i>Magnolia grandiflora 'Exmouth'</i>	Bull Bay Magnolia	12 m	5-8m	100L	10
<i>Magnolia grandiflora 'Little Gem'</i>	Little Gem	6M	3M	100 L	15
<i>Acer palmatum</i>	Japanese Maple	4 M	4 M	125 L	6
<i>Melaleuca linarifolia</i>	Snow In Summer	8m	4m	200L	7
<i>Eucalyptus microcorys</i>	Tallowood	30-40m	15m	200L	3
<i>Zelkova serrata 'Green Vase'</i>	Japanese Zelkova	12-15 m	8-10m	200L	9
<i>Ulmus parvifolia 'Burnley Select'</i>	Chinese Elm	8-12m	6-8m	100L	20
<i>Lagerstroemia indica</i>	Crepe Myrtle	5-8 m	3-6m	100L	18
<i>Elaeocarpus reticulatus</i>	Blueberry Ash	4- 6 m	2-3m	100L	15
<i>Fraxinus griffithii</i>	Evergreen Ash	6-8m	4m	100L	15
<i>Acer palmatum</i>	Japanese maple	4- 5 m	4m	100L	10
<i>Brachychiton acerifolius</i>	Flame tree	12 m	6m	200L	11
<i>Angophora costata</i>	Smooth-barked Apple	15-25 m	8-15 m	100L	1

Total Number of trees 432

Tree canopy covered 31.30% in Study Area. Tree planting has been increased along Medowie Road frontage & car parks, and also within the campus. Refer to landscape planting plan for details.

As the asset protection zones (APZ) is within the boundaries of the development site, landscape tree planting need comply with section 4.1.3 and Appendix 5 of 'Planting for Bush Fire Protection 2006'. Standards for Asset protection zones refer to NSW Rural Fire Service SSD 8989 & Bushfire Assessment Report. No canopy is touching within the APZ zone.

The revised planting schedule is intended to supersede the previously approved schedule. The updates reflect recommendations provided by the consulting ecologist (Biosis) and align with the latest requirements of the Port Stephens Council Biodiversity Technical Specification (2024).

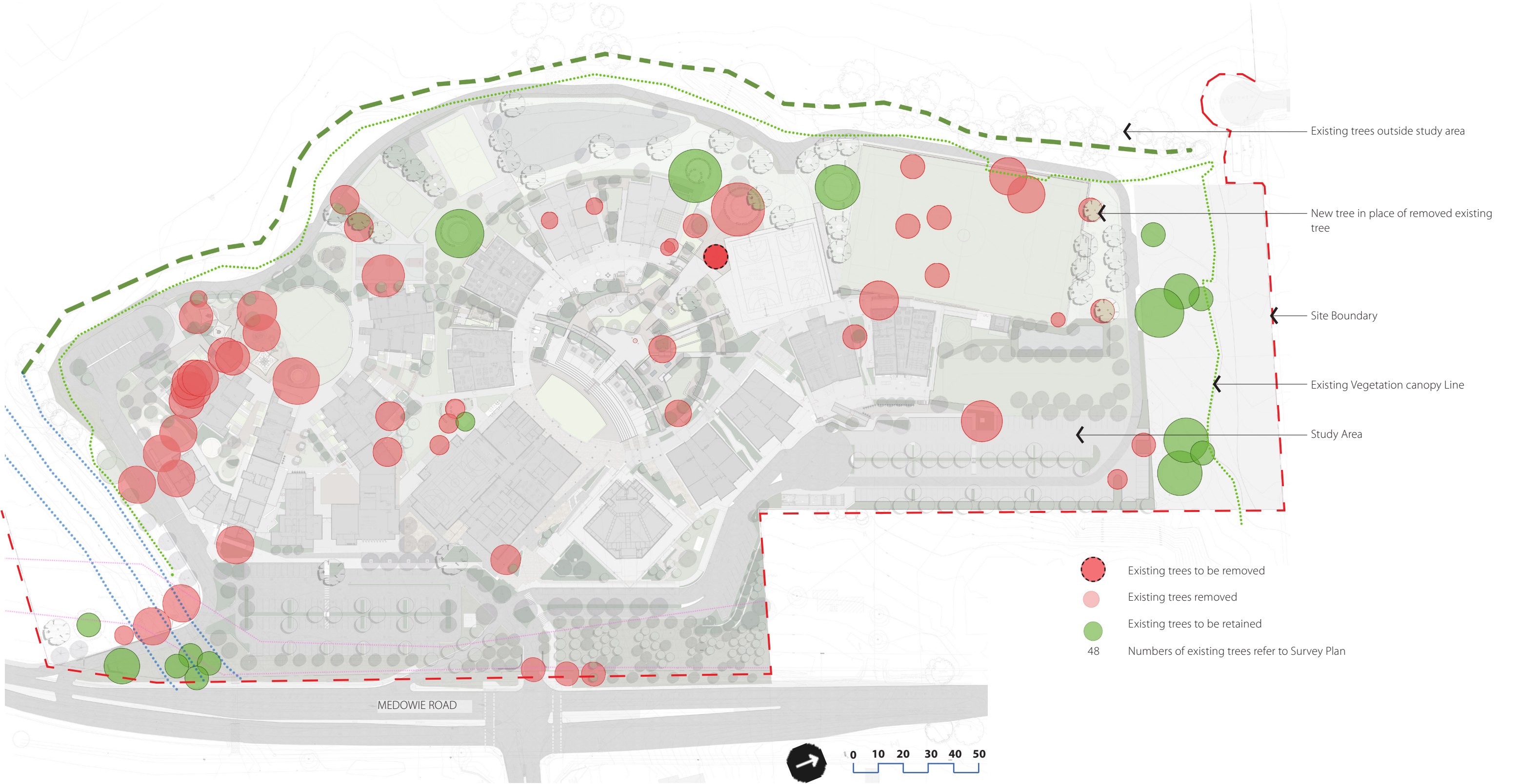

Note
Landscape Tree Removed Plan has shown existing trees removed in the Study Area. Existing trees are removed according to Arboricultural Impact Assessment Report and pines has been removed from school for safety.

PROJECT:
**Catherine McAuley Catholic School
Medowie, NSW.**

DRAWN: MA	DATE: 16/07/2025	SCALE: AS SHOWN
JOB NUMBER: 13790.5	PHASE: SD	D No: REV: L04 E

New tree no. 1



Angophora costata
At Time of Planting (100L Pot Size): Height: **2.5 to 3.5** metres
At Maturity: Height: **15 to 25** metres Canopy Spread: **8-15**metres

Tree 36, a Smooth-barked Apple (*Angophora costata*), was identified as a primary canopy species of PCT 3544 and is recognised as a Koala use tree under Schedule 3 of the Biodiversity and Conservation SEPP. As Port Stephens is located within the Central Coast Koala Management Area (Schedule 2 of the SEPP), particular care is required in the selection of replacement species.

In accordance with Council’s Biodiversity Technical Specification 2024, native trees with a height over 3 m and DBH greater than 300 mm must be replaced at a minimum 1:2 ratio. Moreover, best-practice guidance stipulates that where Koala habitat trees are removed, replacement should ideally be of the same species, sourced from local provenance, and planted in clusters, in proximity to other retained food trees to support habitat continuity.

The proposed replacement of one Smooth-barked Apple, matching the removed species, ensures:

Alignment with the specific koala habitat value of the site,

Consistency with ecological structure and composition of PCT 3544, and

Compliance with the species preference and provenance requirements outlined in the SEPP and Council’s technical specifications.

New tree no. 2



Glochidion ferdinandi
At Time of Planting (100L Pot Size): Height: **2.0 to 2.5** metres
At Maturity: Height: **8 to 12** metres Canopy Spread: **10** metres

Glochidion ferdinandi (Cheese Tree) – selected in line with Port Stephens Council’s Biodiversity Technical Specification as a suitable **endemic species**.

It is a medium-sized, low-maintenance tree, offering dense canopy for shade and habitat value for fruit-eating birds.

It will be planted near the seating circle to enhance comfort and environmental benefits.