

## 01 GFA BY AREA CATEGORY

### BASEMENT

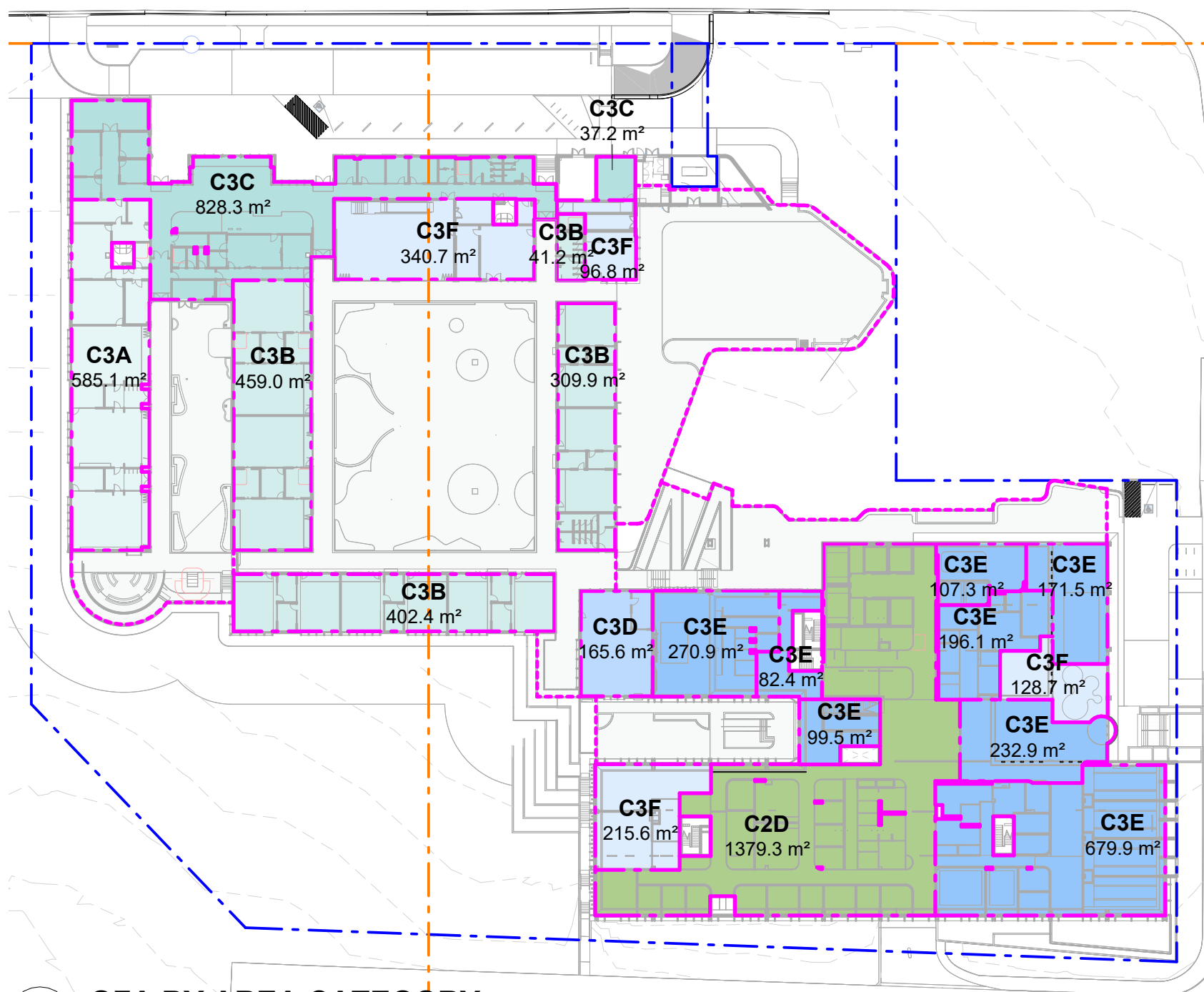

## 02 GFA BY AREA CATEGORY

### LOWER GROUND (CONSULTING BUILDING) & UPPER GROUND (SCHOOL)

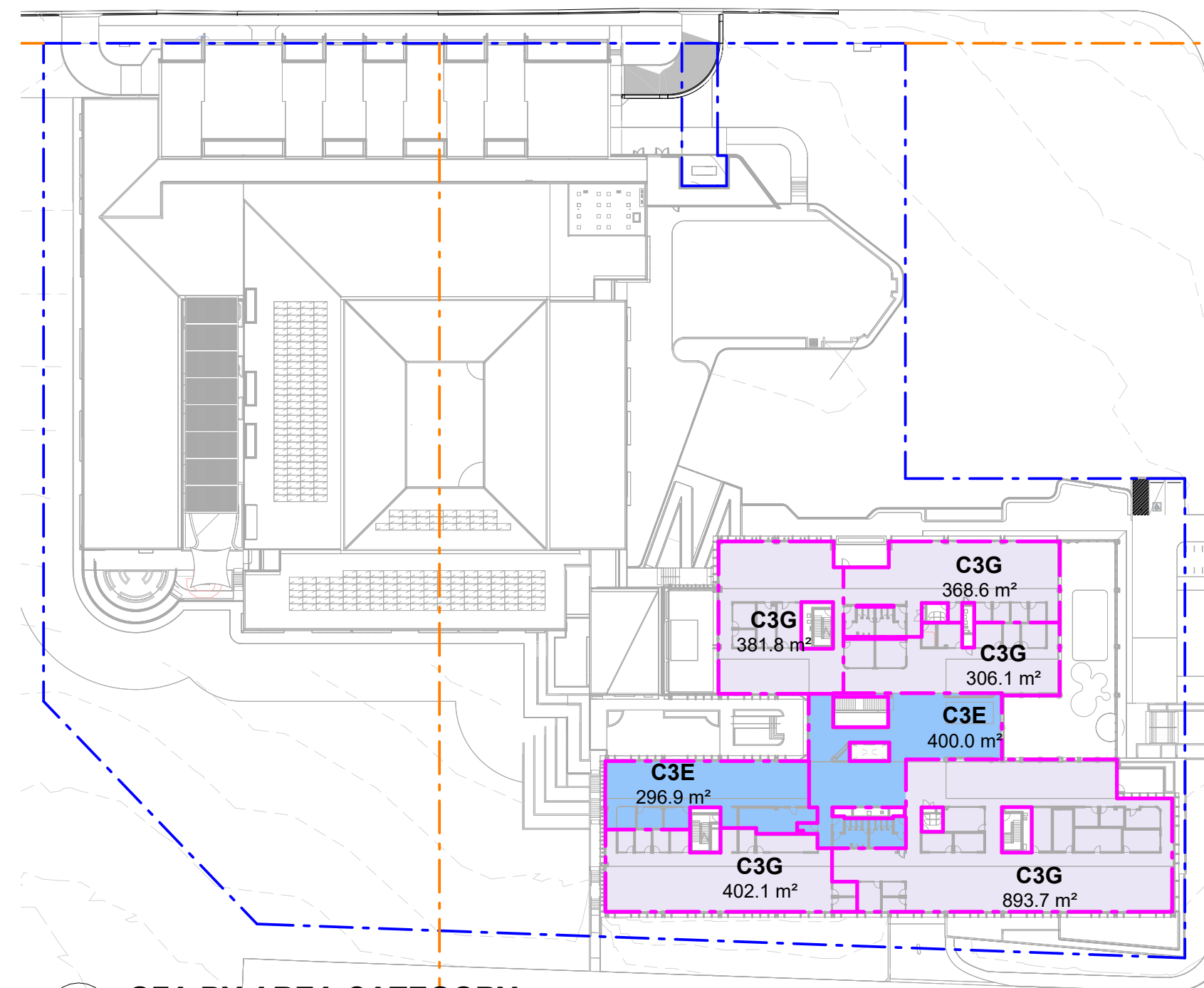

### 03 GFA BY AREA CATEGORY LEVEL 1

| SITE AREA COMPARISON     |                        |
|--------------------------|------------------------|
| SITE BOUNDARY            | AREA                   |
| PROPOSED BOUNDARY (BLUE) | 19339.8 m <sup>2</sup> |

| GROSS FLOOR AREA SCHEDULE |                        |
|---------------------------|------------------------|
| LEVEL                     | AREA                   |
| BASEMENT                  | 560.9 m <sup>2</sup>   |
| LOWER GROUND              | 3564.1 m <sup>2</sup>  |
| UPPER GROUND              | 3266.3 m <sup>2</sup>  |
| LEVEL 01                  | 3049.3 m <sup>2</sup>  |
| GROSS FLOOR AREA          | 10440.7 m <sup>2</sup> |

| GROSS FLOOR AREA SCHEDULE TOTALS PER USE: |                       |
|---|-----------------------|
| Academic Use (3A, 3B, 3C, 3D, 3E, 3F, 3G) |                       |
| Grand total:                              | 9061.4 m <sup>2</sup> |
| Commercial Use (2D)                       |                       |
| Grand total:                              | 1379.3 m <sup>2</sup> |

**NOTE:**

- GFA measurement based on City of Ryde LEP 2014 GFA definition. Areas quoted are an approximation only. For accurate areas a licensed surveyor must be engaged.
- GBA measurement based on the Australian Property Institute method of measurement
- Academic Use = Related to School & associated functionality
- Commerical Use - Relates to income generating uses

| GROSS FLOOR AREA SCHEDULE BY CATEGORY - SCHOOL |               |                              |                       |
|--|---------------|------------------------------|-----------------------|
| LEVEL  | AREA CATEGORY | AREA DESCRIPTION             | AREA                  |
| UPPER GROUND                                   | 3A            | Academic - Pre-School        | 585.1 m <sup>2</sup>  |
|  |               |                              | 585.1 m <sup>2</sup>  |
| UPPER GROUND                                   | 3B            | Academic - Primary School    | 1212.6 m <sup>2</sup> |
|  |               |                              | 1212.6 m <sup>2</sup> |
| UPPER GROUND                                   | 3C            | Academic - School Admin      | 865.5 m <sup>2</sup>  |
|  |               |                              | 865.5 m <sup>2</sup>  |
| UPPER GROUND                                   | 3D            | Academic - School Library    | 165.6 m <sup>2</sup>  |
|  |               |                              | 165.6 m <sup>2</sup>  |
| UPPER GROUND                                   | 3F            | Academic - Shared Facilities | 437.5 m <sup>2</sup>  |
|  |               |                              | 437.5 m <sup>2</sup>  |
| Grand total                                    |               |                              | 3266.3 m <sup>2</sup> |

**GFA AREA NOTE:**  
Gross Floor Area means the sum of the floor area of each floor of a building measured from the internal face of external walls, or from the internal face of walls separating the building from any other building, measured at a height of 1.4 metres above the floor, and includes:

- (a) the area of a mezzanine;
- (b) habitable rooms in a basement or an attic; and
- (c) any shop, auditorium, cinema, and the like, in a basement or attic, but excludes:
- (d) any area for common vertical circulation, such as lifts and stairs;
- (e) any basement:
  - (i) storage; and
  - (ii) vehicular access, loading areas, garbage and services,

- (f) plant rooms, lift towers and other areas used exclusively for mechanical services or ducting;  
(g) car parking to meet any requirements of the consent authority (including access to that car parking);  
(h) any space used for the loading or unloading of goods (including access to it);  
(i) terraces and balconies with outer walls less than 1.4 metres high; and  
(j) voids above a floor at the level of a storey or storey above.

| GROSS FLOOR AREA SCHEDULE BY CATEGORY - CONSULTING BUILDING |               |  |                       |
|---|---------------|--|-----------------------|
| LEVEL   | AREA CATEGORY | AREA DESCRIPTION                           | AREA                  |
| LOWER GROUND  | 2D            | Commercial - Consulting                    | 1379.3 m <sup>2</sup> |
|   |               |  | 1379.3 m <sup>2</sup> |
| BASEMENT  | 3E            | Academic - Institute Library               | 233.7 m <sup>2</sup>  |
| LEVEL 01  | 3E            | Academic - General                         | 400.0 m <sup>2</sup>  |
| LEVEL 01  | 3E            | Academic - Institute Workplace             | 296.9 m <sup>2</sup>  |
| LOWER GROUND  | 3E            | Academic - General                         | 99.5 m <sup>2</sup>   |
| LOWER GROUND  | 3E            | Academic - Institute Business Hub          | 107.3 m <sup>2</sup>  |
| LOWER GROUND  | 3E            | Academic - Institute Cafe                  | 367.7 m <sup>2</sup>  |
| LOWER GROUND  | 3E            | Academic - Institute Collaboration         | 270.9 m <sup>2</sup>  |
| LOWER GROUND  | 3E            | Academic - Institute Conference            | 679.9 m <sup>2</sup>  |
| LOWER GROUND  | 3E            | Academic - Public                          | 232.9 m <sup>2</sup>  |
| LOWER GROUND  | 3E            | Academic - Resource Library                | 82.4 m <sup>2</sup>   |
|   |               |  | 2771.1 m <sup>2</sup> |
| LOWER GROUND  | 3F            | Academic - Institute Showcase              | 128.7 m <sup>2</sup>  |
| LOWER GROUND  | 3F            | Academic - Shared Facilities               | 215.6 m <sup>2</sup>  |
|   |               |  | 344.3 m <sup>2</sup>  |
| BASEMENT  | 3G            | Academic - Workspace - Building Management | 101.5 m <sup>2</sup>  |
| BASEMENT  | 3G            | Academic - Workspace General               | 225.8 m <sup>2</sup>  |
| LEVEL 01  | 3G            | Academic - Workspace                       | 893.7 m <sup>2</sup>  |
| LEVEL 01  | 3G            | Academic - Workspace - Fundraising/Risk    | 368.6 m <sup>2</sup>  |
| LEVEL 01  | 3G            | Academic - Workspace - IT/Support          | 402.1 m <sup>2</sup>  |
| LEVEL 01  | 3G            | Academic - Workspace - Leadership          | 306.1 m <sup>2</sup>  |
| LEVEL 01  | 3G            | Academic - Workspace - Marketing/Finance   | 381.8 m <sup>2</sup>  |
|   |               |  | 2679.7 m <sup>2</sup> |
| Grand total   |               |  | 7174.4 m <sup>2</sup> |

| GROSS BUILDING AREA SCHEDULE |      |                        |
|------------------------------|------|------------------------|
| LEVEL                        | TYPE | AREA                   |
| BASEMENT                     | FECA | 3283.5 m <sup>2</sup>  |
| BASEMENT                     |      | 3283.5 m <sup>2</sup>  |
|                              | UCA  | 183.9 m <sup>2</sup>   |
|                              |      | 183.9 m <sup>2</sup>   |
| LOWER GROUND                 | FECA | 3949.7 m <sup>2</sup>  |
| LOWER GROUND                 |      | 3949.7 m <sup>2</sup>  |
| UPPER GROUND                 | FECA | 3324.4 m <sup>2</sup>  |
| UPPER GROUND                 | UCA  | 3715.7 m <sup>2</sup>  |
| UPPER GROUND                 |      | 7040.1 m <sup>2</sup>  |
|                              | UCA  | 126.8 m <sup>2</sup>   |
|                              |      | 126.8 m <sup>2</sup>   |
| LEVEL 01                     | FECA | 3796.7 m <sup>2</sup>  |
| LEVEL 01                     | UCA  | 94.2 m <sup>2</sup>    |
| LEVEL 01                     |      | 3890.9 m <sup>2</sup>  |
| GROSS BUILDING AREA          |      | 18474.9 m <sup>2</sup> |

DEVELOPMENT APPLICATION  
ONLY  
NOT FOR CONSTRUCTION

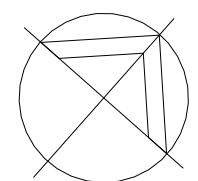

**Client**  
ADCO GROUP PTY LTD / RIDBC

**Project**  
CENTRE OF EXCELLENCE

131 CULLODEN ROAD  
MACQUARIE UNIVERSITY, NSW 2109

|              |                    |
|--------------|--------------------|
| <b>Title</b> | GFA & GBA DIAGRAMS |
|--------------|--------------------|

|                             |                           |
|-----------------------------|---------------------------|
| <b>Drawing No.</b><br>A980  | <b>Issue</b><br>I         |
| <b>Scale</b><br>N/A         | <b>Drawing Size</b><br>A1 |
| <b>Project No.</b><br>19181 | <b>Drawn By</b><br>RS     |

**CAD Reference**  
P:19181 RDBC Centre of Excellence at Macquarie University/dwgfiles/Revit  
22/04/2025 3:02:15 PM

Dimensioned Drawings to take precedence over scaling. Contractor to verify all dimensions on site before construction. All inconsistencies to be reported to the Architect immediately. This drawing and its contents remain the copyright of WMK Architecture Pty Ltd ©

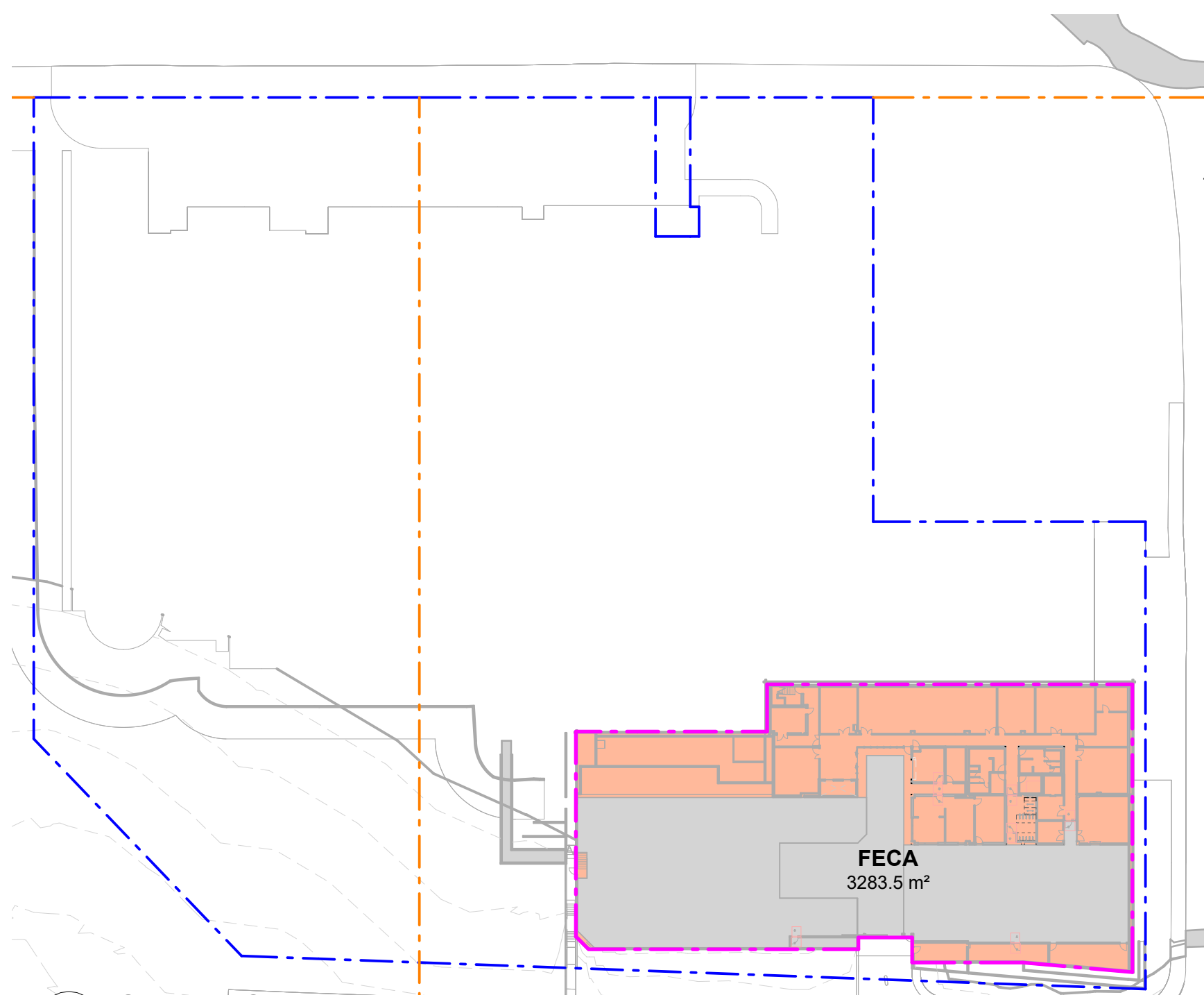

04 **GBA DIAGRAM**  
BASEMENT

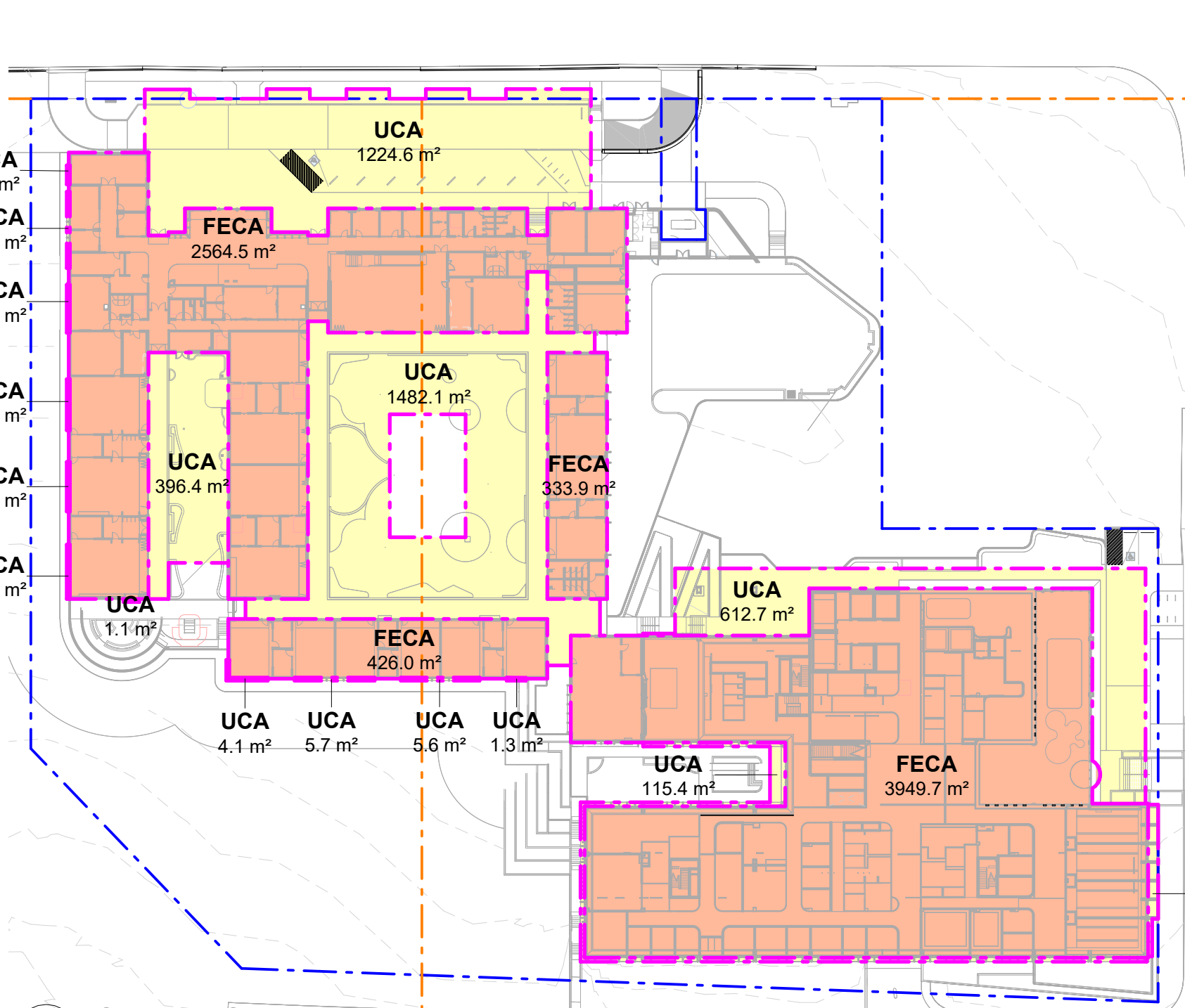

05 **GBA DIAGRAM**  
LOWER GROUND (CONSULTING BUILDING) & UPPER GROUND (SCHOOL)

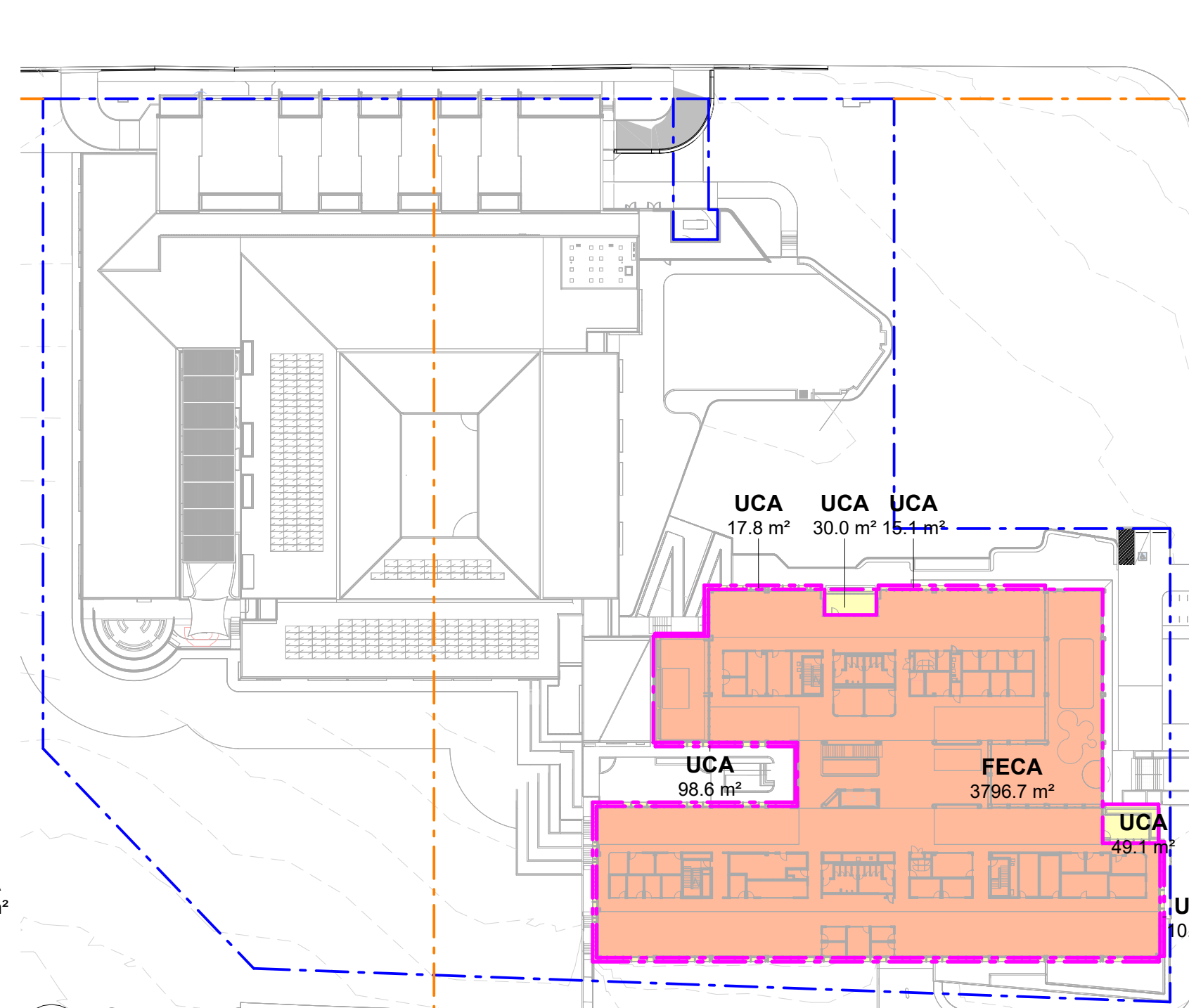

06 **GBA DIAGRAM**  
LEVEL 1