

14 February 2022

Jack Bruderlin (Project Director – School Infrastructure)

Department of Education
School Infrastructure NSW
Level 8, 259 George Street
SYDNEY NSW 2000

Dear Jack

Reference: New Liverpool Primary School SSD-10391 Response to Transport Related Submissions

A State Significant Development (SSD) application has been submitted for the New Liverpool Primary School project at 18 Forbes Street, Liverpool. Stantec completed a Transport and Accessibility Impact Assessment and Student Transport Plan, both dated 11 June 2021, to support the SSD application.

Subsequent to the SSD application being lodged and additional requested information by stakeholders being responded to, the Department of Planning, Industry and Environment (DPIE) have provided the following additional query:

The Department requested additional information regarding parking facility for the preschool users or else an alternate area is to be identified where parents can park during arrival/ departure (when coinciding with the school drop-off/pick-up times). Please address this issue. The response to RFI letter says designated preschool parking spaces of 15mins length of stay will be provided between the hours of 7am to 8:15am and 4pm to 6pm adjacent to the school on Burnside Drive. A detailed study is required for capacity of parking on burnside drive between this time.

Stantec Response:

To address DPIE's concern regarding the provision of preschool parking spaces, it is proposed that four spaces on Burnside Drive within the school kiss and drop zone be signposted as 15-minute spaces outside of the school zone hours, therefore being from 7am to 8am and 4pm to 6pm. It is also noted that there is currently no parking provision on Burnside Drive and the installation of kerbside parking on the western side of Burnside Drive will be primarily for the school and preschool use. Therefore, preschool use will have access to more than the four designated preschool spaces outside of peak school drop off and pick up.

In addition, to respond to DPIE's request during school drop off and pick up hours, three designated 15-minute preschool on-street parking spaces are proposed on Lachlan Street between the times of 8am-9:30am and 2:30pm-4pm to accommodate preschool drop off and pick up in the event that some preschool demand coincides with the school drop off and pick up times. It is noted that preschool pick up and drop off will be discouraged during these times to assist in reducing traffic congestion around the school at these key busy periods.

The proposed designated 15-minute preschool on-street parking spaces are shown in Figure 1.

Figure 1 Preschool Parking



To assist in determining the appropriate quantum of parking spaces, reference has been made to the Liverpool City Council Development Control Plan (DCP) 2008 which provides car parking requirements for different development types. Table 1 sets out the car parking requirements for childcare centres.

Table 1 Preschool Parking Requirements

Childcare Centres	DCP parking rate	Parking space quantum based on 40 children and 130sqm LFA
Located in Residential or Industrial Zones	1 space per staff member and 1 space per 10 children	4
Located in Business Zones	1 space per 35 sqm LFA	3.7

Noting that the staff for the preschool are already accommodated within the staff parking area, it is apparent from the DCP that four spaces would be sufficient to accommodate children drop off and pick up activities. As outlined above, outside of school zone times parking availability will well exceed four spaces on Burnside Drive, however a minimum of four spaces will be dedicated for the preschool. As mentioned, it is also recommended that the starting and finishing hours of the preschool do not coincide with the school zone times to assist in alleviating traffic congestion around the schools. However, as outlined in Figure 1, three on street spaces are also being proposed on Lachlan Street to cater for preschool pick and drop off in the event that it occurs during the school zone times.

Pedestrian paths will be provided connecting the on-street parking spaces on Lachlan Street to the preschool, with the various walking routes shown in Figure 2. These routes equate to a walking distance of approximately 160 metres (through the school site) to 190 metres (along Lachlan Street and Burnside Drive). In Australia the typical walking speed used for determining pedestrian walk time is 1.2 metres per second (Austroads and Transport for NSW), this equates to a walking time of around two minutes

Reference: N174701

10 seconds to two minutes 40 seconds (depending on which school access is used) which is considered minor, and would allow time for parents/ carers to walk their child into the preschool and return to their car within the 15-minute time limit (or pick-up their child and return to their car).

Figure 2 Pedestrian travel path between the preschool and the proposed 15-minute on-street parking spaces on Lachlan Street

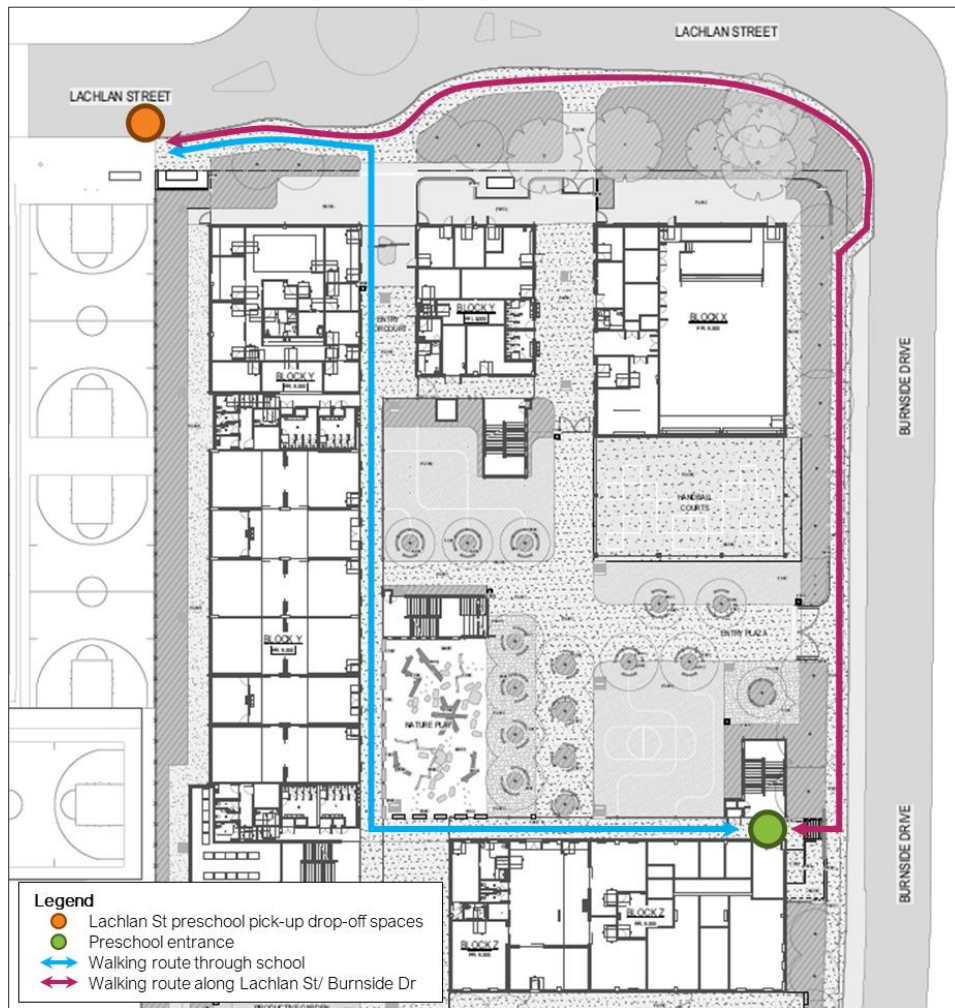

Should you have any questions or require any further information, please do not hesitate to contact me on (02) 8448 1800.

Regards

Karen McNatty

Senior Principal Transportation Engineer