

INTERIM DESIGN MAY BE STAGED AND DELIVERED
TO SUIT TIMING OF LAND DEDICATION

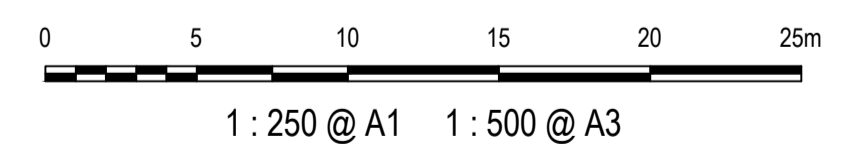

			
G	ISSUED FOR INFORMATION	13-04-22	
F	ISSUED FOR INFORMATION	03-02-22	
E	ISSUED FOR INFORMATION	07-12-21	
D	ISSUED FOR INFORMATION	08-09-21	
C	ISSUED FOR INFORMATION	24-05-21	
B	ISSUED FOR INFORMATION	12-05-21	
A	ISSUED FOR PRICING	12-04-21	
Issue	Description	Date	

THIS DRAWING CANNOT BE
COPIED OR REPRODUCED IN
ANY FORM OR USED FOR ANY
OTHER PURPOSE OTHER THAN
THAT ORIGINALLY INTENDED
WITHOUT THE WRITTEN
PERMISSION OF AT&L

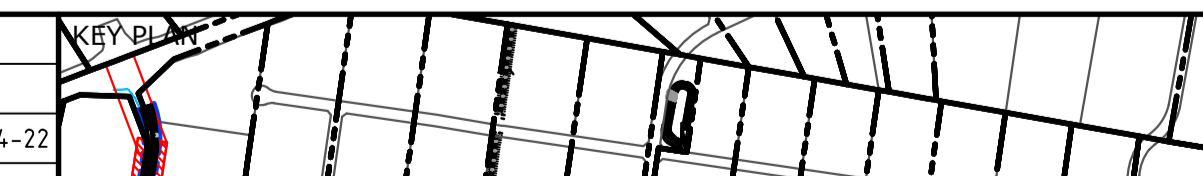

Scales 1 : 250	Drawn	ASD
	Designed	ASD
Grid GDA2020	Checked	AMcl
Height Datum AHD	Approved	AMcl

Project	ABBOTTS ROAD AND ALDINGTON ROAD CONCEPT DESIGN
Title	PAVEMENT AND LINEMARKING PLAN SHEET 2

Civil Engineers and Project Managers	
	Level 7, 153 Walker Street North Sydney NSW 2060 ABN 96 130 882 405 Tel.: 02 9439 1777 Fax: 02 9923 1055 www.atl.net.au info@atl.net.au

LEGEND

WORKS BY OTHERS

PAVEMENT MARKING SCHEDULE

EDGE LINES

E1

E5

E6

LANE LINES

L1

L4

BARRIER LINES

BB

CONTINUITY LINES

C1

CLEARWAY LINES

C3

GIVEWAY LINE

TB

STOP LINE

TF

PAVEMENT ARROWS

AR3(L)

AR3(R)

AR4(L)

AR4(R)

ARU5(R)

PAVEMENT DETAILS

ALDINGTON ROAD/ABBOTT ROAD PAVEMENT

50mm THICKNESS AC14 (A15E) ON

65mm THICKNESS AC20 (C320) ON

65mm THICKNESS AC20 (C320) ON

7mm PRIMERSEAL (R106) ON

260mm CEMENT STABILISED BASE COURSE (DGB20, 3% BY MASS, E=3,500MPa, R73) ON

300mm THICKNESS CONTROLLED SUBGRADE (4% HYDRATED LIME) REFER NOTE 2

RAISED MEDIAN INFILL

125mm THICKNESS N25 CONCRETE (1 LAYER SL82 MESH) ON

100mm THICKNESS DGB20 COMPACTED ROAD BASE

DRIVEWAY ACCESS

150mm THICKNESS N32 CONCRETE (1 LAYER SL82 MESH) ON

100mm THICKNESS DGB20 COMPACTED ROAD BASE

SHARED PATH

150mm THICKNESS N25 CONCRETE (1 LAYER F72 MESH) ON

150mm THICKNESS DGB20 COMPACTED ROAD BASE

REFER TO RMS STANDARDS FOR JOINTING DETAILS.

FOOTPATH

100mm THICKNESS N25 CONCRETE (1 LAYER F72 MESH) ON

100mm THICKNESS DGB20 COMPACTED ROAD BASE

REFER TO RMS STANDARDS FOR JOINTING DETAILS.

LANDSCAPING

TURF AND STREET TREES

NOTE:

PAVEMENT DESIGN BASED ON ASSUMED CBR OF 3%

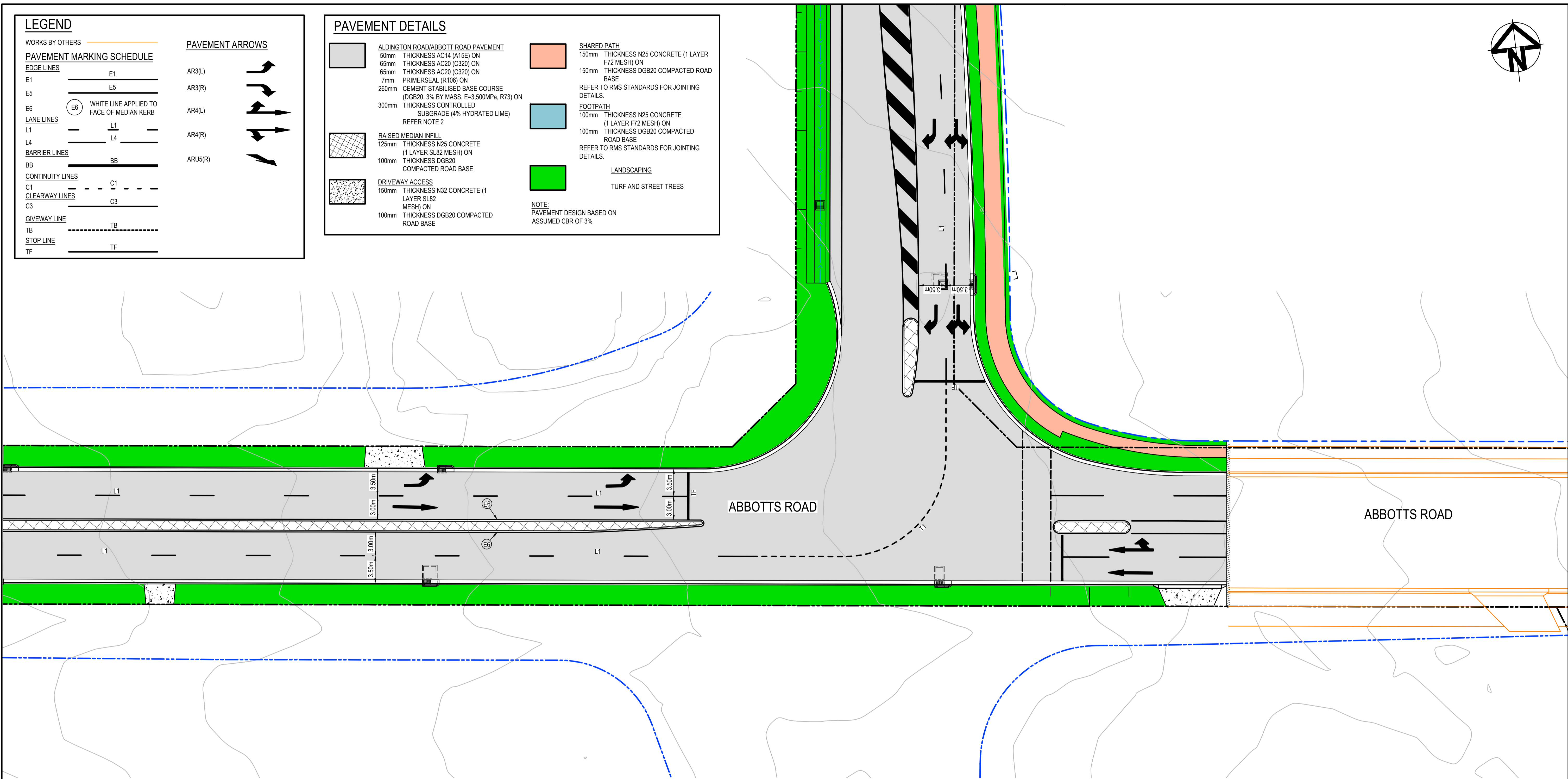

CONCEPT

INTERIM DESIGN MAY BE STAGED AND DELIVERED TO SUIT TIMING OF LAND DEDICATION

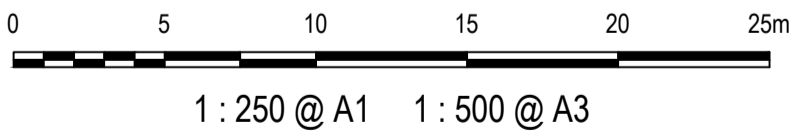

Issue	Description	Date
G	ISSUED FOR INFORMATION	13-04-22
F	ISSUED FOR INFORMATION	03-02-22
E	ISSUED FOR INFORMATION	07-12-21
D	ISSUED FOR INFORMATION	08-09-21
C	ISSUED FOR INFORMATION	24-05-21
B	ISSUED FOR INFORMATION	12-05-21
A	ISSUED FOR PRICING	12-04-21



THIS DRAWING CANNOT BE COPIED OR REPRODUCED IN ANY FORM OR USED FOR ANY OTHER PURPOSE OTHER THAN THAT ORIGINALLY INTENDED WITHOUT THE WRITTEN PERMISSION OF AT&L

Client

FRASERS PROPERTY

ESR

Stockland

FIFECAPITAL

Scales

1 : 250

Grid

GDA2020

Height Datum

AHD

GDA2020

Drawn

ASD

Designed

ASD

Checked

AMoL

Approved

AMoL

Project

ABBOTTS ROAD AND ALDINGTON ROAD CONCEPT DESIGN

Title

PAVEMENT AND LINEMARKING PLAN SHEET 3

Civil Engineers and Project Managers

at&l

Level 7, 153 Walker Street North Sydney NSW 2060
ABN 96 130 882 405
Tel: 02 9439 1777
Fax: 02 9923 1055
www.atl.net.au
info@atl.net.au

Status

FOR INFORMATION NOT TO BE ISSUED FOR CONSTRUCTION

Project - Drawing No.

21-843-C552

Issue

G

A1

LEGEND

WORKS BY OTHERS

PAVEMENT MARKING SCHEDULE

EDGE LINES

E1

E5

E6

LANE LINES

L1

L4

BARRIER LINES

BB

CONTINUITY LINES

C1

CLEARWAY LINES

C3

GIVEWAY LINE

TB

STOP LINE

TF

PAVEMENT ARROWS

AR3(L)

AR3(R)

AR4(L)

AR4(R)

ARU5(R)

ALDINGTON ROAD/ABBOTT ROAD PAVEMENT

50mm THICKNESS AC14 (A15E) ON

65mm THICKNESS AC20 (C320) ON

65mm THICKNESS AC20 (C320) ON

7mm PRIMERSEAL (R106) ON

260mm CEMENT STABILISED BASE COURSE (DGB20, 3% BY MASS, E=3,500MPa, R73) ON

300mm THICKNESS CONTROLLED SUBGRADE (4% HYDRATED LIME) REFER NOTE 2

RAISED MEDIAN INFILL

125mm THICKNESS N25 CONCRETE (1 LAYER SL82 MESH) ON

100mm THICKNESS DGB20 COMPACTED ROAD BASE

DRIVEWAY ACCESS

150mm THICKNESS N32 CONCRETE (1 LAYER SL82 MESH) ON

100mm THICKNESS DGB20 COMPACTED ROAD BASE

SHARED PATH

150mm THICKNESS N25 CONCRETE (1 LAYER F72 MESH) ON

150mm THICKNESS DGB20 COMPACTED ROAD BASE

REFER TO RMS STANDARDS FOR JOINTING DETAILS.

FOOTPATH

100mm THICKNESS N25 CONCRETE (1 LAYER F72 MESH) ON

100mm THICKNESS DGB20 COMPACTED ROAD BASE

REFER TO RMS STANDARDS FOR JOINTING DETAILS.

LANDSCAPING

TURF AND STREET TREES

NOTE: PAVEMENT DESIGN BASED ON ASSUMED CBR OF 3%

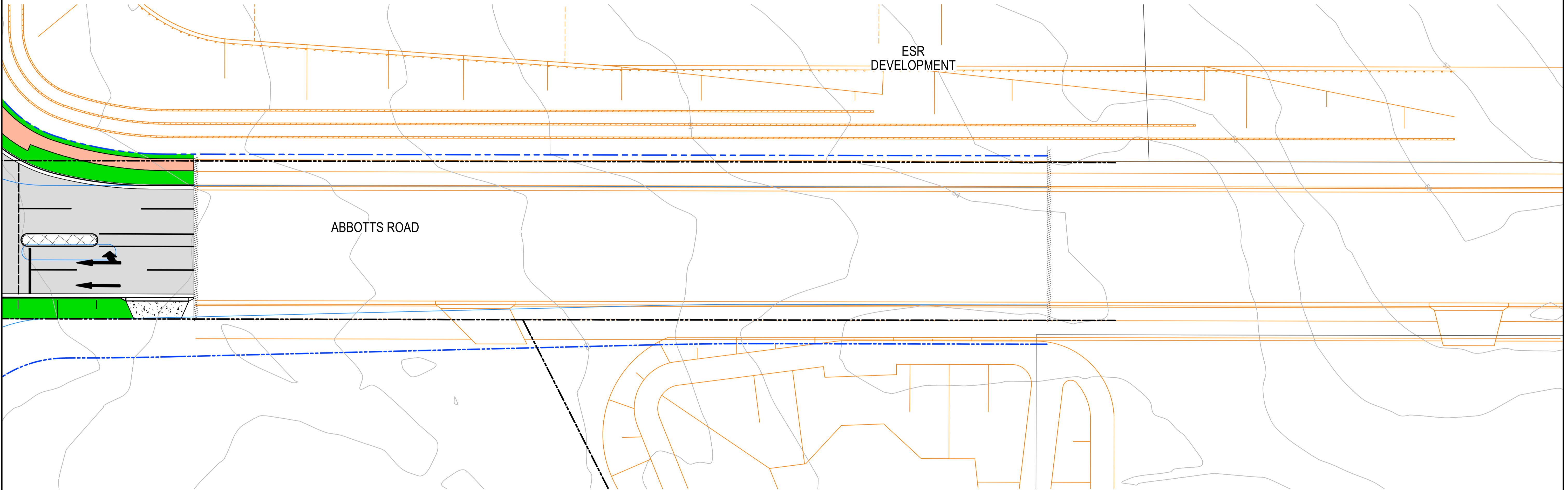

CONCEPT

INTERIM DESIGN MAY BE STAGED AND DELIVERED TO SUIT TIMING OF LAND DEDICATION

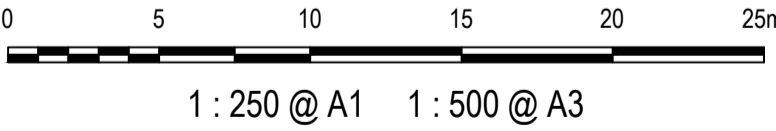

Issue	Description	Date
G	ISSUED FOR INFORMATION	13-04-22
F	ISSUED FOR INFORMATION	03-02-22
E	ISSUED FOR INFORMATION	07-12-21
D	ISSUED FOR INFORMATION	08-09-21
C	ISSUED FOR INFORMATION	24-05-21
B	ISSUED FOR INFORMATION	12-05-21
A	ISSUED FOR PRICING	12-04-21



THIS DRAWING CANNOT BE COPIED OR REPRODUCED IN ANY FORM OR USED FOR ANY OTHER PURPOSE OTHER THAN THAT ORIGINALLY INTENDED WITHOUT THE WRITTEN PERMISSION OF AT&L

Client

FRASERS PROPERTY

ESR

Stockland

FIFECAPITAL

Scales

1 : 250

Grid

GDA2020

Height Datum

AHD

GDA2020

Drawn

ASD

Designed

ASD

Checked

AMcL

Approved

AMcL

Project

ABBOTTS ROAD AND ALDINGTON ROAD CONCEPT DESIGN

Title

PAVEMENT AND LINEMARKING PLAN SHEET 4

Civil Engineers and Project Managers

at&l

Level 7, 153 Walker Street
North Sydney NSW 2060
ABN 96 130 882 405
Tel: 02 9439 1777
Fax: 02 9923 1055
www.atl.net.au
info@atl.net.au

Status

FOR INFORMATION
NOT TO BE ISSUED FOR CONSTRUCTION

Project - Drawing No.

21-843-C553

Issue

A1
G

LEGEND

WORKS BY OTHERS

PAVEMENT MARKING SCHEDULE

EDGE LINES

E1

E5

E6

LANE LINES

L1

L4

BARRIER LINES

BB

CONTINUITY LINES

C1

CLEARWAY LINES

C3

GIVEWAY LINE

TB

STOP LINE

TF

PAVEMENT ARROWS

AR3(L)

AR3(R)

AR4(L)

AR4(R)

ARU5(R)

ALDINGTON ROAD/ABBOTT ROAD PAVEMENT

50mm THICKNESS AC14 (A15E) ON

65mm THICKNESS AC20 (C320) ON

65mm THICKNESS AC20 (C320) ON

7mm PRIMERSEAL (R106) ON

260mm CEMENT STABILISED BASE COURSE (DGB20, 3% BY MASS, E=3,500MPa, R73) ON

300mm THICKNESS CONTROLLED SUBGRADE (4% HYDRATED LIME) REFER NOTE 2

RAISED MEDIAN INFILL

125mm THICKNESS N25 CONCRETE (1 LAYER SL82 MESH) ON

100mm THICKNESS DGB20 COMPACTED ROAD BASE

DRIVEWAY ACCESS

150mm THICKNESS N32 CONCRETE (1 LAYER SL82 MESH) ON

100mm THICKNESS DGB20 COMPACTED ROAD BASE

SHARED PATH

150mm THICKNESS N25 CONCRETE (1 LAYER F72 MESH) ON

150mm THICKNESS DGB20 COMPACTED ROAD BASE

REFER TO RMS STANDARDS FOR JOINTING DETAILS.

FOOTPATH

100mm THICKNESS N25 CONCRETE (1 LAYER F72 MESH) ON

100mm THICKNESS DGB20 COMPACTED ROAD BASE

REFER TO RMS STANDARDS FOR JOINTING DETAILS.

LANDSCAPING

TURF AND STREET TREES

NOTE: PAVEMENT DESIGN BASED ON ASSUMED CBR OF 3%

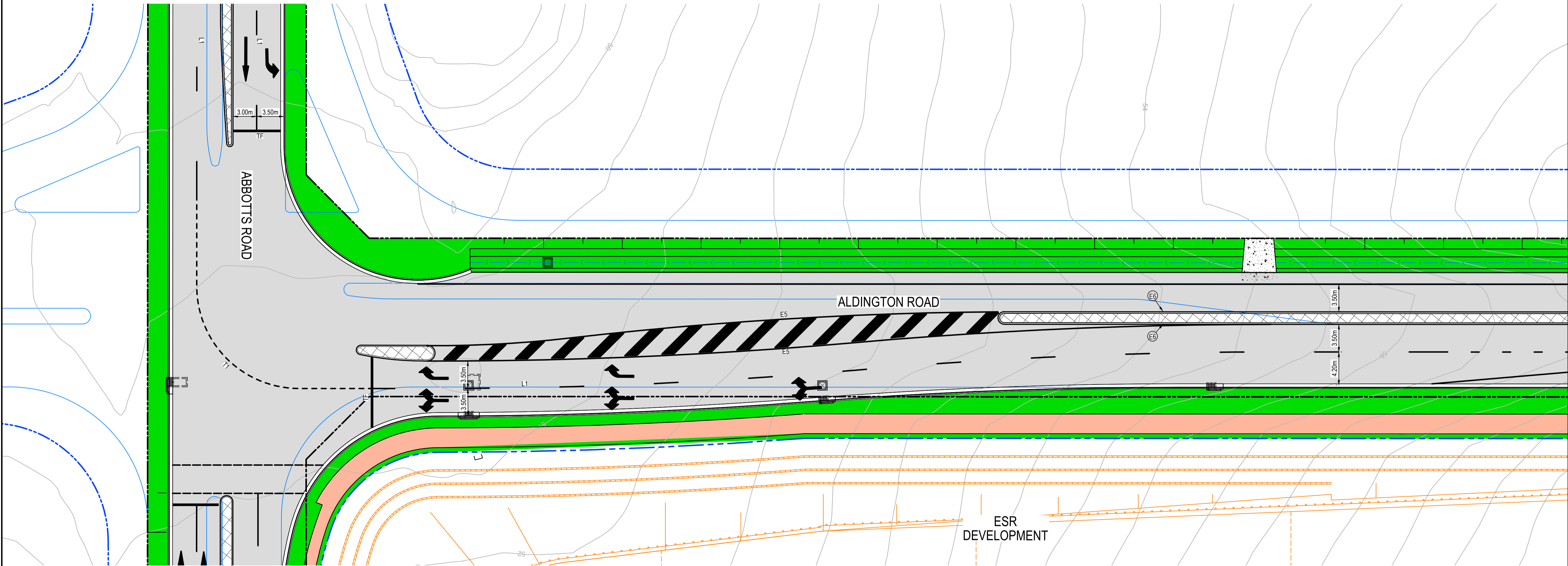

CONCEPT

INTERIM DESIGN MAY BE STAGED AND DELIVERED TO SUIT TIMING OF LAND DEDICATION

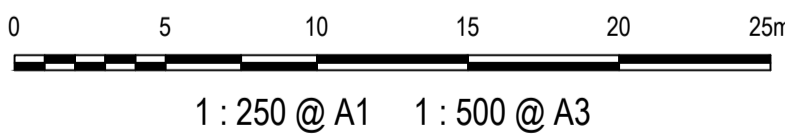

Issue	Description	Date
G	ISSUED FOR INFORMATION	13-04-22
F	ISSUED FOR INFORMATION	03-02-22
E	ISSUED FOR INFORMATION	07-12-21
D	ISSUED FOR INFORMATION	08-09-21
C	ISSUED FOR INFORMATION	24-05-21
B	ISSUED FOR INFORMATION	12-05-21
A	ISSUED FOR PRICING	12-04-21



THIS DRAWING CANNOT BE COPIED OR REPRODUCED IN ANY FORM OR USED FOR ANY OTHER PURPOSE OTHER THAN THAT ORIGINALLY INTENDED WITHOUT THE WRITTEN PERMISSION OF AT&L

Client

FRASERS PROPERTY

ESR

Stockland

FIFECAPITAL

Scales

1 : 250

Grid

GDA2020

Height Datum

AHD

GDA2020

Project

ABBOTTS ROAD AND ALDINGTON ROAD CONCEPT DESIGN

Title

PAVEMENT AND LINEMARKING PLAN SHEET 5

Civil Engineers and Project Managers

at&l

Level 7, 153 Walker Street North Sydney NSW 2060
ABN 96 130 882 405
Tel: 02 9439 1777
Fax: 02 9923 1055
www.atl.net.au
info@atl.net.au

Status

FOR INFORMATION NOT TO BE ISSUED FOR CONSTRUCTION

Project - Drawing No.

21-843-C554

Issue

G

LEGEND

WORKS BY OTHERS

PAVEMENT MARKING SCHEDULE

EDGE LINES

E1

E5

E6

LANE LINES

L1

L4

BARRIER LINES

BB

CONTINUITY LINES

C1

CLEARWAY LINES

C3

GIVEWAY LINE

TB

STOP LINE

TF

PAVEMENT ARROWS

AR3(L)

AR3(R)

AR4(L)

AR4(R)

ARU5(R)

ALDINGTON ROAD/ABBOTT ROAD PAVEMENT

50mm THICKNESS AC14 (A15E) ON

65mm THICKNESS AC20 (C320) ON

65mm THICKNESS AC20 (C320) ON

7mm PRIMERSEAL (R106) ON

260mm CEMENT STABILISED BASE COURSE (DGB20, 3% BY MASS, E=3,500MPa, R73) ON

300mm THICKNESS CONTROLLED SUBGRADE (4% HYDRATED LIME) REFER NOTE 2

RAISED MEDIAN INFILL

125mm THICKNESS N25 CONCRETE (1 LAYER SL82 MESH) ON

100mm THICKNESS DGB20 COMPACTED ROAD BASE

DRIVEWAY ACCESS

150mm THICKNESS N32 CONCRETE (1 LAYER SL82 MESH) ON

100mm THICKNESS DGB20 COMPACTED ROAD BASE

SHARED PATH

150mm THICKNESS N25 CONCRETE (1 LAYER F72 MESH) ON

150mm THICKNESS DGB20 COMPACTED ROAD BASE

REFER TO RMS STANDARDS FOR JOINTING DETAILS.

FOOTPATH

100mm THICKNESS N25 CONCRETE (1 LAYER F72 MESH) ON

100mm THICKNESS DGB20 COMPACTED ROAD BASE

REFER TO RMS STANDARDS FOR JOINTING DETAILS.

LANDSCAPING

TURF AND STREET TREES

NOTE: PAVEMENT DESIGN BASED ON ASSUMED CBR OF 3%

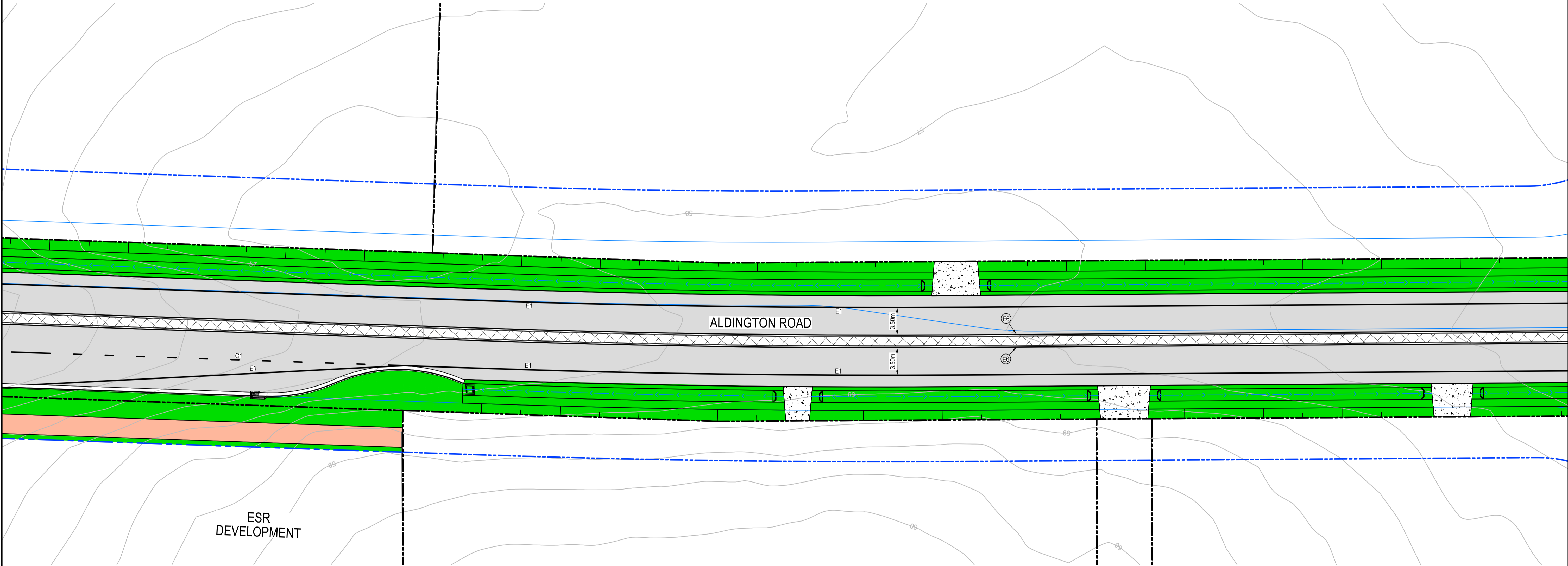

CONCEPT

INTERIM DESIGN MAY BE STAGED AND DELIVERED TO SUIT TIMING OF LAND DEDICATION

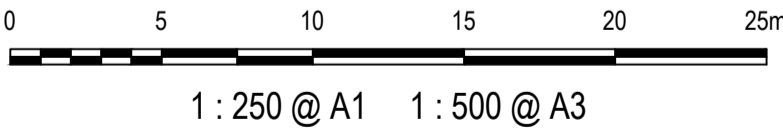

Issue	Description	Date
G	ISSUED FOR INFORMATION	13-04-22
F	ISSUED FOR INFORMATION	03-02-22
E	ISSUED FOR INFORMATION	07-12-21
D	ISSUED FOR INFORMATION	08-09-21
C	ISSUED FOR INFORMATION	24-05-21
B	ISSUED FOR INFORMATION	12-05-21
A	ISSUED FOR PRICING	12-04-21



THIS DRAWING CANNOT BE COPIED OR REPRODUCED IN ANY FORM OR USED FOR ANY OTHER PURPOSE OTHER THAN THAT ORIGINALLY INTENDED WITHOUT THE WRITTEN PERMISSION OF AT&L

Client

FRASERS PROPERTY

ESR

Stockland

FIFECAPITAL

Scales	1 : 250	Drawn	ASD
Grid	GDA2020	Designed	ASD
Height Datum	AHD	Checked	AMcL
		Approved	AMcL

Project

ABBOTTS ROAD AND ALDINGTON ROAD CONCEPT DESIGN

Title

PAVEMENT AND LINEMARKING PLAN SHEET 6

Civil Engineers and Project Managers

at&l

Level 7, 153 Walker Street North Sydney NSW 2060
ABN 96 130 882 405
Tel: 02 9439 1777
Fax: 02 9923 1055
www.atl.net.au
info@atl.net.au

Status

FOR INFORMATION NOT TO BE ISSUED FOR CONSTRUCTION

Project - Drawing No.

21-843-C555

Issue

G

LEGEND

WORKS BY OTHERS

PAVEMENT MARKING SCHEDULE

EDGE LINES

E1

E5

E6

LANE LINES

L1

L4

BARRIER LINES

BB

CONTINUITY LINES

C1

CLEARWAY LINES

C3

GIVEWAY LINE

TB

STOP LINE

TF

PAVEMENT ARROWS

AR3(L)

AR3(R)

AR4(L)

AR4(R)

ARU5(R)

PAVEMENT DETAILS

ALDINGTON ROAD/ABBOTT ROAD PAVEMENT

50mm THICKNESS AC14 (A15E) ON

65mm THICKNESS AC20 (C320) ON

7mm PRIMERSEAL (R106) ON

260mm CEMENT STABILISED BASE COURSE (DGB20, 3% BY MASS, E=3,500MPa, R73) ON

300mm THICKNESS CONTROLLED SUBGRADE (4% HYDRATED LIME) REFER NOTE 2

RAISED MEDIAN INFILL

125mm THICKNESS N25 CONCRETE (1 LAYER SL82 MESH) ON

100mm THICKNESS DGB20 COMPACTED ROAD BASE

DRIVEWAY ACCESS

150mm THICKNESS N32 CONCRETE (1 LAYER SL82 MESH) ON

100mm THICKNESS DGB20 COMPACTED ROAD BASE

SHARED PATH

150mm THICKNESS N25 CONCRETE (1 LAYER F72 MESH) ON

150mm THICKNESS DGB20 COMPACTED ROAD BASE

REFER TO RMS STANDARDS FOR JOINTING DETAILS.

FOOTPATH

100mm THICKNESS N25 CONCRETE (1 LAYER F72 MESH) ON

100mm THICKNESS DGB20 COMPACTED ROAD BASE

REFER TO RMS STANDARDS FOR JOINTING DETAILS.

LANDSCAPING

TURF AND STREET TREES

NOTE:

PAVEMENT DESIGN BASED ON ASSUMED CBR OF 3%

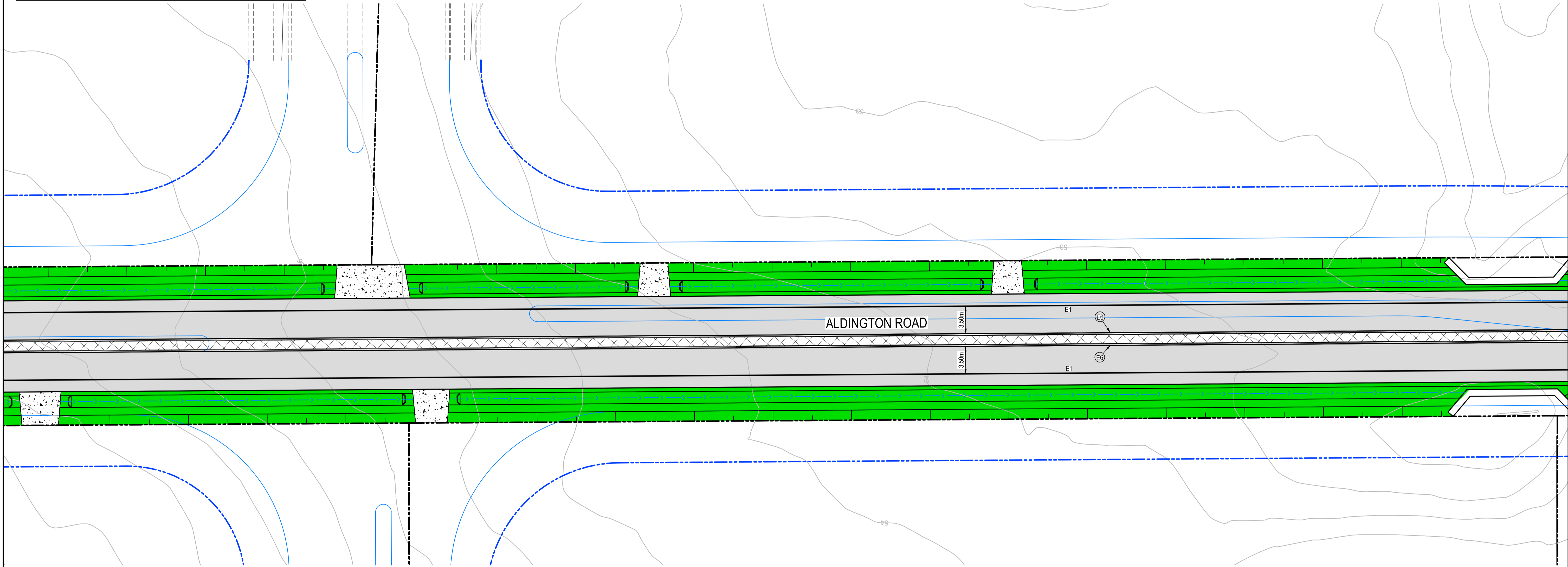
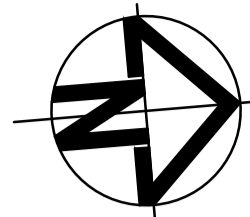

CONCEPT

INTERIM DESIGN MAY BE STAGED AND DELIVERED TO SUIT TIMING OF LAND DEDICATION

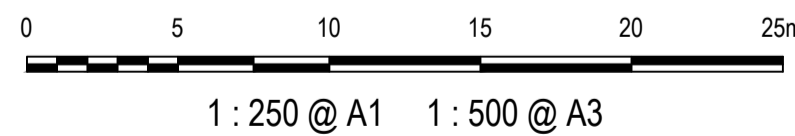

Issue	Description	Date
H	ISSUED FOR INFORMATION	13-04-22
G	ISSUED FOR INFORMATION	03-02-22
F	ISSUED FOR INFORMATION	07-12-21
E	ISSUED FOR INFORMATION	24-09-21
D	ISSUED FOR INFORMATION	08-09-21
C	ISSUED FOR INFORMATION	24-05-21
B	ISSUED FOR INFORMATION	12-05-21
A	ISSUED FOR PRICING	12-04-21



THIS DRAWING CANNOT BE COPIED OR REPRODUCED IN ANY FORM OR USED FOR ANY OTHER PURPOSE OTHER THAN THAT ORIGINALLY INTENDED WITHOUT THE WRITTEN PERMISSION OF AT&L

Client

FRASERS PROPERTY

ESR

Stockland

FIFECAPITAL

Scales

1 : 250

Grid

GDA2020

Height Datum

AHD

GDA2020

Project

ABBOTTS ROAD AND ALDINGTON ROAD CONCEPT DESIGN

Title

PAVEMENT AND LINEMARKING PLAN SHEET 7

Civil Engineers and Project Managers

at&l

Level 7, 153 Walker Street North Sydney NSW 2060
ABN 96 130 882 405
Tel: 02 9439 1777
Fax: 02 9923 1055
www.atl.net.au
info@atl.net.au

Status

FOR INFORMATION NOT TO BE ISSUED FOR CONSTRUCTION

Project - Drawing No.

21-843-C556

Issue

H

LEGEND

WORKS BY OTHERS

PAVEMENT MARKING SCHEDULE

EDGE LINES

E1

E5

E6

LANE LINES

L1

L4

BARRIER LINES

BB

CONTINUITY LINES

C1

CLEARWAY LINES

C3

GIVEWAY LINE

TB

STOP LINE

TF

PAVEMENT ARROWS

AR3(L)

AR3(R)

AR4(L)

AR4(R)

ARU5(R)

PAVEMENT DETAILS

ALDINGTON ROAD/ABBOTT ROAD PAVEMENT

50mm THICKNESS AC14 (A15E) ON

65mm THICKNESS AC20 (C320) ON

65mm THICKNESS AC20 (C320) ON

7mm PRIMERSEAL (R106) ON

260mm CEMENT STABILISED BASE COURSE (DGB20, 3% BY MASS, E=3,500MPa, R73) ON

300mm THICKNESS CONTROLLED SUBGRADE (4% HYDRATED LIME) REFER NOTE 2

RAISED MEDIAN INFILL

125mm THICKNESS N25 CONCRETE (1 LAYER SL82 MESH) ON

100mm THICKNESS DGB20 COMPACTED ROAD BASE

DRIVEWAY ACCESS

150mm THICKNESS N32 CONCRETE (1 LAYER SL82 MESH) ON

100mm THICKNESS DGB20 COMPACTED ROAD BASE

SHARED PATH

150mm THICKNESS N25 CONCRETE (1 LAYER F72 MESH) ON

150mm THICKNESS DGB20 COMPACTED ROAD BASE

REFER TO RMS STANDARDS FOR JOINTING DETAILS.

FOOTPATH

100mm THICKNESS N25 CONCRETE (1 LAYER F72 MESH) ON

100mm THICKNESS DGB20 COMPACTED ROAD BASE

REFER TO RMS STANDARDS FOR JOINTING DETAILS.

LANDSCAPING

TURF AND STREET TREES

NOTE: PAVEMENT DESIGN BASED ON ASSUMED CBR OF 3%

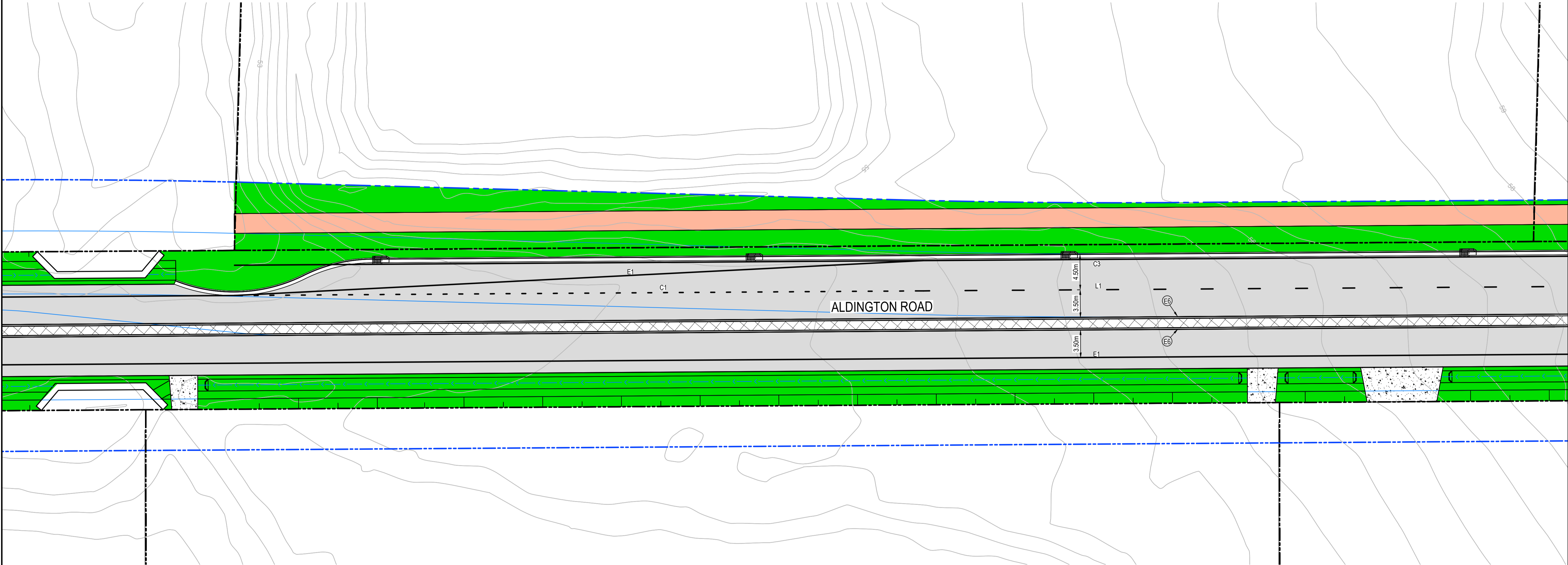

CONCEPT

INTERIM DESIGN MAY BE STAGED AND DELIVERED TO SUIT TIMING OF LAND DEDICATION

0 5 10 15 20 25m

1 : 250 @ A1 1 : 500 @ A3

H	ISSUED FOR INFORMATION	13-04-22
G	ISSUED FOR INFORMATION	03-02-22
F	ISSUED FOR INFORMATION	07-12-21
E	ISSUED FOR INFORMATION	24-09-21
D	ISSUED FOR INFORMATION	08-09-21
C	ISSUED FOR INFORMATION	24-05-21
B	ISSUED FOR INFORMATION	12-05-21
A	ISSUED FOR PRICING	12-04-21
Issue	Description	Date

THIS DRAWING CANNOT BE COPIED OR REPRODUCED IN ANY FORM OR USED FOR ANY OTHER PURPOSE OTHER THAN THAT ORIGINALLY INTENDED WITHOUT THE WRITTEN PERMISSION OF AT&L

Client

FRASERS PROPERTY

ESR

Stockland

FIFECAPITAL

Scales

1 : 250

Grid

GDA2020

Height Datum

AHD

Drawn

ASD

Designed

ASD

Checked

AMcL

Approved

AMcL

Project

ABBOTTS ROAD AND ALDINGTON ROAD CONCEPT DESIGN

Title

PAVEMENT AND LINEMARKING PLAN SHEET 8

Civil Engineers and Project Managers

Level 7, 153 Walker Street
North Sydney NSW 2060
ABN 96 130 882 405
Tel: 02 9439 1777
Fax: 02 9923 1055
www.atl.net.au
info@atl.net.au

Status

FOR INFORMATION
NOT TO BE ISSUED FOR CONSTRUCTION

Project - Drawing No.

21-843-C557

Issue

H

A1

Date Plotted: 13 Apr 2022 - 12:20PM File Name: F:\21-843 Aldington Road Design\6.0 Drgs\Civil\Final\500_Aldington Road Concept Design\21-843-C557.dwg

LEGEND

WORKS BY OTHERS

PAVEMENT MARKING SCHEDULE

EDGE LINES

E1

E5

E6

LANE LINES

L1

L4

BARRIER LINES

BB

CONTINUITY LINES

C1

CLEARWAY LINES

C3

GIVEWAY LINE

TB

STOP LINE

TF

PAVEMENT ARROWS

AR3(L)

AR3(R)

AR4(L)

AR4(R)

ARU5(R)

PAVEMENT DETAILS

ALDINGTON ROAD/ABBOTT ROAD PAVEMENT

50mm THICKNESS AC14 (A15E) ON

65mm THICKNESS AC20 (C320) ON

7mm PRIMERSEAL (R106) ON

260mm CEMENT STABILISED BASE COURSE (DGB20, 3% BY MASS, E=3,500MPa, R73) ON

300mm THICKNESS CONTROLLED SUBGRADE (4% HYDRATED LIME) REFER NOTE 2

RAISED MEDIAN INFILL

125mm THICKNESS N25 CONCRETE (1 LAYER SL82 MESH) ON

100mm THICKNESS DGB20 COMPACTED ROAD BASE

DRIVEWAY ACCESS

150mm THICKNESS N32 CONCRETE (1 LAYER SL82 MESH) ON

100mm THICKNESS DGB20 COMPACTED ROAD BASE

SHARED PATH

150mm THICKNESS N25 CONCRETE (1 LAYER F72 MESH) ON

150mm THICKNESS DGB20 COMPACTED ROAD BASE

REFER TO RMS STANDARDS FOR JOINTING DETAILS.

FOOTPATH

100mm THICKNESS N25 CONCRETE (1 LAYER F72 MESH) ON

100mm THICKNESS DGB20 COMPACTED ROAD BASE

REFER TO RMS STANDARDS FOR JOINTING DETAILS.

LANDSCAPING

TURF AND STREET TREES

NOTE:

PAVEMENT DESIGN BASED ON ASSUMED CBR OF 3%

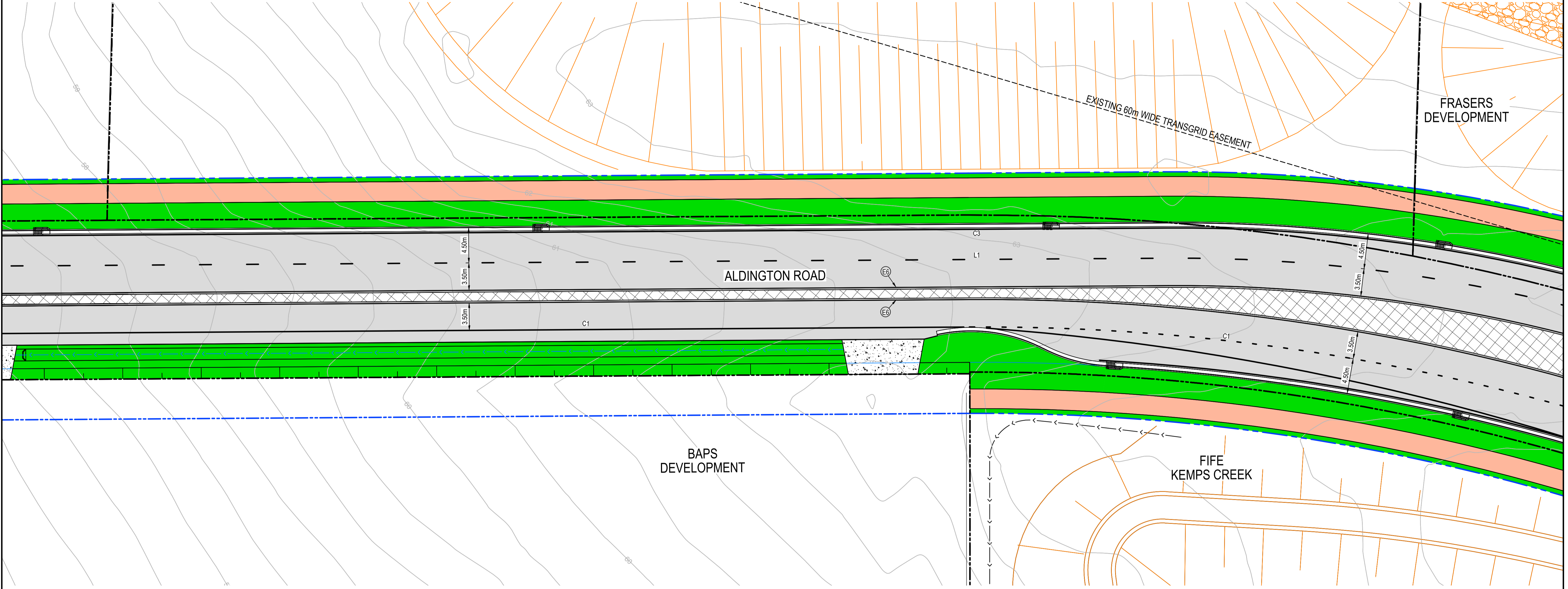
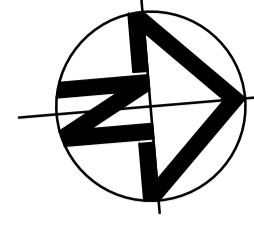

CONCEPT

INTERIM DESIGN MAY BE STAGED AND DELIVERED TO SUIT TIMING OF LAND DEDICATION

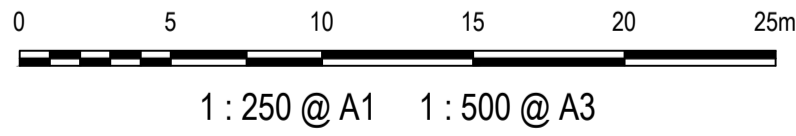

Issue	Description	Date
H	ISSUED FOR INFORMATION	13-04-22
G	ISSUED FOR INFORMATION	03-02-22
F	ISSUED FOR INFORMATION	07-12-21
E	ISSUED FOR INFORMATION	24-09-21
D	ISSUED FOR INFORMATION	08-09-21
C	ISSUED FOR INFORMATION	24-05-21
B	ISSUED FOR INFORMATION	12-05-21
A	ISSUED FOR PRICING	12-04-21



THIS DRAWING CANNOT BE COPIED OR REPRODUCED IN ANY FORM OR USED FOR ANY OTHER PURPOSE OTHER THAN THAT ORIGINALLY INTENDED WITHOUT THE WRITTEN PERMISSION OF AT&L

Client

FRASERS PROPERTY

ESR

Stockland

FIFECAPITAL

Scales	1 : 250	Drawn	ASD
Grid	GDA2020	Designed	ASD
Height Datum	AHD	Checked	AMcL
		Approved	AMcL

Project

ABBOTTS ROAD AND ALDINGTON ROAD CONCEPT DESIGN

Title

PAVEMENT AND LINEMARKING PLAN SHEET 9

Civil Engineers and Project Managers

at&l

Level 7, 153 Walker Street
North Sydney NSW 2060
ABN 96 130 882 405
Tel: 02 9439 1777
Fax: 02 9923 1055
www.atl.net.au
info@atl.net.au

Status

FOR INFORMATION
NOT TO BE ISSUED FOR CONSTRUCTION

Project - Drawing No.

21-843-C558

Issue

H

LEGEND

WORKS BY OTHERS

PAVEMENT MARKING SCHEDULE

EDGE LINES

E1

E5

E6

LANE LINES

L1

L4

BARRIER LINES

BB

CONTINUITY LINES

C1

CLEARWAY LINES

C3

GIVEWAY LINE

TB

STOP LINE

TF

PAVEMENT ARROWS

AR3(L)

AR3(R)

AR4(L)

AR4(R)

ARU5(R)

PAVEMENT DETAILS

ALDINGTON ROAD/ABBOTT ROAD PAVEMENT

50mm THICKNESS AC14 (A15E) ON

65mm THICKNESS AC20 (C320) ON

65mm THICKNESS AC20 (C320) ON

7mm PRIMERSEAL (R106) ON

260mm CEMENT STABILISED BASE COURSE (DGB20, 3% BY MASS, E=3,500MPa, R73) ON

300mm THICKNESS CONTROLLED SUBGRADE (4% HYDRATED LIME) REFER NOTE 2

RAISED MEDIAN INFILL

125mm THICKNESS N25 CONCRETE (1 LAYER SL82 MESH) ON

100mm THICKNESS DGB20 COMPACTED ROAD BASE

DRIVEWAY ACCESS

150mm THICKNESS N32 CONCRETE (1 LAYER SL82 MESH) ON

100mm THICKNESS DGB20 COMPACTED ROAD BASE

SHARED PATH

150mm THICKNESS N25 CONCRETE (1 LAYER F72 MESH) ON

150mm THICKNESS DGB20 COMPACTED ROAD BASE

REFER TO RMS STANDARDS FOR JOINTING DETAILS.

FOOTPATH

100mm THICKNESS N25 CONCRETE (1 LAYER F72 MESH) ON

100mm THICKNESS DGB20 COMPACTED ROAD BASE

REFER TO RMS STANDARDS FOR JOINTING DETAILS.

LANDSCAPING

TURF AND STREET TREES

NOTE: PAVEMENT DESIGN BASED ON ASSUMED CBR OF 3%

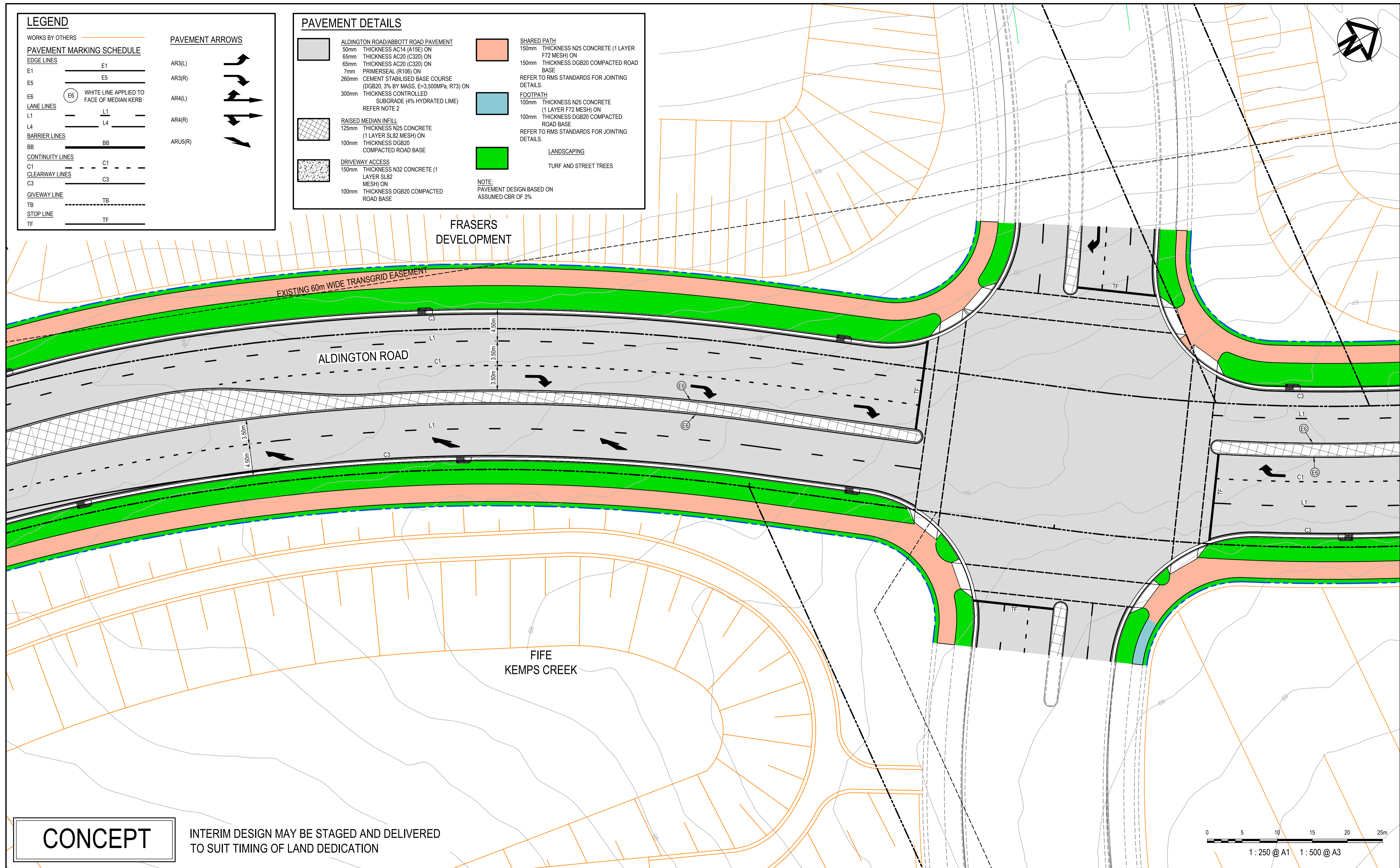

CONCEPT

INTERIM DESIGN MAY BE STAGED AND DELIVERED TO SUIT TIMING OF LAND DEDICATION

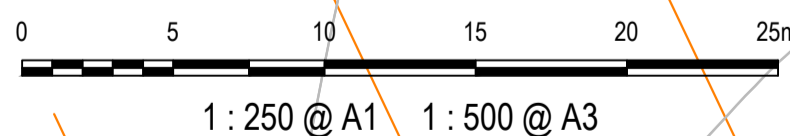

Issue	Description	Date
H	ISSUED FOR INFORMATION	13-04-22
G	ISSUED FOR INFORMATION	03-02-22
F	ISSUED FOR INFORMATION	07-12-21
E	ISSUED FOR INFORMATION	24-09-21
D	ISSUED FOR INFORMATION	08-09-21
C	ISSUED FOR INFORMATION	24-05-21
B	ISSUED FOR INFORMATION	12-05-21
A	ISSUED FOR PRICING	12-04-21



THIS DRAWING CANNOT BE COPIED OR REPRODUCED IN ANY FORM OR USED FOR ANY OTHER PURPOSE OTHER THAN THAT ORIGINALLY INTENDED WITHOUT THE WRITTEN PERMISSION OF AT&L

Client

FRASERS PROPERTY

ESR

Stockland

FIFECAPITAL

Scales

1 : 250

Grid

GDA2020

Height Datum

AHD

GDA2020

Drawn

ASD

Designed

ASD

Checked

AMcL

Approved

AMcL

Project

ABBOTTS ROAD AND ALDINGTON ROAD CONCEPT DESIGN

Title

PAVEMENT AND LINEMARKING PLAN SHEET 10

Civil Engineers and Project Managers

at&l

Level 7, 153 Walker Street North Sydney NSW 2060
ABN 96 130 882 405
Tel: 02 9439 1777
Fax: 02 9923 1055
www.atl.net.au
info@atl.net.au

FOR INFORMATION
NOT TO BE ISSUED FOR CONSTRUCTION

Project - Drawing No.
21-843-C559

Issue
H

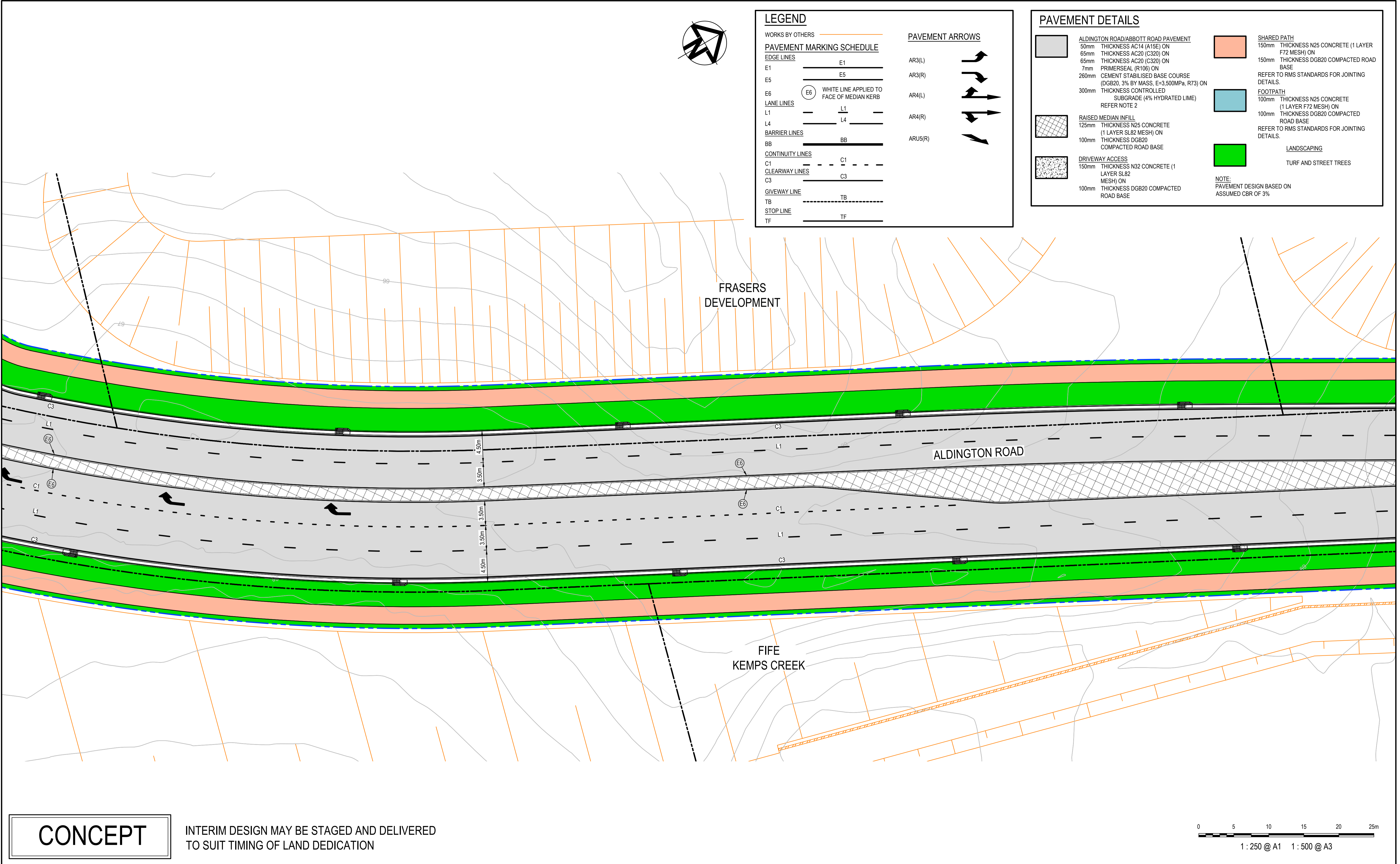

LEGEND

WORKS BY OTHERS

PAVEMENT MARKING SCHEDULE

PAVEMENT ARROWS

PAVEMENT DETAILS

ALDINGTON ROAD/ABBOTT ROAD PAVEMENT

50mm THICKNESS AC14 (A15E) ON

65mm THICKNESS AC20 (C320) ON

65mm THICKNESS AC20 (C320) ON

7mm PRIMERSEAL (R106) ON

260mm CEMENT STABILISED BASE COURSE (DGB20, 3% BY MASS, E=3.500MPa, R73) ON

300mm THICKNESS CONTROLLED SUBGRADE (4% HYDRATED LIME) REFER NOTE 2

RAISED MEDIAN INFILL

125mm THICKNESS N25 CONCRETE (1 LAYER SL82 MESH) ON

100mm THICKNESS DGB20 COMPACTED ROAD BASE

DRIVEWAY ACCESS

150mm THICKNESS N32 CONCRETE (1 LAYER SL82 MESH) ON

100mm THICKNESS DGB20 COMPACTED ROAD BASE

SHARED PATH

150mm THICKNESS N25 CONCRETE (1 LAYER F72 MESH) ON

150mm THICKNESS DGB20 COMPACTED ROAD BASE

REFER TO RMS STANDARDS FOR JOINTING DETAILS.

FOOTPATH

100mm THICKNESS N25 CONCRETE (1 LAYER F72 MESH) ON

100mm THICKNESS DGB20 COMPACTED ROAD BASE

REFER TO RMS STANDARDS FOR JOINTING DETAILS.

LANDSCAPING

TURF AND STREET TREES

NOTE:

PAVEMENT DESIGN BASED ON ASSUMED CBR OF 3%

CONCEPT

INTERIM DESIGN MAY BE STAGED AND DELIVERED TO SUIT TIMING OF LAND DEDICATION

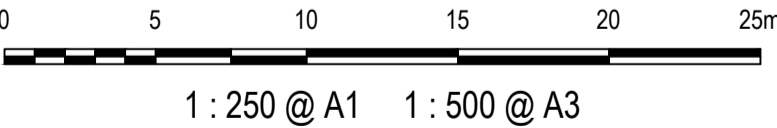

H	ISSUED FOR INFORMATION	13-04-22
G	ISSUED FOR INFORMATION	03-02-22
F	ISSUED FOR INFORMATION	07-12-21
E	ISSUED FOR INFORMATION	24-09-21
D	ISSUED FOR INFORMATION	08-09-21
C	ISSUED FOR INFORMATION	24-05-21
B	ISSUED FOR INFORMATION	12-05-21
A	ISSUED FOR PRICING	12-04-21

KEY PLAN

THIS DRAWING CANNOT BE COPIED OR REPRODUCED IN ANY FORM OR USED FOR ANY OTHER PURPOSE OTHER THAN THAT ORIGINALLY INTENDED WITHOUT THE WRITTEN PERMISSION OF AT&L

Scales

1 : 250

Grid

GDA2020

Height Datum

AHD

Drawn

ASD

Designed

ASD

Checked

AMoL

Approved

AMoL

Project

ABBOTTS ROAD AND ALDINGTON ROAD CONCEPT DESIGN

Title

PAVEMENT AND LINEMARKING PLAN SHEET 11

Civil Engineers and Project Managers

Level 7, 153 Walker Street
North Sydney NSW 2060
ABN 96 130 882 405
Tel: 02 9439 1777
Fax: 02 9923 1055
www.atl.net.au
info@atl.net.au

Status

FOR INFORMATION
NOT TO BE ISSUED FOR CONSTRUCTION

Project - Drawing No.

21-843-C560

Issue

H

Date Plotted: 13 Apr 2022 - 12:22PM

File Name: F:\21-843 Aldington Road Design\6.0 Drgs\Civil\Final\500_Aldington Road Concept Design\21-843-C560.dwg

LEGEND

WORKS BY OTHERS

PAVEMENT MARKING SCHEDULE

EDGE LINES	
E1	E1
E5	E5
E6	E6 WHITE LINE APPLIED TO FACE OF MEDIAN KERB
LANE LINES	
L1	L1
L4	L4
BARRIER LINES	
BB	BB
CONTINUITY LINES	
C1	C1
CLEARWAY LINES	
C3	C3
GIVEWAY LINE	
TB	TB
STOP LINE	
TF	TF

PAVEMENT ARROWS

AR3(L)	
AR3(R)	
AR4(L)	
AR4(R)	
ARU5(R)	

PAVEMENT DETAILS

	ALDINGTON ROAD/ABBOTT ROAD PAVEMENT 50mm THICKNESS AC14 (A15E) ON 65mm THICKNESS AC20 (C320) ON 7mm PRIMERSEAL (R106) ON 260mm CEMENT STABILISED BASE COURSE (DGB20, 3% BY MASS, E=3,500MPa, R73) ON 300mm THICKNESS CONTROLLED SUBGRADE (4% HYDRATED LIME) REFER NOTE 2		SHARED PATH 150mm THICKNESS N25 CONCRETE (1 LAYER F72 MESH) ON 150mm THICKNESS DGB20 COMPACTED ROAD BASE REFER TO RMS STANDARDS FOR JOINTING DETAILS.
	RAISED MEDIAN INFILL 125mm THICKNESS N25 CONCRETE (1 LAYER SL82 MESH) ON 100mm THICKNESS DGB20 COMPACTED ROAD BASE		FOOTPATH 100mm THICKNESS N25 CONCRETE (1 LAYER F72 MESH) ON 100mm THICKNESS DGB20 COMPACTED ROAD BASE REFER TO RMS STANDARDS FOR JOINTING DETAILS.
	DRIVEWAY ACCESS 150mm THICKNESS N32 CONCRETE (1 LAYER SL82 MESH) ON 100mm THICKNESS DGB20 COMPACTED ROAD BASE		LANDSCAPING TURF AND STREET TREES

NOTE:
PAVEMENT DESIGN BASED ON
ASSUMED CBR OF 3%

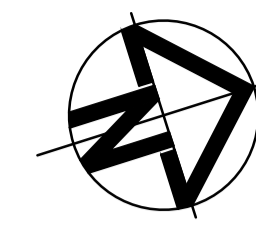

CONCEPT

INTERIM DESIGN MAY BE STAGED AND DELIVERED
TO SUIT TIMING OF LAND DEDICATION

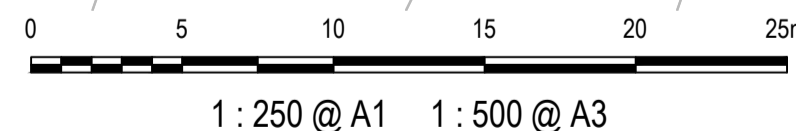

Issue	Description	Date
H	ISSUED FOR INFORMATION	13-04-22
G	ISSUED FOR INFORMATION	03-02-22
F	ISSUED FOR INFORMATION	07-12-21
E	ISSUED FOR INFORMATION	24-09-21
D	ISSUED FOR INFORMATION	08-09-21
C	ISSUED FOR INFORMATION	24-05-21
B	ISSUED FOR INFORMATION	12-05-21
A	ISSUED FOR PRICING	12-04-21



THIS DRAWING CANNOT BE
COPIED OR REPRODUCED IN
ANY FORM OR USED FOR ANY
OTHER PURPOSE OTHER THAN
THAT ORIGINALLY INTENDED
WITHOUT THE WRITTEN
PERMISSION OF AT&L

Client

Scales	1 : 250	Drawn	ASD
Grid	GDA2020	Designed	ASD
Height Datum	AHD	Checked	AMcL
		Approved	AMcL

Project

ABBOTTS ROAD AND
ALDINGTON ROAD
CONCEPT DESIGN

Title

PAVEMENT
AND LINEMARKING
PLAN
SHEET 12

Civil Engineers and Project Managers

Level 7, 153 Walker Street
North Sydney NSW 2060
ABN 96 130 882 405
Tel: 02 9439 1777
Fax: 02 9923 1055
www.atl.net.au
info@atl.net.au

Status

FOR INFORMATION
NOT TO BE ISSUED FOR CONSTRUCTION

Project - Drawing No.

21-843-C561

Issue

H

LEGEND

WORKS BY OTHERS

PAVEMENT MARKING SCHEDULE

EDGE LINES

E1

E5

E6

LANE LINES

L1

L4

BARRIER LINES

BB

CONTINUITY LINES

C1

CLEARWAY LINES

C3

GIVEWAY LINE

TB

STOP LINE

TF

PAVEMENT ARROWS

AR3(L)

AR3(R)

AR4(L)

AR4(R)

ARU5(R)

PAVEMENT DETAILS

ALDINGTON ROAD/ABBOTT ROAD PAVEMENT

50mm THICKNESS AC14 (A15E) ON

65mm THICKNESS AC20 (C320) ON

65mm THICKNESS AC20 (C320) ON

7mm PRIMERSEAL (R106) ON

260mm CEMENT STABILISED BASE COURSE (DGB20, 3% BY MASS, E=3,500MPa, R73) ON

300mm THICKNESS CONTROLLED SUBGRADE (4% HYDRATED LIME) REFER NOTE 2

RAISED MEDIAN INFILL

125mm THICKNESS N25 CONCRETE (1 LAYER SL82 MESH) ON

100mm THICKNESS DGB20 COMPACTED ROAD BASE

DRIVEWAY ACCESS

150mm THICKNESS N32 CONCRETE (1 LAYER SL82 MESH) ON

100mm THICKNESS DGB20 COMPACTED ROAD BASE

SHARED PATH

150mm THICKNESS N25 CONCRETE (1 LAYER F72 MESH) ON

150mm THICKNESS DGB20 COMPACTED ROAD BASE

REFER TO RMS STANDARDS FOR JOINTING DETAILS.

FOOTPATH

100mm THICKNESS N25 CONCRETE (1 LAYER F72 MESH) ON

100mm THICKNESS DGB20 COMPACTED ROAD BASE

REFER TO RMS STANDARDS FOR JOINTING DETAILS.

LANDSCAPING

TURF AND STREET TREES

NOTE: PAVEMENT DESIGN BASED ON ASSUMED CBR OF 3%

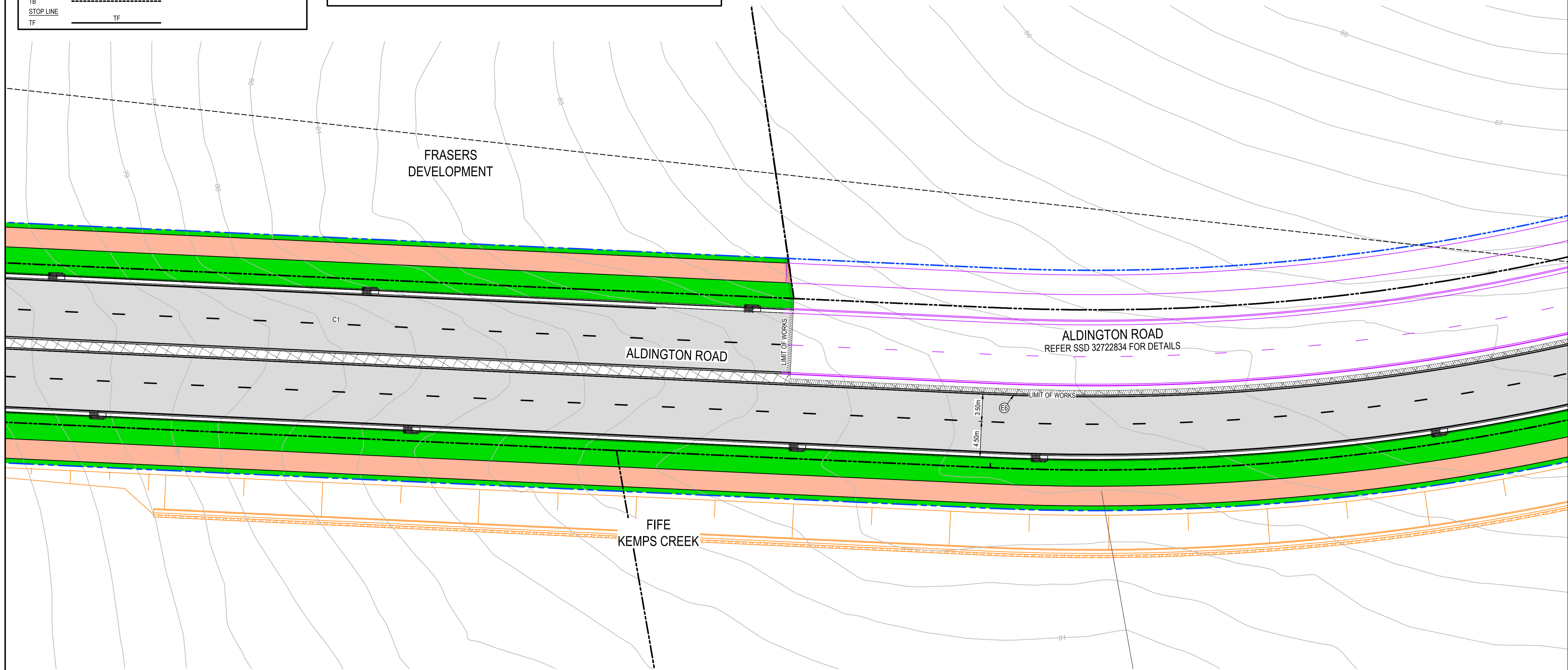

CONCEPT

INTERIM DESIGN MAY BE STAGED AND DELIVERED TO SUIT TIMING OF LAND DEDICATION

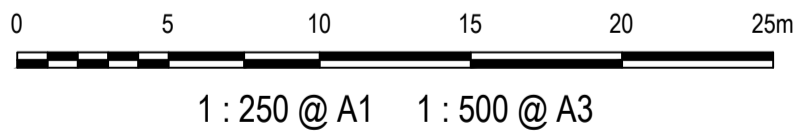

H	ISSUED FOR INFORMATION	13-04-22
G	ISSUED FOR INFORMATION	03-02-22
F	ISSUED FOR INFORMATION	07-12-21
E	ISSUED FOR INFORMATION	24-09-21
D	ISSUED FOR INFORMATION	08-09-21
C	ISSUED FOR INFORMATION	24-05-21
B	ISSUED FOR INFORMATION	12-05-21
A	ISSUED FOR PRICING	12-04-21
Issue	Description	Date

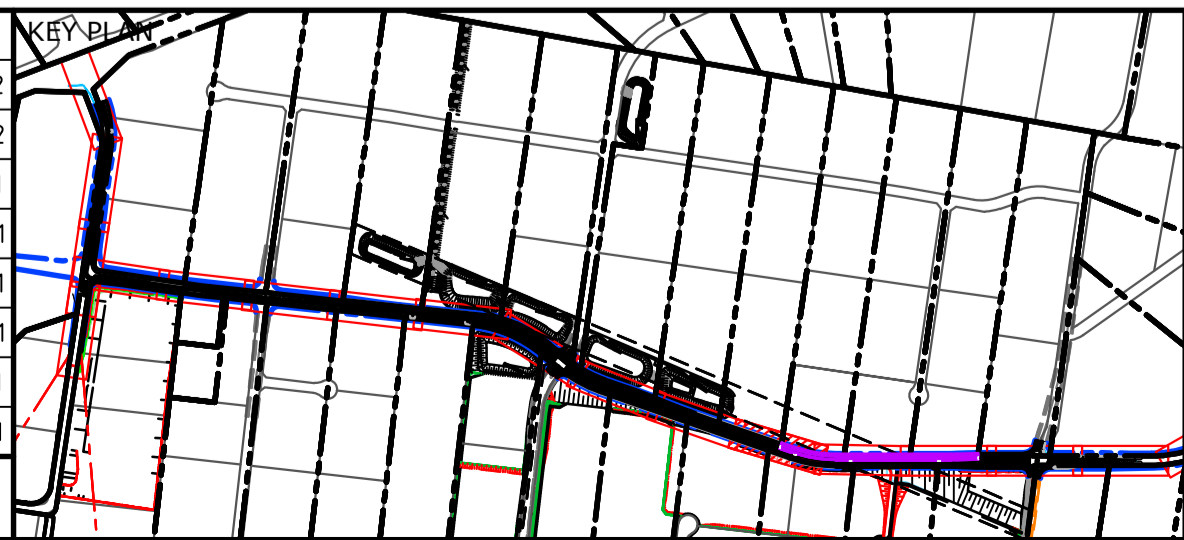

THIS DRAWING CANNOT BE COPIED OR REPRODUCED IN ANY FORM OR USED FOR ANY OTHER PURPOSE OTHER THAN THAT ORIGINALLY INTENDED WITHOUT THE WRITTEN PERMISSION OF AT&L

Client

FRASERS PROPERTY

ESR

Stockland

FIFECAPITAL

Scales

1 : 250

Grid

GDA2020

Height Datum

AHD

GDA2020

Project

ABBOTTS ROAD AND ALDINGTON ROAD CONCEPT DESIGN

Title

PAVEMENT AND LINEMARKING PLAN SHEET 13

Civil Engineers and Project Managers

at&l

Level 7, 153 Walker Street North Sydney NSW 2060
ABN 96 130 882 405
Tel: 02 9439 1777
Fax: 02 9923 1055
www.atl.net.au
info@atl.net.au

Status

FOR INFORMATION NOT TO BE ISSUED FOR CONSTRUCTION

Project - Drawing No.

21-843-C562

Issue

H

LEGEND

WORKS BY OTHERS

PAVEMENT MARKING SCHEDULE

EDGE LINES

E1

E5

E6

LANE LINES

L1

L4

BARRIER LINES

BB

CONTINUITY LINES

C1

CLEARWAY LINES

C3

GIVEWAY LINE

TB

STOP LINE

TF

PAVEMENT ARROWS

AR3(L)

AR3(R)

AR4(L)

AR4(R)

ARU5(R)

PAVEMENT DETAILS

ALDINGTON ROAD/ABBOTT ROAD PAVEMENT

50mm THICKNESS AC14 (A15E) ON

65mm THICKNESS AC20 (C320) ON

65mm THICKNESS AC20 (C320) ON

7mm PRIMERSEAL (R106) ON

260mm CEMENT STABILISED BASE COURSE (DGB20, 3% BY MASS, E=3,500MPa, R73) ON

300mm THICKNESS CONTROLLED SUBGRADE (4% HYDRATED LIME) REFER NOTE 2

RAISED MEDIAN INFILL

125mm THICKNESS N25 CONCRETE (1 LAYER SL82 MESH) ON

100mm THICKNESS DGB20 COMPACTED ROAD BASE

DRIVEWAY ACCESS

150mm THICKNESS N32 CONCRETE (1 LAYER SL82 MESH) ON

100mm THICKNESS DGB20 COMPACTED ROAD BASE

SHARED PATH

150mm THICKNESS N25 CONCRETE (1 LAYER F72 MESH) ON

150mm THICKNESS DGB20 COMPACTED ROAD BASE

REFER TO RMS STANDARDS FOR JOINTING DETAILS.

FOOTPATH

100mm THICKNESS N25 CONCRETE (1 LAYER F72 MESH) ON

100mm THICKNESS DGB20 COMPACTED ROAD BASE

REFER TO RMS STANDARDS FOR JOINTING DETAILS.

LANDSCAPING

TURF AND STREET TREES

NOTE: PAVEMENT DESIGN BASED ON ASSUMED CBR OF 3%

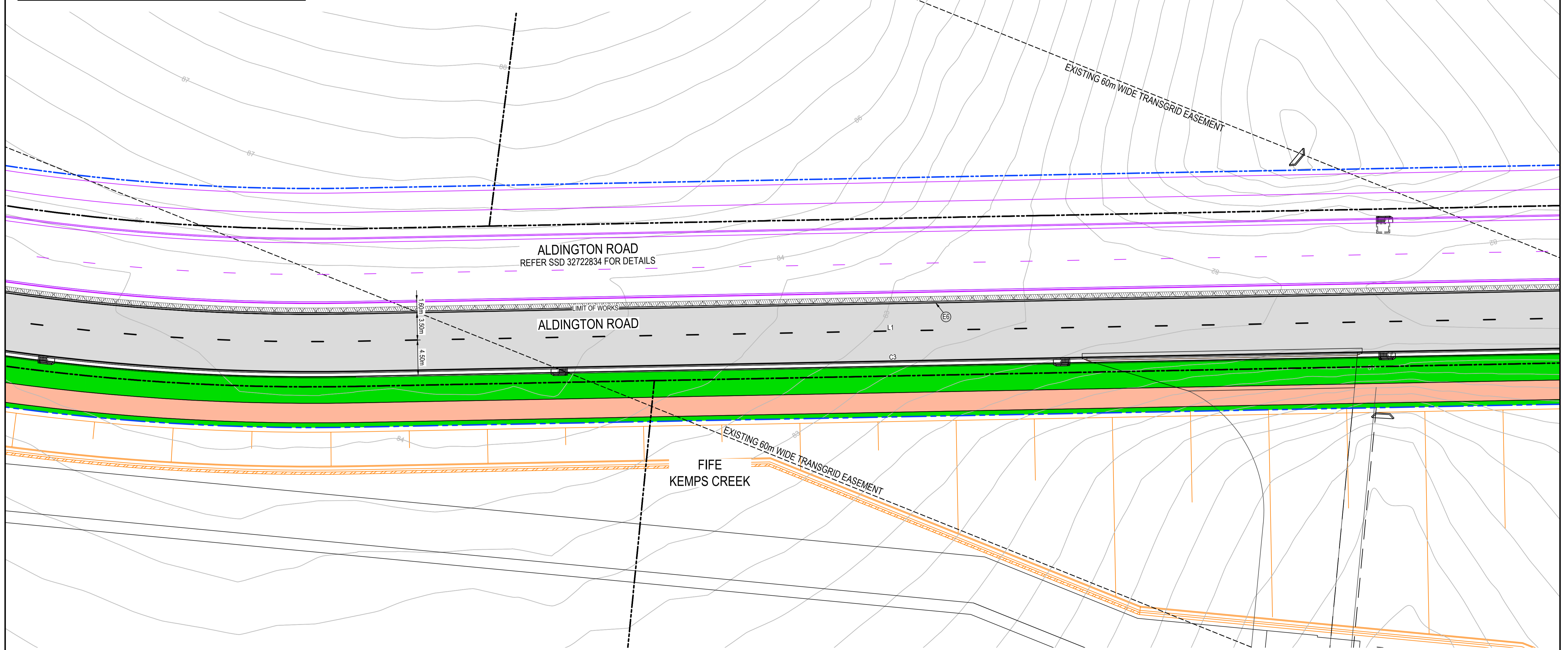

CONCEPT

INTERIM DESIGN MAY BE STAGED AND DELIVERED TO SUIT TIMING OF LAND DEDICATION

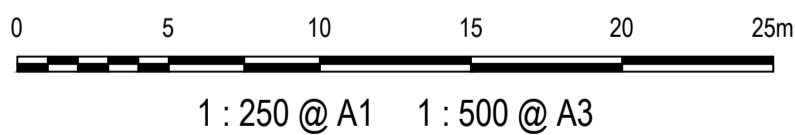

Issue	Description	Date
H	ISSUED FOR INFORMATION	13-04-22
G	ISSUED FOR INFORMATION	03-02-22
F	ISSUED FOR INFORMATION	07-12-21
E	ISSUED FOR INFORMATION	24-09-21
D	ISSUED FOR INFORMATION	08-09-21
C	ISSUED FOR INFORMATION	24-05-21
B	ISSUED FOR INFORMATION	12-05-21
A	ISSUED FOR PRICING	12-04-21



THIS DRAWING CANNOT BE COPIED OR REPRODUCED IN ANY FORM OR USED FOR ANY OTHER PURPOSE OTHER THAN THAT ORIGINALLY INTENDED WITHOUT THE WRITTEN PERMISSION OF AT&L

Client

FRASERS PROPERTY

ESR

Stockland

FIFECAPITAL

Scales

1 : 250

Grid

GDA2020

Height Datum

AHD

GDA2020

Project

ABBOTTS ROAD AND ALDINGTON ROAD CONCEPT DESIGN

Title

PAVEMENT AND LINEMARKING PLAN SHEET 14

Civil Engineers and Project Managers

at&l

Level 7, 153 Walker Street North Sydney NSW 2060
ABN 96 130 882 405
Tel: 02 9439 1777
Fax: 02 9923 1055
www.atl.net.au
info@atl.net.au

Status

FOR INFORMATION NOT TO BE ISSUED FOR CONSTRUCTION

Project - Drawing No.

21-843-C563

Issue

H

A1

LEGEND

WORKS BY OTHERS

PAVEMENT MARKING SCHEDULE

EDGE LINES

E1

E5

E6

LANE LINES

L1

L4

BARRIER LINES

BB

CONTINUITY LINES

C1

CLEARWAY LINES

C3

GIVEWAY LINE

TB

STOP LINE

TF

PAVEMENT ARROWS

AR3(L)

AR3(R)

AR4(L)

AR4(R)

ARU5(R)

PAVEMENT DETAILS

ALDINGTON ROAD/ABBOTT ROAD PAVEMENT

50mm THICKNESS AC14 (A15E) ON

65mm THICKNESS AC20 (C320) ON

65mm THICKNESS AC20 (C320) ON

7mm PRIMERSEAL (R106) ON

260mm CEMENT STABILISED BASE COURSE (DGB20, 3% BY MASS, E=3,500MPa, R73) ON

300mm THICKNESS CONTROLLED SUBGRADE (4% HYDRATED LIME) REFER NOTE 2

RAISED MEDIAN INFILL

125mm THICKNESS N25 CONCRETE (1 LAYER SL82 MESH) ON

100mm THICKNESS DGB20 COMPACTED ROAD BASE

DRIVEWAY ACCESS

150mm THICKNESS N32 CONCRETE (1 LAYER SL82 MESH) ON

100mm THICKNESS DGB20 COMPACTED ROAD BASE

SHARED PATH

150mm THICKNESS N25 CONCRETE (1 LAYER F72 MESH) ON

150mm THICKNESS DGB20 COMPACTED ROAD BASE

REFER TO RMS STANDARDS FOR JOINTING DETAILS.

FOOTPATH

100mm THICKNESS N25 CONCRETE (1 LAYER F72 MESH) ON

100mm THICKNESS DGB20 COMPACTED ROAD BASE

REFER TO RMS STANDARDS FOR JOINTING DETAILS.

LANDSCAPING

TURF AND STREET TREES

NOTE: PAVEMENT DESIGN BASED ON ASSUMED CBR OF 3%

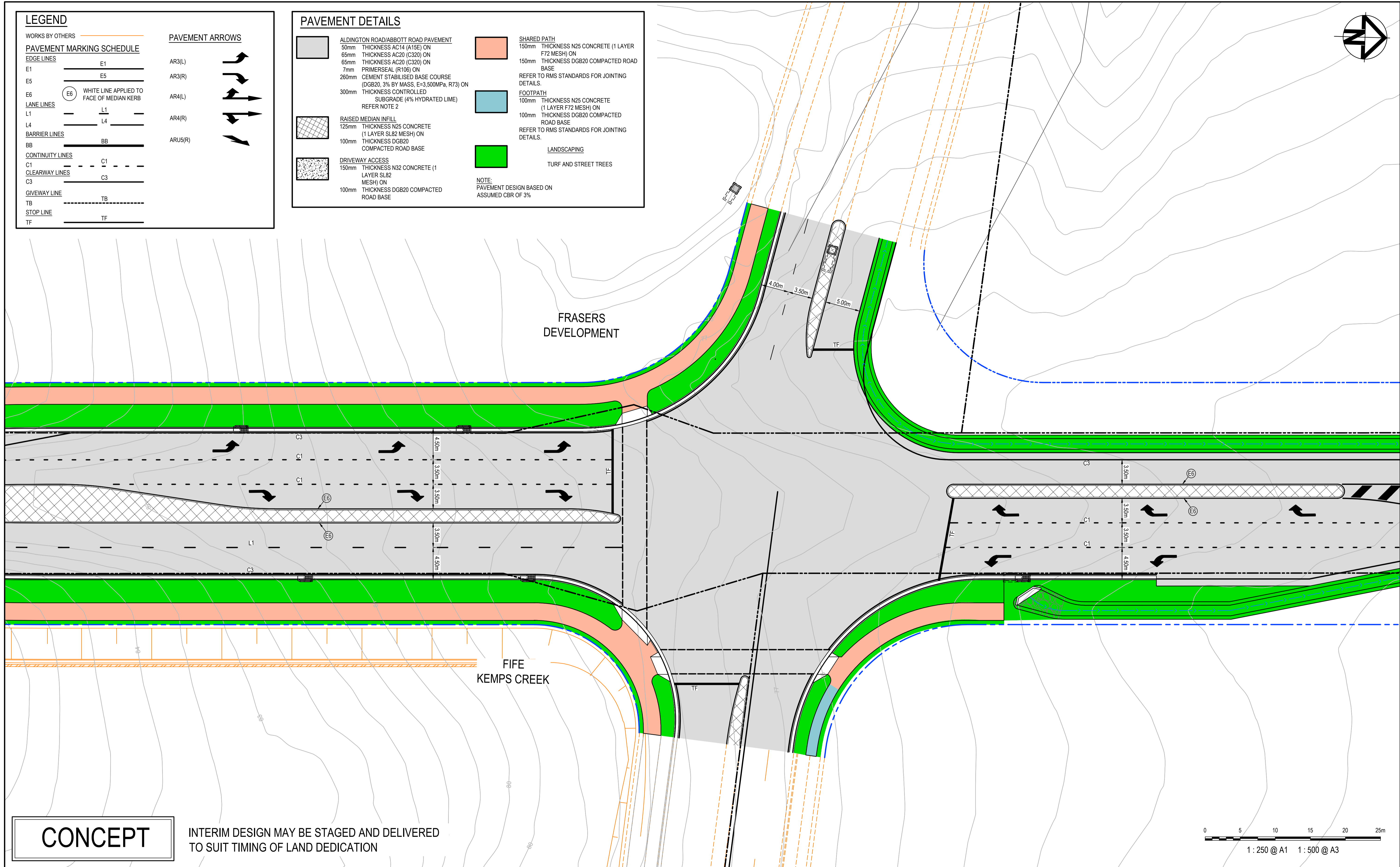

CONCEPT

INTERIM DESIGN MAY BE STAGED AND DELIVERED TO SUIT TIMING OF LAND DEDICATION

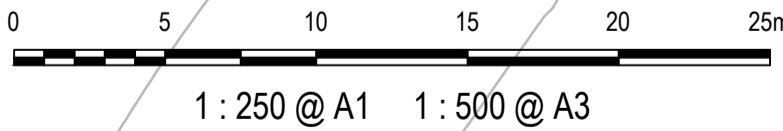

Issue	Description	Date
H	ISSUED FOR INFORMATION	13-04-22
G	ISSUED FOR INFORMATION	03-02-22
F	ISSUED FOR INFORMATION	07-12-21
E	ISSUED FOR INFORMATION	24-09-21
D	ISSUED FOR INFORMATION	08-09-21
C	ISSUED FOR INFORMATION	24-05-21
B	ISSUED FOR INFORMATION	12-05-21
A	ISSUED FOR PRICING	12-04-21

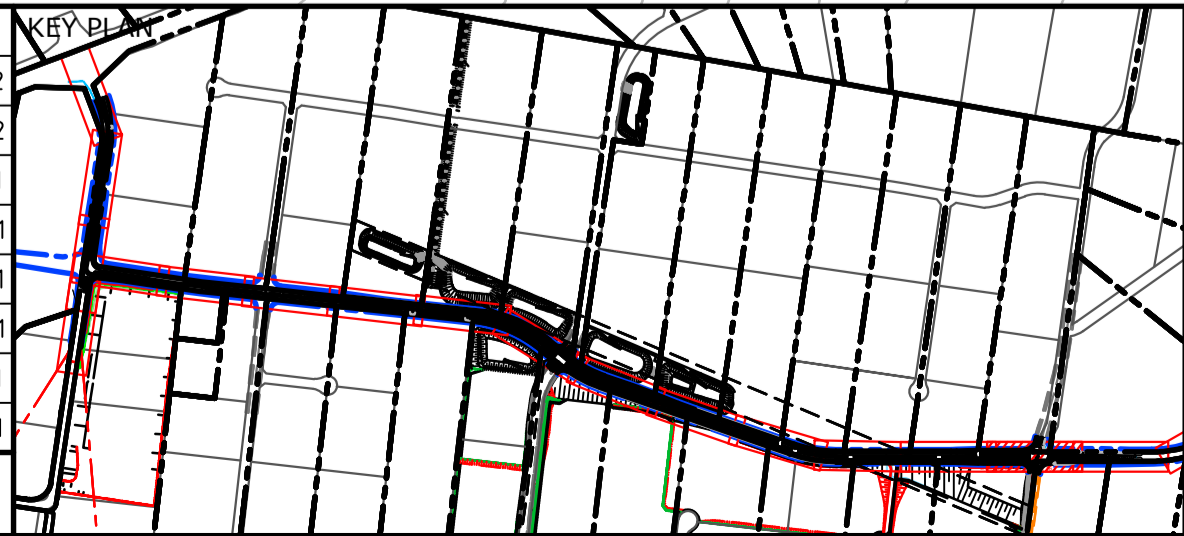

THIS DRAWING CANNOT BE COPIED OR REPRODUCED IN ANY FORM OR USED FOR ANY OTHER PURPOSE OTHER THAN THAT ORIGINALLY INTENDED WITHOUT THE WRITTEN PERMISSION OF AT&L

Client

FRASERS PROPERTY

ESR

Stockland

FIFECAPITAL

Scales

1 : 250

Grid

GDA2020

Height Datum

AHD

GDA2020

Drawn

ASD

Designed

ASD

Checked

AMcL

Approved

AMcL

Project

ABBOTTS ROAD AND ALDINGTON ROAD CONCEPT DESIGN

Title

PAVEMENT AND LINEMARKING PLAN SHEET 16

Civil Engineers and Project Managers

at&l

Level 7, 153 Walker Street
North Sydney NSW 2060
ABN 96 130 882 405
Tel: 02 9439 1777
Fax: 02 9923 1055
www.atl.net.au
info@atl.net.au

Status

FOR INFORMATION
NOT TO BE ISSUED FOR CONSTRUCTION

Project - Drawing No.

21-843-C565

Issue

H

LEGEND

WORKS BY OTHERS

PAVEMENT MARKING SCHEDULE

EDGE LINES

E1

E5

E6

LANE LINES

L1

L4

BARRIER LINES

BB

CONTINUITY LINES

C1

CLEARWAY LINES

C3

GIVEWAY LINE

TB

STOP LINE

TF

PAVEMENT ARROWS

AR3(L)

AR3(R)

AR4(L)

AR4(R)

ARU5(R)

PAVEMENT DETAILS

ALDINGTON ROAD/ABBOTT ROAD PAVEMENT

50mm THICKNESS AC14 (A15E) ON

65mm THICKNESS AC20 (C320) ON

65mm THICKNESS AC20 (C320) ON

7mm PRIMERSEAL (R106) ON

260mm CEMENT STABILISED BASE COURSE (DGB20, 3% BY MASS, E=3,500MPa, R73) ON

300mm THICKNESS CONTROLLED SUBGRADE (4% HYDRATED LIME) REFER NOTE 2

RAISED MEDIAN INFILL

125mm THICKNESS N25 CONCRETE (1 LAYER SL82 MESH) ON

100mm THICKNESS DGB20 COMPACTED ROAD BASE

DRIVEWAY ACCESS

150mm THICKNESS N32 CONCRETE (1 LAYER SL82 MESH) ON

100mm THICKNESS DGB20 COMPACTED ROAD BASE

SHARED PATH

150mm THICKNESS N25 CONCRETE (1 LAYER F72 MESH) ON

150mm THICKNESS DGB20 COMPACTED ROAD BASE

REFER TO RMS STANDARDS FOR JOINTING DETAILS.

FOOTPATH

100mm THICKNESS N25 CONCRETE (1 LAYER F72 MESH) ON

100mm THICKNESS DGB20 COMPACTED ROAD BASE

REFER TO RMS STANDARDS FOR JOINTING DETAILS.

LANDSCAPING

TURF AND STREET TREES

NOTE: PAVEMENT DESIGN BASED ON ASSUMED CBR OF 3%

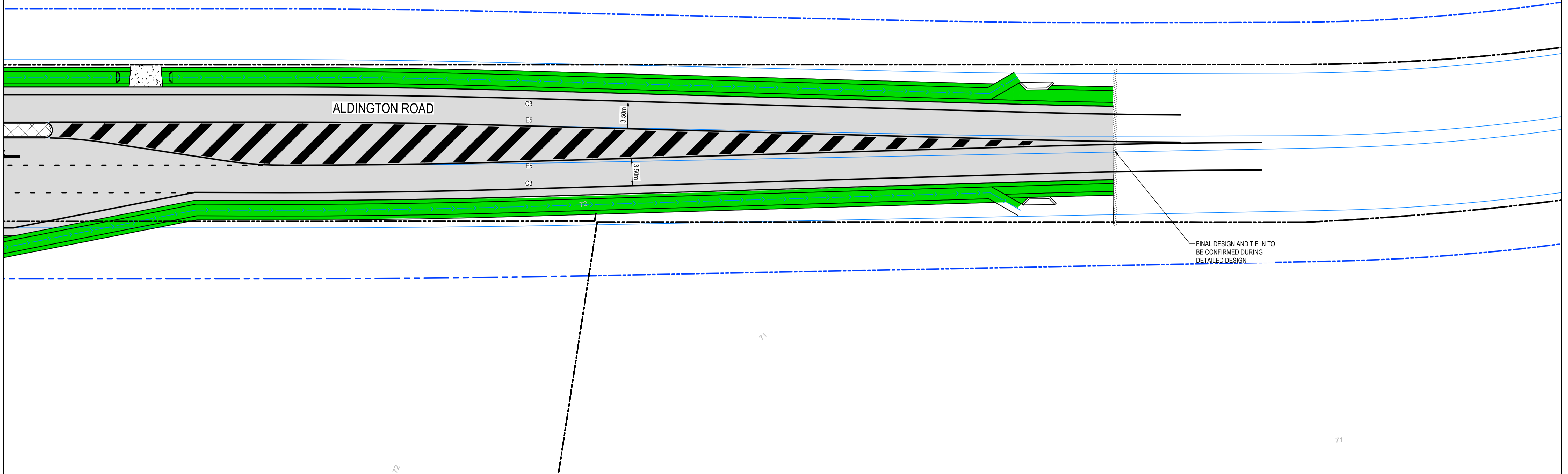

CONCEPT

INTERIM DESIGN MAY BE STAGED AND DELIVERED TO SUIT TIMING OF LAND DEDICATION

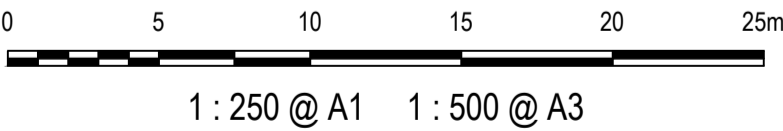

Issue	Description	Date
G	ISSUED FOR INFORMATION	13-04-22
F	ISSUED FOR INFORMATION	03-02-22
E	ISSUED FOR INFORMATION	07-12-21
D	ISSUED FOR INFORMATION	08-09-21
C	ISSUED FOR INFORMATION	24-05-21
B	ISSUED FOR INFORMATION	12-05-21
A	ISSUED FOR PRICING	12-04-21



THIS DRAWING CANNOT BE COPIED OR REPRODUCED IN ANY FORM OR USED FOR ANY OTHER PURPOSE OTHER THAN THAT ORIGINALLY INTENDED WITHOUT THE WRITTEN PERMISSION OF AT&L

Client

FRASERS PROPERTY

ESR

Stockland

FIFECAPITAL

Scales

1 : 250

Grid

GDA2020

Height Datum

AHD

GDA2020

Drawn

ASD

Designed

ASD

Checked

AMcL

Approved

AMcL

Project

ABBOTTS ROAD AND ALDINGTON ROAD CONCEPT DESIGN

Title

PAVEMENT AND LINEMARKING PLAN SHEET 17

Civil Engineers and Project Managers

at&l

Level 7, 153 Walker Street North Sydney NSW 2060
ABN 96 130 882 405
Tel: 02 9439 1777
Fax: 02 9923 1055
www.atl.net.au
info@atl.net.au

Status

FOR INFORMATION NOT TO BE ISSUED FOR CONSTRUCTION

Project - Drawing No.

21-843-C566

Issue

A1

G