

SIGNAGE:	
	TYPE 1 STREET SIGNAGE
	TYPE 2 TENANT IDENTIFICATION SIGNAGE
	TYPE 3 DIRECTION SIGNAGE
	TYPE 4 CORPORATE SIGNAGE

LEGEND:	
	UDLP AREA 2
	WAREHOUSE
	OFFICE
	SHARED PATHWAY
	LANDSCAPE
	OSD

- NOTES:
- UNLESS REFERENCED TO A SITE PLAN, AREAS ARE INDICATIVE ONLY AND SUBJECT TO CHANGE AND DETAIL DESIGN. REFER TO AREA SPECIFIC SITE PLANS FOR DETAILS WHERE AVAILABLE.
 - LANDSCAPE CALCULATIONS ARE SUBJECT TO LANDSCAPE ARCHITECT'S INPUT.
 - LANDSCAPE CALCULATIONS SUBJECT TO WORKS AND MEASUREMENTS ON SITE.

- NOTES:
- ALL LEVELS ARE INDICATIVE & SHOULD BE READ IN CONJUNCTION WITH CIVIL ENG. DWGS FOR FINAL LEVELS OF ALL EARTH WORKS
 - ALL SERVICES RELOCATION TO BE CONFIRMED BY ENG.
 - ALL DESIGNS ARE INDICATIVE AND SUBJECT TO DETAILED DESIGN
 - LANDSCAPE IS SHOWN INDICATIVELY AND IS SUBJECT TO LANDSCAPE ARCHITECTS INPUT.

Notes

-This drawing and design is subject to Reid Campbell (NSW) Pty Ltd copyright and may not be reproduced without prior written consent.
-Contractor to verify all dimensions on site before commencing work.
-Report all discrepancies to project manager prior to construction.
-Figured dimensions to be taken in preference to scaled drawings.
-All work is to conform to relevant Australian Standards and other Codes as applicable, together with other Authorities' requirements and regulations.

NSW Registered Architect Mark David Roach, 10332
NSW Registered Architect James Webb, 10187

Issue	Description	Date	DR	CH
A	Issue for Information	22.04.2020	AM	MF
B	For Submission	09.06.2020	AM	MF
C	For Submission	19.06.2020	AM	MF

REID CAMPBELL
Architecture, Interiors, Project Management
ACN 002 033 891 ABN 28 517 959 875
Level 15, 124 Walker Street
North Sydney NSW 2060 Australia
Tel: 61 02 9954 5011 Email: sydney@reidcampbell.com
Fax: 61 02 9954 4946 Web: www.reidcampbell.com

**MOOREBANK
PRECINCT
EAST - STAGE 2**

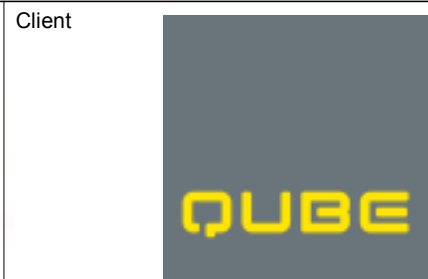

Project
MOOREBANK PRECINCT EAST
MOOREBANK AVENUE,
MOOREBANK, NSW
Drawn Checked Print Date
AM MF 19/06/2020 9:38:57 AM

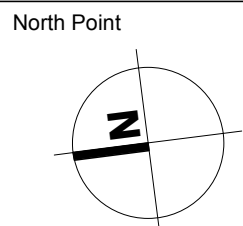

Drawing Title
MPE UDLP - AREA 3

Drawing Number
SSS2-RCG-AR- SKC-175

Issue
C

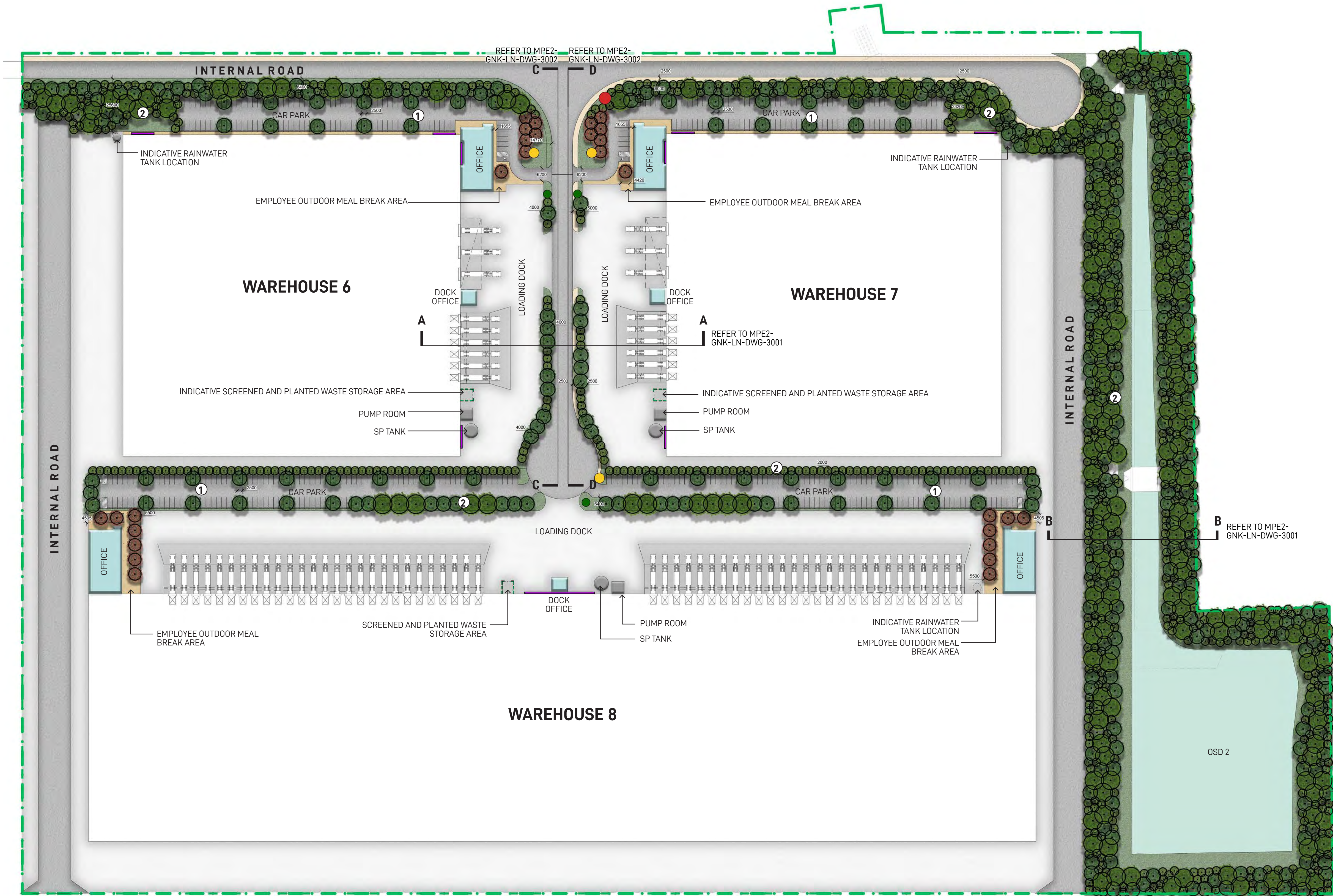

KEY PLAN

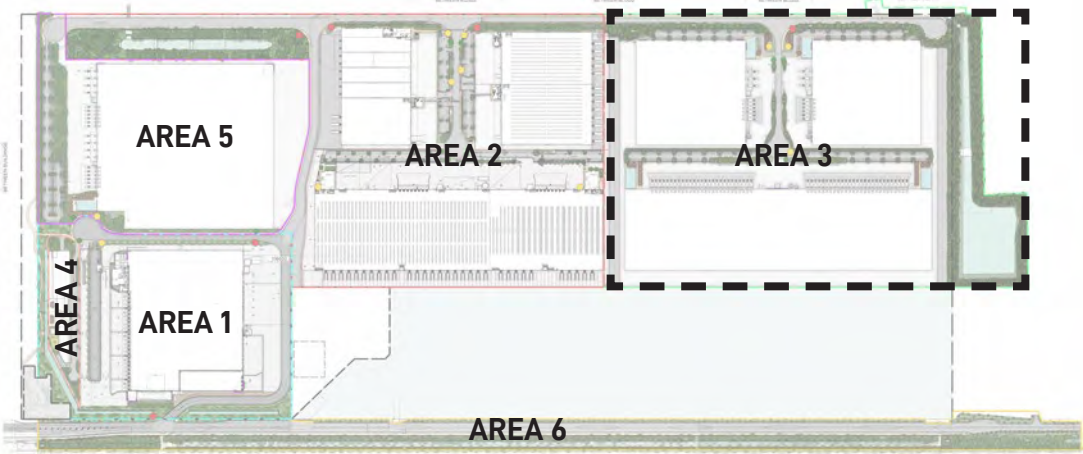

LEGEND

- Area 3 Boundary
- Hard Landscaping
- Proposed Garden Bed
- Proposed Canopy Trees
- Proposed OSD
- Type 1 Street Signage
- Type 2 Tenant Identification Signage
- Type 3 Direction Signage
- Type 4 Corporate Signage
- Proposed canopy tree planting in 2.5M carpark bays spaced at every 6-8 car spaces providing amenity and visual screening of proposed warehousing in accordance with condition b140(e)(iii) & b140(e)(vi)
- Proposed mix of native canopy trees and shrubs providing visual mitigation of proposed warehouses

NOTE
Elements shown in plans are indicative and are subject to final design

INDICATIVE TREE IMAGES

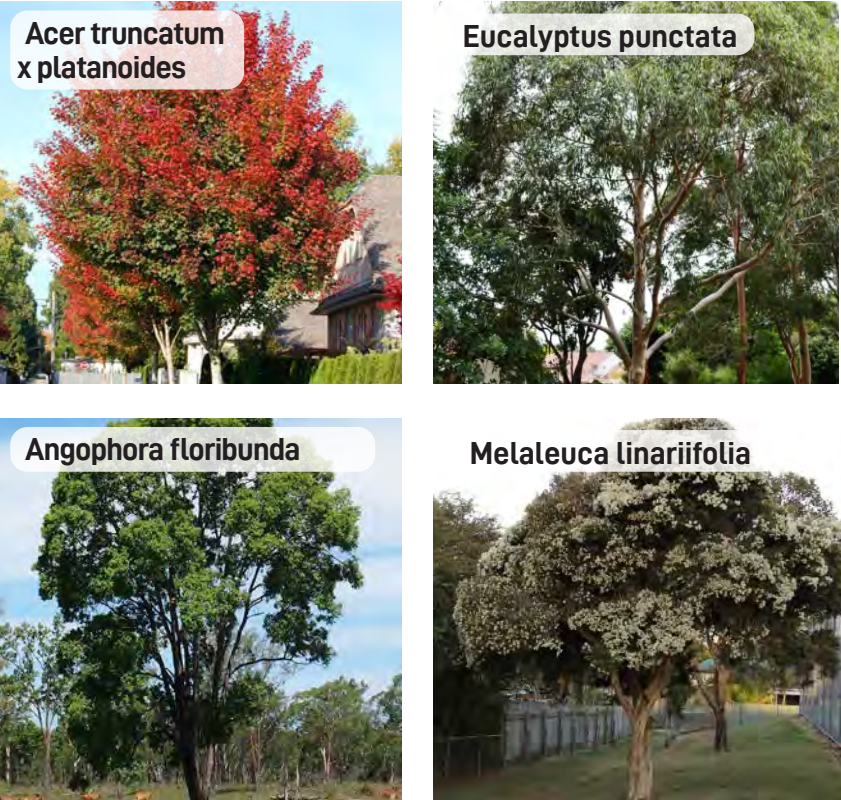

INDICATIVE SHRUB IMAGES



Landscape Architect

GROUND INK

Suite 201, 75 Archer St, Chatswood NSW 2067 Ph. (02) 9411 3279
www.groundink.com.au ABN 55 163 025 456 ACN 163 025 456
© Ground Ink Pty Ltd This design and drawing is protected by copyright.

Client

QUBE

MOOREBANK LOGISTICS PARK

Architect

REID CAMPBELL

15/124 Walker St, North Sydney NSW 2060
Ph. (02) 9954 5011
www.reidcampbell.com

Project Manager

ASPECT

Suite 117 / 25 Solent Circuit
Baulkham Hills NSW 2153
Ph. 0409 515 535
http://aspectenvironmental.com.au/

Note

Verify all dimensions on site before commencing work. Report all discrepancies to Landscape Architect prior to construction. Figured dimensions to be taken in preference to scaled drawings.

All work is to conform to relevant Australian standards and other codes as applicable.

Location of underground services to be proven on site and protected if necessary prior to construction. Dial before you dig.

Plant species and quantities shown are indicative only and are subject to change based on future project requirements.

Issue	Date	Description	Drawn	Checked
A	04.04.20	Issue for Coordination	KF	RL
B	28.10.20	Issue for Coordination	KF	RL

Drawing Title

**AREA 3
LANDSCAPE MASTERPLAN**

FOR COORDINATION					Drawing Number	
Date	Job Number	Drawn	Checked		MPE2-GNK-LN-DWG-3000	
28.10.20	20200421	KF	RL			
Project					Moorebank Precinct East Moorebank Logistics Park, Moorebank NSW	
Scale					1:1000 @ A1	
					0 5 10 15 20 25m	
					North	
					Rev B	

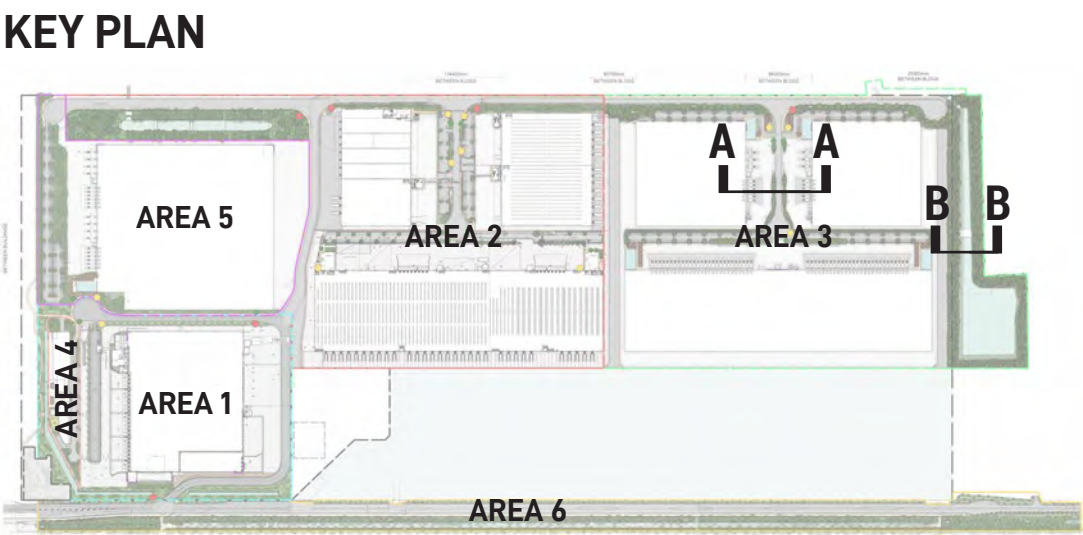

WAREHOUSE 6 & 7 INTERNAL ROAD SECTION A-A



OSD 2 SECTION B-B



KEY PLAN

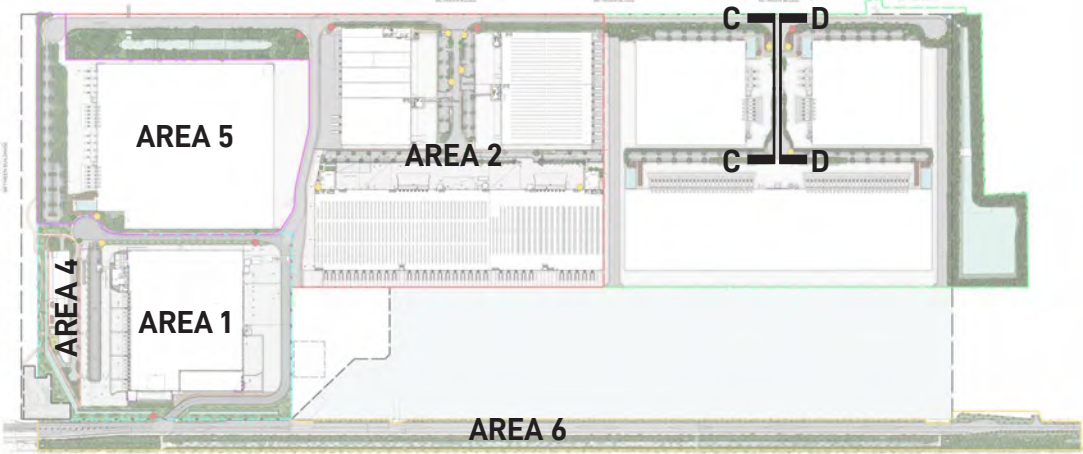

WAREHOUSE 6 SOUTH ELEVATION C-C

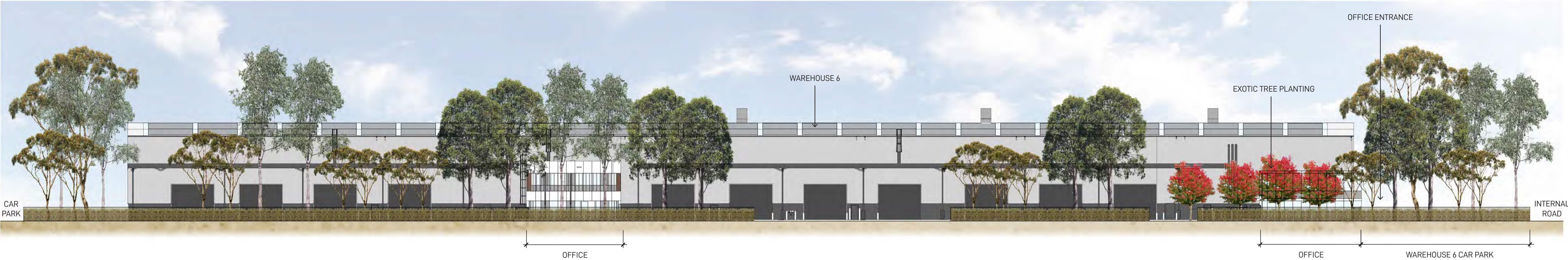

WAREHOUSE 7 NORTH ELEVATION D-D



FOR COORDINATION

Landscape Architect

GROUND INK

Suite 201, 75 Archer St, Chatswood NSW 2067 Ph. (02) 9411 3279
www.groundink.com.au ABN 55 163 025 456 ACN 163 025 456
© Ground Ink Pty Ltd This design and drawing is protected by copyright.

Client

Architect

15/124 Walker St, North Sydney NSW 2060
Ph. (02) 9954 5011
www.reidcampbell.com

Project Manager

Suite 117 / 25 Solent Circuit
Baulkham Hills NSW 2153
Ph. 0409 515 535
http://aspectenvironmental.com.au/

Note

Verify all dimensions on site before commencing work. Report all discrepancies to Landscape Architect prior to construction. Figured dimensions to be taken in preference to scaled drawings.

All work is to conform to relevant Australian standards and other codes as applicable.

Location of underground services to be proven on site and protected if necessary prior to construction. Dial before you dig.

Plant species and quantities shown are indicative only and are subject to change based on future project requirements.

Issue	Date	Description	Drawn	Checked
A	29.4.20	Preliminary	KF	RL
B	28.10.20	Issue for Coordination	KF	RL

Drawing Title

AREA 3
LANDSCAPE ELEVATIONS

Date04.06.20Job Number20200421DrawnKFCheckedRLDrawing NumberMPE2-GNK-LN-DWG-3002

ProjectMoorebank Precinct EastMoorebank Logistics Park, Moorebank NSW

Scale1:200 @ A1

012345678m
| | | | | | | |

North

RevA

DECEMBER 22ND 3PM

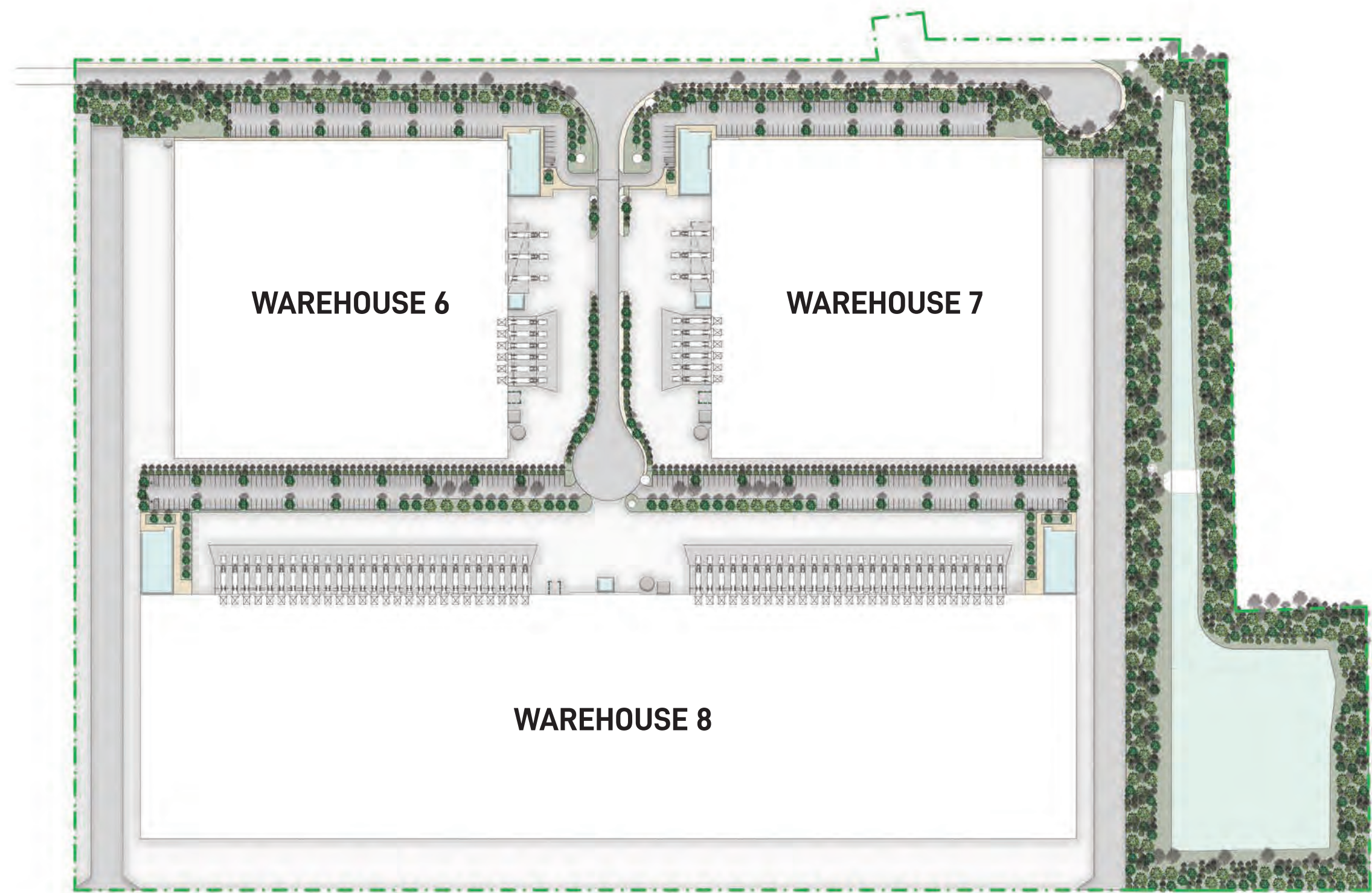

ANTICIPATED TREE GROWTH 5 YEARS AFTER INSTALLATION

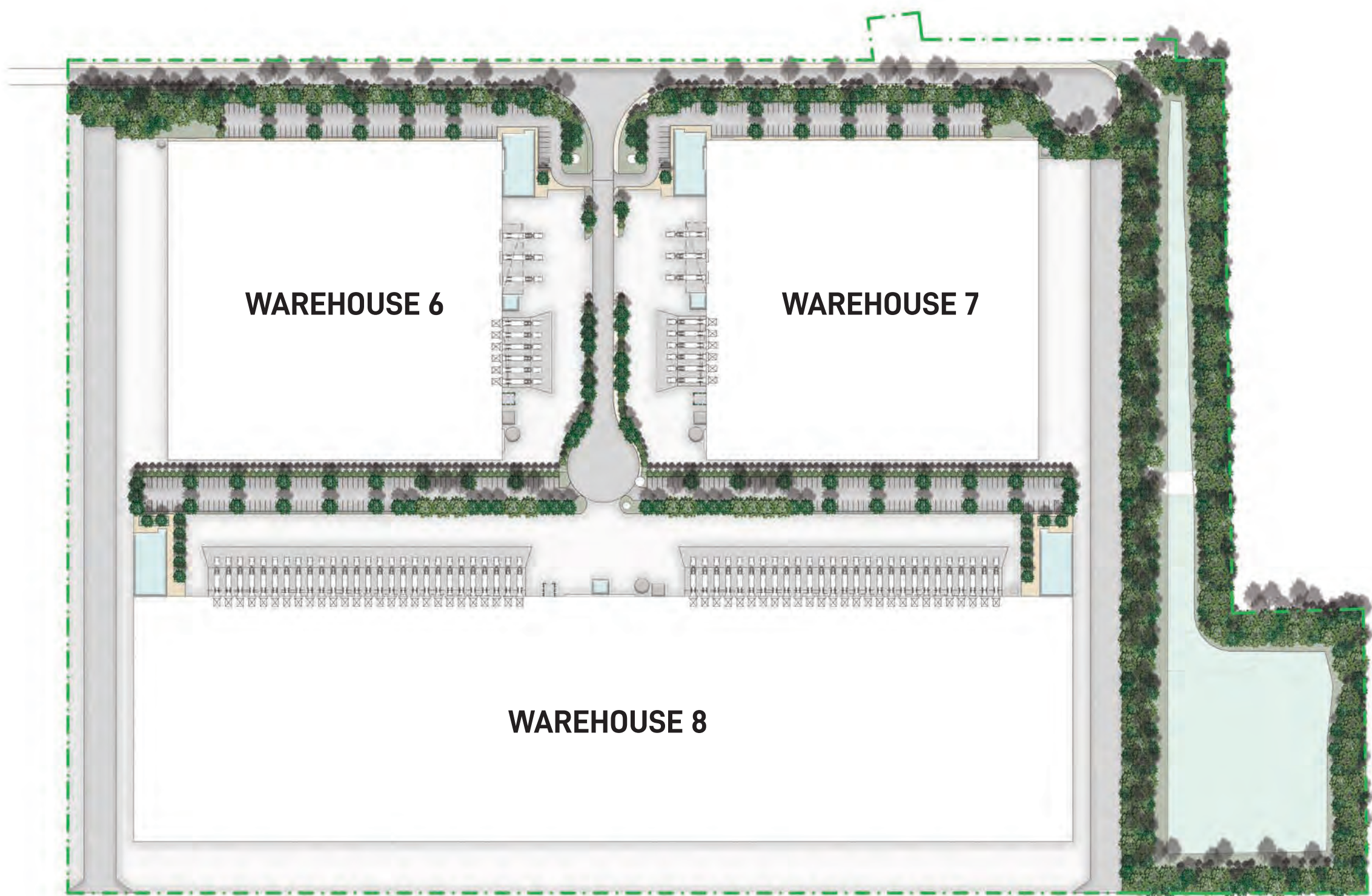

ANTICIPATED TREE GROWTH 15 YEARS AFTER INSTALLATION

JULY 22ND 3PM

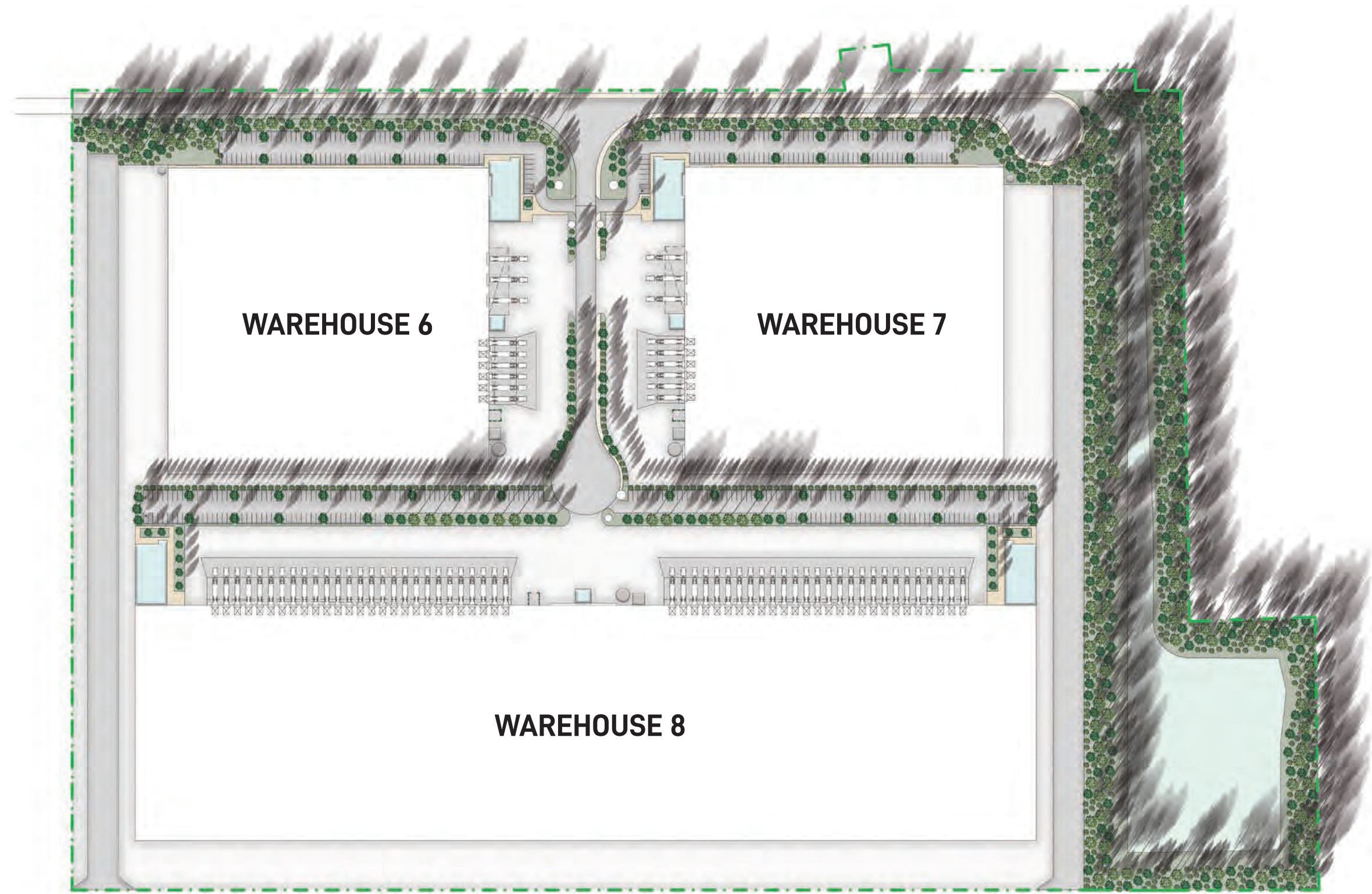

ANTICIPATED TREE GROWTH 5 YEARS AFTER INSTALLATION

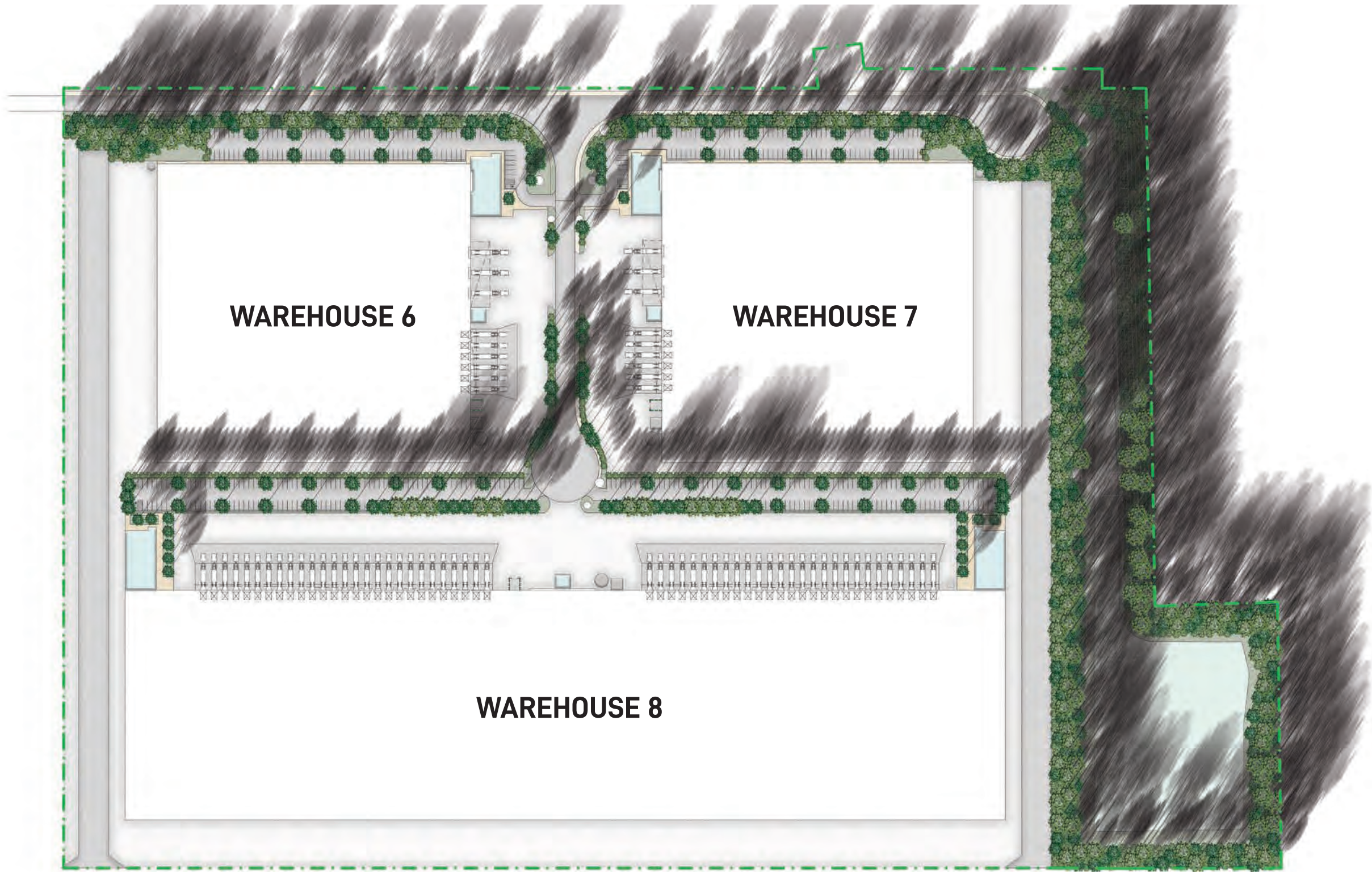

ANTICIPATED TREE GROWTH 15 YEARS AFTER INSTALLATION

NOTE
The final height of the proposed trees may differ from those indicated and will be dependent on environmental factors, installation size, and the implementation of an appropriate maintenance regime which is subject to future specifications.
Refer to Architect's details for building shade diagram