

REVISED MASTERPLAN PRECINCT DEVELOPMENTS

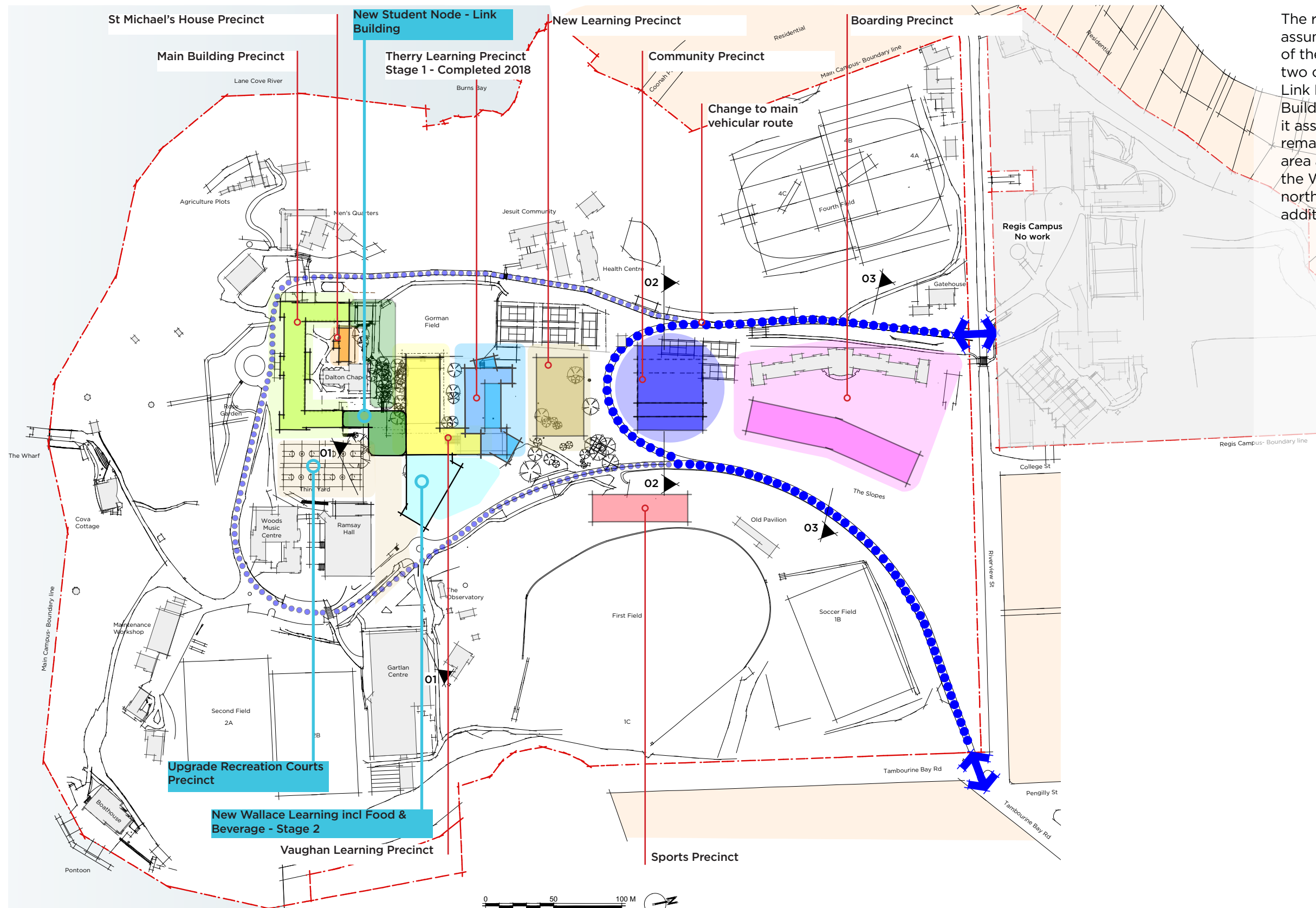

The revised precinct proposals assume the same break up of the Wallace Precinct into two components being the Link Building and the Wallace Building. For the modification it assumes the Link Building remains the same in height and area as previously shown and that the Wallace Building is shifted north with greater footprint and additional area.

REVISED STAGES | NEW WALLACE LEARNING BUILDING

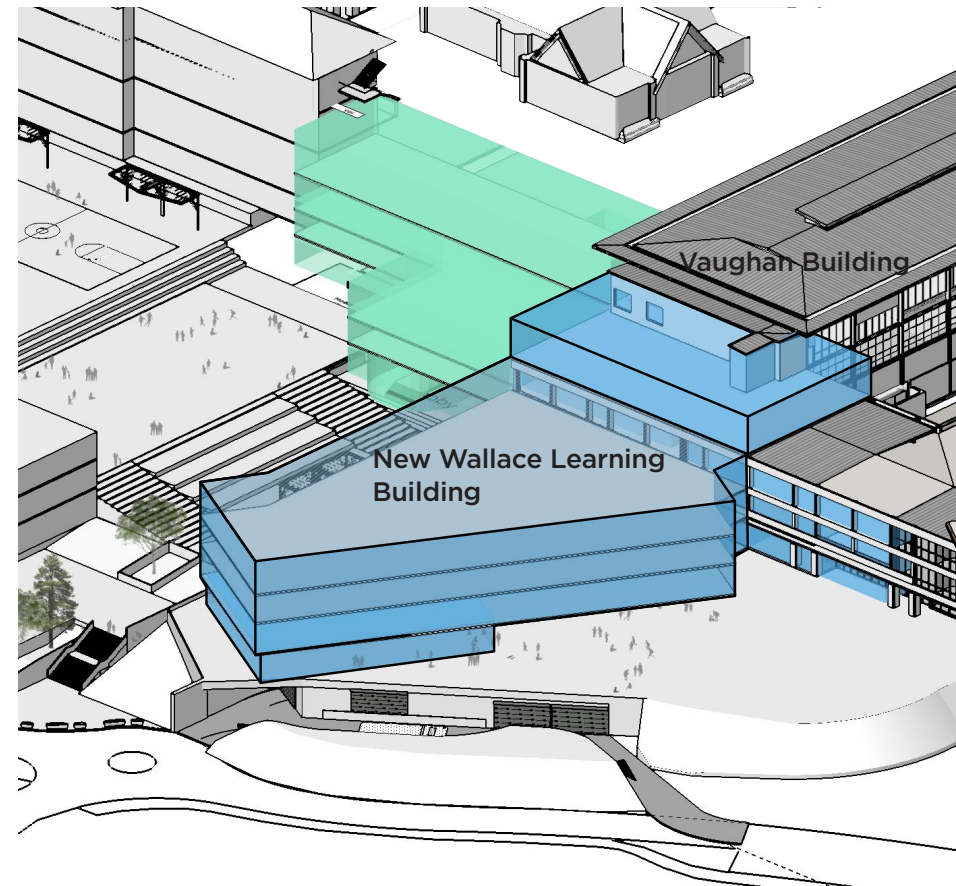

New Wallace Learning Building

- Number of Levels = 5
- Top of Building = RL 51.00

Demolish the existing Wallace and replace with new facility of greater footprint located 30m north attached to existing Vaughan building. Height of new building at 5 levels will be 1 level higher than the approved scheme which will equate to the existing top floor level of the existing Vaughan Building. The new building will provide improved and diverse learning opportunities for Science, Technology, Engineering, Mathematics and PDHPE as a STEMP facility. Ground level will accommodate a C.O.L.A and Canteen (Food & Beverage) with servicing by loading area on basement level.

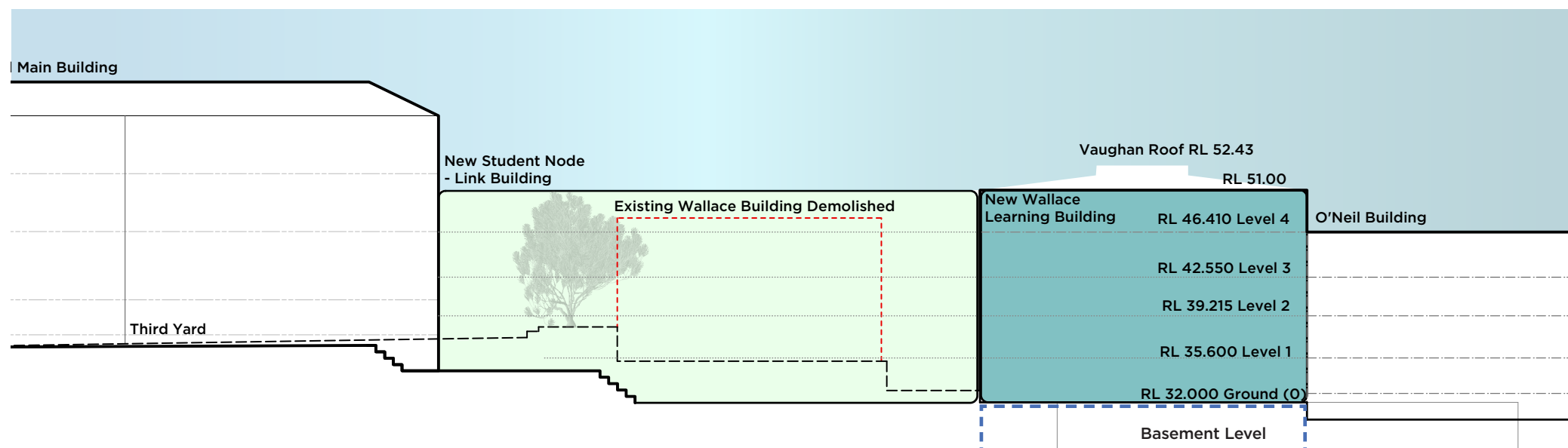

PROPOSED STAGE 2

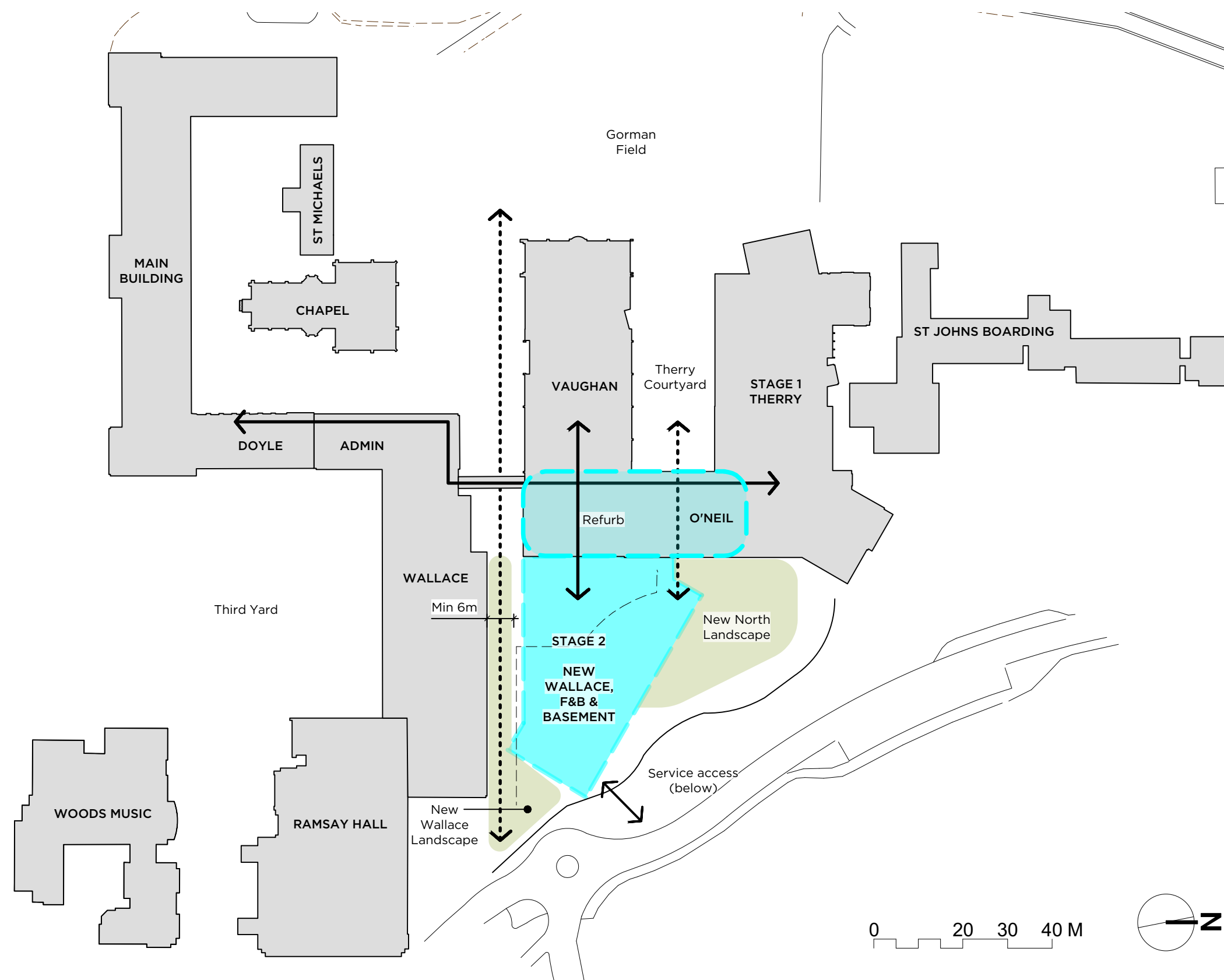

Stage 2

In summary **Stage 2** scope of works consists of the following:

- New five storey Wallace Building as a STEMP facility accommodating Science, Technology, Engineering, Mathematics and PDHPE faculties, six Pastoral Care House areas, staff rooms, a new Canteen and basement area for deliveries & storage.
- Refurbishment of existing O'Neil building to allow integration of New Wallace Building to connect to existing fabric.
- New North Landscaped Area
- New Wallace Landscaped Area between existing and new Wallace Buildings.