

PARKING SCHEDULE	
BICYCLE STORAGE	24
VISITOR BICYCLES	8
CAR WASH BAYS	1
VISITOR BAYS ON STREET	3
VISITOR BAYS OFF STREET	14
RESIDENTIAL BAYS (INC. ADAPT 7-off)	68
TOTAL PARKING BAYS	86

BLD 9 - GFA	
Number	Area
Ground	714 m ²
Level 1	1285 m ²
Level 2	1292 m ²
Level 3	1220 m ²
Level 4	1219 m ²
Level 5	1069 m ²
Level 7	288 m ²
TOTAL	7088 m²

BUILDING 9					
	1B	1B+ST	2B	2B(ADAPT)	TOTAL
GL	2	-	7	1	10
L1	2	1	7	1	11
L2	2	-	15	1	18
L3	-	-	7	1	8
L4	2	-	13	1	16
L5	-	-	5	1	6
L6	-	-	3	-	3
TOTAL	8	1	57	6	72

REV	DATE	AMENDMENT
A	11.03.2011	PRELIMINARY ISSUE FOR COORDINATION
B	18.03.2011	FINAL DRAFT FOR PA ISSUE
C	08.04.2011	FINAL DRAFT FOR PA ISSUE
D	19.04.2011	REVISED FINAL DRAFT ISSUE
E	08.06.2011	FINAL ISSUE FOR PA APPLICATION
F	13.12.2011	REVISED APPLICATION
G	13.03.2012	S96 APPLICATION

Consultants	
Landscape Arch	Sturt Associates Suite 91, Level 5, 330 Wattle Street, Ultimo NSW 2007 Tel: 0211 5744
Solar Access	Huggins 2 Linton Street, Lane Cove NSW 2066 Tel: 9427 6100
Traffic	TTP Suite 403, Level 6, 282 Victoria Ave, Cheshamwood NSW 2067 Tel: 9411 5600
Healthcare/Basis	Efficient Living 248/176 South Creek Road, Corner NSW 2099 Tel: 9544 0202
Acoustic	Acoustic Logic 9 Swain Street, Mascot NSW 2020 Tel: 8538 9688

Clerk:

Meriton
Apartments Pty. Ltd.
Builders & Developers

Level 11, 528 Kent Street, Sydney NSW 2000
Tel: (02) 9287 2888 Fax: (02) 9287 2777 Email: info@design.meriton.com.au Website: <http://www.meriton.com.au>

PTW Architects

Level 17, 9 Castlereagh St
Sydney NSW Australia 2000

T +612 9232 5877
F +612 9221 4139

NSW Registered Architects
A Architects No. 2522
A Builders No. 3916
A Surveyors No. 4778
A Real Estate No. 5957
A Strata No. 6229
A Property No. 5247

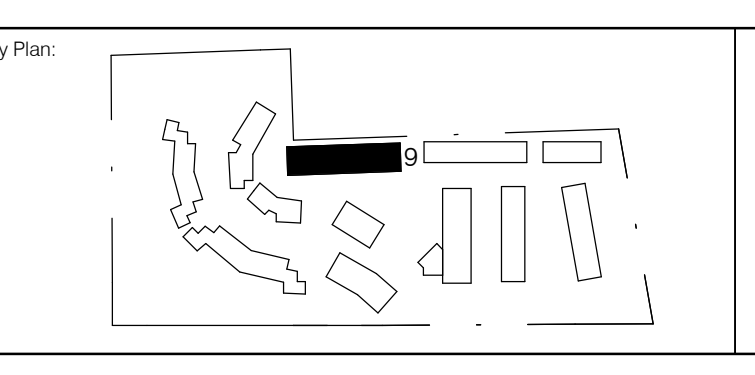

Project			
EPPING PARK - STAGE 2			
BUILDING 9			
61 MOBBS LANE, EPPING			
BUILDINGS 6,9,10,17			
Title			
COVER SHEET BUILDING 9			

Scale:	Plot Date:	Job No:	
As indicated	15/3/12 1:10:57 PM	211.006	
Dwg No:	Drawn By:	Checked By:	Revision:
A0900	Author	Checker	G
Status:			
PROJECT APPLICATION			

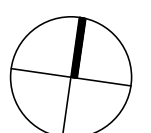

Sheet List

Sheet Number	Sheet Name
--------------	------------

A0900	COVER SHEET BUILDING 9
A0901	DRAWING LIST
A0902	SITE PLAN
A0903	SITE SECTIONS 1
A0904	SITE SECTIONS 2
A0910	BUILDING 9 PARKING LEVEL 1 PLAN
A0912	BUILDING 9 GROUND FLOOR PLAN
A0913	BUILDING 9 LEVEL 1 TO LEVEL 2 PLAN
A0914	BUILDING 9 LEVEL 3 TO 4 PLAN
A0915	BUILDING 9 LEVEL 5 TO LEVEL 6
A0916	BUILDING 9 LEVEL ROOF PLAN
A0920	ELEVATIONS NS
A0921	BUILDING 9 ELEVATIONS EW
A0930	BUILDING 9 LONG SECTION
A0933	BUILDING 9 CROSS SECTIONS
A0950	SHADOW STUDIES - DEC.
A0951	SHADOW STUDIES - JUNE
A0952	SHADOW STUDIES - MARCH
D0001	DIAGRAM BUILDING PLAN DEPTH

<p style="font-size: 6px;">Do not scale from drawings.</p> <p style="font-size: 6px;">Verify all dimensions on site before commencing work.</p> <p style="font-size: 6px;">Copying or reproduction of the drawing is strictly prohibited without the consent of Pacific Trust & Builders Ltd.</p> <p style="font-size: 6px;">The Architect shall not be liable for any loss or claims whatsoever arising out of or in respect of any errors, omissions or omissions in this document transferred from the computer system of the Architect to anyone at the time of printing or otherwise.</p> <p style="font-size: 6px;">The recipient of the data shall be responsible for ensuring accuracy and completeness of data received from the user's disk and the contents are solely representative of the project information and cannot be used and should be representative of the current version of the drawings as provided by the Architect.</p>	<table border="1" style="width: 100%; border-collapse: collapse;"> <thead> <tr> <th>ISSUE</th> <th>DATE</th> <th>AMENDMENT</th> </tr> </thead> <tbody> <tr><td>A</td><td>11.03.2011</td><td>PRELIMINARY ISSUE FOR COORDINATION</td></tr> <tr><td>B</td><td>18.03.2011</td><td>FINAL DRAFT FOR PA ISSUE</td></tr> <tr><td>C</td><td>08.04.2011</td><td>FINAL DRAFT FOR PA ISSUE</td></tr> <tr><td>D</td><td>19.04.2011</td><td>REVISED FINAL DRAFT ISSUE</td></tr> <tr><td>E</td><td>08.06.2011</td><td>FINAL ISSUE FOR PA APPLICATION</td></tr> <tr><td>F</td><td>13.12.2011</td><td>REVISED APPLICATION</td></tr> <tr><td>G</td><td>13.03.2012</td><td>S96 APPLICATION</td></tr> </tbody> </table>	ISSUE	DATE	AMENDMENT	A	11.03.2011	PRELIMINARY ISSUE FOR COORDINATION	B	18.03.2011	FINAL DRAFT FOR PA ISSUE	C	08.04.2011	FINAL DRAFT FOR PA ISSUE	D	19.04.2011	REVISED FINAL DRAFT ISSUE	E	08.06.2011	FINAL ISSUE FOR PA APPLICATION	F	13.12.2011	REVISED APPLICATION	G	13.03.2012	S96 APPLICATION	<p>Consultants:</p> <table style="width: 100%; border-collapse: collapse;"> <tr> <td style="width: 25%;">Landscape Arch</td> <td style="width: 25%;">Sturt Associates</td> <td style="width: 25%;">Suite 91, Level 5, 330 Wattle Street, Ultimo NSW 2007</td> <td style="width: 25%;">Tel: 0211 5744</td> </tr> <tr> <td>Solar Access</td> <td>Huggins</td> <td>2 Lincoln Street, Lane Cove NSW 2066</td> <td>Tel: 9427 8100</td> </tr> <tr> <td>Traffic</td> <td>TTP</td> <td>Suite 403, Level 6, 282 Victoria Ave, Cheshamwood NSW 2067</td> <td>Tel: 9411 5600</td> </tr> <tr> <td>Nature/Basis</td> <td>Efficient Living</td> <td>24/1/76 South Creek Road, Crompton NSW 2099</td> <td>Tel: 9544 0202</td> </tr> <tr> <td>Acoustic</td> <td>Acoustic Logic</td> <td>9 Sarah Street, Mascot NSW 2020</td> <td>Tel: 8538 9688</td> </tr> </table>	Landscape Arch	Sturt Associates	Suite 91, Level 5, 330 Wattle Street, Ultimo NSW 2007	Tel: 0211 5744	Solar Access	Huggins	2 Lincoln Street, Lane Cove NSW 2066	Tel: 9427 8100	Traffic	TTP	Suite 403, Level 6, 282 Victoria Ave, Cheshamwood NSW 2067	Tel: 9411 5600	Nature/Basis	Efficient Living	24/1/76 South Creek Road, Crompton NSW 2099	Tel: 9544 0202	Acoustic	Acoustic Logic	9 Sarah Street, Mascot NSW 2020	Tel: 8538 9688	<p>Client:</p> <div style="text-align: center;">  <p>Meriton Apartments Pty. Ltd. Builders & Developers</p> </div> <p>Level 11, 528 Kent Street, Sydney NSW 2000 Tel: (02) 9287 2888 Fax: (02) 9287 2777 Email: info@design.meriton.com.au Internet: http://www.meriton.com.au</p>	<p>PTW Architects</p> <div style="text-align: center;">  </div> <p>Level 17, 9 Castlereagh St Sydney NSW Australia 2000 T +612 9232 5877 F +612 9221 4139</p> <p style="font-size: 6px;">NSW Registered Architects A Architects No. 2522 J Wilson Architects No. 3916 D Jones Architects No. 4778 A Ross Architects No. 5607 S Street Architects No. 6229 A Theyer Architects No. 5247</p>	<p>Key Plan:</p> 	<p>Project: EPPING PARK - STAGE 2 BUILDING 9 61 MURRIS LANE, EPPING BUILDINGS 6/9, 10, 17</p> <p>Title: DRAWING LIST</p>	<table border="1" style="width: 100%; border-collapse: collapse;"> <tr> <td style="width: 25%;">Scale:</td> <td style="width: 25%;">Plot Date:</td> <td style="width: 25%;">Job No:</td> <td style="width: 25%;"></td> </tr> <tr> <td>@B1</td> <td>15/3/12 1:11:18 PM</td> <td>211.006</td> <td></td> </tr> <tr> <td>Dwg No:</td> <td>Drawn By:</td> <td>Checked By:</td> <td>Revision:</td> </tr> <tr> <td>A0901</td> <td>Author</td> <td>Checker</td> <td>G</td> </tr> <tr> <td colspan="4" style="text-align: center;">Status: PROJECT APPLICATION</td> </tr> </table>	Scale:	Plot Date:	Job No:		@B1	15/3/12 1:11:18 PM	211.006		Dwg No:	Drawn By:	Checked By:	Revision:	A0901	Author	Checker	G	Status: PROJECT APPLICATION			
ISSUE	DATE	AMENDMENT																																																																					
A	11.03.2011	PRELIMINARY ISSUE FOR COORDINATION																																																																					
B	18.03.2011	FINAL DRAFT FOR PA ISSUE																																																																					
C	08.04.2011	FINAL DRAFT FOR PA ISSUE																																																																					
D	19.04.2011	REVISED FINAL DRAFT ISSUE																																																																					
E	08.06.2011	FINAL ISSUE FOR PA APPLICATION																																																																					
F	13.12.2011	REVISED APPLICATION																																																																					
G	13.03.2012	S96 APPLICATION																																																																					
Landscape Arch	Sturt Associates	Suite 91, Level 5, 330 Wattle Street, Ultimo NSW 2007	Tel: 0211 5744																																																																				
Solar Access	Huggins	2 Lincoln Street, Lane Cove NSW 2066	Tel: 9427 8100																																																																				
Traffic	TTP	Suite 403, Level 6, 282 Victoria Ave, Cheshamwood NSW 2067	Tel: 9411 5600																																																																				
Nature/Basis	Efficient Living	24/1/76 South Creek Road, Crompton NSW 2099	Tel: 9544 0202																																																																				
Acoustic	Acoustic Logic	9 Sarah Street, Mascot NSW 2020	Tel: 8538 9688																																																																				
Scale:	Plot Date:	Job No:																																																																					
@B1	15/3/12 1:11:18 PM	211.006																																																																					
Dwg No:	Drawn By:	Checked By:	Revision:																																																																				
A0901	Author	Checker	G																																																																				
Status: PROJECT APPLICATION																																																																							