



Do not scale from drawings.  
 Verify all dimensions on site before commencing work.  
 Copying or reproduction of the drawings is strictly prohibited without the consent of Pacific Trusts & Builders Ltd.  
 The Architect shall not be liable for any loss or claims whatsoever arising out of or in respect of the services provided in connection with the development undertaken from the completion of the date of the issue of the Certificate of Occupancy.  
 The signatory of the data shall be responsible for checking accuracy and consistency of data throughout the user's file.  
 The CAD files and their contents are hereby represented as the project information and cannot be relied upon beyond the representative aspect or PAE version of the drawings as provided by the Architect.

ISSUE	DATE	AMENDMENT
A	11.03.2011	PRELIMINARY ISSUE FOR COORDINATION
B	18.03.2011	FINAL DRAFT FOR PA ISSUE
C	08.04.2011	FINAL DRAFT FOR PA ISSUE
D	19.04.2011	REVISED FINAL DRAFT ISSUE
E	24.06.2011	FINAL ISSUE FOR PA APPLICATION

Consultants	
Landscape Arch	Sturl Associates Suite B1, Level 5, 330 Wattle Street, Ultimo NSW 2007 Tel: 0211 5744
Soil Access	Huggins 2 Linton Street, Lane Cove NSW 2066 Tel: 9427 8100
Traffic	TTP Suite 403, Level 6, 282 Victoria Ave, Cheshamwood NSW 2087 Tel: 9411 5600
Nathura/Basix	Efficient Living 24/8176 South Creek Road, Cumber NSW 2099 Tel: 9544 0300
Acoustic	Acoustic Logic 9 Swain Street, Mascot NSW 2020 Tel: 8338 9688

Client:  

**Meriton  
 Apartments Pty. Ltd.**  
 Builders & Developers  
 Level 11, 528 Kent Street, Sydney NSW 2000  
 Tel: (02) 9287 2888 Fax: (02) 9287 2777 Email: info@design.meriton.com.au Internet: http://www.meriton.com.au

PTW Architects  
  
 Level 17, 9 Castlereagh St  
 Sydney NSW Australia 2000  
 T +612 9232 5877  
 F +612 9221 4139  
NSW Registered Architects  
 A Architects No. 2022  
 J Wilson Architects No. 3916  
 S Wilson Architects No. 4776  
 A Ross Architects No. 5057  
 S Ross Architects No. 4209  
 A Thompson Architects No. 5247

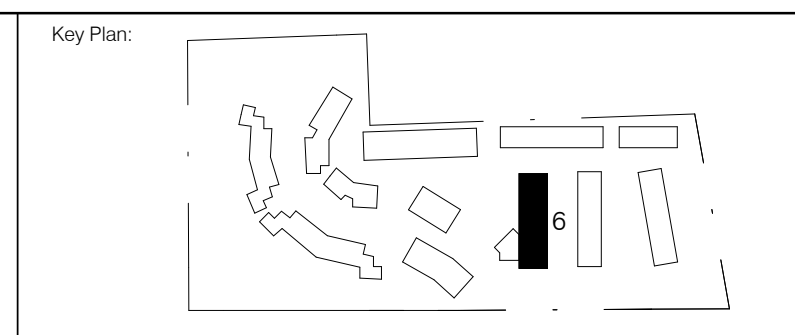

Project:  
**EPPING PARK - STAGE 2 B6**  
 61 MORRIS LANE, EPPING  
 BUILDINGS 6

Scale:		Plot Date:	Job No:
1:100		24/06/2011 6:25:45 PM	211.006
Dwg No:	Drawn By:	Checked By:	Revision:
A0643	Author	Checker	E
Status:	PA		

