



Appendix A

Photographic Record



View looking south west across Victoria Road towards the site.



View looking north along Victoria Road along the eastern site boundary.





View looking south along Victoria Road along the eastern site boundary in the vicinity of the proposed service vehicle and car park access.



View looking north along Waterloo Road along the western site boundary.





View looking south along Waterloo Road along the western site boundary.



View east along Darling Street across its intersection with Waterloo Road towards Victoria Road.





Appendix B

Reduced Plans



LEVEL 5

LEVEL 4

LEVEL 3

LEVEL 2



LEVEL 1

LEVEL 1

GROUND

BASEMENT 1

BASEMENT 4

BASEMENT 3

BASEMENT 2

Key

Gross Floor Area (GFA)

| Floors | GFA |
|--------------------------------------------------|---------------------------|
| B4 | 30m ² |
| B3 | 140m ² |
| B2 | 2275m ² |
| B1 | 3895m ² |
| Ground | 5900m ² |
| Level 1 | 4600m ² |
| Level 2 | 3605m ² |
| Level 3 | 2280m ² |
| Level 4 | 430m ² |
| Level 5 | 1900m ² |
| Level 6 | 1465m ² |
| Level 7 | 1955m ² |
| Level 8 | 1465m ² |
| Level 9 | 1955m ² |
| Level 10 | 1465m ² |
| Level 11 | 1955m ² |
| Level 12 | 1465m ² |
| Level 13 | 1955m ² |
| Level 14 | 1465m ² |
| Level 15 | 1955m ² |
| Level 16 | 1465m ² |
| Level 17 | 1955m ² |
| Level 18 | 1465m ² |
| Level 19 | 1955m ² |
| Level 20 | 1465m ² |
| Level 21 | 1955m ² |
| Level 22 | 1200m ² |
| Level 23 | 930m ² |
| Level 24 | 815m ² |
| Level 25 | 735m ² |
| Level 26 | 580m ² |
| Level 27 | 735m ² |
| Level 28 | 580m ² |
| Level 29 | 735m ² |
| Level 30 | 580m ² |
| Sub-Total | 59515m ² |
| Levels 5-30 2% GFA deduction for services risers | - 660m ² |
| Total | 55155m² |



Do not scale from drawings verify all dimensions on site before commencing site works. This drawing is preliminary and is provided without the consent of Frank Starbuck Architects P/L and PTW Architects P/L.

Revision 18 compilation package for EA 02.02.2012

Client Rozelle Village Pty Limited
Level 17/15 Pitt St
Sydney NSW Australia 2000

Concept - Design Architect PTW Architects
Level 17 9 Castlereagh St
Sydney NSW Australia 2000
T 612 9329 7971
F 612 9321 4139
www.ptw.com.au

Design Documentation Architect STANBAC ASSOCIATES ARCHITECTS
Level 3, 348 Kent St
Sydney NSW Australia 2000
T 612 9329 7971
F 612 9321 4139
www.stanbac.com.au

Project Drawing Drawing
PRJ NO. 21000600 not to scale
SCALE DATE
DRAWN LRF
CHECKED DH
GFA SCHEDULE PLANS
PA1201 18
Rozelle Village
Victoria Road, Darling Street and Waterloo Street,
Rozelle NSW Australia



Appendix C

Swept Path Analysis – Car Parking

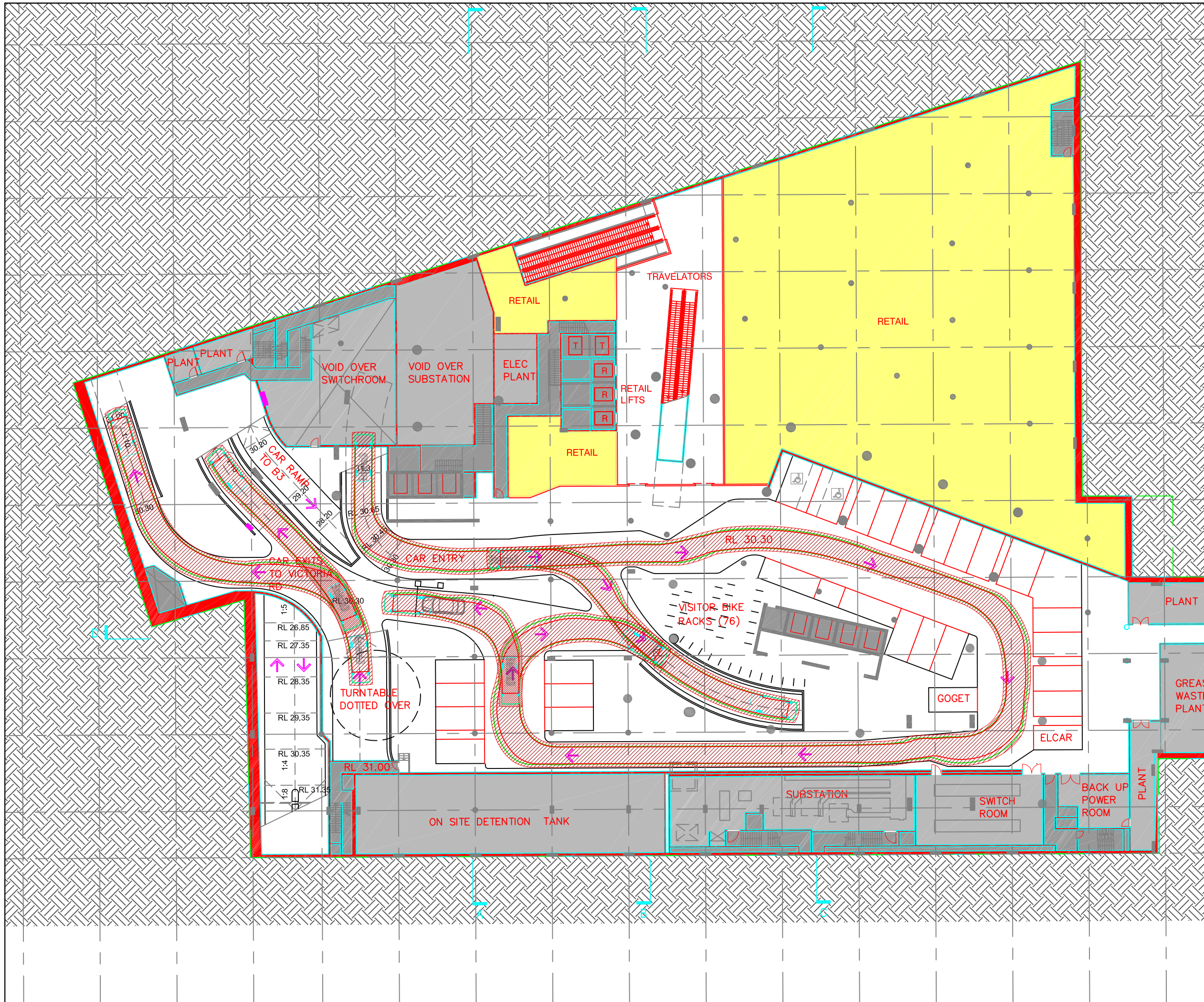

| | | |
|--------------------------------------------------------------------------------------------------------------------------------------------------------------------------------------------------------------------------------------------|----------------|-----------------------|
| notes This drawing is prepared for information purposes only. It is not to be used for construction. | | |
| no. | revision note | by. date |
| architect PTW Architects Level 7, 9 Castlereagh Street Sydney NSW 2000 | | |
| client Rozelle Village PTY LTD | | |
| scale 1:400 @ A3 0m 4 8 12 16 | | |
| project Rozelle Village | | |
| drawing prepared by TRAFFIX traffic and transport planners suite 3.08 46a macleay street potts point NSW 2011 PO Box 1061 potts point nsw 1035 t: +61 2 8324 8700 f: +61 2 9380 4481 e: info@traffix.com.au | | |
| drawing title Swept Path Analysis - Basement 2 - B99 Vehicle | | |
| drawn: | initials | checked: - date: date |
| 11 294 | - | TX.01 - |
| project no. | drawing phase. | drawing no. rev |



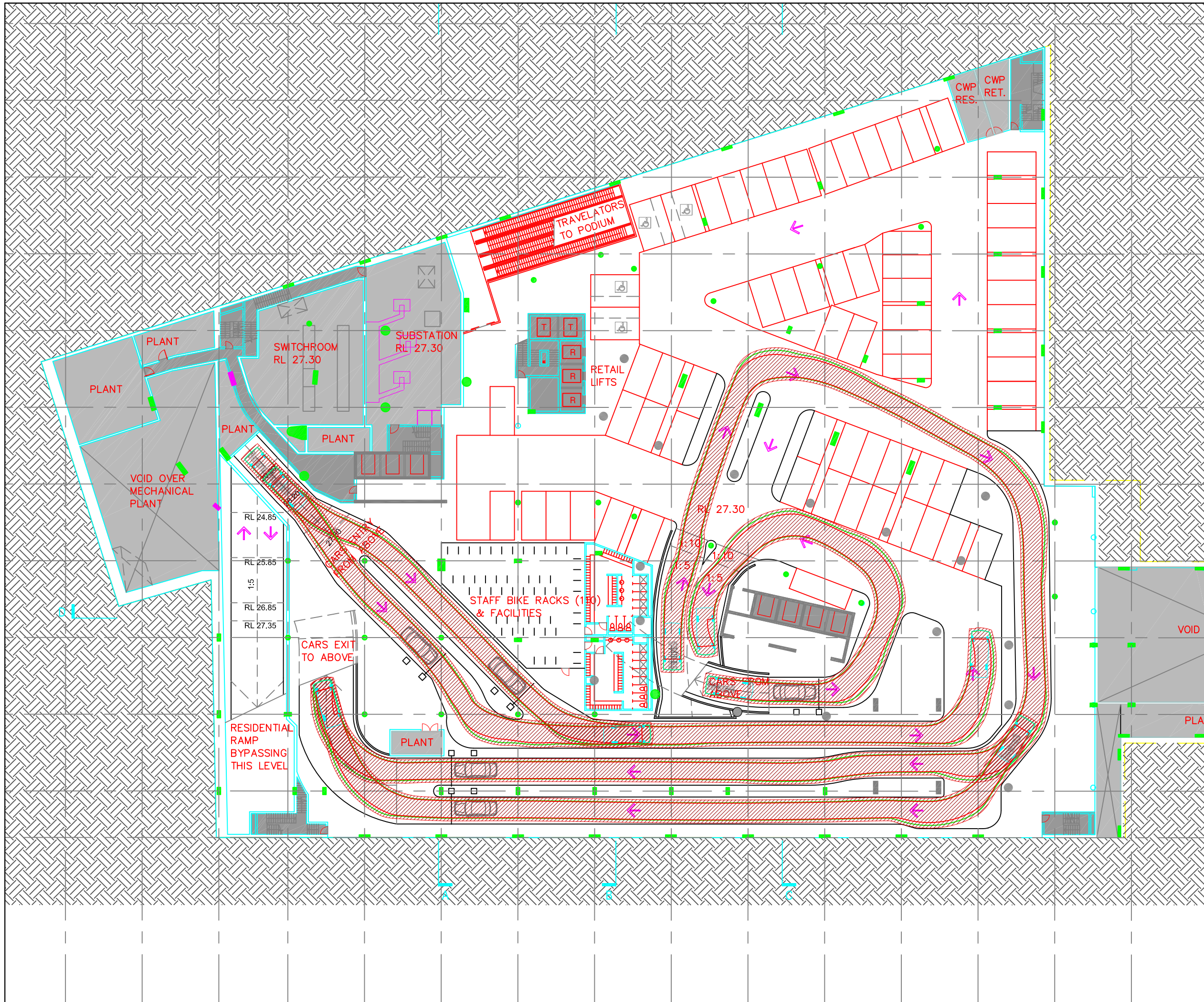

notes
 This drawing is prepared for information purposes only. It is not to be used for construction.

| no. | revision note | by. | date |
|-----|---------------|-----|------|
| | | | |

architect
PTW Architects
 Level 7, 9 Castlereagh Street
 Sydney NSW 2000

client
Rozelle Village PTY LTD

scale
 1:400 @ A3
 0m 4 8 12 16

project
Rozelle Village

drawing prepared by
TRAFFIX
 traffic and transport planners
 suite 3.08 46a macleay street
 potts point NSW 2011
 PO Box 1061 potts point nsw 1035
 t: +61 2 8324 8700
 f: +61 2 9380 4481
 e: info@traffix.com.au

traffix
 traffic & transport planners

drawing title
Swept Path Analysis - Basement 3 - B99 Vehicle

| | | |
|-----------------|------------|------------|
| drawn: initials | checked: - | date: date |
|-----------------|------------|------------|

| | | | |
|-------------|----------------|-------------|-----|
| 11 294 | - | TX.01 | - |
| project no. | drawing phase. | drawing no. | rev |

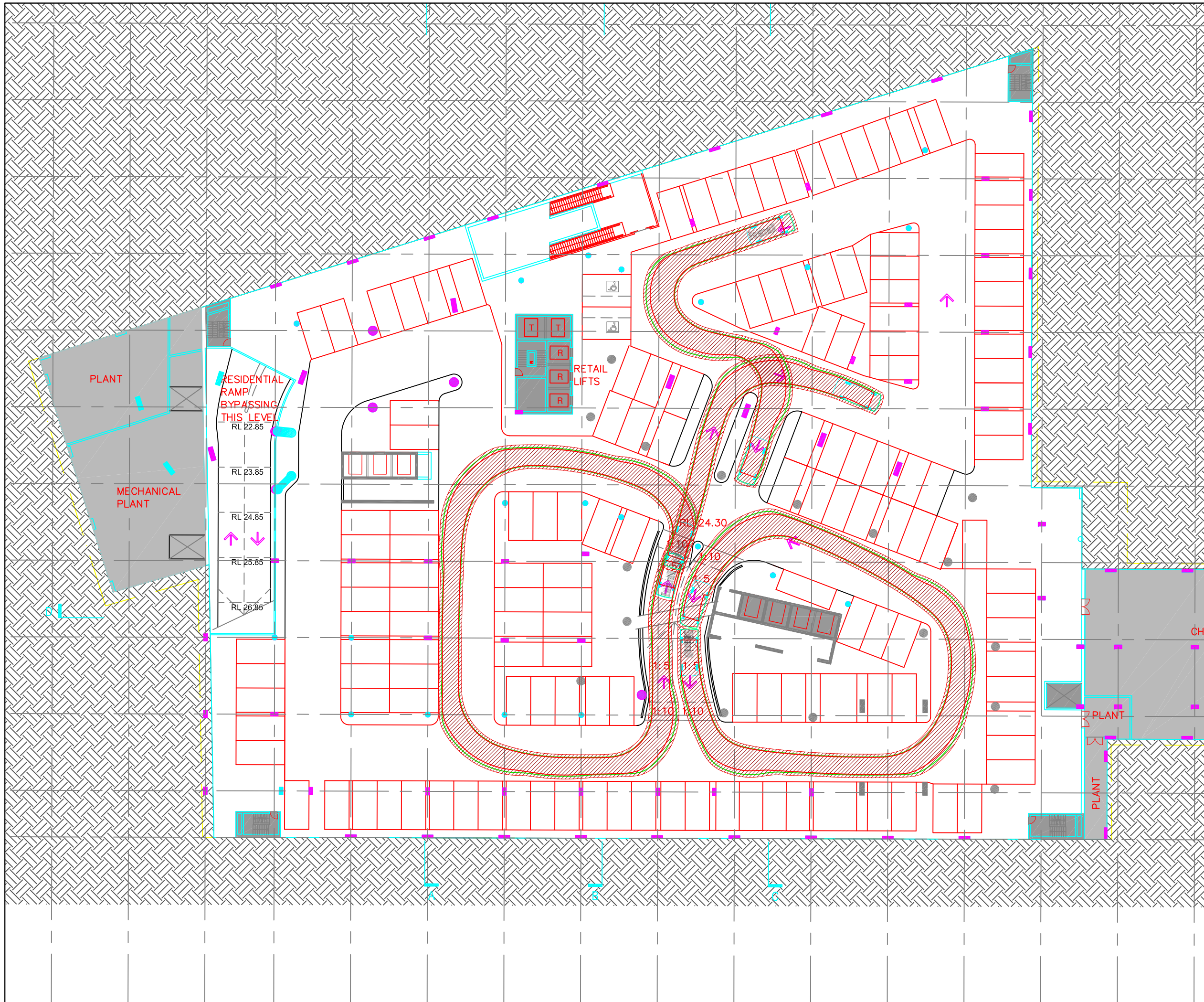

notes
 This drawing is prepared for information purposes only. It is not to be used for construction.

| no. | revision note | by. | date |
|-----|---------------|-----|------|
| | | | |

architect
PTW Architects
 Level 7, 9 Castlereagh Street
 Sydney NSW 2000

client
Rozelle Village PTY LTD

scale
 1:400 @ A3
 0m 4 8 12 16

project
Rozelle Village

drawing prepared by
TRAFFIX
 traffic and transport planners
 suite 3.08 46a macleay street
 potts point NSW 2011
 PO Box 1061 potts point nsw 1035
 t: +61 2 8324 8700
 f: +61 2 9380 4481
 e: info@traffix.com.au

traffix
 traffic & transport planners

drawing title
**Swept Path Analysis - Basement 4-6
 B99 Vehicle**

| | | |
|-----------------|------------|------------|
| drawn: initials | checked: - | date: date |
|-----------------|------------|------------|

| | | | |
|---------------|----------------|--------------|-----|
| 11 294 | - | TX.01 | - |
| project no. | drawing phase. | drawing no. | rev |



Appendix D

Swept Path Analysis – Loading Dock

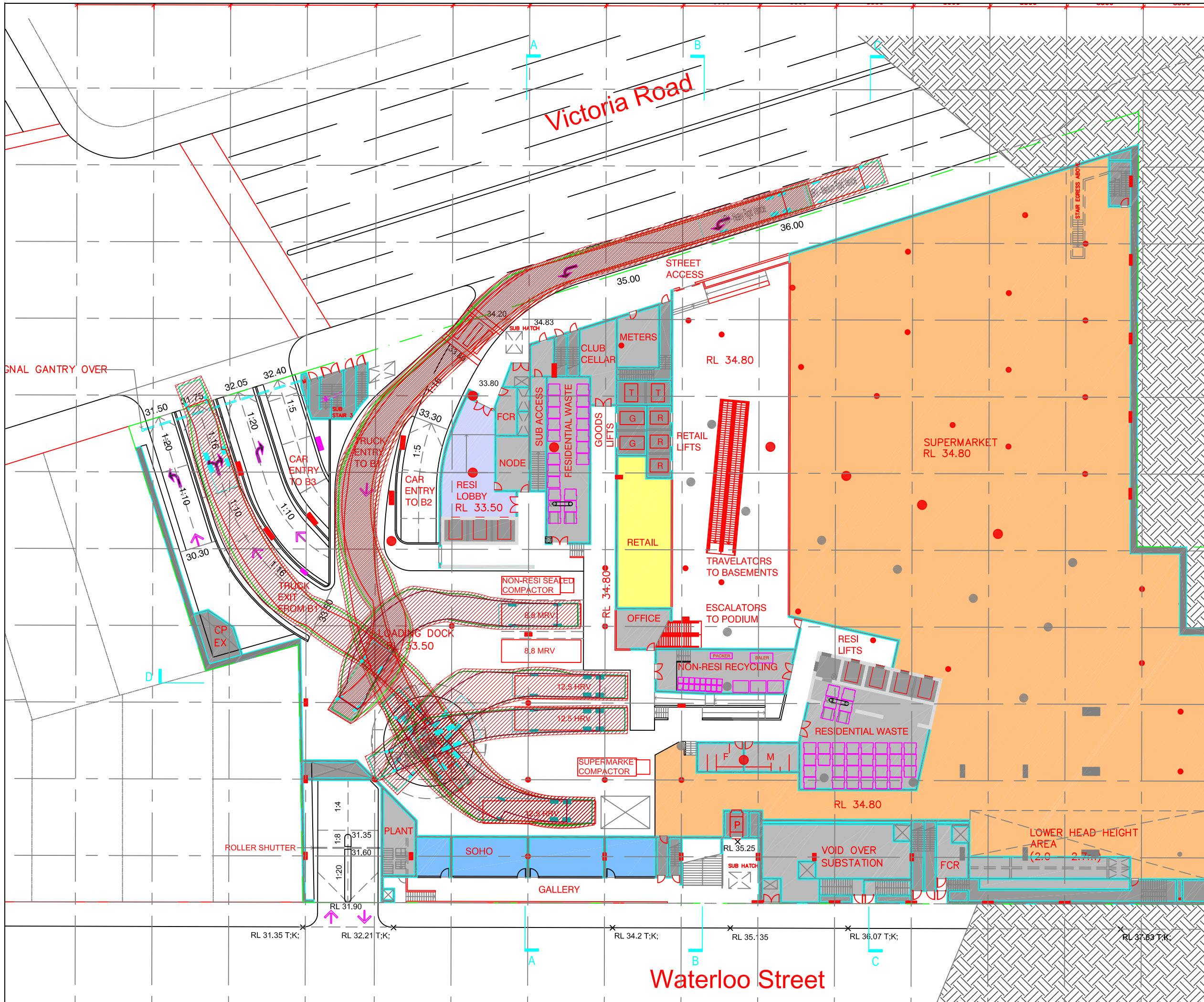

notes
 This drawing is prepared for information purposes only. It is not to be used for construction.

no. revision note by. date

architect
 PTW Architects
 Level 7, 9 Castlereagh Street
 Sydney NSW 2000

client
 Rozelle Village PTY LTD

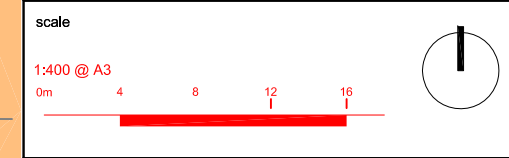

project
 Rozelle Village

drawing prepared by
TRAFFIX
 traffic and transport planners
 suite 3.08 46a macleay street
 potts point NSW 2011
 PO Box 1061 potts point nsw 1035
 t: +61 2 8324 8700
 f: +61 2 9380 4481
 e: info@traffix.com.au



drawing title
 Swept Path Analysis - Basement 1: MRV & HRV Access

drawn: initials checked: - date: date

11 294 - TX.01 -
 project no. drawing phase. drawing no. rev