

- CONSTRUCT CONCRETE ACCESS 8m WIDE VARYING TO 4.5m WIDE WITH 10m DIA. TURNING AREA
- ▣ RIGHT OF CARRIAGE WAY AND EASEMENT FOR SERVICES AND EASEMENT TO DRAIN WATER VAR. WIDTH.
- ▣ RECIPROCAL RIGHT OF CARRIAGE WAY AND EASEMENT FOR SERVICES AND EASEMENT TO DRAIN WATER 3.5m WIDE AND VAR.
- EASEMENT TO DRAIN WATER 1.5m WIDE
- STORMWATER PIPE
- EXISTING RESIDENCE SWIMMING POOL AND OTHER STRUCTURES ARE TO BE DEMOLISHED
- ⊕ MAKE SMOOTH CONNECTION WITH EXISTING DRIVEWAY
- DRIVEWAY
- VEHICULAR ACCESS LOT 3
- CONSERVATION AREA
- ▨ MANAGED BUFFER TO CONSERVATION AREA/APZ
- ▨ GENERAL LANDSCAPE AREA

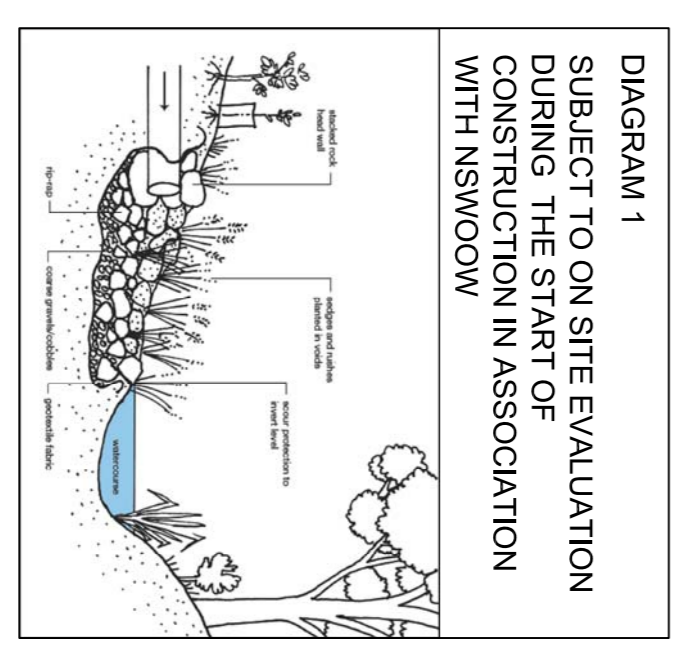

CROSS SECTION - CREEK, STORMWATER CONNECTION
NOT TO SCALE

BEECHWORTH ROAD

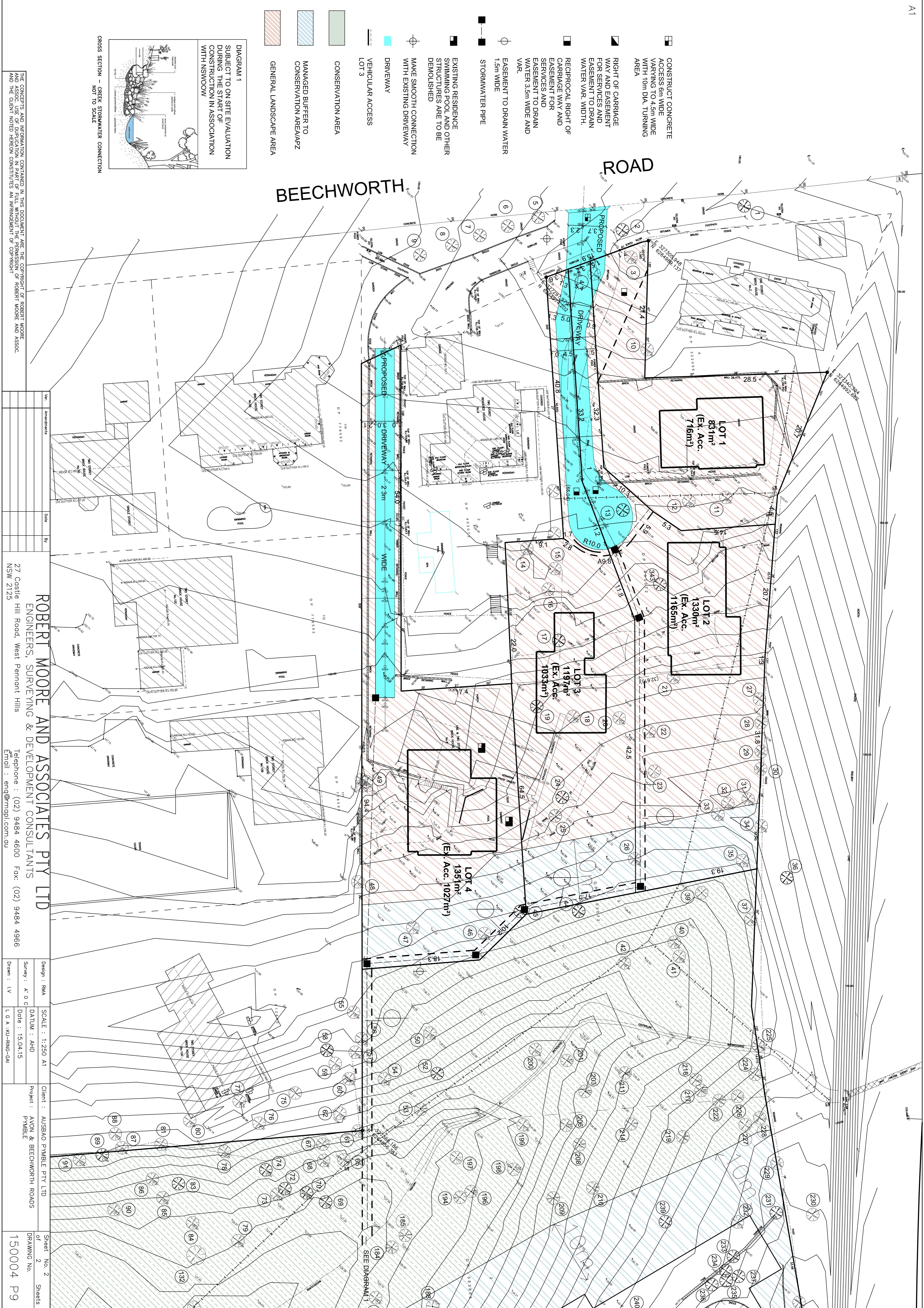

Author:	Amendments:	Date:	By:
<p>ROBERT MOORE AND ASSOCIATES PTY LTD ENGINEERS, SURVEYING & DEVELOPMENT CONSULTANTS</p> <p>27 Castle Hill Road, West Pennant Hills NSW 2125</p> <p>Telephone : (02) 9484 4600 Fax: (02) 9484 4966 Email : eng@rmapl.com.au</p>			
Design: RMA	SCALE: 1:250 A1	Client: AUSBAD PYMBLE PTY LTD	Sheet No. 2
Survey: A O C	DATUM: AHD	Project: AVON & BEECHWORTH ROADS	of 2 Sheets
Date: 15.04.15	Drawn: LV	DRAWING No. 150004 P9	