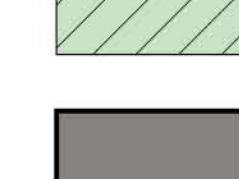
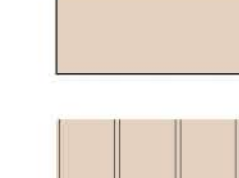

Legend

-  Existing trees / tall shrubs to be retained
-  Existing trees / tall shrubs to be removed
-  Existing garden beds
-  Proposed Central Coast Regional Cancer Care Centre
-  Proposed new driveway / carpark pavement
-  Proposed new pedestrian pavement
-  Proposed new pedestrian feature pavement and banding
-  Proposed native tree plantings
-  Proposed feature tree plantings
-  Proposed shrub / hedge plantings
-  Proposed new garden beds and plantings
-  Turfed areas

Key

- 01** Proposed Central Coast Regional Cancer Care Centre
- 02** Proposed vehicular access and disabled parking area
- 03** Proposed terraced garden beds and feature plantings
 - terrace walling
 - shade tolerance tree, shrub, and groundcover feature plantings
- 04** Existing steps modification
 - remove existing top steps for vehicular access widening
 - provide new steps with paved landing to top of steps
 - provide new garden bed and plantings adjoining new steps
- 05** Existing Southern Buffer Plantings
 - provide additional / infill native tree, shrub, and groundcover plantings
 - provide mulching to existing planting beds as required
- 06** Existing Eastern Buffer Plantings
 - provide additional / infill native tree and shrub plantings

N/A

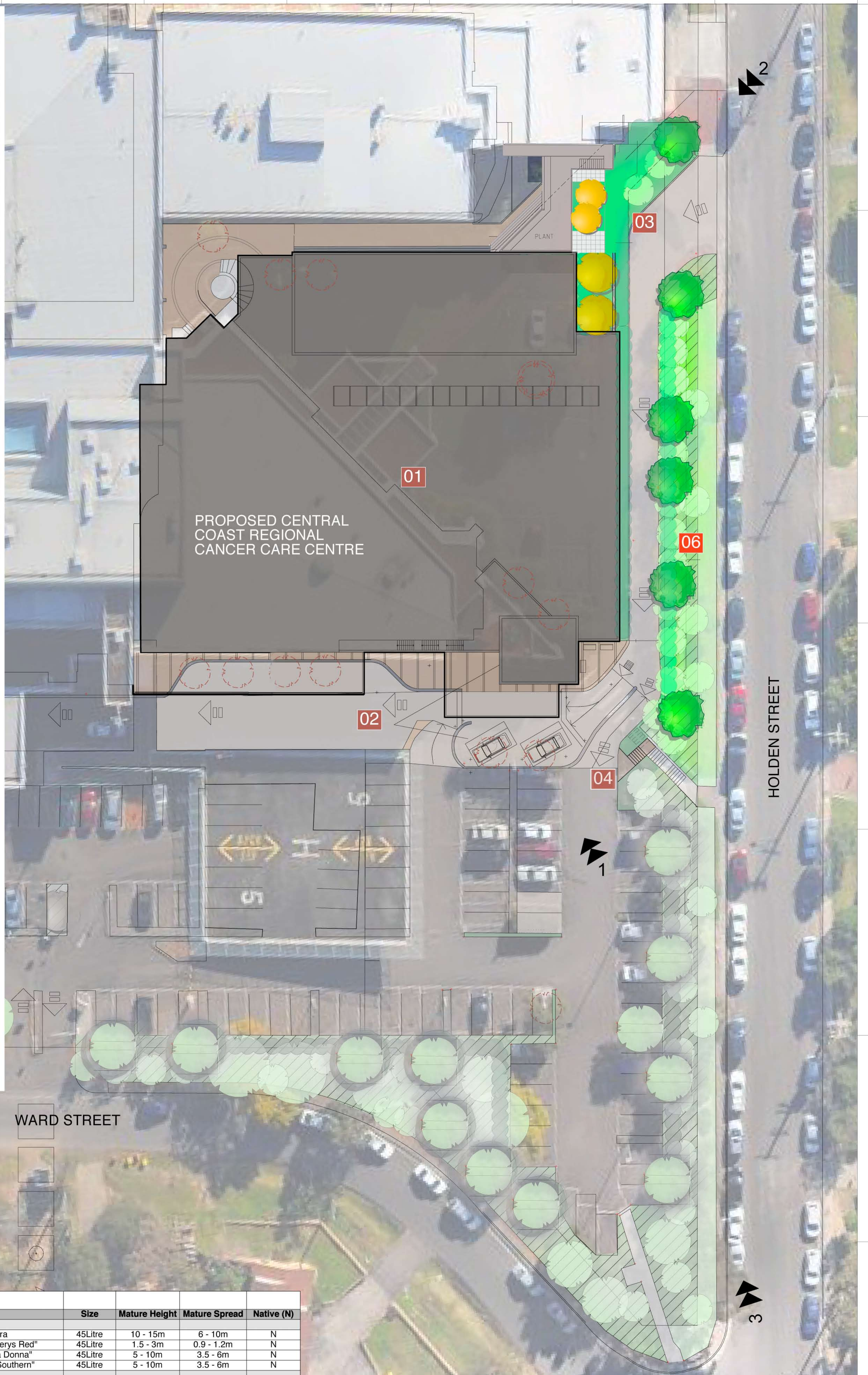

Proposed Plant Schedule						
ID	Common Name	Botanical Name	Size	Mature Height	Mature Spread	Native (N)
Trees						
BC	Lemon Scented Myrtle	Backhousia citriodora	45Litre	10 - 15m	6 - 10m	N
CE	NSW Christmas Bush	Ceratopetalum "Alberys Red"	45Litre	1.5 - 3m	0.9 - 1.2m	N
EL	Blueberry Ash	Elaeocarpus "Prima Donna"	45Litre	5 - 10m	3.5 - 6m	N
SY	Aussie Southern Lilly Pilly	Syzygium "Aussie Southern"	45Litre	5 - 10m	3.5 - 6m	N
Shrubs						
AH	Dwarf Lilly Pilly	Acmena 'Hedge Master'	200mm	0.8 - 1.0m	0.8 - 1.0m	N
BD	Heath-leaved Banksia	Banksia ericifolia dwarf	200mm	3 - 5m	3.5 - 6m	N
DE	Gymea Lily, Giant Lily	Doryanthes excelsa	200mm	1.5 - 3m	1.2 - 2.0m	N
GH	Grevillea	Grevillea 'Honey Gem'	200mm	1.5 - 3m	1.2 - 2.0m	N
GS	Superb Grevillea	Grevillea x 'Superb'	200mm	1.5 - 3m	1.2 - 2.0m	N
SA	Bush Christmas	Syzygium australe 'Bush Christmas'	200mm	1.5 - 3m	1.2 - 2.0m	N
WF	Coastal Rosemary	Westringia fruticosa 'Naringa'	200mm	0.9 - 1.5m	0.9 - 1.2m	N
Native Grasses & Ground Covers						
AF	Kangaroo Paw 'Gold Velvet'	Anigozanthos 'Gold Velvet'	150mm	0.75 - 0.9m	0.3 - 0.6m	N
GJ	Prickly Grevillea	Grevillea juniperina	150mm	0.6 - 0.75m	2.0 - 3.5m	N
DR	Spreading Flax Lily	Dianella revoluta 'Little Rev'	150mm	0.3 - 0.45m	0.3 - 0.6m	N
DT	Flax Lily	Dianella tasmanica 'Tasred'	150mm	0.75 - 0.9m	0.0 - 0.3m	N
LT	Spiny-headed mat rush	Lomandra longifolia 'Tanika'	150mm	0.45 - 0.6m	0.6 - 0.9m	N
HV	False Sarsaparilla	Hardenbergia violacea	150mm	0.75 - 0.9m	1.2 - 2.0m	N
MY	Carpet Spreading Myoporum	Myoporum parvifolium 'Yareena'	150mm	0.45 - 0.6m	0.9 - 1.2m	N
TJ	Star Jasmine	Trachelospermum jasminoides	150mm	3 - 5m	3.5 - 6m	N
WM	Mundi	Westringia fruticosa 'Mundi'	150mm	0.45 - 0.6m	0.9 - 1.2m	N

PROJECT
CENTRAL COAST REGIONAL CANCER CARE CENTRE (Gosford Hospital)
 Crn Holden St & Racecourse Rd Gosford NSW 2250

PREPARED BY:
 **GREENLAND DESIGN PTY LTD** -
 ABN 73 139 152 855
 Landscape Architect: C. Ly I AILA
 Mob.: 0403 164 198

CLIENT: SILVER THOMAS HANLEY
 HEALTH ARCHITECTURE

TITLE
LANDSCAPE CONCEPT PLAN

DRAWN BY: **CL** SCALE: **1:250 (A1)** DATE: **20/10/10**

NO. **DoP 14** AMD. **C**

REV	DESCRIPTION	DATE
C	Draft for Part 3A Test for Adequacy	17/11/10
B	Draft for Part 3A Test for Adequacy	17/11/10
A	Concept Plan	20/10/10

