

In accepting and utilizing this document the recipient agrees that SJB Architects (NSW) Pty. Ltd. ACN 081 094 724 (SJB Architects) retain all common law, statutory law and other rights including copyright and intellectual property rights. The recipient agrees not to use this document for any purpose other than its intended use, to waive all claims against SJB Architects resulting from unauthorised changes, or to reuse the document on other projects without the prior written consent of SJB Architects. Under no circumstances shall transfer of this document be deemed a sale. SJB Architects makes no warranties of fitness for any purpose.

The Builder/Contractor shall verify job dimensions prior to any work commencing. Figured dimensions shall take precedence over scaled work.

Rev.	Date	Revision
A	12/11/2010	DA Test of Adequacy
A-1	22/02/2011	Preferred Project

PARKING SCHEDULE - BASEMENT - 01	
PARKING TYPE	NUMBER
Adaptable Car Space	33
Standard Car Space	279
<b>TOTAL</b>	<b>312</b>

PARKING TYPE	
PARKING TYPE	NUMBER
Carwash Bay	1
Motor Bike Space	2
<b>TOTAL</b>	<b>3</b>

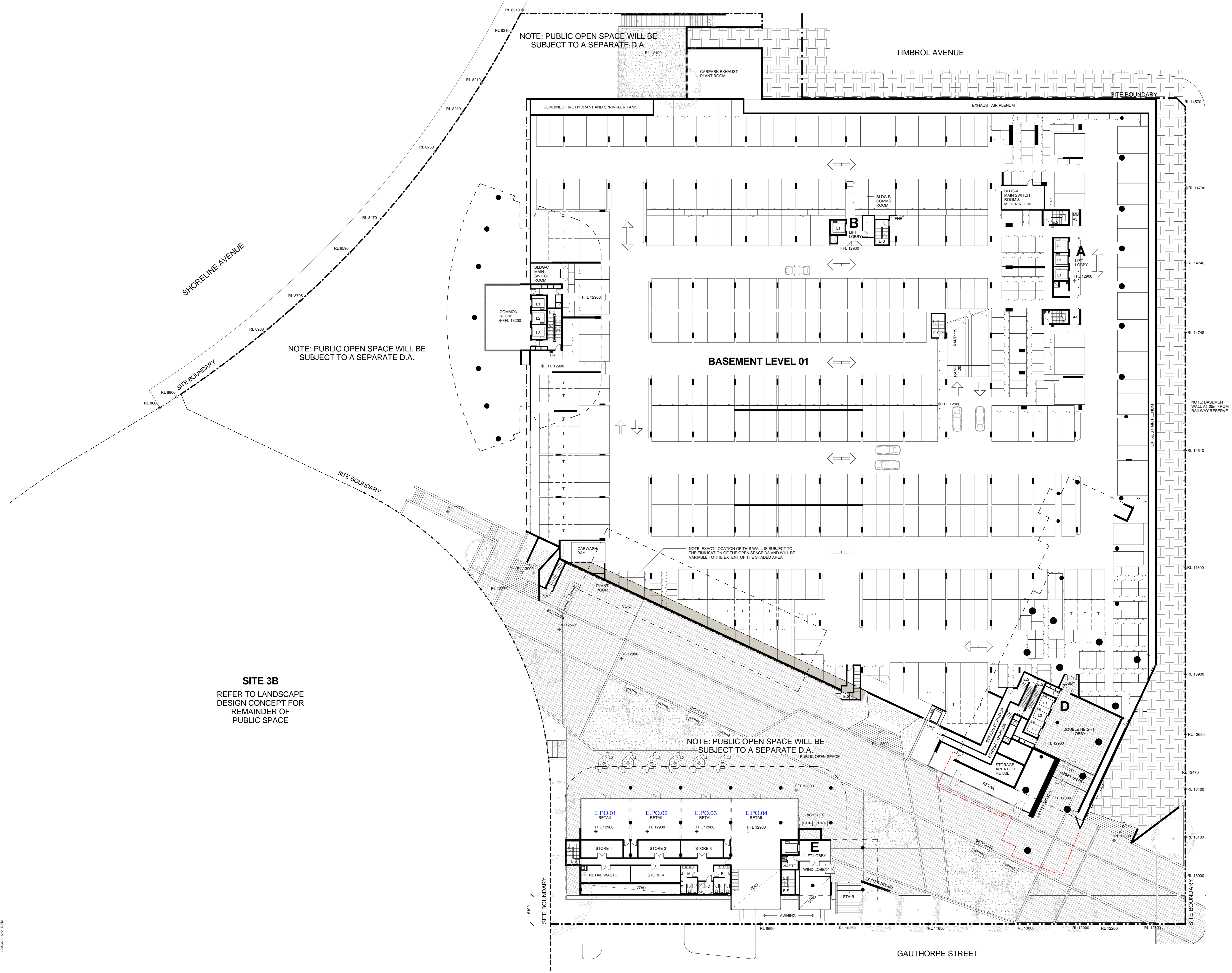

WALKER STREET

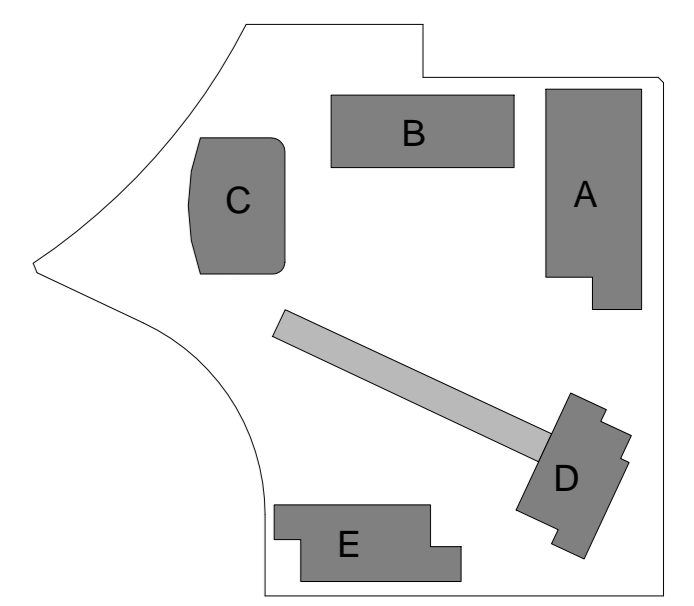

**SITE 3B**  
REFER TO LANDSCAPE  
DESIGN CONCEPT FOR  
REMAINDER OF  
PUBLIC SPACE



Client  
Project  
**STAGE 2A + 3A**  
**WALKER ST.**  
**RHODES**  
for  
Billbergia Developments

Drawing Name  
**Level 1 Basement**

Date  
**08/12/10**

Scale  
**1 : 250**

Sheet Size  
**@ B1**

Reg No.  
**MM/NH**

Drawn  
**JP**

Job No.  
**4410**

Drawing No.  
**A-0202**

Revision  
**A-1**

SJB Architects  
Level 2, 490 Crown St  
Surry Hills NSW  
2010 Australia  
T 61 2 9380 9811  
F 61 2 9380 9822  
www.sjb.com.au  
Norman Architects  
Adam Haddock 7188  
John Pradel 7004

