

In accepting and utilising this document the recipient agrees that SJB Architects (NSW) Pty. Ltd. ACN 081 094 724 SJB Architects, retain all common law, statutory law and other rights including copyright and intellectual property rights. The recipient agrees not to use this document for any purpose other than its intended use. To waive all claims against SJB Architects resulting from unauthorised changes, or to reuse the document on other projects without the prior written consent of SJB Architects. Under no circumstances shall transfer of this document be deemed a sale. SJB Architects makes no warranties of fitness for any purpose.

The Builder/Contractor shall verify job dimensions prior to any work commencing. Figured dimensions shall take precedence over scaled work.

Rev.	Date	Revision
A	12/11/2010	DA Test of Adequacy

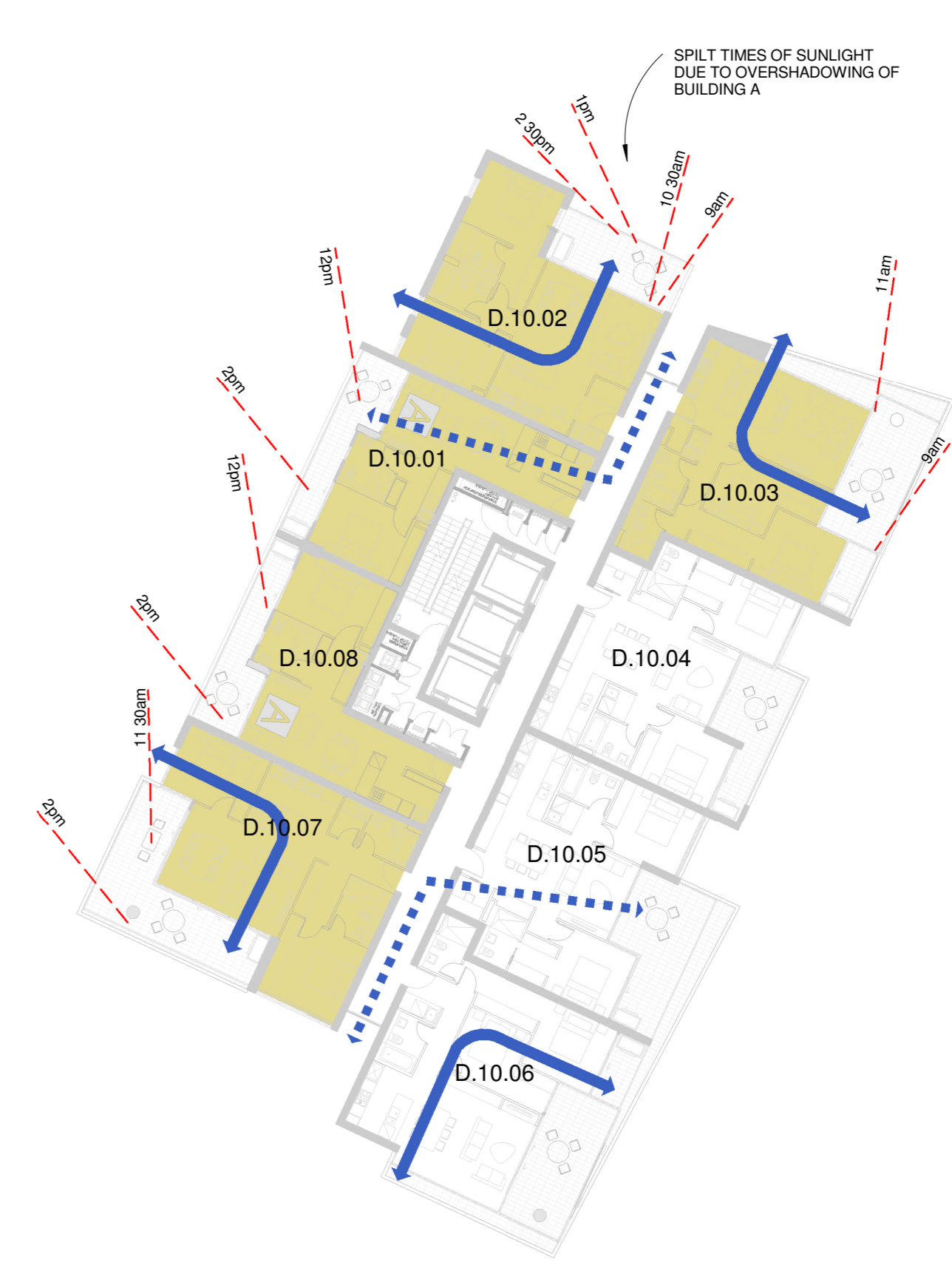
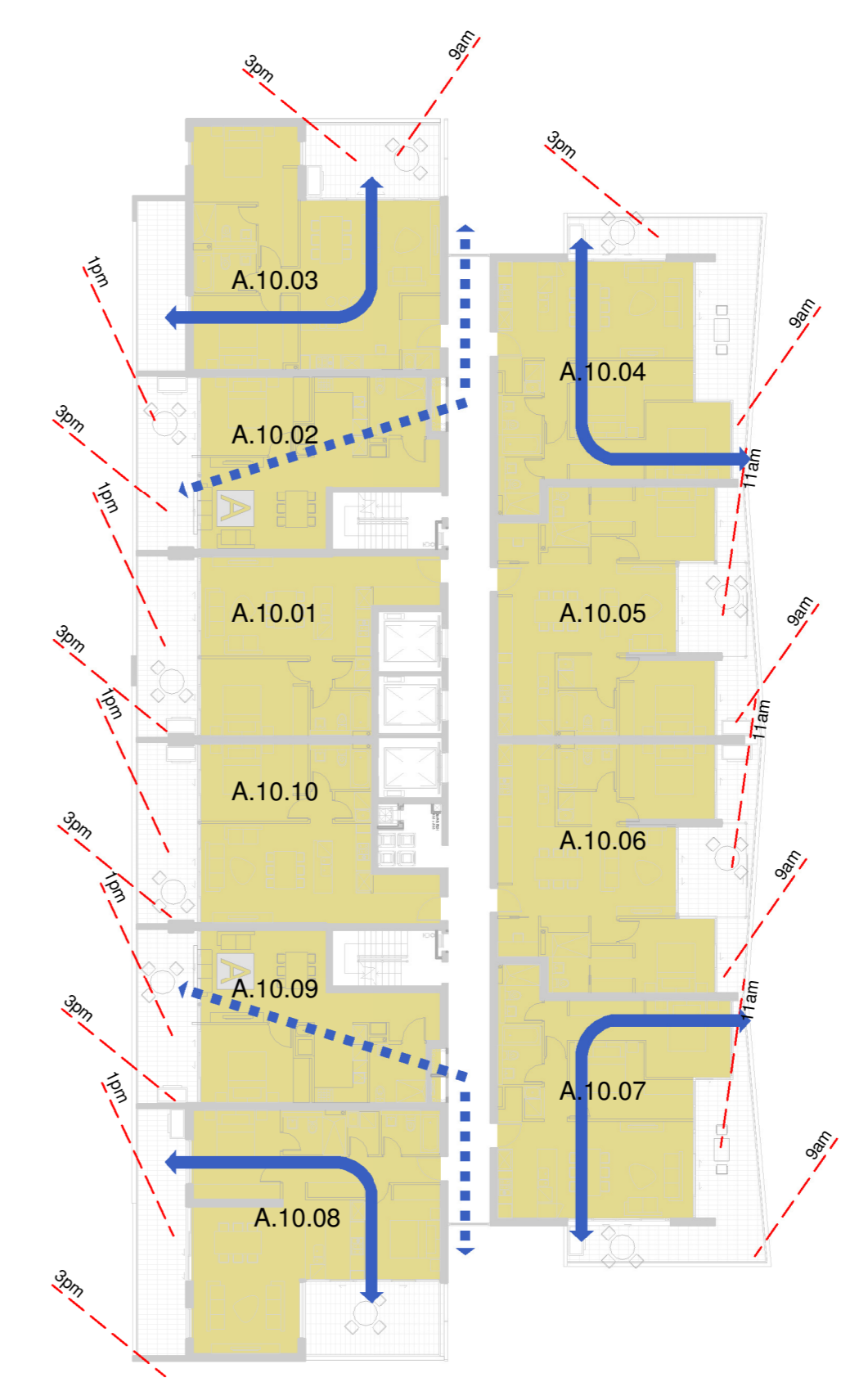
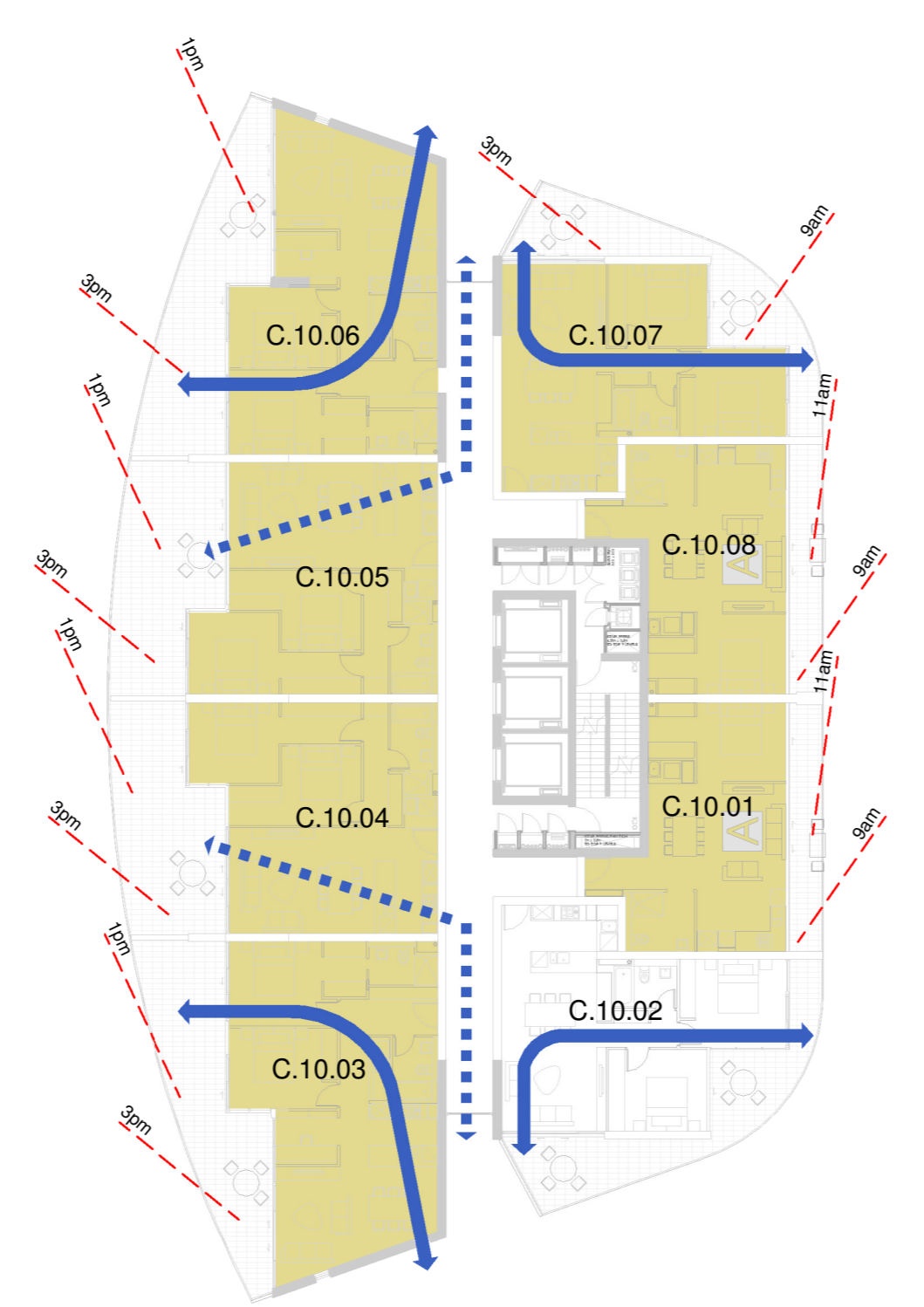

LEVEL	SOLAR ANALYSIS 9am-3pm 21st JUNE	
	2 HOURS (no of apartments)	FLOW THROUGH (no of apartments)
PDM	13	13
L1	33	37
L2	34	38
L3	36	38
L4	42	41
L5	34	32
L6	20	20
L7	22	18
L8	22	18
L9	22	18
L10	22	18
L11	22	18
L12	22	18
L13	22	18
L14	22	18
L15	22	18
L16	22	18
L17	22	18
L18	22	18
L19	22	18
L20	15	12
L21	15	12
L22	15	12
L23	15	12
L24	15	12
TOTAL	573	509
TOTAL UNITS	736	736
% OF TOTAL	77.9%	69.2%

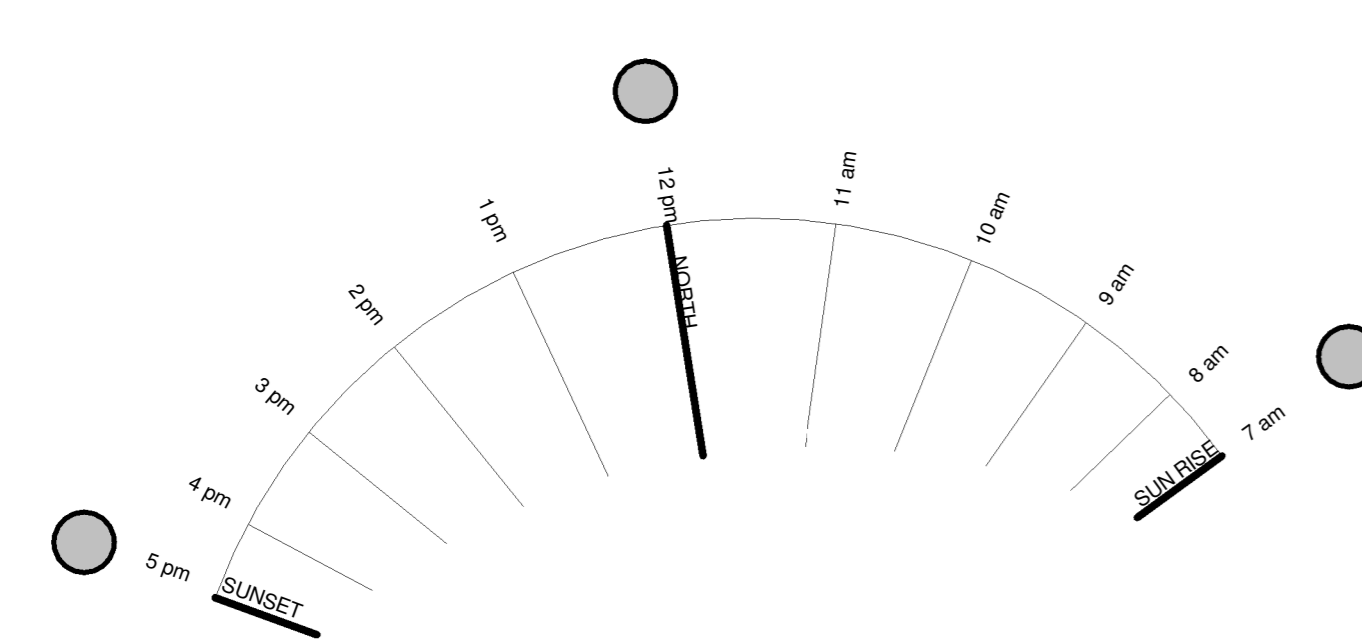
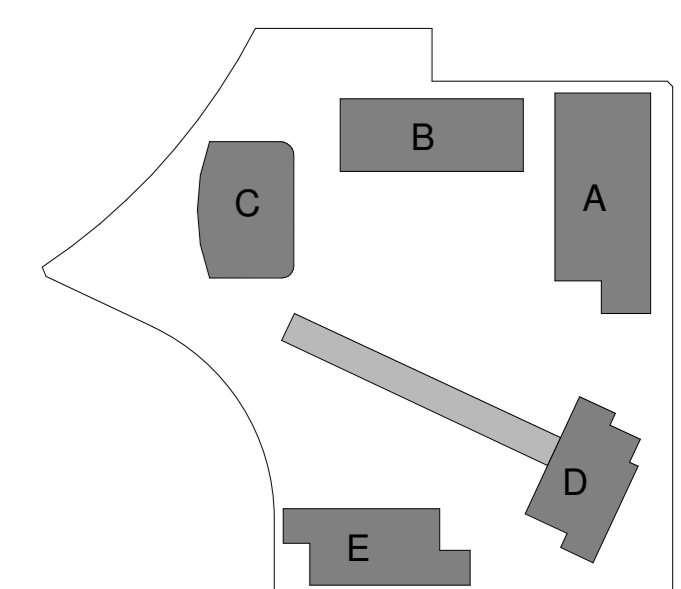

KEY

- CROSS FLOW APARTMENTS
- CROSSFLOW APARTMENTS USING BUILDING SIDE AIRFLOW
- APARTMENTS WITH MIN 2 HOURS OF SUNLIGHT ACHIEVED ON 21st JUNE BETWEEN 9am AND 3pm

Client

Project
**STAGE 2A + 3A
WALKER ST.
RHODES
for
Billbergia**

Drawing Name
Level 10 - Solar Study

Date: 11/03/10 Scale: 1 : 250 Sheet Size: @ B1

Reg No. Drawn Ctk.
DP/NH JP

Job No. Drawing No. Revision
4410 A-0270 A

SJB Architects
Level 2, 490 Crown St
Surry Hills NSW
2010 Australia
T 61 2 9380 9911
F 61 2 9380 9922
www.sjb.com.au

Nominated Architects
Adam Haddock 7188
John Prater 7004