

In accepting and utilising this document the recipient agrees that SJB Architects (NSW) Pty. Ltd. ACN 081 094 724 T/A SJB Architects, retain all common law, statutory law and other rights including copyright and intellectual property rights. The recipient agrees not to use this document for any purpose other than its intended use, to waive all claims against SJB Architects resulting from unauthorised changes, or to reuse the document on other projects without the prior written consent of SJB Architects. Under no circumstances shall transfer of this document be deemed a sale. SJB Architects makes no warranties of fitness for any purpose.

The Builder/Contractor shall verify job dimensions prior to any work commencing. Figured dimensions shall take precedence over scaled work.

Rev.	Date	Revision
A	12/11/2010	DIA Test of Adequacy

PARKING SCHEDULE - BASEMENT - 01	
PARKING TYPE	NUMBER
Adaptable Car Space	33
Standard Car Space	279
TOTAL	312

PARKING TYPE	NUMBER
Carwash Bay	1
Motor Bike Space	2
TOTAL	3

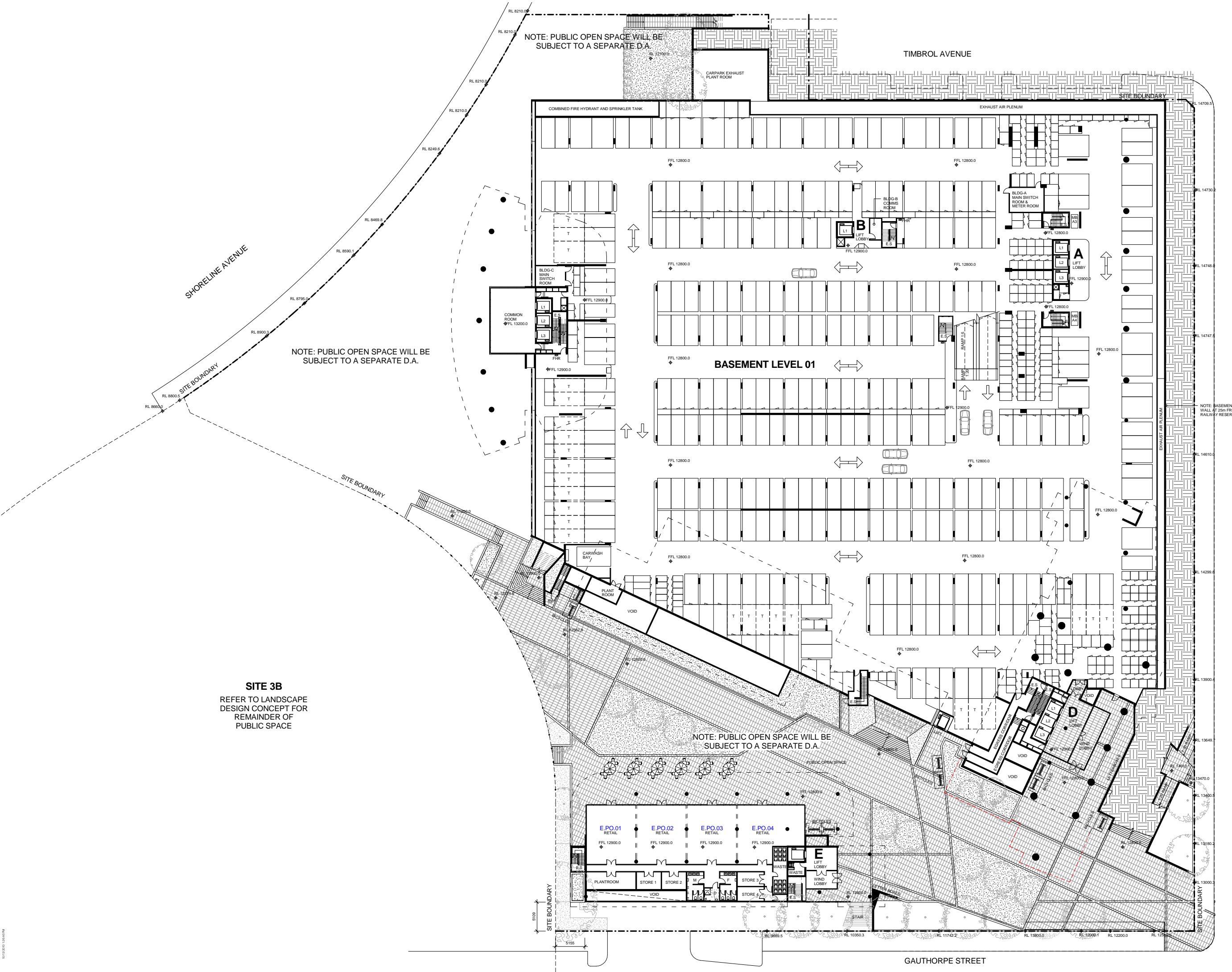

SITE 3B
REFER TO LANDSCAPE
DESIGN CONCEPT FOR
REMAINDER OF
PUBLIC SPACE

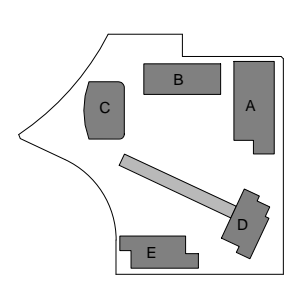

Client



Billbergia
creating communities®

Project
STAGE 2A + 3A
WALKER ST.
RHODES
for
Billbergia

Drawing Name
Level 1 Basement



Date	Scale	Sheet Size
08/12/10	1 : 250	@ B1
Req. No.	Drawn	Chk.
	MM/NH	JP
Job No.	Drawing No.	Revision
4410	A-0202	A

SJB Architects
Level 2, 490 Crown St
Surry Hills NSW
2010 Australia
T 61 2 9380 9911
F 61 2 9380 9922
www.sjb.com.au

Nominated Architects
Adam Haddock 7188
John Pradel 7004

