

In accepting and utilising this document the recipient agrees that SJB Architects (NSW) Pty. Ltd. ACN 081 094 724 / SJB Architects, retain all common law, statutory law and other rights including copyright and intellectual property rights. The recipient agrees not to use this document for any purpose other than its intended use, to waive all claims against SJB Architects resulting from unauthorised changes, or to reuse the document on other projects without the prior written consent of SJB Architects. Under no circumstances shall transfer of this document be deemed a sale. SJB Architects makes no warranties of fitness for any purpose.

The Builder/Contractor shall verify job dimensions prior to any work commencing. Figured dimensions shall take precedence over scaled work.

Rev.	Date	Revision
A	12/11/2010	DA Test of Adequacy

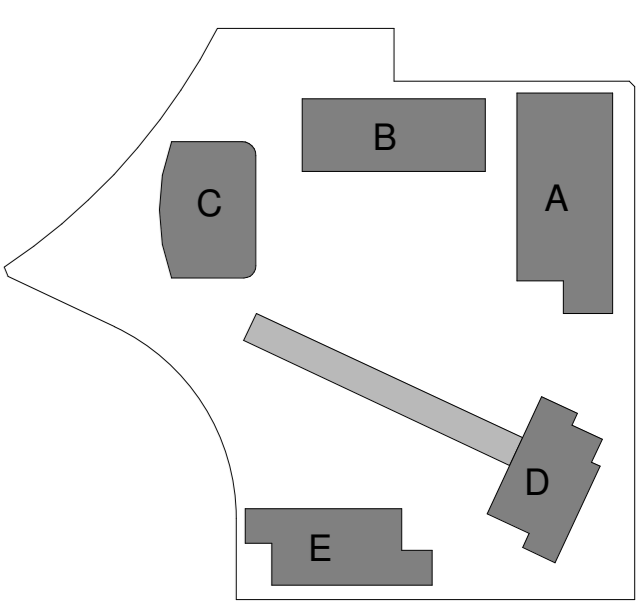
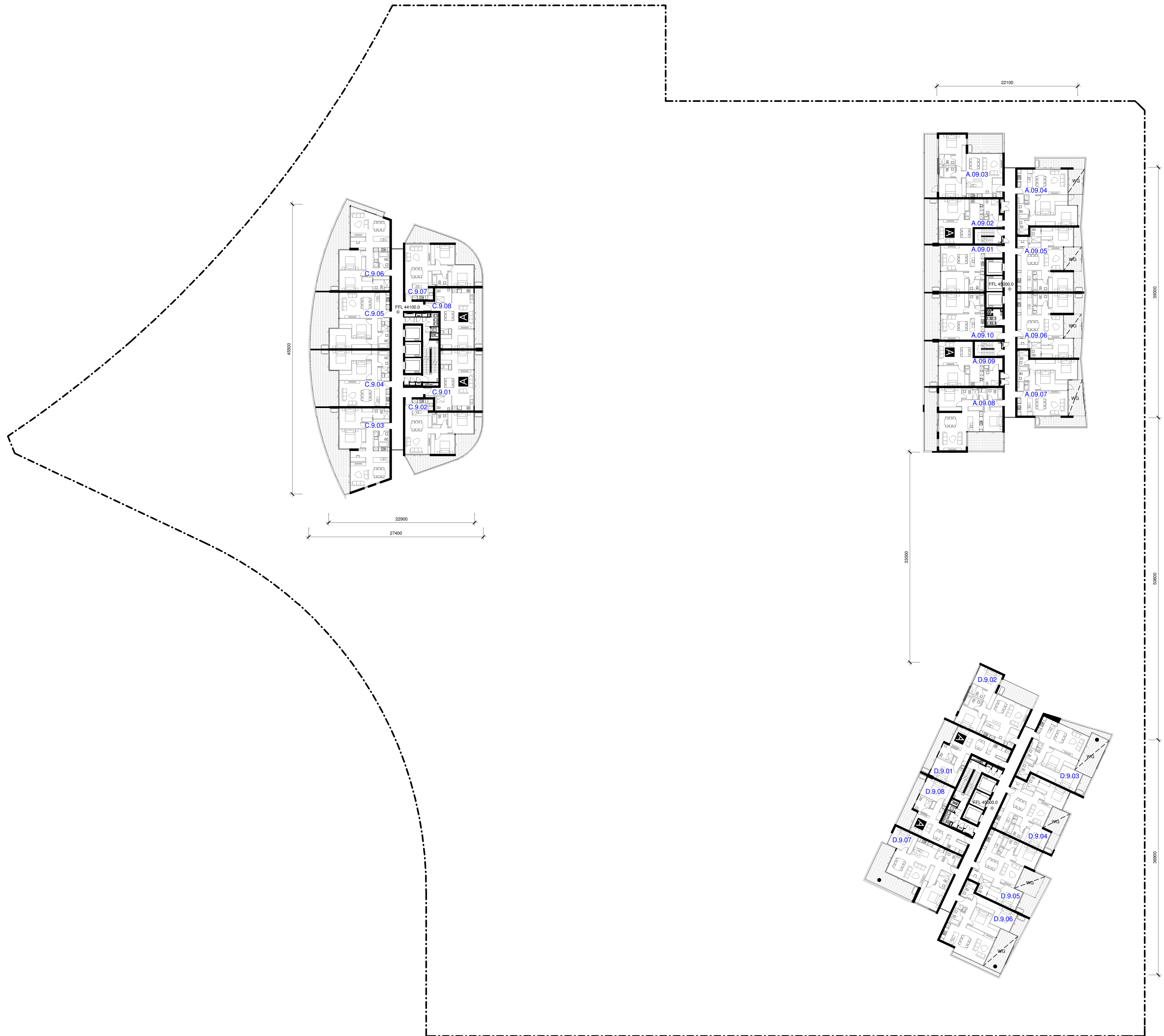

Client  
 Project  
**STAGE 2A + 3A**  
**WALKER ST.**  
**RHODES**  
 for  
**Billbergia**

Drawing Name  
**Level 09 Plan**  
**Levels 10-12 similar**

Date: 23/11/10  
 Scale: 1 : 250  
 Sheet Size: @ B1

Reg No. BS/NH  
 Drawn: BS/NH  
 Chk. JP

Job No. 4410  
 Drawing No. A-0211  
 Revision: A

**SJB Architects**  
 Level 2, 490 Crown St  
 Surry Hills NSW  
 2010 Australia  
 T 61 2 9380 9911  
 F 61 2 9380 9922  
 www.sjb.com.au  
 Nominated Architects  
 Adam Haddock 7188  
 John Pradel 7004

