



# ROYAL RANDWICK RACECOURSE

Spectator Precinct  
Landscape Design Report  
23 September 2010

ISSUE C

**AECOM**

Document Control  
Sheet

Project: Royal Randwick Racecourse Spectator  
Precinct  
Report Title: Landscape Design Report  
Client Reference: Australian Jockey Club Ltd  
Revision / Version: Issue B  
Authors: Phil Black, Phil Clegg  
Approved by: Paul Geehan  
Date: 23.09.2010

Distribution: Electronic Copies to:  
Refer to transmittal

Revision	Date	Approved	Details of Revision
Issue A	07.09.2010	Paul Geehan	Draft Report
Issue B	21.09.2010	Paul Geehan	Draft Report
Issue C	23.09.2010	Paul Geehan	Final Report

This document has been prepared solely for the benefit of MMA and HDA and is issued in confidence for the purposes only for which it is supplied. Unauthorised use of this document in any form whatsoever is prohibited. No liability is accepted by EDAW Australia Pty Ltd or any employee, contractor, or sub-consultant of this company with respect to its use by any other person. This disclaimer shall apply notwithstanding that the document may be made available to other persons for an application for permission or approval to fulfil a legal obligation.

# Contents

<b>1.1 Introduction</b>	<b>4</b>
<b>1.2 Context</b>	<b>4</b>
Site Analysis	
<b>1.3 Landscape Structure</b>	<b>9</b>
Arrival	
Circulation	
Pedestrian Axis	
Spectator Precinct	
Super Grid	
Green Links	
Stormwater Management	
Furniture & Art Installations	
<b>1.4 Concept Design</b>	<b>14</b>
<b>1.5 Planting Palette</b>	<b>18</b>
<b>1.6 Indicative Planting Schedule</b>	<b>20</b>
<b>1.7 Character and Material Imagery</b>	<b>22</b>

# 1.1 INTRODUCTION

The Australian Jockey Club (AJC Ltd) is proposing to develop a new spectator precinct at Royal Randwick Racecourse.

The new spectator precinct external works and public realm will be developed within the existing spectator areas as part of the development of the new entry and grandstand upgrade.

The site is located at the main entrance to Alison Road and the former tramway entrance. The site has a significant number of large existing mature figs that provide a strong landscape structure and evergreen backdrop. The existing gradient slopes from a ridgeline through the centre of the precinct east towards the racecourse itself and west towards the tramway entry. Storm water run off will be collected primarily by the amended existing storm water system, allowing for run off to be harvested within garden beds and turf areas.

## Development Application

This report describes the landscape components of the proposed development. It includes a Landscape Concept Plan (as required by the Development Control Plan 2007), supported by a description of the design intent, for approval.

### Legend

- - - Royal Randwick Racecourse
- - - Extent of Part 3A works

# 1.2 CONTEXT



Regional Context

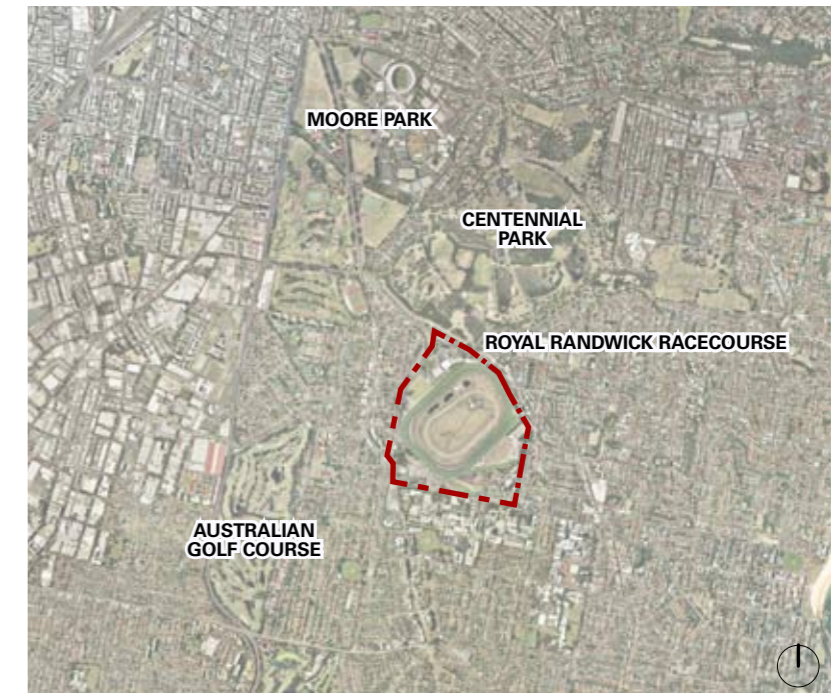

Local Context



Royal Randwick Racecourse

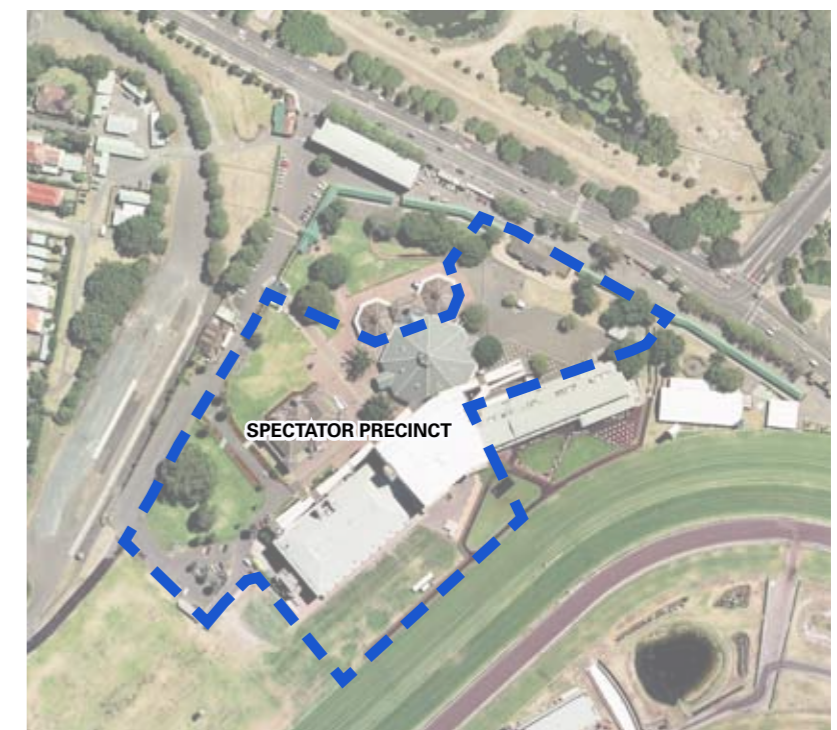

Extent of Part 3A Works

# Site Analysis



1 View of entry plaza from Alison Road



2 View of existing spectator stands from entry plaza



3 View of existing bus shelter and turnstiles



4 View of existing picnic area



5 View of existing large fig tree

# Site Analysis

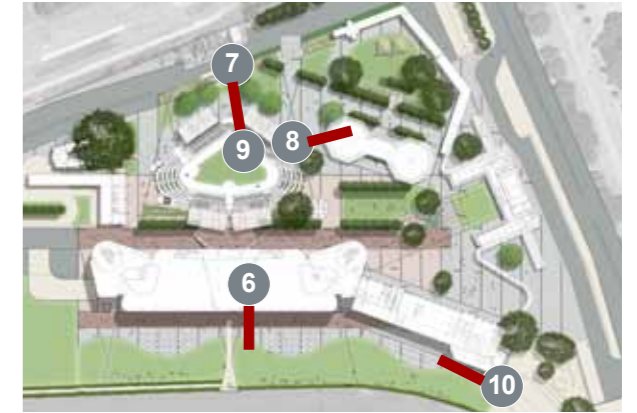

6 View of racetrack from existing paddock stand



7 View to Tea-House from Heritage turnstiles



8 Tote building



9 Heritage Turnstile



10 Members Stand

# 1.3 LANDSCAPE STRUCTURE



## Arrival

Gates / Turnstiles / Experience / Anticipation



## Circulation

Track / Parade ground / Crowd movement / Experience hierarchy





### Pedestrian Axis

Linear / Primary / Secondary / Boulevard / Threshold / Activity / Channel / Experience



### Spectator Precinct

Core / Experience / Activity / Density / Character / Atmosphere / Structure / Materiality





### Super Grid

Pattern / Zone / Emphasis / Architecture / Delineation



### Green Space

Unity / Overlay / Backdrop / Flexibility / Relief / Passive



**Stormwater Management**  
Passive irrigation / Capture / Reuse / Control / Infiltration



**Furniture & Art Installations**  
Entry/icon / Gathering / Atmosphere / Wayfinding / Direction / Seating / Heritage



## 1.4 CONCEPT DESIGN

### Design Approach

The proposed upgrades to the Spectator Precinct will be a well designed series of quality landscape spaces meshed together to form a cohesive public realm responding to the functional program of the public realm, which must be flexible in use, yet robust.

The New Spectator Precinct consists of 6 key key organizing functions:

1. Arrival
2. Circulation
3. Pedestrian axis
4. Spectator precinct
5. Super grid
6. Green links
7. Stormwater
8. Furniture and Art Installation

The various landscape spaces will be linked by these key organizing functions to create a legible and well ordered public realm. Each of the spaces will offer unique landscape characteristics provided through subtle delineations in landscape treatments, creating a distinctive feel and quality as you move from one space to another.

### Design Intent

The landscape design has evolved in response to the proposed architectural program together with the functional program of the external spaces thus created.

- / The proposed adaptive re-use of the existing Swab Building (described elsewhere) will create a new visitor experience at the main turnstile entry zone. Immediately inside the new entry an orientation zone is defined by the turfed Swab Building quadrangle, a major new 'Equestrian' artwork (see below), and a large turfed quadrangle beyond. The whole is defined by the large existing trees. The composition of these features is designed to lead visitors around to the pedestrian boulevard of the Parade Ground.
- / The proposed grandstand buildings and Parade Ground create a new spectator experience. The public realm response presents a pedestrian 'boulevard' that defines the main crowd circulation zone whilst creating a cohesive 'threshold' space to the new buildings.
- / The Spectator Precinct is primarily a welcoming and enjoyable pedestrian environment. Open lawn areas will be enlarged to provide flexible places of respite during 'event-mode' and areas for picnics and open air functions. The existing mature Fig Trees provide an established evergreen backdrop while providing shade to seating areas beneath. Lines of pleached trees, such as the Hills Fig, provide spatial definition, shade and a mediating scale between the pedestrian and the heroic scale of the grandstands, creating an intimate street-like atmosphere. Within the Old Tote Building a cafe/ bar spills out into adjacent paved areas and services the adjacent picnic areas.
- / Various sandstone features recovered from previous works programs are to be integrated into the equestrian artwork as part of a broader, site-wide interpretative program. An equestrian artwork, on the

theme of 'Wild Brumbies' will incorporate shallow and misting water features to provide an illusion of movement to life size bronze horses. This iconic artwork will provide an exciting entry statement, a very legible meeting point and orientation feature.

- / All existing trees will be retained. New tree planting throughout the Parade Ground boulevard will incorporate passive water harvesting and rain gardens for irrigation purposes. This is considered best practice for both the initial establishment and long term health of street trees.
- / The diamond shaped parade ground is sunken below ground level and flanked by two existing mature figs. Each corner of the parade ground is framed with a garden bed of hedging and dense ground covers. Shade structures to the western side of the parade ground are mirrored by pleached trees on the eastern side which reinforce the pedestrian axis. The pleached trees in this area are positioned strategically to avoid blocking views of the parade ground from the upper story of the adjacent grand stands viewing boxes.
- / The landscaping continues around the western site boundary either side of the tramway entry to maximise the extent of softscape within the precinct. The existing boundary wall and planting is retained to ensure current levels of privacy at the site boundary.

## Hard Landscaping

### Paving

- / Type 1: Threshold Paving
  - Dark red coloured high density precast concrete unit paving with a honed finish layed within an insitu white concrete flush header band.
- / Type 2 : Precinct Paving
  - Light red high density precast concrete unit paving with a shot-blast finish within a honed dark red brick header course aligned with architectural column grid.
- / Type 3 : Other Paving
  - Charcoal coloured high density precast concrete unit paving with a shot-blast finish within dark red brick header course aligned with architectural column grid.

### Seats

- / Sandstone collected and held at the site maintenance depot will be designed into custom sandstone bench seats that sit primarily under the existing mature figs in order to maximise the shaded areas. The seats will feature LED strip lights are located within the base to provide subtle night time lighting.

### Walls

- / Low retaining walls and informal seating walls are constructed from in-situ concrete to match the design language of the architecture and existing site elements.

### Furniture and Fittings

- / Stainless Steel is proposed for handrails, amd stormwater trench grates. Black powder coated square hollow sections will be used for bollards, bike racks, bins, signage an dlight poles to retain a coherent 'family' of elements across the site.
- / Existing cast iron grandstand columns held on site will will be reused to provide a rhythmic overlay and subtle spatial definition along the western side .

### Lighting

- / Tapered square hollow section light poles will be utilised to provide general lighting to the Spectator Precinct.
- / LED strip lights shall be embedded in the paving to reinforce the east - west connection between the race track and the parade ground and as features set to walls and sandstone bench seating.
- / Subtle 'up lighting' of the pleached boulevard trees will highlight the seating areas and trees in the evening.

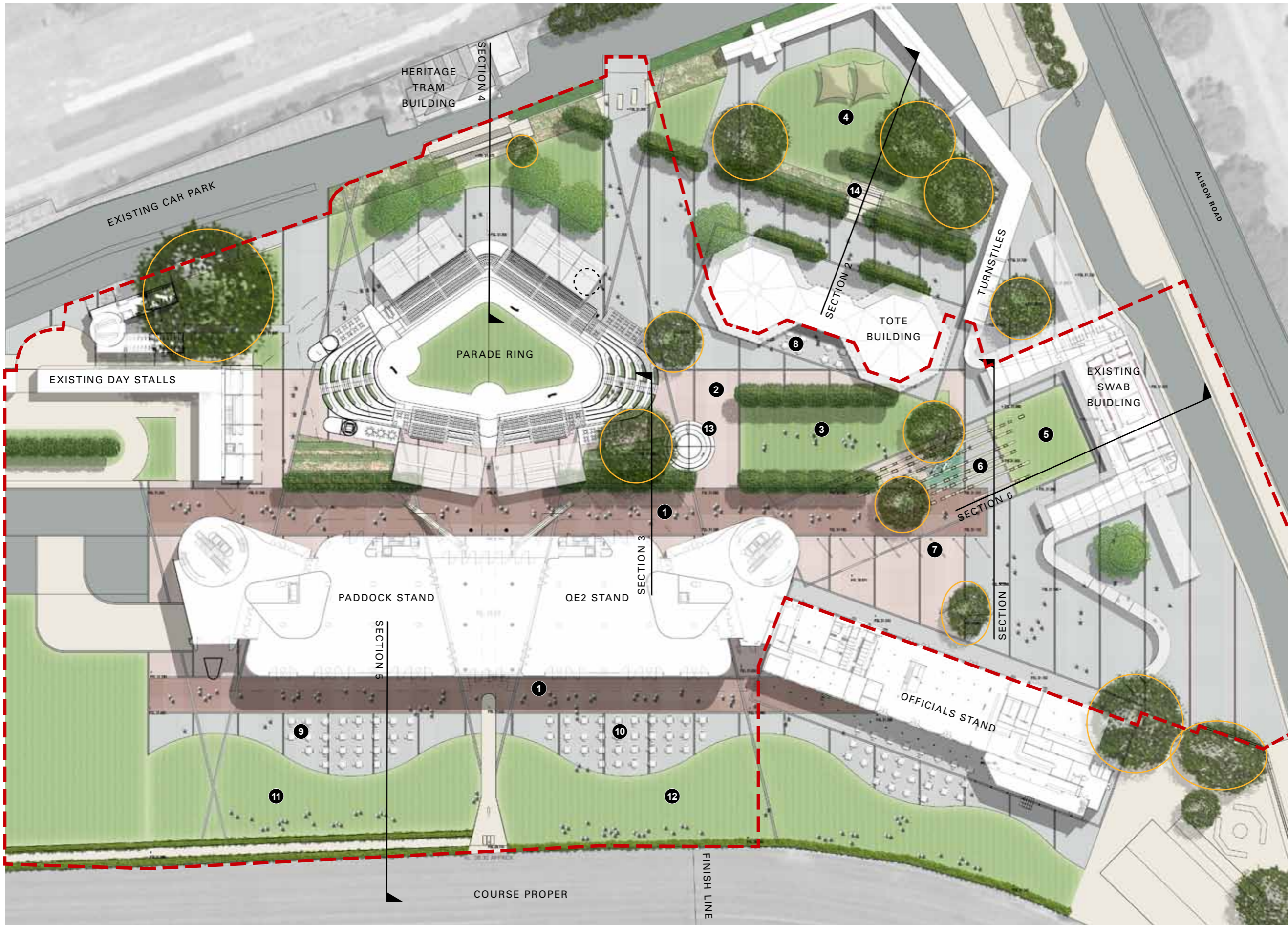

### Legend

- 1 Main Pedestrian Boulevards
  - 2 Spectator Precinct
  - 3 Main Lawn
  - 4 Family Lawn & Play Area
  - 5 Swab Building Lawn
  - 6 Running Horse Water Feature
  - 7 Heritage Lamp-posts
  - 8 Outdoor Cafe/ Bar Space
  - 9 Members Outdoor Seating Area
  - 10 Public Outdoor Seating Area
  - 11 Members Spectator Lawn
  - 12 Public Spectator Lawn
  - 13 Pedestrian Tunnel Access
  - 14 Bridal Gate
- 
- Concrete Paving Bands
  - Block Paving Type 1
  - Block Paving Type 2
  - Block Paving Type 3
  - Formal Lawn
  - Ornamental Garden Bed
  - English Box Hedging
  - Existing Fig Tree
  - Proposed Tree
  - Pleached Trees
- 
- Extent of Part 3A Works
  - Existing Tree to be retained and protected
  - ⊖ Existing Tree to be removed (refer Arborist Report)

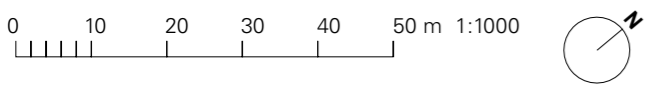

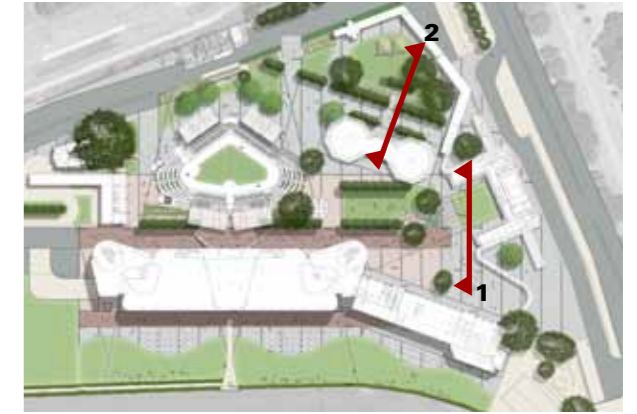

Section 1

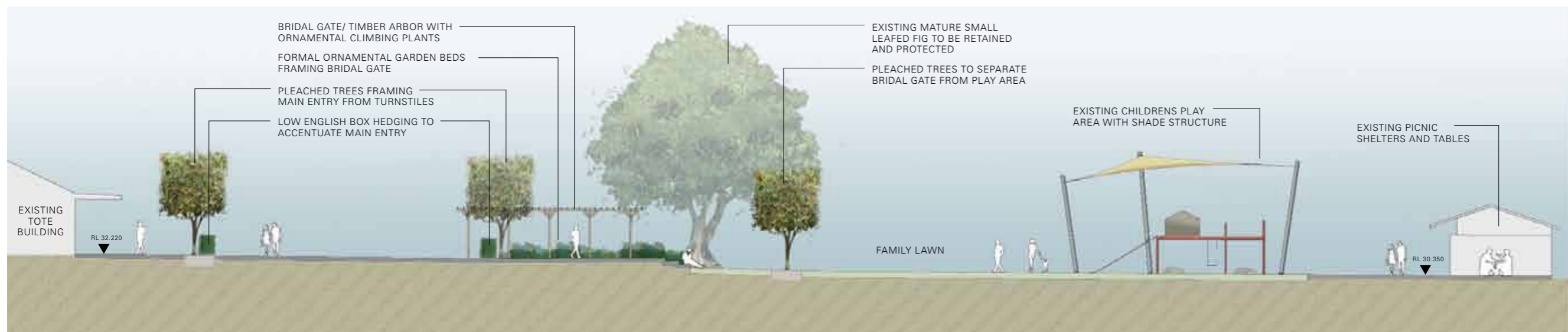

Section 2



Section 3



Section 4

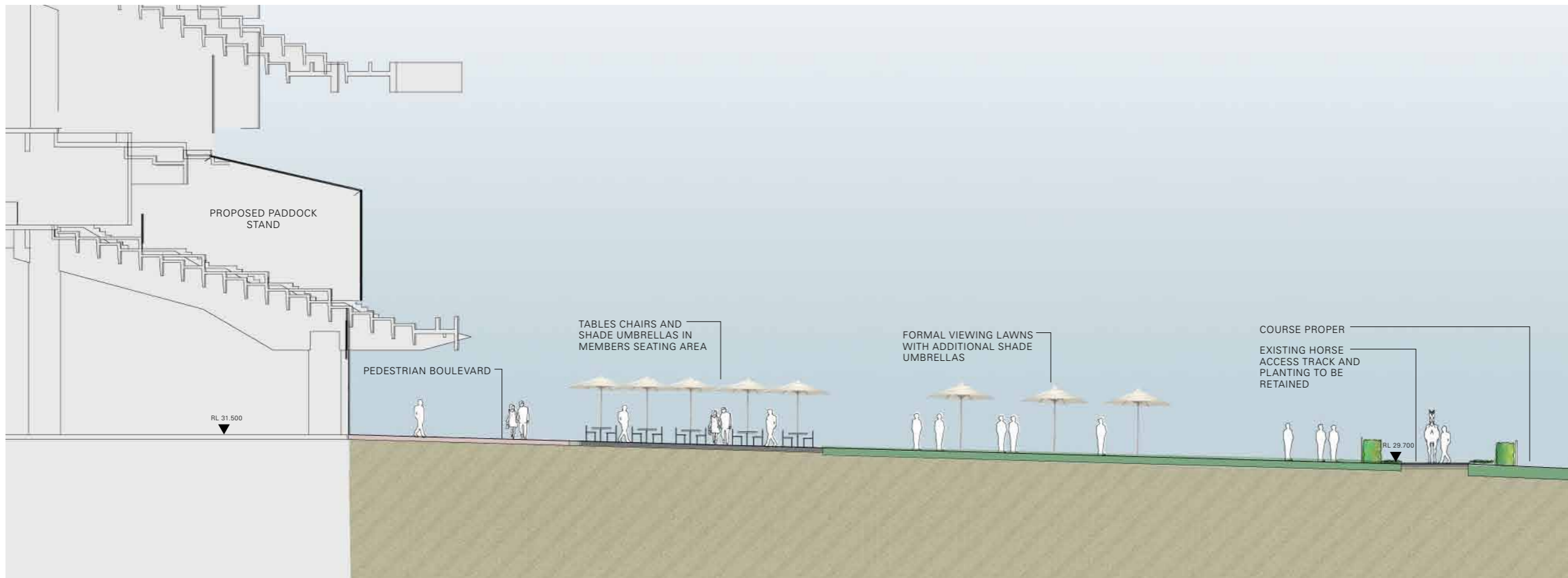
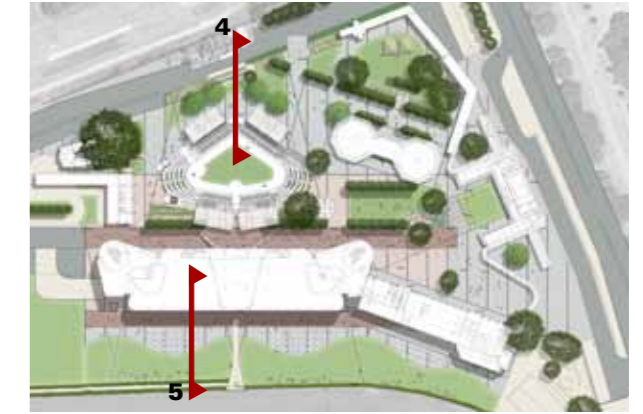

Section 5

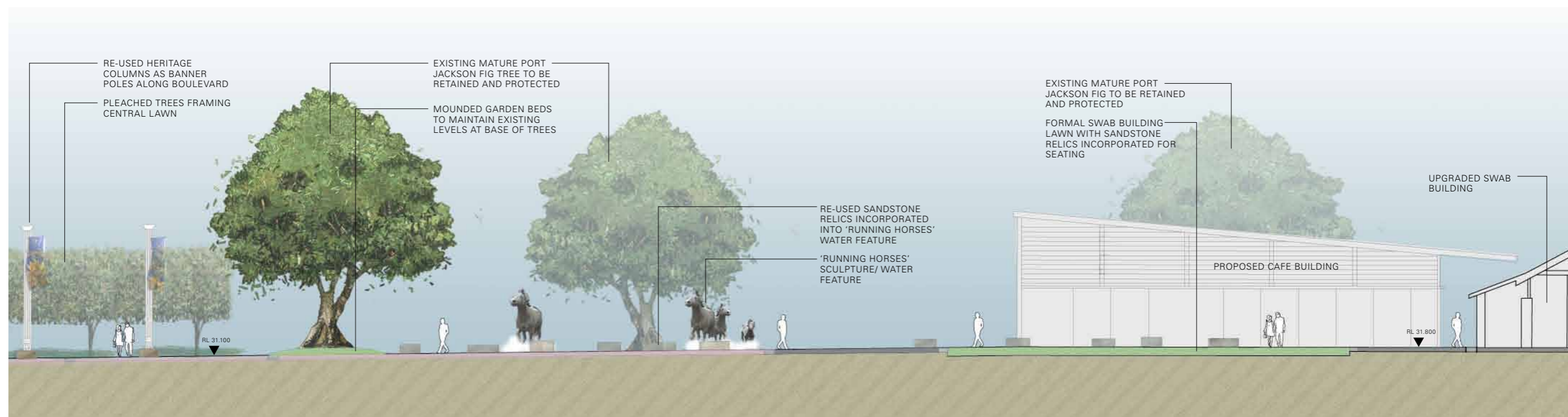

Section 6

## 1.5 PLANTING PALETTE - Trees



Existing *Ficus rubiginosa*



Pleached *Ficus hillii*



Pleached *Tilia cordata*

## Hedges and Groundcovers



Flowering Poppy spp



*Rhoeo spathacea*



*Alternanthera dentata*



*Buxus japonica*



*Carpobrotus glaucescens*

## 1.6 INDICATIVE PLANTING SCHEDULE

Botanical Name	Common Name	Mature height	Nominal Spacing
<b>Boulevard Trees - Deciduous</b>			
<i>Tilia cordata</i>	Small-leaved Lime	8m	As Shown
<i>Ficus Hilli</i>	Hills Fig	10m	As Shown
<b>Structure Trees - Evergreen</b>			
<i>Ficus rubiginosa</i>	Port Jackson Fig	20m	As Shown
<i>Ficus microcarpa var. hillii</i>	Hill's Fig	20m	As Shown
<i>Ficus macrophylla</i>	Moreton Bay Fig	20 m	As Shown
<b>Shrubs and Groundcovers</b>			
<i>Magnolia grandiflora</i> 'Little Gem'	Dwalf Magnolia	10m	1/m2
<i>Ajuga reptans</i>	Blue Bugle	0.3m	9/m2
<i>Dianella revoluta</i>	Flax Lillies	0.5m	9/m2
<i>Liriope</i> 'Evergreen Giant'	Turf Lily	0.8m	9/m2
<i>Alternanthera dentata</i>	Joseph's coat	0.5m	6/m2
<i>Hardenbergia violacea</i>	Happy Wanderer	0.2m	4/m2
<i>Trachelospermum jasminoides</i>	Chinese Star Jasmine	0.2m	4/m2
<i>Rhoeo spathacea</i>	Moses in the Cradle	0.2m	9/m2
<i>Carpobrotus glaucescens</i>	Native Pig Face	0.2m	9/m2
<i>Dianella</i> 'Little Rev'	Little rev	0.3m	4/m2
<b>Hedges</b>			
<i>Buxus japonica</i>	japanese box	0.8m	4/m2
<i>Photinia x fraseri</i> 'Red Robin'	Red Robin	1.2m	4/m2
<i>Murraya paniculata</i>	Oranage jessamine	1m	4/m2
<b>Turf</b>			
<i>Stenotaphrum secundatum</i> 'Sir Walter'	Soft-leaved Buffalo		N/A

# 1.8 MATERIAL IMAGERY - Arrival



Impressive arrival signage such as this example at the Melbourne Museum



A subtle misting water feature highlights arrival



Existing mature figs provide an evergreen backdrop



Well articulated ground plain emphasis pedestrian orientation

# Circulation



Unit paving highlights the pedestrian zones



Strip LED lighting accentuates circulation between the track and parade ground



Modular unit paving provides a robust felxible surface



Rubberised surfaces are necessary in equestrian zones



Insitu concrete headers frame paving

## Pedestrian Axis



A well defined pedestrian axis Pedestrian axis allows for large crowd movement and service vehicle access



Subtle uplighting ensures night time accents



Tree planting along the axis gives street definition to the main circulation zones



Pleached trees reinforce the formal axis, mediating between the human and architectural scales

# Spectator Precinct



Informal tree arrangement within structured paving layout



Sporting Events of Regional Significance



Large Scale Pedestrian Boulevard at Sydney Olympic Park



Clipped Box Hedging and Formal Lawns

## Super Grid



Structure to the ground plane emphasises the architectural setout



A paving 'super grid' provides order to the detailed design overlay



The super grid ties the site together as a whole

# Green Space



Green space across the site is predominantly turf



The central lawn area is the heart of the Spectator Precinct



Paths from tramway entries cut through the turf areas



Special events and functions, including marquees

# Stormwater Management

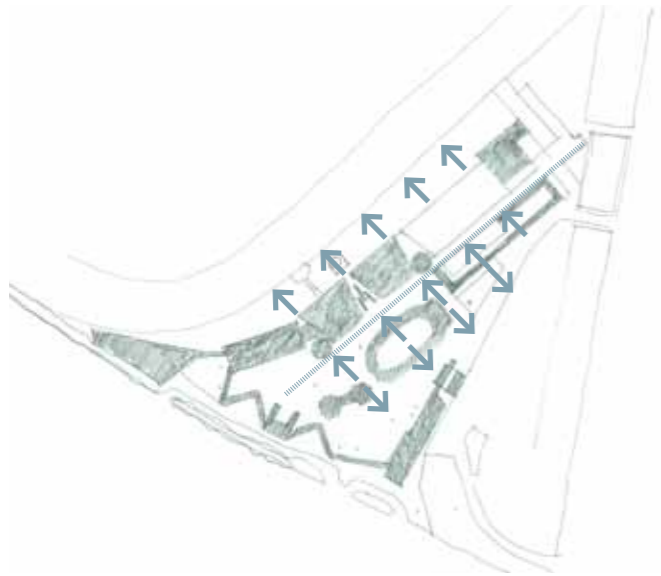

Drainage grates and other service pits are intergrtaed into the paving layout



Stainless steel trench grates ensure grades are smooth and peven



Stormwater run off is directed to turf areas for passive irrigation purposes



Garden beds and tree pits also benefit from passive irrigation

## Furniture & Art Installations



Existing sandstone relics are intergrated into the spectator precinct



Wild brumbies at the main entry provide a sence of excitement



Furniture and lighting elements retain the existing black powder coat aesthetic



The brumbies and sandstone relics are incorporated into the arrival

