

INTELLECTUAL PROPERTY
© COPYRIGHT BVN ARCHITECTURE PTY LIMITED. UNLESS OTHERWISE ADVISED IN WRITING, ALL RIGHTS TO USE THIS DOCUMENT ARE RESERVED TO BVN ARCHITECTURE PTY LIMITED. THIS DOCUMENT MAY ONLY BE USED FOR THE ORIGINAL PURPOSE AND PROJECT FOR WHICH IT HAS BEEN CREATED AND CANNOT BE REPRODUCED, COPIED, REPRODUCED, OR OTHERWISE USED, OR COPIED, ANY UNAUTHORIZED USE OF THIS DOCUMENT IS AT THE USER'S SOLE RISK AND WITHOUT LIMITING BVN'S RIGHTS THE USER RELEASES AND INDEMNIFIES BVN FROM AND AGAINST ALL LOSS OR DAMAGE.

| ISSUE | DATE | FOR |
|-------|----------|-------------|
| 1 | 16.07.10 | SPP PDP |
| 2 | 04.08.10 | SPP PDP |
| 3 | 16.08.10 | INFORMATION |
| 4 | 19.08.10 | DA |
| 5 | 23.08.10 | DA |

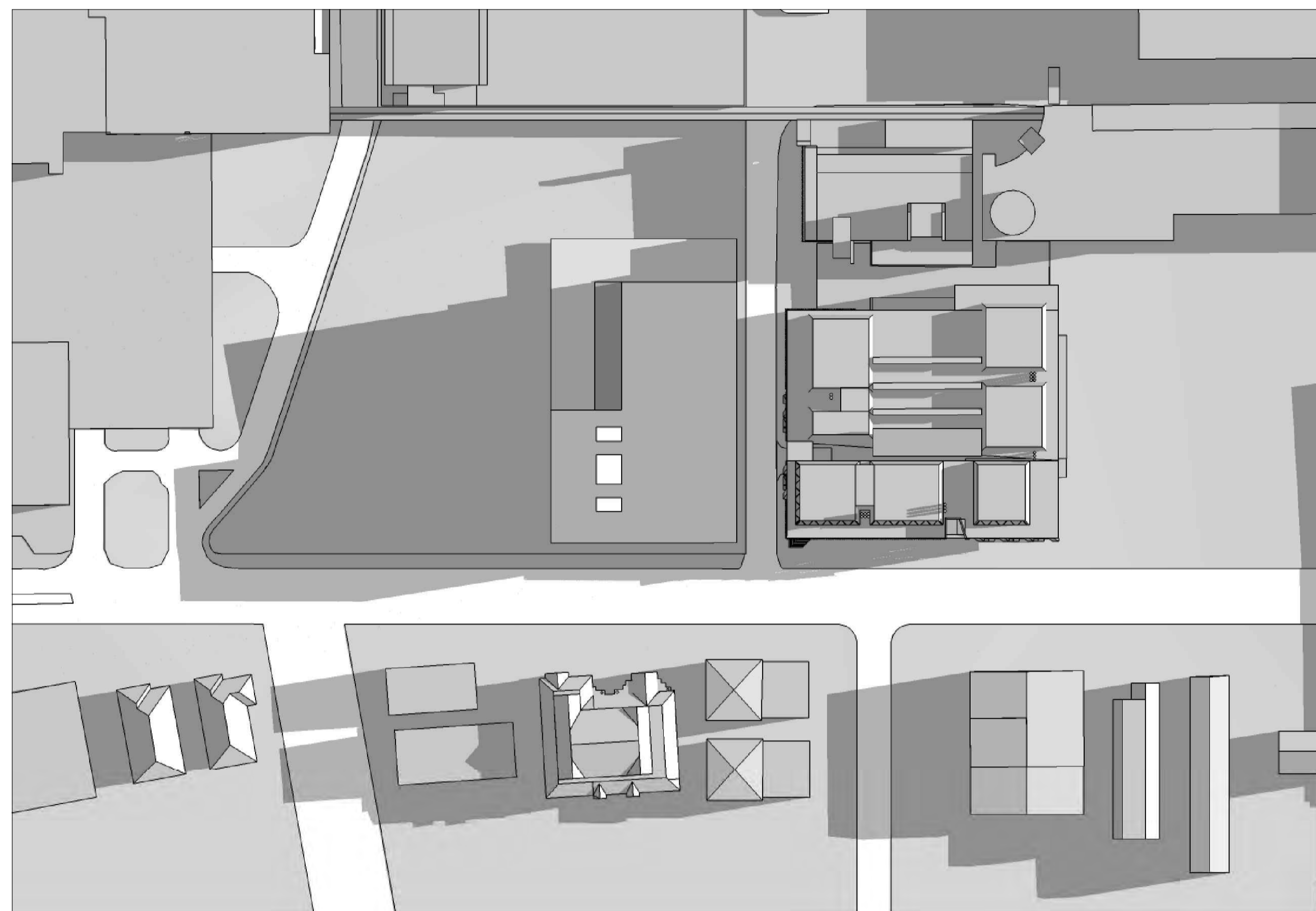

JUNE 21 - 9:00 AM



* SHADOW IMPACT AT 195 HAWKESBURY ROAD
GROUND FLOOR CARPARK ONLY

JUNE 21 - 12:00 PM



JUNE 21 - 3:00 PM



PROJECT

WESTMEAD
MILLENNIUM INSTITUTE &
RESEARCH HUB
BVN PROJECT NUMBER

s0911005

DRAWING KEY

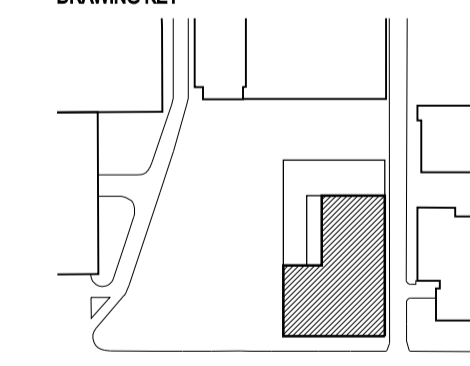

TRUE NORTH PROJECT NORTH

GRAPHIC SCALE

SCALE

NTS DO NOT SCALE
STATUS

PRELIMINARY
DRAWING

SHADOW DIAGRAMS 02

DRAWING NUMBER ISSUE
DA-Z-02 5