

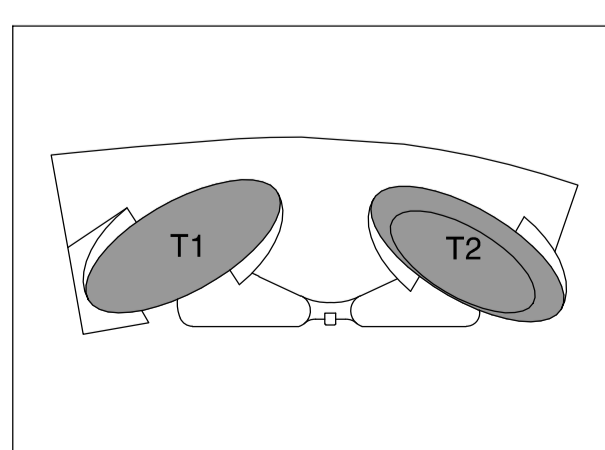

**APPENDIX A
BATES SMART
DRAWINGS**

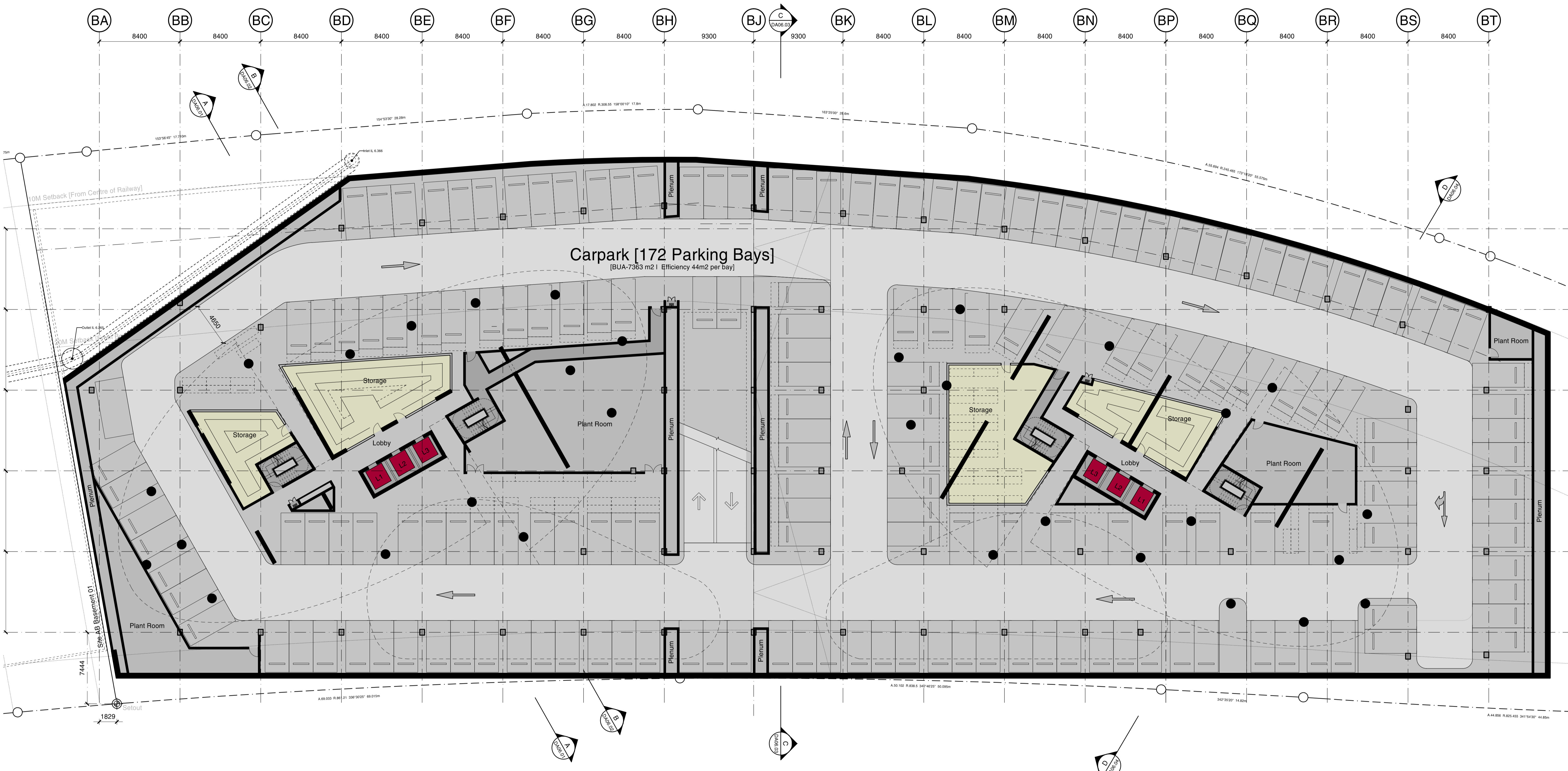

Revision	Date	Description	Initial	Checked
A	06/04/11	DA Submission	JJ	MD

Site 3
Sydney Olympic Park
 Plan
 Basement 004

Check all dimensions and site conditions prior to commencement of any work, the purchase or ordering of any materials, fittings, plant, services or equipment and the preparation of shop drawings and/or the fabrication of any components.
 Do not scale drawings - refer to figured dimensions only. Any discrepancies shall immediately be referred to the architect for clarification.
 All drawings may not be reproduced or distributed without prior permission from the architect.

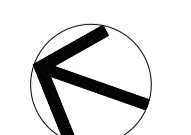

Scale: 1:200@A1, 1:400@A3
 Drawn: _____ Checked: _____
 Project No.: S11202
 Status: DA
 Plot Date: 12/4/2011 5:12:39 PM
 Plot File: S:\11200-11299\11202_billbergia_homebush\00_ea\cad\plot...
 Drawing No.: DA02.100[A] [Revision]

Sydney 1/243 Liverpool Street
 East Sydney NSW 2010 Australia
 T 02 8354 5100 F 02 8354 5199
 email syd@batesmart.com.au
 http://www.batesmart.com.au

Melbourne 1 Nicholson Street
 Melbourne VIC 3000 Australia
 T 03 8664 6200 F 03 8664 6300
 email melb@batesmart.com.au
 http://www.batesmart.com.au

Bates Smart Pty Ltd ABN 70 004 999 400



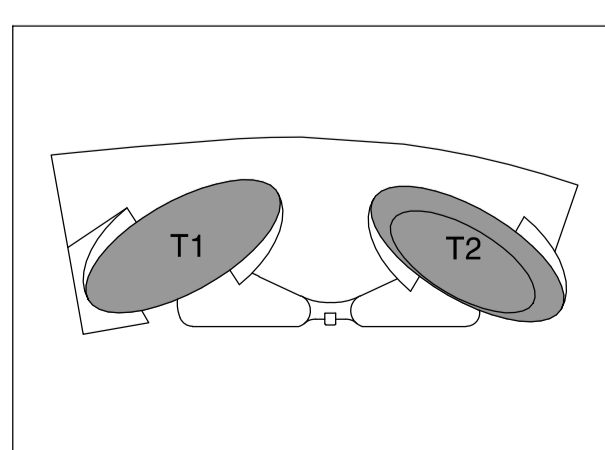
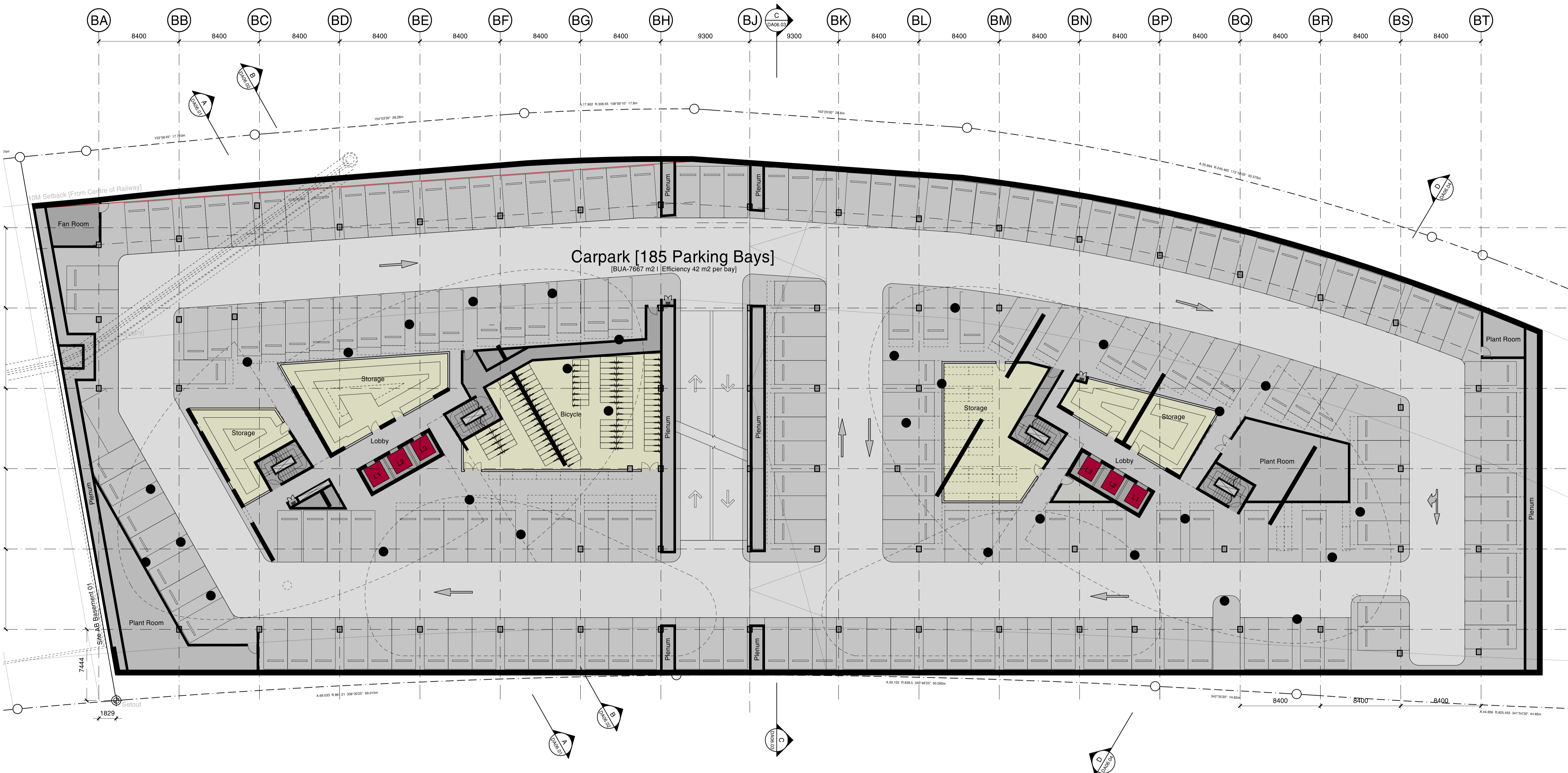

Revision	Date	Description	Initial	Checked
A	06/04/11	DA Submission	JJ	MD

**Site 3
Sydney Olympic Park**
Plan
Basement 003

Check all dimensions and site conditions prior to commencement of any work, the purchase or ordering of any materials, fittings, plant, services or equipment and the preparation of shop drawings and/or the fabrication of any components.
Do not scale drawings - refer to figured dimensions only. Any discrepancies shall immediately be referred to the architect for clarification.
All drawings may not be reproduced or distributed without prior permission from the architect.

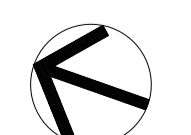

Scale: 1:200@A1, 1:400@A3
 Drawn: _____ Checked: _____
 Project No.: S11202
 Status: DA
 Plot Date: 12/4/2011 5:12:46 PM
 Plot File: S:\11200-11299\11202_billbergia_homebush\00_ea\cad\plot...
 Drawing No.: DA02.101[A] (Revision)

Sydney 1/243 Liverpool Street
 East Sydney NSW 2010 Australia
 T 02 8354 5100 F 02 8354 5199
 email syd@batesmart.com.au
 http://www.batesmart.com.au

Melbourne 1 Nicholson Street
 Melbourne VIC 3000 Australia
 T 03 8664 6200 F 03 8664 6300
 email melb@batesmart.com.au
 http://www.batesmart.com.au

Bates Smart Pty Ltd ABN 70 004 999 400



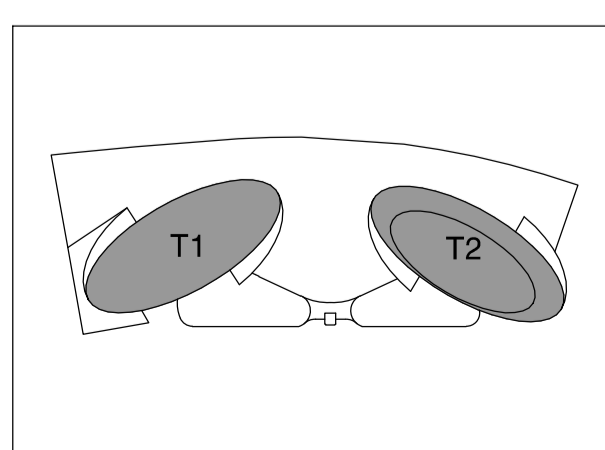
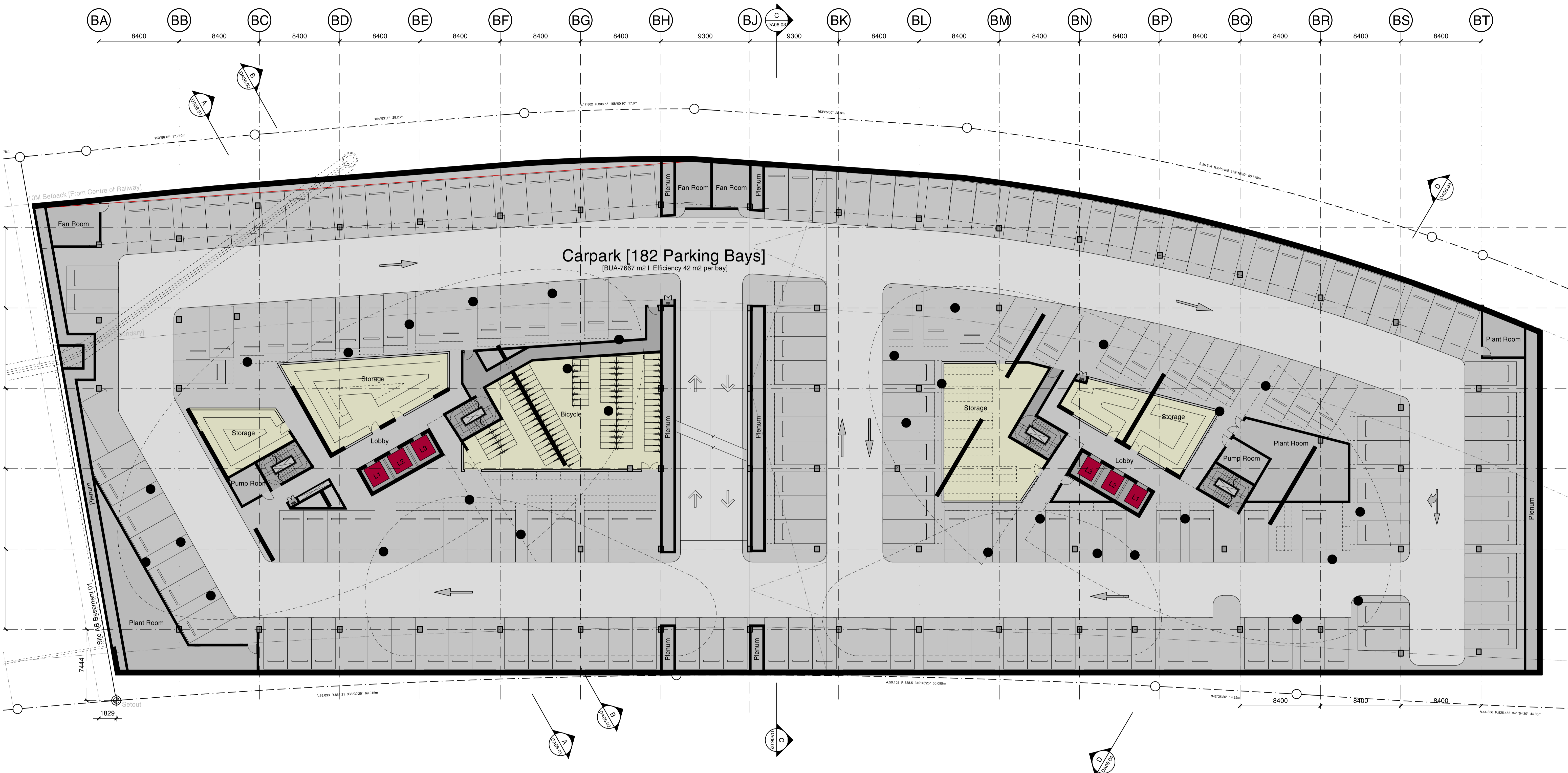

Revision	Date	Description	Initial	Checked
A	06/04/11	DA Submission	JJ	MD

**Site 3
Sydney Olympic Park**
Plan
Basement 002

Check all dimensions and site conditions prior to commencement of any work, the purchase or ordering of any materials, fittings, plant, services or equipment and the preparation of shop drawings and/or the fabrication of any components.
Do not scale drawings - refer to figured dimensions only. Any discrepancies shall immediately be referred to the architect for clarification.
All drawings may not be reproduced or distributed without prior permission from the architect.

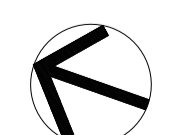

Scale	1:200 @ A1, 1:400 @ A3
Drawn	Checked
Project No.	S11202
Status	DA
Plot Date	12/4/2011 5:12:53 PM
Plot File	S:\11200-11299\11202_billbergia_homebush\00_ea\cad\plot...
Drawing No.	DA02.102[A]

Sydney 1/243 Liverpool Street
East Sydney NSW 2010 Australia
T 02 8354 5100 F 02 8354 5199
email syd@batesmart.com.au
http://www.batesmart.com.au

Melbourne 1 Nicholson Street
Melbourne VIC 3000 Australia
T 03 8664 6200 F 03 8664 6300
email melb@batesmart.com.au
http://www.batesmart.com.au

Bates Smart Pty Ltd ABN 70 004 999 400



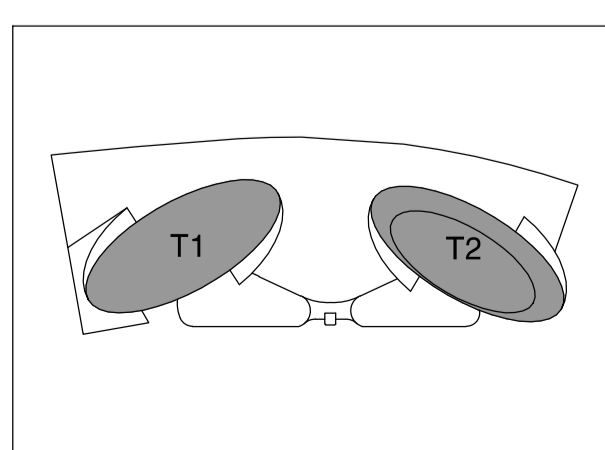
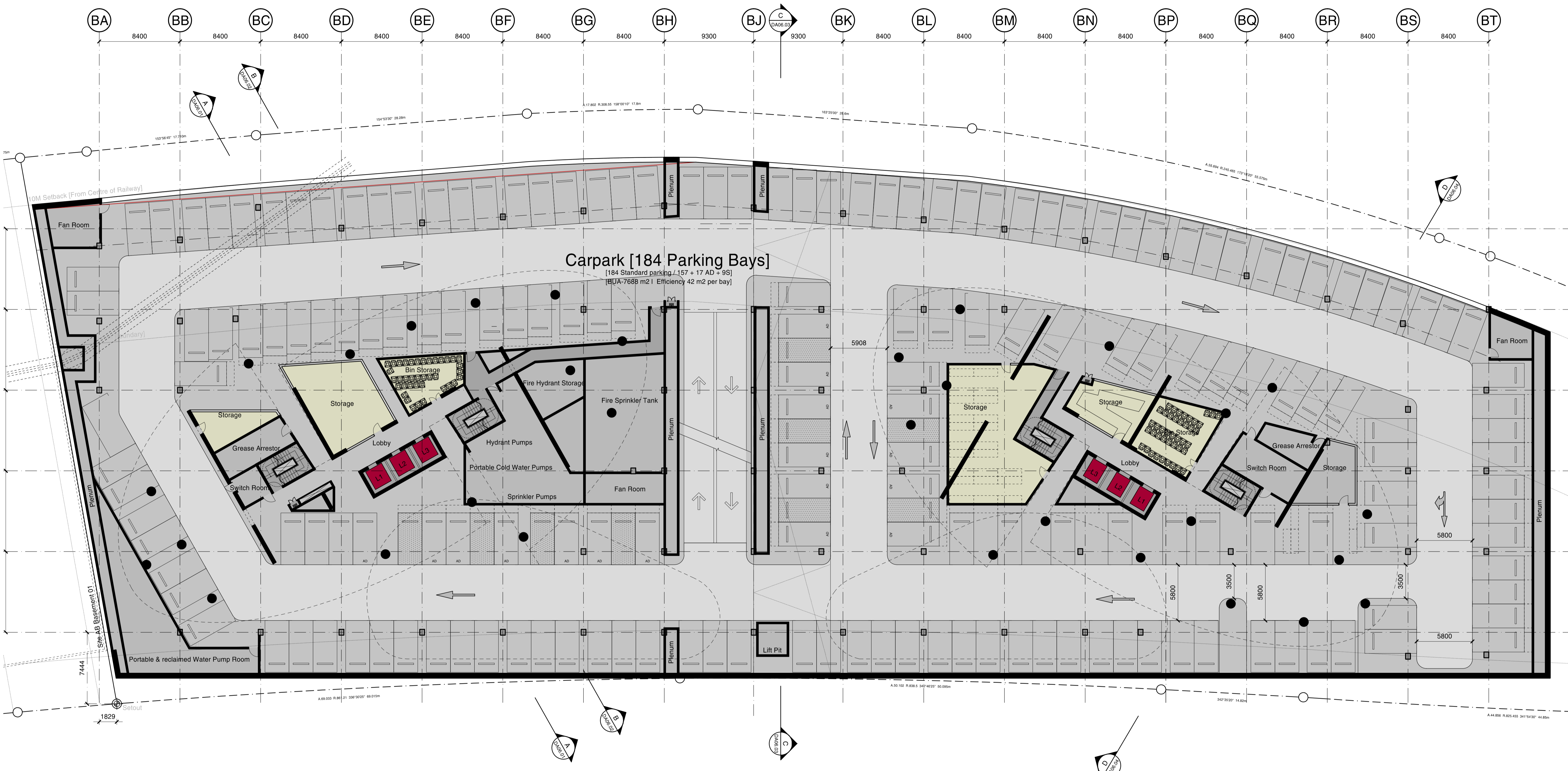

Revision Date	Description	Initial	Checked
A 06/04/11	DA Submission	JJ	MD

**Site 3
Sydney Olympic Park**
Plan
Basement 001

Check all dimensions and site conditions prior to commencement of any work, the purchase or ordering of any materials, fittings, plant, services or equipment and the preparation of shop drawings and/or the fabrication of any components.
Do not scale drawings - refer to figured dimensions only. Any discrepancies shall immediately be referred to the architect for clarification.
All drawings may not be reproduced or distributed without prior permission from the architect.

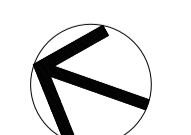

Scale: 1:200
 Drawn: _____ Checked: _____
 Project No.: S11202
 Status: DA
 Plot Date: 12/4/2011 5:13:01 PM
 Plot File: S:\11200-11299\11202_billbergia_homebush\00_ea\cad\plot...
 Drawing No.: DA02.103[A] [Revision]

Sydney 1/243 Liverpool Street
 East Sydney NSW 2010 Australia
 T 02 8354 5100 F 02 8354 5199
 email syd@batesmart.com.au
 http://www.batesmart.com.au

Melbourne 1 Nicholson Street
 Melbourne VIC 3000 Australia
 T 03 8664 6200 F 03 8664 6300
 email melb@batesmart.com.au
 http://www.batesmart.com.au

Bates Smart Pty Ltd ABN 70 004 999 400



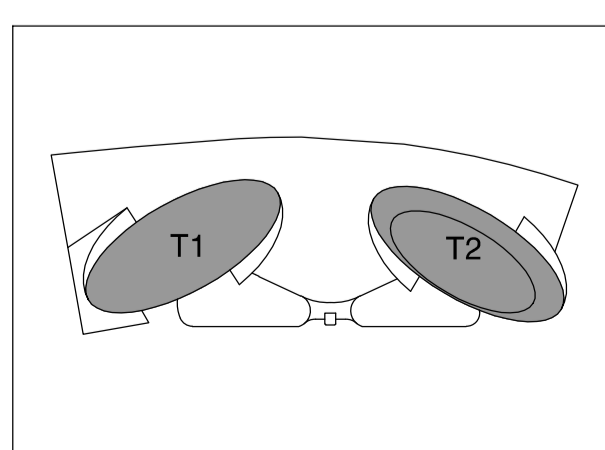
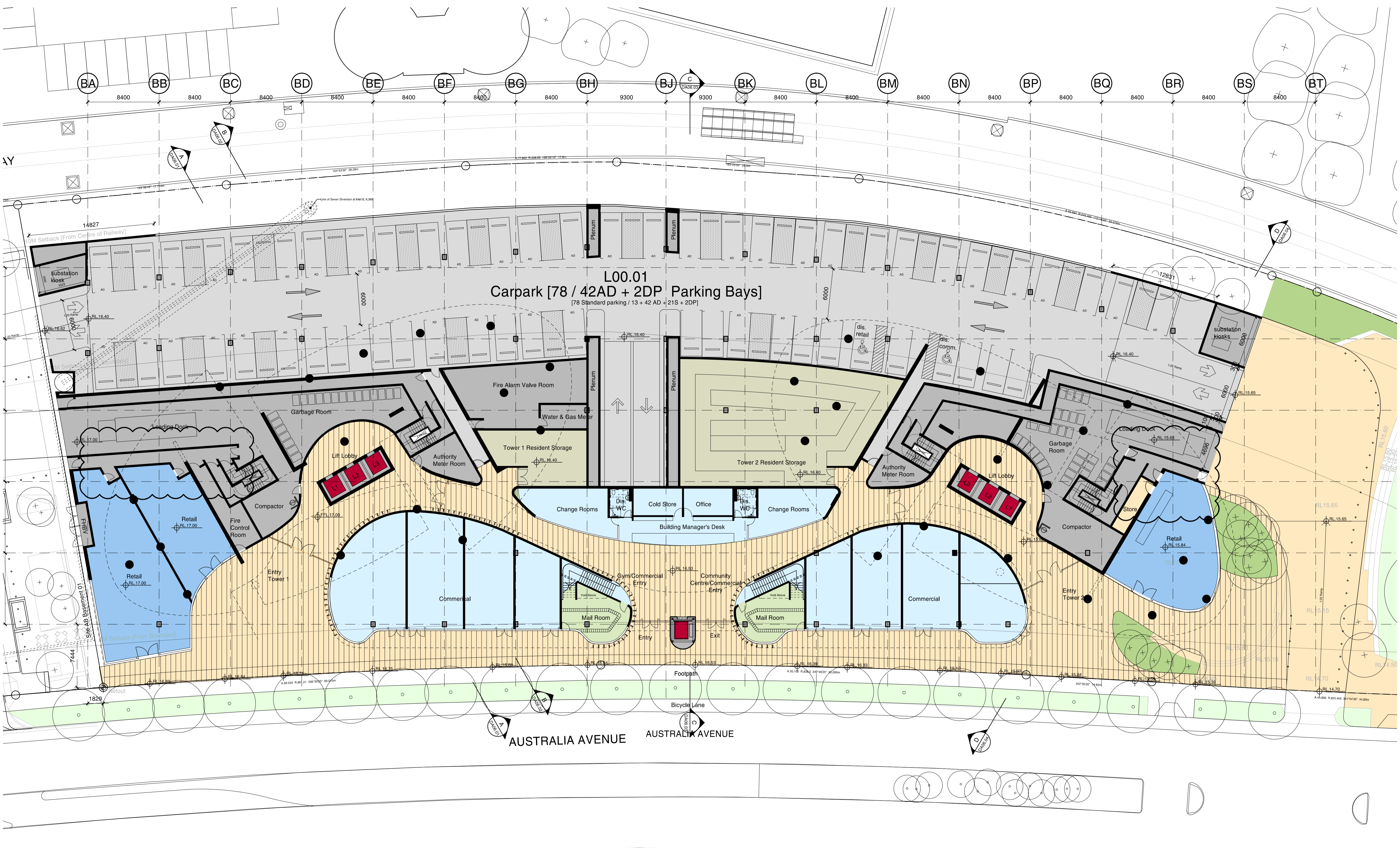

Revision Date	Description	Initial	Checked
B 06/06/11	Revised Access to Retail Units	JC	MD
A 06/04/11	DA Submission	JJ	MD

**Site 3
Sydney Olympic Park
Ground Floor Plan**

Check all dimensions and site conditions prior to commencement of any work, the purchase or ordering of any materials, fittings, plant, services or equipment and the preparation of shop drawings and/or the fabrication of any components.
Do not scale drawings - refer to figured dimensions only. Any discrepancies shall immediately be referred to the architect for clarification.
All drawings may not be reproduced or distributed without prior permission from the architect.

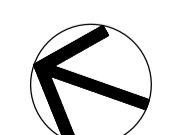

Scale	1:200 @ A1, 1:400 @ A3
Drawn	Checked
Project No.	S11202
Status	DA
Plot Date	6/6/2011 5:28:10 PM
Plot File	S:\11200-11299\11202_billbergia_homebush\00_eor\cad\plots\...
Drawing No.	DA02.200[B]

Sydney 1/243 Liverpool Street
East Sydney NSW 2010 Australia
T 02 8354 5100 F 02 8354 5199
email syd@batesmart.com.au
http://www.batesmart.com.au

Melbourne 1 Nicholson Street
Melbourne VIC 3000 Australia
T 03 8664 6200 F 03 8664 6300
email melb@batesmart.com.au
http://www.batesmart.com.au

Bates Smart Pty Ltd ABN 70 004 999 400

