

NOTES

- BUILDER/CONTRACTOR SHALL VERIFY JOB DIMENSIONS BEFORE ANY JOB COMMENCES.
- FIGURED DIMENSIONS TAKE PRECEDENCE OVER DRAWINGS AND JOB.
- ALL SHOP DRAWINGS SHALL BE SUBMITTED TO THE ARCHITECT/CONSULTANT AND MANUFACTURE SHALL NOT BE COMMENCED UNTIL INSPECTED AND APPROVED BY THE ARCHITECT/CONSULTANT.
- DO NOT SCALE ASK.

© COPYRIGHT OF THIS DRAWING IS VESTED IN DURBACH BLOCK JAGGERS ARCHITECTS & BVA

THIS DRAWING IS AN UNCONTROLLED COPY, UNLESS NOTED OTHERWISE.

REV	DESCRIPTION	DATE
A	Revision A	01/06/11
B	Revision B	03/06/11
C	Revision C	27/07/11
D	Revision D	01/08/11
E	Revision E	01/11/11
F	Revision F	4/11/11
G	Draft ECR Application	05/12/11
H	Project Application	19/12/11

CONSULTANT
 DURBACH BLOCK JAGGERS
 Level 2, 51 Roslyn St
 North Sydney NSW 1585
 Tel: (02) 9597 3500
 Fax: (02) 9597 3510

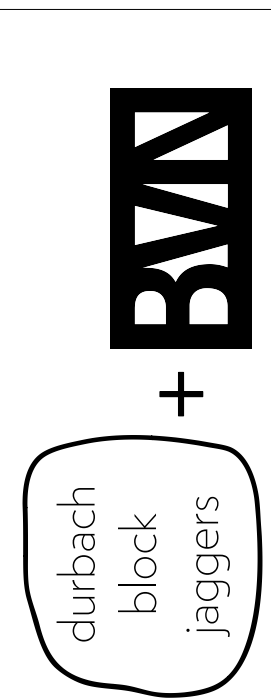

PROJECT
THOMAS ST BUILDING
 PROJECT APPLICATION
 MP09_0213

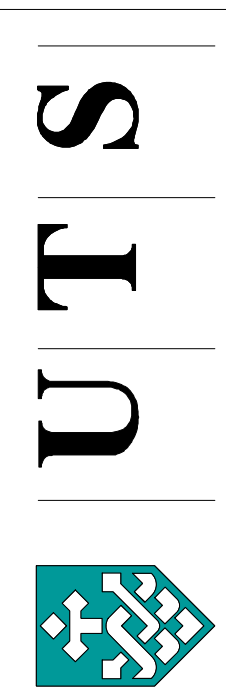

University of Technology, Sydney
 FACILITIES MANAGEMENT UNIT
 Building 10, Level 6, 235 Jones St
 B r o a d w a y N S W 2 0 0 7
 Ph: 9514-2830 Fax: 9514-4690

Drawing Title
FIRST FLOOR
CL 01 (RL 18.38)

FIMU Project Number	
Drawn By CB	Approved By Date App.
Drawing Scale @ A1 1:200	Drawing Status Project Application
UTS Drg File Name	UTS Drg File No Rev No H
Consultant File Number 1650•106	

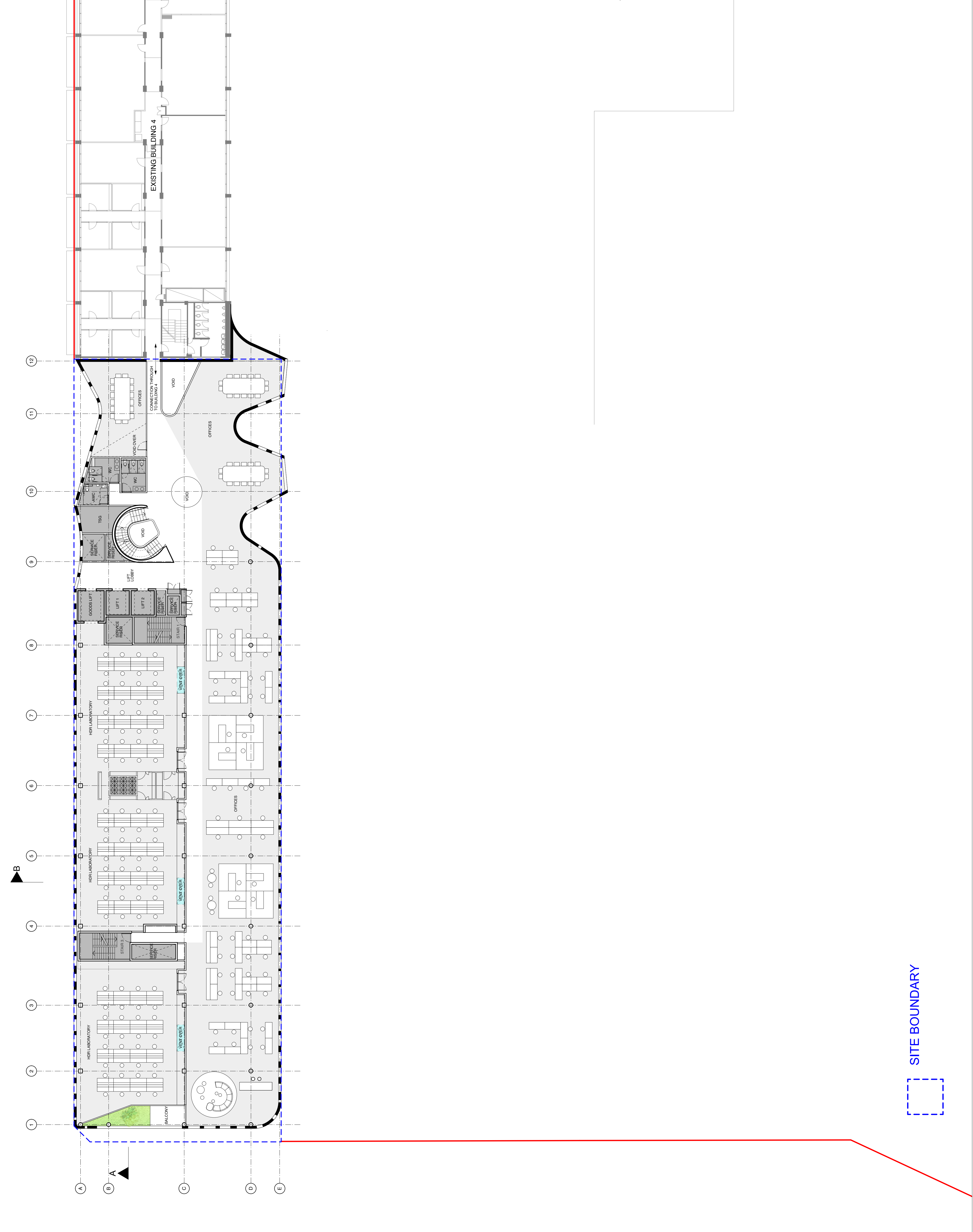

SITE BOUNDARY

Appendix C Photographs



Jones Street north of Building 2 looking east



Jones Street north of Broadway looking north



Jones Street looking south towards Broadway



Car Park/Service Vehicle Access Ramp south of Thomas Street looking north



Thomas Street east of Jones Street looking east



Wattle Street looking south from Broadway



Broadway looking east



Broadway and Jones Street looking east