

- 1 ENTRY PRECINCT
- 2 COMMUNITY PARK NODE
- 3 POCKET PARK
- 4 WETLAND RESERVE
- 5 CREEK / DRAINAGE CORRIDOR
- 6 FRASER DRIVE ENTRY

NOTE: STREET TREE LOCATIONS ARE FOR INDICATIVE PURPOSES ONLY.

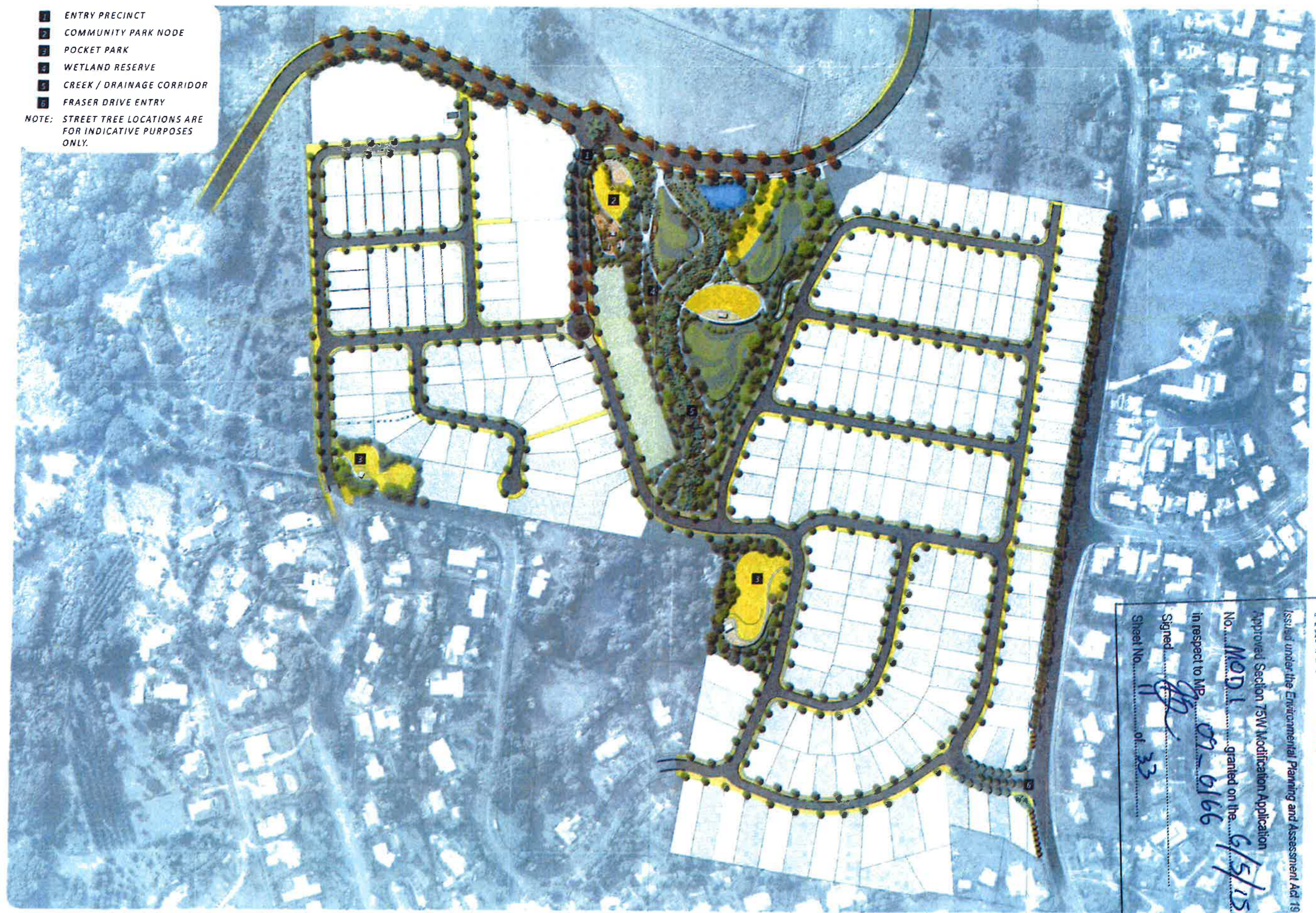

NSW GOVERNMENT
PLANNING

Issued under the Environmental Planning and Assessment Act 1979

Approved Section 73W Modification Application
No. **MOD 1** granted on the **6/5/15**
in respect to MP **09-6166**

Signed: *[Signature]*
Sheet No. **11** of **33**

LANDSCAPE MASTERPLAN

100906 | 11 FEB 15 | DA09 | NORTH | SCALE 1:3000 @ A3
PROJECT ALTITUDE ASPIRE | TERRANORA | LANDSCAPE MASTERPLAN | CLIENT NEWLAND DEVELOPERS PTY LTD

FIGURE 1 - LANDSCAPE MASTERPLAN
FORM LANDSCAPE ARCHITECTS | 3

- BIO-RETENTION
- COMMUNITY PARK NODE
- POCKET PARKS
- DRAINAGE CHANNEL
- REVEGETATION ZONE
- ENTRY PRECINCTS
- WETLAND



NSW GOVERNMENT
 Planning

Issued under the Environmental Planning and Assessment Act 1979

Approved Section 75W Modification Application
 No. MDL 1 granted on the 6/5/15

In respect to MP 09-0166

Signed *[Signature]*

Sheet No. 10 of 33

LANDSCAPE STRUCTURE

100906 | 11 FEB 15 | DA09 | NORTH ☺ | SCALE 1:3000 @ A3
 PROJECT ALTITUDE ASPIRE | TERRANORA | LANDSCAPE MASTERPLAN | CLIENT NEWLAND DEVELOPERS PTY LTD

FIGURE 2 - LANDSCAPE STRUCTURE
 FORM LANDSCAPE ARCHITECTS | 4

- PARK PATHWAYS
- CONCRETE PATHWAYS
- BLUESTONE GABION RETAINING WALLS
- TRANSITIONAL ROAD TREATMENT
- MAJOR ROADS
- PRIMARY BOULEVARD
- SECONDARY SPINE ROAD
- TERTIARY STREETS



NSW GOVERNMENT
Planning

Received under the Environmental Planning and Assessment Act 1979

Approved Section 75N Modification Application
No. MOD 1 granted on the 6/5/15

In respect to MR. 07-0166

Signed: *[Signature]*

Sheet No. 13 of 33

CIRCULATION NETWORK

100906 | 11 FEB 15 | DA09 | NORTH | SCALE 1:3000 @ A3
PROJECT ALTITUDE ASPIRE | TERRANORA | LANDSCAPE MASTERPLAN | CLIENT NEWLAND DEVELOPERS PTY LTD

FIGURE 3 - CIRCULATION NETWORK
FORM LANDSCAPE ARCHITECTS | 5

COMPLYING AREA
 TOTAL PARK AREA

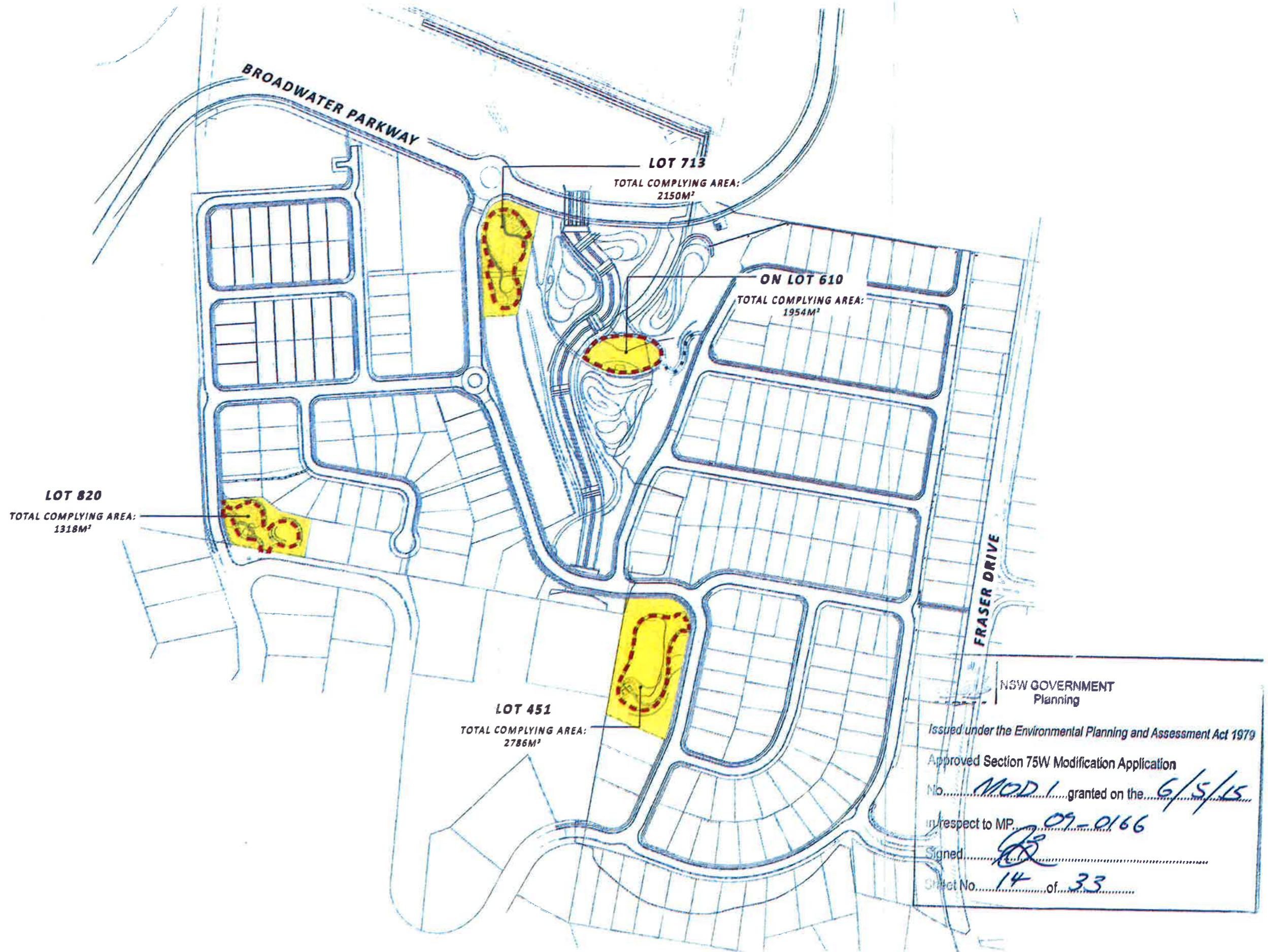

NSW GOVERNMENT
Planning

Issued under the Environmental Planning and Assessment Act 1979

Approved Section 75W Modification Application

No. MOD 1 granted on the 6/5/15

in respect to MP. 09-0166

Signed [Signature]

Sheet No. 14 of 33

COMPLIANCE AREAS

100906 | 11 FEB 15 | DA09 | NORTH ☺ | SCALE 1:3000 @ A3
 PROJECT ALTITUDE ASPIRE | TERRANORA | LANDSCAPE MASTERPLAN | CLIENT NEWLAND DEVELOPERS PTY LTD

- - - ALUMINIUM & TIMBER FENCE
- TIMBER SCREEN FEATURE FENCE
- - - TIMBER PALING FENCE

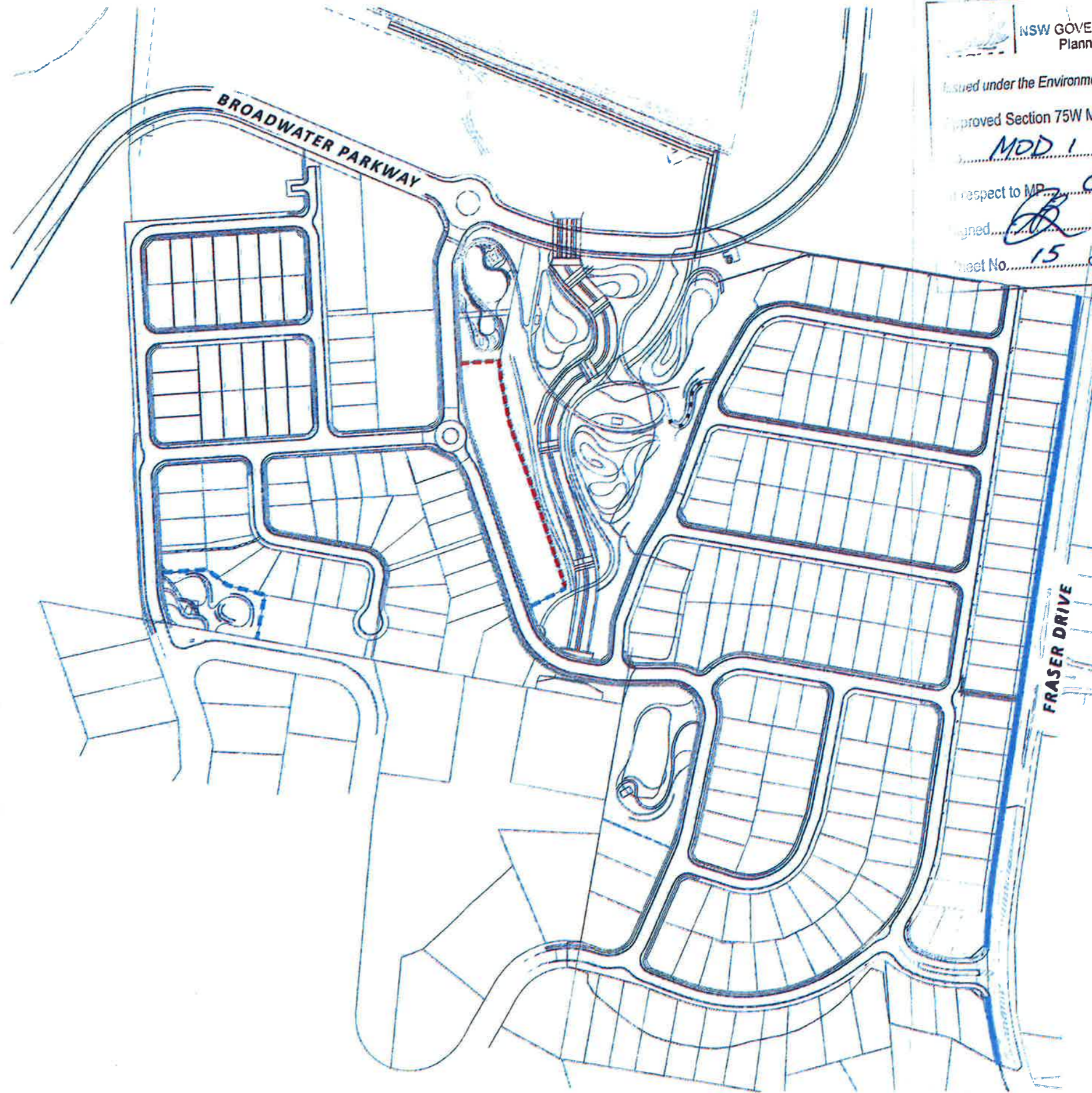

NSW GOVERNMENT
 Planning

Issued under the Environmental Planning and Assessment Act 1979

Approved Section 75W Modification Application
 MDD 1 granted on the 6/5/15

in respect to MP 09-0166

Signed *[Signature]*

Sheet No. 15 of 33

FENCE TYPES

100906 | 11 FEB 15 | DA09 | NORTH ☉ | SCALE 1:3000 @ A3
 PROJECT ALTITUDE ASPIRE | TERRANORA | LANDSCAPE MASTERPLAN | CLIENT NEWLAND DEVELOPERS PTY LTD



- 1 SHELTER AND DECK
- 2 BRIDGE ACROSS CREEK
- 3 SEDGES AND MARGINAL PLANTING ZONE
- 4 DRAINAGE GULLY
- 5 PARK PEDESTRIAN PATH
- 6 PARK SHELTER
- 7 GABION RETAINING WALLS
- 8 WETLAND
- 9 BIO RETENTION BASIN

NSW GOVERNMENT
 Planning
 Approved under the Environmental Planning and Assessment Act 1979
 Approved Section 75W Modification Application
 No. MOD 1 granted on the 6/5/15
 in respect to MP 09-0166
 Signed: [Signature]
 Sheet No. 20 of 33
 FORM LANDSCAPE ARCHITECTS | 12

DRAINAGE CORRIDOR AND WETLANDS
 100906 | 11 FEB 15 | DA09 | NORTH | SCALE 1:1000 @ A3
 PROJECT ALTITUDE ASPIRE | TERRANORA | LANDSCAPE MASTERPLAN | CLIENT NEWLAND DEVELOPERS PTY LTD