

 NSW GOVERNMENT
 Planning
 Issued under the Environmental Planning and Assessment Act 1979
 Approved Application No. m209-0166
 granted on the 30-5-2014
 Signed [Signature]
 Sheet No. 62 of 136

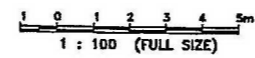

NEWLAND DEVELOPERS PTY LTD
TERRANORA PRECINCT 1
ROAD 12 CROSS SECTIONS
SHEET 2 OF 2

09-374
 07-01-2013
SK 3615
 REVISION B

Bradford Lees Pty Ltd
 ABN 29 064 159 191
 Ph 07 5528 6411
 Fax 07 5528 6422
 Web www.bradlees.com.au
 Email mail@bradlees.com.au
 Postal PO Box 2293, Southport QLD 4215
 Gold Coast Office Level 1, 34 Thomas Drive, Chevron Island QLD 4217



INTERSECTION ROAD 12

V.C. 15m
 ΔG. 12.94%
 R. 115.9

L.P. 0
 R.L. 25.293

L.P. 10
 R.L. 24.993

LIMIT OF CONSTRUCTION

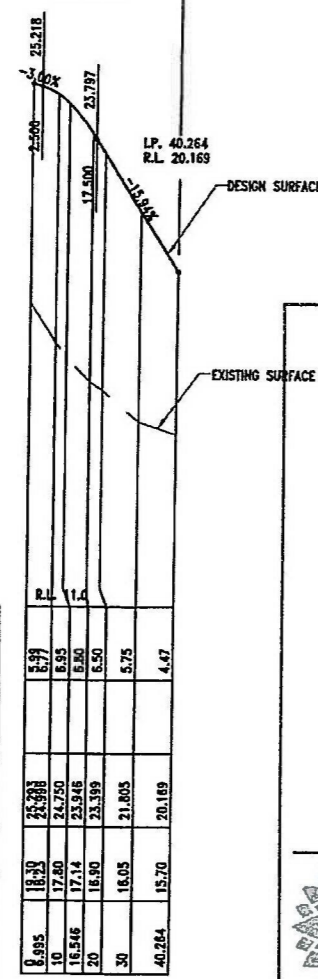

DATUM	R.L.
HEIGHT OF FILL	6.92
DEPTH OF CUT	
PAVEMENT LEVEL ON PEGGED CENTRELINE	25.218
EXISTING SURFACE LEVEL	18.30
PEGGED CHAINAGE	8.995

HORIZONTAL CURVE DATA

R15

NSW GOVERNMENT
 Planning

Issued under the Environmental Planning and Assessment Act 1979

Approved Application No. M98/0166

granted on the 30-5-2014

Signed [Signature]

Sheet No. 63 of 126

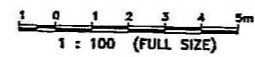
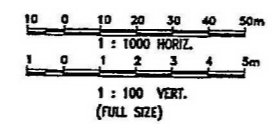
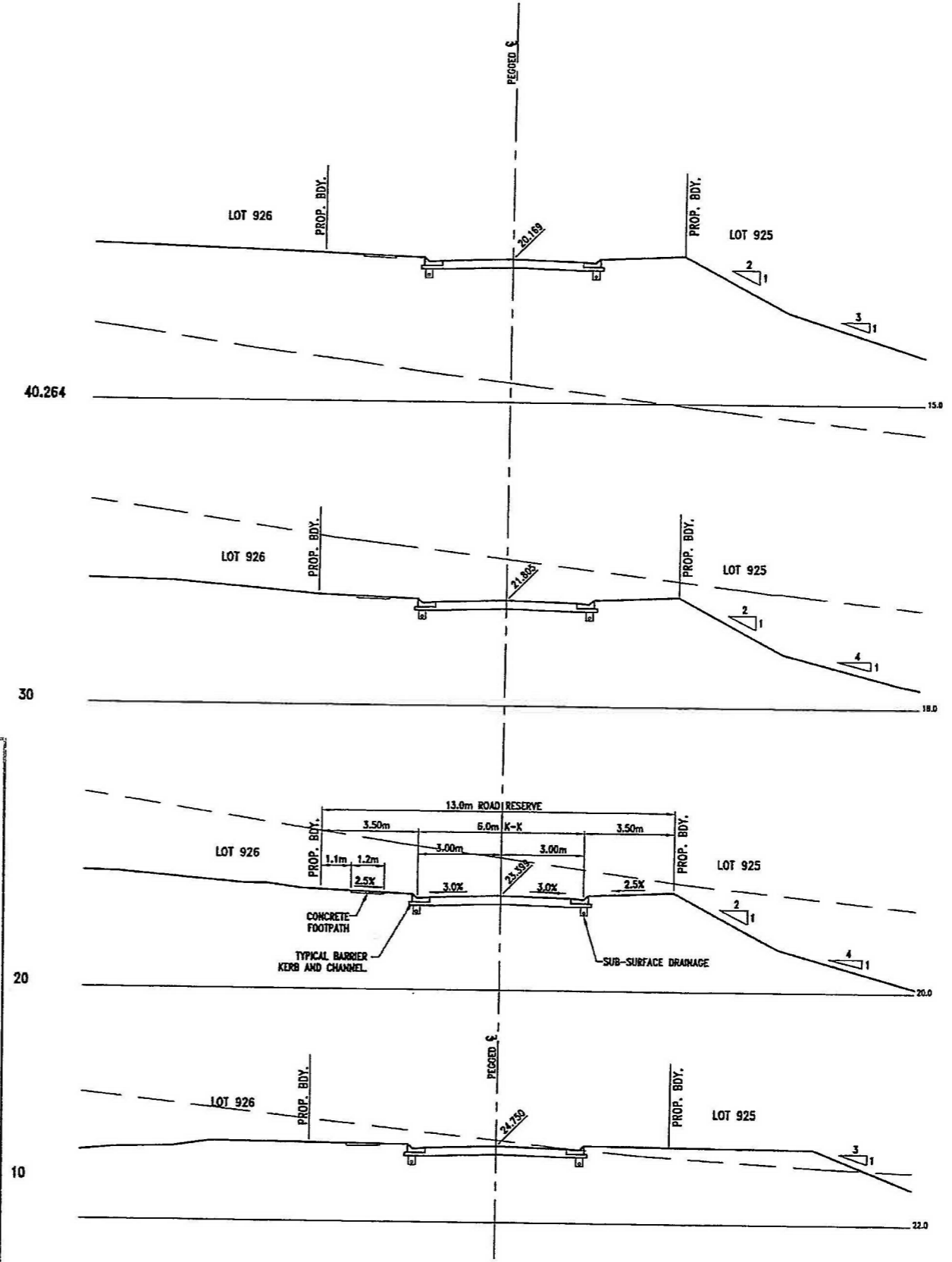

NEWLAND DEVELOPERS PTY LTD

09-374 07-01-2013

TERRANORA PRECINCT 1

ROAD 13 LONGITUDINAL AND CROSS SECTIONS

SK 3616

REVISION B

Bradford Lees Pty Ltd
 ABN 29 064 159 191

Ph 07 5528 6411
 Fax 07 5528 6422
 Web www.bradlees.com.au
 Email mail@bradlees.com.au
 Postal PO Box 2293, Southport QLD 4215
 Gold Coast Office Level 1, 34 Thomas Drive, Chevron Island QLD 4217

Bradlees
 Civil Consulting

QUALITY ASSURED COMPANY
 AS/NZS ISO 9001
 REG. NO. 203

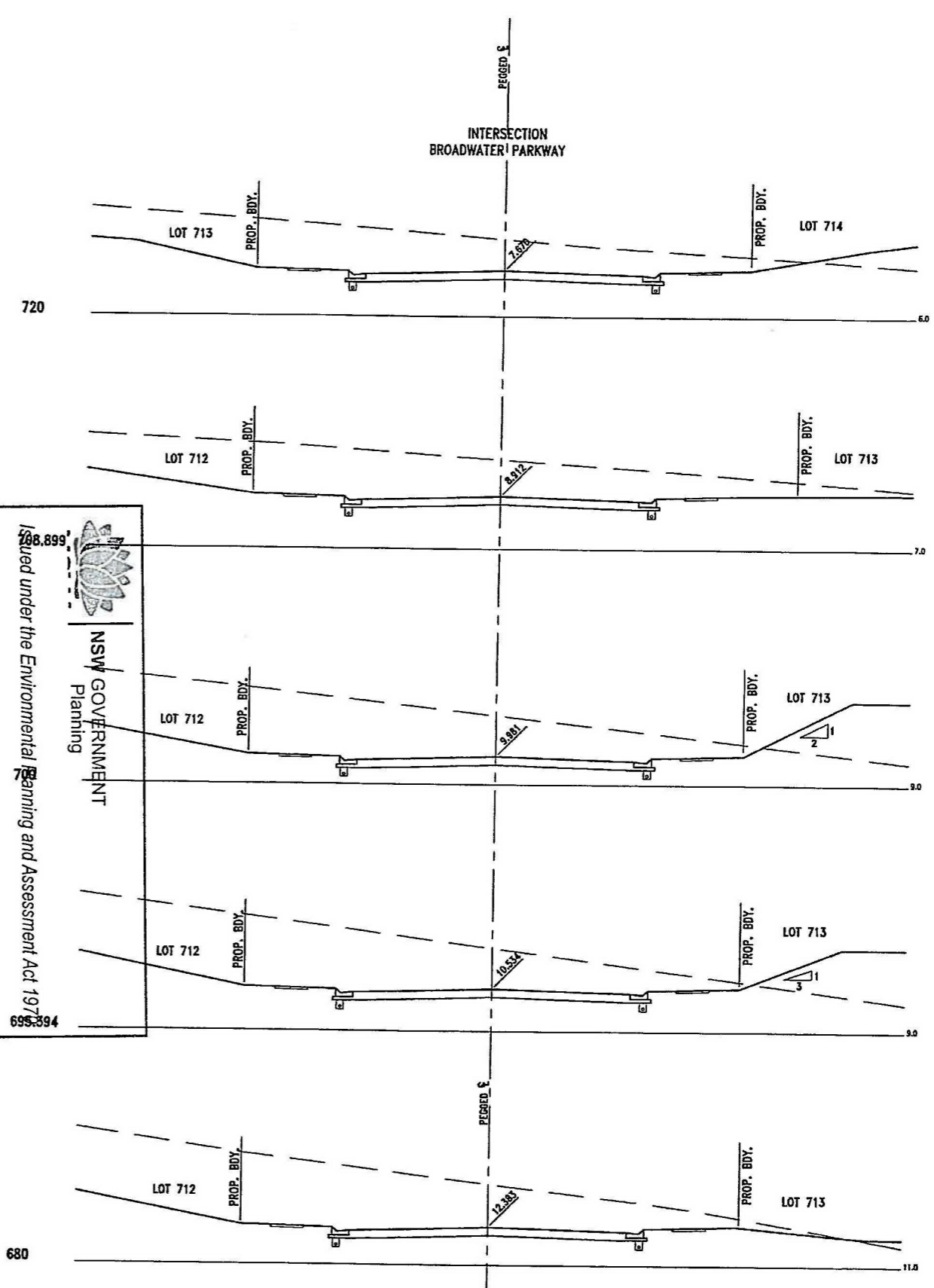
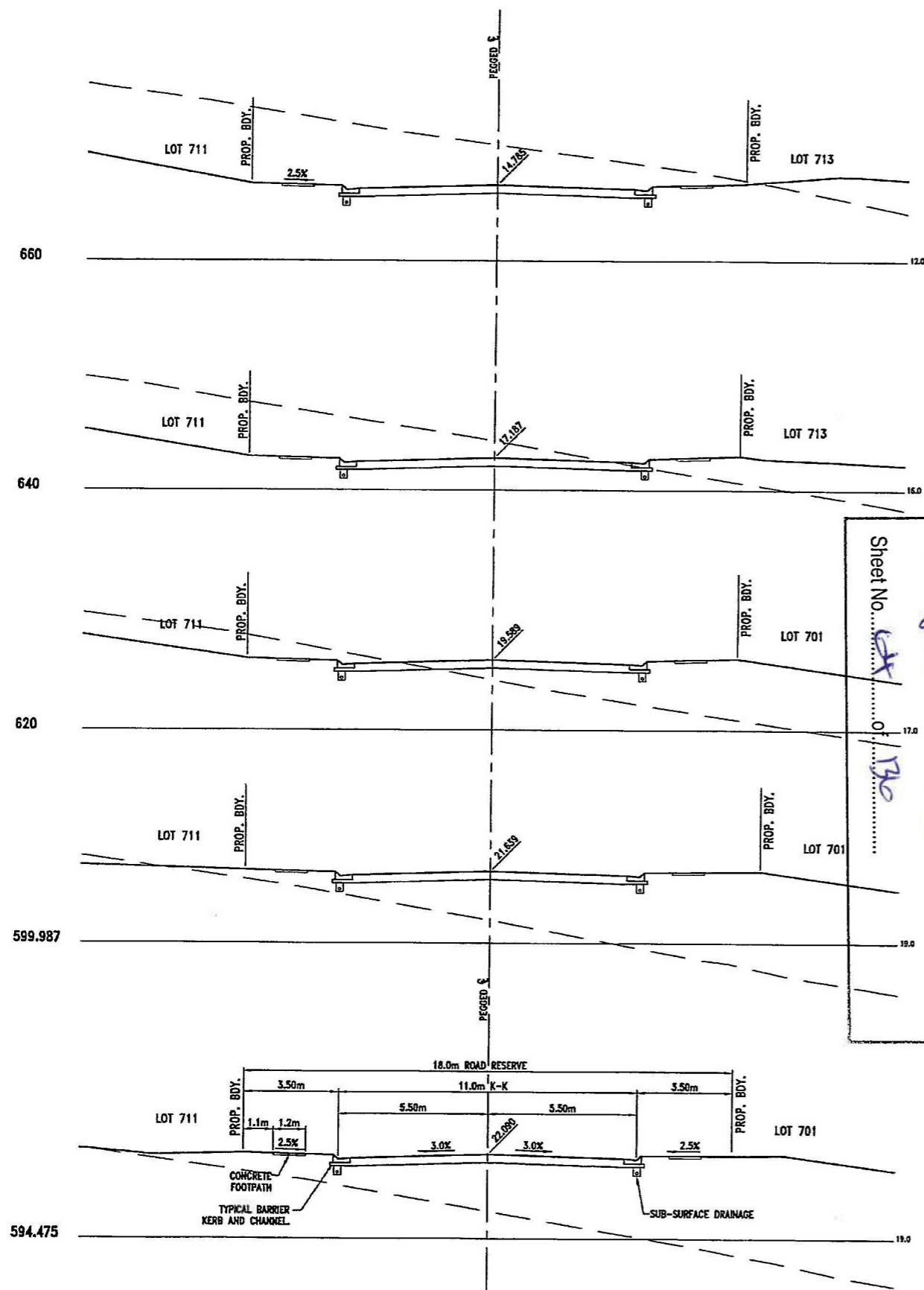

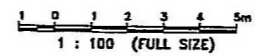
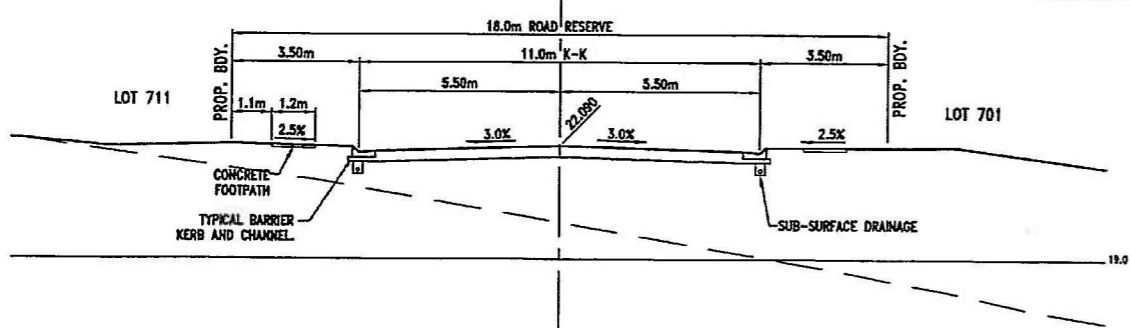

 Issued under the Environmental Planning and Assessment Act 1979
 Approved Application No. **MP09.0166**
 granted on the **30-5-2014**
 Signed: *[Signature]*
 Sheet No. **4** of **13**

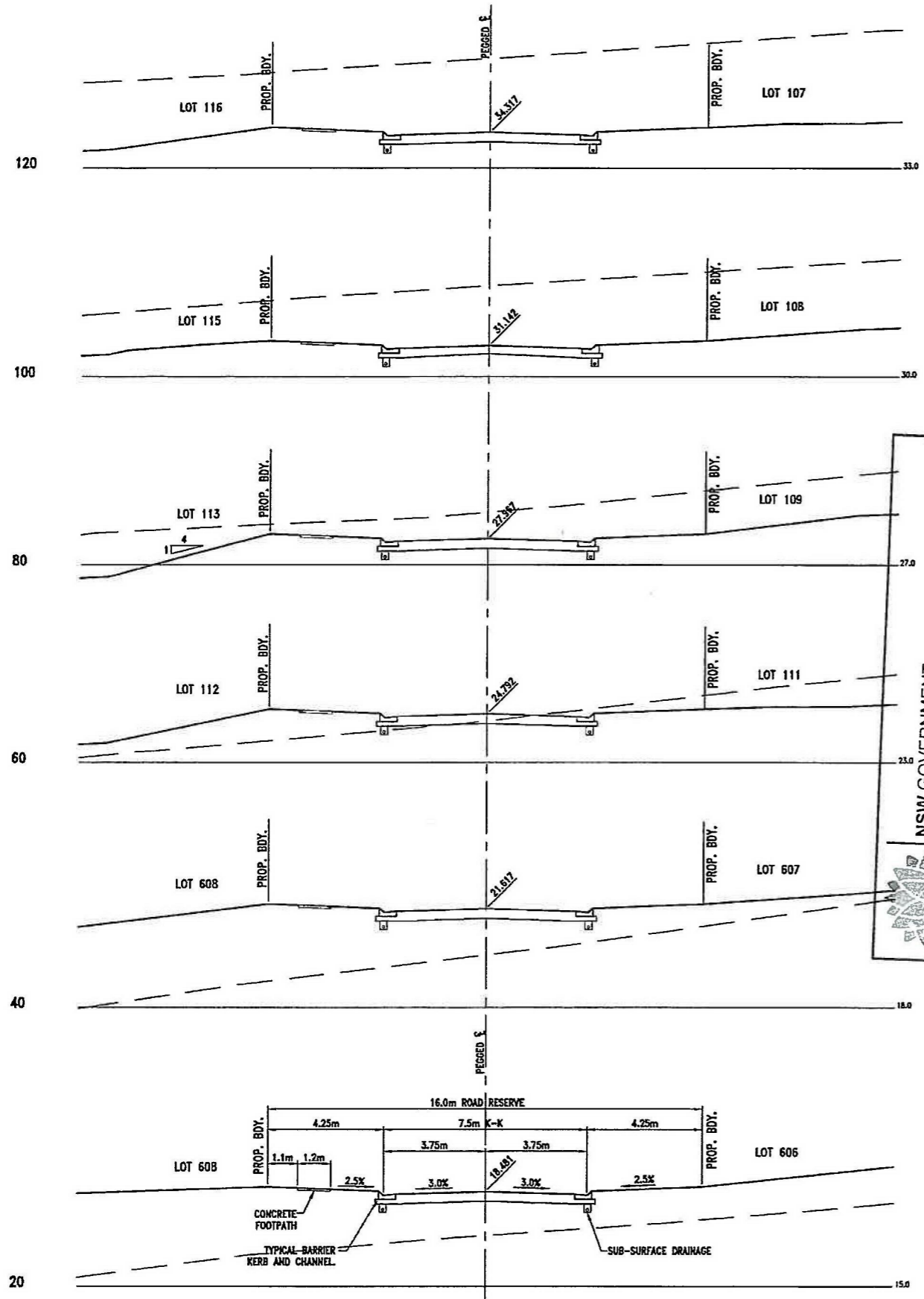

NEWLAND DEVELOPERS PTY LTD TERRANORA PRECINCT 1 ROAD 2 CROSS SECTIONS SHEET 5 OF 5	09-374 07-01-2013 SK 3963 REVISION A
---	---

Bradford Lees Pty Ltd ABN 29 064 159 191 Ph 07 5528 6411 Fax 07 5528 6422 Web www.bradlees.com.au Email mail@bradlees.com.au Postal PO Box 2293, Southport QLD 4215 Gold Coast Office Level 1, 34 Thurmas Drive, Chevron Island QLD 4217	 Bradlees Civil Consulting  <small>QUALITY ASSURED COMPANY AS/NZS ISO 9001:2008 REG. NO. 233</small>
---	---



NSW GOVERNMENT
Planning

Issued under the Environmental Planning and Assessment Act 1979

Approved Application No. MP09/0165

granted on the 30.5.2014

Signed [Signature]

Sheet No. 65 of 136

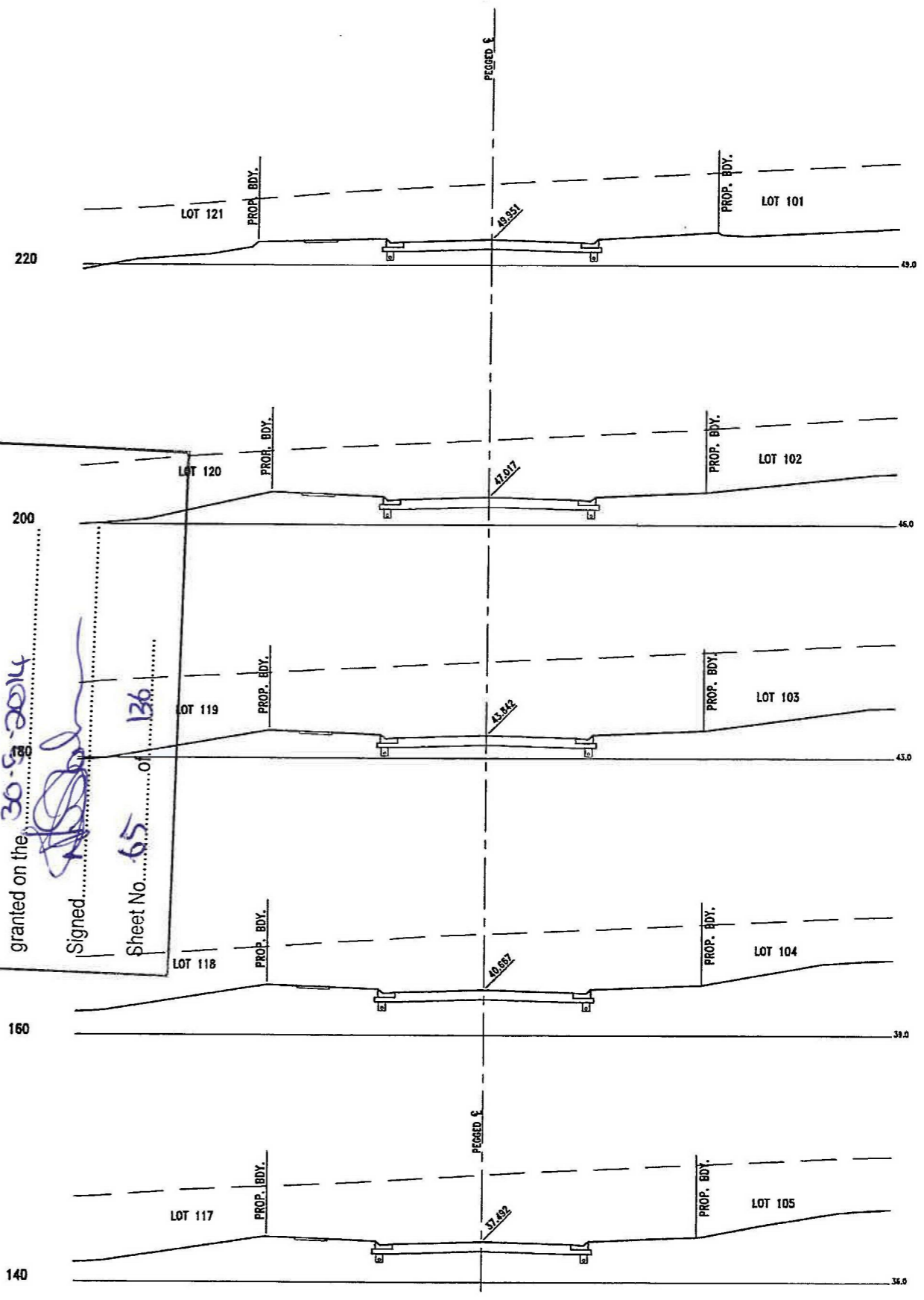
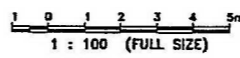

NEWLAND DEVELOPERS PTY LTD

TERRANORA PRECINCT 1

ROAD 6

CROSS SECTIONS

09-374
07-01-2013

SK 3965

REVISION A

Bradford Lees Pty Ltd
ABN 29 064 159 191

Ph 07 5528 6411
Fax 07 5528 6422
Web www.bradlees.com.au
Email mail@bradlees.com.au
Postal PO Box 2293, Southport QLD 4215
Gold Coast Office Level 1, 34 Thomas Drive, Chevron Island QLD 4217

Bradlees
Civil Consulting

QUALITY ASSURED COMPANY
AS/NZS ISO 9001:2008
REG. NO. 531



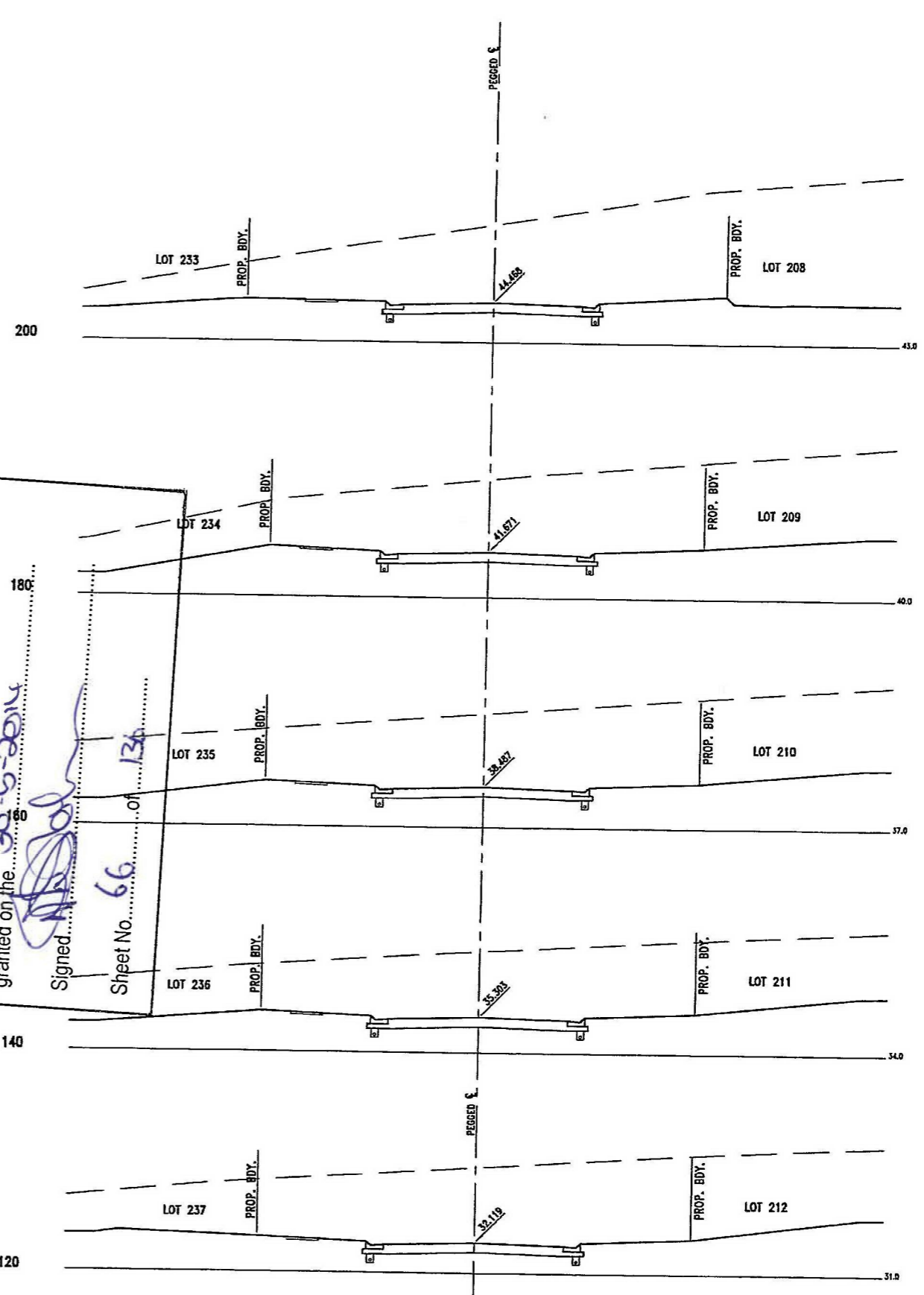
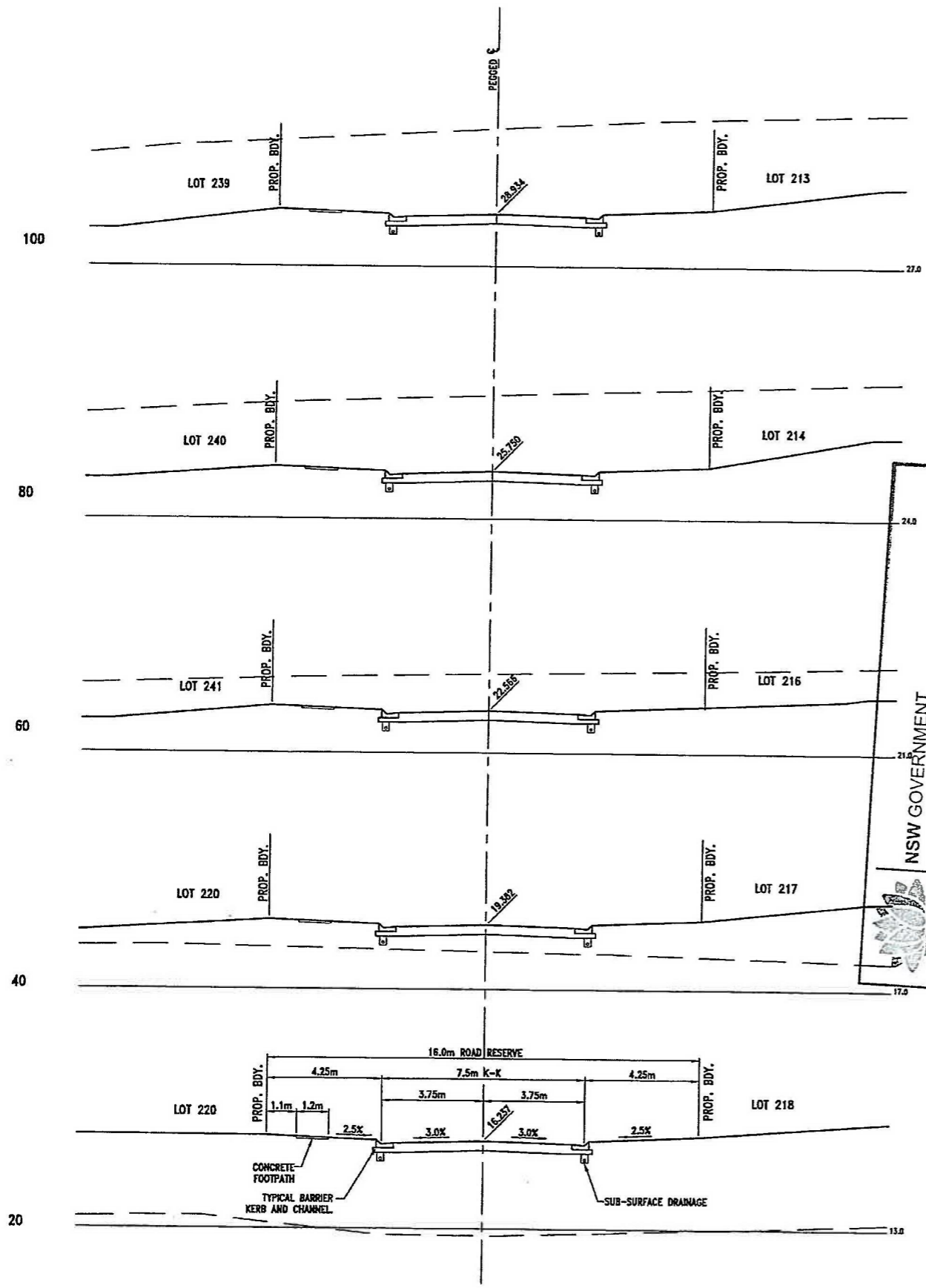

NSW GOVERNMENT
Planning

Issued under the Environmental Planning and Assessment Act 1979

Approved Application No. **M2009-0166**

granted on the **30-9-2014**

Signed: *[Signature]*

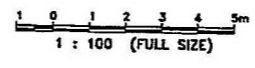
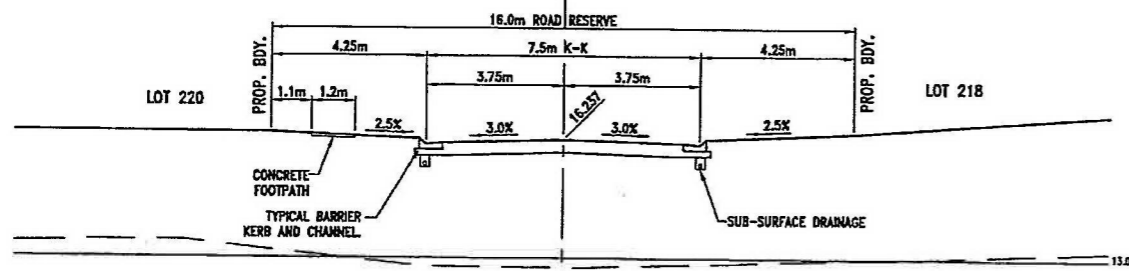

Sheet No. **66** of **134**

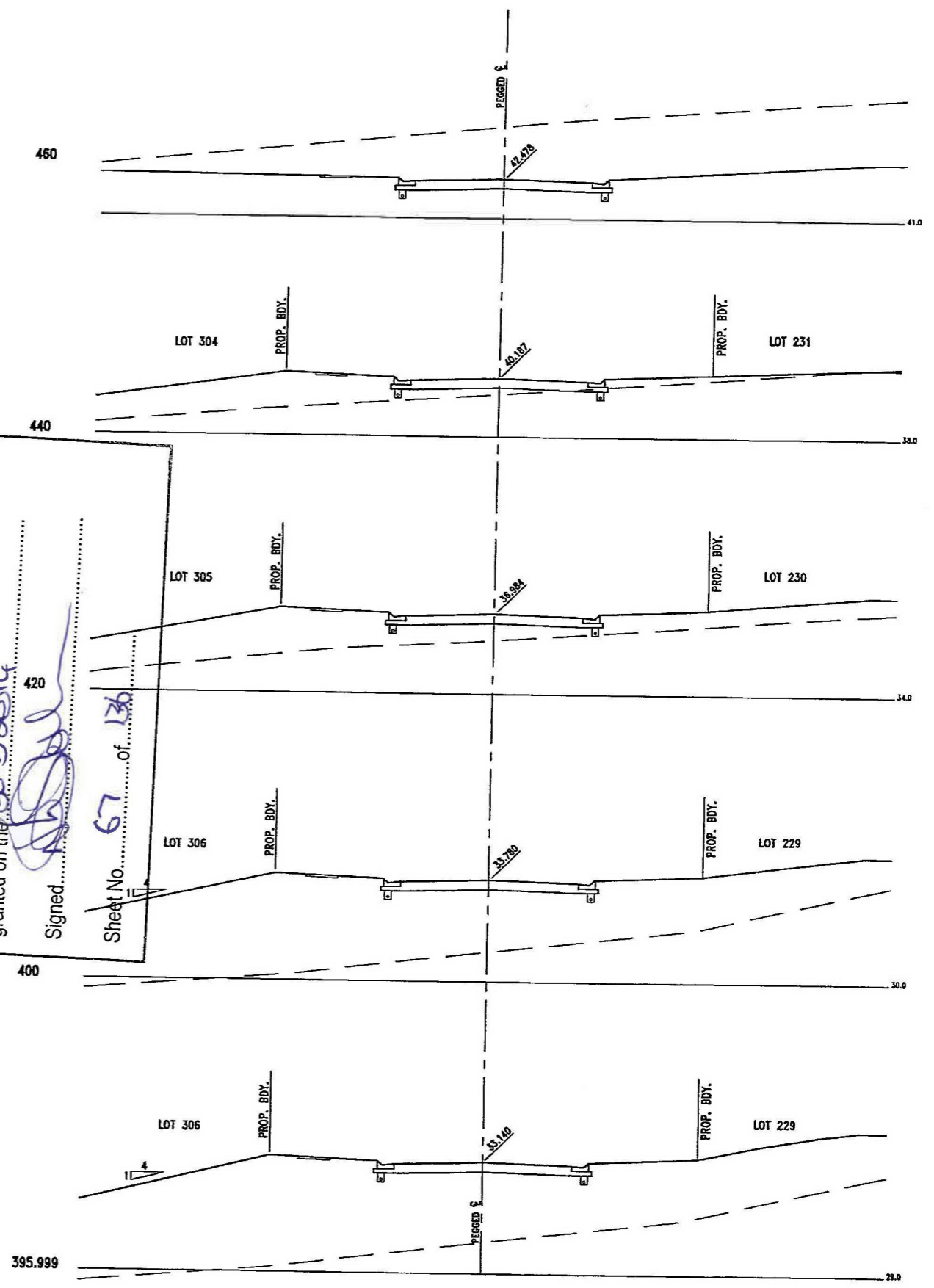
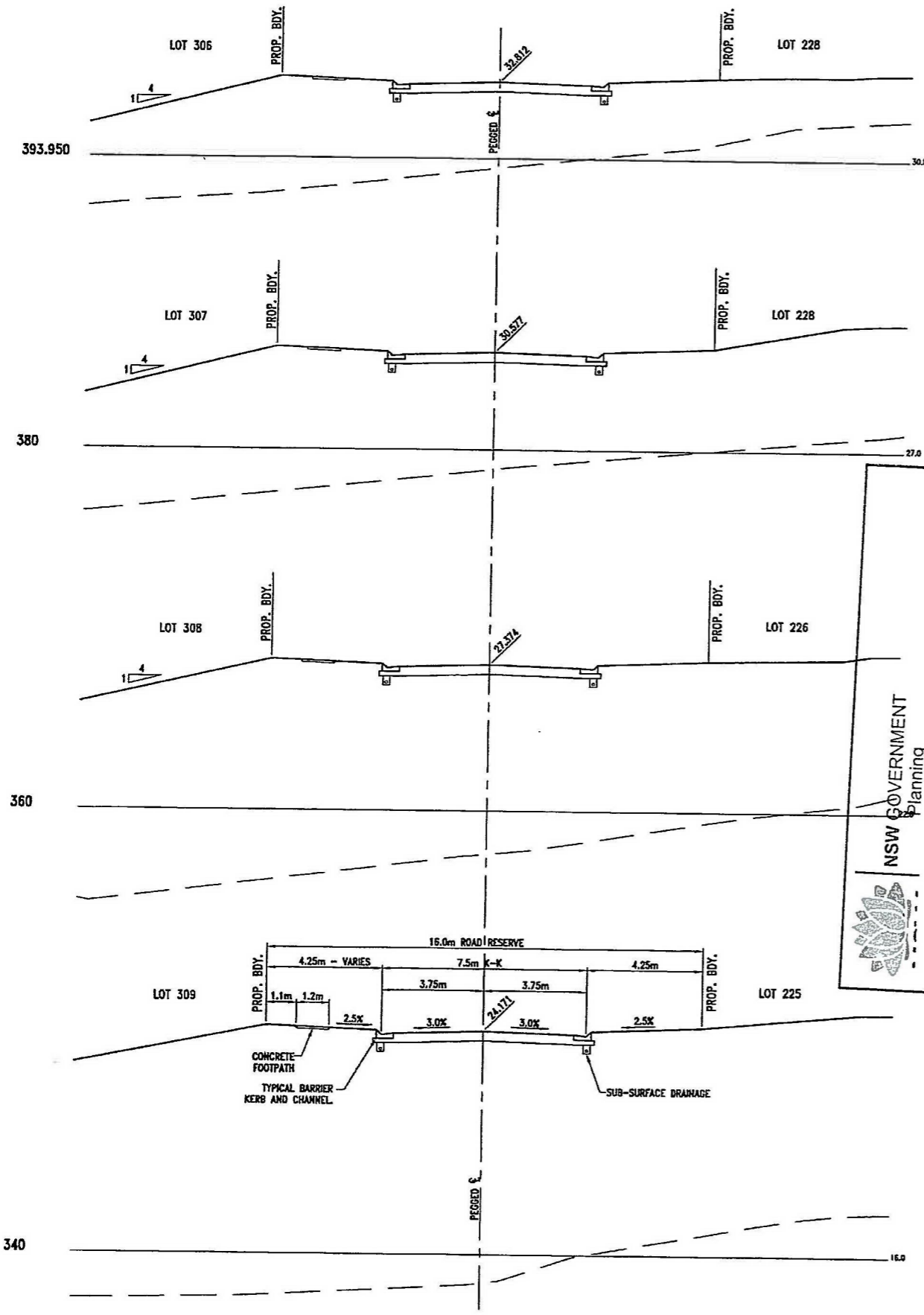

NEWLAND DEVELOPERS PTY LTD	09-374 07-01-2013
TERRANORA PRECINCT 1 ROAD 7 CROSS SECTIONS	SK 3966 REVISION A

Bradford Lees Pty Ltd ABN 29 064 159 191 Ph 07 5528 6411 Fax 07 5528 6422 Web www.bradlees.com.au Email mar@bradlees.com.au Postal PO Box 2293, Southport QLD 4215 Gold Coast Office Level 1, 34 Thomas Drive, Chevron Island QLD 4217	Bradlees Civil Consulting	
---	-------------------------------------	--



NSW GOVERNMENT
 Planning
 Issued under the Environmental Planning and Assessment Act 1979
 Approved Application No. M2009-0166
 granted on the 20.08.2014
 Signed: 
 Sheet No. 67 of 136

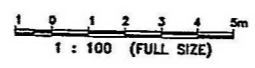

NEWLAND DEVELOPERS PTY LTD TERRANORA PRECINCT 1 ROAD 8 CROSS SECTIONS SHEET 4 OF 4	09-374 07-01-2013 SK 3967 REVISION A
---	---

Bradford Lees Pty Ltd ABN 29 064 159 191 Ph 07 5528 6411 Fax 07 5528 6422 Web www.bradlees.com.au Email mail@bradlees.com.au Postal PO Box 2293, Southport QLD 4215 Gold Coast Office Level 1, 34 Thomas Drive, Chevron Island QLD 4217	 Bradlees Civil Consulting  <small>QUALITY ASSURED COMPANY AS PER ISO 9001:2008 REG. NO. 233</small>
--	---