

LAYOUT
1:250

NOTE
FUTURE ULTIMATE
CONSTRUCTION BY OTHERS

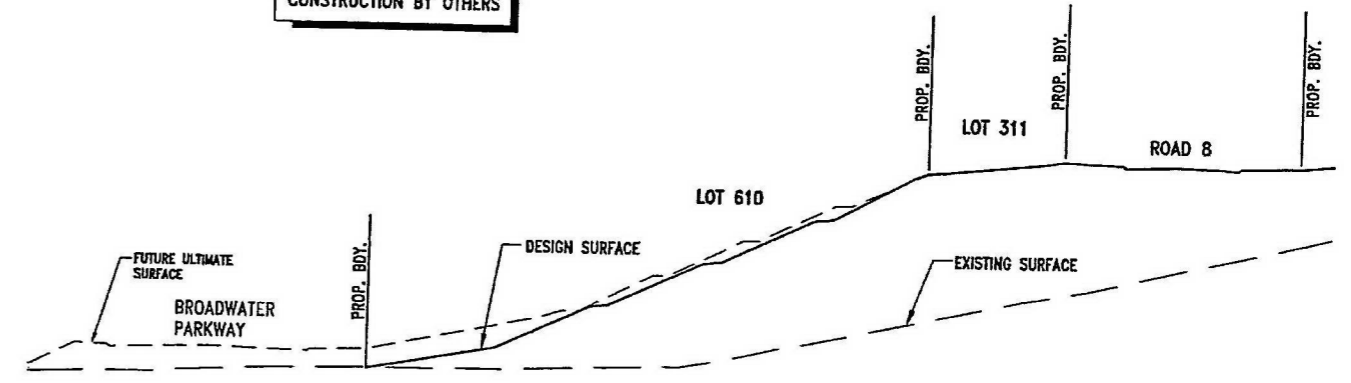

DATUM R.L. -5.0

SECTION B
SCALE 1:250

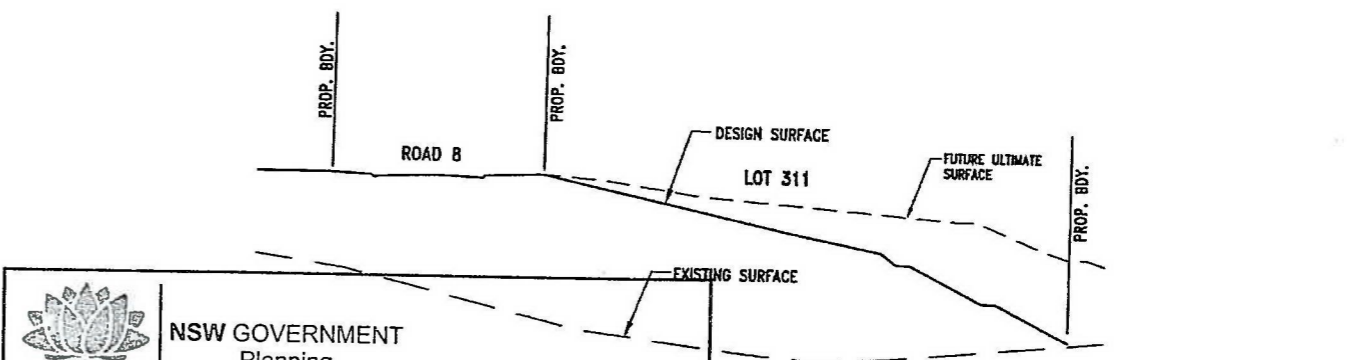

SECTION A
SCALE 1:250

NSW GOVERNMENT
Planning
Issued under the Environmental Planning and Assessment Act 1979
Approved Application No. MPC9.0166
granted on the 30.9.2014
Signed [Signature]
Sheet No. 85 of 136

- LEGEND**
- 15 FINISHED SURFACE CONTOURS
 - 12 EXISTING SURFACE CONTOURS
 - STAGE BOUNDARY
 - FINISHED SURFACE LEVEL

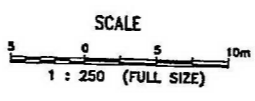

NEWLAND DEVELOPERS PTY LTD	09-374 15-03-2013
TERRANORA PRECINCT 1	SK 4032
EXISTING BOUNDARY TIE IN	REVISION A

Bradford Lees Pty Ltd ABN 29 064 159 191 Ph 07 5528 6411 Fax 07 5528 6422 Web www.bradlees.com.au Email mail@bradlees.com.au Postal PO Box 2293, Southport QLD 4215 Gold Coast Office Level 1, 34 Thomas Drive, Chevron Island QLD 4217	 Bradlees Civil Consulting <small>QUALITY ASSURED COMPANY AS/NZS ISO 9001:2008 REG. NO. 223</small>
--	---

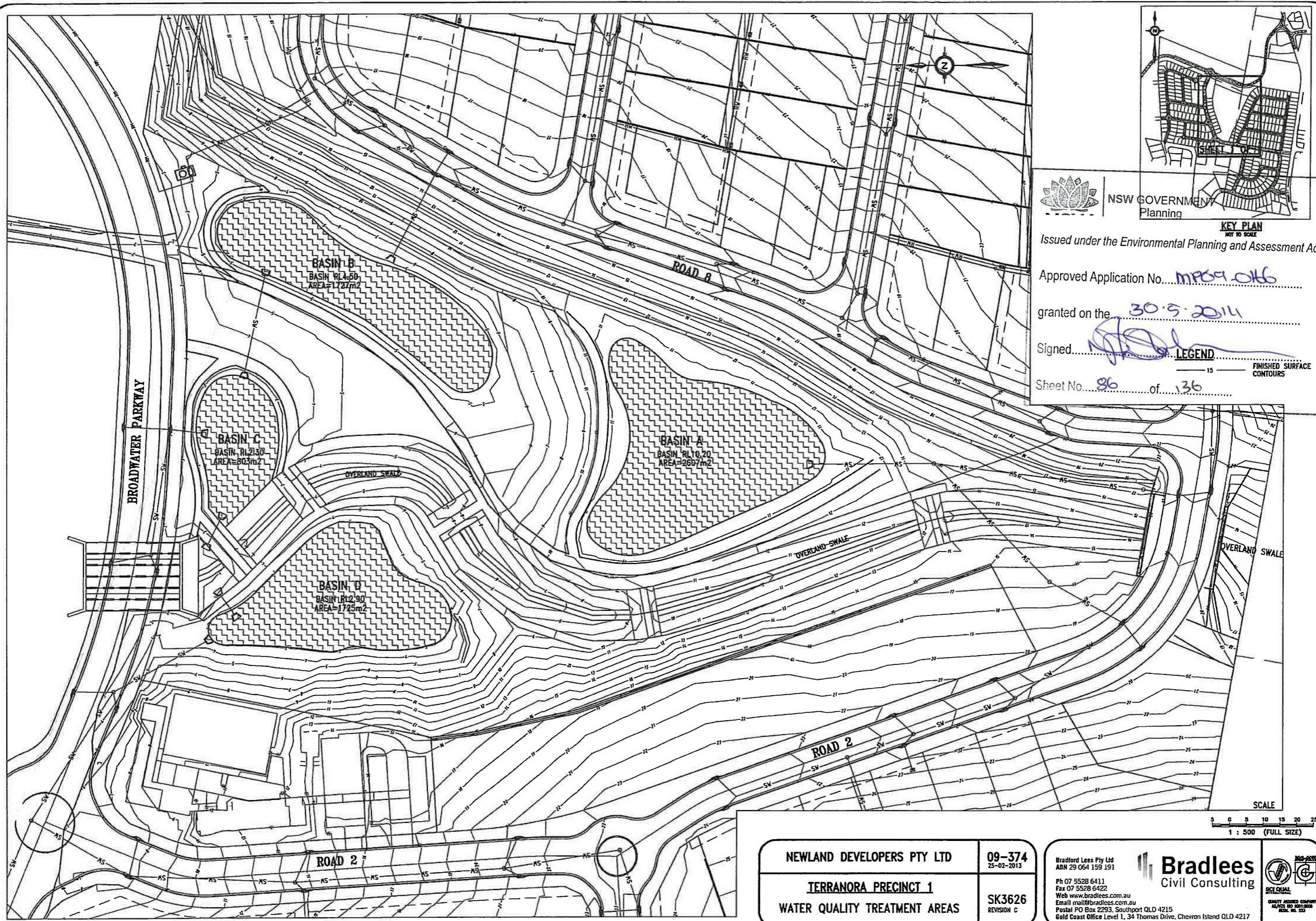

NSW GOVERNMENT
Planning

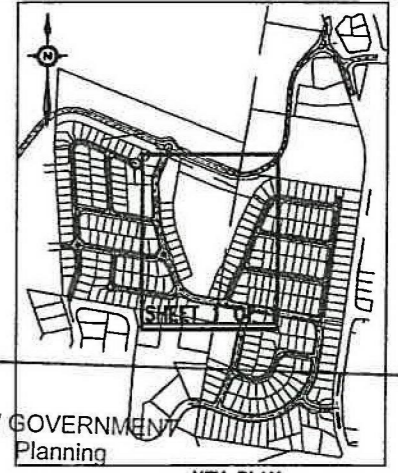

KEY PLAN
NOT TO SCALE

Issued under the Environmental Planning and Assessment Act 1979

Approved Application No. MP09 016

granted on the 30.9.2011

Signed [Signature] LEGEND

Sheet No. 86 of 136

15 FINISHED SURFACE CONTOURS

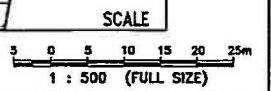

NEWLAND DEVELOPERS PTY LTD
09-374 25-02-2013
TERRANORA PRECINCT 1
WATER QUALITY TREATMENT AREAS
SK3626 REVISION C

Bradford Lees Pty Ltd
ABN 29 064 159 191
Ph 07 5528 6411
Fax 07 5528 6422
Web www.bradlees.com.au
Email mail@bradlees.com.au
Postal PO Box 2293, Southport QLD 4215
Gold Coast Office Level 1, 34 Thomas Drive, Chevron Island QLD 4217

Bradlees
Civil Consulting

MS-ASSE
BCL QUAL
QUALITY ASSURED COMPANY
AS/NZS ISO 9001:2008
REG. NO. 233

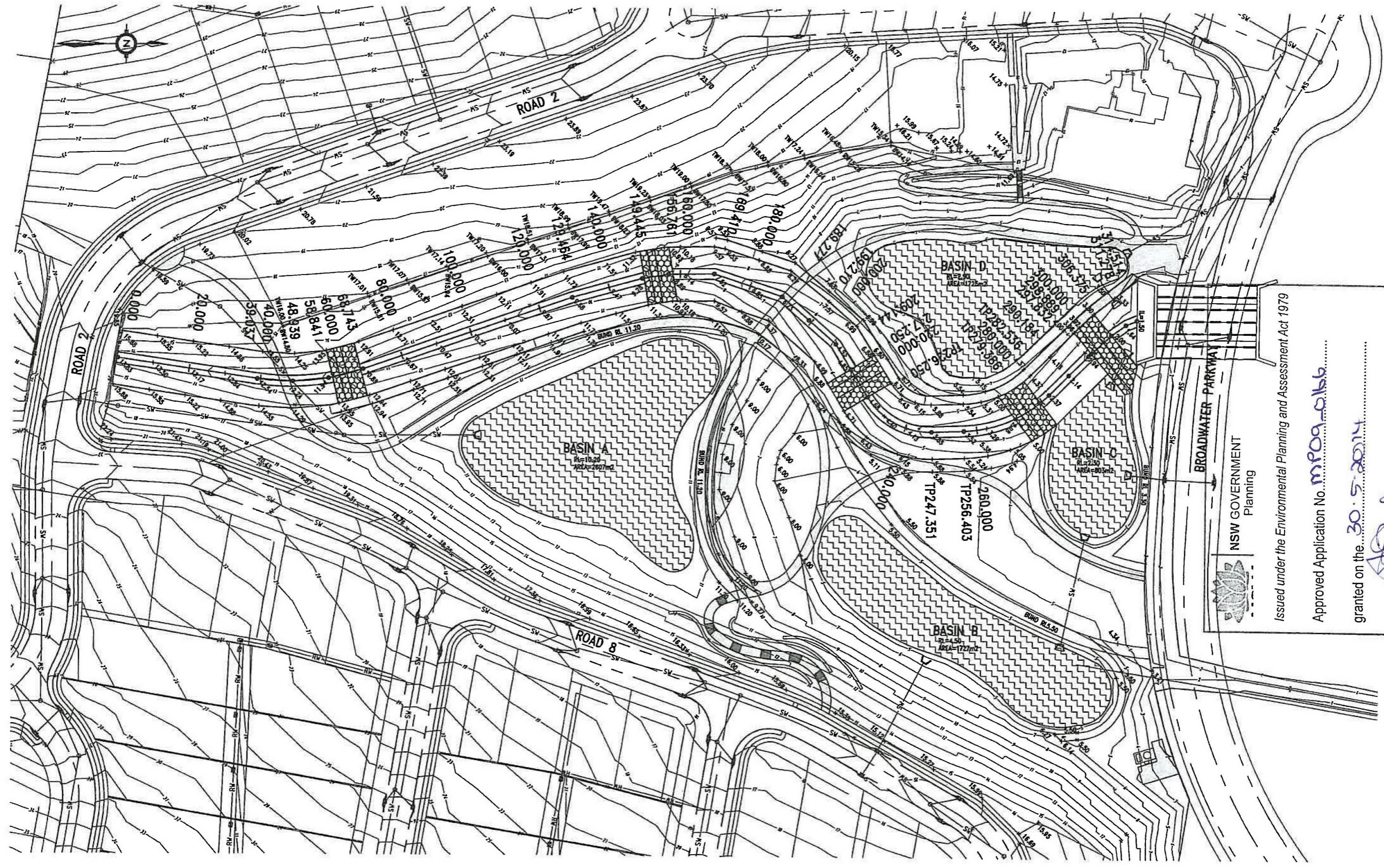

NSW GOVERNMENT
Planning

Issued under the Environmental Planning and Assessment Act 1979

Approved Application No. **m109 0156**

granted on the **30.5.2011**

Signed *[Signature]*

Sheet No. **87** of **136**

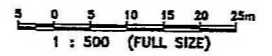

NEWLAND DEVELOPERS PTY LTD	09-374 09-04-2013
TERRANORA PRECINCT 1 CENTRAL OPEN DRAIN SWALE PLAN	SK3618 REVISION D

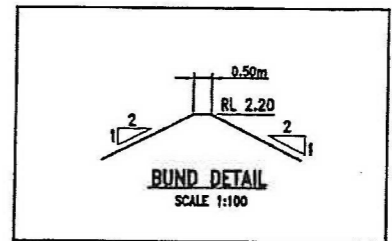
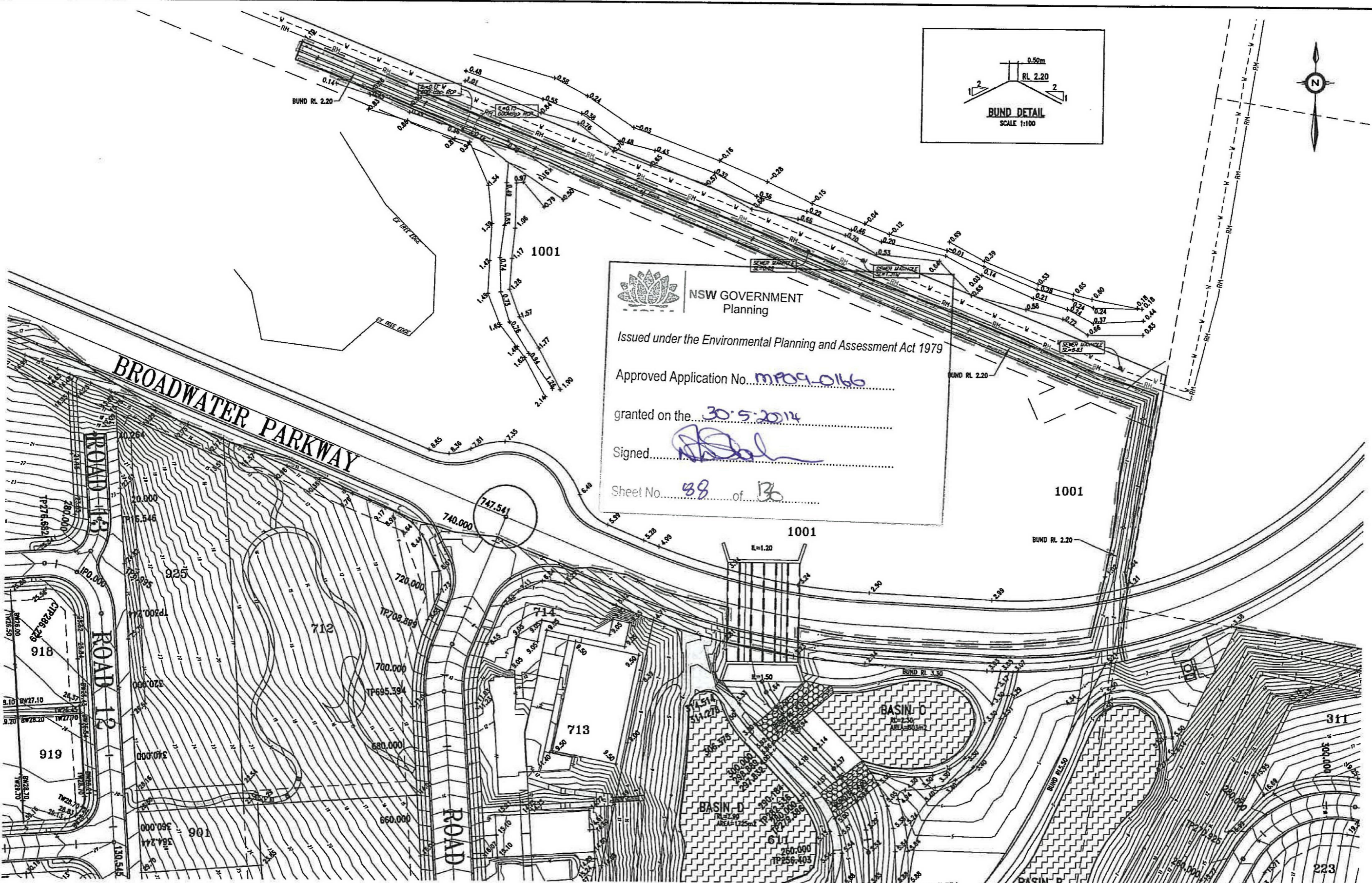

Bradford Lees Pty Ltd ABN 29 064 159 191 Ph 07 5528 6411 Fax 07 5528 6422 Web www.bradlees.com.au Email mail@bradlees.com.au Postal PO Box 2293, Southport QLD 4215 Gold Coast Office Level 1, 34 Thomas Drive, Chevron Island QLD 4217	Bradlees Civil Consulting	 <small>QUALITY ASSURED COMPANY AS/NZS ISO 9001:2008 REG. NO. 513</small>
--	-------------------------------------	--



NSW GOVERNMENT Planning
 Issued under the Environmental Planning and Assessment Act 1979
 Approved Application No. MP09-0166
 granted on the 30-5-2014
 Signed [Signature]
 Sheet No. 39 of 136

SCALE
 0 5 10 15 20 25m
 1 : 500 (FULL SIZE)

NEWLAND DEVELOPERS PTY LTD TERRANORA PRECINCT 1 CENTRAL OPEN DRAIN SWALE BUND	09-374 17-04-2013 SK 4038 REVISION B
--	---

Bradford Lees Pty Ltd ABN 29 064 159 191 Ph 07 5528 6411 Fax 07 5528 6422 Web www.bradlees.com.au Email mail@bradlees.com.au Postal PO Box 2293, Southport QLD 4215 Gold Coast Office Level 1, 34 Thomas Drive, Chevron Island QLD 4217	 Bradlees Civil Consulting 
--	---



NSW GOVERNMENT
Planning

Issued under the Environmental Planning and Assessment Act 1979

Approved Application No. MP09-0166

granted on the 30.5.2014

Signed [Signature]

Sheet No. 89 of 136

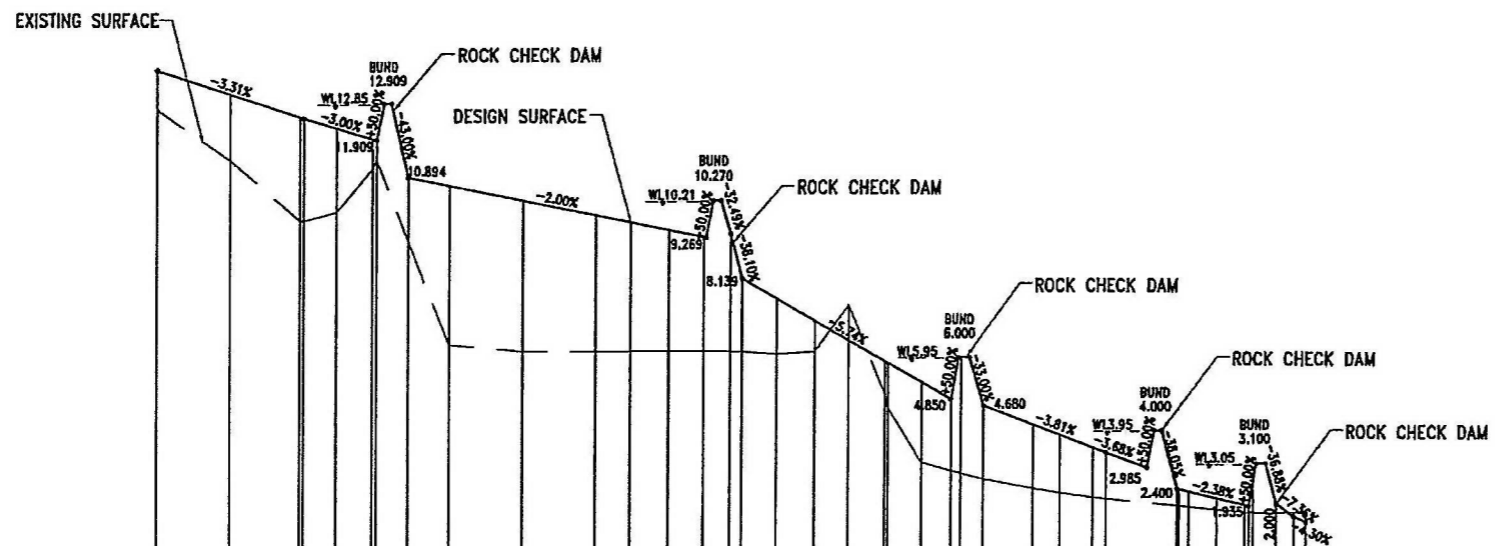
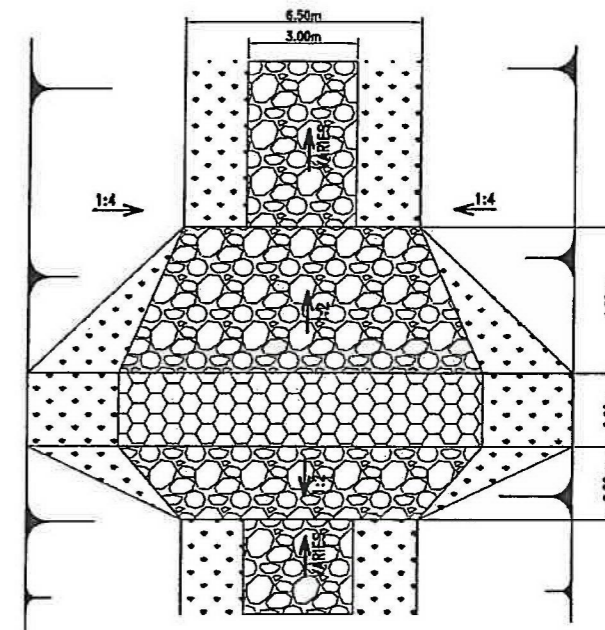
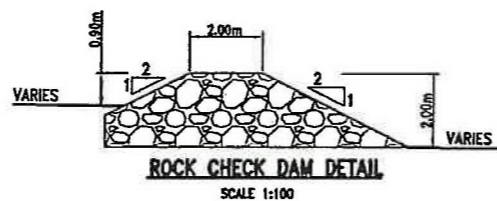

DATUM	R.L. -3.0
HEIGHT OF FILL	1.06 1.81 2.83 2.80 2.30 0.82 0.53 1.75 4.35 4.12 3.72 3.55 3.32 3.13 3.22 2.00 1.96 3.18 2.01 1.75 1.59 1.37 0.45 0.45 0.41 0.31 0.20 0.18 0.83 0.25
DEPTH OF CUT	
PAVEMENT LEVEL ON PEGGED CENTRELINE	13.833 13.171 12.541 12.509 12.241 11.944 11.809 10.894 10.669 10.269 9.869 9.660 9.469 9.280 8.373 8.139 7.598 6.990 6.457 5.886 5.841 5.316 4.650 4.680 4.156 3.877 3.532 3.395 2.400 2.385 2.325 2.143 1.960 1.935 2.592 2.000 1.839 1.560 0.23
EXISTING SURFACE LEVEL	12.75 11.36 9.71 9.71 9.94 11.13 11.38 9.19 8.32 6.14 6.14 6.15 6.15 6.15 6.15 6.14 6.08 6.15 7.42 4.99 4.61 3.11 2.89 2.82 2.67 2.41 2.29 2.16 2.13 1.85 1.94 1.91 1.84 1.76 1.76 1.75 1.75 1.76 1.73
PEGGED CHAINAGE	0 20 39.037 40 48.939 58.841 60 66.743 80 100 120 128.484 140 148.445 156.781 160 168.410 180 188.277 198.210 200 205.144 217.250 220 226.250 240 247.351 258.403 260 273.388 280 281.536 290.184 297.852 298.889 300 308.375 311.278 314.514

HORIZONTAL CURVE DATA

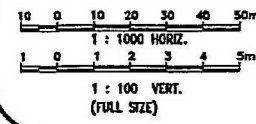
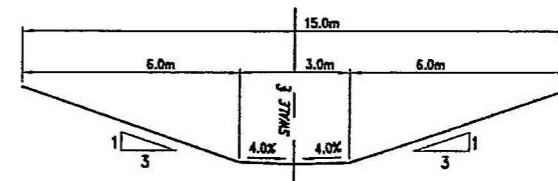

NEWLAND DEVELOPERS PTY LTD
09-374 25-02-2013

TERRANORA PRECINCT 1
CENTRAL OPEN DRAIN
SWALE LONG SECTION

SK3619
REVISION B

Bradlees Civil Consulting

Bradford Lees Pty Ltd
ABN 29 054 159 191
Ph 07 5528 6411
Fax 07 5528 6422
Web www.bradlees.com.au
Email mail@bradlees.com.au
Postal PO Box 2293, Southport QLD 4215
Gold Coast Office Level 1, 34 Thomas Drive, Chevron Island QLD 4217

QUALITY ASSURED COMPANY
AS/NZS ISO 9001:2008
REG. NO. 233

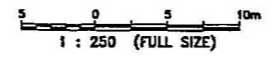
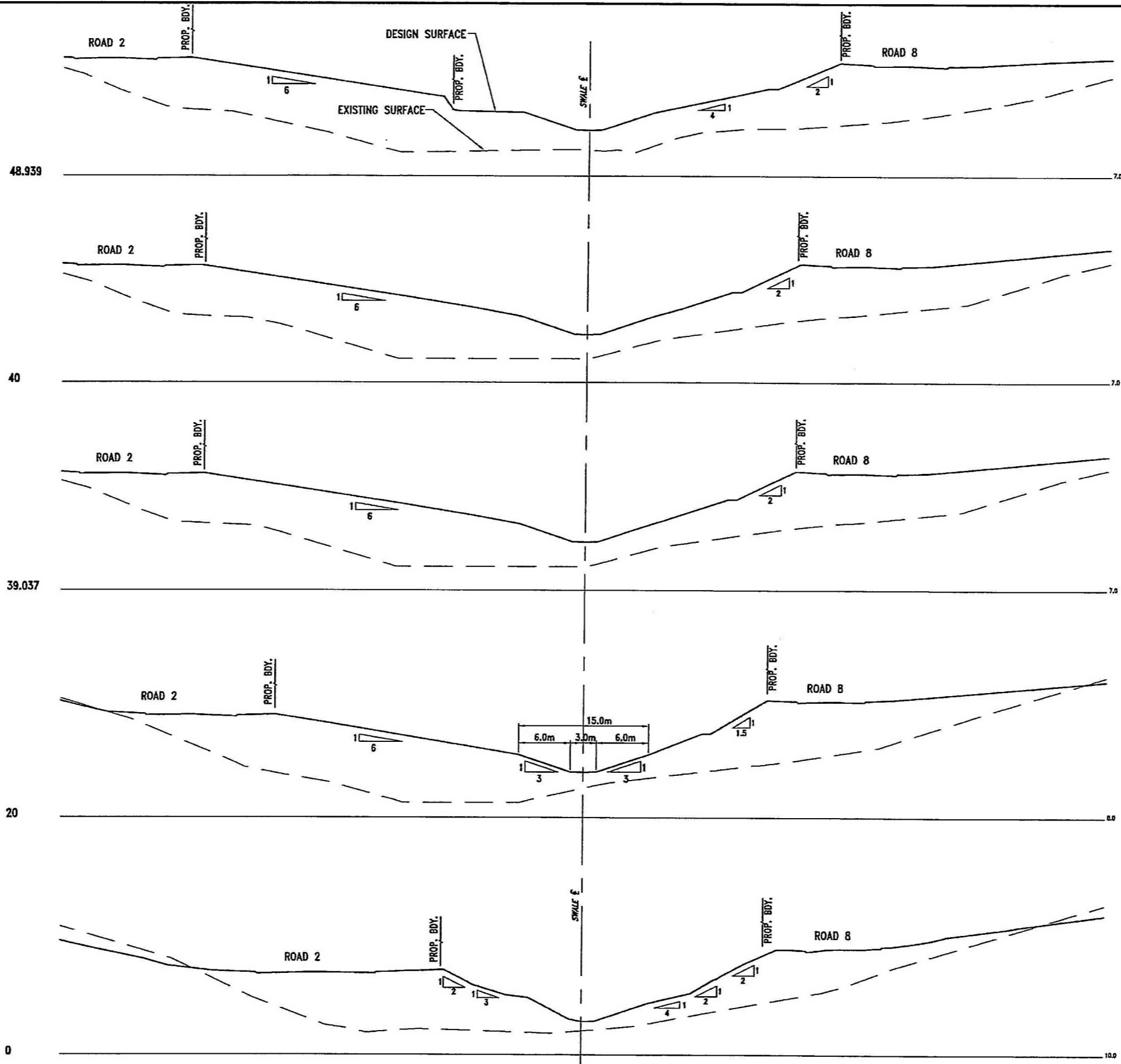



 NSW GOVERNMENT
 Planning
 Issued under the Environmental Planning and Assessment Act 1979
 Approved Application No. M.P.09-016
 granted on the 30.5.2014
 Signed [Signature]
 Sheet No. 90 of 136

NEWLAND DEVELOPERS PTY LTD 25-02-2013	09-374 25-02-2013
TERRANORA PRECINCT 1 CENTRAL OPEN DRAIN SWALE CROSS SECTIONS SHEET 1 OF 6	SK3620 REVISION C

Bradfords Pty Ltd ABN 29 064 159 191 Ph 07 5528 6411 Fax 07 5528 6422 Web www.bradlees.com.au Email mail@bradlees.com.au Postal PO Box 2293, Southport QLD 4215 Gold Coast Office Level 1, 34 Thomas Drive, Chevron Island QLD 4217	 Bradlees Civil Consulting  <small>QUALITY ASSURED COMPANY 45/202 ISO 9001:2008 REG. NO. 233</small>
--	---

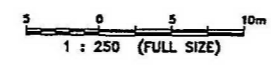
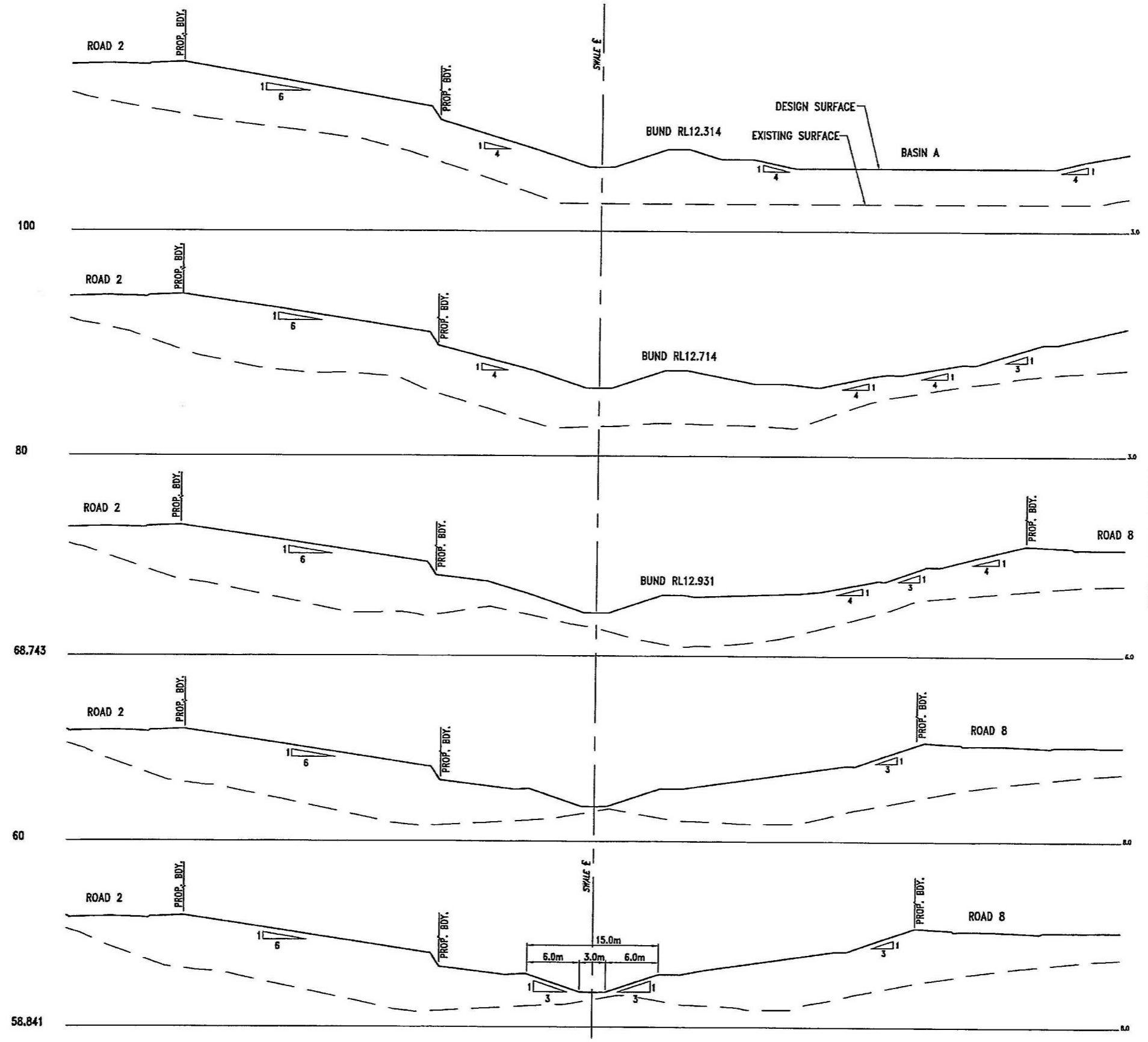

NSW GOVERNMENT
Planning

Issued under the Environmental Planning and Assessment Act 1979

Approved Application No. m209.0115

granted on the 30.5.2014

Signed [Signature]

Sheet No. 91 of 136

NEWLAND DEVELOPERS PTY LTD
09-374
25-02-2013

TERRANORA PRECINCT 1
CENTRAL OPEN DRAIN SWALE
CROSS SECTIONS SHEET 2 OF 6

SK3621
REVISION C

Bradford Lees Pty Ltd
ABN 29 064 159 191

Ph 07 5528 6411
Fax 07 5528 6422
Web www.bradlees.com.au
Email mail@bradlees.com.au
Postal PO Box 2293, Southport QLD 4215
Gold Coast Office Level 1, 34 Thomas Drive, Chevron Island QLD 4217

Bradlees
Civil Consulting

QUALITY ASSURED COMPANY
AS/NZS ISO 9001:2008
REG. NO. 253

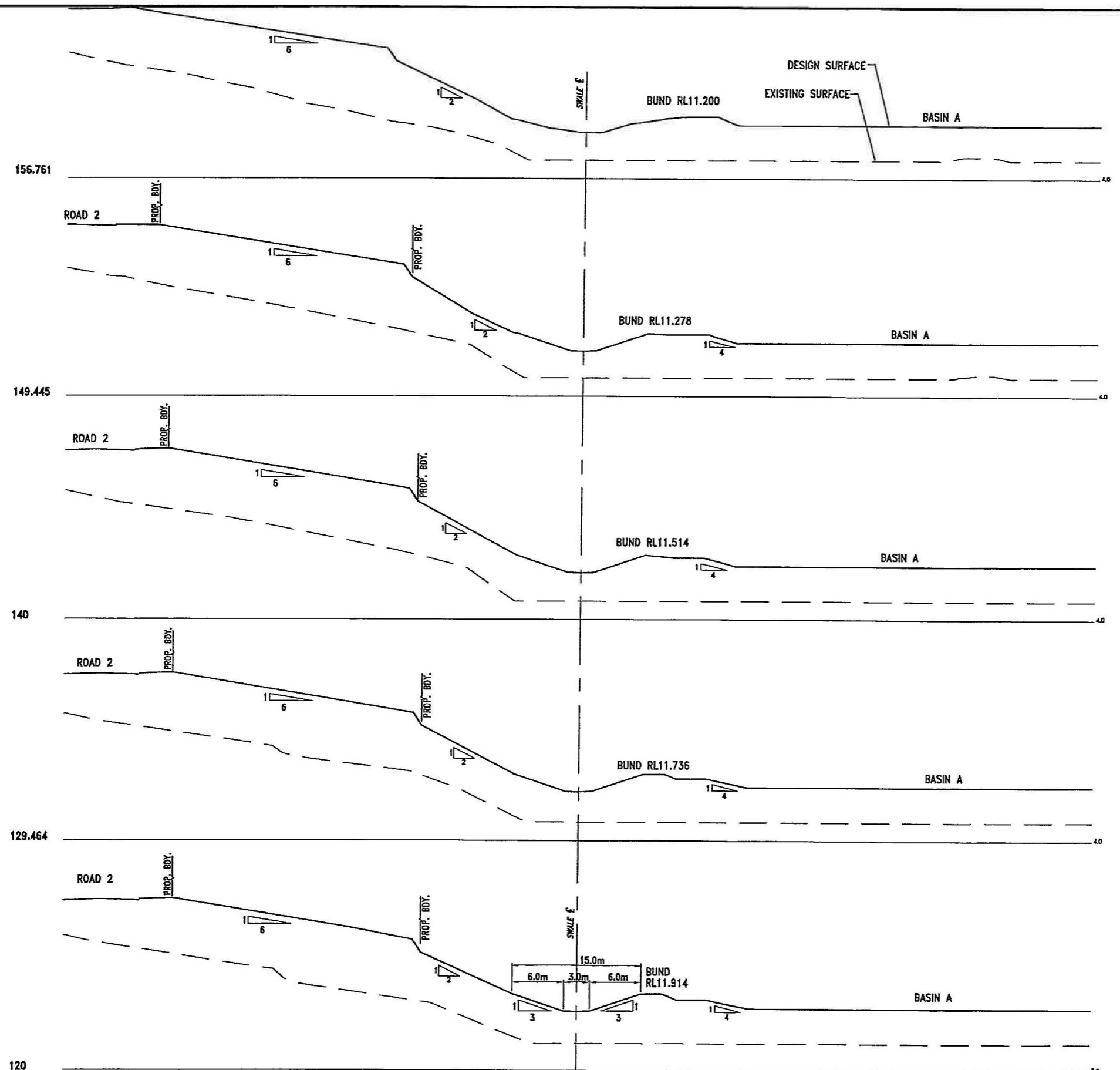

NSW GOVERNMENT
Planning

Issued under the Environmental Planning and Assessment Act 1979

Approved Application No. MP09/016

granted on the 30.5.2014

Signed [Signature]

Sheet No. 92 of 136

NEWLAND DEVELOPERS PTY LTD
25-02-2013

TERRANORA PRECINCT 1
CENTRAL OPEN DRAIN SWALE
CROSS SECTIONS SHEET 3 OF 6

09-374
25-02-2013

SK3622
REVISION C

Bradford Lees Pty Ltd
ABN 29 054 159 191
Ph 07 5528 6411
Fax 07 5528 6422
Web www.bradlees.com.au
Email mail@bradlees.com.au
Postal PO Box 2253, Southport QLD 4215
Gold Coast Office Level 1, 34 Thomas Drive, Chevron Island QLD 4217

Bradlees
Civil Consulting

QUALITY ASSURED COMPANY
ALWAYS DO IT RIGHT
REG. NO. 238

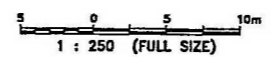
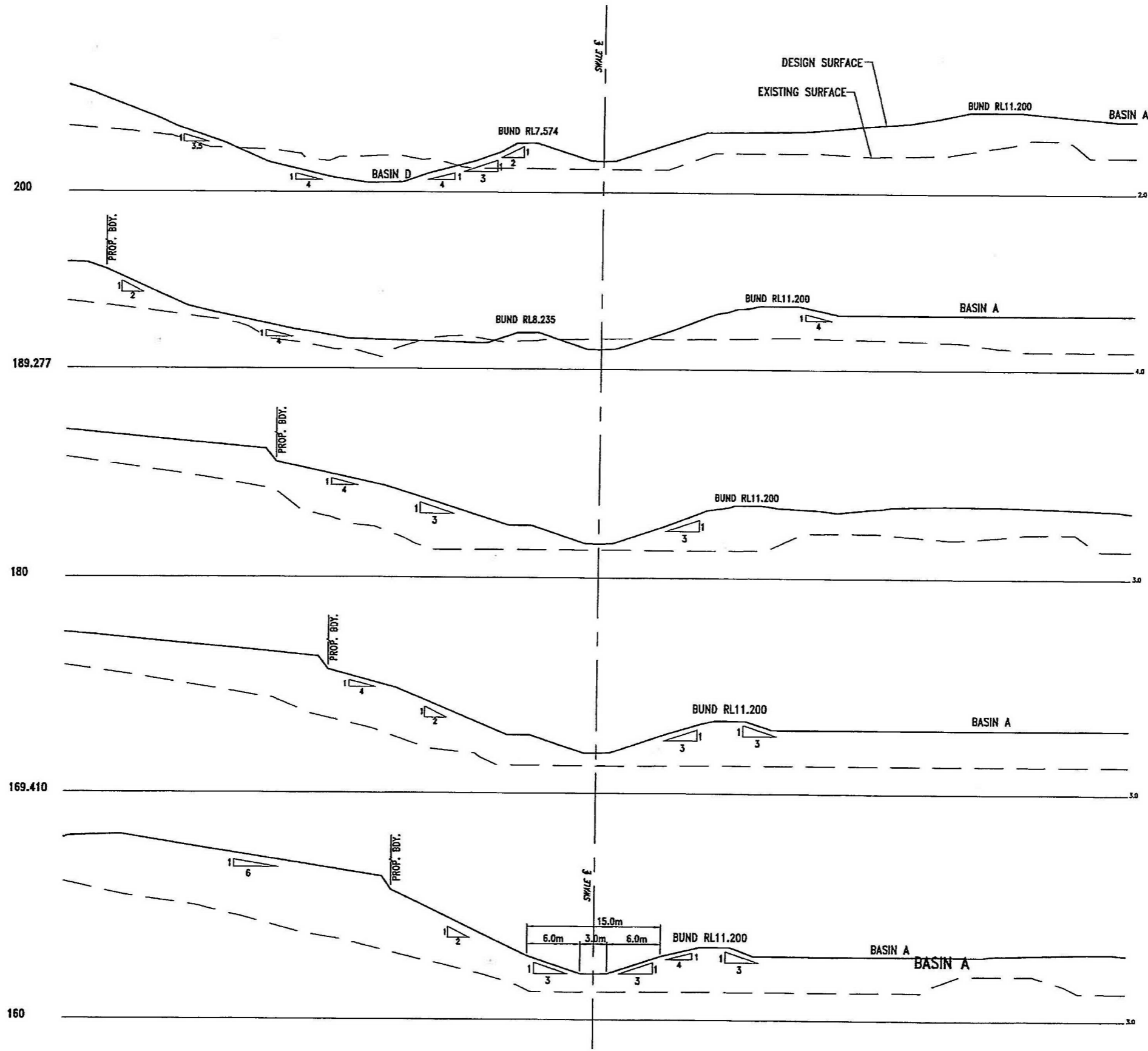



NSW GOVERNMENT
 Planning

Issued under the Environmental Planning and Assessment Act 1979

Approved Application No. MPC9.016

granted on the 30.5.2014

Signed: 

Sheet No. 93 of 136

NEWLAND DEVELOPERS PTY LTD
 09-374
 25-02-2013

TERRANORA PRECINCT 1
 CENTRAL OPEN DRAIN SWALE
 CROSS SECTIONS SHEET 4 OF 6

SK3623
 REVISION C

Bradford Lees Pty Ltd
 ABN 29 064 159 191

Bradlees
 Civil Consulting

Ph 07 5528 6411
 Fax 07 5528 6422
 Web www.bradlees.com.au
 Email mail@bradlees.com.au
 Postal PO Box 2203, Southport QLD 4215
 Gold Coast Office Level 1, 34 Thomas Drive, Chevron Island QLD 4217



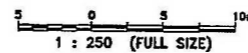
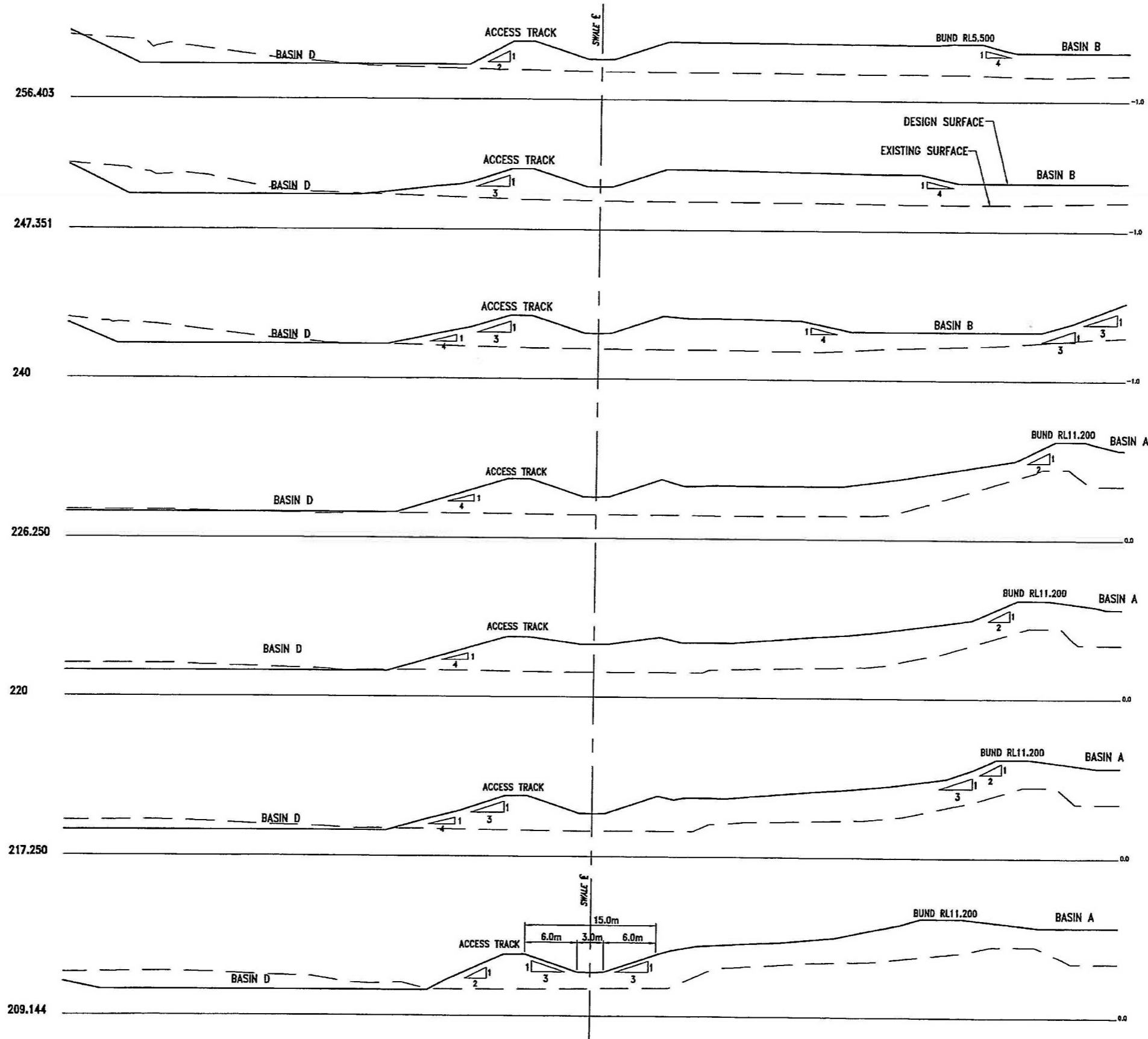

NEWLAND DEVELOPERS PTY LTD
09-374
 25-02-2013

TERRANORA PRECINCT 1
CENTRAL OPEN DRAIN SWALE
CROSS SECTIONS SHEET 5 OF 6

SK3624
 REVISION C

Bradford Lees Pty Ltd
 ABN 29 064 159 191
 Ph 07 5528 6411
 Fax 07 5528 6422
 Web www.bradlees.com.au
 Email mail@bradlees.com.au
 Postal PO Box 2293, Southport QLD 4215
 Gold Coast Office Level 1, 34 Thomas Drive, Chevron Island QLD 4217



NSW GOVERNMENT
 Planning

Issued under the Environmental Planning and Assessment Act 1979

Approved Application No. MPO1-0166

granted on the 30.5.2014

Signed [Signature]

Sheet No. 914 of 136

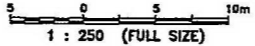
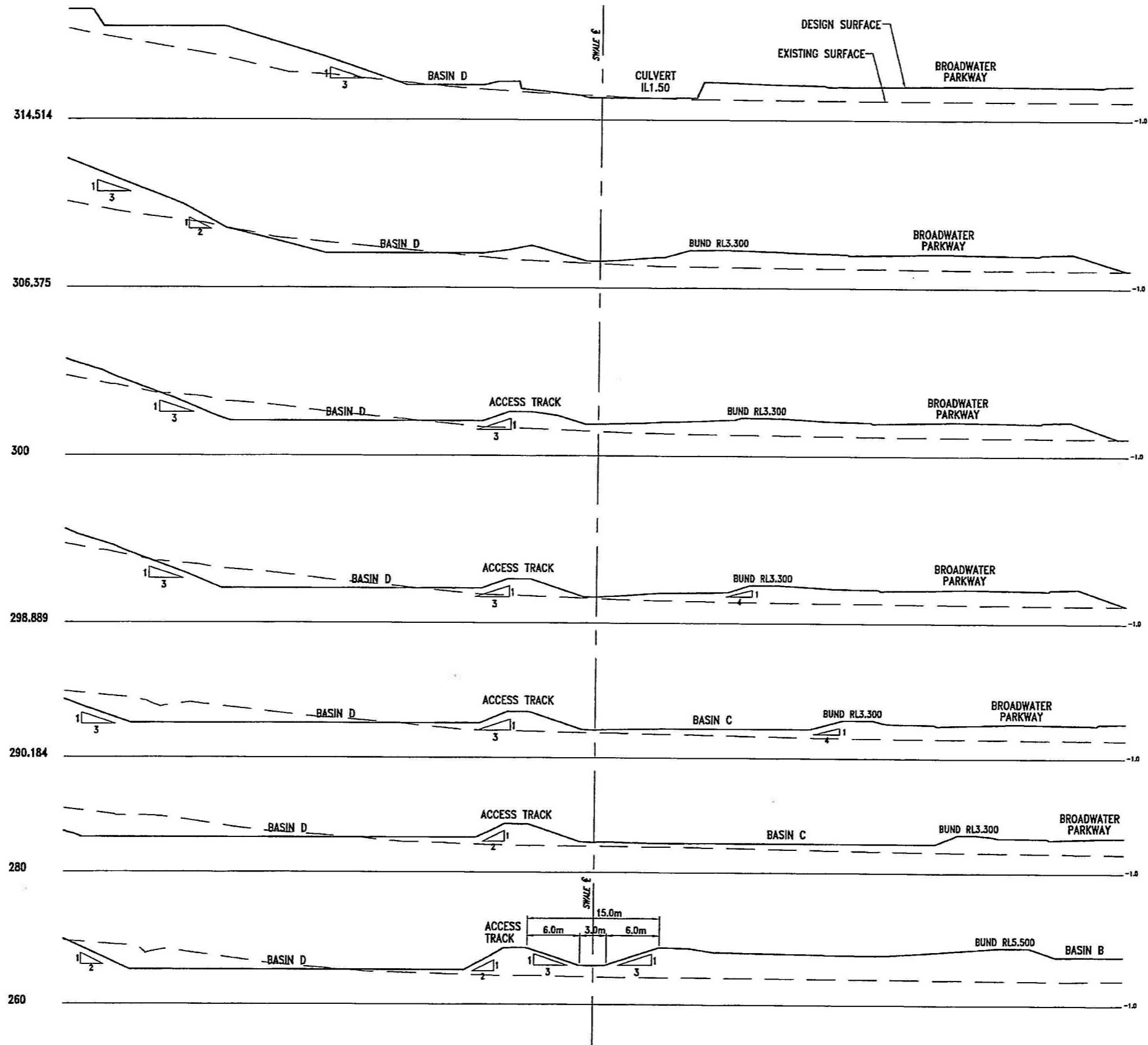

NSW GOVERNMENT
Planning

Issued under the Environmental Planning and Assessment Act 1979

Approved Application No. M.P051.0166

granted on the 30.5.2014

Signed [Signature]

Sheet No. 95 of 136

NEWLAND DEVELOPERS PTY LTD
09-374 25-02-2013

TERRANORA PRECINCT 1
CENTRAL OPEN DRAIN SWALE
CROSS SECTIONS SHEET 6 OF 6

SK3625
REVISION C

Bradford Lees Pty Ltd
ABN 29 054 159 191

Ph 07 5528 6411
Fax 07 5528 6422
Web www.bradlees.com.au
Email mail@bradlees.com.au
Postal PO Box 2293, Southport QLD 4215
Gold Coast Office Level 1, 34 Thomas Drive, Chevron Island QLD 4217

Bradlees
Civil Consulting

QUALITY ASSURED COMPANY
AS/NZS ISO 9001:2008
REG. NO. 221