

SECTION 1

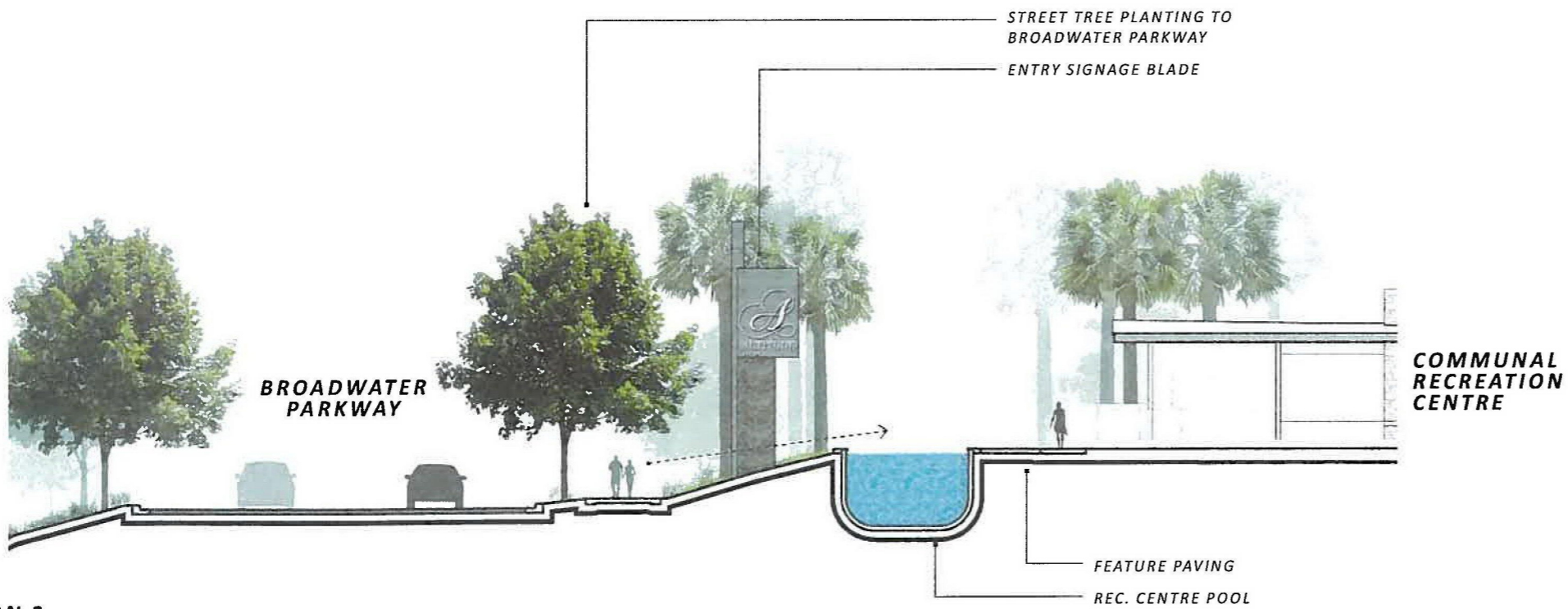
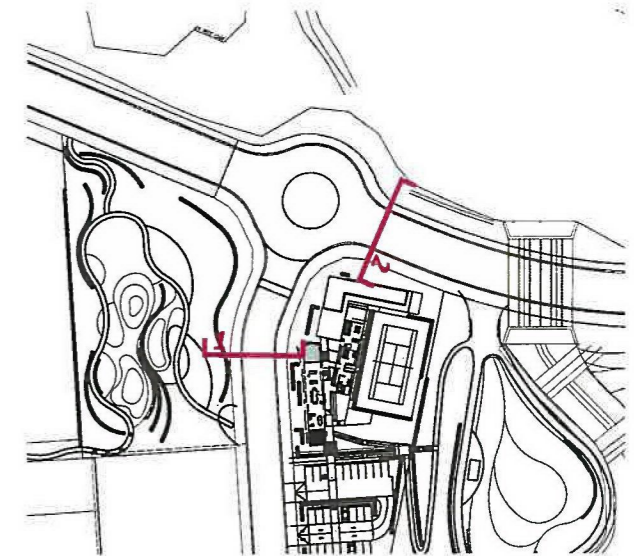

SECTION 2

NSW GOVERNMENT  
Planning

Issued under the Environmental Planning and Assessment Act 1979

Approved Application No. MPO9-0166

granted on the 30.5.2014

Signed.....*[Signature]*.....

Sheet No. 122 of 136

LANDSCAPE SECTIONS

100906 | 12 AUG 13 | DA07 | SCALE 1:200 @ A3

PROJECT ALTITUDE ASPIRE | TERRANORA | LANDSCAPE MASTERPLAN | CLIENT NEWLAND DEVELOPERS PTY LTD



NSW GOVERNMENT  
Planning

Issued under the Environmental Planning and Assessment Act 1979

Approved Application No. MPO920166

granted on the 30/5/2014

Signed [Signature]

Sheet No. 123 of 126

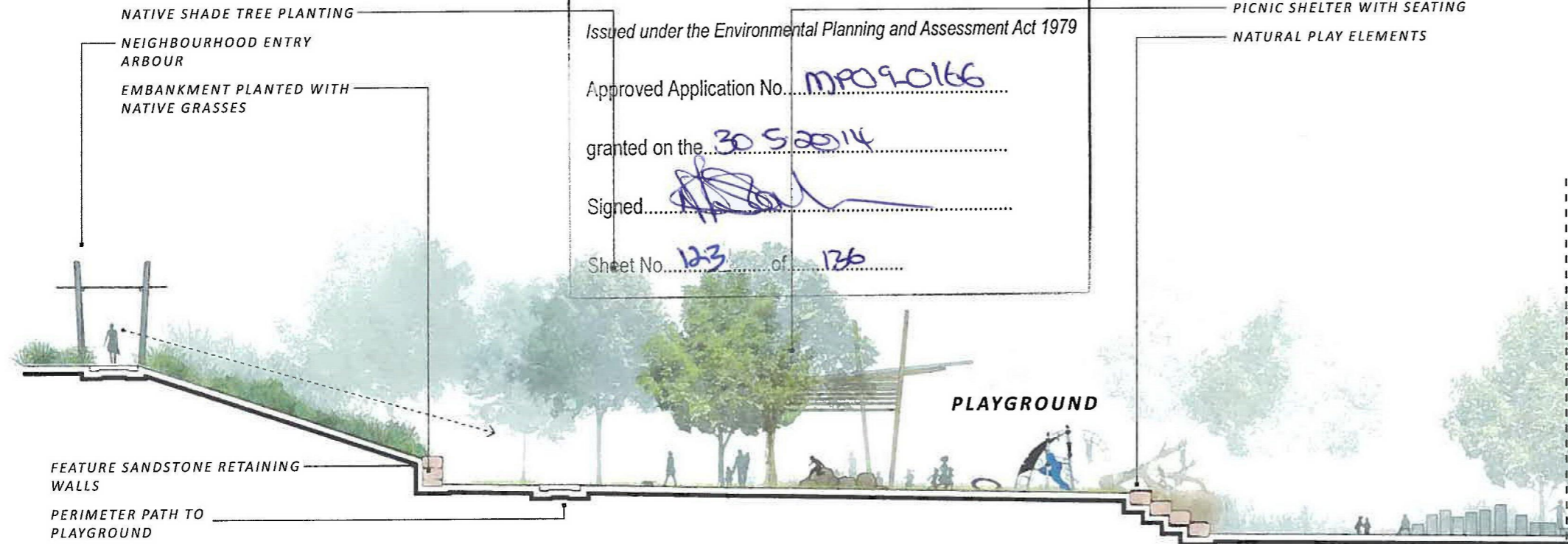

NATIVE SHADE TREE PLANTING

NEIGHBOURHOOD ENTRY  
ARBOUR

EMBANKMENT PLANTED WITH  
NATIVE GRASSES

PICNIC SHELTER WITH SEATING

NATURAL PLAY ELEMENTS

PLAYGROUND

FEATURE SANDSTONE RETAINING  
WALLS

PERIMETER PATH TO  
PLAYGROUND

SECTION 3

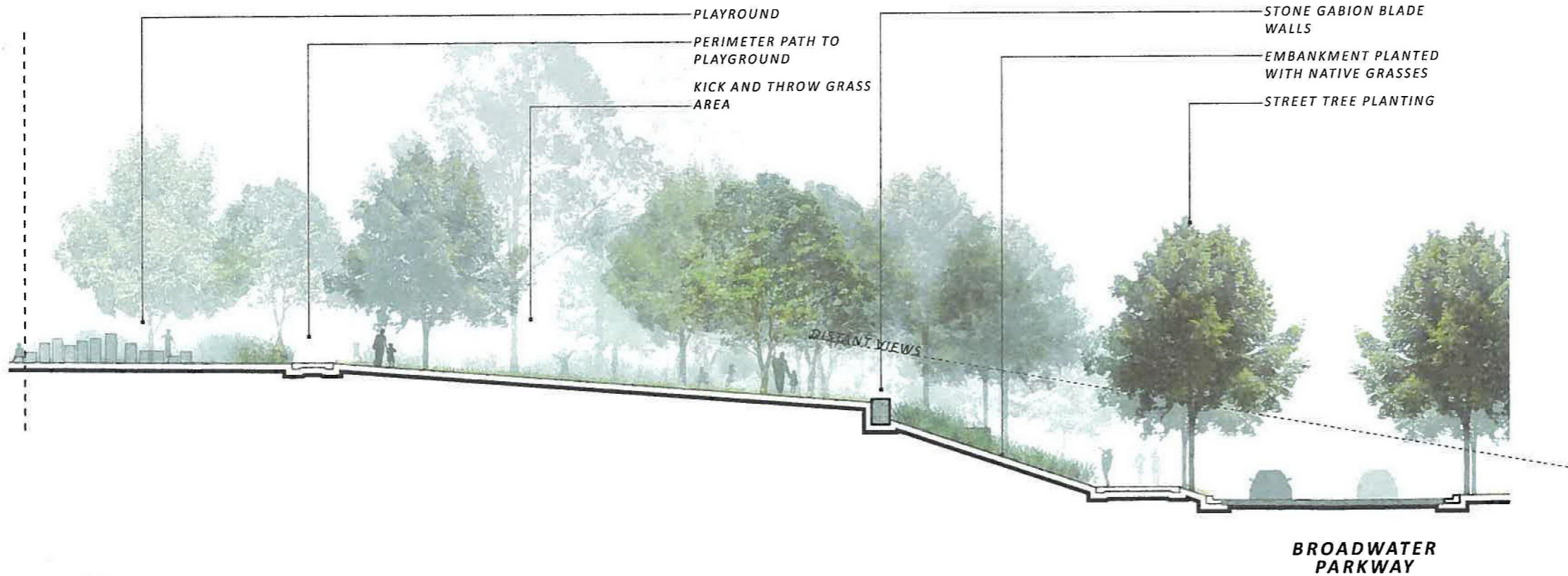

PLAYGROUND

PERIMETER PATH TO  
PLAYGROUND

KICK AND THROW GRASS  
AREA

STONE GABION BLADE  
WALLS

EMBANKMENT PLANTED  
WITH NATIVE GRASSES

STREET TREE PLANTING

DISTANT VIEWS

BROADWATER  
PARKWAY

SECTION 3 (cont.)

LANDSCAPE SECTION

100906 | 12 AUG 13 | DA07 | SCALE 1:200 @ A3

PROJECT ALTITUDE ASPIRE | TERRANORA | LANDSCAPE MASTERPLAN | CLIENT NEWLAND DEVELOPERS PTY LTD

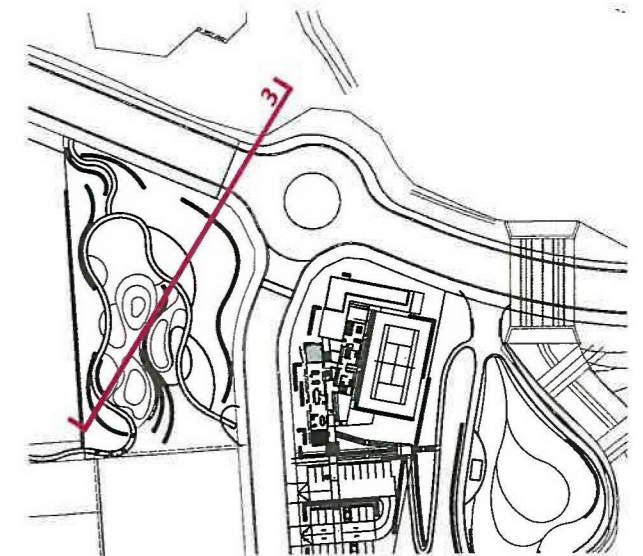



**NSW GOVERNMENT**  
 Planning

Issued under the Environmental Planning and Assessment Act 1979

Approved Application No... *MPO9-0166* .....

granted on the *30.5.2014* .....

Signed... *[Signature]* .....

Sheet No... *124* ..... of *136* .....

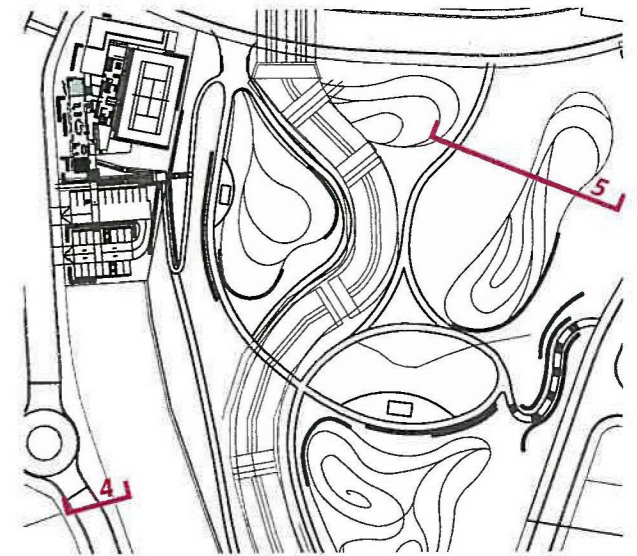

**SECTION 4**

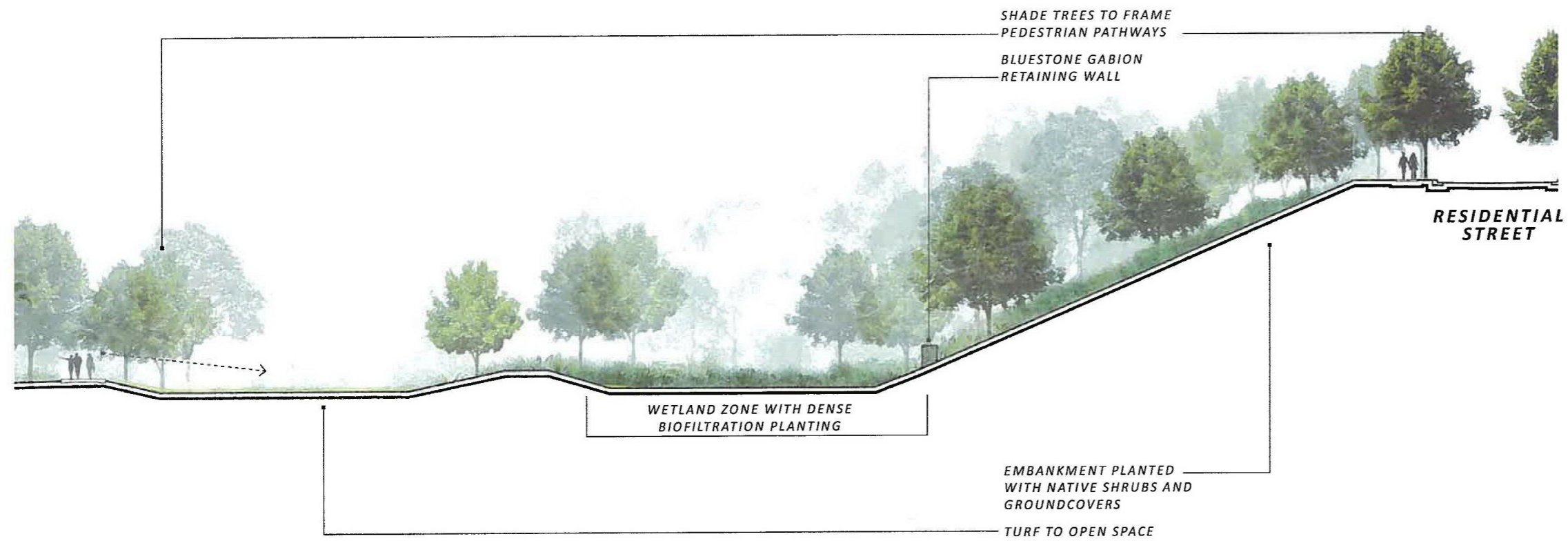

**SECTION 5**

**LANDSCAPE SECTIONS**

100906 | 12 AUG 13 | DA07 | SCALE 1:200 @ A3

PROJECT ALTITUDE ASPIRE | TERRANORA | LANDSCAPE MASTERPLAN | CLIENT NEWLAND DEVELOPERS PTY LTD

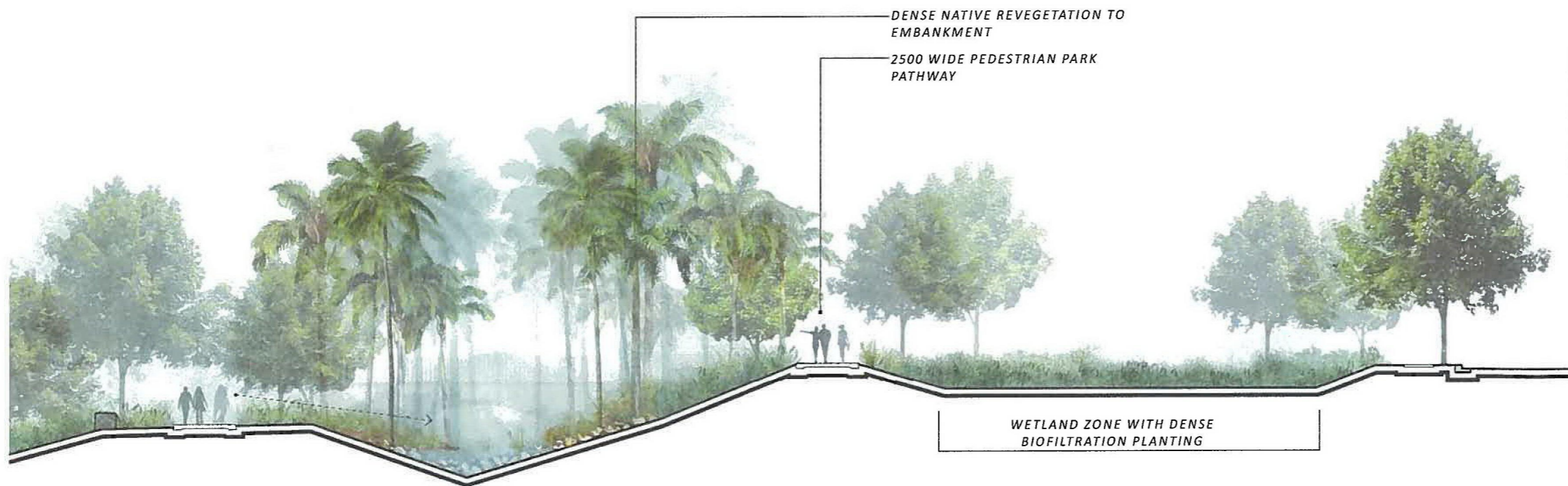

DENSE NATIVE REVEGETATION TO EMBANKMENT  
 2500 WIDE PEDESTRIAN PARK PATHWAY

WETLAND ZONE WITH DENSE BIOFILTRATION PLANTING

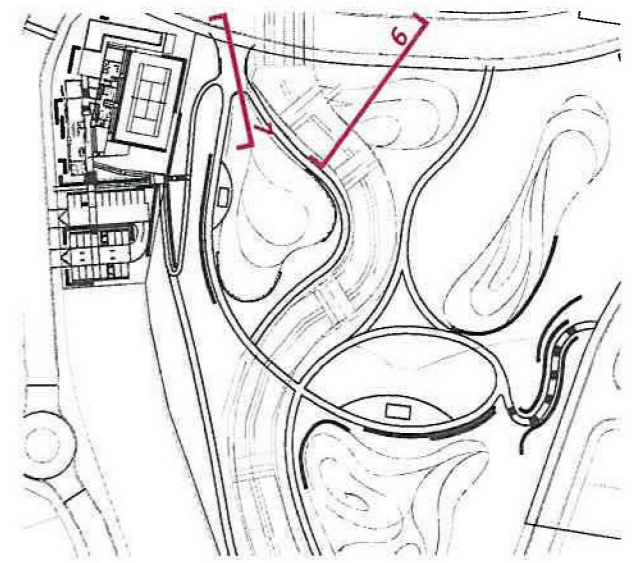

BROADWATER PARKWAY

SECTION 6

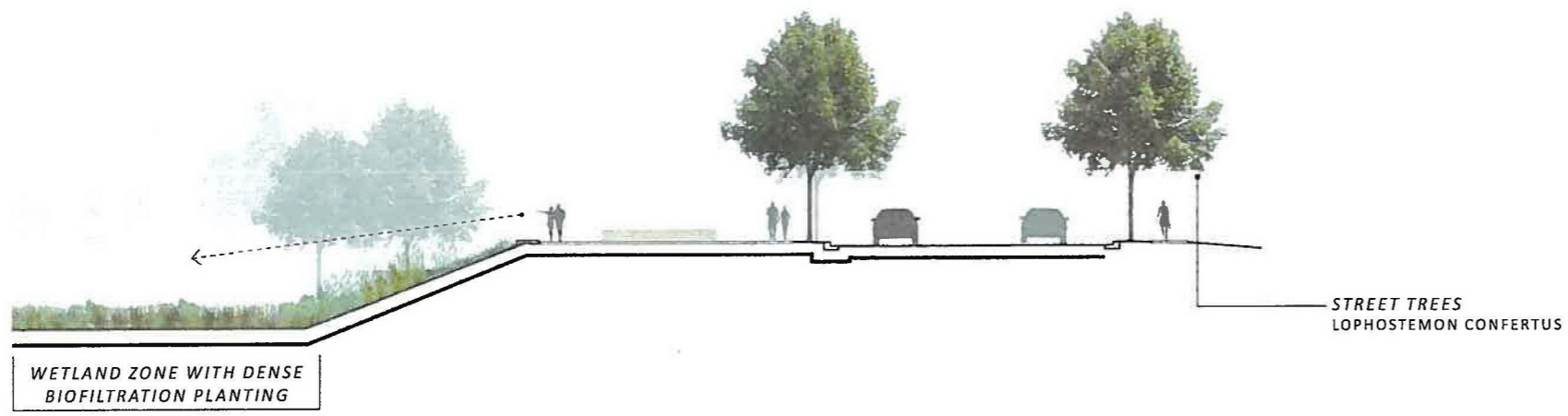

BIO FILTRATION BASIN

WETLAND ZONE WITH DENSE BIOFILTRATION PLANTING

STREET TREES  
 LOPHOSTEMON CONFERTUS

SECTION 7

 GOVERNMENT OF WESTERN AUSTRALIA  
 Planning  
 Issued under the Environmental Planning and Assessment Act 1979  
 Approved Application No. MPO9-0166  
 Approved Application Date 30-5-2014  
 Issued on the 30-5-2014  
 Issued by [Signature]  
 Sheet No. 125 of 136

LANDSCAPE SECTIONS

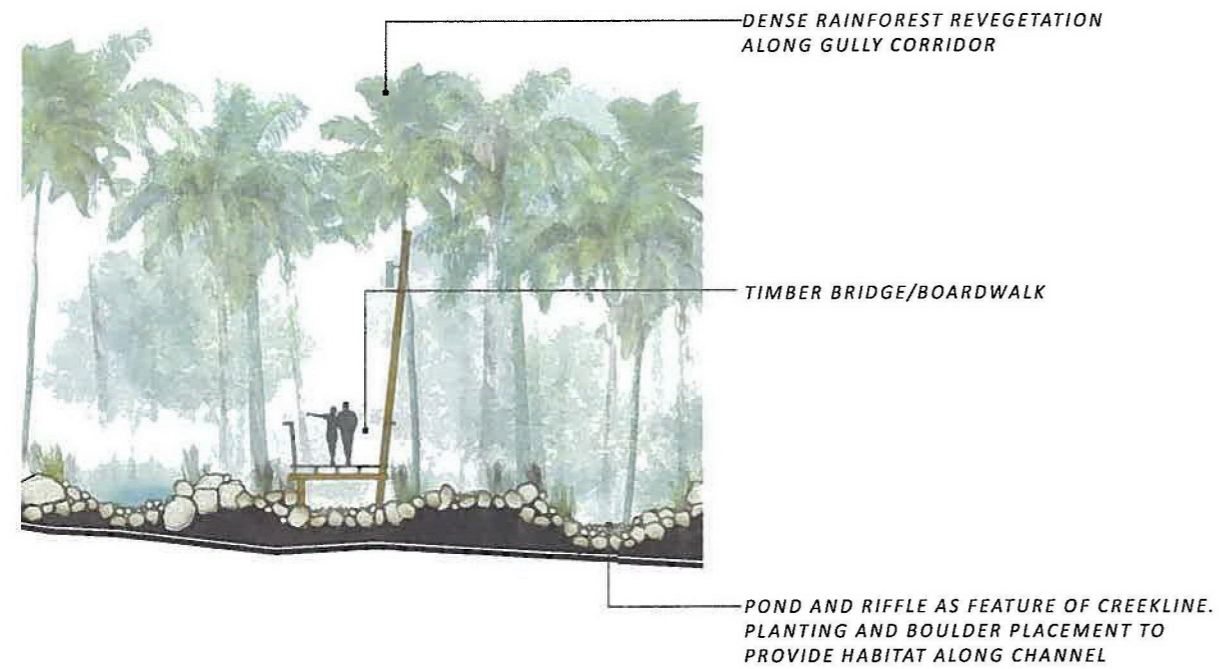

**NSW GOVERNMENT**  
 Planning

Issued under the Environmental Planning and Assessment Act 1979

Approved Application No. M2009.0166

granted on the 30.5.2014

Signed [Signature]

Sheet No. 126 of 136

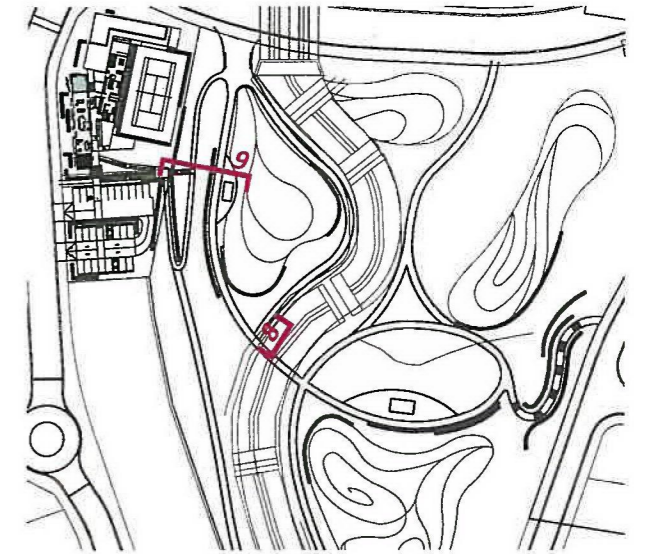

**SECTION 8**

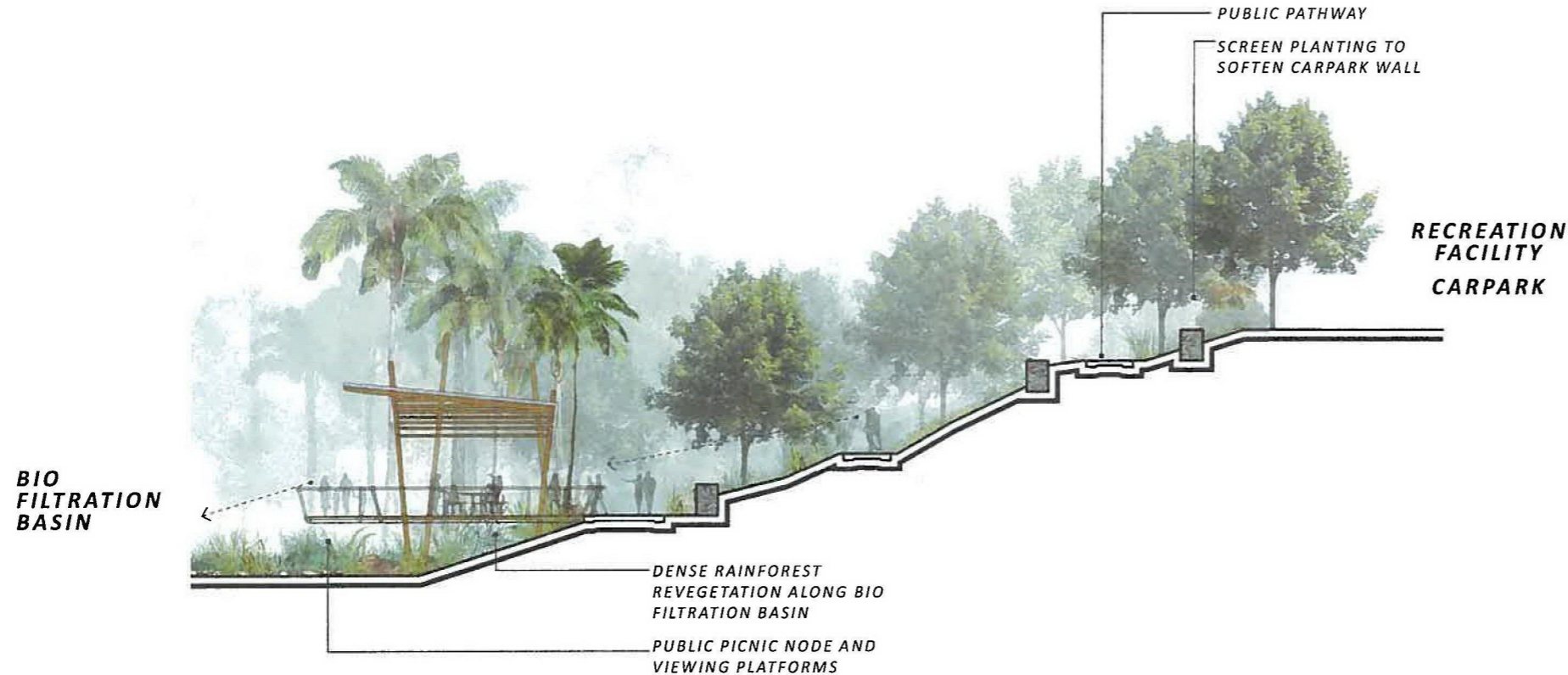

**SECTION 9**

**LANDSCAPE SECTIONS**

100906 | 12 AUG 13 | DA07 | SCALE 1:200 @ A3

PROJECT ALTITUDE ASPIRE | TERRANORA | LANDSCAPE MASTERPLAN | CLIENT NEWLAND DEVELOPERS PTY LTD

**NSW GOVERNMENT**  
 Planning

*Issued under the Environmental Planning and Assessment Act 1979*

Approved Application No... MPO9.0166

granted on the... 30.5.2014

Signed... 

Sheet No... 127 ...of... 136

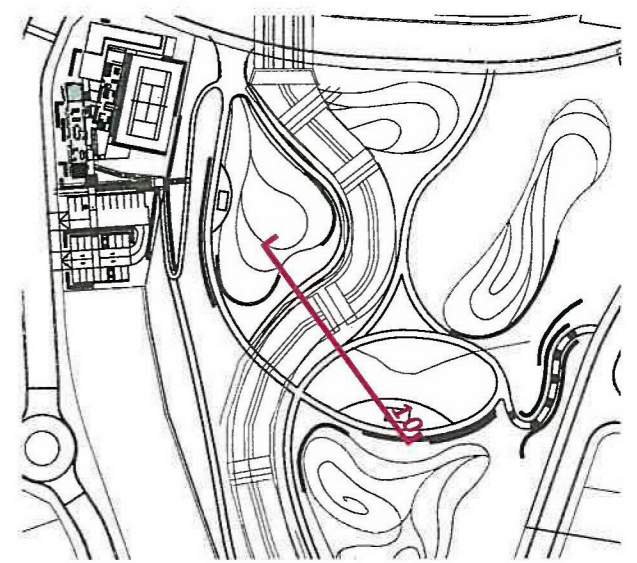

**SECTION 10**

**LANDSCAPE SECTIONS**



NSW GOVERNMENT  
Planning

Issued under the Environmental Planning and Assessment Act 1979

Approved Application No. MPO9-0166

granted on the 30.5.2014

Signed [Signature]

Sheet No. 128 of 136

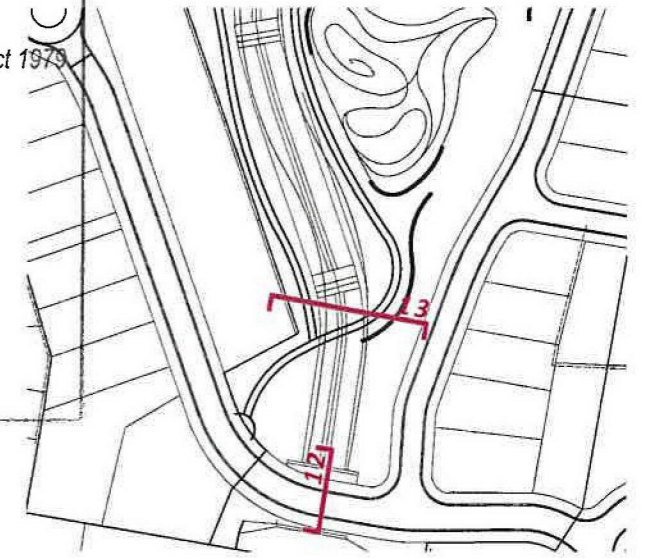

BEBO ARCH BRIDGE WITH STONE  
CLADDING TO CONCRETE STRUCTURAL  
WALLS

FEATURE TRANSITION PAVEMENT TO  
REINFORCE BRIDGE CROSSING

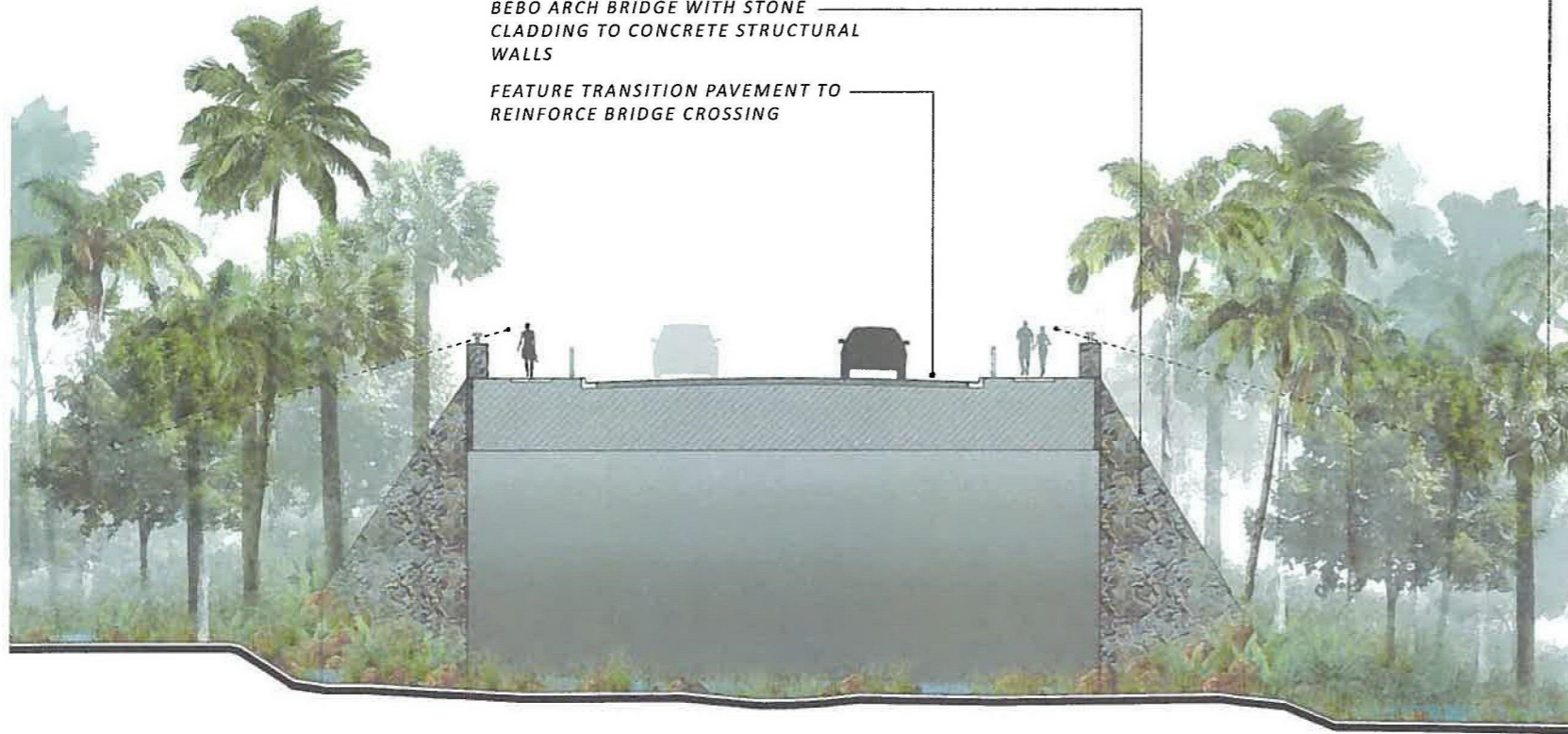

SECTION 12

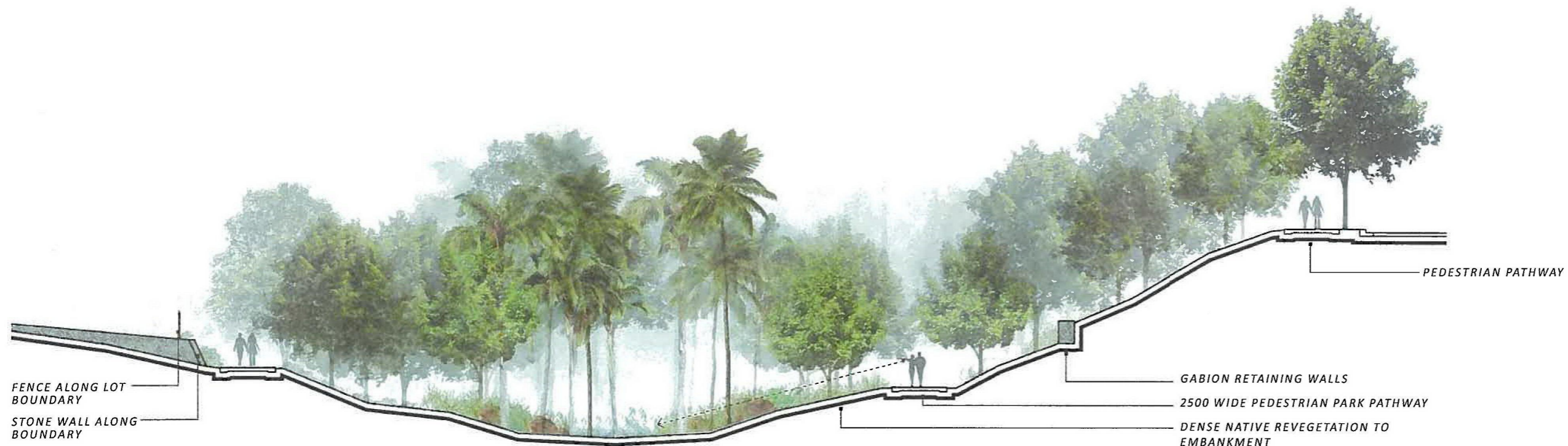

SECTION 13

LANDSCAPE SECTIONS

100906 | 12 AUG 13 | DA07 | SCALE 1:200 @ A3

PROJECT ALTITUDE ASPIRE | TERRANORA | LANDSCAPE MASTERPLAN | CLIENT NEWLAND DEVELOPERS PTY LTD



PERSPECTIVE OF LANDSCAPE BUFFER & SCREENING TO FRASER DRIVE.  
 (SOURCE: TWEED HEADS SHIRE COUNCIL, DCP, 2011)

**NSW GOVERNMENT**  
 Planning  
 Issued under the Environmental Planning and Assessment Act 1979  
 Approved Application No. M2009-0166  
 granted on the 30-5-2014  
 Signed [Signature]  
 Sheet No. 129 of 136

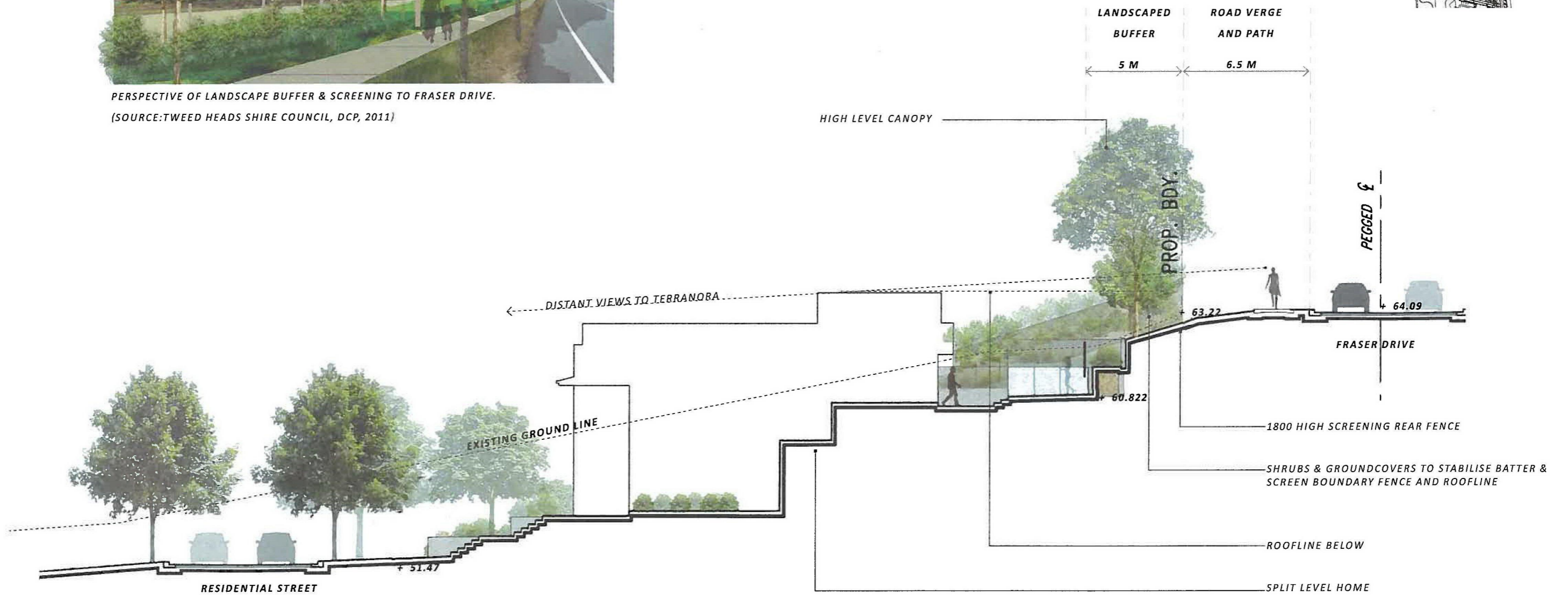
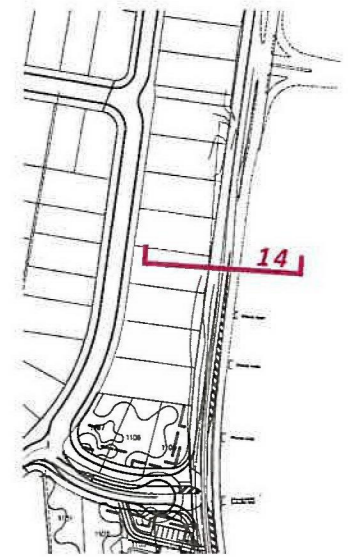

SECTION 14



NSW GOVERNMENT  
Planning

Issued under the Environmental Planning and Assessment Act 1979

Approved Application No. MP09-0166

granted on the 30.5.2014

Signed [Signature]

Sheet No. 130 of 136

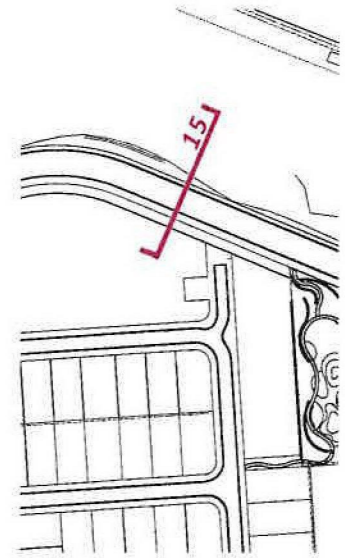
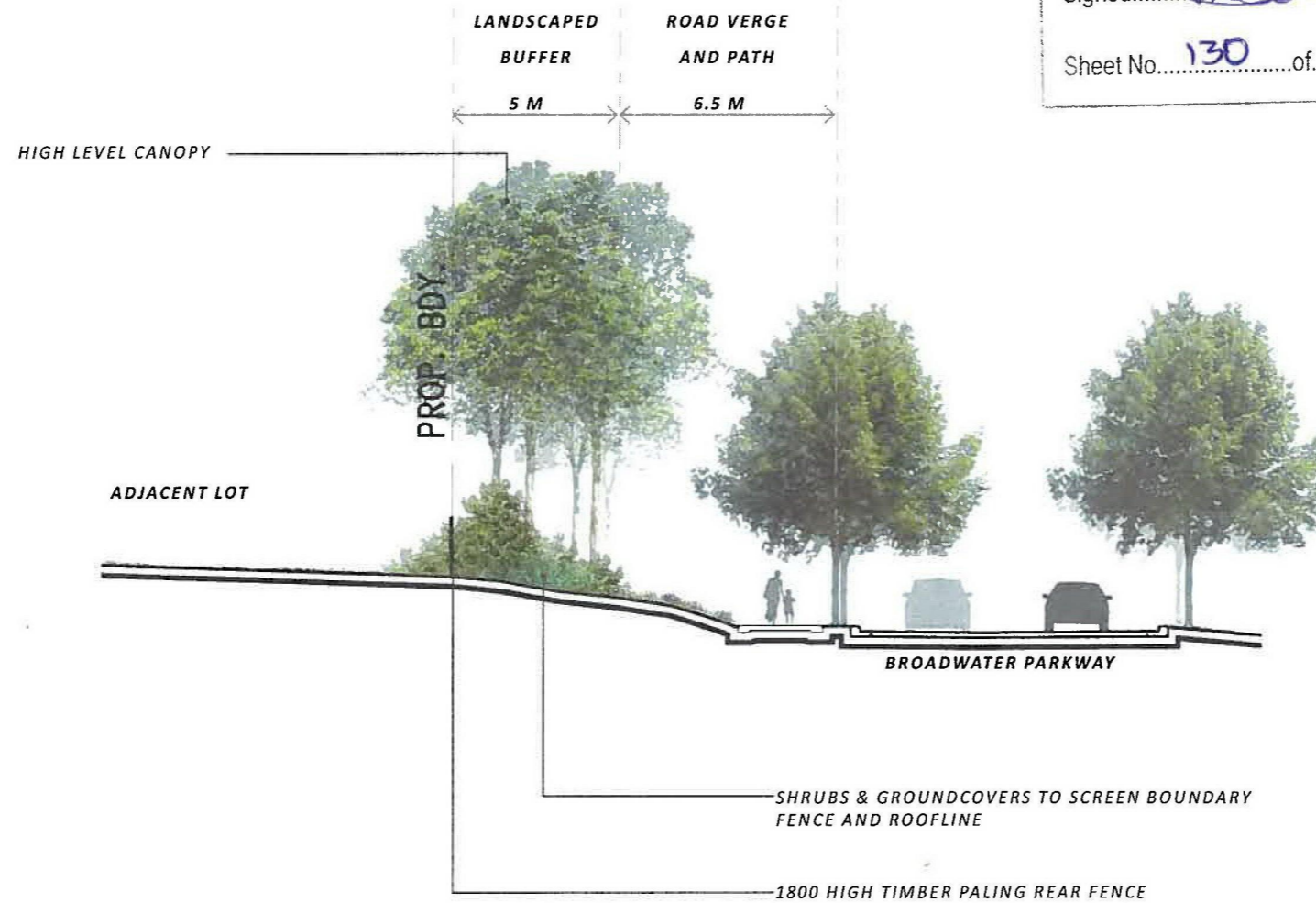

### SECTION 15