

FOR CONTINUATION REFER DWG C111

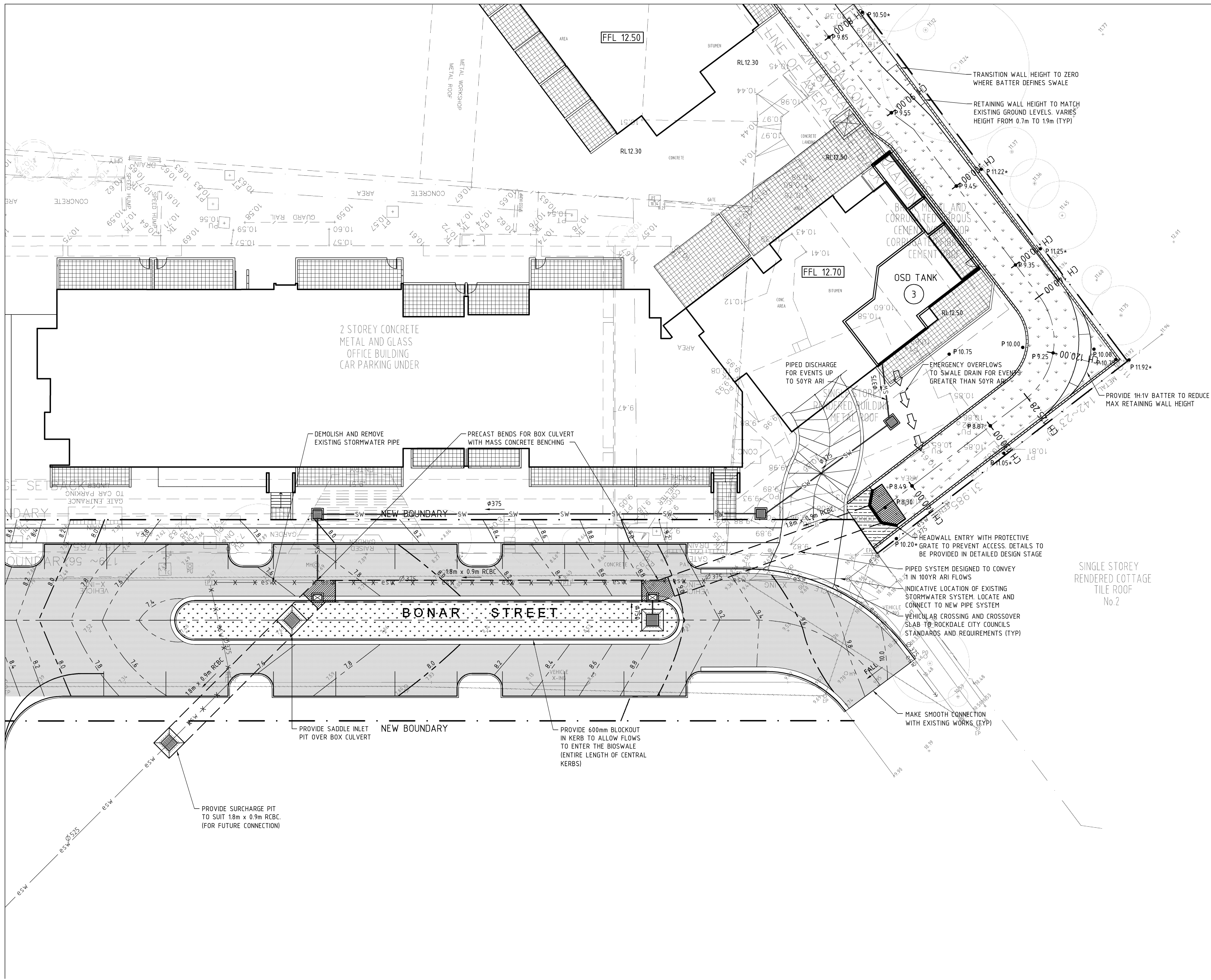

ALL STORMWATER PITS AND PIPES INCLUDING SIZES, ALIGNMENTS, LEVELS, ETC. ARE SUBJECT TO DETAILED DESIGN AND COORDINATION IN CONJUNCTION WITH TWO- DIMENSIONAL FLOODING ANALYSIS AND DRAINS MODELLING.

PRELIMINARY - NOT FOR CONSTRUCTION

300mm A1 SHEET

200mm

100mm

|     |                                      |          |                      |                       |                              |                      |
|-----|--------------------------------------|----------|----------------------|-----------------------|------------------------------|----------------------|
| H   | CONTOURS AMENDED                     | 08.10.09 | DAC                  | DAC                   | X                            | CJA                  |
| G   | BASE PLAN UPDATED - RE-ISSUED FOR DA | 17.09.09 | DAC                  | DAC                   | X                            | CJA                  |
| F   | BASE PLAN UPDATED - RE-ISSUED FOR DA | 14.09.09 | DAC                  | DAC                   | CJA                          | CJA                  |
| E   | ISSUED FOR DA                        | 11.09.09 | DAC                  | CSR                   |                              | CJA                  |
| D   | ISSUED FOR CLIENT REVIEW             | 02.09.09 | AMP                  | CSR                   |                              | CJA                  |
| C   | ISSUED FOR APPROVAL                  | 17.07.09 | AMP                  | CSR                   |                              | CJA                  |
| B   | ISSUED FOR DA                        | 11.03.09 | DAC                  | DAC                   |                              | CJA                  |
| A   | ISSUED FOR CLIENT APPROVAL           | 04.03.09 | DAC                  | DAC                   |                              | GWS                  |
| Rev | Amendment / Reason For Issue         | Date     | Drawing Completed by | Designed & Checked by | Verified by X = Not verified | Issue Authorised (+) |

Copyright  
This drawing remains the property of Hughes Trueman Pty. Ltd. It may only be used for the purpose for which it was commissioned & in accordance with the terms of engagement for that commission. Hughes Trueman denies any liability or responsibility for loss or damage caused by the inappropriate use of this drawing.

\* Drawing Status Warning: Unless there is an authorised Hughes Trueman signature at \*, this drawing is not authorised for issue.

This Drawing may have been prepared using COLOUR, and may be incomplete if copied to BLACK & WHITE

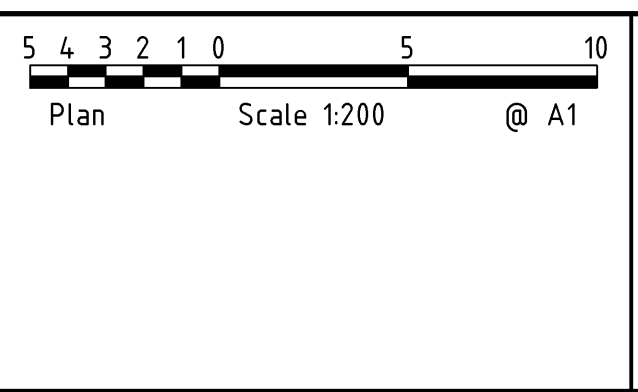

**HughesTrueman**  
Consulting Engineers Planners & Managers

ABN 53 831 529 091  
Level 3, 90 Phillip Street, PO Box 163, PARRAMATTA NSW 2150  
T +61 2 9891 5044 F +61 2 9891 5386 parramatta@hughestrueman.com.au

Project  
**PROPOSED RESIDENTIAL DEVELOPMENT**  
LOFTUS STREET, ARNCLIFFE

Client  
**MERITON APARTMENTS**

Architect/Project Manager  
**MERITON APARTMENTS**

Drawing Title  
**SITWORKS PLAN**  
SHEET 4 OF 4

Drawing No.  
**08P395 - DA-C113**

Rev  
**H**

File Name: P:\Parramatta\13088\08P395\DWG\DA\C111\08P395-DA-C111-131.dwg