



- NOTES:-
1. Medium traffic volume & low speed local council road
2 lane 2 way undivided road
 2. Vehicle ingress/egress of Eastlakes Shopping Centre
 3. Two (2) Lane Traffic access maintained past work in all directions
 4. Traffic control devices use and implemented as part of this TCP must meet AS 3.2.3
 5. Pedestrians access maintained around works as per AS 2.3.7
Safe clearances must be maintained for access from traffic flow
 6. Work area is to be clearly defined with traffic cones, barriers or fencing as per AS 1742.3 Section 2.4
 7. Sequence for erection and removal of signs and devices must follow AS 1742.3 Section 2.5.3
 8. TCP must be implemented by a certified and competent person and follow steps set out in AS 1742.3 Section 2.1
 9. TCP must only be implemented during approved hours of road authority
 10. The site must be inspected before TCP is implemented, during operation and pre-closedown as per AS 1742.3 Section 2.5.5
 11. Duplication of signs may be required as per AS 1742.3 Section 3.5.5
 12. The site must be monitored to avoid end of queue collisions as per AS 1742.3 Section 4.7.8
 13. Any modifications made to this TCP must be noted in box provided

 <p>Roadwork Solutions Pty Ltd 24 Anvil Road Seven Hills 1300 433 093 www.roadworksolutions.com.au</p>	 <p>CHRISTIE CIVIL</p>	<p>EVANS AVE EASTLAKES UBD REF 276 F-2</p>	 <p>NORTH</p>
		<p>Drawn By Ms Belinda Moore RMS PWZTMP # 35254322 14/07/2017 NOT DRAWN TO SCALE</p>	
		<p>VERSION: 001</p>	

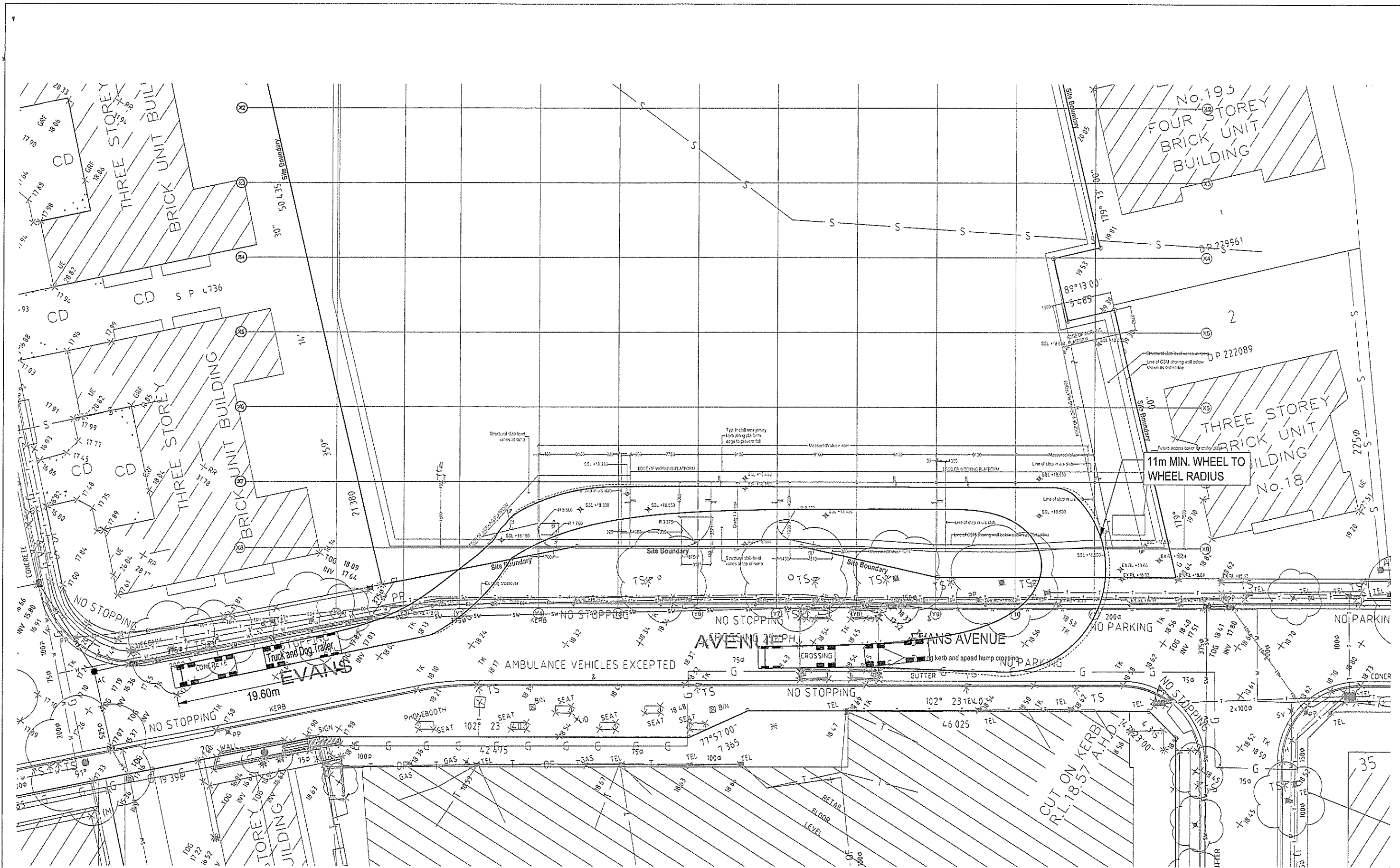

PLAN
SCALE 1:200

NO.	REVISION DESCRIPTION	DATE
A	FOR INFORMATION	07.09.17

SCALE BAR
0 1 2 3 4 5 10m 15 20m
SCALE 1:200

Copyright
THIS DRAWING IS THE PROPERTY OF VAN DER MEER CONSULTING AND IS NOT TO BE REPRODUCED OR USED WITHOUT THE AUTHORITY OF VAN DER MEER CONSULTING.

WARRANTY
THE DRAWING AND ITS CONTENTS ARE ELECTRONICALLY GENERATED AND COPIES SHALL BE USED FOR THE PURPOSE FOR WHICH THEY WERE ENTERED. VAN DER MEER CONSULTING SHALL NOT ACCEPT RESPONSIBILITY FOR ANY CONSEQUENCES ARISING FROM THE USE OF THE DRAWING FOR OTHER THAN THE INTENDED PURPOSE OR WHERE THE DRAWING HAS BEEN ALTERED, AMENDED OR CHANGED EITHER MANUALLY OR ELECTRONICALLY BY ANY THIRD PARTY.

NOTE
THIS IS AN UNCONTROLLED DOCUMENT. INFORMATION FOR INFORMATION PURPOSES ONLY. PLEASE REFER TO THE CONTROLLED DOCUMENT PRECEDENCE OVER SCALED COPY. SCALE REDUCED SIZE DRAWINGS MUST BE CHECKED AGAINST THE ORIGINAL DRAWING PRIOR TO COMMENCING ANY WORKS ON SITE.

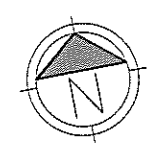

van der Meer Consulting
van der meer
LEVEL 3, 30 CHANDOS STREET
ST LEONARDS NSW 2065
Telephone 61-2-9436 0433 Fax 61-2-9436 1370
www.vandermeer.com.au
van der Meer (NSW) Pty Ltd
A.B.N. 56 158 268 301

CLIENT
CROWN GROUP
LEVEL 29, 1 MARKET STREET
SYDNEY NSW 2000

ARCHITECT
FJMT
LV L 5, 70 KINGS STREET SYDNEY NSW 2000

PROJECT TITLE
EASTLAKES CENTRE - NORTHERN SITE
GARDENERS ROAD
EASTLAKES, NSW 2018

DRAWING TITLE
**CONSTRUCTION PLATFORM
VEHICLE TURNING PATH**

DRAWING STATUS PRELIMINARY NOT TO BE USED FOR CONSTRUCTION			
PROJECT LEADER RJB	DESIGNER NT	SIGNATURE	
DRAWN PERSON NT	SCALE AS SHOWN	DATE OCT 2015	SHEET SIZE A1
JOB NO. SY151-030	DRAWING NO. SK11	REVISION A	