

2 ISOMETRIC
DECEMBER 21 9AM

1:1000

- INDICATES PROPOSED SHADOW
- EXISTING BUILDINGS

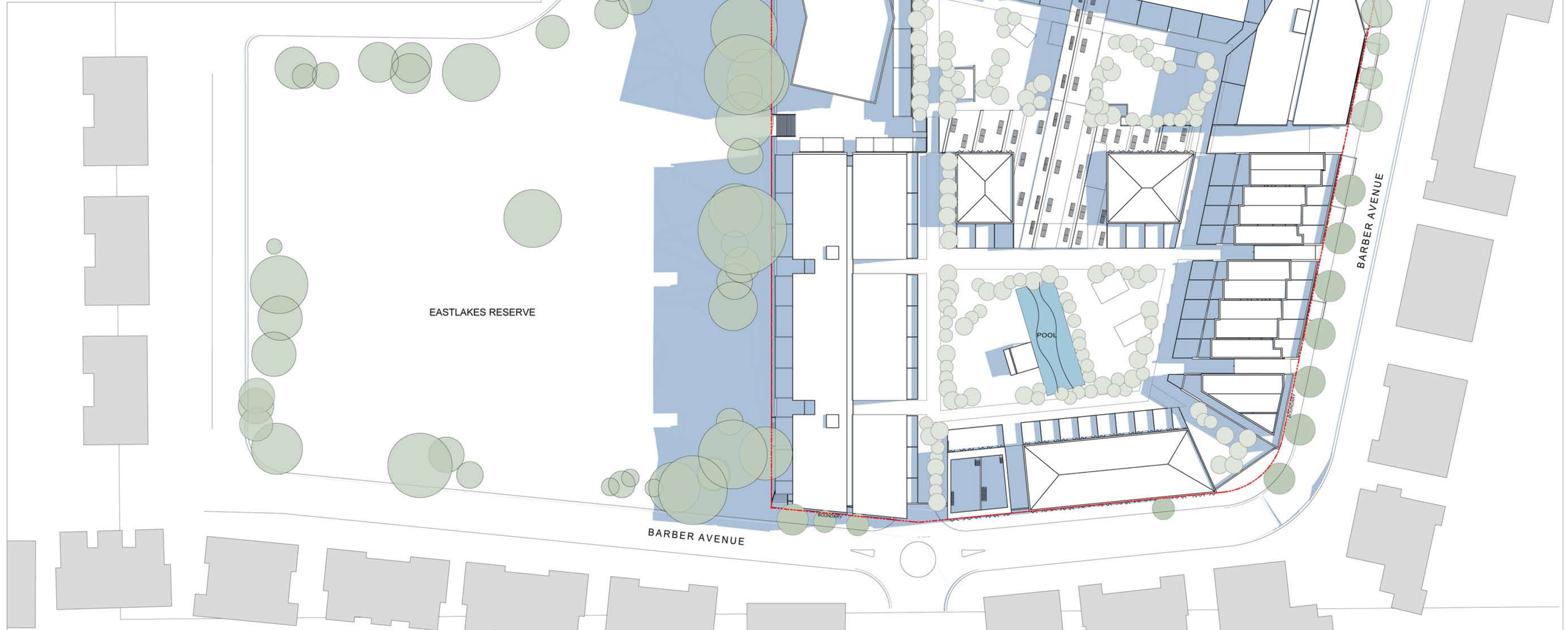

1 ISOMETRIC
DECEMBER 21 9AM

1:500

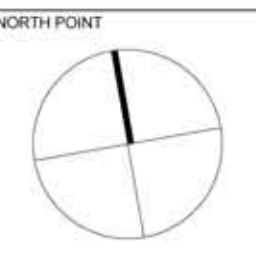

REV	DESCRIPTION OF CHANGE	DRAWN	CHECK	DATE
A	FINAL DRAFT	VZ	RB	17.04.12
B	SA PART SUBMISSION	VZ	RB	20.04.12

CLIENT
CROWN PROSHA JOINT VENTURE

BKK

CROWN
INTERNATIONAL HOLDINGS GROUP

80 ALFRED STREET
MILSONS POINT, NSW 2061
P. 02 9625 0088
eastlakesinfo@crownprosha.com.au

ARCHITECTS
RICE DAUBNEY
ANALYSING CREATING AND IMPLEMENTING ARCHITECTURE

110 WALKER STREET | NORTH SYDNEY 2060
T: 02 9556 2866 | F: 02 9559 3015
RD@ricedaubney.com.au | www.ricedaubney.com.au
the rice daubney group (inc) Pty Ltd. abn: 72 207 305 789
rice daubney trading trust - abn: 58 880 354 983

PROJECT:
**EASTLAKES TOWN CENTRE
SYDNEY, NSW, 2018**

DRAWING TITLE:
**SHADOW DIAGRAM
DECEMBER 21 - 9.00AM**

SCALE:	CHECKED:
1:500 @ A1	RB
PROJECT NUMBER:	ISSUE:
11001	B