

D	STW Modification B	05/2013
C	Section 75W Submission	11/2012
B	EA Submission	15/12/09
A	submitted for Test of Adequacy	09/11/09

Do not scale from drawings. Verify all dimensions on site before commencing work. Copying or the reproduction of this drawing is strictly prohibited without the consent of PTW Architects PL

Client
Merton Group
 Level 11 Merton Tower,
 528 Kent St,
 Sydney NSW 2000

Architect
PTW Architects
 Level 13, 9 Castlereagh St,
 Sydney NSW Australia 2000
 T 612 9232 5877
 F 612 9221 4139
 www.ptw.com.au

Contractor

Consultants	-
Planner	-
Structural	-
Services	-
Landscapes	-
Acoustics	-
Traffic	-

MERTON THOMAS STREET
 Thomas Street/ Albert Avenue
 Chatswood NSW 2067

Project No. 212007
 Scale: 1:200@A1:1:400@A3
 Date: 10/9/2009
 Drawn: DH
 Checked: SP
 Approved: SP

LEVEL 3 PLAN
 CAR PARKING
A-0103
D
 SECTION 75 W MODIFICATION 6

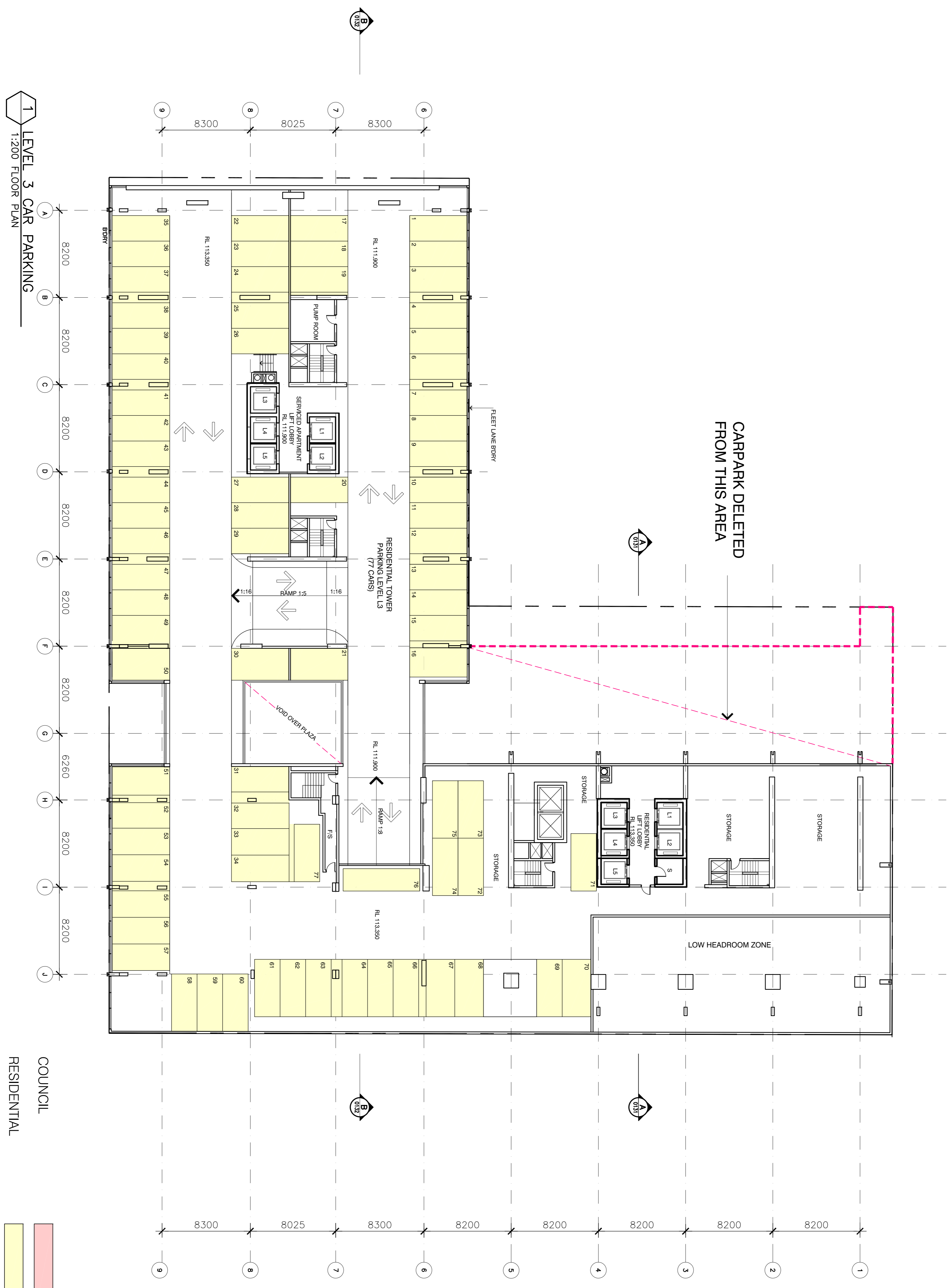

1 LEVEL 3 CAR PARKING
 1:200 FLOOR PLAN

- COUNCIL
- RESIDENTIAL
- CHILD CARE
- SERVICED APARTMENTS

