

H Section 75W Submission	19.06.2014
G Revised Modification 6	2.12.2013
F S75W Modification 6	05.2013
E Section 75W Submission	11.2012
D CC Submission, Council comments inundated	11.07.2012
C Construction Certificate Submission	2.07.2012
B ISSUE FOR CC	12.06.2012

Do not scale from drawings. Verify all dimensions on site before commencing work. Copying or the reproduction of this drawing is strictly prohibited without the consent of PTW Architects P/L.

Client
Meriton Group
 Level 11 Meriton Tower,
 528 Kent St,
 Sydney NSW 2000

Architect
PTW Architects
 Level 13, 9 Castlereagh St
 Sydney NSW Australia 2000
 T 612 9232 5877
 F 612 9221 4139
 www.ptw.com.au

Contractor

Consultants
 Planner -
 Structural -
 Services -
 Landscape -
 Acoustics -
 Traffic -

MERITON THOMAS STREET
 Thomas Street/ Albert Avenue
 Chatswood NSW 2067

Project No. 212007
 Scale: 1:200@A1;1:400@A3
 Date: APRIL 2012
 Drawn: EA/RB
 Checked: EA
 Approved: SP

BASEMENT 2 PLAN

A-0116 H
 SECTION 75W SUBMISSION

LEGEND

- 17 DECREASE CAR SPACES NUMBER
- 19 INCREASE CAR SPACES NUMBER
- 38 STAIR ADD TO COMPLY WITH BCA
- 40 NEW LIFT / STAIR RELOCATE
- 41 NEW PLANT ROOM
- 44 RELOCATE STAIR
- 45 NEW STORAGE

LEGEND

- E/A - EXHAUST AIR RISER
- S/A - SUPPLY AIR
- S/P - STAIR PRESSURISATION
- F/S - FIRE STAIR
- L1 - LIFT 1
- PL1 - COUNCIL LIFT
- PS - COUNCIL STAIR
- E - ELECTRICAL

- COUNCIL
- RESIDENTIAL
- CHILD CARE
- SERVICED APARTMENTS

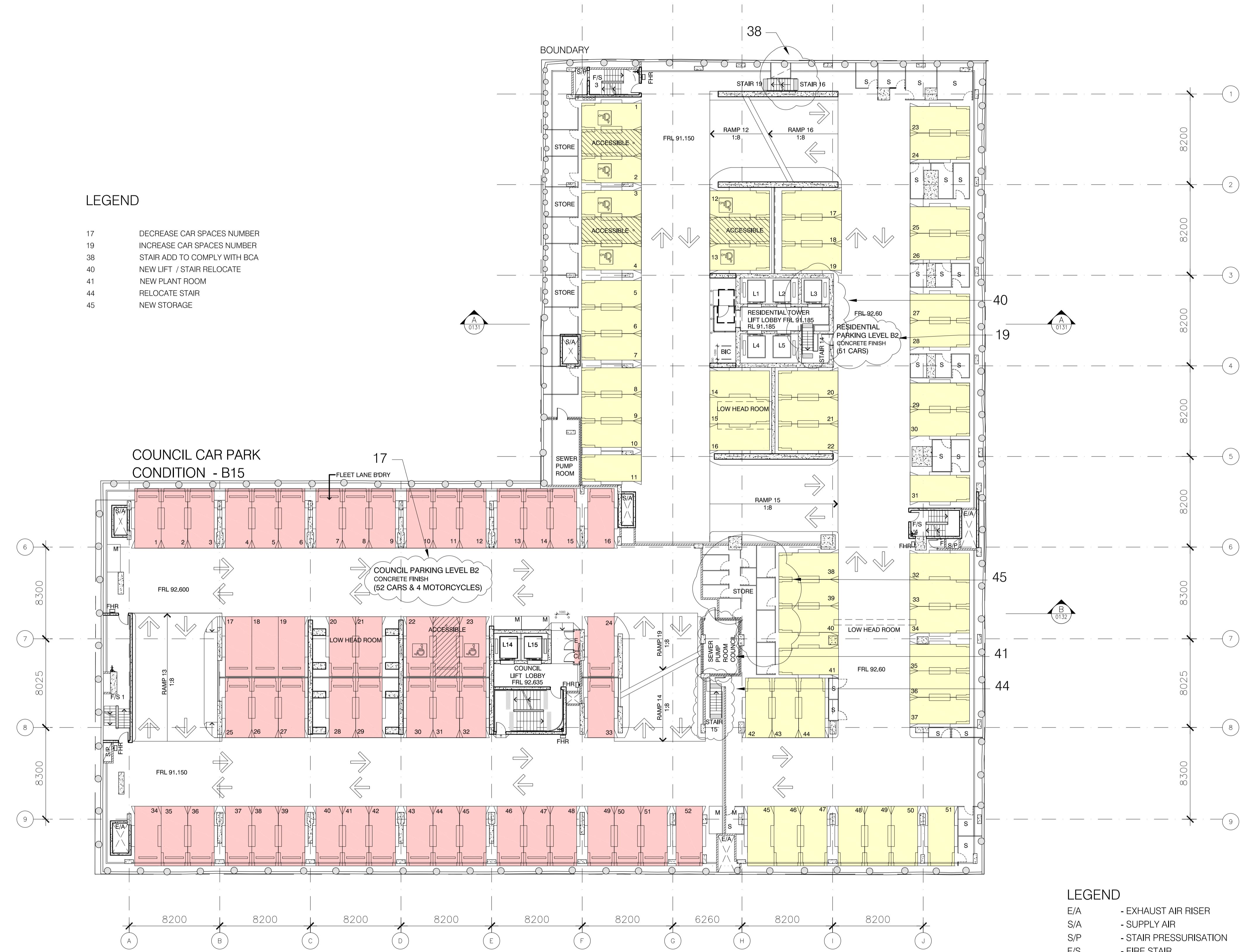

1 BASEMENT 2 PLAN
 1:200