

PLAN
OF PROPOSED SUBDIVISION OF LOTS 28 & 29
D.P.881417 & LOT 10 D.P.846558 AND
CONSOLIDATION OF LOT 22 D.P.867249
& LOTS 24-27 INCL. D.P.881417
VICTORIA STREET, DARLINGHURST
CITY OF SYDNEY

1:500

BASEMENTS

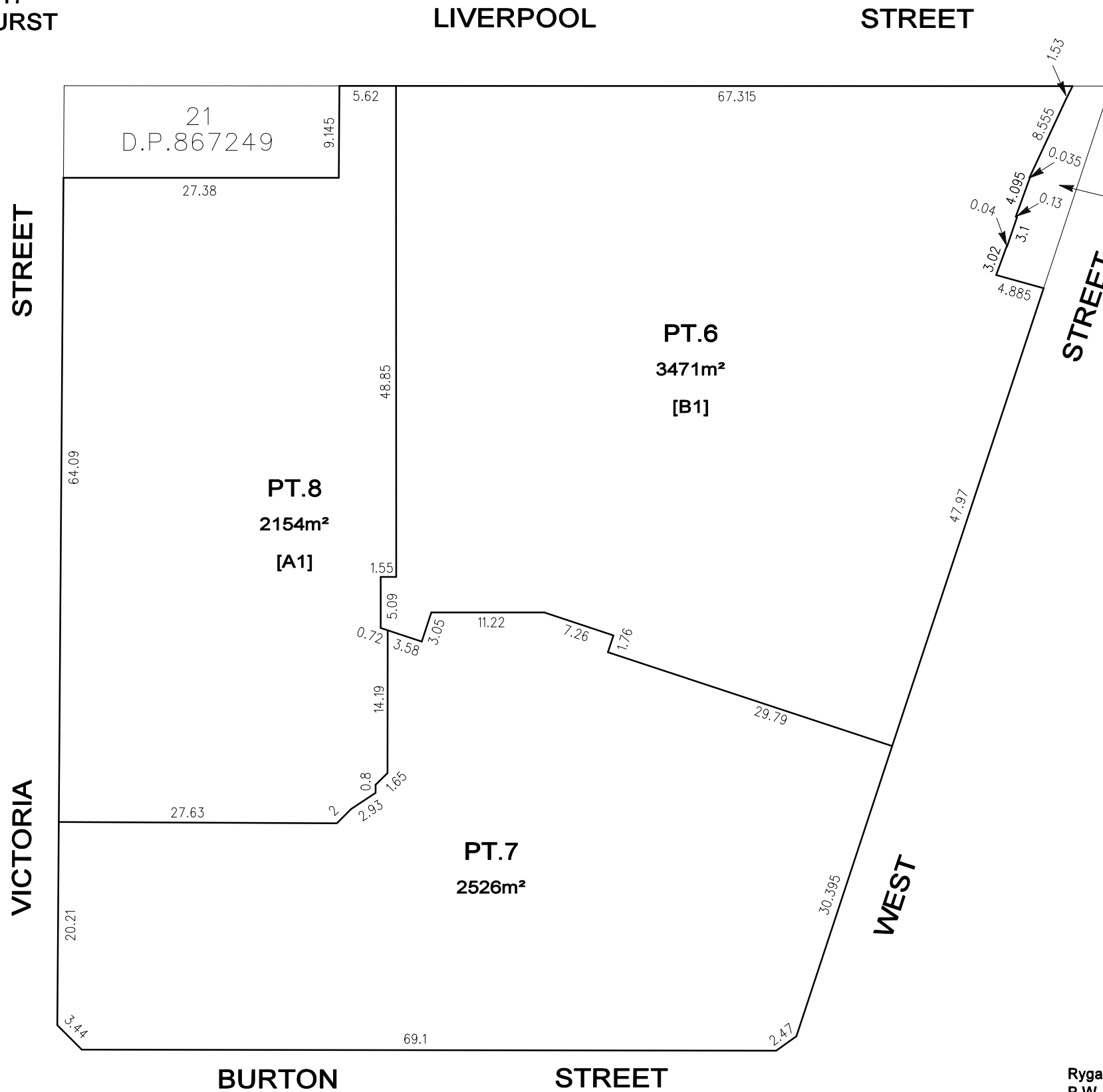

No.520
 Bk.3286

STRATUM STATEMENTS
 [A1] PT.8 INCLUDES BASEMENTS
 [B1] PT.6 INCLUDES BASEMENT

NOTE :
 DIMENSIONS AND AREAS SHOWN HEREON
 ARE SUBJECT TO SURVEY



PLAN
OF PROPOSED SUBDIVISION OF LOTS 28 & 29
D.P.881417 & LOT 10 D.P.846558 AND
CONSOLIDATION OF LOT 22 D.P.867249
& LOTS 24-27 INCL. D.P.881417
VICTORIA STREET, DARLINGHURST
CITY OF SYDNEY

1:500
LEVEL 1

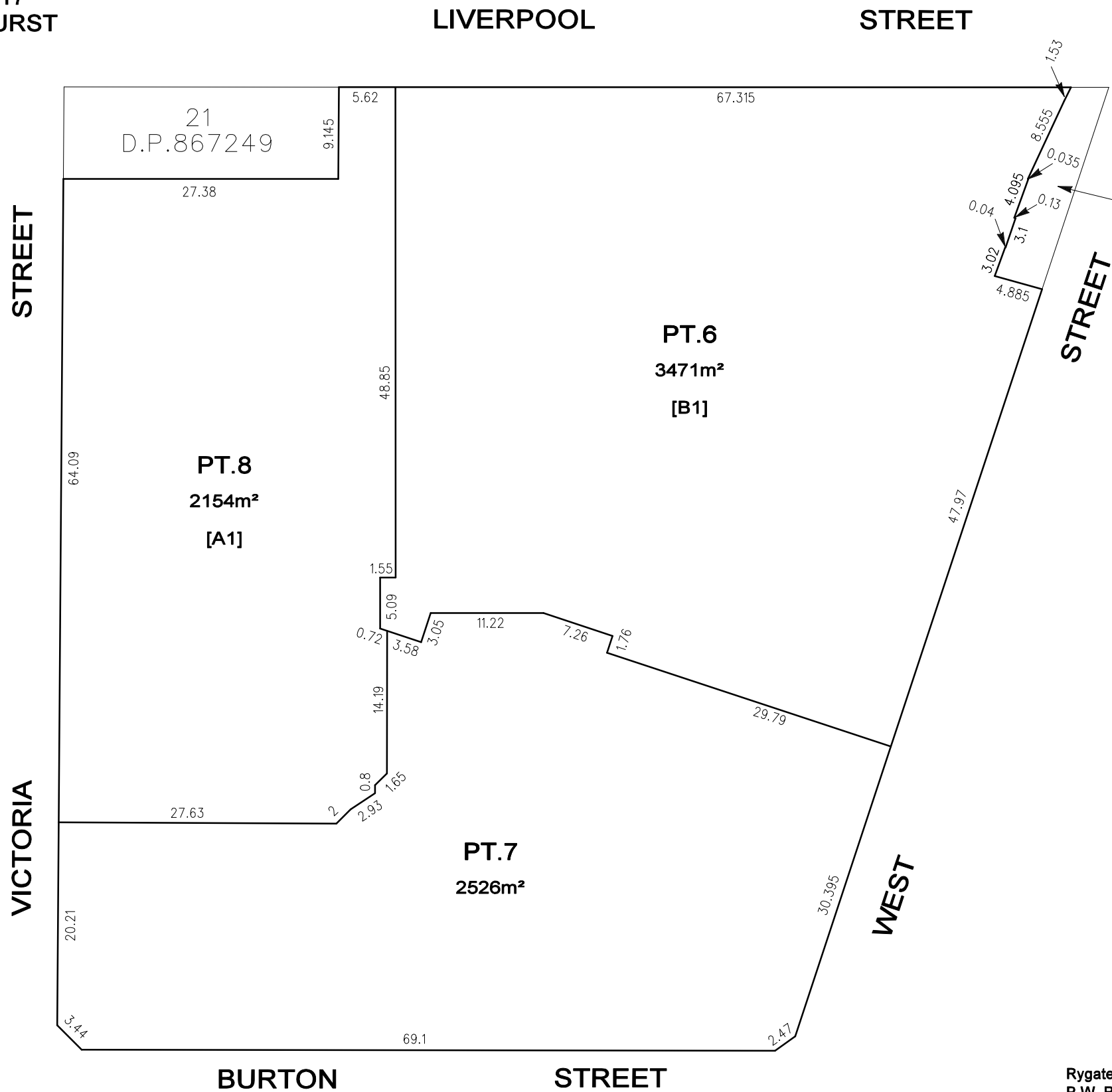

No.520
 Bk.3286

STRATUM STATEMENTS
 [A1] PT.8 INCLUDES LEVEL 1
 [B1] PT.5 INCLUDES LEVEL 1

NOTE :
 DIMENSIONS AND AREAS SHOWN HEREON
 ARE SUBJECT TO SURVEY



PLAN
OF PROPOSED SUBDIVISION OF LOTS 28 & 29
D.P.881417 & LOT 10 D.P.846558 AND
CONSOLIDATION OF LOT 22 D.P.867249
& LOTS 24-27 INCL. D.P.881417
VICTORIA STREET, DARLINGHURST
CITY OF SYDNEY

1:500

LEVEL 3

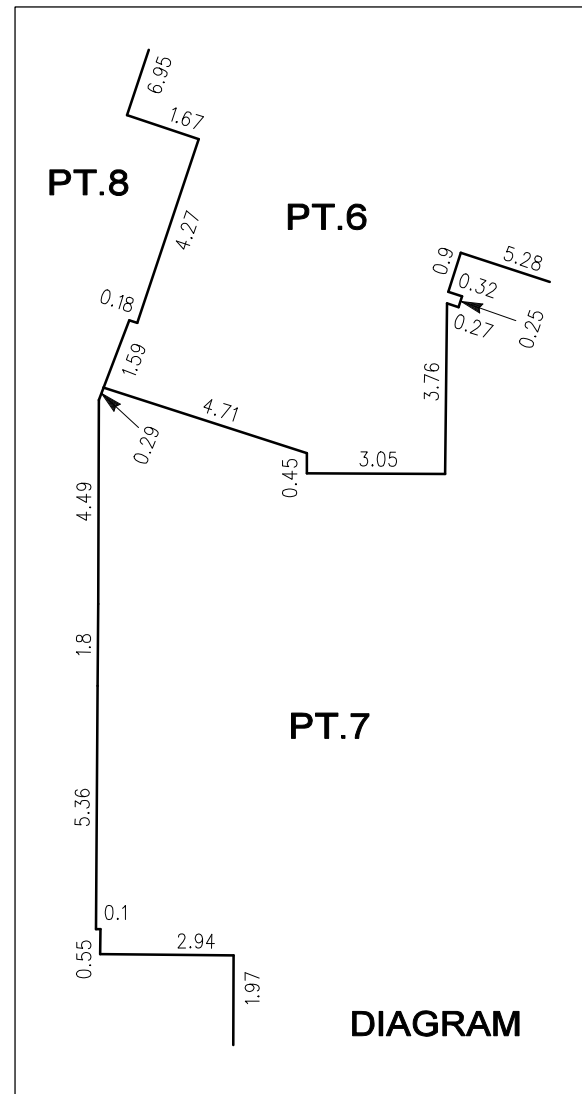

NOTE :
 DIMENSIONS AND AREAS SHOWN HEREON
 ARE SUBJECT TO SURVEY

EACH LOT ABOVE LEVEL 3 IS AFFECTED BY RESTRICTION
 ON USE OF LAND AS REGARDS FIRE SAFETY AND RELIEF
 AIR DISCHARGE

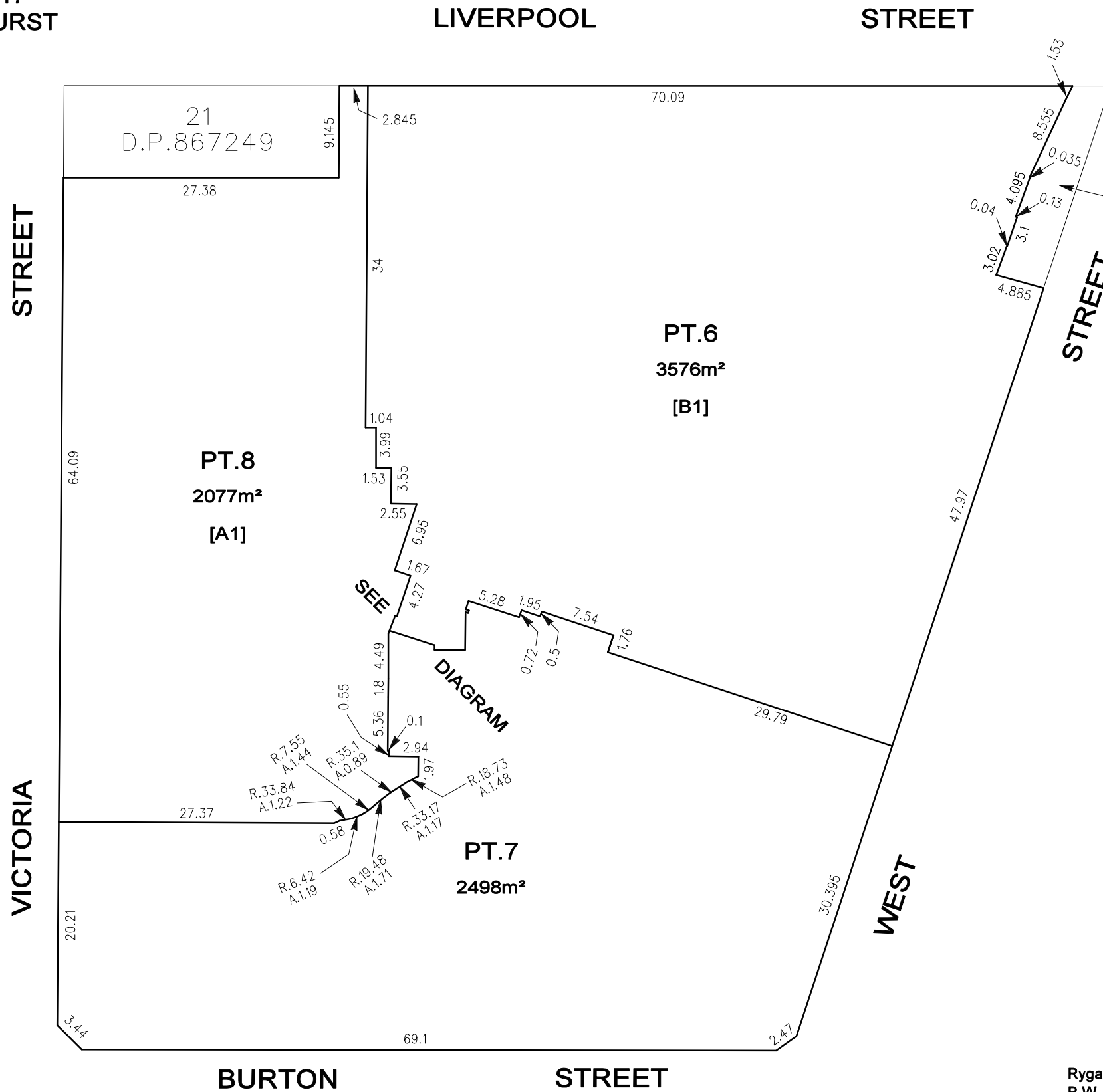

No.520
 Bk.3286

STRATUM STATEMENTS
 [A1] PT.8 INCLUDES LEVEL 3
 [B1] PT.5 INCLUDES LEVEL 3



PLAN
OF PROPOSED SUBDIVISION OF LOTS 28 & 29
D.P.881417 & LOT 10 D.P.846558 AND
CONSOLIDATION OF LOT 22 D.P.867249
& LOTS 24-27 INCL. D.P.881417
VICTORIA STREET, DARLINGHURST
CITY OF SYDNEY

1:500
LEVEL 4

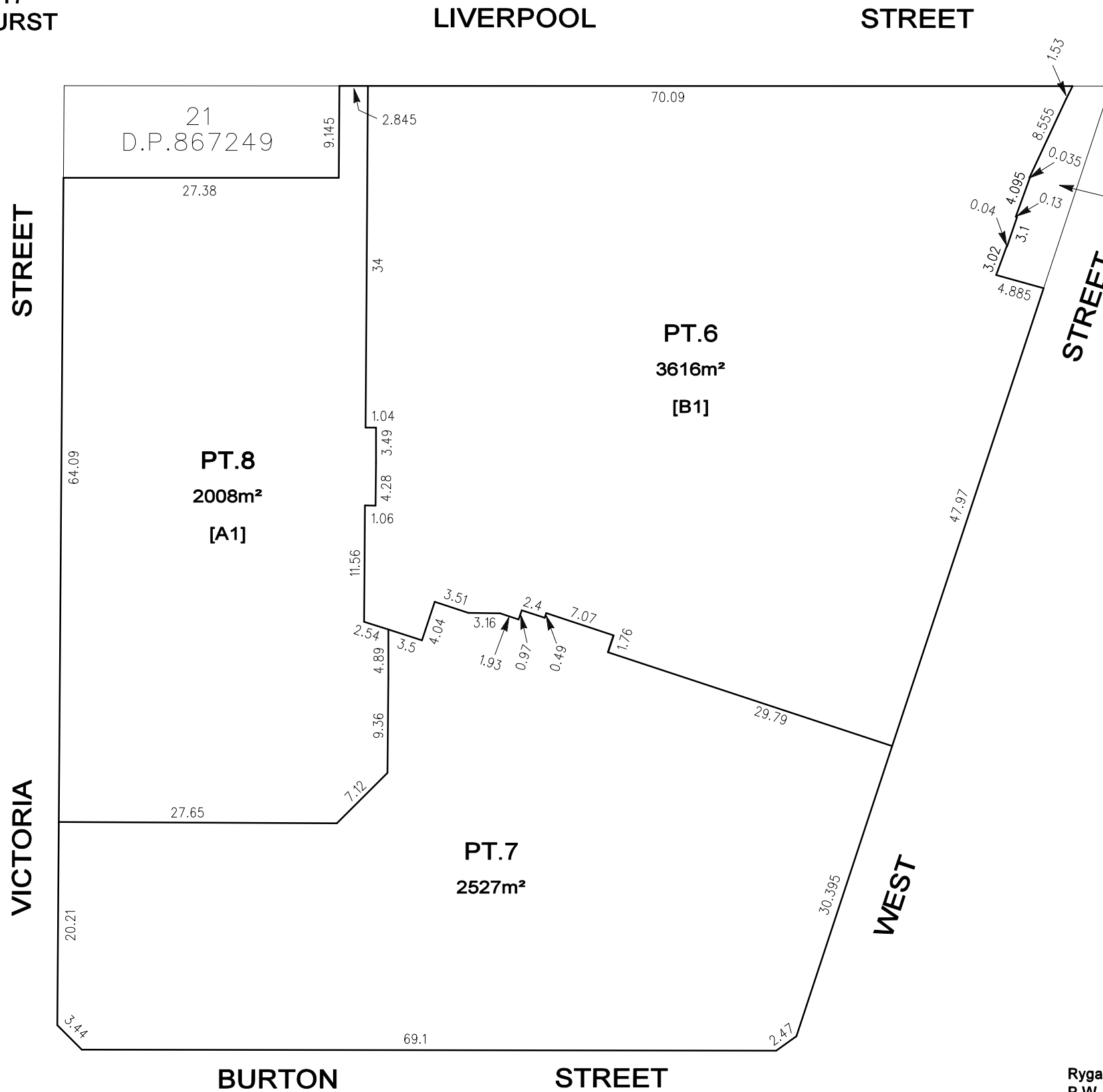

No.520
 Bk.3286

STRATUM STATEMENTS
 [A1] PT.8 INCLUDES LEVEL 4
 [B1] PT.5 INCLUDES LEVEL 4

NOTE :
 DIMENSIONS AND AREAS SHOWN HEREON
 ARE SUBJECT TO SURVEY



PLAN
OF PROPOSED SUBDIVISION OF LOTS 28 & 29
D.P.881417 & LOT 10 D.P.846558 AND
CONSOLIDATION OF LOT 22 D.P.867249
& LOTS 24-27 INCL. D.P.881417
VICTORIA STREET, DARLINGHURST
CITY OF SYDNEY

1:500
LEVEL 5

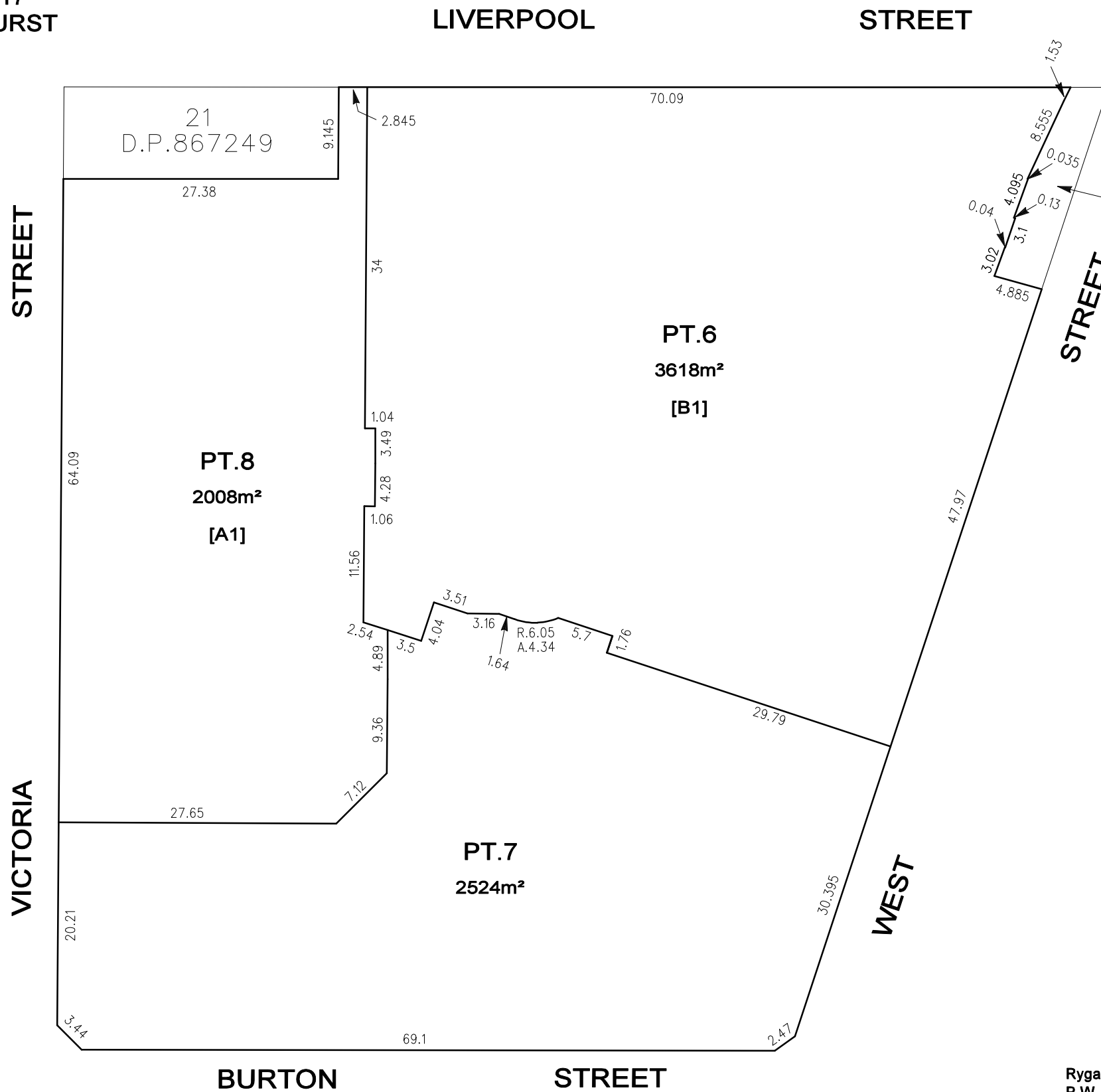

No.520
 Bk.3286

STRATUM STATEMENTS
 [A1] PT.8 INCLUDES LEVEL 5
 [B1] PT.5 INCLUDES LEVEL 5

NOTE :
 DIMENSIONS AND AREAS SHOWN HEREON
 ARE SUBJECT TO SURVEY



PLAN
OF PROPOSED SUBDIVISION OF LOTS 28 & 29
D.P.881417 & LOT 10 D.P.846558 AND
CONSOLIDATION OF LOT 22 D.P.867249
& LOTS 24-27 INCL. D.P.881417
VICTORIA STREET, DARLINGHURST
CITY OF SYDNEY

1:500
LEVEL 6

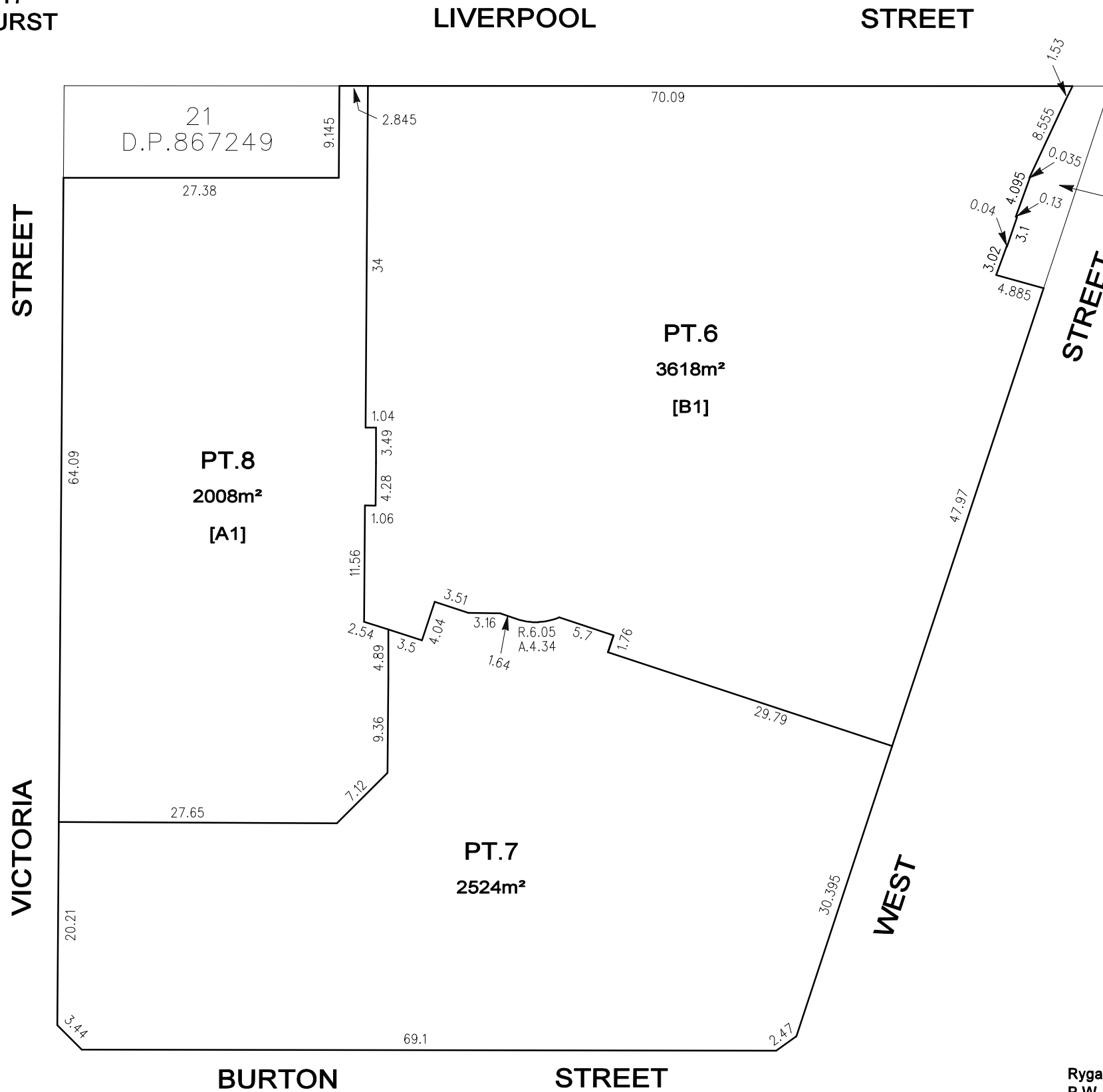

STRATUM STATEMENTS
[A1] PT.8 INCLUDES LEVEL 6
[B1] PT.5 INCLUDES LEVEL 6

NOTE :
 DIMENSIONS AND AREAS SHOWN HEREON
 ARE SUBJECT TO SURVEY

Rygate & Company Pty Limited
 P.W. Rygate & West
 ABN 61 001 204 897



a Level 9, 89 York St, Sydney NSW 2000
p +61 2 9262 6800 **f** +61 2 9262 6843
e surveyors@rygate.com.au
w rygate.com.au

REF: 74606 DATE: 8/6/2012

PLAN
OF PROPOSED SUBDIVISION OF LOTS 28 & 29
D.P.881417 & LOT 10 D.P.846558 AND
CONSOLIDATION OF LOT 22 D.P.867249
& LOTS 24-27 INCL. D.P.881417
VICTORIA STREET, DARLINGHURST
CITY OF SYDNEY

1:500
LEVEL 7

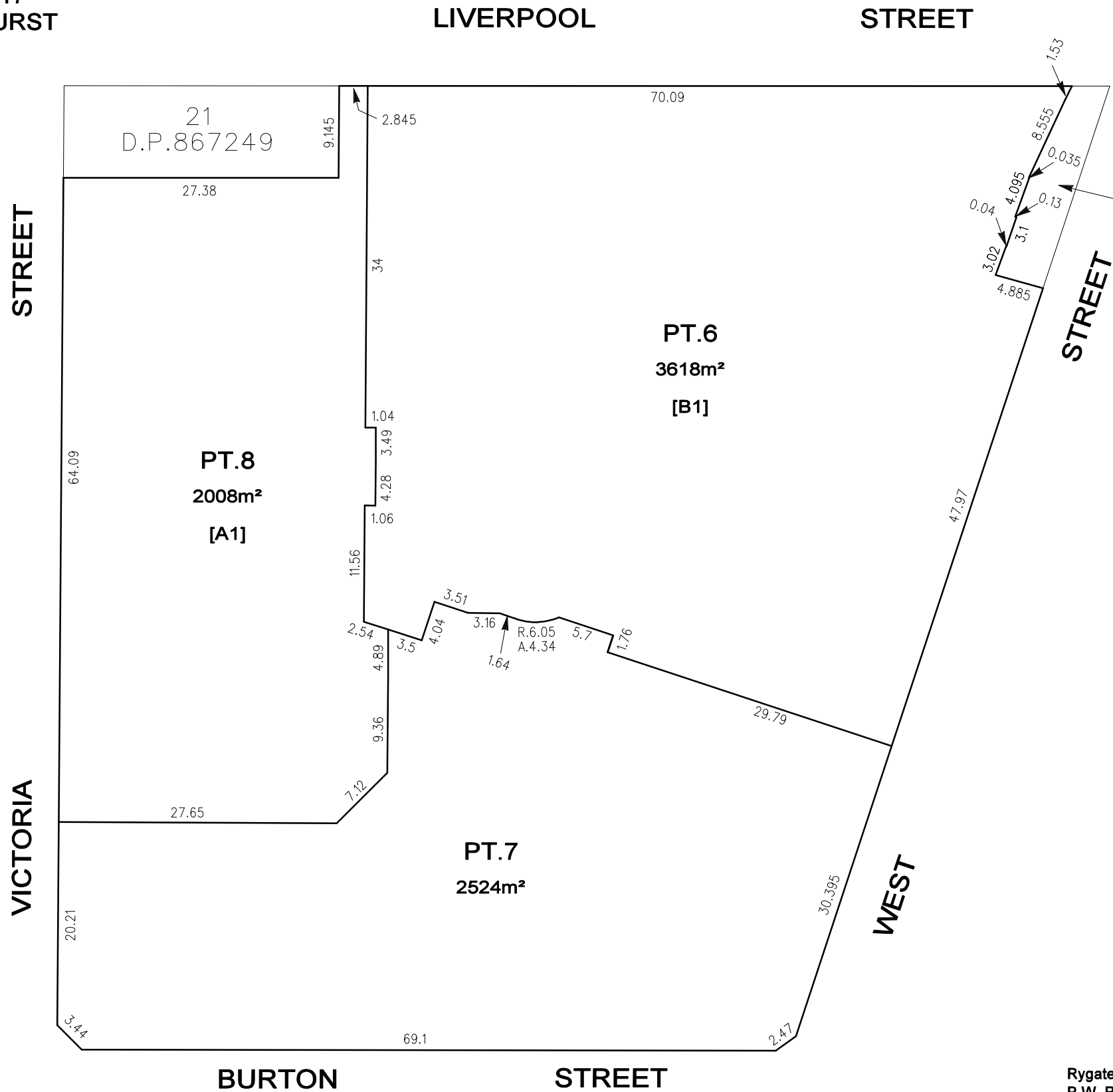

STRATUM STATEMENTS
[A1] PT.8 INCLUDES LEVEL 7
[B1] PT.5 INCLUDES LEVEL 7

NOTE :
 DIMENSIONS AND AREAS SHOWN HEREON
 ARE SUBJECT TO SURVEY

Rygate & Company Pty Limited
 P.W. Rygate & West
 ABN 61 001 204 897



a Level 9, 89 York St, Sydney NSW 2000
p +61 2 9262 6800 **f** +61 2 9262 6843
e surveyors@rygate.com.au
w rygate.com.au

REF: 74606 DATE: 8/6/2012

PLAN
OF PROPOSED SUBDIVISION OF LOTS 28 & 29
D.P.881417 & LOT 10 D.P.846558 AND
CONSOLIDATION OF LOT 22 D.P.867249
& LOTS 24-27 INCL. D.P.881417
VICTORIA STREET, DARLINGHURST
CITY OF SYDNEY

1:500
LEVEL 8

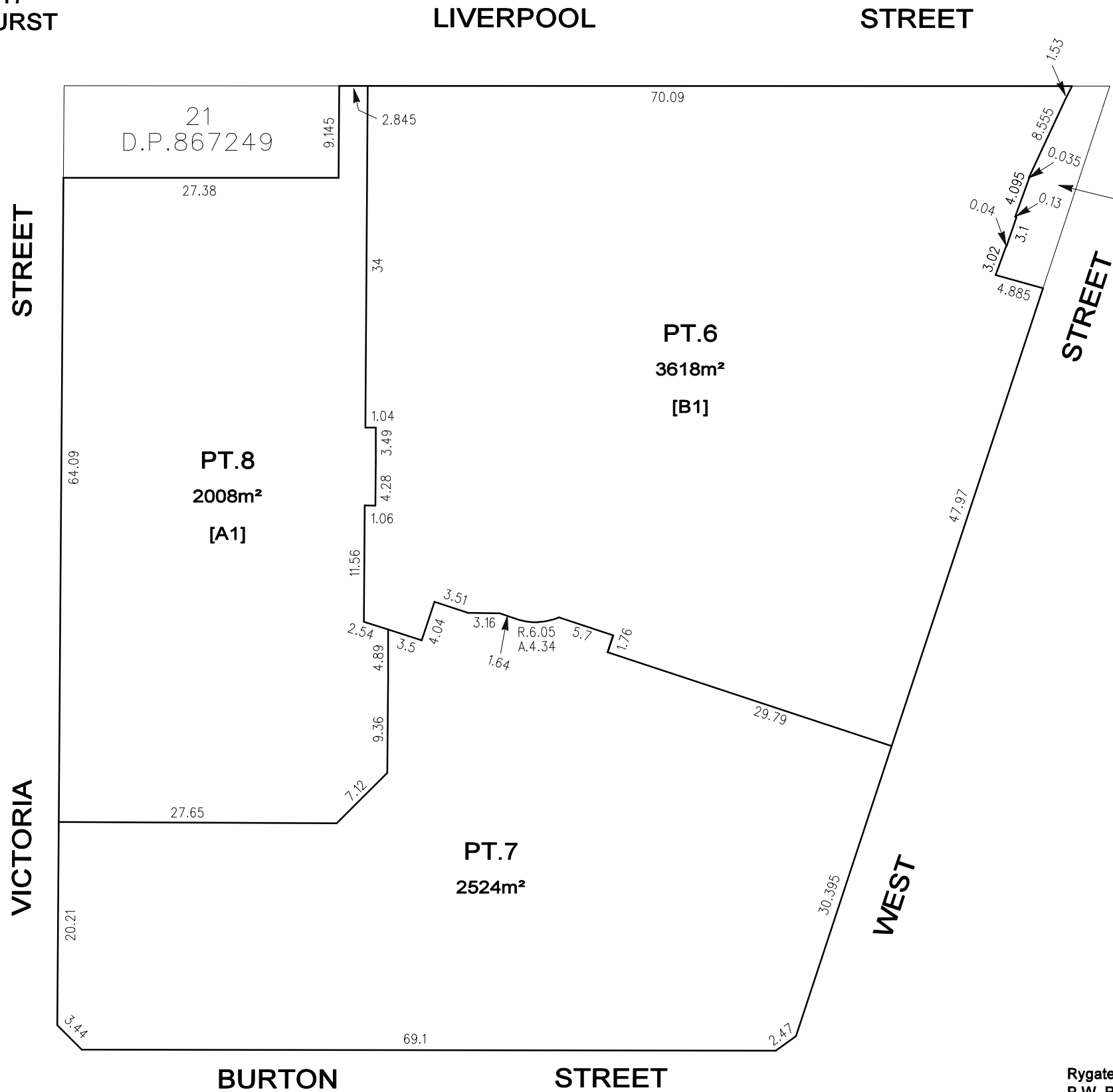

STRATUM STATEMENTS
[A1] PT.8 INCLUDES LEVEL 8
[B1] PT.5 INCLUDES LEVEL 8

NOTE :
 DIMENSIONS AND AREAS SHOWN HEREON
 ARE SUBJECT TO SURVEY

Rygate & Company Pty Limited
 P.W. Rygate & West
 ABN 61 001 204 897



a Level 9, 89 York St, Sydney NSW 2000
p +61 2 9262 6800 **f** +61 2 9262 6843
e surveyors@rygate.com.au
w rygate.com.au

REF: 74606 DATE: 8/6/2012

PLAN
OF PROPOSED SUBDIVISION OF LOTS 28 & 29
D.P.881417 & LOT 10 D.P.846558 AND
CONSOLIDATION OF LOT 22 D.P.867249
& LOTS 24-27 INCL. D.P.881417
VICTORIA STREET, DARLINGHURST
CITY OF SYDNEY

1:500
LEVEL 9

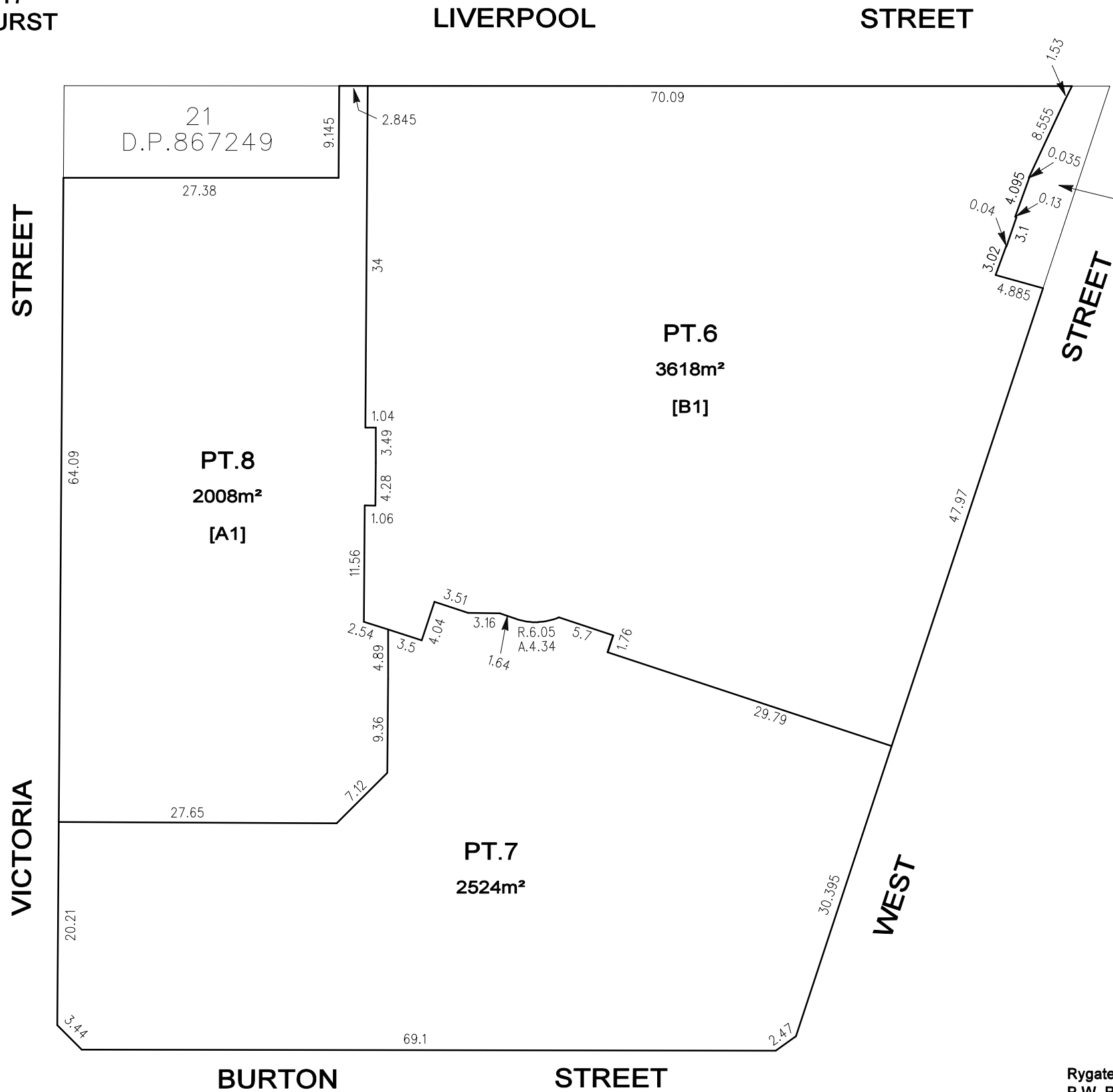

STRATUM STATEMENTS
[A1] PT.8 INCLUDES LEVEL 9
[B1] PT.5 INCLUDES LEVEL 9

NOTE :
 DIMENSIONS AND AREAS SHOWN HEREON
 ARE SUBJECT TO SURVEY

Rygate & Company Pty Limited
 P.W. Rygate & West
 ABN 61 001 204 897



a Level 9, 89 York St, Sydney NSW 2000
p +61 2 9262 6800 **f** +61 2 9262 6843
e surveyors@rygate.com.au
w rygate.com.au

REF: 74606 DATE: 8/6/2012

PLAN
OF PROPOSED SUBDIVISION OF LOTS 28 & 29
D.P.881417 & LOT 10 D.P.846558 AND
CONSOLIDATION OF LOT 22 D.P.867249
& LOTS 24-27 INCL. D.P.881417
VICTORIA STREET, DARLINGHURST
CITY OF SYDNEY

1:500

LEVEL 10

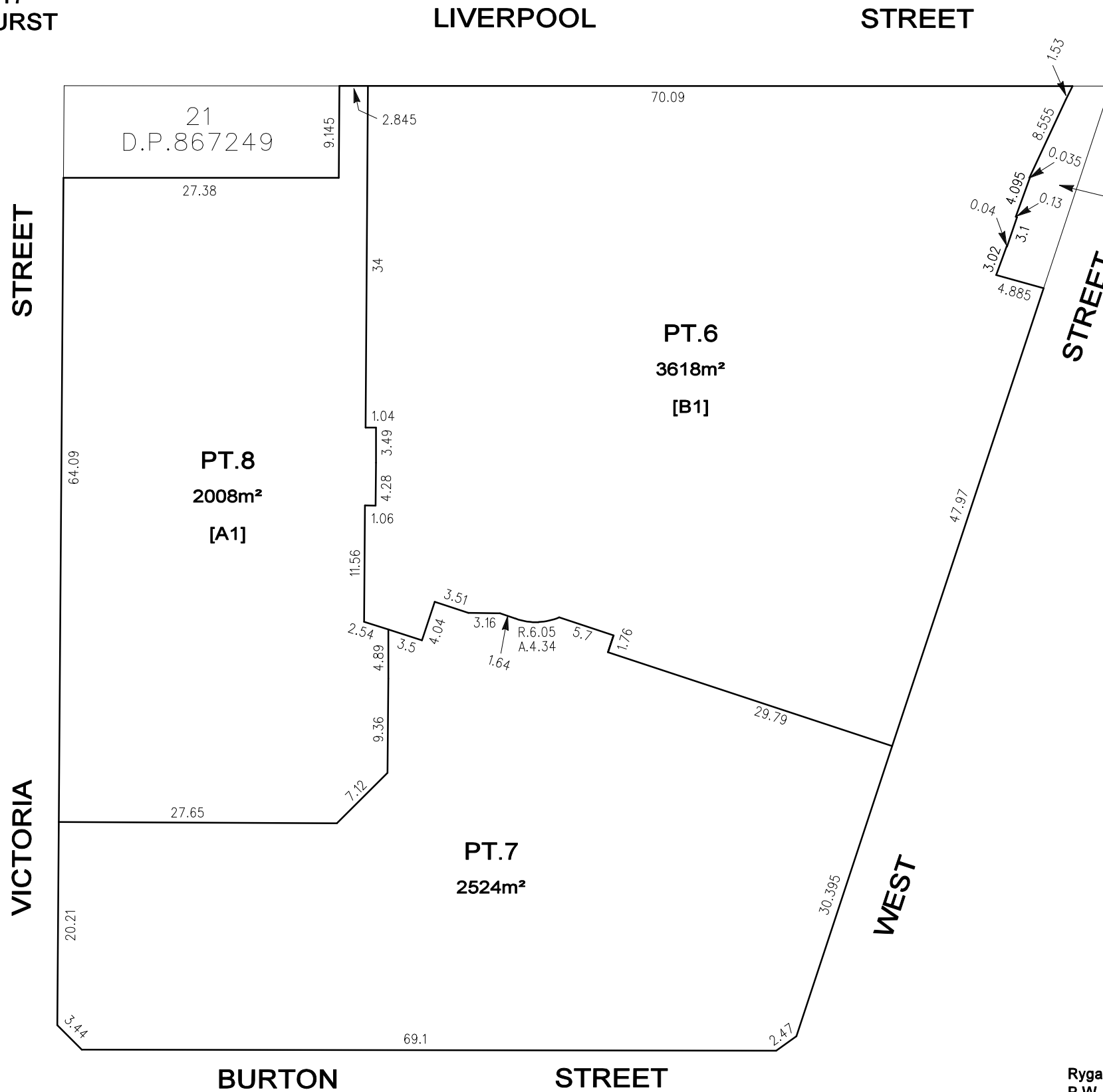

No.520
Bk.3286

STRATUM STATEMENTS
[A1] PT.8 INCLUDES LEVELS 10 TO 15
[B1] PT.5 INCLUDES LEVEL 10

NOTE :
DIMENSIONS AND AREAS SHOWN HEREON
ARE SUBJECT TO SURVEY

Rygate & Company Pty Limited
P.W. Rygate & West
ABN 61 001 204 897



a Level 9, 89 York St, Sydney NSW 2000
p +61 2 9262 6800 f +61 2 9262 6843
e surveyors@rygate.com.au
w rygate.com.au

REF: 74606 DATE: 8/6/2012