

© copyright of dem (austr) Pty Limited s/n 52 085 456 844. Any unauthorised use or distribution of information depicted on this document without dem (austr) Pty Limited prior consent is prohibited.

any reports, drawings, advice or information included or referenced that is prepared and/or provided by any other party, including the client/partner, is the sole representation of the party who prepared the report/drawing, advice or information and does not constitute a representation by dem (austr) Pty Limited. dem (austr) Pty Limited expressly takes no responsibility for any documents, advice or other material prepared by any other party.

figures dimensions to be taken in preference to scaled dimensions, verify all dimensions on the job before preparing shop drawings or commencing work. dimensions shown are computer generated and the contractor is to apply standard building tolerances.

verified suitable for the use stipulated by the relevant revision/issue only if installed and checked by an authorised dem (austr) Pty Limited representative.

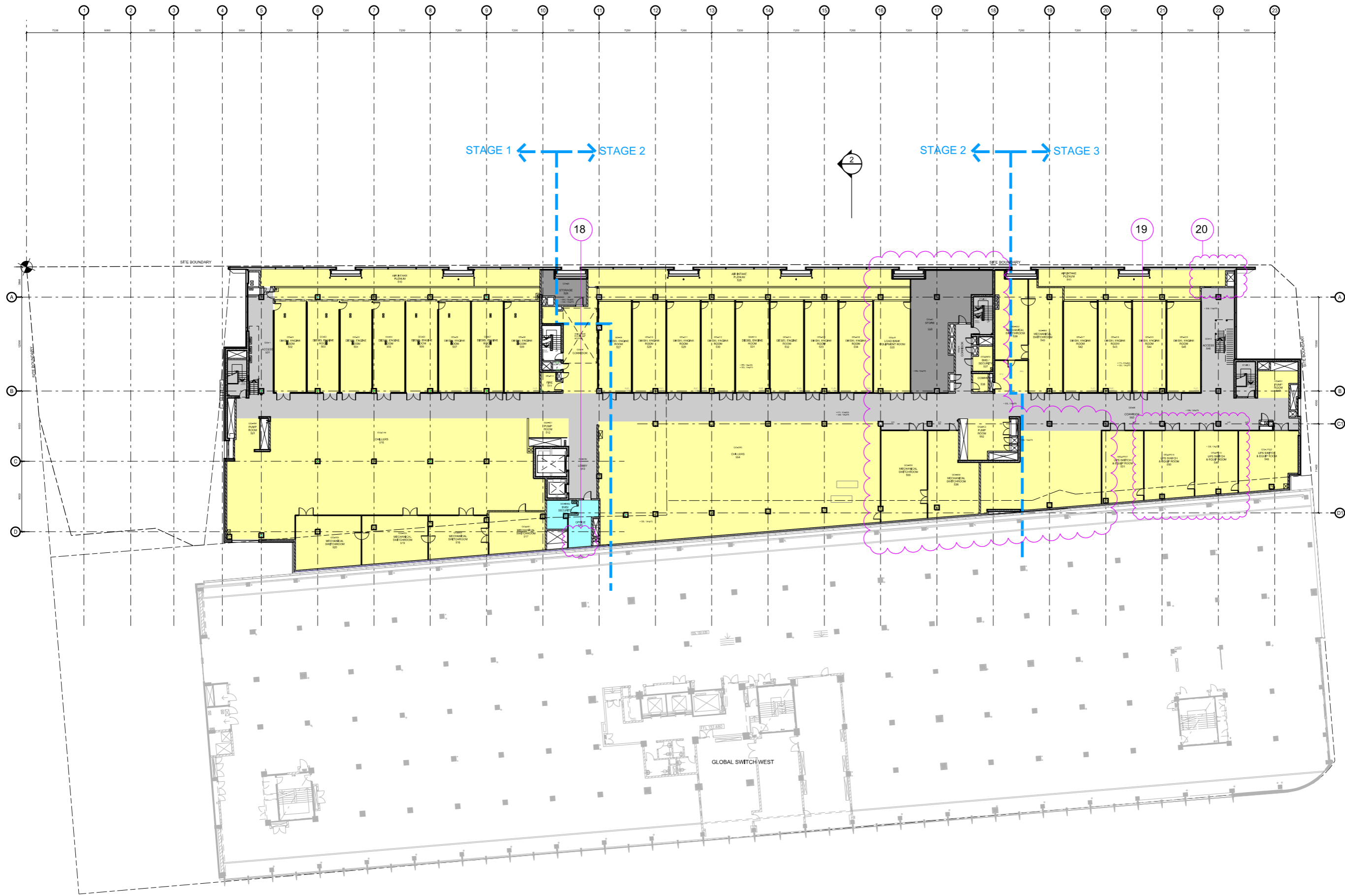

amendments		checked		verified	
no.	date	by	chk'd	int	chk'd
005	05-05-15	SECTION 75W SUBMISSION	KK	KK	SJ
	05-09-15	NUMBERED CLOUED AMENDMENTS	KK	KK	SJ

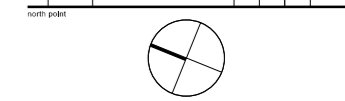

project client
GLOBAL SWITCH
 Sydney East Campus
 273 Pyrmont Street, Ultimo NSW 2007

Global Switch Property (Australia)
 400 Harris Street Ultimo NSW 2007

project manager
area3
 consulting | project management | design
 suite 1203 23 hunter street, sydney nsw 2000
 t: 1 300 786 300 w: aread3.com.au
 design & build contractor

architect

 dem
 planning, urban design, architecture,
 landscape architecture, interior design

level 8, 15 help street chatswood, nsw 2067
 pc po box 5036 west chatswood nsw 1515
 t: 02 9969 6000 f: 02 9966 6111
 e: info@dem.com.au
 structural consultant

services consultant

drawing title
Level 5 Floor Plan

section 75W

original	scale	drawn	project no.
b1	1:200	KK/MN	4277-00
drawing no.			rev no.
ar-1208			B05